

Walkie-talkie

T5 User Manual



This set included 2 walkie-talkie units: there are communication devices which operate on mobile on mobile radio frequencies. They come with 8/22(option) channels as well as back-lit LCD screen, enabling you to communicate over several kilometers free-of -charge (up to 5KM in open areas).

Note: Please read these user instructions carefully before using the equipment and retain for future consultation!

Specific Recommendations

- To avoid the risk of burns, do not use the device if the aerial is damage in any way.
- Don not use the device in a potentially explosive setting (e.g. Around pumps, on the lower deck of a boat or around a fuel-storage installation or chemical products).
- If traveling in a car or by bike, stop before using the device.
- Switch off the device if on an airplane or in a hospital.
- Never use the device in close proximity to a radio that avoid to interference.
- Remove the batteries if the device is not use for an extended period of time. Never mix used with new batteries.
- Position the transmitter and antenna at least 5cm from your face. Direct the antenna upwards and speak normally.
- Clean the device with a damp cloth. Avoid the use of cleaning agents and solvents.
- Do not modify the device in any way. In the event of damage occurring, ensure that the device us checked by a qualified professional.
- The device cannot be used to contact the emergency services.

Functional description

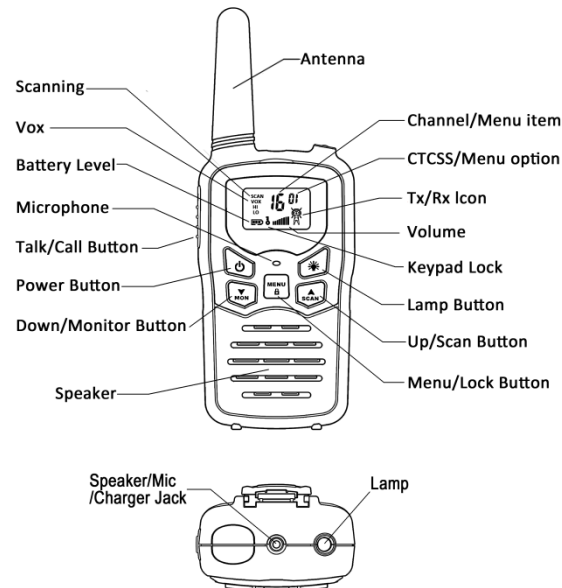

BEFORE USE

Removing the belt clip

Before insert batteries into the device, first pull the belt clip latch away from the device.

Installing the Batteries

A. FOR USE OF NON RECHARGEABLE BATTERIES:

1. Slid down the battery compartment cover.
2. Insert 4* AAA Alkaline (Not included)
3. Position the batteries according to the polarity making on the battery compartment.
4. After placing batteries into correct positions, replace the battery cover.

B. FOR USE OF RECHARGEABLE BATTERIES WITH CRADLE AND ADAPTER

1. If your walkie-talkie comes with a cradle and wall charger, you should only use the battery pack provided to charge. It cannot charge other type rechargeable batteries.

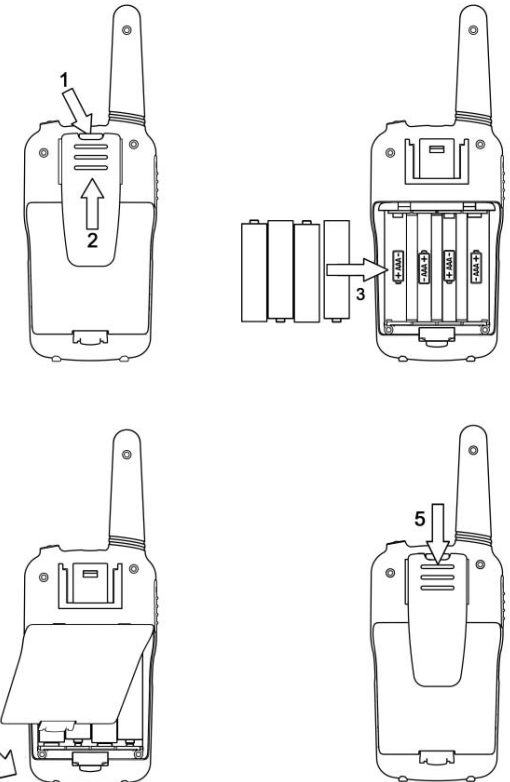

Using the device

1. Turning the device on/off

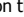
Switch on the device: Press and hold on the  button 3 seconds then you will hear a beep sound.

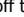
Switch off the device: Press and hold the  button 3 seconds then you will hear a beep sound.

2. Adjusting the volume

To increase the volume, press the **Up ▲** button. And press the **Down ▼** button to decrease the volume.

3. Low Battery Indication

The device can detect the low battery level when the battery voltage goes low. When battery voltage is low, the battery icon will flash and a beep will be heard to indicate that the batteries need to be replaced.

4. Receiving/transmitting communications:

The devices are in "Reception" mode when it is turned ON and no transmitting.

When a signal is received on the current channel, the LCD will display in reception.

When you press the PTT (push to talk) button, the devices switches to "Transmission" mode.

Hold the device in a vertical position with the MIC (microphone) 3-5cm away from your mouth. While holding the PTT button, speak into the microphone in a normal tone of voice.

Release the PTT button when you have finished transmitting.

For others to receive your transmission, they must be on the same channel with you.

Note:

- 1. The talking range will depend on your surroundings and environment. It will be affected by obstructions such as hills or buildings.
- 2. Don't try to use two devices which are less than 1.5m (5 feet) apart. Otherwise, you may experience interference.

5. Changing Channels

Press the MENU button one time, the channel number will flash on the display.

Press the up▲/down▼ button to change the channel.

Press the PTT button to confirm and return to stand-by mode.

Note: if no button is pressed within 15 seconds during setting, the device will return to stand-by mode.

6. CTCSS (Continues Tone Coded Squelch System)

Press the MENU button twice, the current CTCSS code will flash on the display.

Press the up▲/down▼ button to change the 99 available codes.

Press the PTT button to confirm and return to stand-by mode..

License free radio's operating on the 400-470MHZ frequency band, the device has 8/22(option) available radio channels. If there are many device users near you, there is a chance that some of the users are operating on the same radio channel.

When using CTCSS, a low frequency tone (between 67-250Hz) will be transmitted along with the voice signal. There are 99 available tones to choose form.

You are free to choose one of the 99 available sub-channels. Due to filtering, these sub-channels will generally not be audible so they will not disturb the communication.

7. VOX (Hands free function)

Press the MENU button three times, the current VOX setting will flash on the display and the VOX icon will display,

Press UP▲ button to set the VOX sensitivity level between 1 and 3 level (level 3 is the high sensitive level).

Press down▼ button until "OF" appears on the display to turn VOX OFF.

Press the PTT button to confirm and return to stand-by mode.

In VOX mode, the radio will transmit a signal when it is activated by your voice or other sound around you.

VOX Operation is not recommended if you plan to use your device in a noisy or windy environment.

Note: VOX mode will be over ride when you press the PTT button.

8. Scanning for an active radio channel

Press and hold the UP▲ button 2 seconds: The "SCAN" function indicator will appear on the display and the channel will scan continuously from 1 to 8 /I to 22. Once an active channel is found, the scanning will stop and you can listen to the transmission.

When the transmission is on the found channel stop, the scanning will resume automatically.

Note: If you press PTT button while listening to a found channel, the device will go back to stand-by mode on the found channel.

9. Monitor

Press and hold the DOWN▼ button about 3 seconds to active monitor.

Release the DOWN ▼ button return to standby mode.

10. Setting the Call tones

The device has 10 call tones.

Press the MENU button 4 times, "CA" is displayed and on the current call tone.

Press the UP▲/Down▼ button to change another call tones.

Press the PTT button to confirm and return to stand-by mode.

11. Sending a call tone

Press the PTT button one time quickly, the call tone will be transmitted on the setting channel.

12. Roger Beep On/Off

After the PTT button is released, the device will send out a roger beep to confirm that have stopped talking.

Press the MENU button 5 times; "RO" will be displayed.

Press the UP▲/Down▼ button disable the roger beep ON/OFF.

Press The PTT button to confirm your selection and return to the stand-by mode.

13. Backlit display

Press any button except for the MENU button to activate the back light of the LCD display. The back light will light on about 5 seconds.

14. Earpiece connection

The device can be used with earpiece (If there is earpiece packed together with the device).

The connector is located on the top of the device.

Insert the earpiece plug into the connector (2.5mm jack).

There is a small "PTT" button on the earpiece that has the same function as the PTT button on the device.

When you use the PTT button from the earpiece, you must also use the microphone from the earpiece to talk.

Note: Do not connect other earpieces; it may damage your device.

15. Battery saving function

When the device has not been used for 6 seconds, the economy mode is automatically activated. This does not affect the reception of transmission and the standby mode is automatically re-activated as soon as a signal is detected.

16. Built-in Flash light

Your device has a built-in flash light that can be used in sending light signals or for our lighting needs.

17. Lock & Unlock the device

Press and hold MENU button for 3 seconds to lock the device.

Press and hold MENU button for 3 seconds to unlock the device.

18. Technical specifications

Frequency	446.00625MHz~446.9375MHz
	462.5625MHz~467.7125MHz
Channel	8/22 channels
Number Sub-code	CTCSS 99
Transmission Power	≤0.5W
Range	Up to 5 Km in open field
Battery type	4* AAA Alkaline/rechargeable batteries (DC 6.0V)
	The battery voltage: 1.5V
Modulation type	FM-F3E
Channel spacing	12.5 KHz (Narrow band)

Channel and Frequency (MHz)

Europe (8CH)

Ch	Frequency	Ch	Frequency	Ch	Frequency
1	446.00625	4	446.04375	7	446.08125
2	446.01875	5	446.05625	8	446.09375
3	446.03125	6	446.06875		

USA (22CH)

Ch	Frequency	Ch	Frequency	Ch	Frequency	Ch	Frequency
1	462.5625	7	462.7125	13	467.6875	19	462.6500
2	462.5875	8	467.5625	14	467.7125	20	462.6750
3	462.6125	9	467.5875	15	462.5500	21	462.7000
4	462.6375	10	467.6125	16	462.5750	22	462.7250
5	462.6625	11	467.6375	17	462.6000		
6	462.6875	12	467.6625	18	462.6250		

FCC Statement

This equipment has been tested and found to comply with the limits for a Class B digital device, pursuant to part 15 of the FCC Rules. These limits are designed to provide reasonable protection against harmful interference in a residential installation. This equipment generates, uses and can radiate radio frequency energy and, if not installed and used in accordance with the instructions, may cause harmful interference to radio communications. However, there is no guarantee that interference will not occur in a particular installation. If this equipment does cause harmful interference to radio or television reception, which can be determined by turning the equipment off and on, the user is encouraged to try to correct the interference by one or more of the following measures:

- Reorient or relocate the receiving antenna.
- Increase the separation between the equipment and receiver.
- Connect the equipment into an outlet on a circuit different from that to which the receiver is connected.
- Consult the dealer or an experienced radio/TV technician for help.

Caution: Any changes or modifications to this device not explicitly approved by manufacturer could void your authority to operate this equipment.

This device complies with part 15 of the FCC Rules. Operation is subject to the following two conditions: (1) This device may not cause harmful interference, and (2) this device must accept any interference received, including interference that may cause undesired operation.

This equipment complies with FCC radiation exposure limits set forth for an uncontrolled environment. User should avoid un-intended operation of usage when it is collocated with other transmitters or antenna.