

INSTALL/REMOVAL INSTRUCTIONS: IGNITION LOCK CYLINDER

ATTENTION: Refer to the appropriate shop manual for your vehicle to obtain specific service procedures for this part. If you do not have a service manual or lack the skill to install this part, it is recommended that you seek the services of a qualified technician. Pay special attention to all cautions and warnings included in the shop manual. Read and follow all instructions carefully.

REMOVAL/INSTALL OF IGNITION LOCK CYLINDER (924-724) Ford 2011–90, Lincoln 2007–93, Mazda 2009–98, Mercury 2007–90

**PLEASE WEAR
SAFETY GLASSES!**

Removal Instructions

STEP 1: Disconnect battery

STEP 2: Rotate lock cylinder to the run position.

STEP 3: Push a small screwdriver or small drift punch in hole in trim shroud under lock cylinder. Push retaining pin in while pulling on lock cylinder to remove from column.



Disclaimer:

Even though every attempt is made to ensure this information is complete and accurate, it is impossible to account for all possible circumstances or situations. Please consult with a qualified auto technician before attempting to perform any work you are not qualified to do. Automobiles can be hazardous to work on; be sure to take all necessary safety precautions. Failure to do so may result in property damage or personal injury. Certain motor vehicle standards and performance requirements may apply to your motor vehicle (such as Federal Motor Vehicle Safety Standards by the National Highway Traffic Safety Administration). Be sure that your work is performed in accordance with such standards and that you do not disable any motor vehicle safety feature.

©2018 Dorman Products, Inc.

No reproductions in whole or in part without prior written approval.

INSTALL/REMOVAL INSTRUCTIONS: IGNITION LOCK CYLINDER

ATTENTION: Refer to the appropriate shop manual for your vehicle to obtain specific service procedures for this part. If you do not have a service manual or lack the skill to install this part, it is recommended that you seek the services of a qualified technician. Pay special attention to all cautions and warnings included in the shop manual. Read and follow all instructions carefully.

Installation Instructions

STEP 1: Install lock cylinder by rotating the new lock to the run position and pressing down on retaining pin.

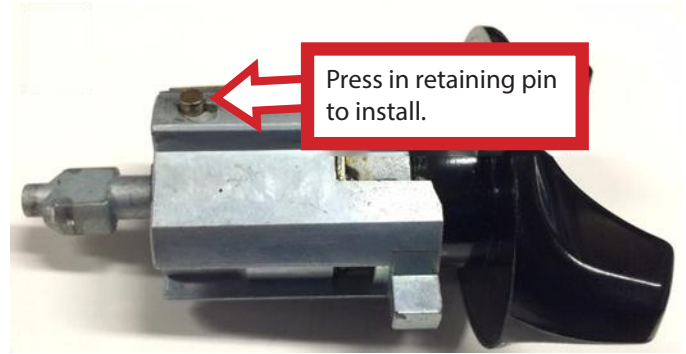

STEP 2: Insert lock into column. Ensure that cylinder is fully seated and aligned in interlocking washer before turning key to the off position. This will enable the lock retaining pin to extend into cylinder housing.

STEP 3: Rotate new lock cylinder using key to ensure proper operation in all positions.

STEP 4: Reconnect battery.

We appreciate your opinions regarding this product!
Please call our Technical Assistant with any challenges or suggestions regarding the installation or operation of this product.

1-800-523-2492

Disclaimer:

Even though every attempt is made to ensure this information is complete and accurate, it is impossible to account for all possible circumstances or situations. Please consult with a qualified auto technician before attempting to perform any work you are not qualified to do. Automobiles can be hazardous to work on; be sure to take all necessary safety precautions. Failure to do so may result in property damage or personal injury. Certain motor vehicle standards and performance requirements may apply to your motor vehicle (such as Federal Motor Vehicle Safety Standards by the National Highway Traffic Safety Administration). Be sure that your work is performed in accordance with such standards and that you do not disable any motor vehicle safety feature.

©2018 Dorman Products, Inc.

No reproductions in whole or in part without prior written approval.