

Bring fun into your way



UK/ GT1 User Manual





GENERAL SAFETY NOTICE

Always wear a helmet and protective safety equipment.

Wear closed shoes without heels and ensure your laces are tied.

Only use your scooter in line with its intended purpose.

- Check your scooter for any loose parts, flat tires, signs of damage, or excessive wear before every ride. Stop operation immediately and contact your place of purchase if something does not feel right.
- Start riding slowly to familiarize yourself with the operation of your scooter. Start in the slowest speed mode and slowly try out the brakes. Always slow down when riding over bumps or on rough road conditions. Slightly bend knees to adjust these surfaces.
- Keep the scooter away from children. It is not a toy. Riders must be 18+ years old.
- Do not use your electric scooter in heavy rain, or on surfaces covered by more than 12 mm (1/2 inches) of water. Do not submerge the scooter in liquid or let any liquid near the battery or electrical components.
- Do not lend your scooter to anybody unfamiliar with its operation. Ensure any new riders are familiar with these instructions and are wearing proper safety gear.
- Once riding in public space, you are subject to the risks faced by all traffic participants just like when you are riding a bike.
- Other traffic participants may not obey traffic regulations or may ride carelessly.
- The faster you ride your scooter, the longer it will take you to stop.
- The scooter may slip on slippery surfaces leading to subsequent injuries to the rider. Pay special attention crossing train tracks and/or when it is wet.
- Always use caution, adapt your speed to road and traffic conditions and keep distance from other traffic participants.
- Watch out for pedestrians. Do not use your scooter in any way that could harm pedestrians. Slow down when you are passing them to avoid accidents.
- You must follow all local traffic rules and regulations.
- Do not accelerate when you go downhill.
- Do not press the accelerator when you're walking the scooter.
- Always steer clear of obstacles.
- Do not hang heavy items on the handlebar.
- Keep both feet on the deck all time.
- Always keep your hands on the handlebar.
- Do not ride in traffic lanes or residential areas where vehicles and pedestrians are both allowed.
- Do not turn the handlebar violently during high-speed riding.
- Do not ride in a ponding that is higher than 38 mm (1.5 inches).

- No passengers are allowed, including children.
- Keep your feet off the rear mudguard.
- Do not touch the disc brake rotor after braking.
- Do not try riding up or down stairs or jumping over obstacles.

WARNING

As with any mechanical component, a vehicle is subject to high stresses and wear. The various materials and components may react differently to wear or fatigue. If the expected service life for a component has been exceeded, it may break suddenly, therefore risking causing injuries to the user. Cracks, scratches, and discoloration in the areas subject to high stresses indicate that the component has exceeded its service life and should be replaced.

TABLE OF CONTENTS

UNPACKING & ASSEMBLY	01
PRODUCT OVERVIEW	03
DISPLAY & BUTTONS	04
SETTINGS	06
ISINWHEEL APP	07
FOLDING & UNFOLDING	08
RIDING NOTICE	10
CHARGING INSTRUCTIONS	10
DISC BRAKE ADJUSTMENT	12
CARE & MAINTENANCE	14
SPECIFICATIONS	15
LIMITED WARRANTY STATEMENT	16
QUESTIONS & ANSWERS	18
CONTACT US	18



UNPACKING & ASSEMBLY

Package Contents



1 x Scooter



1 x Charger



1 x Toolkit



1 x Spare Headlight
Mounting Hardware Kit



1 x User Manual

- When unboxing your GT1 electric scooter, please verify that the above items are all included in the package. If anything is missing or damaged, please email the isinwheel customer service for support.
- Keep the package box to ship back the scooter when necessary.

Assembly



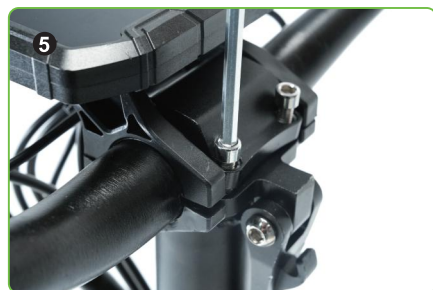
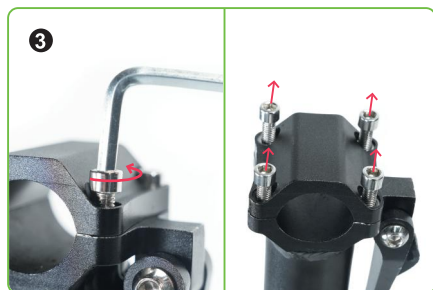

1. Lift the stem to its riding position.
2. Close the folding latch until you hear a click.
3. Remove the four bolts pre-tightened on the handlebar clamp.
4. Place the handlebar in the handlebar clamp.
5. Adjust the handlebar to a desired position and angle. Retighten the bolts of the handlebar clamp (Angle adjustment of the display is required for easy bolt tightening).
6. Tighten the bolts of the display clamp.
7. Now the scooter is fully assembled.

⚠ Fully charge the battery before your first ride.



PRODUCT OVERVIEW







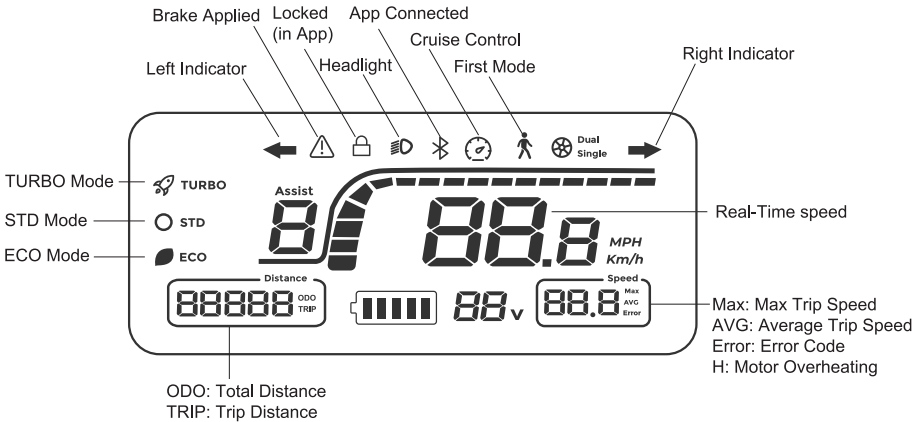

DISPLAY & BUTTONS

Display

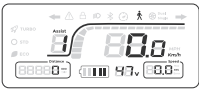

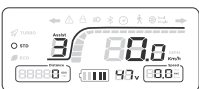
About riding mode and top speed:

Ride Mode		Top Speed
First Mode		6 km/h
ECO Mode		10 km/h
STD Mode		15 km/h
TURBO Mode		25 km/h

Buttons

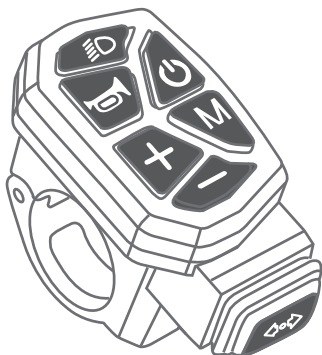

Button	Function
	<ul style="list-style-type: none"> • Hold for 2 seconds to power on/off the scooter. (The scooter will automatically power off when there is no operation for 10 minutes.) • Press to turn on the ambient lights on two sides of the deck and press again to turn off the ambient lights when the scooter is powered on.
	Hold for 3 seconds to enter the settings when the scooter is powered on.
	<ul style="list-style-type: none"> • Press to turn on the headlight, taillight, red side lights, and the blue spot lights when the scooter is powered on. • Press again to turn off these lights.
	Press to sound the horn and release to stop the horn when the scooter is powered on.
	Press to change the riding mode from 1 to 4 when the scooter is powered on. (The riding mode resets to 1 every time the scooter restarts.)
	Press to change the riding mode from 4 to 1 when the scooter is powered on. (The riding mode resets to 1 every time the scooter restarts.)
	Push to the left or right to turn on the left or right indicator lights and spot light respectively when the scooter is powered on.



SETTINGS

1. To enter the settings, hold the “M” button for about 3 seconds when the scooter is powered on.
2. After entering the settings, press the “M” button to switch the setting items between P01, P05, P06, P99, and ODO.
3. When selecting P01, P05, or P06, press the “+” or “-” button to change the setting. When selecting P99 or ODO, hold the “+” button to change the corresponding settings and the scooter will return to the main screen after changing.
4. After changing the setting of the previous item (P01, P05, or P06), press the “M” button to save the setting and switch to the next item.
5. After changing all the setting items, to save all the settings, hold the “M” button for about 3 seconds or you can wait 5 seconds, and the settings will be saved and the scooter will return to the main screen.

There are 5 setting items in the settings:

P01: System of units (00 means metric system and 01 means imperial system)

P05: Cruise control (00 means off and 01 means on)

P06: Zero start/non-zero start (00 means zero start and 01 means non-zero start)

P99: Factory reset all the settings (hold the “+” button for 5 seconds)

ODO: Reset odometer (hold the “+” button for 5 seconds)



Scan the QR code or search "isinwheel" on the App Store (iOS) or Google Play Store (Android) to download the app for more information and functions.



1. Open the app and tap "Sign up".

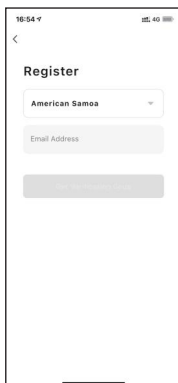

2. Select country or region and enter your email address.

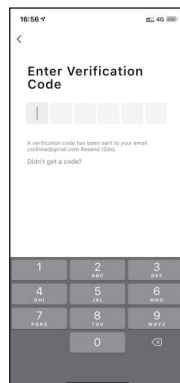

3. Find the verification code sent by us in your mailbox. Fill in the verification code.



4. Set a password for your account.

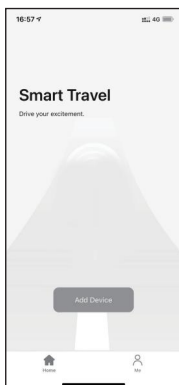

5. Account registration is finished. You are ready to use the app.



FOLDING & UNFOLDING

Folding Steps

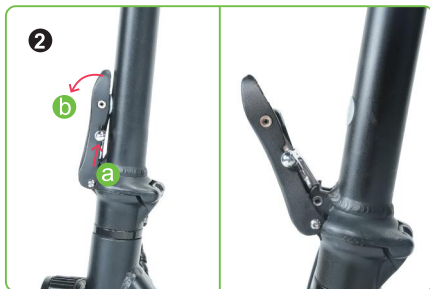

1. Hold the Power button for 2 seconds to turn off the scooter.
2. Open the folding latch.
3. Fold down the stem.
4. Adjust the stem or the handlebar to make the hook catch either of the two horizontal bars above the rear fender.
5. Now the stem can be used as a carrying handle to transport the scooter.

Unfolding Steps



1. Detach the hook from the horizontal bar.
2. Raise the handlebar back into the riding position.
3. Close the folding latch until it clicks in place.
4. Now the scooter is fully unfolded.



RIDING NOTICE

- The isinwheel GT1 electric scooter is a leisure device. But once they're in a public area, they'll be seen as vehicles, subjecting to any risks faced by vehicles. For your safety, please follow instructions in the manual and traffic laws and regulations set forth by government and regulatory agencies.
- At the same time, you should understand that risks cannot be entirely avoided as others may violate traffic regulations and drive incautiously, and you're exposed to road accidents just as when you're walking or biking. The faster the scooter is, the longer it takes to stop. On a smooth surface, the scooter may slip, lose balance, and even result in a fall. Thus it is crucial that you use caution, keep proper speed and distance, especially so when you're unfamiliar with the place.
- Respect pedestrians' Right of Way. Try not to startle them while driving, especially children. When you ride from behind pedestrians, ring your bell to give them a heads-up and slow your scooter to pass from their left (applicable to countries where vehicles drive on the right). When you ride across pedestrians, keep to the right at a low speed. When you drive across pedestrians, keep the lowest speed or getting off the vehicle.
- Closely follow the safety instructions in the manual. isinwheel shall not be liable for any financial losses, physical injuries, accidents, legal disputes and other interest conflicts resulted from actions that violate user instructions.
- Do not lend your scooter to whoever doesn't know the operations. And when you do lend it to your friends, please take the responsibility to ensure he/she knows the operation and wears the safety gear.
- Check the scooter before every use. When you note loose parts, low battery alerts, excessive wear, strange sounds, malfunctions, and other abnormal conditions, stop riding.
- **WARNING – Risk of Fire – No User Serviceable Parts.**



CHARGING INSTRUCTIONS

- Your scooter will be fully charged when the LED indicator on the charger turns green from red.
- With charging protection, the scooter will cut off charging automatically after the battery is fully charged. Even so, we still don't recommend charging your scooter for more than 24 hours continuously.
- Do not connect the charger if the charging port is wet.
- Keep the charging port closed when not charging.



Never use a charger other than the official one to avoid danger.

Charging Warnings and Battery Safety Warnings

- Use caution when using outlets to prevent electric shock.
- Do not leave the charger plugged in for extended period of times (> 24 hours).
- Only charge your scooter in a safe, clean, and dry environment. Keep the charger and scooter away from inflammable materials as they may get hot.
- Only use the original battery packs and the original charger supplied with your scooter.
- Contact your place of purchase if you need a replacement. Use of other models or brands may not be safe.
- Do not touch any part of the charging port and keep them away from metal objects to prevent short circuiting which may result in battery damage or physical injuries, and/or death.
- Do not place the battery in direct contact with heat or near high temperatures.
- Do not expose the battery to direct sunlight.
- Do not leave the scooter in a car where the battery might get hot.
- Do not pierce the battery with sharp objects. Do not subject it to impact or force.
- Stop charging if the battery fails to recharge within the approximate charging time. This will prevent the battery from overheating, rupturing, or igniting.
- Do not charge the battery in temperatures below 0°C / 32°F or above 40°C / 104°F as this can hamper performance, result in breaking, overheating, rupturing, or igniting and could cause personal injury or property damage.
- Do not charge your scooter if the charging port on the scooter is damaged or wet. Do not charge if there is excessive heat, odor, or leakage coming from the battery or it looks abnormal in any way.
- If the battery leaks and you accidentally get in touch with the liquid, rinse immediately and thoroughly with water and then seek medical care.
- Never attempt to disassemble, modify, or perform repairs or maintenance on the battery. You run the risk of damaging the protective and safety components that prevent incidents, personal injury, or property damage.
- Mishandling or misuse of the battery can result in lower performance, shorter lifespan, rupturing, igniting, or other incidents and could increase the risk of serious personal injury.
- Do not discharge the battery using any other product than the scooter. Doing so could result in damage to other products or the battery and reduced lifespan of your scooter.
- The battery could overheat, rupture, or ignite and cause personal injury or property damage.
- In daily use, avoid recharging the scooter after completely exhausting the battery. If the battery level is low, charge the scooter as soon as possible.
- Please charge the scooter every other month to preserve the battery.



DISC BRAKE ADJUSTMENT

To adjust the disc brake



You need a hex wrench to loosen the bolt on the cable clamp.

- If the disc brake is dragging, slide the arm of the clamp backward along the cable while holding the cable in one hand. Then, retighten the bolt on the brake clamp.
- If the disc brake does not work efficiently, the cable is slack. You need to slide the arm of the clamp forward along the cable while holding the cable in one hand. Then, retighten the bolt on the brake cable clamp.

Notice: The disc brake may squeak when in use until it is broken in. This is normal and does not affect the brake's function or performance.

To eliminate brake noise

For easier operating, we suggest you put the scooter on the desk.



1. Turn off the scooter.
2. Loosen the two brake caliper mounting bolts (not the bolt on the cable clamp).
3. Reposition the brake caliper to make the brake rotor in the middle of the brake pads.
4. After repositioning the brake caliper, retighten the bolts.



CARE & MAINTENANCE

Cleaning

To clean stains on the scooter's body, wipe them off with a damp cloth. For stubborn stains, brush them with toothpaste and then wipe them off with a damp cloth.

- Do not clean the scooter with alcohol, gasoline, kerosene, or other corrosive and volatile chemical solvents.
- Do not wash the scooter deck with high-pressure water sprays. During cleaning, make sure the scooter is turned off, the charging cable is unplugged, and the waterproof charging port cover is closed to prevent electric shock or other major problems.

Storage

- Store the scooter in a cool and dry place with a temperature of -10°C~35°C (14°F~95°F) when it is not in use. In extremely humid environments, the internal parts may suffer from condensation or even water accumulation, which may damage the battery rapidly.
- Store the scooter indoors as prolonged exposure to UV rays and rainwater may damage the enclosure materials and reduce the battery pack's lifespan.
- Charge the scooter every other month to preserve the battery during storage.
- Mishandling of used batteries may do tremendous harm to the environment. Please follow local regulations to dispose of used batteries to protect the environment.

Battery Maintenance

- Only use the original battery pack and charger to avoid safety hazards.
- Fully charge the battery to maximize its lifespan after each use.
- Charge the battery as soon as possible if the battery is low. Avoid charging the battery after completely exhausting it.
- Never dismantle or puncture the battery.
- Keep the battery contacts from metal objects to prevent short circuits that may result in battery damage or even injuries and deaths.

Battery Disposal

- Do not dispose of your battery by way of land filling, incineration, or household trash.
- We recommend disposing your battery through a local recycling program suitable for lithium-ion batteries. Contact your local waste management service for more information.
- Mishandling of used batteries may do tremendous harm to the environment. You must abide by local laws and regulations to properly dispose of used batteries.

SPECIFICATIONS

Scooter	Unfolded Size (L x W x H)	116*65*116 cm / 45.67*25.6*45.67 in.
	Folded Size (L x W x H)	116*65*60 cm / 45.67*25.6*23.62 in.
	Scooter Weight	23.75 kg / 52.25 lbs
	Max Load Capacity	150 kg / 330 lbs
	Recommended Age	18+ Years Old
	Max Speed	25 km/h / 15.5 mph
	Range	40~45 km / 25~28 Miles
	Operating Temperature	-15~40 °C / 5~104 °F
Wheel	Type	Off-Road Pneumatic Tires
	Size	10 in.
Battery	Capacity	48 V, 10 Ah
	Charging Time	4~5 h
Motor	Power	800 W
Charger	Input	AC 100-240 V, 50/60 Hz, 2.5 A
	Output	DC 54.6 V, 2 A

(1) About the height: from the ground to the highest end of the body.

(2) About the range: measured under the conditions of a full charge, a load of 70 kg (154 lbs), at 25°C (77°F), on a flat road without wind, and at a speed of 15 km/h (9.3 mph). The actual range will differ with different factors, such as load, humidity, wind speed, and operation habits.

(3) The maximum load shall be kept within 150 kg (330 lbs) (rider and belongings included) in any case. Consider the extra weight of the gravity generated by speed.



LIMITED WARRANTY STATEMENT

30 DAY SATISFACTION GUARANTEED RETURN POLICY

If you are unsatisfied with your purchase, isinwheel's return policy allows you to return the product purchased on the Authorization channel within 30 days counting from the date of receipt of shipment, and request a refund from the Authorization channel for any reason.

For the return request, isinwheel is not responsible for lost packages due to the carrier, or products received that cannot be verified. Received products that have damage determined to have been caused by the end-user may be subject to denial of the return request.

TO QUALIFY FOR A REFUND, ALL THE FOLLOWING CONDITIONS MUST BE MET.

1. A Return Merchandise Authorization (RMA) must be requested from isinwheel within 30 days from the date of receipt of shipment. To request an RMA, email the isinwheel Service Team.
2. The cost of return shipping will be borne by the customer.
3. For warranty service, please keep your receipt and/or invoice to validate proof of purchase.
4. Returned product must be in good physical condition (not physically broken or damaged).
5. All accessories originally included with your purchase must be included with your return.
6. If you return a product to isinwheel, (a) without an RMA from isinwheel(b) without all parts included in the original package, isinwheel retains the right to refuse delivery of such return.

LIMITED PRODUCT WARRANTY

1. isinwheel warrants the original purchaser that your isinwheel product shall be free from defects in materials and workmanship under normal use for a period aforementioned.
2. isinwheel does not warrant the operation of the product will be uninterrupted or error-free. isinwheel is not responsible for damage arising from failure to follow instructions relating to the product's usage.
3. Within 180 days after purchasing the scooter, if the battery is defective, it can be replaced free of charge. After exceeding this time limit, it needs to be replaced at a charge.
4. Only the original owner of an scooter purchased from isinwheel online store is covered by this Limited Warranty. The Warranty Period begins upon your receipt of the scooter and shall end immediately upon the earlier of the end of the Warranty Period or any sale or transfer of the scooter to another person, and under no circumstances shall the Limited Warranty apply to any subsequent owner or other transferees of the scooter.

LIMITED WARRANTY DOES NOT COVER

1. Normal wear and tear of any Covered Component.
2. Consumables or normal wear and tear parts (including without limitation tires, tubes, brake pads, cables, housing, grips).
3. Any damage or defects to Covered Components resulting from failure to follow instructions in the scooter owner's manual, acts of God, accident, misuse, neglect, abuse, commercial use, alterations, modification, improper assembly, installation of parts or accessories not originally intended or compatible with the scooter as sold, operator error, water damage, extreme riding, stunt riding, or improper follow-up maintenance.
4. For the avoidance of doubt, isinwheel will not be liable and/or responsible for any damage, failure or loss caused by any unauthorized service or use of unauthorized parts.
5. The Battery is not warranted from damage resulting from power surges, the use of an improper charger, improper maintenance or other such misuses, normal wear or water damage.

REMEDIES

- If a hardware defect is found and a valid claim is received by isinwheel within the Warranty Period, isinwheel will, at its option and to the extent permitted by law, either (1) repair the product at no charge, using new or refurbished replacement parts or, (2) replace the product with a new or refurbished product. In the event of a defect, to the extent permitted by law, these are your sole and exclusive remedies. Shipping and handling charges may apply except where prohibited by applicable law. This Limited Warranty is valid only in the jurisdictions where the products are sold from our official website, and is valid to the extent permitted by the applicable laws of such jurisdictions.
- Any replacement hardware product will be warranted for the remainder of the original warranty period or thirty (30) days, whichever is longer, or for any additional period of time that may be applicable in your jurisdiction.

HOW TO OBTAIN WARRANTY SERVICE

- A Warranty Service Order must be requested from isinwheel within Warranty Period from the date of receipt of shipment. To request a Warranty Service Order, contact isinwheel Service Team.
- To obtain warranty service, you must deliver the product, in either its original packaging or packaging providing an equal degree of protection, to the address specified by isinwheel. In accordance with applicable law, isinwheel may require the customer to furnish proof of purchase details and/or comply with registration requirements before receiving warranty service. period or thirty (30) days, whichever is longer, or for any additional period of time that may be applicable in your jurisdiction.

LIMITATION OF DAMAGES

- Except to the extent prohibited by applicable law, isinwheel shall not be liable for any incidental, indirect, special, or consequential damages, including but not limited to loss of, even when isinwheel has been advised of the profits, revenue or data, resulting from any breach of express or implied warranty or condition, or under any other legal theory possibility of such damages.
- Some jurisdictions do not allow the exclusion or limitation of special, indirect, incidental or consequential damages, so the above limitation or exclusion may not apply to you.

QUESTIONS & ANSWERS

1. What if the scooter arrived with broken or missing parts?

Answer: Please take a photo and send to the isinwheel Support Team by email, and isinwheel Support Team will reply to you soon and send the correct replacement part.

2. Are the tyres replaceable and how to replace them?

Answer: Yes, the tyres are replaceable. Please contact the isinwheel support team for more information or search "How to replace scooter tyres" tutorial videos on YouTube.

3. What if the disc brake doesn't work well?

Answer: Please see "DISC BRAKE ADJUSTMENT" in this manual or search "How to adjust scooter disc brakes" tutorial videos on YouTube. If you still have problems, please contact us.

4. What should I do when I hear unusual noise from the rear wheel?

Answer: It usually means your brake rotor tilts to cause friction noise. Please see "DISC BRAKE ADJUSTMENT" in this manual. If you still have problem, please contact us.

5. What should I do when there is an error code on the screen?

Answer: If you see any error code below, please contact the isinwheel Support Team to remove the error code.

Name	Definition
E10	Communication Fault
E14	Accelerator Fault
E15	Brake Lever Fault
E16	Motor Hall Sensor Fault
E50	Over-Voltage

CONTACT US

Contact us if you experience issues relating to riding, maintenance and safety, or errors/faults with your isinwheel GT1 electric scooter.

✉ support@isinwheel.co.uk
support@isinwheel.fr
support@isinwheel.de
support@isinwheel.es

🌐 www.isinwheel.co.uk
www.isinwheel.fr
www.isinwheel.de
www.isinwheel.es

1. CE Warning

- 1) The appliance is not to be used by persons (including children) with reduced physical, sensory or mental capabilities, or lack of experience and knowledge, unless they have been given supervision or instruction.
- 2) Children being supervised not to play with the appliance.

2. Disposal of Electrical and Electronic Equipment

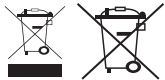

The crossed-out garbage can means that you are legally obliged to dispose of these devices separately from unsorted municipal waste. Disposal via the residual waste bin or the yellow bin is prohibited. If the products contain batteries or rechargeable batteries that are not permanently installed, they must be removed before disposal and disposed of separately as a battery.

3. Options for Returning Old Devices (EAR)

Owners of old devices can hand them over within the scope of the options for returning or collecting old devices that have been set up and made available by public waste disposal authorities, so that proper disposal of the old devices is ensured.

4. Data Protection

We advise all end users of waste electrical and electronic equipment that you are responsible for deleting personal data on the old devices to be disposed of.

5. Declaration of Conformity

Shenzhen Xincheng Times Technology Co., Ltd. hereby declares that the device of type "GT1" complies with the legal regulations of the EU Directives 2014/30/EU and 2011/65/EU (RoHS).

For the full text of the EU Declaration of Conformity, visit the link:

<https://www.isinwheel.co.uk/pages/declaration-of-conformity>