



INSTRUCTION MANUAL

EW3060

HYDROH1 2-in-1 Cordless Hard Floor Cleaner
Back/Red

Ewbank has a British heritage to be proud of. It's a household favourite and much loved brand that has been providing innovative cleaning solutions for over 140 years.



| | |
|-----------------------------------|-------|
| Safety Instructions..... | 3-7 |
| Appliance Overview | 8-9 |
| Product Assembly..... | 10 |
| Operating Instructions..... | 11-14 |
| Cleaning & Maintenance | 15-18 |
| Troubleshooting | 19-20 |
| Specifications | 21 |
| Fuse Replacement..... | 22 |
| Disposal of the Appliance | 22 |
| Warranty Terms & Conditions | 23 |

SAVE THESE INSTRUCTIONS

Household use only.

When using an electrical appliance, basic precautions should always be followed, including the following:

READ ALL INSTRUCTIONS BEFORE USING THIS

APPLIANCE, Failure to follow the warnings and instructions may result in electric shock, fire and/or serious injury.

WARNING—To reduce the risk of fire, electric shock, or injury:

1. Use only indoors, on non-carpeted floor surfaces such as vinyl, tile, sealed wood, etc. Be careful not to run over loose objects or edges of area rugs. Stalling the brush may result in premature belt failure.
2. Do not allow to be used as a toy. Close attention is necessary when used by or near children, pets or plants.
3. Use only as described in this manual. Use only manufacturer's recommended attachments.
4. Do not use with damaged cord or plug. If appliance is not working as it should, has been dropped, damaged, left outdoors, or dropped into water, return it to a service center.
5. Do not handle charger, including charger plug, and charger terminals with wet hands.
6. Do not put any object into openings. Do not use with any opening blocked; keep free of dust, lint, hair, and anything that may reduce air flow.
7. Keep hair, loose clothing, fingers, and all parts of body away from openings and moving parts.
8. Use extra care when cleaning on stairs.
9. Do not use to pick up flammable or combustible liquids, such as gasoline, or use in areas where they may be present.

10. Do not pick up anything that is burning or smoking, such as cigarettes, matches, or hot ashes.
11. Do not use without filter.
12. Prevent unintentional starting. Ensure the switch is in the off-position before picking up or carrying the appliance. Carrying the appliance with your finger on the switch or energizing appliance that have the switch on invites accidents.
13. Always switch off the appliance before making any adjustments, changing accessories, or storing appliance. Such preventive safety measures reduce the risk of starting the appliance accidentally.
14. Recharge only with the charger specified by Ewbank. A charger that is suitable for one type of battery pack may create a risk of fire when used with another battery pack.
15. Use appliances only with specifically designated Ewbank battery packs. Use of any other battery packs may create a risk of injury and fire.
16. Under abusive conditions, liquid may be ejected from the battery; avoid contact. If contact accidentally occurs, flush with water. If liquid contacts eyes, additionally seek medical help. Liquid ejected from the battery may cause irritation or burns.
17. Do not use a battery pack or appliance that is damaged or modified. Damaged or modified batteries may exhibit unpredictable behavior resulting in fire, explosion or risk of injury.
18. Do not expose a battery pack or appliance to fire or excessive temperature. Exposure to fire or temperature above 130°C may cause explosion.
19. Follow all charging instructions and do not charge the battery pack or appliance outside of the temperature range specified in the instructions. Charging improperly or at temperatures outside of the specified range may

damage the battery and increase the risk of fire.

20. Have servicing performed by a qualified repair person using only identical replacement parts. This will ensure that the safety of the product is maintained.
21. Do not modify or attempt to repair the appliance or the battery pack except as indicated in the instructions for use and care.
22. Always turn off this appliance before connecting or disconnecting motorized nozzle.
23. Do not charge or store the appliance outdoors or inside the car. Only charge, store or use the battery in a dry indoor area where the temperature is higher than 4°C but lower than 40°C. The charger is for indoor use only.
24. Do not use to pick up ultrafine particles, such as lime, cement, sawdust, gypsum powder, or ashes.
25. Do not use to pick up sharp objects, such as metallic nails, pieces of glass, metal paper clips, or pins.
26. Do not use to pick up hazardous material and chemicals, such as solvent, drain cleaner, strong acids or strong alkali.
27. Stop using immediately if the machine is overheating, making unusual noises, issuing unusual odor, performing low suction, or leaks electricity.
28. Turn cleaner OFF and disconnect from electrical outlet in case of long-term storage.
29. Always clean dirty water tank after each use to avoid potential blockage, which may result to low suction power, motor overheating or reduce the service life.
30. Store appropriately indoors in a dry place after use.
31. Do not place or submerge machine in standing water or try to clean flooded areas.
32. All date and technical instruction of this manual based on results from lab tests of Ewbank or designated third party. The company reserves all rights for final explanation.

33. Do not use the appliance when the water depth is more than 5mm above the surface.

Range of Usage

- The HYDROH1 2-in-1 cordless hard floor cleaner is to be used on indoors hard floor, such as vinyl, tile, sealed wood, etc. Use on a rough surface may not get the best performance.
- Keep your appliance away from heat sources, such as fireplace or heater, to avoid casing deformation.
- Do not use to pick up flammable or combustible liquids, ultrafine particles, sharp objects, hazardous material, chemicals or anything that is burning or smoking, as described above.

About Cleaning Solution

- A large amount of cleaning solution entering into the motor may cause danger.
- Add solution as instructed on page 12. Do not use the product with acidic, alkaline solution or any substances harmful to the environment.
- Keep out of reach of children. If any solution gets into the eyes, immediately flush them with clean water. If any solution be swallowed by accident, seek medical care immediately.
- Dirty water and solution disposal should comply with local environmental regulations.

About the Cleaner

- Do not modify or attempt to repair the cleaner except as indicated in the instructions for operating and cleaning.
- Charge the machine with Ewbank HYDROH1 adaptor. Input Voltage: AC 100-240V. Both high and low voltages can damage the adaptor or the machine, even cause danger to the user.
- Use extra care when cleaning on stairs.

- Ensure that the Power Switch is in the OFF-position before picking up or carrying the machine. Do not lay flat or lean down the machine to prevent dirty water from entering into the motor.
- To avoid being accidentally tripping over the appliance, please put the unit on the storage tray near wall.
- Always install the tanks rightly before use.
- Do not allow the appliance or charger to get wet to avoid risk of fire or injury caused by short circuit.

READ AND SAVE THESE INSTRUCTIONS

This hard floor cleaner is intended for household use only.

Read the safety and operating instructions through carefully before using the floor washer. This is the only way to ensure safe and reliable use of the device. If the appliance is sold or passed on, ensure it is equipped with this instruction manual. You will also need these operating instructions for ordering spare parts and accessories. Please keep this booklet in a safe place.

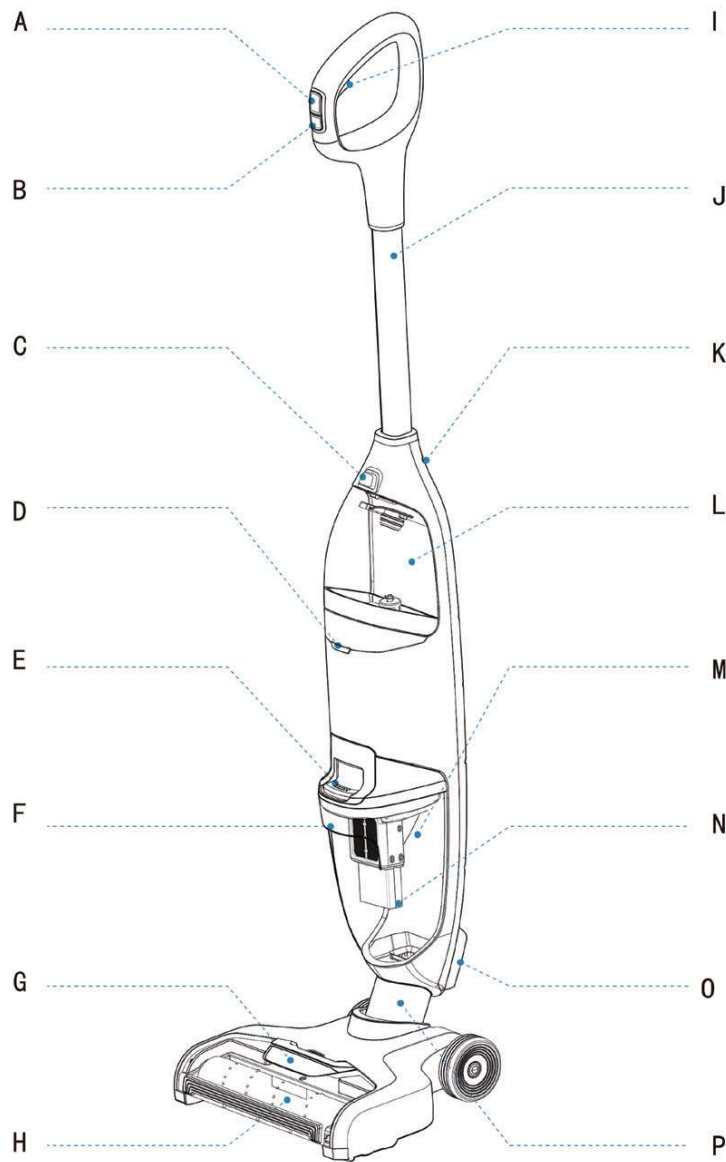

Accessories

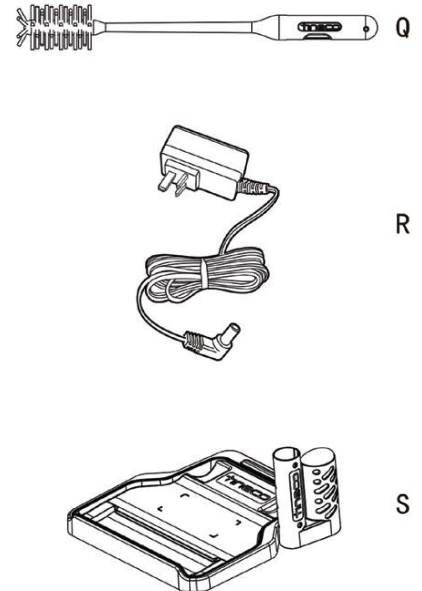

- A. Switch button
- B. Boost button
- C. Clean water tank release button
- D. Indicator light
- E. Dirty water tank release button
- F. Dirty water tank handle
- G. Brush roll cover
- H. Brush roll
- I. Solution trigger
- J. Handle

- K. Handle fix screw
- L. Clean water tank (CWT)
- M. Dirty water tank (DWT)
- N. Filter and floater
- O. Air outlet cover
- P. Brush rotator
- Q. 2-in-1 cleaning tool
- R. Charger adaptor
- S. Self-cleaning storage tray

ACCESSORIES

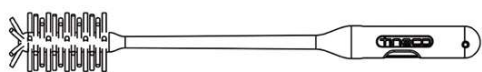

2-in-1 cleaning tool

A full brush to clean DWT, brush chamber and the opening; the end with bristle to remove dirt and mud on the roller and DWT; the end with small blade to remove hair and debris wrapped around the roller.

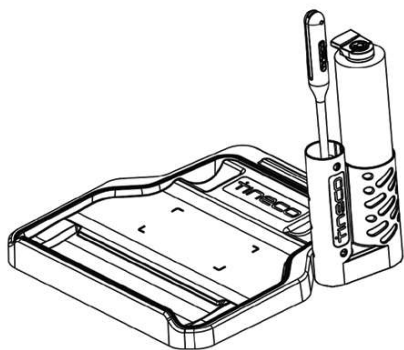

Self-cleaning Storage Tray

Place the appliance on the storage tray vertically. Store the 3-in-1 cleaning tool and the brush roll in the tool caddy.

* Actual accessories may vary from shown or change without notice, available accessories may vary by market

HANDLE ASSEMBLY / DISASSEMBLY

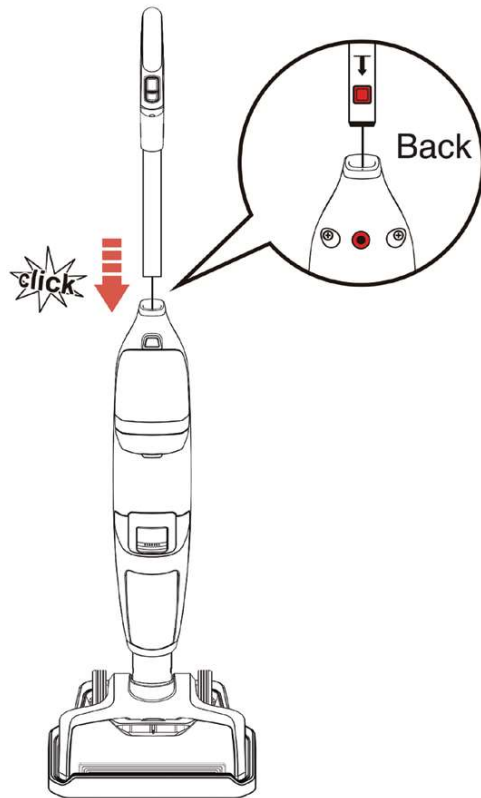

To assemble the handle, insert it into the unit base until you hear a click.

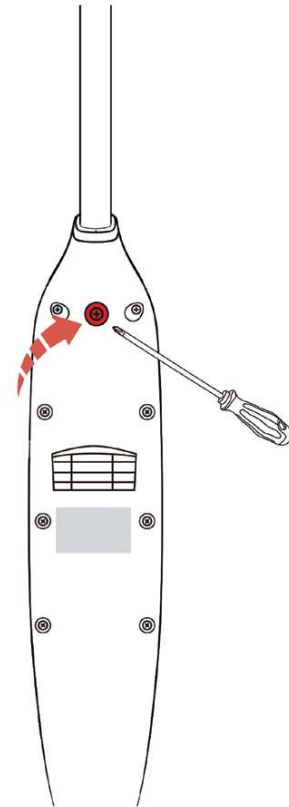

To disassemble the handle, first remove the screw with screwdriver, then press the spring located with a tool to release the handle. Lift the released handle from the unit.

Note: Before the first use, please charge the appliance for 3-4 hours (refer to "Charging Instructions" for details).

Use directly when you just need to absorb water; add water/solution when you need to deep clean the floor (refer to "FILLING CLEAN WATER TANK" for details).

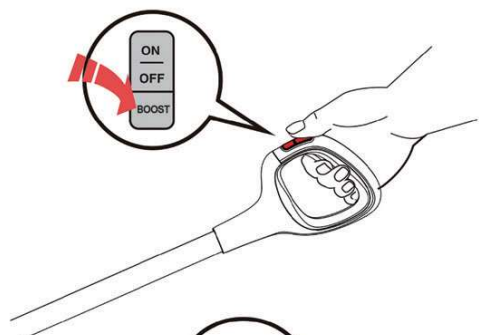

Switch ON to start the machine.
Press Boost button for Boost mode to remove tough dirt and stains with higher speed and stronger spray.

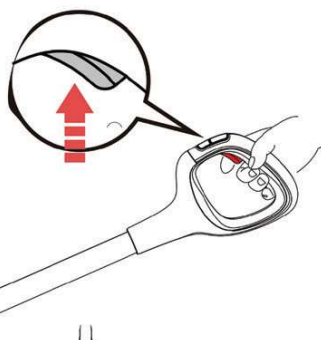

Squeeze the Solution trigger when moving backward to spray liquid as needed.

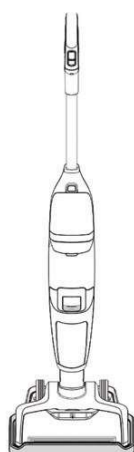

Place the appliance on the storage tray vertically after use.

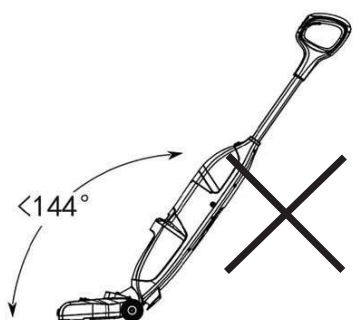

Note: Do not recline the appliance over 144° to prevent water leakage.

Note:

- *Do not use for absorbing foam liquid.
- *When cleaning excessively dirty, press Boost button for Boost mode.

FILLING CLEAN WATER TANK



Press clean water tank release button to remove it from the unit.

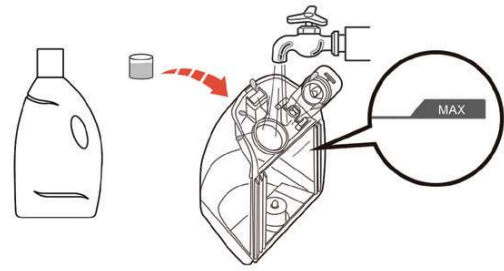

Open the tank cap, fill the tank with warm tap water (60°C MAX). When deep cleaning, add one bottle cap of floor cleaning solution (not included) to the water, then close the cap tightly.



Place back the tank until you hear a click.

IMPORTANT NOTE: To prevent leakage during operation DO NOT fill Clean Water Tank to the MAX line

EMPTY DIRTY WATER TANK



Press dirty water tank release button to remove it from the unit.

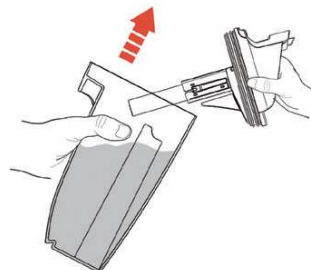

Pour dirty water and debris out.



Place the tank back in place until you hear a click.

IMPORTANT NOTE: When you hear a tone change in the sound of the motor you need to turn off the appliance immediately and empty the DWT to prevent water leakage. If you are using the appliance for large jobs then ensure you empty the DWT regularly



CHARGING

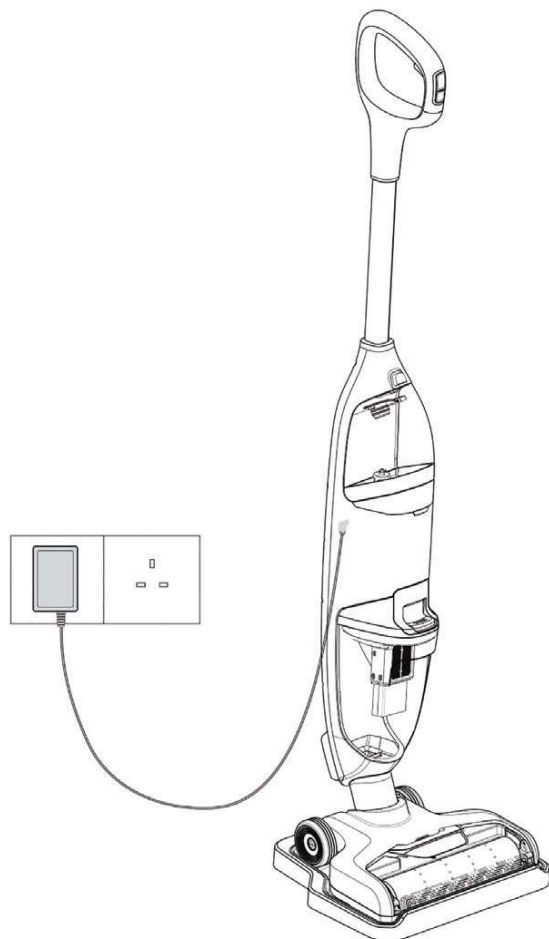

The indicator light will flash red when it's power is low.

Please charge it.

1. Before charging the unit, please ensure that all water has been removed from the clean and dirty water tanks and the machine is dry.
2. To charge the unit, connect the external charger cord to the unit and plug into the wall outlet.
3. To avoid tripping accidentally, please put the unit on the storage tray near the wall during charging.

Charge the unit only with the adaptor from Ewbank.

- For optimal performance, the unit must be charged every 3 months. It may take 3-4 hours for a full charge.
- Store appropriately indoors in a dry place. Do not expose machine to sunlight or freezing temperature. Recommended temperature range: 4°C ~ 40°C.

IMPORTANT NOTE: To prevent leakage during operation DO NOT fill Clean Water Tank to the MAX line

INDICATOR LIGHT

Working



Solid blue light: Normal mode



Flashing blue light: Boost mode

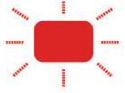

Flashing red light: The appliance/brush roll is blocked, or out of power

During Charging

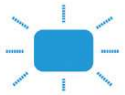

Breathing blue light.

Charging Complete



Solid blue light for 2 minutes then turns off.

Battery Disposal Warning:



- Remove the built-in battery before disposing.
- Switch OFF and disconnect plug from electrical outlet before removing the battery.
- Dispose of batteries properly and safely. DO NOT dispose of battery in fire, water, soil or trash compactor.
- Leaks from battery cells can occur under extreme conditions. If any liquid gets on the skin wash quickly with soap and water. If any liquid gets into the eyes, do not rub eyes, immediately flush them with clean water continuously for a minimum of 15 minutes. Seek medical attention immediately.

Note:

- In order to maintain performance, it is recommended that you clean the components regularly.
- For optimal performance and preventing odors, always clean and dry the DWT, floater, filters, pre-filter, brush roll, brush roll cover after each use.

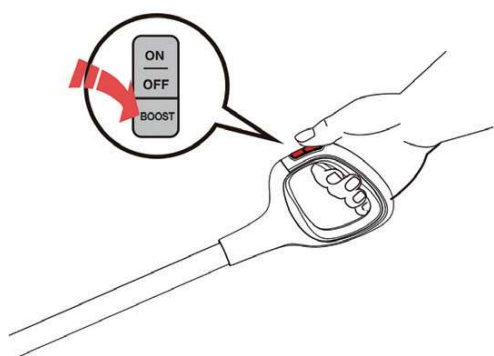
MAIN BODY

To reduce the risk of injury, switch off and disconnect plug from electrical outlet before operating.

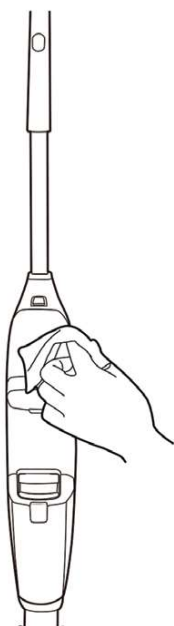

Use cloth to clean the surface with neutral detergent. The cloth should be dry to prevent water from entering the appliance.

Note:

After performing maintenance, place the appliance back on the storage tray vertically. Do not expose machine to direct sunlight, and store it appropriately indoors in a dry place.

DIRTY WATER TANK

Note:

When dirty water reaches MAX line, the floater will block off your DWT creating a high pitched sound indicating it's time to switch OFF the appliance.

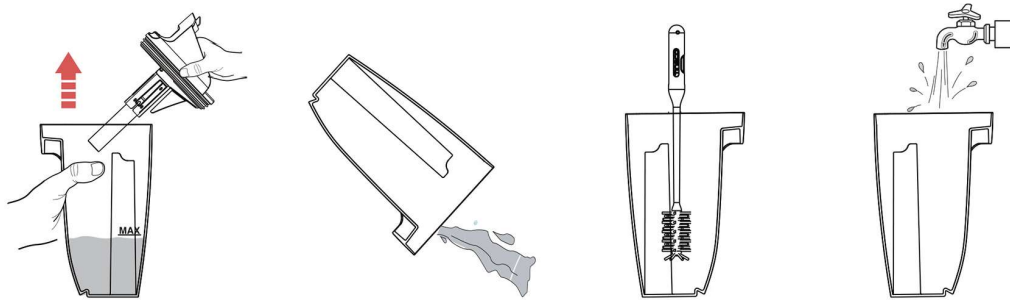

Switch OFF then pull up the tank lid to empty the DWT. Use 2-in-1 cleaning tool to remove remaining debris. Rinse the inside of the dirty water tank.

FILTER & FLOATER

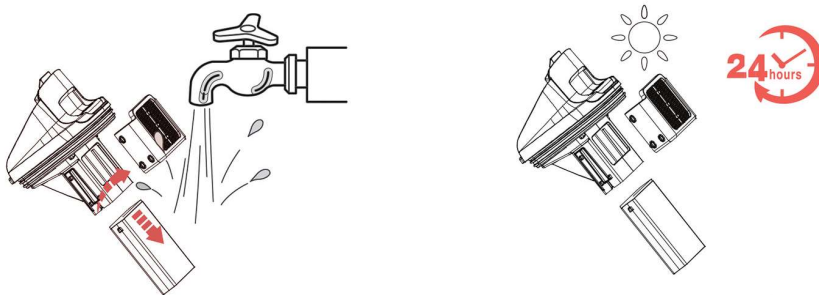

Note:

If the filter and the floater have been blocked, rinse with water. Take off the filter from the tank lid, pull out the floater, and rinse them with water.

PRE-FILTER

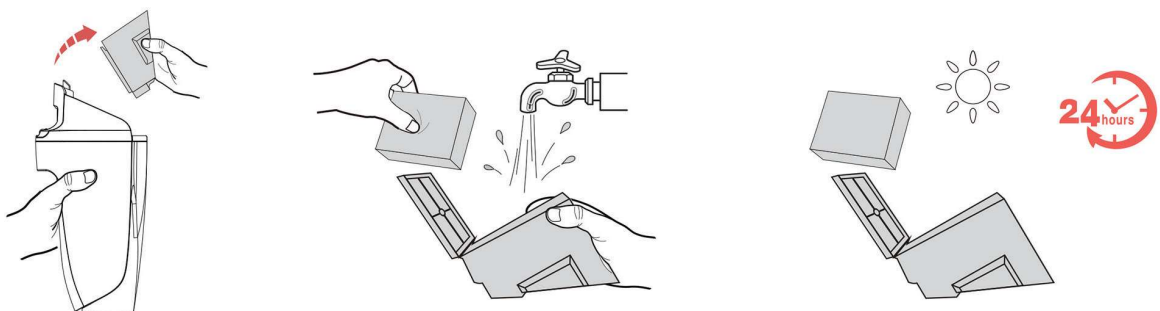

Grasp recessed area on each side of the pre-filter and pull upward to remove, then rinse with water. Let it dry out before placing back into the lid of the dirty water tank.

BRUSH ROLL SELF-CLEANING

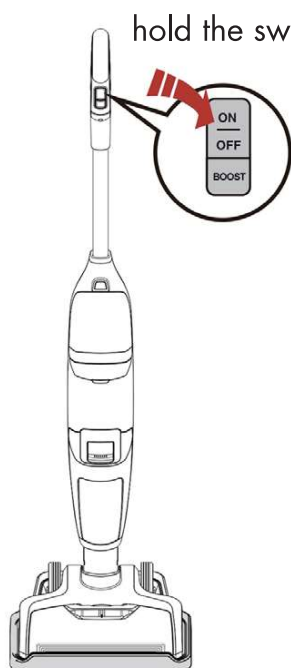

Note:

- For optimal performance, use quick self-cleaning function as often as needed.
- Please empty the dirty water tank before and after self-cleaning.

Place unit on storage tray. The clean water tank should be at least 1/3 full of water. Press and hold the ON button for 3 seconds to start the brush roll self-cleaning mode. The appliance will automatically shut off once finished. The entire self-cleaning process takes about 40 seconds.

BRUSH ROLL COVER

Note:

For optimal performance, please clean the brush roll cover periodically.

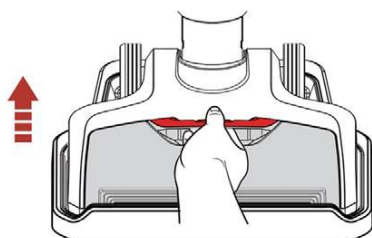

Grab the front handle while pressing the button and pull upward to remove.

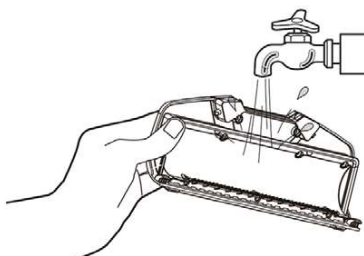

Rinse with water

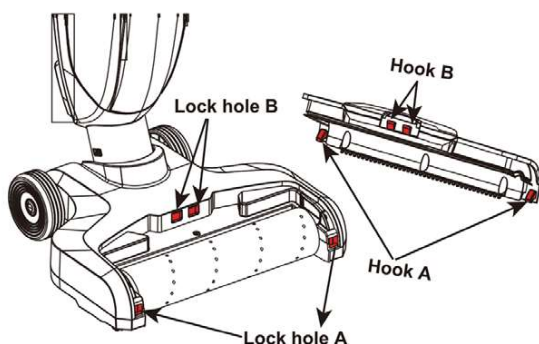

Press hook A into the lock hole A, then press hook B into the lock hole B.



Always latch brush cover into right place to avoid suction loss or water leakage.

BRUSH ROLL

Note:

For optimal performance, please clean the brush roll after each use.

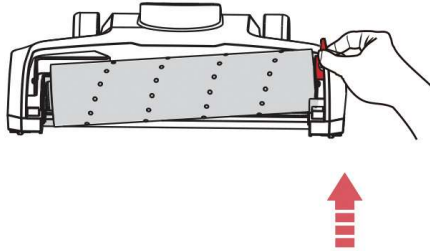

Remove the brush roll by grabbing the brush roll tab and pulling upward.

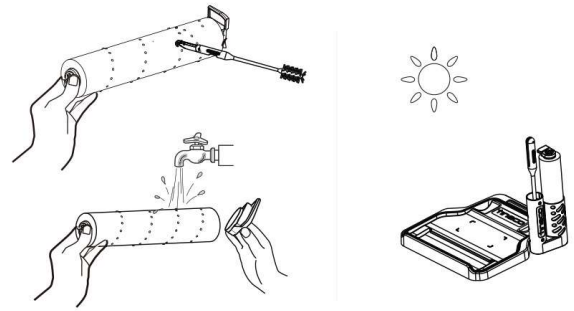

Take off the brush roll tab. Remove the hair and debris wrapped around the roller with included 2-in-1 cleaning tool. Rinse with water. Put the brush roll back into the tool caddy and let it dry out before reinstalling.

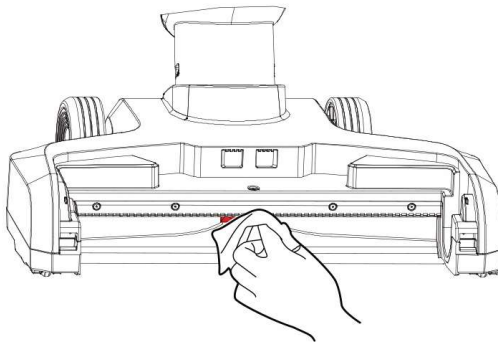

Remove hair and debris from the brush roll chamber and the opening with tissue or cloth.

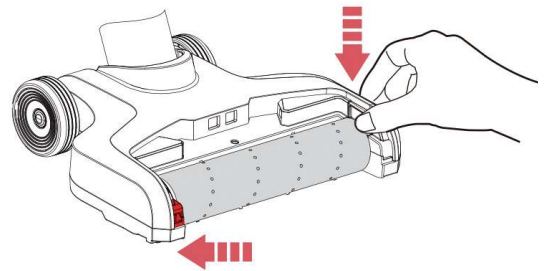

Put back brush roll by inserting the brush roll end into the left side of the foot, then lock the pull tab into place by pressing downward.

If you experience difficulties with the appliance, please check the suggestions below before contacting customer services on 01473 271272:

| PROBLEM | POSSIBLE CAUSES | SOLUTIONS/TIPS |
|--|--|--|
| Solid red light | Device overheating | Let your device cool down before using |
| The light flashes alternatively blue and red | Defective product | Please contact our customer service team |
| Loss of suction power | Brush malfunction | Make sure brush roll and brush roll cover installed correctly, clean brush roll and debris channel |
| | The sponge for pre-filter is dirty | Clean the pre-filter |
| | The DWT has picked up maximum amount of dirty water and has reached MAX line | Empty the dirty water then reinstall the DWT |
| | Brush cover is not latched in place | Reinstall brush cover |
| | The debris channel or the airway is blocked | Remove blockages |
| Machine makes unusual noises during normal usage | The debris channel or the airway is blocked | Remove blockages |
| | The DWT has picked up maximum amount of dirty water and has reached MAX line | Empty the dirty water then reinstall the DWT |
| Machine won't charge | The external charger cord not correctly plugged | Unplug the charger, then plug again into the machine and then into the wall outlet |
| Machine won't spray | The CWT may be empty | Refill CWT |
| | The CWT may not be installed correctly | Install the CWT correctly |

| PROBLEM | POSSIBLE CAUSES | SOLUTIONS/TIPS |
|-----------------------------------|--|--|
| Air outlet cover is leaking water | Then floater or the sponge for pre-filter may not be installed | Install the floater and the sponge correctly |
| | The DWT has picked up maximum amount of dirty water and has reached MAX line | Empty the dirty water then reinstall the DWT |
| | The sponge for Pre-filter is moist | Let the sponge dry out |
| | The floater is blocked | Remove blockages |

**Danger!**

Never try to repair a defective appliance yourself. You can put yourself and/or future users in danger. Repairs must only be done by a service engineer.

| | |
|-----------------|--|
| Model | EW3060 HYDROH1 |
| Charging Input | 100-240V |
| Voltage | 22.2V 2500mAH Li-ion |
| Rated Power | 120W |
| Running Time | 22mins |
| Charging Time | 3-4hrs |
| Water Flow Rate | Normal: about 40ml/min Boost: 220ml/min |
| CWT Capacity | 550ml |
| DWT Capacity | 400ml |
| Waterproof | IPX4 |

Fuse Replacement (Class II)

Remove the fuse cover with a small flat head screw driver. Take out the fuse and replace with a new fuse of the same Amp. Replace the fuse cover and push back into place.



Disposal Information

The European Directive 2012/19/EU on Waste Electrical and Electronic Equipment (WEEE), requires that old household electrical appliances must not be disposed of in normal unsorted municipal waste.

Old appliances must be collected separately in order to optimise the recovery and recycling of the materials they contain and reduce the impact on human health and the environment.

The crossed out "wheeled bin" symbol on the product reminds you of your obligation, that when you dispose of the appliance it must be separately collected. Consumers should contact their local authority or retailer for information concerning the correct disposal of their old appliance.





Ewbank Warranty Terms & Conditions

This product is guaranteed for a period of 24 months as standard from the date of purchase against mechanical and electrical defects.

To qualify for the warranty, the product must be used for domestic household use only and in accordance with the instructions in the user manual. Any misuse of the product will result in the warranty being void.

The warranty does not cover accidental damage, misuse, neglect, tampering or incorrect adjustment or installation.

The warranty will be rendered invalid if the product is resold, has had its serial number removed (or has an invalid serial number), or if an unauthorised person has carried out any repairs or alterations.

The warranty does not cover accessories or consumable parts that require replacement under normal use. This includes shelving, dials, filters, belts and trays etc.

In the unlikely event of a breakdown please refer to the Troubleshooting guide in your user manual and check all plugs, fuses and the electricity supply.

If you still require assistance please contact our Customer Service department on **01473 271 272** or write to us at the following address:

**Customer Service Department
Ewbank, 38 Bluestem Road,
Ipswich, Suffolk, IP3 9RR**

Please quote the Product Code and the PO Number on the rating label and give details of the exact fault. We will then decide whether to repair or replace the item.

Before we arrange the repair or replacement you will be required to return a copy of your proof of purchase. Please retain your original.

If an item is replaced within the agreed warranty period, the warranty for the replacement item will be calculated from the purchase date of the original.

In the event that the product is inspected and no fault is found or the product is not within the warranty period you will be charged for the repair and any carriage costs.



Your Guarantee

This product is covered by a 2 year guarantee.

This does not cover normal wear and tear or abuse.

For guarantee purposes, please retain your original receipt as proof of purchase.

This guarantee does not affect your statutory rights.

For spares, service and further information please contact;

Ewbank, 38 Bluestem Road, Ipswich, Suffolk, IP3 9RR

Tel: 01473 271 272

Disclaimer: Ewbank operate a policy of continual improvement and development.

We therefore reserve the right to change/alter the specification and appearance of our appliances without prior notice.

All diagrams and images shown in this manual are for illustration purposes only.