



HS80 RGB WIRELESS



官方网站: corsair.com

技术服务热线: 400 841 7130

支持: support.corsair.com

博客: corsair.com/blog

论坛: forum.corsair.com

微信: CorsairRMA

© 2021 CORSAIR MEMORY, Inc. 版权所有。

实物可能与所示图片不同。进口商: 可赛尔 (深圳) 贸易有限公司

产地: 中国 | 产品: 耳机 | 49-002220 AB

© 2021 CORSAIR MEMORY, Inc. All rights reserved.



HS80 RGB WIRELESS

采用空间音效技术的优质游戏耳机

Premium Gaming Headset with Spatial Audio



简体中文 1

ENGLISH 5

包装内容物部分

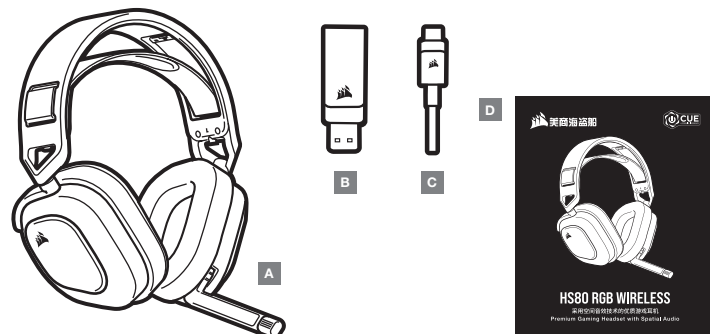

A — 美商海盗船 HS80 RGB WIRELESS 耳机

B — 无线 USB 发射器

C — USB 充电线

D — 快速入门指南

控件和功能部分

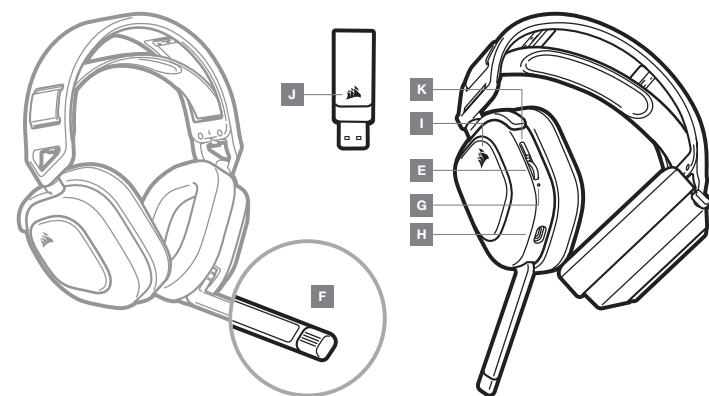

E — 音量控制 / 均衡器开关

F — 麦克风状态 LED 指示灯

G — 耳机状态LED指示灯(电池 / 充电)

H — 充电端口

I — RGB LED 灯

J — 配对状态 LED (无线 USB 发射器)

K — 电源按钮

开始使用您的美商海盗船 HS80 RGB WIRELESS 耳机

将无线 USB 发射器连接到 PC 上可正常工作的任何 USB 端口。耳机可在与无线发射器相距达 18 米 (60 英尺) 的范围内工作,但其他无线设备、电子设备及其他障碍(例如墙)可能会影响这款耳机的无线工作范围。使用线 USB 连接,在 PC 上再观高清音频(高达 24bit / 96kHz 音频)。如要在 USB 模式下使用耳机,请首先关闭耳机的电源,然后用随附的 USB 线缆将其与您的 PC 连接。

重要提示:初次在 PC 上使用美商海盗船 HS80 RGB WIRELESS 耳机时,操作系统会自动安装设备驱动程序。我们建议在设备驱动程序加载后重新启动 PC,然后再开始使用耳机。长时间以高音量收听音频可能会损害听力。应每隔一段时间休息一下,而且刚开始时应尽可能将音量调至较低水平,然后再调高音量。

PLAYSTATION

将无线 USB 发射器连接到 PS4 或 PS5 主机上的任意 USB 端口。在 PlayStation 界面上,将“Output to Headphones”(输出到耳机)设置为“All Audio”(所有音频)。将音量控制(耳机)调整到高。然后再用耳机音量控制整音量。

iCUE

请访问 corsair.com/support/downloads 下载 iCUE 软件。
使用 iCUE 软件可启用耳机的全套功能。



注意:如果在不使用软件的情况下使用耳机,某些功能将禁用。

- > 请在运行 Windows 10 或更新版本的 PC 上安装 iCUE 软件。
- > 安装完成后,重新启动 PC,然后启动 iCUE。

iCUE 软件可用于

- > 选择 RGB 颜色偏好和灯光强度
- > 选择和自定义音频均衡器 (EQ) 设置。
- > 调节麦克风输入音量和麦克风侧音。
- > 更新产品固件。

请注意:耳机必须处于 USB 模式(已关闭电源并已连接至 PC),才能更新固件。
软件随附的文档更详细地介绍了如何使用耳机的功能。

音频设置

短按 (0.1-0.5秒) 音量控制旋钮开关均衡器。

麦克风控制

向上翻转麦克风静音。向下翻转麦克风取消静音。

注意: iCUE 软件也可用于控制这些功能。

充电

美商海盗船 HS80 RGB WIRELESS 耳机在初次使用之前必须充满电。

- > 将 USB 充电线连接到 PC 上可正常工作的任何 USB 端口。
 - > 将 USB 充电线连接到 CORSAIR HS80 RGB WIRELESS 耳机。
- 美商海盗船 HS80 RGB WIRELESS 耳机的电池没有“记忆效应”,因此,重新充电前无需完全放电。
请记住,USB 充电线需要使用高功率 (USB 2.0 或更好) 端口。旧式设备上的一些 USB 端口不支持 USB 2.0。

电池状态 LED 指示灯 (耳机上)

电量低	电量中	电量高
红灯	橙灯	绿灯

LED 指示灯将在充电时闪烁,并在充满电时呈绿色持续亮起。未充电时,LED 指示灯将按以上所示电池电量颜色闪烁。

无线状态 LED 指示灯 (无线 USB 发射器)

- > 如果发射器连接到耳机并运行正常,则 LED 指示灯将呈白色持续亮起。
- > 如果发射器无法连接到耳机,则 LED 指示灯将呈红色快速闪烁。
- > 如果耳机和发射器均已开启,但是 LED 指示灯依旧呈红色闪烁,请使用 iCUE 软件重新对发射器和耳机进行配对。

为了获得更好的无线性能

- > 将无线 USB 接收器底座放置在不障碍的开阔区域。
- > 确保在首次使用之前给电池充满电。
- > 不要让电池长期保持完全放电状态。使电池保留部分电量可以尽可能地延长电池续航时间。
- > 如果 RGB 照明效果对您不重要,则可以通过 iCUE 禁用,以延长电池使用时间。
- > 耳机充满电后,立即拔掉 USB 充电线。
- > 将耳机放置在室温环境中 (20-30°C 或 68-86°F)。

PACKAGE CONTENTS SECTION

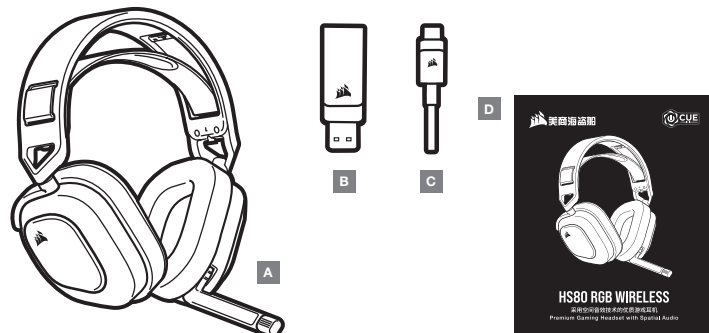

A — CORSAIR HS80 RGB WIRELESS headset

B — Wireless USB transmitter

C — USB charging cable

D — Quick start guide

CONTROLS AND FEATURES SECTION

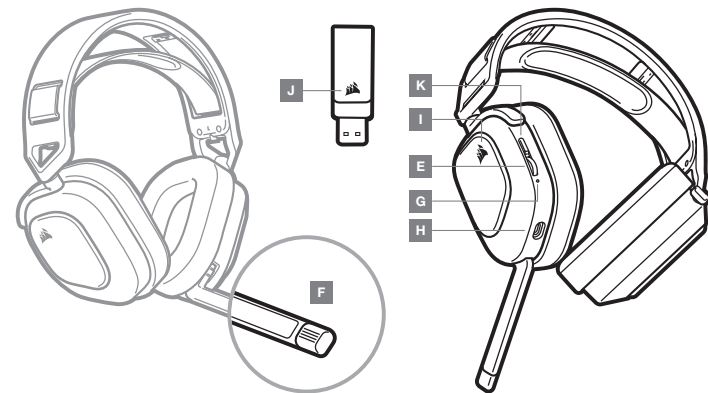

E — Volume control / EQ toggle

F — Microphone status LED

G — Headset status LED (battery / charge)

H — Charging port

I — RGB LED light

J — Pairing status LED (Wireless USB transmitter)

K — Power button

GETTING STARTED WITH YOUR CORSAIR HS80 RGB WIRELESS HEADSET

Connect the wireless USB transmitter to any working USB port on your PC. The headset is designed to operate at a range of up to 60ft (18m) from the wireless transmitter, but other wireless devices, electronics, and obstructions such as walls may reduce wireless range. Use a wired USB connection for the highest quality audio reproduction on PC (up to 24bit / 96kHz audio). To use the headset in USB mode, first power off the headset then connect it to your PC using the included USB cable.

IMPORTANT: The first time you use the CORSAIR HS80 RGB WIRELESS Headset on a PC, the operating system will automatically install the device driver. After the device driver loads, we recommend you reboot your PC before use. Prolonged listening at high volumes may adversely affect your hearing. Take breaks between sessions and always begin with the volume at the lowest possible level before increasing.

PLAYSTATION

Connect the wireless USB transmitter to any USB port on your PS4 or PS5 console. Use the PlayStation UI to set "Output to Headphones" to "All Audio". Adjust volume control (Headphones) to maximum level. Then adjust volume with the headset volume control.

iCUE

Go to corsair.com/support/downloads to download the iCUE Software. Using the iCUE software will enable the full feature set of your headset.



NOTE: If the headset is used without software, some features will be disabled.

- > Install the iCUE software on a PC running Windows 10 or later.
- > After installation is complete, reboot your PC, and launch iCUE.

iCUE SOFTWARE CAN BE USED TO

- > Choose your RGB color preference and light intensity.
- > Select and customize audio equalizer (EQ) settings.
- > Adjust microphone input volume, and microphone sidetone.
- > Update product firmware.

Please note: headset must be in USB mode (powered off and connected to PC) to update firmware. The software's built-in documentation explains how to use the headset's features in greater detail.

AUDIO SETTINGS

Short key press (0.1-0.5 seconds) on Volume Control wheel toggles EQ.

MIC CONTROL

Flip-up microphone to mute. Flip-down microphone to unmute.

NOTE: iCUE software can also be used to control these features.

CHARGING

The CORSAIR HS80 RGB WIRELESS Headset must be fully charged before its first use.

- > Connect the USB charging cable to any working USB port on your PC.
- > Connect the USB charging cable to the CORSAIR HS80 RGB WIRELESS Headset.

The CORSAIR HS80 RGB WIRELESS Headset battery has no "memory effect", so there is no need to completely discharge it before recharging.

Remember that the USB charging cable requires a high power (USB 2.0 or better) port. Some USB ports found on older devices do not support USB 2.0.

BATTERY STATUS LED INDICATIONS (ON HEADSET)

LOW	MEDIUM	HIGH
RED	ORANGE	GREEN

LED will pulse while being charged and turn solid green at full charge. When not being charged, LED will blink based on power levels shown above.

WIRELESS STATUS LED INDICATIONS (ON WIRELESS USB TRANSMITTER)

- > When the transmitter is connected to the headset and operating normally, LED will turn solid white.
- > If the transmitter cannot connect to the headset, LED will blink red rapidly.
- > If headset is turned on and the transmitter is powered on and LED is still blinking red, please use iCUE software to re-pair the transmitter to the headset.

FOR OPTIMAL WIRELESS PERFORMANCE

- > Place the wireless USB transmitter in an open, unobstructed area.
- > Make sure the battery is fully charged before initial use.
- > Do not leave the battery fully discharged for long periods. Battery life is maximized by keeping the battery in a partially charged state.
- > If RGB lighting effects are unimportant to you, they can be disabled with iCUE to extend battery life.
- > Remove the USB charging cable promptly after the headset has been fully charged.
- > Keep the headset at room temperature (20-30°C or 68-86°F).