

INSTRUCTION MANUAL

Espresso Machine



Item No.: CM8050 / CM8050H
Model NO.: CM5020B-UL

Thank you for purchasing this product!

If you have any question about the product such as missing parts, damaged products, product assembling and operation, please contact us via our customer service phone:

818-468-1528 or 661-435-8826.

Please read all the owner's instruction booklet before use.

CONTENTS

IMPORTANT SAFEGUARDS	1
KNOWING YOUR COFFEE MACHINE	3
Control Panel.....	4
Accessories	4
Accessories Instructions.....	4
OPERATING INSTRUCTIONS.....	6
Before the First Use	6
Make Espresso Coffee	7
Make Frothing Milk	9
SLEEP MODE	9
CLEANING AND MAINTENANCE	10
Descaling Instructions	10
Daily Maintenance of the Grinder	13
How to Clean the Grinder	14
Environmental Protection	15
TROUBLESHOOTING	16

IMPORTANT SAFEGUARDS



Before using the electrical appliance, the following basic precautions should always be followed:

1. Read all instructions.
2. Before using, check that the voltage of wall outlet corresponds to rated voltage.
3. To protect against fire, electric shock and injury to person, do not immerse cord or plug in water or other liquids.
4. Someone should supervise the coffee machine when using it, and do not let children and people who are unable to take care of themselves approach the coffee machine.
5. Remove plug from wall outlet before cleaning and when not in use. Allow appliance cool down completely before taking off, attaching components or before cleaning.
6. Do not operate any appliance with a damaged cord or plug or after the appliance malfunctions, or is dropped or damaged in any manner. Return appliance to the nearest authorized service facility for examination, repair or electrical or mechanical adjustment.
7. The use of accessory attachments not recommended by the appliance manufacturer may result in fire, electric shock or injury to persons.
8. Do not use this appliance outdoors.
9. Ensure the power cord do not touch hot surface of appliance.
10. Do not place the coffee machine on hot surface or beside fire in order to avoid to be damaged.
11. Do not use appliance for the use other than its intended use and place it in a dry environment.
12. Fill the water tank with clean, cold water. Do not add mineral water, milk or other liquid drinks to the water tank.
13. To disconnect, remove plug from wall outlet, always hold the plug, but never pull the cord.
14. Do not touch the hot surface of appliance while using (such as steam wand). Use handle or knobs.
15. Children should be supervised to ensure that they do not play with the appliance.
16. The temperature for operating or storing the coffee machine shall be higher than 32°F.
17. Do not operate the coffee machine at an environment with high temperature, strong magnetic field or moist air.
18. This appliance can be used by children aged 8 and above if they have been given supervision or instruction concerning use of the appliance in a safe way and understand the hazards involved. Cleaning and user maintenance shall not be made by children unless they are older than 8 and supervised.
19. Keep the appliance and its cord out of reach of children aged less than 8 years.
20. This machine has a grounding plug. Make sure the household socket you use is properly grounded.
21. Do not operate the coffee machine without water.
22. This appliance is intended to be used in household and similar applications such as:
 - staff kitchen areas in shops, offices and other working environments;

- farm houses;
- hotels, motels and other residential type environments;
- bed and breakfast type environments.

23. Appliances can be used by persons with reduced physical, sensory or mental capabilities or lack of experience and knowledge if they have been given supervision or instruction concerning use of the appliance in a safe way and understand the hazards involved.

24. Cleaning and maintenance of the appliance should not be done by children without supervision.

25. The utensils must not be immersed in water, and the handle of the pressure funnel cannot be placed in the dishwasher.

26. Care should be taken when removing the cutter-head, emptying the bean hopper and cleaning.

27. Turn off the power switch and disconnect the power supply before replacing accessories or touching internal moving parts.

28. Batteries must be removed from the appliance before disposal; When removing the battery, the appliance must be powered off; Batteries should be disposed of safely.

29. Save the instruction.



Warning: Pressure

In order to prevent hot steam and hot water from scalding the body or causing other personal injuries, and to prevent damage to this product, when the machine brews coffee or foams, do not remove the water tank or funnel. Before you remove the funnel to brew another cup of coffee, make sure that the coffee machine is in standby mode. If you want to add more water into the water tank, please turn off the machine by pressing the Power button . When four indicators are off, the product is turned off. When extracting coffee, make sure that the funnel is turned to the specified position to avoid it getting loose due to pressure reason during use, which may easily cause human injury.



High Temperature

When the machine is working, do not extend your hands and other body parts into the bottom of the funnel or steam tube to prevent burns; at any time, it is not allowed to touch the steam tube with your hands or other body parts. You can only turn the steam tube by touching silicone sleeve that wraps the steam tube.

SAVE THESE INSTRUCTIONS

KNOWING YOUR COFFEE MACHINE

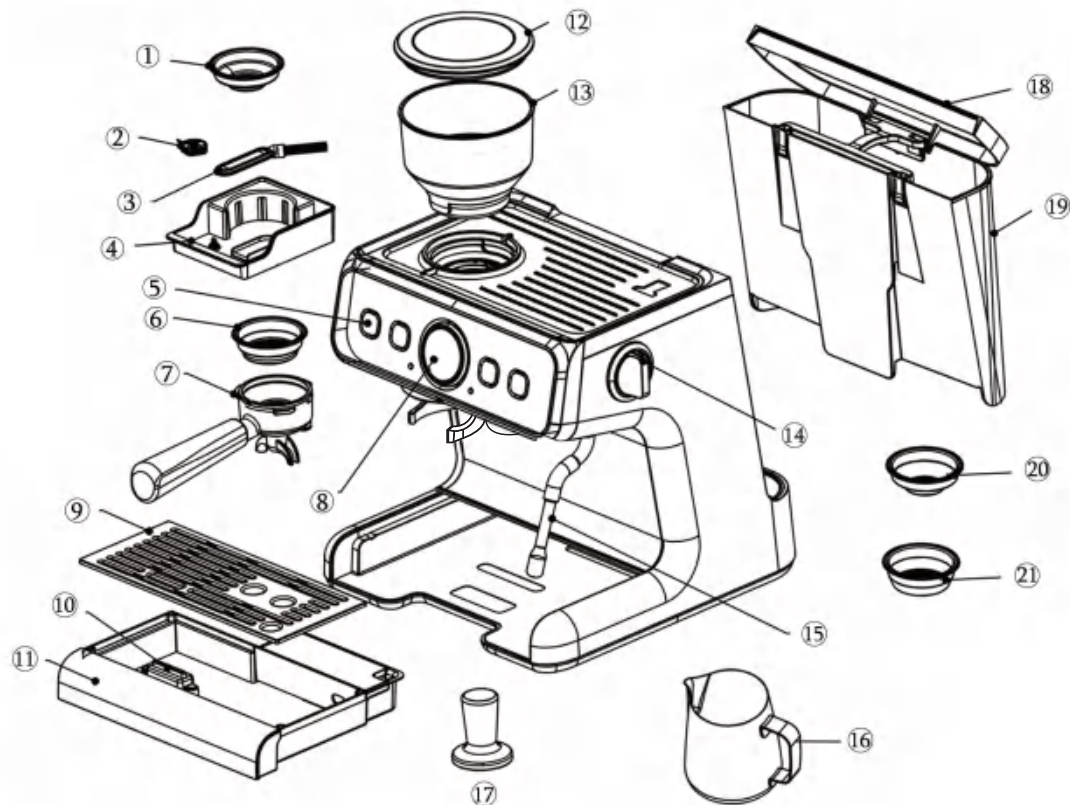

- | | |
|----------------------------|----------------------------|
| ① 1 cup single wall filter | ⑫ Bean hopper lid |
| ② Cleaning pin | ⑬ Bean hopper |
| ③ Cleaning brush | ⑭ Knob |
| ④ Tool box | ⑮ Steam tube |
| ⑤ Button | ⑯ Milk cup |
| ⑥ 2 cup single wall filter | ⑰ Coffee tamper |
| ⑦ Pressure funnel | ⑱ Water tank cover |
| ⑧ Pressure gauge | ⑲ Water tank |
| ⑨ Drip plate | ⑳ 1 cup double wall filter |
| ⑩ Floater | ㉑ 2 cup double wall filter |
| ⑪ Drip tray | |

Control Panel

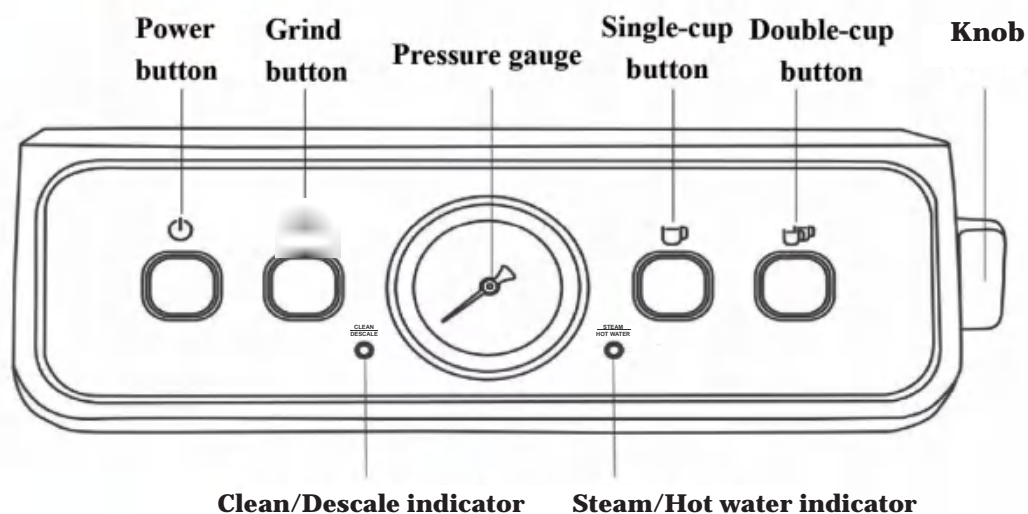

Accessories

This product is equipped with auxiliary tools for use. The cleaning pin, cleaning brush, are placed in a separate tool box. Single or double cup filter can also be placed in the tool box for easy storage. The tool box is placed on the lower left side of the machine.



Accessories Instructions

Cleaning Pin

The cleaning pin can be used to clean single and double cup filters and steam nozzle. The thicker one is used to clean the steam nozzle, and the thinner one can be used to clean the filters.



Clean steam nozzle



Clean filter

Cleaning Brush

Mainly used to clean the grinding system. You can use it to clean the grinder and the powder chamber.

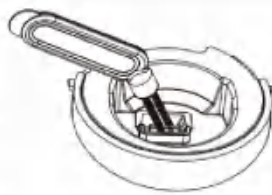

You can clean the grinder by cleaning the plasma and the powder outlet.

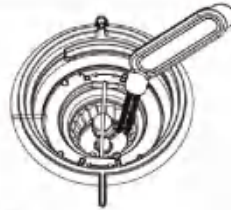

After removing the bean hopper and the grinding wheel, you can clean the grinding chamber and the powder-dispensing channel.

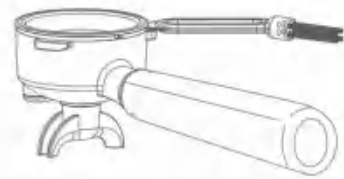

The other end of the cleaning brush can be used to detach the filter from the funnel.

Coffee Tamper

Mainly used to compact coffee powder.



Tamp the ground coffee downwards

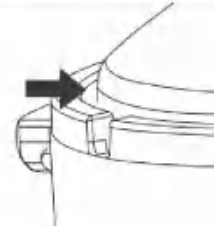
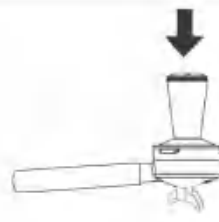

When the edge of the tamper is flush with the filter, it means the most suitable amount of powder

Double Wall Filters

Use double wall filters if using pre-ground coffee. If you are new to coffee making, we recommend using a double wall filter.

Double wall filters regulate the pressure and help to optimize the extraction regardless of the grind, dose, tamp pressure or freshness.

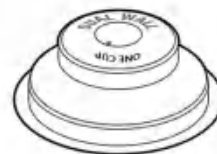

1 CUP



2 CUP

Single Wall Filters

Use single wall filters if grinding fresh whole coffee beans.

Single wall filters allow you to experiment with grind, dose and tamp to create a more balanced espresso.



1 CUP



2 CUP

NOTE: If the coffee powder exceeds the MAX line after being tamped, you can continue to tamp. If the powder is too firm to tamp down, take some powder out and then re-tamp. If the handle cannot be installed on the brewing head, it may be that the powder exceeds the MAX line.



OPERATING INSTRUCTIONS

Before the First Use

Remove all labels and packaging materials attached to the coffee machine and make sure all accessories are present and undamaged.

Use warm water and mild dish detergent to clean accessories (water tank, handle, filters and drip tray) and rinse thoroughly with clean water. Use a soft, damp cloth to dry the outer casing and the bean hopper thoroughly.

 **Do not immerse the casing, power cord or power plug in water or other liquids.**

Install the Water Tank

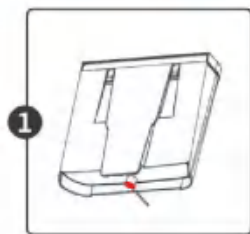

Remove the red sealant from the bottom of the water tank

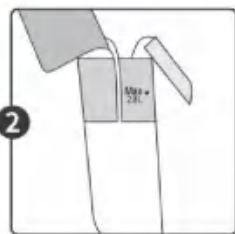

Pour into the pure drinking water

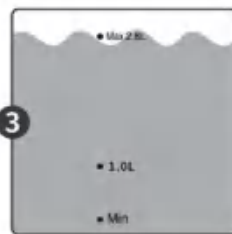

The water level should not exceed the "max" position

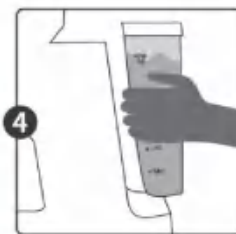

Install the water tank

Install the Bean Hopper

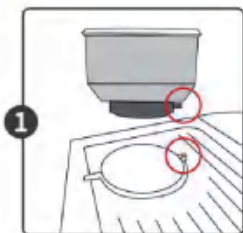

Align with the red circle in the picture



Press down the bean hopper and turn it clockwise to load it

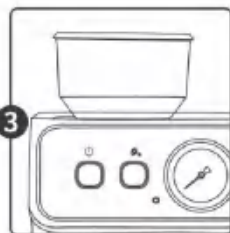

Install the bean hopper

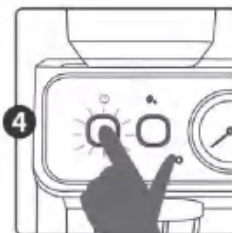





Preheat after power on

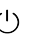

It enters standby mode after preheating.

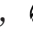
NOTE

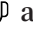
1. In the preheating mode, the  indicator flashes and  indicator lights up at the same time.
2. In the standby mode, the , ,  and  indicators light solidly, and the coffee machine can be used normally.

Clean the Brewing Head And Steam Tube

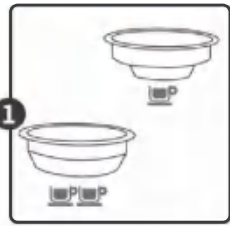

Choose single or double wall filter first.



Install the filter into the funnel.

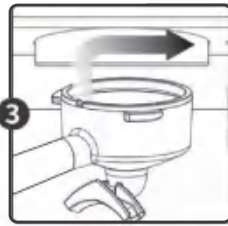

Turn the funnel into the brewing head.

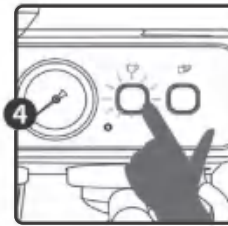

Press the single cup button.

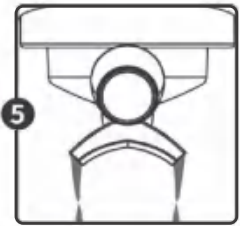

Clean the brewing head with hot water.



Turn the knob to the "Q".

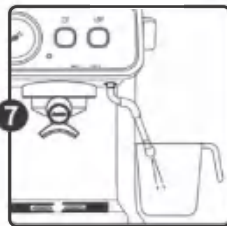

Use a cup to collect a little bit of hot water.

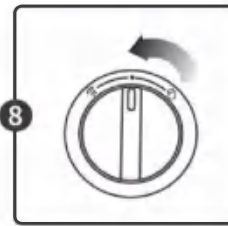

Turn off hot water knob and the cleaning is finished.

Make Espresso Coffee

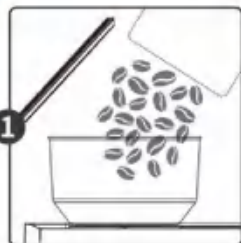

Pour into some fresh coffee beans.

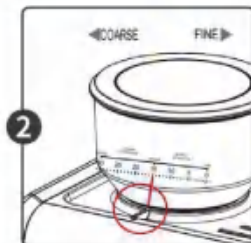

Slightly adjust the gear according to your demand from the 15th gear.



Place the funnel into the grinder.



Press the grind button.

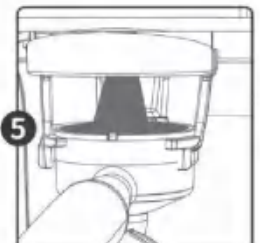

It automatically stops after outputting the set powder output amount.

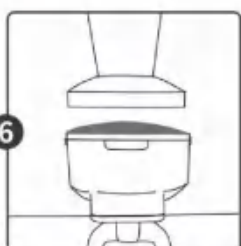

Use the Coffee Tamper to press the coffee powder tightly.



Wipe away any coffee powder that spills around.

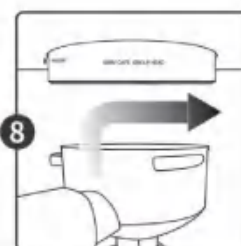

Lock the funnel by rotating it counterclockwise.



Place a coffee cup.

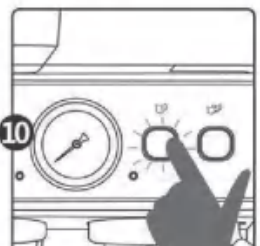

Choose single or double cup espresso.

WARNING

When the water tank is short of water, the machine will remind the user to refill the tank. The four buttons flash and the machine buzzes five times.

WARNING

1. The reminder will also appear when coffee powder is too fine and the machine cannot brew coffee.
2. At the same time, the machine buzzes five times and will not sound for a long time.
3. If there is no operation one minute after reminding, the machine will enter the standby mode.



Coffee powder instructions

To brew a single-cup coffee, it is recommended to load about 0.5oz of coffee powder and tamp the powder with a force of about 12.5kg. When the set coffee dose reaches about 1oz, the machine will stop working.

To brew a double-cup coffee, it is recommended to load about 0.6oz of coffee powder and tamp the powder with a force of about 12.5kg. When the set coffee dose reaches about 2oz, the machine will stop working.

Customized coffee dose setting

As for brewed coffee, you can adjust the specific coffee dose of single-cup and double-cup according to your needs as follows:

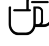
Long press the  or  button to enter the customized flow setting. The  or  button will flash slowly and the machine will dispense coffee normally. When the required amount is reached (adjustable coffee amount ranges from 0.7oz (20ml) to 13.5oz (400ml), short press the button, the machine returns to standby mode and the current brewing setting will be saved.

To restore the coffee dose to factory settings, long press the , ,  and  buttons.

Make Frothing Milk

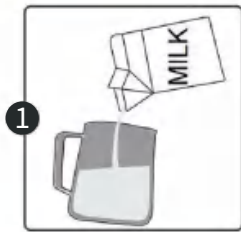

1 Pour in 1/2 cup of fresh iced milk and turn to the steam knob to preheat the steam.

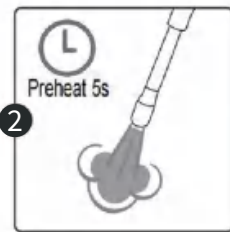

2 Preheat for around 5s until the steam releases stably, then turn off the steam knob.



3 Put the steam tube into the milk cup, soak 2mm-4mm of the steam tube outlet into the milk.



4 Turn the knob to the steam position.

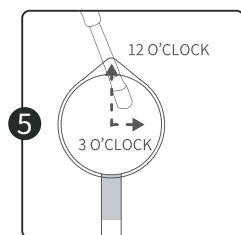

5 Hold the bottom of the milk cup with left hand and hold the handle of the milk cup with right hand. Position the steam tube arm and the outlet as shown.



6 Turn off the steam knob when the milk cup is hot enough.

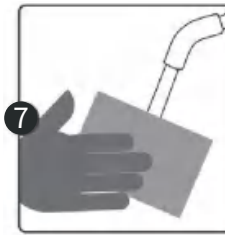

7 Wipe the steam tube and turn to the steam knob again to drain the milk. Then turn off the knob.





8 Milk froth finished. Pour the frothing milk into the espresso prepared.

WARNING

1. The steam function will generate high-temperature steam, please pay attention to avoid scalding when using it.
2. After milk frothing, please turn the knob to the “●” position in time. If is not turned back, the Steam indicator will flash as an alarm.

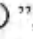
SLEEP MODE

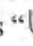
The machine will automatically enter into the sleep mode after 20 minutes of no operation during the standby mode. You can activate the machine again by pressing Power button “”, the machine will re-enter into preheat state.

Suggestion: We suggest that you can preheat the appliance, including the funnel, filters and cup before brewing coffee, so that the coffee will not be affected by the coldness of appliance. The specific operation is as below: Put the filter into the funnel and then install the funnel onto the funnel bracket, put a cup well in position and press “” or “” to make the appliance work. After the appliance stops working, the coffee brewing can be activated again.

CLEANING AND MAINTENANCE

⚠ WARNING: Please unplug before cleaning to allow the coffee machine to cool down sufficiently to prevent scalding. Do not immerse the coffee machine or the power cord plug in water or other liquids to avoid danger.

1. After each use, put all detachable parts into water for cleaning, add cleaning liquid if necessary, and then rinse with clean water.

2. Often use a moisture-proof sponge to scrub the external surface of the machine to remove dirt.

NOTE: Do not use alcohol or detergent, and do not immerse the machine in water for cleaning.

3. Turn clockwise to remove the metal funnel to remove the coffee grounds, then you can use a detergent to clean the funnel and metal filter accessories, but you must rinse them with clean water after.

4. After cleaning all the detachable parts, wipe all parts to dry.

IMPORTANT

Winter Storage Care

To avoid damage, use and store your Espresso Machine where it will not freeze. Because some water remains inside the appliance, freezing can damage the product. If storing or moving during freezing weather, purge your Espresso Machine. If the coffee machine is placed in a low temperature environment for a long time, please follow below steps:

Step1: Remove the water tank

Step2: Turn on the coffee function or hot water for 10 seconds, completely release the water, and ensure that the machine is completely thawed.

NOTE

1. Never immerse the machine in the water for cleaning.

2. The detachable water tank cannot be washed in the dishwasher.

3. Do not wash the funnel with any descaler in the dishwasher, please use neutral detergent and warm water, otherwise it will be corroded and affect subsequent use.

Descaling Instructions

This machine has a descaling reminder function and descaling program. When the system detects that the flow amount of the whole machine reaches 15 liter, the descaling reminder function will be activated. It is recommended to descale every 4-6 months. When in descaling mode, the machine runs at maximum power and the entire program is expected to take about 10 minutes to run.

Descaling Methods

- A. Fill the water tank with 1 liter of water. Add the descaling tablets and wait for the descaling tablets to dissolve.
- B. Add half a cup of liquid descaling agent into the water tank, then add 1 liter warm water to allow the solution to mix thoroughly.
- C. Add 1.5 scoops of white vinegar into the water tank, then add 1 liter warm water to allow the solution to mix thoroughly.

Descaling Preparation



After the descaling reminder is activated or before the user starts the descaling program independently, please complete the following preparation before running the descaling program:

1. There is at least 1 liter of water in the water tank;
2. Empty the water tray and install it in place;
3. Turn on the appliance and put it in standby mode;

Descaling Operation

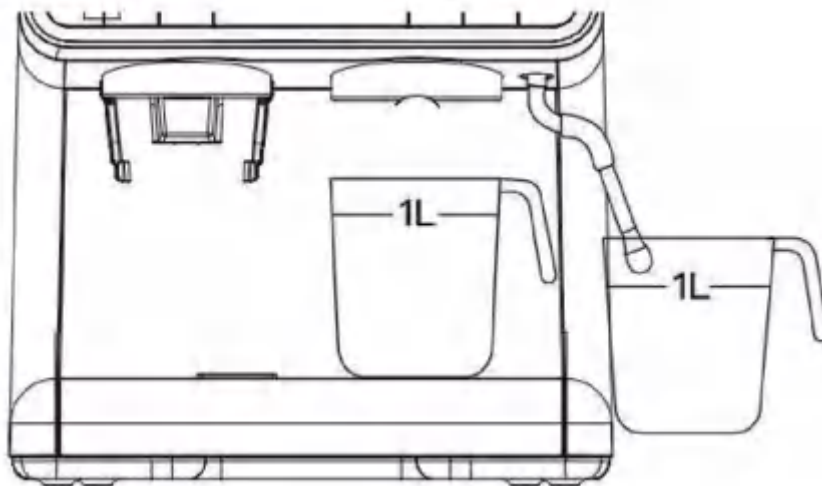
1. Insert the water tank into place, place a 1 liter container under the brewing head and another 1 liter container under the steam tube.

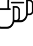

2. In standby mode, keep pressing the  and  buttons, the machine will start the descaling process. The indicators of  and  button keep on, and the CLEAN/DESCALE indicator flashes slowly.

NOTE

1. The cleaning function can be exited at any time by pressing the power button;
2. If the descaling cycle below is not started within 1 minute, the appliance will exit the descaling cycle and return to standby mode.

3. Start the descaling cycle.

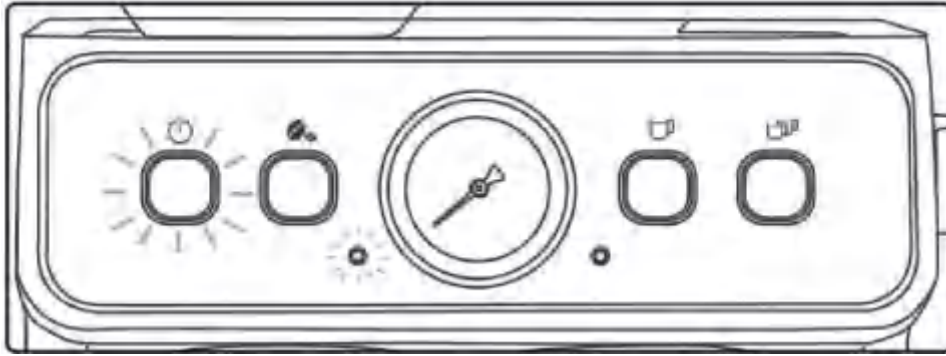

- Turn the knob to ☕ position, the indicators of the ⏻ and ☕ button keep on, and the Clean/Descal and Steam/Hot water indicators flash slowly. The pump starts to work and the machine makes different noises, and the hot water dispenses from the brewing head and the steam tube.
- The hot water will stop coming out from the brewing head and the steam tube within 3 minutes.
- Turn the knob to “●” position in 5 minutes or the machine will automatically exit from the descaling cycle. The STEAM/HOT WATER indicator goes out while the CLEAN/DESCALE indicator keeps flashing slowly, and the indicators of the ⏻ and ☕ button keep on.

Important

A maximum of 5 minutes is allowed before completing Step 4 before exiting from the descaling cycle.

4. The steam tube and the brewing head need to be cleaned with fresh water to clear the descaling solution inside.
- Clean the water tank and fill the water tank with water.
 - Empty the containers and put them back.
 - Turn the knob to the ☕ position. The indicator of the ⏻ button flashes quickly while the indicator of the ☕ button keeps on, and the CLEAN/DESCALE indicator flashes slowly.
 - The pump starts to work and the machine makes different noises, and the hot water dispenses from the brewing head and the steam tube.
5. The descaling cycle completed.
- The hot water will stop coming out within 3 minutes. The buzzer beeps once, the indicators of the ⏻ and ☕ button keep on, the CLEAN/DESCALE indicator goes out and the STEAM/HOT WATER indicator flashes quickly.
 - Turn the knob to the ● position, the machine returns to standby mode.

Daily Maintenance of the Grinder

During the use of the grinder, due to the influence of coffee beans and external factors, the powder outlet channel will be blocked. When the following circumstances occur, be sure to clean the powder outlet channel in time:

1. Clean the flour outlet channel and grinding wheel at least once every two weeks:
2. When the amount of powder output decreases, please clean the powder outlet channel and grinding wheel.
3. When using the grinder to grind fine coffee powder, please clean the powder outlet channel in time;
4. This machine is equipped with a static-free and anti-flying powder system. When the coffee powder floats out of the funnel, please use a brush to clean the powder outlet in time.

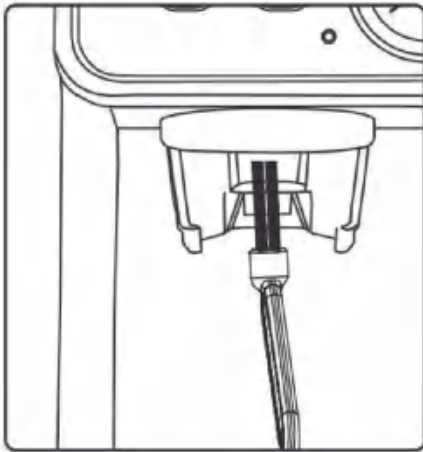

Figure 1: Cleaning channel location

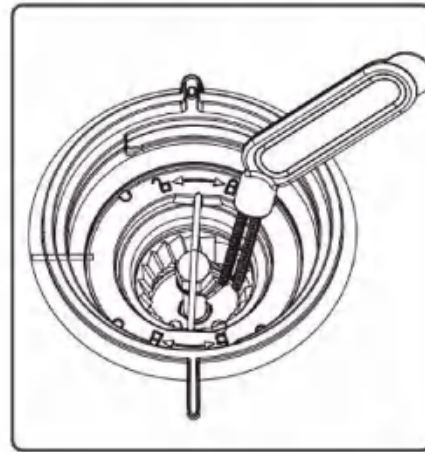
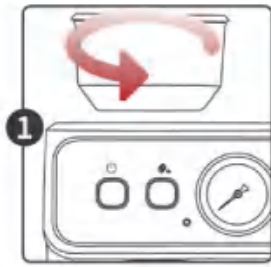
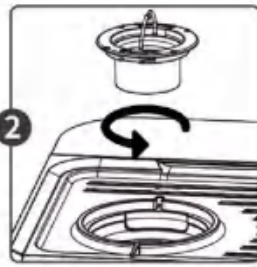

Figure 2: Cleaning grinder wheel location

How to Clean the Grinder



Turn the bean hopper counterclockwise and take out it.



Unscrew the internal grinding wheel counterclockwise.



After taking it out, clean the grinding wheel with a cleaning brush.

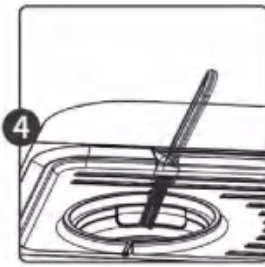

Clean the grinding chamber with a cleaning brush.

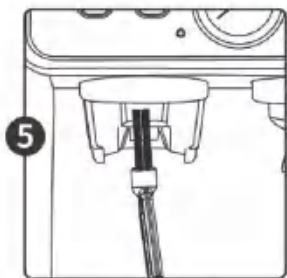

Clean the powder channel with the brush.

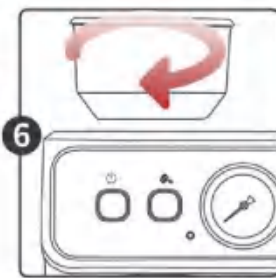

Reinstall the empty bean box but do not install the grinding wheel at this time .



Press the grind button.

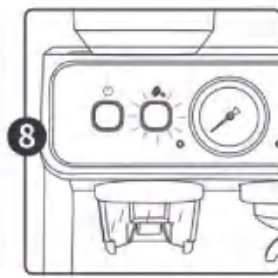

Let the grinder run to sweep out the remaining
(If it is not cleaned, please repeat steps 4, and 5)

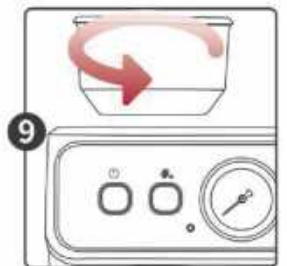

Remove the bean hopper by rotating it counterclockwise.

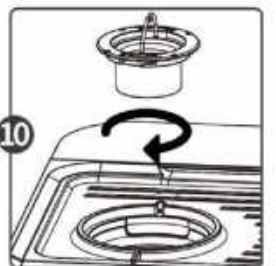

Install the grinding wheel clockwise.

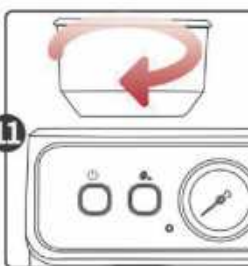

Install the bean box by rotating it clockwise.

NOTE

1. When cleaning the bean grinder, please confirm that there are no beans in the bean hopper, and when pressing the grinding button, the bean grinder can operate normally and no coffee powder flows out of the powder outlet.
2. The grinding wheel cannot be washed directly with water.

If you do not find the cause of the problem, please do not disassemble the machine and you should contact your local maintenance agency.

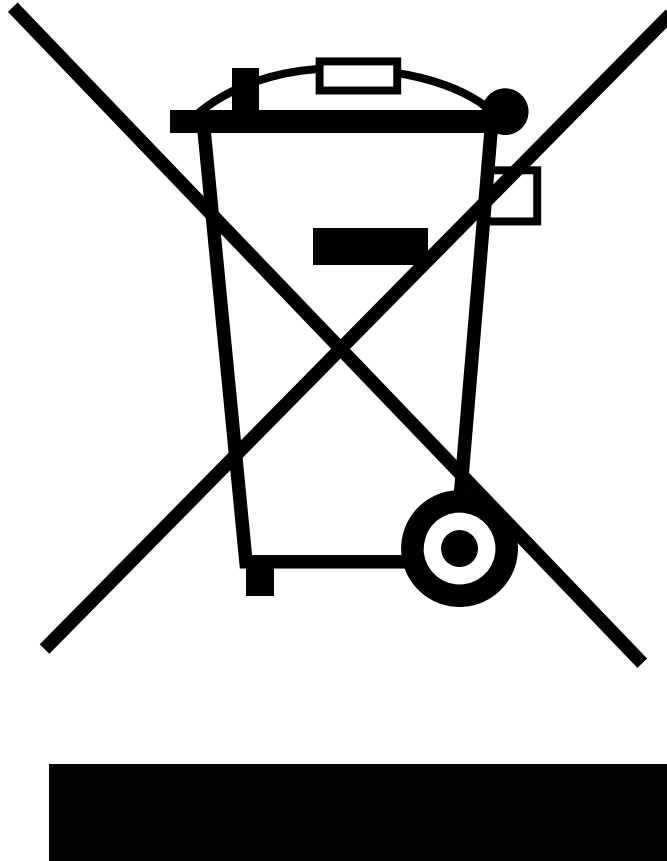

You can help protect the environment!

Strictly abide by the regulations: Please put the discarded electrical equipment into the corresponding waste station for disposal.

TROUBLESHOOTING

Malfunction	Reason	Solution
No display	Check that the plug is in place and Power button is pressed.	Insert the power plug, make sure you press the Power button.
The indicator on the front panel of the machine is red.	The bean hopper is not installed.	Install the bean hopper.
There are water marks on the bottom of the machine.	The water tank or the water tray is not installed in place. The drip tray is full.	Make sure that the water tank and the drip tray are installed in place, and the drip tray is empty. If the issue is not solved, please don't disassemble the machine on your own, but send it to local authorized maintenance center for reparation.
You will hear a ticking sound after starting the machine and a hissing sound after the coffee is dispensed.	This is a normal phenomenon and the sound is produced by the normal operation of the pressure control valve.	
No coffee comes out from funnel, or coffee does not come out from funnel smoothly, or the funnel cannot be installed in funnel bracket properly.	Excessive amount of coffee powder, too fine coffee powder or excessive pressure.	The amount of powder should not exceed the standard amount. Adjust the grinding setting of the grinder appropriately until it is suitable. It should not be pressed repeatedly with excessive force when pressing the powder.
Coffee without cream.	The coffee beans are damp or the coffee powder is too coarse.	Choose fresh coffee beans and powder with moderate grinding thickness to make coffee.
No steam.	The steam function is not preheated. The steam nozzle is blocked.	The machine can only produce steam after the machine is preheated in steam mode. The machine needs to be descaled and use a cleaning needle to clean the steam nozzle.
Can't make coffee or hot water immediately after the steam comes out and the machine will automatically pump water.	After steaming is completed, the pressure needs to be released to reduce the temperature. At this time, other operations cannot be performed. The water pumping is used for cooling down the heating element quickly.	The machine can only produce steam after the machine is preheated in steam mode. The machine needs to be descaled and use a cleaning needle to clean the steam nozzle.

If you do not find the cause of the problem, please do not disassemble the machine and you should contact your local maintenance agency.

Thank you for purchasing this product! If you have any question about the product, such as missing parts, damaged products, product assembling, and operation, please contact us via customer service number: **818-468-1528 or 661-435-8826.**

IMPORTANT

Please call our customer service department for any consulting:

818-468-1528

661-435-8826

(8:30am - 5:30pm P.S.T.)

DATED PROOF OF PURCHASE IS REQUIRED FOR WARRANTY SERVICE.

AVIS

Veuillez appeler le service à la clientèle pour toutes questions au:

818-468-1528

661-435-8826

(8:30am - 5:30pm P.S.T.)

PREUVE D'ACHAT ORIGINALE REQUISE POUR SERVICE DE GARANTIE.

IMPORTANTE

Sólo hay que llamar nuestro departamento de servicio al cliente en caso de tener preguntas o inquietudes:

818-468-1528

661-435-8826

(8:30am - 5:30pm P.S.T.)

SE REQUIERE PRUEBA DE COMPRA CON FECHA PARA SERVICIO BAJO GARANTÍA.

ROWAN ELECTRIC APPLIANCE LLC
Phone: 818-468-1528 or 661-435-8826