



MAKE A DIFFERENCE

Box Drawer and Fridge Slide System

BXG.2124-S
(INSTALLATION INSTRUCTION)

ATTENTION • Please verify all parts are present and read instructions carefully before starting installation.
Please feel free to contact your distributor if you have any kind of question about your purchase.

1 CONTENTS

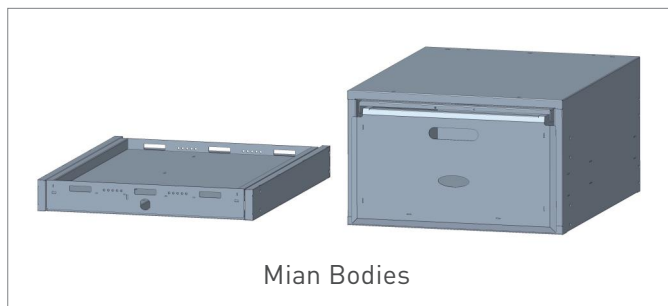

Main Bodies

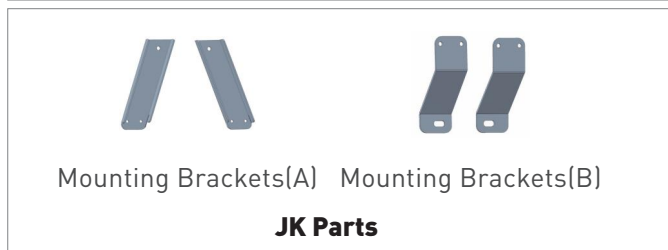

Mounting Brackets(A) Mounting Brackets(B)

JK Parts

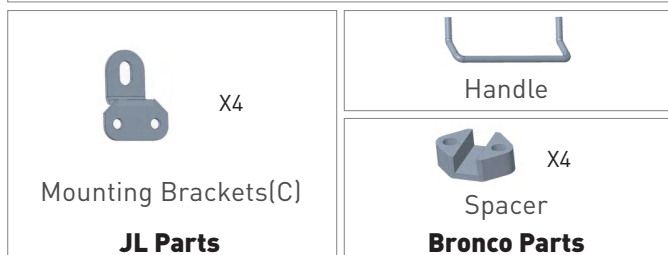

Mounting Brackets(C)

JL Parts

Handle



Bronco Parts

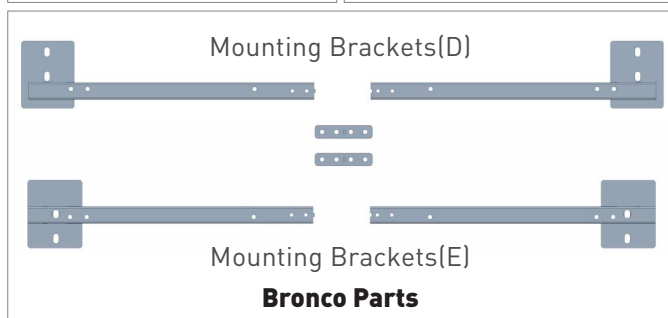

Mounting Brackets(D)

Mounting Brackets(E)

Bronco Parts

Qty	Part Name	Size(mm)	Picture
8	Hex Socket Bolt	M8×45	
4	Button Bolt	M8×30	
2	Button Bolt	M6×35	
2	Button Bolt	M6×20	
16	Button Bolt	M6×12	
2	Button Bolt	M4×10	
8	Flat Head Socket Bolt	M6×12	
2	Split Lock Washer	D4	
4	Flat Washer	M8×20×1.5	
8	Flat Washer	M8×16×1.5	
4	Flat Washer	M6×20×2	
16	Flat Washer	M6×12×1	
8	Flange Hex Lock Nut	M6	
2	Nylon Round Spacer	24×10×12	
16	Rubber Stopper		
8	Rubber Stopper		
1	Allen Wrench	M2.5	
2	Key		
1	Lock		

2 TOOLS REQUIRED

◆ Drive Socket Ratchet Wrench

◆ 4mm, 5mm Hex Bit Socket

◆ 10mm, 13mm Wrench

To view online instruction, please
• scan the QR code. •



3 INSTALLATION INSTRUCTION

Step 1

Install the handle.

•(2) M4x10 Button Bolts

•(2) M4 Split Lock Washers

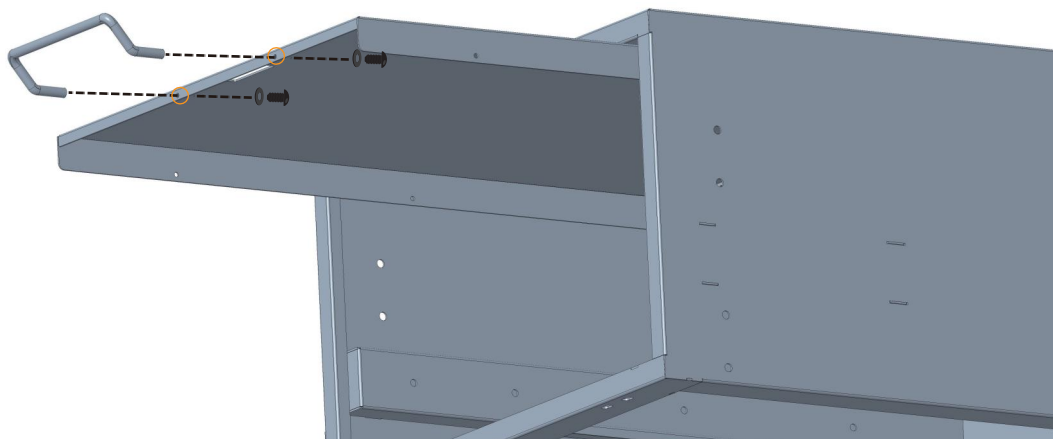

Step 2

Remove the drawers from both.



Step 3

Assemble the main body.

•(4) M6x12 Button Bolts

•(4) M6x12x1 Flat Washers

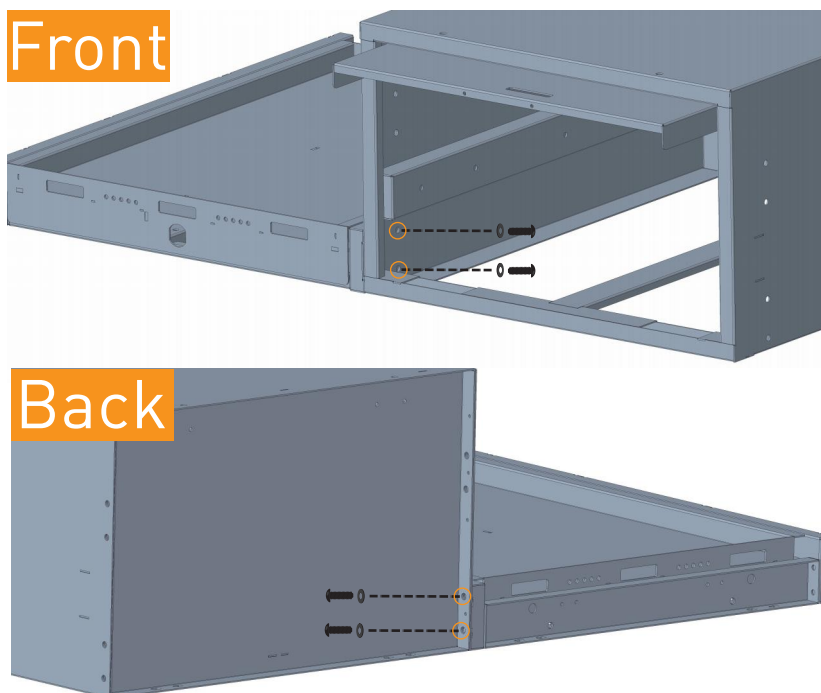

JK Model

Step 4

Fold down the rear seats and remove four factory hooks from the vehicle. Locate four factory holes.

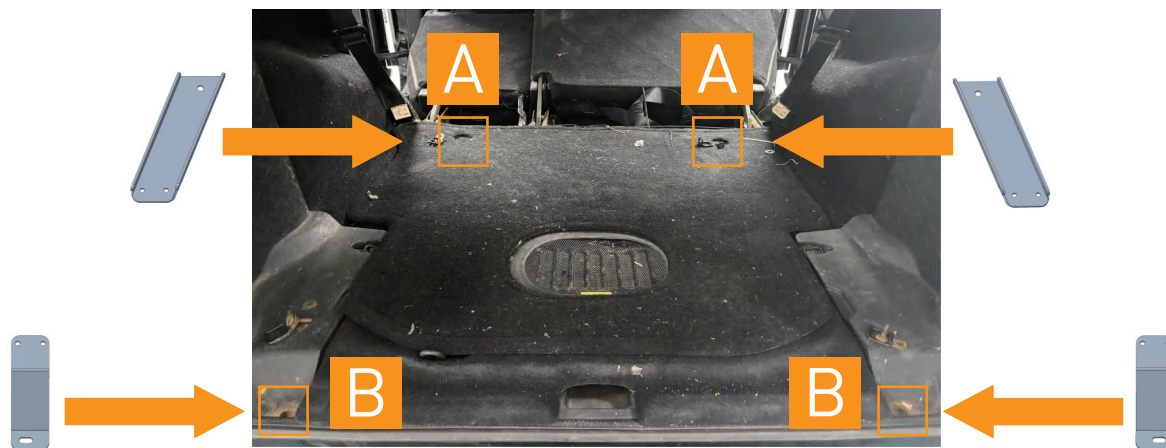

Step 5

(Driver Side) Secure the mounting brackets A and B. Tighten the hardware.

- (2) M6x35 Button Bolts
- (2) M6x20 Button Bolts
- (4) M6x20x2 Flat Washers
- (8) M6 Flange Hex Lock Nuts
- (2) 24x10x12 Nylon Round Spacers

If you have placed the vehicle floor mats, please insert the Nylon Round Spacer into the holes.

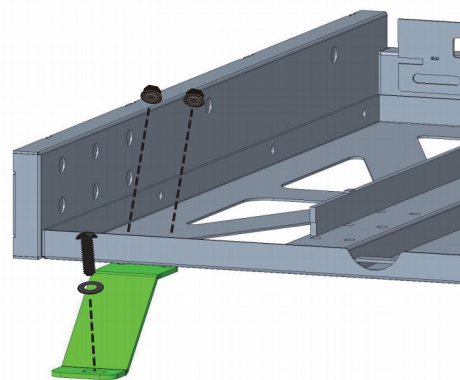
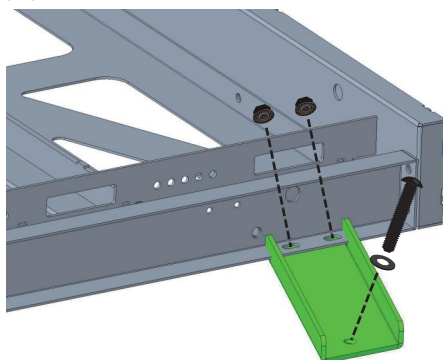

JL Model

Step 6

Please fold down the rear seats and remove four factory hooks from the vehicle.

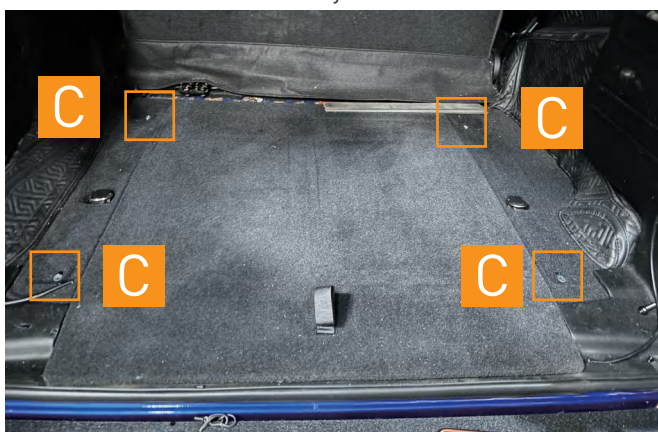

Insert the mounting brackets C into four installation positions.

Repeat this step on for the remaining mounting brackets (C). **Do not fully hardware to allow adjustability.**

- (4) M8x30 Button Bolts

- (4) M8x20x1.5 Flat Washers

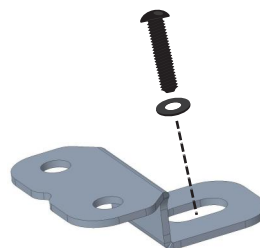
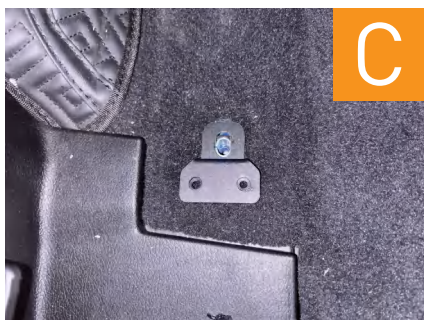

(Driver Side) Secure the main body to the mounting bracket C. Repeat this step on for the remaining mounting brackets (C). Tighten the hardware.

- (8) M6x12 Button Bolts

- (8) M6x12x1 Flat Washers

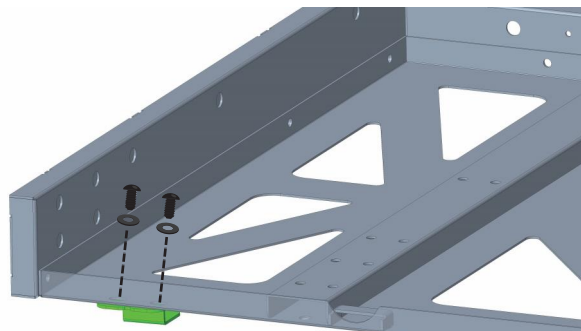

Bronco Model

Remove the (4) factory hooks. lift up the cargo liner mat and locate four factory positions. Align the (4) spacers with the positions and reinstall the cargo liner mat.

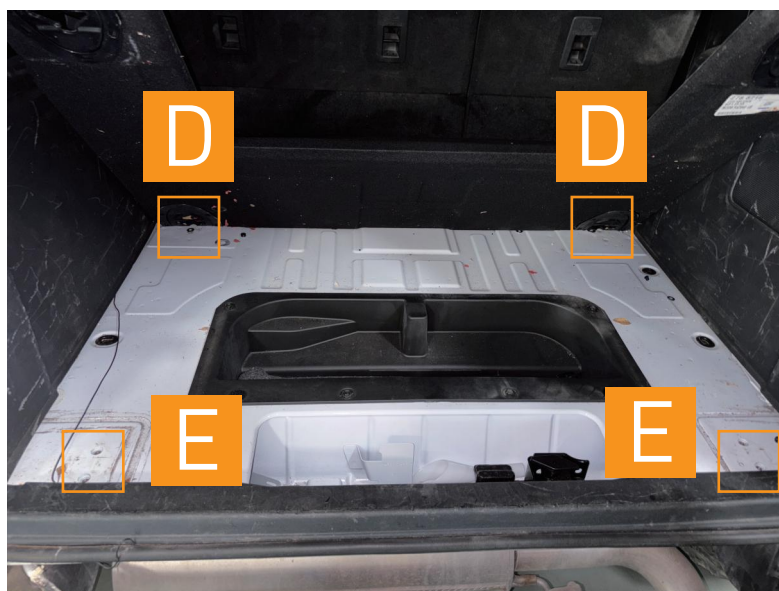

Assemble the mounting brackets (E). Repeat this step on for the remaining mounting brackets (D). Tighten the hardware.

- (8) M6x12 Flat Head Socket Bolts

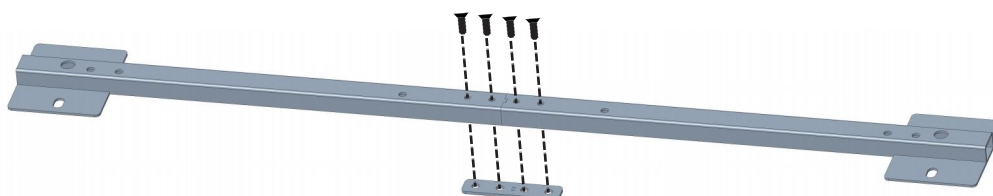

Secure the mounting brackets (E) to the vehicle. Repeat this step on for the remaining mounting brackets (D). Tighten the hardware.

• (8) M8x45 Hex Socket Bolts

• (8) M8x16x1.5 Flat Washers

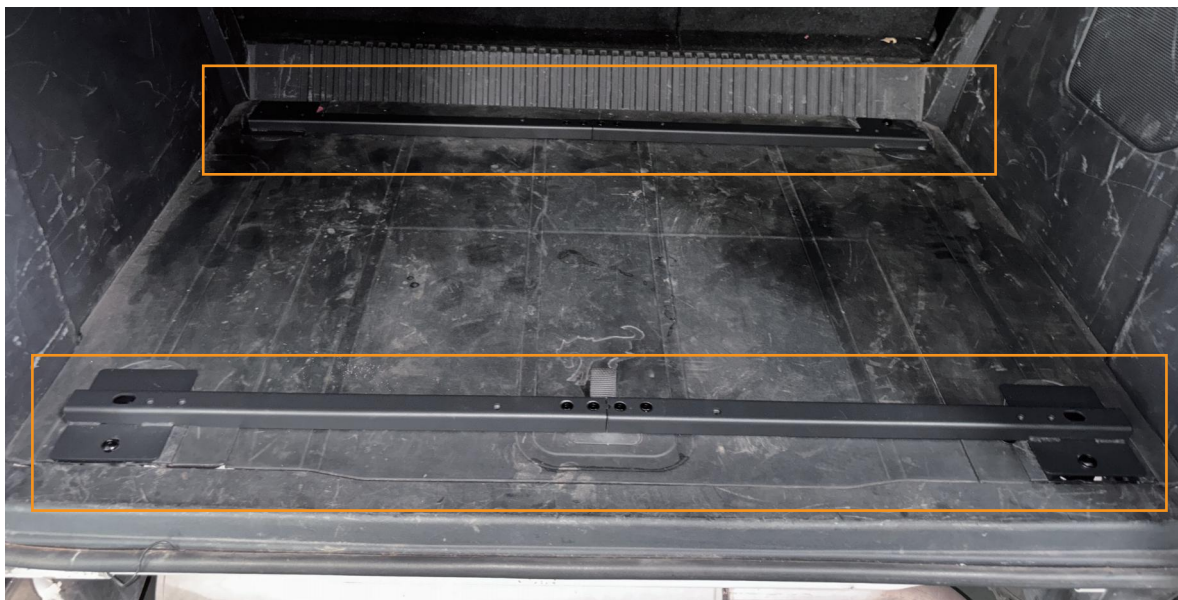
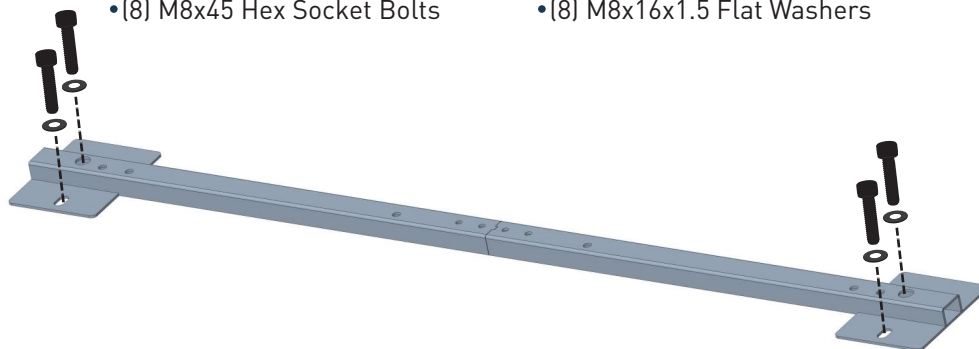

Secure the main body to the mounting brackets D and E. Tighten the hardware.

• (12) M6x12 Button Bolts

• (12) M6x12x1 Flat Washers

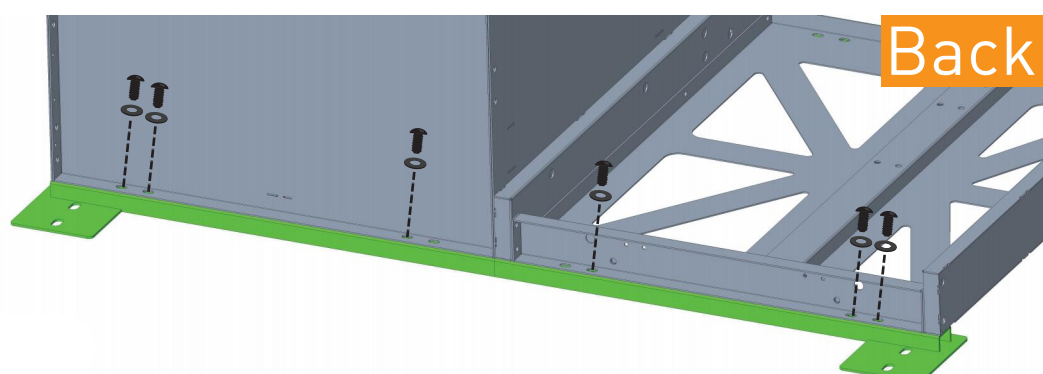
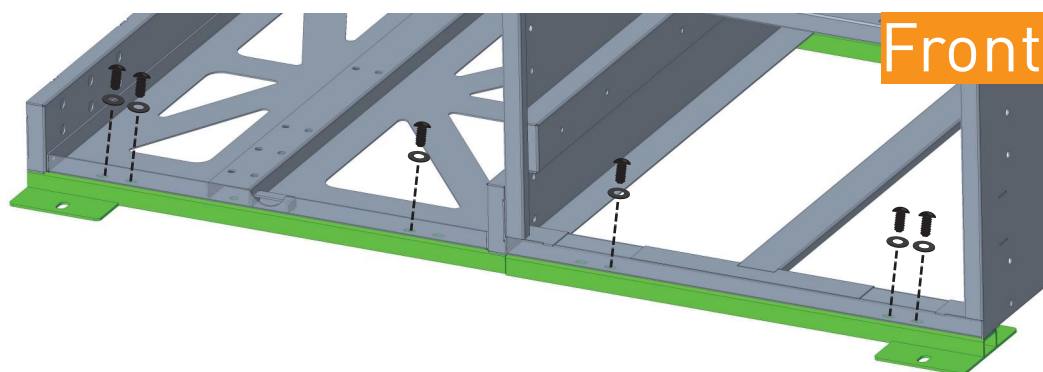

Install the lock to the fridge slide drawer.

Notice: Flip the fridge slide drawer over and perform this step on the bottom side of the drawer.

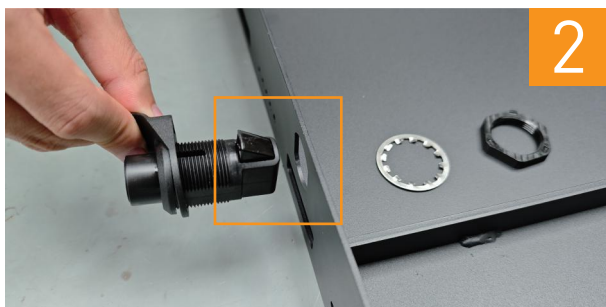
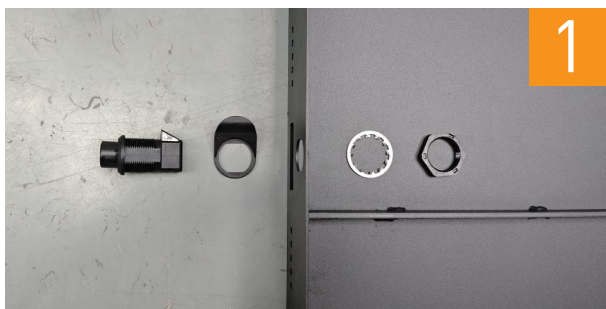

Reinstall all drawers.

Notice: Adjust the stopper plate position and tighten the bolts to prevent the fridge slide drawer from being pulled out accidentally.

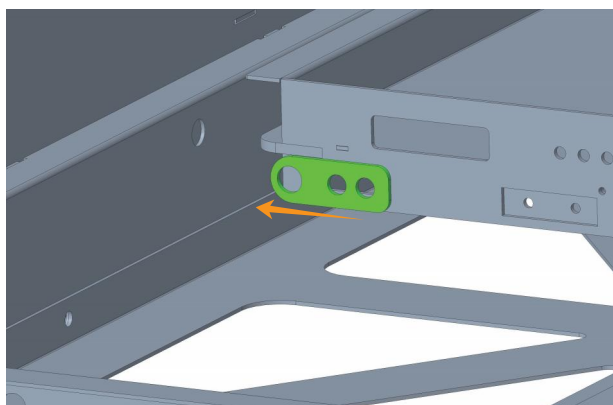

Finally, refer to the following images for instructions on how to use the lock.



Install the rubber stoppers to the surface holes of the box.

- Rubber Stopper

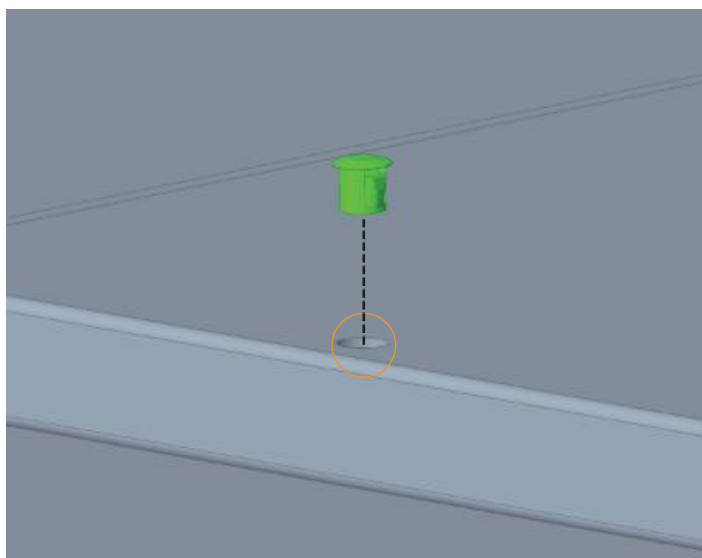

The installation is complete. We hope you enjoy a wonderful off-road life with this quality Hooke Road product!

