

QUICK INSTALLATION GUIDE

MR600, MR800, MR1000

01 PRODUCTS

1.1 CHECKING DELIVERABLE

After unpacking the inverter, please check whether the delivery is complete and whether there is any obvious external damage. If any damage is found or any components are missing, please contact your dealer. The delivery list is shown in the table below:

Serial number	Photograph	Descriptions	Quantities
1		MR600/MR800/MR1000	1 unit
2		Wi-Fi antenna	1 pcs
3		M6*25 mm cross slotted outer hexagon screws	2 pcs
4		Nut	2 pcs
5		Grounding lugs and M4*14 mm Phillips screws	1 set
6		Quick installation guide	1 pcs
7		Warranty card	1 pcs
8		Quality certificate	1 pcs
9		Shipment inspection report	1 pcs
10		Installation map	1 pcs

1.2 ACCESSORIES LIST

The list of accessories for the product is shown as below:

Serial number	Artifact	Descriptions	Use
1		AC trunk connector	AC branch cable connected to AC trunk cable
2		AC trunk plug	AC bus expansion
3		AC trunk end cap	Unused T-connectors bus end protection
4		AC trunk branch cap	Unused T-connectors branch end protection
5		AC disassembly tool	Removing the AC end branch connector
6		DC disassembly tool	Removing the DC end connector
7		Smart meter	AC energy metering
8		DC extension cable	Connect PV modules to microinverter
9		AC trunk cable	Microinverter sink bus

Note: The accessories in the table above are not included in the packing list, detailed specifications and models can be referred to the components list. You can contact SOFARSOLAR sales to purchase or prepare by yourself.

02 PREPARATION

Microinverter reference wiring diagram

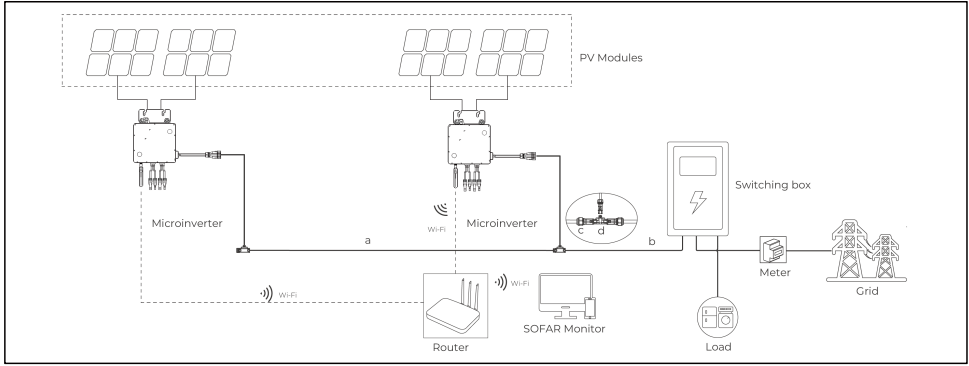

2.1 PREPARE THE CORRESPONDING CABLES ACCORDING TO THE TABLE BELOW

Serial number	Descriptions	Source (of information etc.)
a	AC trunk cable	Own/purchase (refer to accessories list)
b	AC cable	Own
c	AC trunk plug	Purchase (refer to accessories list)
d	AC trunk connector	Purchase (refer to accessories list)

Note: The accessories in the table above are not included in the product delivery list and need to be purchased separately. SOFARSOLAR provides some prefabricated cables and accessories. If you need, please contact SOFARSOLAR sales for details.

2.2 SIZE AND LOCATION

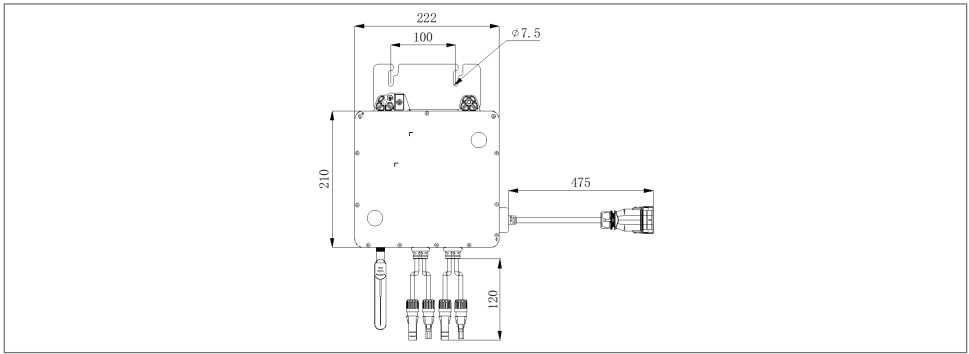

- 1.It is recommended to install the microinverter underneath the PV modules, please avoid direct sunlight, rain, snow, etc. as much as possible, and preferably choose a fully shaded location:
- 2.The microinverter should ideally be more than 15 mm away from the PV modules above it to ensure that the inverter has a good space for heat dissipation.

03 INSTALLATION STEPS

Make sure the microinverter is installed in a reasonable environment (see product user manual for details: <https://www.sofarsolar.com/service.html>)

Step 1: Make sure that the grid voltage matches the voltage level on the microinverter label

SO FAR Micro Inverter

Model No:MR1000

PV Input	Max. Apparent Power:	1100 VA		
Max. Input Voltage:	58 Vd.c.	Max. Output Current:	4.5 A	
MPP Voltage Range:	26-55 Vd.c.	Power Factor Range:	0.8leading-0.8lagging	
Max. Input Current:	2*20 A	Inverter Topology:	Isolated	
Max. Isc:	2*25 A	Protective Class:	Class I	
AC Output	Rated Output Voltage:	L+N+Ⓢ,220/230/240 Va.c.	IP Rating:	IP67
Rated Output Frequency:	50/60 Hz	Overvoltage Category:	AC III, DC II	
Rated Output Power:	1000 W			

Manufacturer : Shenzhen SOFARSOLAR Co.,Ltd.

Address : 11/F., Gaoxinqi Technology Building, No.67 Area,Xingdong Community, Xin'an Sub-district, Bao'an District, Shenzhen City,China

Made in China

Step 2: Mount the microinverter on the bracket

1. Please mark the mounting position of each microinverter on the bracket according to the layout of the PV modules. Put two nuts in the groove, then install two M6*25 mm cross slotted outer hexagon screws.
2. After hanging the microinverter from the screws on the bracket, tighten the Phillips screws with a torque of 5.5 kgf.cm.

Step 3: Install the antenna

After the microinverter is reliably mounted to the bracket, the Wi-Fi antenna is fixed to the microinverter.

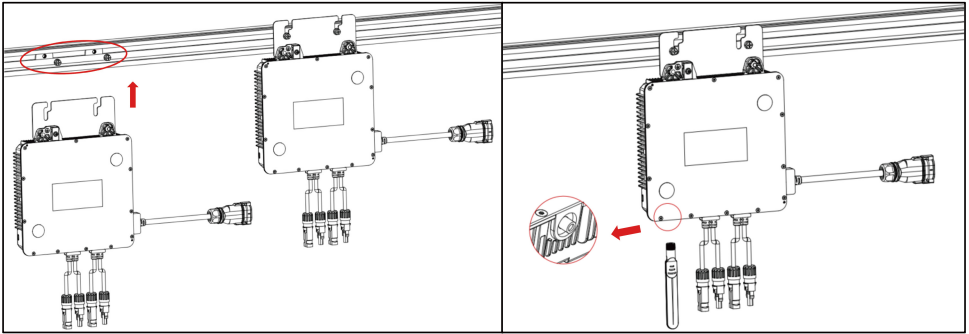

Step 4: Ground the microinverter

It must be properly grounded through the microinverter's own grounding lug connection to the bracket.
(Grounding cable needs to be prepared by yourself, 6 mm² size is recommended)

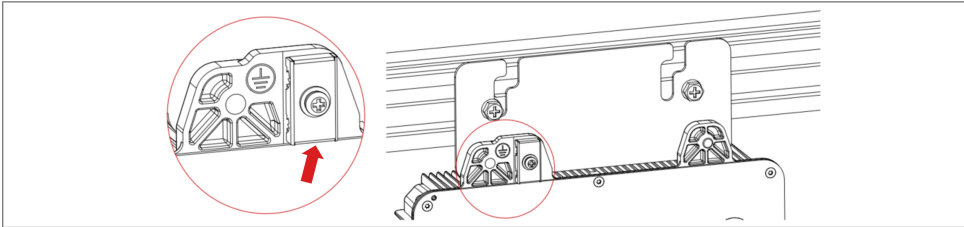

Step 5: Connect the microinverter AC cable

- 1.Please plan the proper location for the AC trunk cable to connect to the inverter first, then choose the proper AC extension cable according to the distance between the microinverters.
- 2.Install the AC trunk end cap at the end of the AC trunk cable.

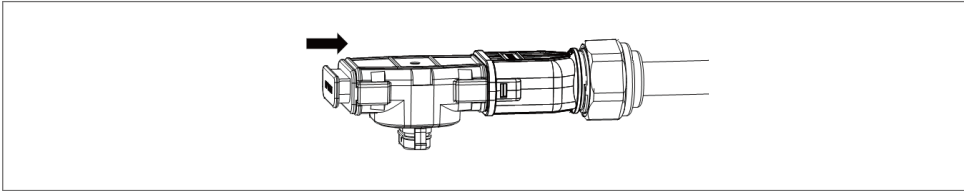

3.Plug the microinverter AC terminal connector into the AC trunk connector. Please pay attention to the direction of the connector when inserting, when you hear a clear "click" sound, it means that the connection is successful.

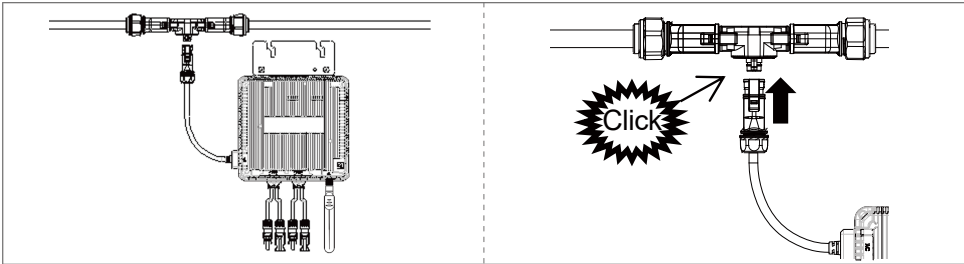

Attention:

- To remove the microinverter AC connector from the AC trunk connector, use the AC disassembly tool and insert the tool into the side of the AC spur connector to complete the removal.

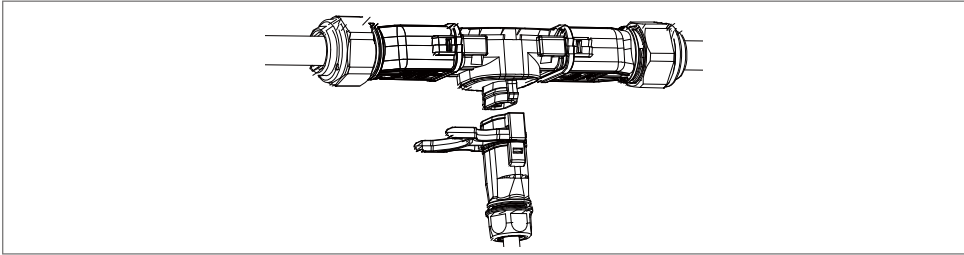

- Unused trunk connector ports, please cover AC trunk branch cap.

Step 6: Connect the microinverter and PV modules

Connect the photovoltaic module interface to the DC input of the microinverter through the DC extension cable. A "click" sound indicates that the connection is successful.

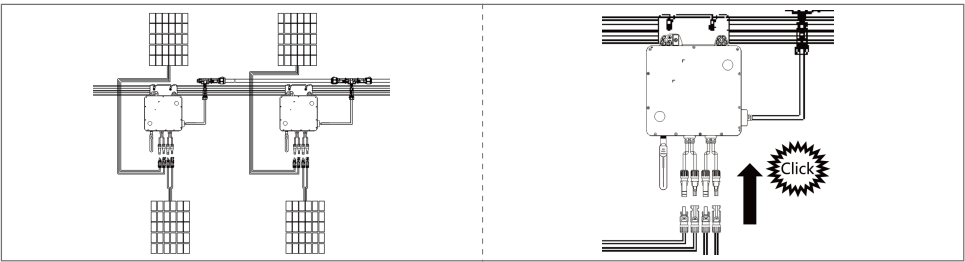

Step 7: Create installation map

It is recommended to use an installation map to record the location of the microinverter on the roof, or you can draw an installation map yourself.

- 1.There are two sheets of serial numbers affixed to each microinverter case. One of the sheets can be peeled off. Remove the removable serial number label from each microinverter and attach the serial number label to the appropriate location on the installation map.

(Installation map templates can be obtained from User Manual 7.2 Installation Maps.)

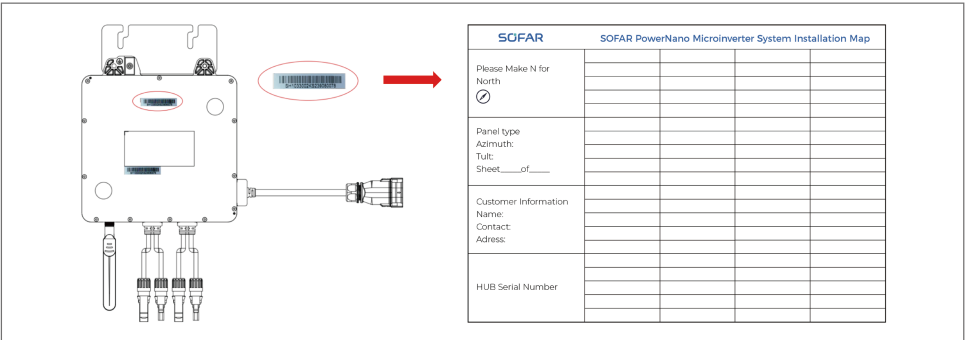

2.When the installation map is completed, you can upload it during the construction of the station after logging into the SOFAR Monitor APP. In the APP you can get graphical solar system operation information and can monitor and analyze system information in real time.

Step 8: Commissioning

- 1.Cable connection check

 **ATTENTION**

- Before starting up the device for the first time (commissioning), all operations performed on the device should be thoroughly checked. In particular, check that the DC terminal voltage and the AC terminal voltage comply with the permissible range of the microinverter.

- 2.Start the inverter

- 1)Close each microinverter branch AC circuit breaker.
- 2)The main grid-connected circuit breaker is closed and the system generates power in approximately 3 minutes (the specific start time is required by national/regional regulations).

3)Please pay attention to the indicator light display on the side of the inverter. When the microinverter is connected to the PV modules, if the indicator green light is always on, the microinverter is working normally at this time.

- 3.Open the APP to check the working status of the microinverter.

Step 9: Connecting the monitoring system

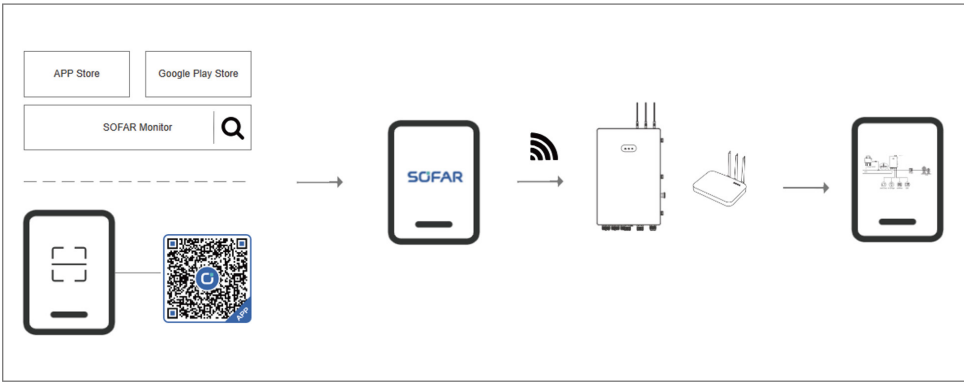

Please refer to "SOFAR Monitor User Manual" to set up the monitoring system.

(You can download SOFAR Monitor APP by scanning the QR code below, and check it in the "My - Personal Settings - About Software - Operation Manual" page of SOFAR Monitor APP.)

