

Serial Number	Name	Quantity
7	Fixed base	1
6	Faucet body	1
5	Decorative cover	1
4	Self-tapping screw	2
3	Wrench	1
2	Fixed screw	1
1	plastic wall plug	2

Standard List of Accessories:

When you open the product packaging, please check whether the objects in it are consistent with the main body and accessories you purchased. If there is any inconsistency, please contact our company or our distributor.

- Note: 1. Accessories are subject to change without prior notice if the change does not affect usage;
2. The appearance of the product is subject to the physical objects you receive, and the schematic diagram is only for reference.



Pis Contact Us for More Options

INSTALLATION STEPS

Helpful Information Tools:
Gather the necessary tools as shown below to complete the installation of this Pot Filler Faucet

You May Need



Read all instructions before installationTurn off hot and cold water supplies at angle stops before installing Pot Filler Faucet

Easy Installation



STEP 1

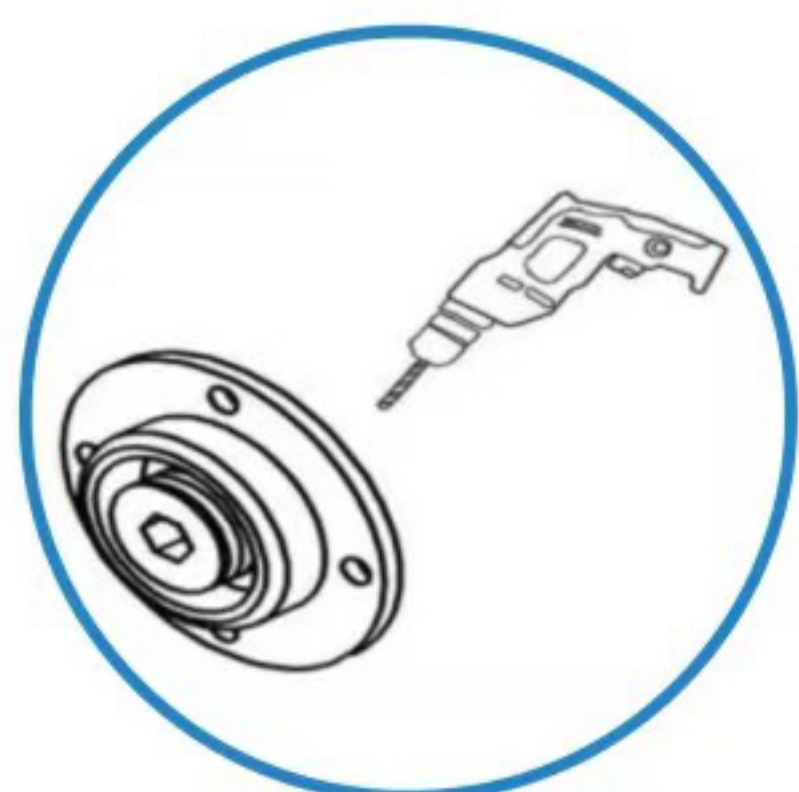

STEP 2

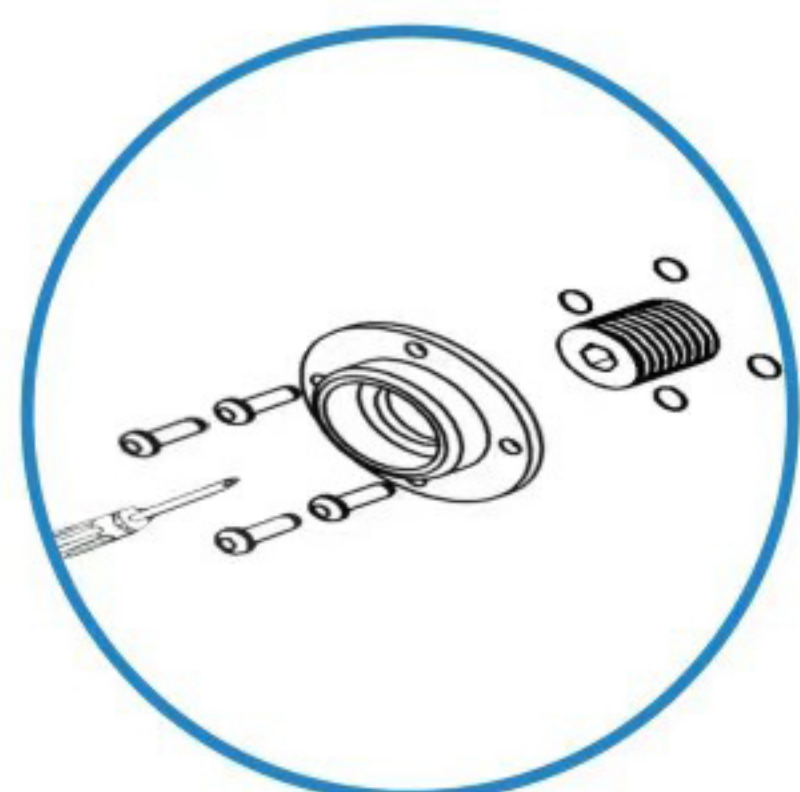

STEP 3

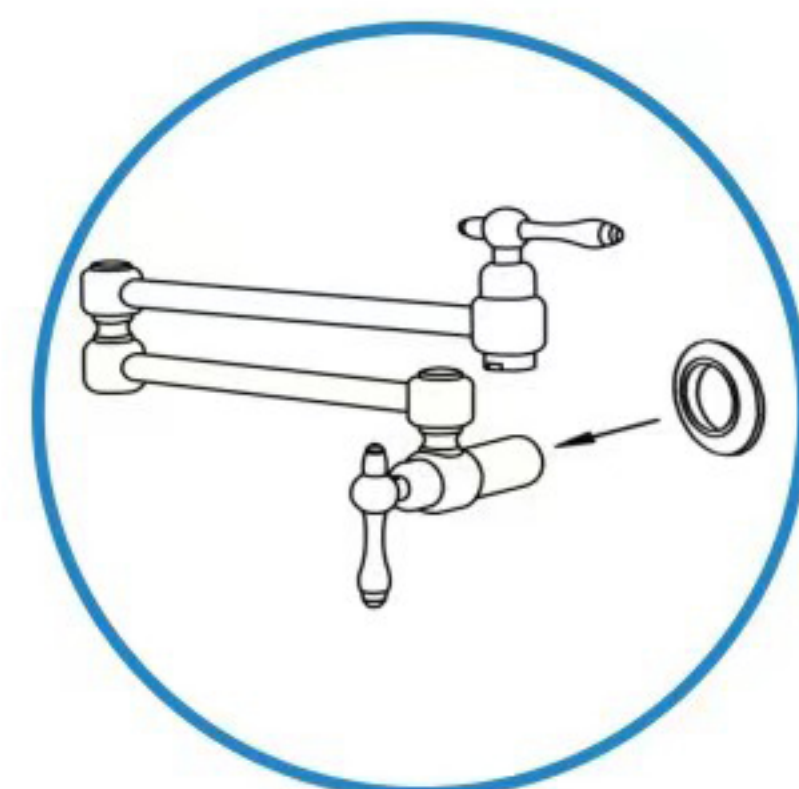

STEP 4

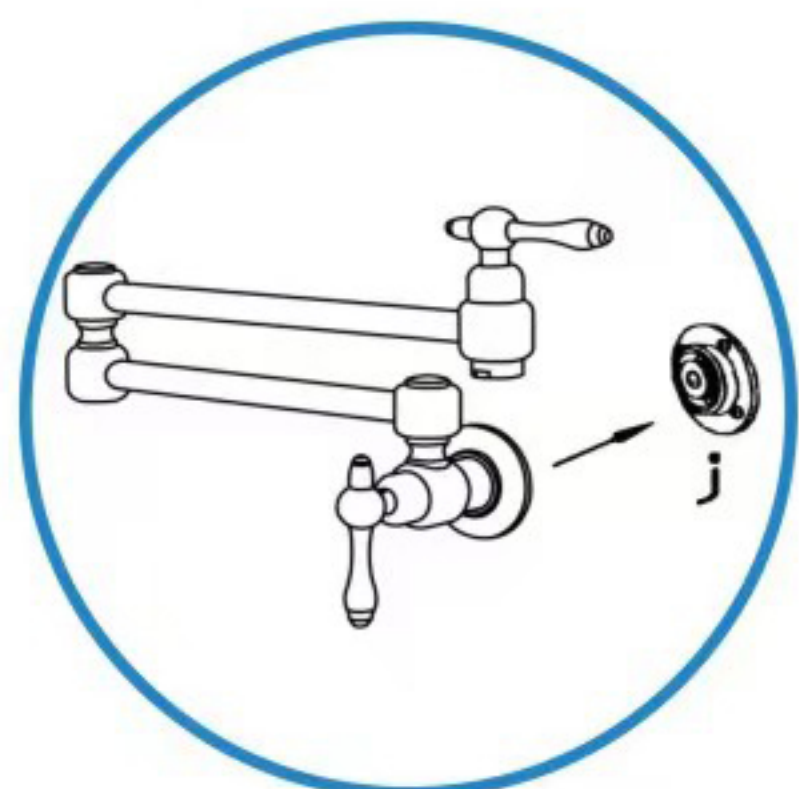

STEP 5

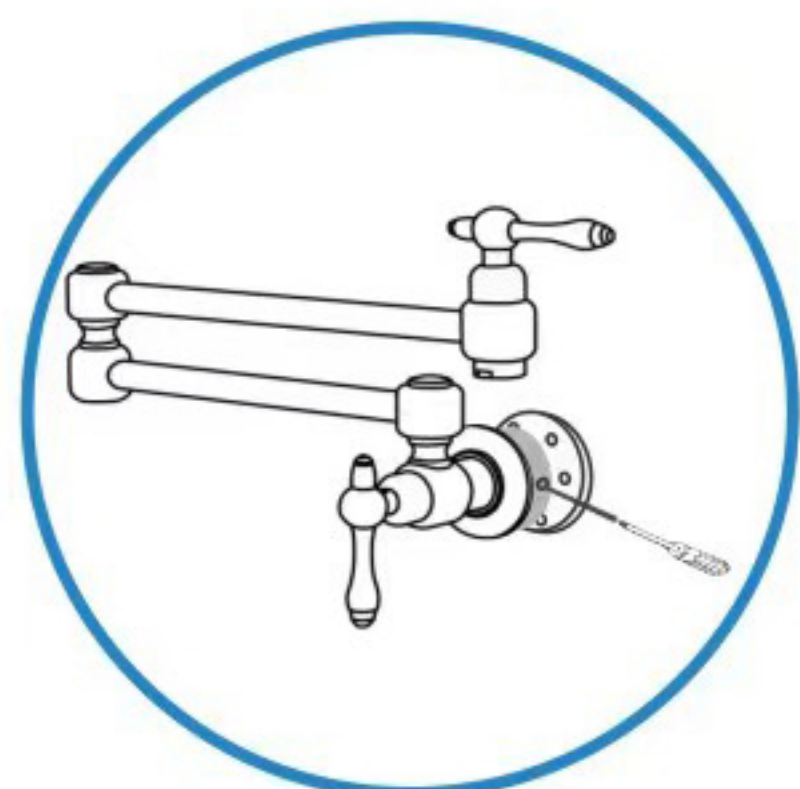

STEP 6

STEP 1
Wrap the sealing tape on the 1/2 NPT thread joint and connect the water pipe.

STEP 2
Put the base on the thread joint and punch.

STEP 3
Knock the nail into the hole, fixing the base with screws.

STEP 4
Put the decorative cover on the faucet interface tube.

STEP 5
Connect the faucet to the thread joint on the wall, and use a hex wrench to tighten the screw from the side of the base to fix the base.

STEP 6
Knock the nails into the side hole, fixing the faucet with screws.

INSTALLATION DIMENSION

Product Size

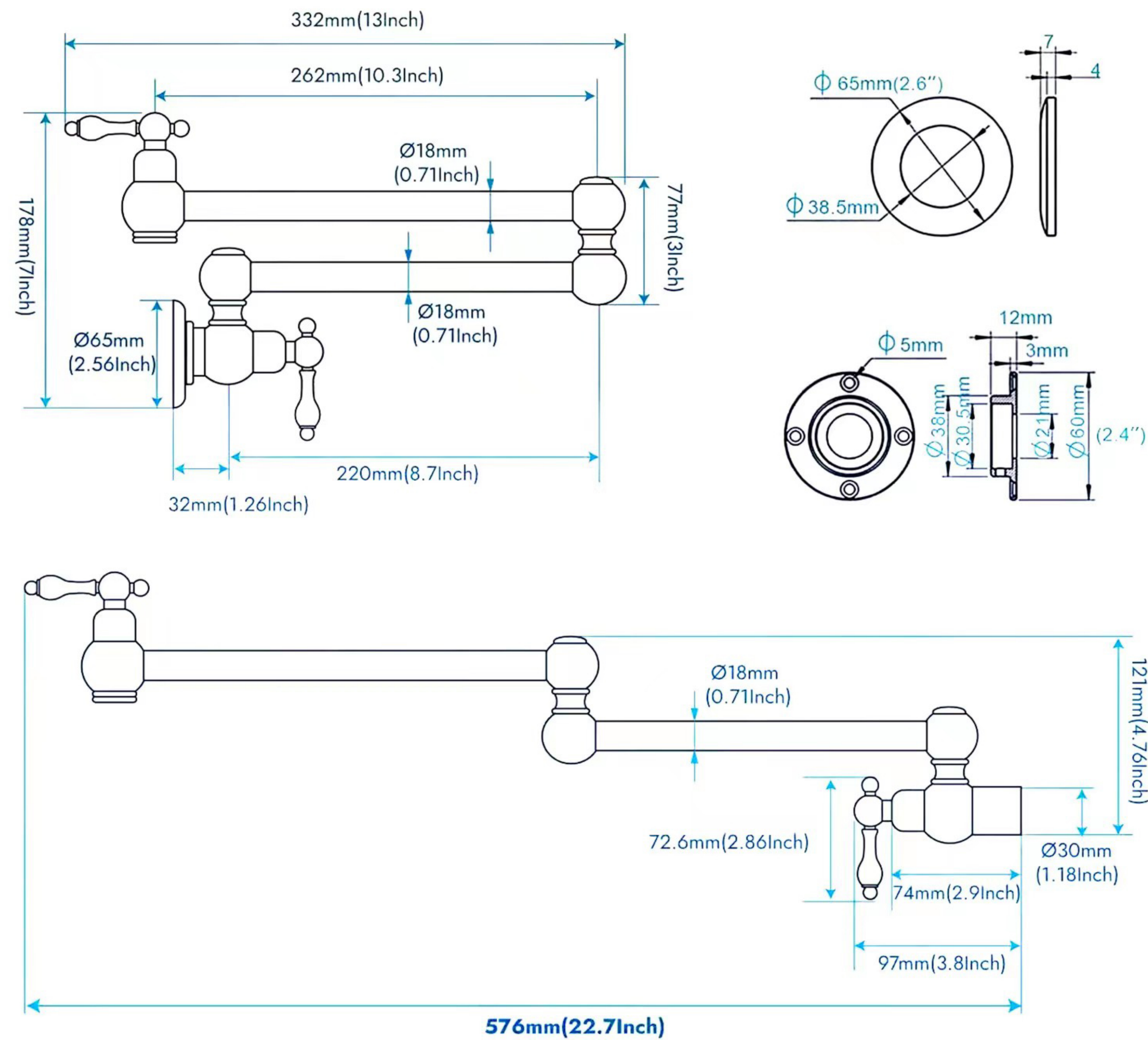

CLEANING CARE

In order to keep the appearance of Pot Filler Faucet clean, bright and good performance, please take care of the Pot Filler Faucet as follows:

1. Rinse with water only and dry with soff cotton cloth;
2. Use mild liquid and colorless glass cleaner to remove surface dirt and scale fim, or use polish without abrasive effect.
3. Do not use abrasive deterfgent, polish, emery cloth, paper towel or scraper, etc.;
4. Do not use acid cleaner, or cleaner and soap with insoluble gran etc.;
5. In the process of use, mud my accumulate in the bubbler and make the water flow show, The bubbler can be unscrewed.rinsed with water, and then installed back in place.

Pls feel free to contact us if you have any questions. We will solve this in time with this email of vanbus@163.com