

Important Safety Precautions

1. Please read all the instructions carefully before using the product.
2. When cleaning the display, please unplug the power cord. Please wipe the display with a soft wet cloth instead of liquid or spray cleaner. Please use LCD screen cleaner in case of a stubborn stain.
3. Do not use accessories that are not recommended by the manufacturer, or there may be dangerous.
4. When unplugging the power cord of the display or the power adapter, please hold the power plug with your hand rather than directly pull the power cord to unplug it.
5. Do not place the display near water, such as bathtub, washbasin, kitchen sink, or washing machine. Do not place the display on the wet ground, or near the swimming pool. Do not use fingers or hard objects to press the surface of the LCD screen.
6. The grooves and holes on the shell or at the back and bottom of the display are designed for the ventilation and heat dissipation of the components to ensure reliable operation. So, do not put the display on the bed, sofa, carpet, or other similar surfaces to prevent the heat dissipation holes from blocking and do not place the display near or above the radiator or heater. In addition, do not place the display in an embedded device unless adequate ventilation is provided.
7. Only the power supply type shown on the nameplate can be used for the display. Please feel free to consult the display dealer or the local power supply administration, if you have any doubts about your power supply type.
8. For safety, the display or the power adapter uses a power cord with a three-prong plug, whose third prong can only be properly grounded when used with a properly grounded socket. If your socket cannot match with the plug, please contact an electrician to replace your original socket so that the plug can give full play to ensuring safety.
9. As you may face high voltage or other dangers after removing the shell, do not repair the display by yourself. You can have it repaired by qualified maintenance personnel.
10. Please unplug the power cord of the display or the power adapter from the socket, and contact qualified maintenance personnel for repairing the display, when following cases occur:
 - a. The power cord or the plug is damaged or worn out.
 - b. The display has been dropped from high or the shell is damaged.
 - c. Any obvious abnormality indicates a necessary repair.
11. Please place the display in a well-ventilated environment, which is away from strong light, high temperature, or humidity.
12. The room temperature for the display store is -10°C ~ 60°C, or it may be permanently damaged.

Name and Content of Toxic/Hazardous Substances/Elements in the Product

Component	Toxic/Hazardous Substance or Element					
	(Pb)	(Hg)	(Cd)	(Cr6+)	(PBB)	(PBDE)
Display screen	×	○	○	○	○	○
Plastic shell	○	○	○	○	○	○
PCBA*	×	○	○	○	○	○
Power cord and cables	×	○	○	○	○	○
Metal parts	○	○	○	○	○	○
Packing materials*	○	○	○	○	○	○
Loudspeaker (optional)	×	○	○	○	○	○
Accessories*	○	○	○	○	○	○

○ : Indicates that the toxic/hazardous substance in all homogeneous materials of corresponding component is within the content limit specified in GB/T26572-2011.

× : Indicates that the toxic/hazardous substance in one or more homogeneous materials of corresponding component is beyond the content limit specified in GB/T26572-2011.

To care for and protect the earth better, please send it to a local manufacturer with nationally recognized qualification for recycling according to the national applicable laws and regulations on recycling of waste electrical and electronic products when you no longer need this product or at the end of its service life. The environment-friendly use period of this product is 10 years (see the Marking for the Restriction of the Use of Hazardous Substances in the right figure).  Such use period will be maintained, only if you use the product under the normal working conditions specified in the User Guide only.



Any questions or comments, please contact us as below
 support@ktcpay.com [North America]
 support.eu@ktcpay.com [Europe]
 For your warranty information, please visit www.ktcpay.com



KTC H27V13/H24V13 Display User Guide

Please read the User Guide carefully and keep it properly.
 The pictures involved in the User Guide are for reference only,
 please refer to the actual product for details.

1. Installing the Base

a. Insert the base into the support to fix;

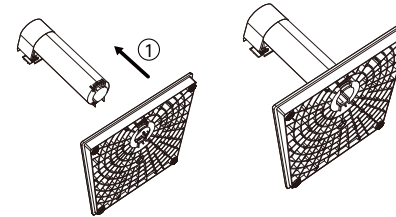

b. Install the base in the direction of the arrow into the hole position to lock the base;

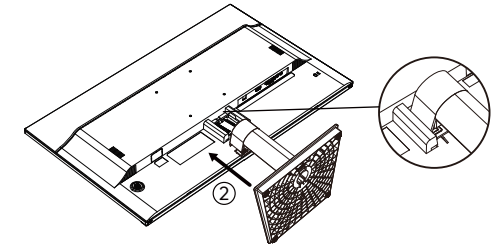

2. Removing the Base

a. Press down on the snap and push the base back hard;

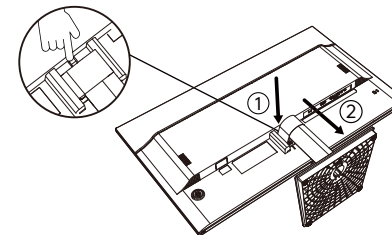

b. Pinch both sides of the base snap, pull out the bracket with force;

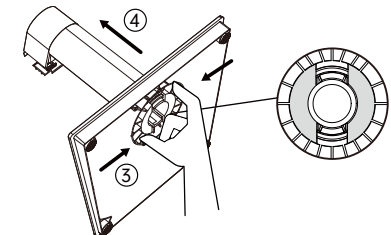

3. Appearance and Functions

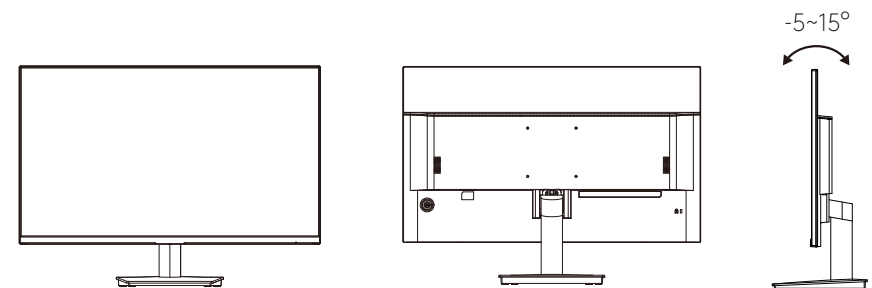

KEY TO COMBAT

1. Product Introduction

It is a kind of high-performance intelligent multiple frequency scanning display, which adopts active matrix thin film transistor LED-backlit LCD. The display is controlled through the microcomputer MCU digital technology. It is compact and lightweight, which is suitable for narrow working spaces.

Before installation, please check whether the following articles are complete in the packing box:

- LCD×1
- Power Adapter×1
- Signal Cable(Optional)×1
- Warranty Card×1
- Base×1
- User Guide×1

If any of above product is missing, please contact with product distributor immediately.

Notice: Specific accessories in order to prevail in kind. Please keep packing materials for future movement.

2. Display Installation

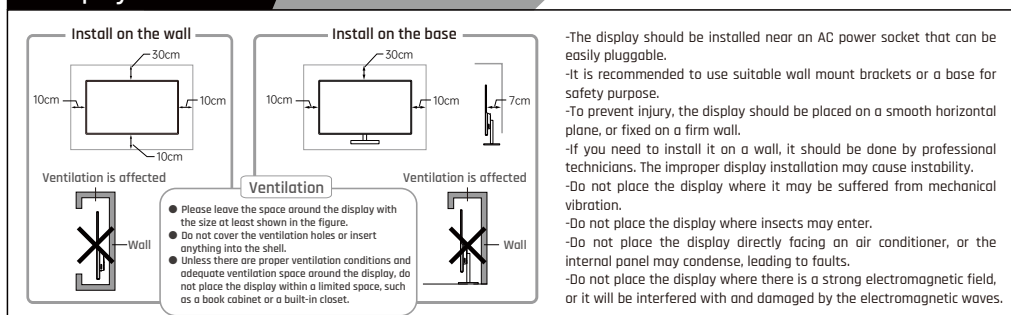

3. Display Operation

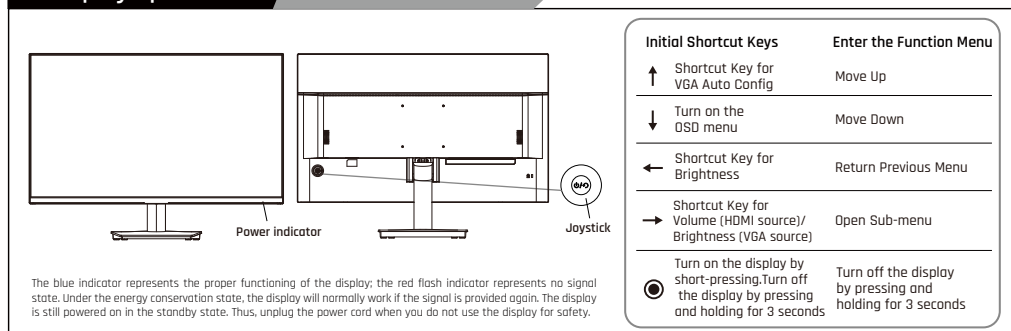

4. Port Description

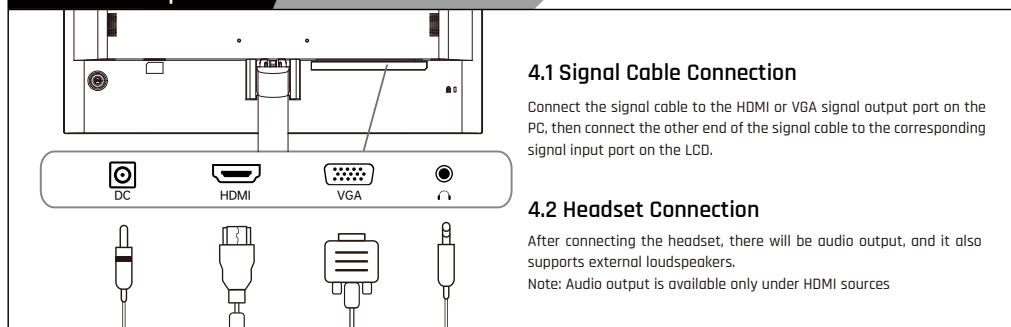

5. Safety Protection

When the PC video signal exceeds the frequency range of the display, the display will disable the line and field synchronizing signals to protect the display. Under this circumstance, you must set the output frequency of the PC to an acceptable range for the display to work properly.

6. Power Management System

Mode	Power Consumption
Normal Operation	≤36W
Standby	≤0.5W

Remark: If there is a subtle difference between the User Guide and the actual operation, the latter shall prevail.

7. Simple Problems Disposal

Symptoms	Disposal Methods
1.Blank screen /Power indicator does not work	Check whether the power supply is in good contact with the display and the power socket; and check whether the display is turned off.
2.Blurred , too large or too small images	Go to the "Image Settings" category menu and select "Image Auto Adjust" to make the monitor adjust automatically to correct. (Only available for monitors with VGA)
3.Dark screen	Enter the "Brightness & Contrast" menu to regulate the contrast and the brightness of the display.
4.Display overheating	Leave at least 5cm of ventilated space around the display. Do not place articles on the display.
5.Dark/light spots when powered on	It is normal. Because of the temperature difference in the environment, the backlight tube emits uneven light at the initialstage after the display turns on. However, the backlight tube will emit normal light after 20 minutes, and the dark/light spots will be eliminated at that time.
6.Image distortion, flashing, shaking	Check your computer configuration, choose the correctresolution, and reset your refresh rate.
7.Noisy signal when powered off	During the power-off of the display, there may be some noisy signals on the screen caused by the normal discharge.

8. Product Technical Specifications

	H27V13	H24V13		H27V13	H24V13
Panel Dimension	27"	23.8"	Working condition	Temperature: 0℃~40℃ Humidity: 30%~90% (Non-condensing) Atmosphere: 86kPa~106kPa	
Best Operating Resolution Ratio	1920×1080 @ 100Hz				
Input Voltage	DC 12V / 3A				
Contrast	1300:1	1000:1	Storage condition	Temperature: -20℃~55℃ Humidity: 20%~93% (Non-condensing) Atmosphere: 86kPa~106kPa	
Active Area	597.89mm × 336.31mm	527.04mm × 296.46mm			
Pitch size for wall mount	100mm × 100mm		Packing Dimension and Weight (W×H×D) Display Dimension (W×H×D) (excluding base) Packing Dimension (W×H×D) Net Weight of Display (including base) Packing Weight	616×364.3×42mm	540×319.6×42mm
Maximum elevation	5000m			708×465×145mm	620×475×115mm
				4.3Kg	2.8Kg
				5.7Kg	4.1Kg



The terms HDMI and HDMI High-Definition Multimedia Interface, and the HDMI Logo are trademarks or registered trademarks of HDMI Licensing Administrator, Inc. in the United States and other countries.