

Quick Installation Guide

Wireless Charger Cam

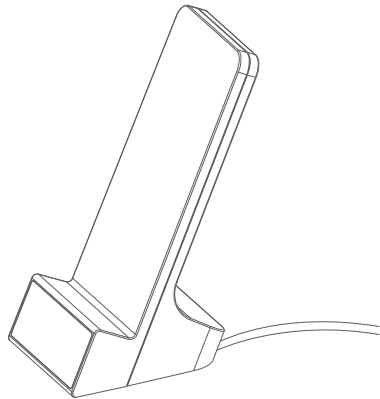

REV1.1.0

1.Packing List

Open the package, then make sure the Wireless Charger Cam (device) is intact, and with all the below accessories.

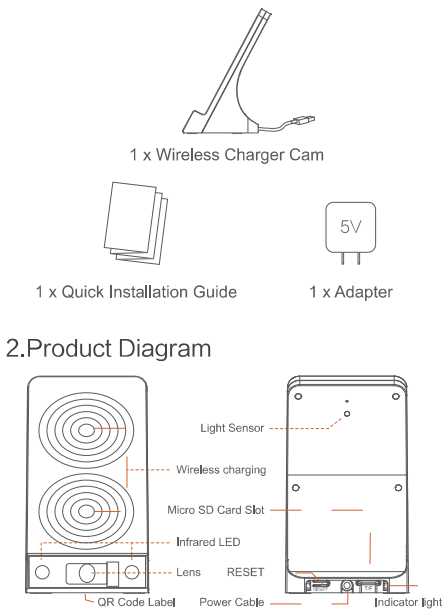

2.Product Diagram

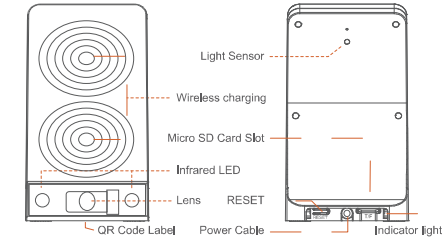

Description

Introduction

Light Sensor	Infrared light adjustment
Wireless charging	Wireless charging sensing area
Micro SD Card Slot	Support Micro-SD card storage(up to 128G)
Infrared LED	Additional light in Low-light conditions
Lens	Capture Videos
RESET	Press and hold [RESET] for 5 seconds, the device will be restored to factory default setting.
Power Cable	Supply power(5V 2A)

Indicator light	
Blue LED indicator	Light off: No power
	Light solid: Power on
Red LED indicator	Light blink: System running normally
	Light off: Wi-Fi no connection
	Light solid: Wi-Fi connected
	Light blink: Waiting connect to Wi-Fi

3.Use wireless charging function

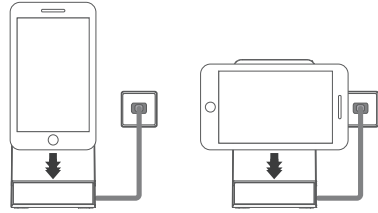

- Please charge with the original adapter, then put the phone on the device.
- Please remove the smartphone from the device when it's fully charged

WARNING

- Only original 5V 2A adapter is allowed.
- Only support the mobile phones which support wireless charging.
- Distance between the router and the device should be within 3 meters during configuration.
- Do not place the objects such as metal, magnets or magnetic stripe cards between the smartphone and the device's charge sensing area. The smartphone may not charge properly or be damaged due to overheating.
- If your phone with a thick protective case, wireless charging may not work. Please remove the protective case if it is thick, and then put the phone on the device for charging.

Wireless charging support smart phone model

This Smart Wireless Charger supports Samsung Galaxy Note 8, S8, S8 Plus, S7, S7 Edge, S6 Edge Plus, Note 5 fast charging. Standard wireless charging for iPhone X,8 Plus,8 and most Q-enabled devices like LG G6, S6, S6 Edge, and most models of MOTO,HTC and Nokia, etc.

If your phone not support wireless charging, can be use with wireless charging receivers.

4.Preparation

Please prepare the below stuff before you use it.

4.1 One smartphone or tablet PC(Mac or Windows PC is not acceptable) with IOS 6.0 or Android 4.0 system(higher version system is acceptable)



4.2 Wi-Fi Router



- Device can only connect to 2.4Ghz Wi-Fi router.
- Make sure turn on the DHCP of router, and MAC address should be off.

- Distance between the router and the device should be within 3 mtrs during configuration.
- Please don't use special character such as Chinese, symbol to name the WiFi.
- Please don't use special character such as Chinese, symbol as the password for the WiFi and Wi-Fi password can not be blank.

4.3 Install "Clock Live" App

- Search "Clock Live" App from Apple Store or Google Play, then download.
- Scan the QR Code below and install the App.



5.Operation Instruction (please read, IMPORTANT!)

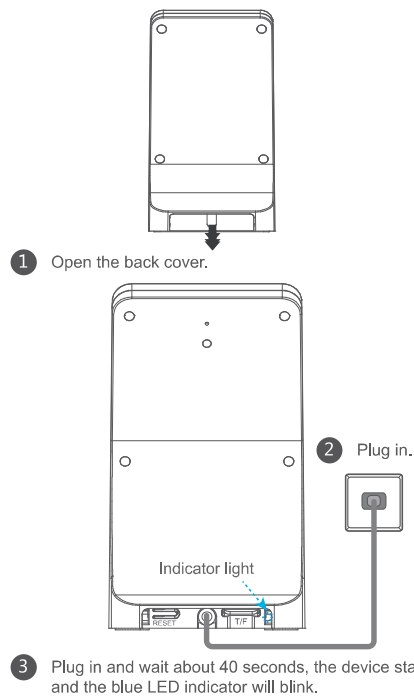

6.Configure Device

Open the App.



1 Click "+"

2 Click "First Add"

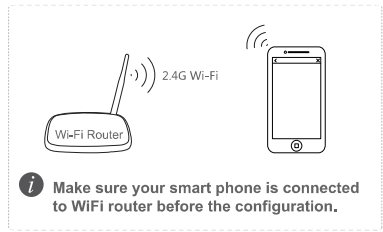

3 Make sure your smart phone is connected to WiFi router before the configuration.

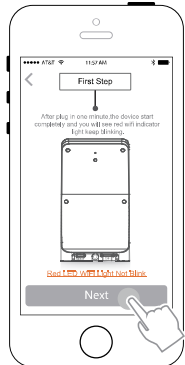

3 When the red LED indicator is blinking, please click Next.

Notice

- If the red LED indicator does not blink, press [RESET] button and hold 5 seconds, until the blue LED indicator is solid, release the button and the device is reset to factory default setting.

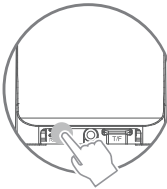

- In order to make sure the device work normally, please don't use any non-matched adapter.(standard output: DC 5V 2A)
- After the device started, if the red LED indicator does not blink, please reset the device to factory default setting.
- Press [RESET] button and hold 5 seconds, when the blue LED indicator is solid, release the button, then the device is reset to factory default setting.

7. My Cameras

- 1 Click the screen to watch the video.

The diagram illustrates the mobile application interface. It features a video player at the top displaying a scene with two children and a dog. Below the video player is a control bar with several buttons: a 'Return' button (circular arrow), a 'Peak Support' button (circular arrow with a peak icon), a 'Snapshot' button (camera icon), and a 'Storage' button (circular arrow with a storage icon). The interface also shows a status bar at the top with the time '10:06' and a battery level indicator.

2 Watch Video.

Click "".

page.

 If the live video is frozen, please close it and open again. If it is still frozen, please power off and restart the device and the WiFi router, and keep the device and the WiFi router within 3m to configure again.

The photos, graphics, charts and illustrations provided in the user Manual are only used to explanation and interpretation, which may be different from specific products, please refer to the real object.

The user manual maybe updated because of the products version upgrade or other requirements, if you need the latest version of the user manual, please contact customer service for the latest version of the user manual.