

# Cool Mist Ultrasonic Humidifier LCDJSQ-022 User's Guide

Thanks for your purchase.  
We provide a one-year warranty.  
If any quality issues,  
replacement or refund is available.  
Please feel free to contact us via E-mail:

[info@lacidoll.com](mailto:info@lacidoll.com)





# Precautions

Thank you for purchasing our humidifier **LCDJSQ-022**.  
Please read this manual carefully before using  
and keep it for future reference.

All pictures shown are for illustration purposes only.  
Actual products may vary due to product enhancement.

# Contents

---

Safety Guide .....	1-2
Components .....	3
Placement .....	4
Installation .....	5-6
Water filling& Use of Essential Oil .....	7
Control Panel& Remote Control .....	8
Maintenance .....	9-10
FAQ .....	11-12
Product Specification .....	13
Warranty .....	14

# Safety Guide

---

- ❶ Do not disassemble or modify the machine.
- ❷ Do not subject the machine to strong impacts.
- ❸ Keep a safe distance when the humidifier is spraying mist, especially if you have a sensitive respiratory tract.
- ❹ Turn off the machine before moving it.
- ❺ Do not connect the machine to a socket that exceeds the rated voltage or use an extension cable, as this may cause fire or electric shock.
- ❻ If the plug or wire becomes abnormally hot, stop using the machine immediately.
- ❼ Do not unplug the power plug with wet hands, as this may cause electric shock or injury.
- ❽ Do not block the outlet or add water to the mist outlet, as this may cause water leakage, deformation or failure.
- ❽ Do not block the outlet or add water to the mist outlet, as this may cause water leakage, deformation or failure.
- ❾ Do not use acidic detergents in the main body, as they may produce toxic gas.
- ❿ Children should use the machine under adult supervision.
- ⓫ Do not put essential oil into the main body or water tank, as this may cause water leakage, deformation or failure.
- ⓬ When the machine is not in use for more than 24 hours, please pour out the water from the water tank and main body to prevent mold or impurities from harming your health.
- ⓭ Before the first use, leave the machine at room temperature for 30 minutes to avoid damage to the water tank due to sudden temperature changes.

# Safety Guide

---

- ❶ Use the machine at normal room temperature, which ranges from 5°C to 40°C.
- ❷ When the room temperature drops below 0°C, please pour out the water in the water tank and sink to avoid freezing and damaging the machine.
- ❸ Note: The above safety guide is for your reference only. Please read the user manual carefully before using the machine. If you have any questions, please contact customer service.

**Main Body**

- Cover
- LED Display
- Water Tank
- Mist Outlet
- Essential Oil Tray
- Tank Handle
- Humidity Sensor
- Power Cord
- Water Viewport

**Remote Control**

- POWER
- HUMIDITY
- MAX MIST
- TIMER
- UV
- SLEEP

**Internal Components**

- Water Outlet
- UV lamp
- Float
- Water Inlet
- Atomizer
- Fan Outlet

**Water Pump Assembly**

- Main Body
- Pump Connector
- Water Pipe
- Water Pump

# Placement

Place the humidifier in a horizontal position that is more than 50 cm away from walls, furniture, household appliances, and other objects.

Do not use the humidifier in the following situations to avoid water leakage, signal jamming, damage or injury:



- ❗ In direct sunlight.
- ❗ On an unstable platform.
- ❗ In high temperatures, humidity, or dust.
- ❗ Near the air conditioner, heater, or stove.
- ❗ Near mobile phones, computers, and other precision instruments.
- ❗ Near the radio and other objects that emit radio waves.
- ❗ Under tables, or on the carpets, bedding, etc.



# Installation



1. Take off the main body, take out the remote control and other accessories in the water tank.



3. Remove the protective bag from the water pump.



2. Remove the insulating plastic sheet before using the remote control.



4. Place the main body on the water tank properly.

# Installation

---



## **Note:**

If the water pump fails to pump water, please try disassembling it along with the water pipe and then reinstalling them.

To remove the pump, turn the connector counterclockwise, and to reinstall it, turn the connector clockwise.

# Water Filling& Use of Essential Oil

---



- Add water without opening the cover.
- Add water from the water tank.

- ❶ Add water below 40°C to the water tank.
- ❷ Do not exceed the max water line.
- ❸ Do not let the water into the mist outlet to avoid machine failure.
- ❹ Do not add mineral water, plasma water, or tap water that has been left for a long time. If mold or impurities breed, it may cause health problems.
- ❺ When the water level is low, the machine will prompt for water shortage and shut down automatically. Refill the water and turn it back on.



- To use essential oils, click on the tray on the back of the machine, and it will pop out.
- ❶ Place a tissue or sponge underneath before adding essential oil.
- ❷ Do not put essential oil directly into the water tank or sink, as it may cause water leakage, deformation or failure.



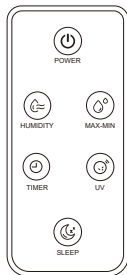



# Control Panel& Remote Control



Remote control



Display& buttons

 POWER	Touch the power button, the display lights up and the humidifier starts to work.
 HUMIDITY	The humidity setting range is 40-90%, and each touch increases by 5%. The humidifier will automatically stop spraying mist when the surrounding humidity reaches the set value.
 TIMER	The timer can be set for 1-12 hours, and each touch increases by 1 hour. The humidifier will shut down automatically when the time reaches the set value.
 MAX-MIN	The mist volume can be adjusted in four levels: low, medium, high.
 UV	Touch the UV button to turn on or off the UV sterilization function. A purple light in the water sink will appear when turning it on.
 SLEEP	Touch the sleep button to enter the sleep mode, and the display will be dimmed. Touch any button to exit sleep mode, and the display will light up.

- ❶ The operation of remote control is the same as the control panel.
- ❷ Please remove the insulating plastic sheet before using the remote control.
- ❸ When turning on the UV light, do not look directly for a long time, otherwise it may cause eye discomfort.

# Maintenance



## External

- Clean the external surface of the humidifier 1-2 times a week using a clean cloth to remove dust and dirt.
- If the dirt is stubborn, soak the cloth in a neutral detergent before wiping.
- Make sure the main body is completely dry before use.



## Water Sink& tank

- Clean the water sink and tank 1-2 times a week as water can cause minerals and organic matter to accumulate, affecting the function of the humidifier.
- Use a soft cloth or brush to clean the internal surfaces of the sink and tank.
- For stubborn dirt, soak the cloth in white vinegar or baking soda before wiping.

# Maintenance

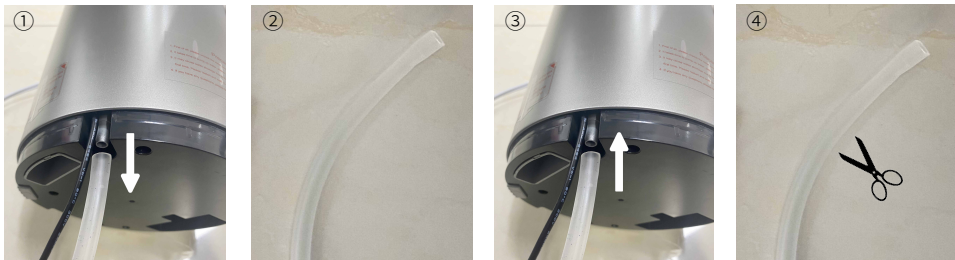

## Water Pump

If you notice sediment in the water pipe, you can clean it using a slim brush or contact our customer service to request a replacement. Follow these steps to clean or replace the water pipe:

1. Unplug the water pipe from the humidifier.
2. Clean the water pipe using a slim brush, or replace it if necessary.
3. Reinstall the water pipe by plugging it back into the humidifier.
4. If the water pipe is too long, you can cut it to a suitable length before reinstalling it.

### Note:

- ❶ Always disconnect the power plug before performing any maintenance on the humidifier.
- ❶ Do not directly flush the whole machine with water as this can cause short circuit and failure.
- ❶ Use mild detergent and make sure to remove any residue to avoid harm to health.
- ❶ If the humidifier will not be used for more than 24 hours, pour out the water from the tank and sink to avoid mold or impurities that may be harmful to health.

# FAQ

---

Q: Why doesn't the display light up after turning on the power?

A: It's possible that water has entered the circuit board. Air-dry the main body for one day. If it still can't be turned on, please contact customer service via email.

Q: Why is the red light flashing?

A: Open the sink and check whether the water can be pumped up.  
If not, disassemble the water pump and water pipe and install them again (see page 6). If neither of these is the issue, please contact customer service to get replacement pump via email.

Q: Why is the mist output low?

A: When the ambient humidity exceeds the set value, the machine will automatically stop spraying mist. However, if the atomizer is damaged, please contact customer service via email.

Q: Why is there abnormal noise?

A: There may be too little water in the tank or the humidifier may not be on a stable surface. Please fill the water and place the humidifier on a flat and stable surface.

Q: Why is the humidity value not consistent with the room humidity?

A: Ensure the humidity sensor is not blocked or wet. A difference of 5-10 degrees is within the normal range. If it's not within this range, please contact customer service via email.

# FAQ

---

Q: Why is there white powder around the humidifier?

A: Tap water contains minerals that can adhere to objects. Clean the water tank regularly and keep precision instruments away from the humidifier to avoid damage.

Q: Why is there scale in the water sink or tank?

A: Tap water contains minerals that can adhere to objects. Clean the water sink and tank regularly.

Q: Why is there interference with the TV remote control signal?

A: Keep the humidifier 1m away from the TV or other objects that emit radio waves.

Q: Why is the floor wet or there is water around the humidifier?

A: The humidity may be too high or the humidifier may be placed in a non-ventilated place, causing the mist to not fully evaporate.

Q: Why is the fire on the stove turning red?

A: The composition of tap water can react with the flame, so keep the humidifier away from the stove.



# Product Specifications

Product Name	Ultrasonic Humidifier
Model Number	LCDJSQ-022
Operation Mode	Low Medium High
Max Mist Output	300ml/h
Rated Power	28W
Noise	≤35dB
Coverage Area	500 sq.ft
Tank Capacity	2.1Gal / 8L
Size	(W)260mm × (D)260mm × (H)750mm
N.W.	2.2Kg
G.W.	3.2Kg
Safety Functions	1-12 hours Timer
	Waterless auto shut-off
	Automatic shutdown when falling



# Warranty

---

## Warranty Period

- ① Our company provides a one-year warranty, which starts from the date of purchase.
- ① When returning the product, please confirm that the product is intact, and the packing boxes and accessories are complete.

## Non-Warranty Policy

The following conditions are not covered by the warranty.

- ① Over the warranty period.
- ① Damage caused by natural disasters and other force majeure.
- ① Any damage caused by use not in accordance with the requirements in the User Manual.
- ① Failure or damage caused by forced use of the product.
- ① The user disassembles or repairs the product without authorization.

## Warranty Requirements

1. Please provide the warranty card and the order number.
2. Please describe the problems in details with pictures or videos.
3. Send e-mail to [info@acidoll.com](mailto:info@acidoll.com)

Sorry that warrant service would not be available if you are unable to provide the above information.

