

# Series 9, Integrated Double DishDrawer Dishwasher

Series 9 | Integrated



Integrating into your kitchen design seamlessly, each drawer fits a half load that you can load and wash independently.

- Knock to pause function is perfect if you miss a dish
- Six wash programs, as well as additional Quick wash, Sanitise and Extra Dry options
- Flexible racking can be folded down to fit bigger dishes
- Customise with your own front panel and handle to match your kitchen cabinetry, or choose our stainless steel panel

## DIMENSIONS

Height	820 - 880 mm
Width	599 mm
Depth	553 mm

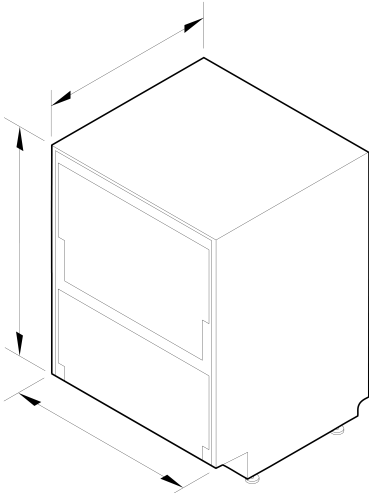

## FEATURES & BENEFITS

### SEAMLESS INTEGRATION

Slide your DishDrawer™ Dishwasher into an existing kitchen space or integrate into kitchen cabinetry, for a seamless look whilst delivering superior dish care.

### Ease Of Use

DishDrawer™ Dishwashers are as easy to open and close as kitchen drawers, making loading dishes simple. Flexible racking allows you to make adjustments to fit in a variety of dishes.

### Independent Wash

With the ability to use both drawers independently and select different wash programs the DishDrawer™ Dishwasher can wash everything from fine glass and crystal to heavily soiled pots and pans.

### TRUE HALF LOAD

Each drawer holds a true half load for guilt-free small washes and fast turnaround of your dishes. Both drawers operate independently so different wash cycles can run simultaneously to accommodate a variety of loads.

### Quick, Sanitise And Extra Dry Options

The Quick wash modifier delivers a faster wash while maintaining performance. The Sanitise option provides extra protection killing 99.9% of bacteria in the final rinse. The Extra Dry setting is perfect for plastic dishes.

### KNOCK TO PAUSE

These DishDrawer™ Dishwashers have a knock to pause function. A knock on the front panel will pause the dishwasher which can be re-started again by using the start/play button.

### QUIET PERFORMER

Running at a very low decibel rating, these DishDrawer™ Dishwashers do their job without making a fuss. The combination of intelligent technology and simple mechanics means greater reliability and excellent wash performance.

## SPECIFICATIONS

### Accessories (included)

Cutlery basket	•
Kickstrip	true

Knife clip and multipurpose clip	•	Water usage (per wash cycle)	7.8L per drawer	Supply voltage	220 - 240V
Accessories (sold separately)		Controls		Product dimensions	
Door panel black stainless steel	ADDD60DPB	Electronic fault/Diagnostic indicator	•	Depth	553 mm
Door panel recessed handle black stainless steel	ADDD60DNB	End of cycle beeps	•	Height	820 - 880 mm
Door panel recessed handle matte black glass	ADDD60DZB	Energy saving delay start option of up to 12 hours	•	Width	599 mm
Door panel recessed handle stainless steel	ADDD60DNX	Internal wash selector	•	Wash Program Modifiers	
Door panel stainless steel	ADDD60DPX	Keylock	•		
Handle kit Contemporary round, aluminium	AHS-OBDD-60S	Knock to pause	•		
Handle kit Contemporary square fine, aluminium	AHD5-OBDD-60SX	Rinse aid indicator light	•		
Handle kit Contemporary square fine, black	AHD5-OBDD-60SB	Smart appliance	•		
Handle kit Contemporary square, aluminium	AHD3-OBDD-60S	Features		Wash Programs	
Handle kit Contemporary square, black	AHD3-OBDD-60B	Built-in water softener	•		
Capacity and loading		Fan assisted drying	•		
Accommodates round plates up to	280mm	Flood protection	•		
Adjustable height, foldable cupracks	•	Flow through detergent dispenser	•		
Fold down tines	•	Motor type	BLDC	Delicate	•
Pitch adjustable tines	•	Quiet operation	•	Eco	•
Place settings	12	SmartDrive™ technology	•	Fast	•
Place settings per drawer	6	Performance		Heavy	•
Consumption		Noise on standard cycle top drawer	43 dBA	Medium	•
Energy rating	E	Power requirements		Rinse	•
Energy usage	54kWh/100 cycles per drawer	Amperage	10A	Wash programs	6
		Supply frequency	50Hz	Water connection	
				Water pressure	100kPa - 1000kPa
				Water supply	3/4" BSP (20mm) Connector Water Inlet Hose

SKU 82360

The product dimensions and specifications in this page apply to the specific product and model. Under our policy of continuous improvement, these dimensions and specifications may change at any time. You should therefore check with Fisher & Paykel's Customer Care Centre to ensure this page correctly describes the model currently available. © Fisher & Paykel Appliances Ltd 2020

Other product downloads available at fisherpaykel.com

- ↓ DWG
- ↓ 2D-DXF Integrated Double DishDrawer™ Dishwasher
- ↓ DXF
- ↓ Energy Label DishDrawer™ Dishwasher
- ↓ Installationsvejledning DA
- ↓ Installationsanleitung DE
- ↓ Installatiehandleiding NL
- ↓ Installation Guide EN
- ↓ Asennusopas FI
- ↓ Guide d'installation FR
- ↓  HE
- ↓ Guida D'Installazione IT
- ↓ Installasjonsveiledning NOR
- ↓ Guía de instalación ES
- ↓ Installationsguide SV
- ↓ Planning Guide (English)
- ↓ Product Information Sheet Double DishDrawer™ Dishwasher
- ↓ Quick Start Guide DishDrawer™ Dishwasher EN
- ↓ Quick Start Guide DishDrawer™ Dishwasher DUT
- ↓ Quick Start Guide DishDrawer™ Dishwasher ES
- ↓ Quick Start Guide DishDrawer™ Dishwasher FIN
- ↓ Quick Start Guide DishDrawer™ Dishwasher HEB
- ↓ Quick Start Guide DishDrawer™ Dishwasher ITA

- ↓ Revit
- ↓ Rhino
- ↓ SketchUp
- ↓ User Guide Integrated DishDrawer™ Dishwasher
- ↓ Wash Program Data DishDrawer™ Dishwasher EN
- ↓

Where applicable:

All appliances use energy, and energy usage typically generates carbon emissions. **Fisher & Paykel Appliances' In-use Energy Carbon Emissions Estimate** indicates carbon emissions from a product's in-use energy. This is calculated either annually or per cycle, using the product's market-specific energy label energy consumption data multiplied by the carbon emissions factor for energy in your country or region.

Our In-use Energy Carbon Emissions Estimate is designed to assist customers in making informed purchasing decisions when comparing different Fisher & Paykel products. For example, a heat pump dryer typically has a lower In-use Energy Carbon Emissions Estimate than a vented dryer.



**A PEACE OF MIND SALE**  
**24 Hours 7 Days a Week Customer Support**  
T 08000886605 W [www.fisherpaykel.com](http://www.fisherpaykel.com)