

MOBILE TV FLOOR STAND

(SUITABLE FOR 37-86" TVS)

KATVSFWS86A

SAFETY & WARNINGS

Read the entire user guide before you start installation and assembly. If you have any questions regarding any of the instructions or warnings, contact your local distributor for assistance.

CAUTION: Use with products heavier than the rated weights indicated may result in instability causing possible injury.

- Please closely follow the assembly instructions. Improper installation may result in damage or serious personal injury.
- Safety gear and proper tools must be used. This product should only be installed by professionals.
- This product is designed to be installed on solid concrete walls, masonry walls or wood stud walls.
- Make sure that the supporting surface will safely support the combined weight of the equipment and all attached hardware and components.
- Use the mounting screws provided and **DO NOT OVER TIGHTEN** mounting screws.
- This product contains small items that could be a choking hazard if swallowed. Keep these items away from children.
- This product is intended for indoor use only. Using this product outdoors could lead to product failure and personal injury.
- Never exceed the maximum load capacity of 50kg (TV), 5kg (media shelves) or it may result in product failure or personal injury.

IMPORTANT: Ensure that you have received all parts according to the component checklist prior to installation. If any parts are missing or faulty, contact your place of purchase for a replacement.

MAINTENANCE: Check that the product is secure and safe to use at regular intervals (at least every three months).

VESA Compatible
200x200 300x200
400x200 300x300
400x300 400x400
400x600



COMPONENTS



A (x1)



B (x1)



C (x1)



D (x1)



E (x1)



F (x1)

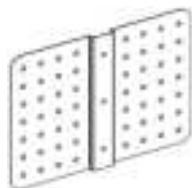

G (x1)



H (x2)



I (x4)



J Cable Ties (x5)



K M6x8 (x2)



L M6x8 Screw (x2)



M M6x12 Screw (x4)



N M6x16 Screw (x4)

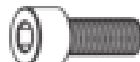

O M8x20 Hex Screw (x3)



P M8x75 Hex Screw (x2)



Q D8 Washer (x3)



R M8 Nut (x2)



S Allen Key 3mm (x1)



T Allen Key 4mm (x1)



U Allen Key 6mm (x1)



V Open Spanner
10-13mm (x1)



M-A M6x14
Screw (x4)



M-B M8x16
Screw (x4)



M-C M6x30
Screw (x4)



M-D M8x35 Screw (x4)



M-E D8 Washer (x4)



M-F Spacer (x4)



M-G Spacer (x4)

ASSEMBLY

Step 1:

Note: 2 people recommended for this step.

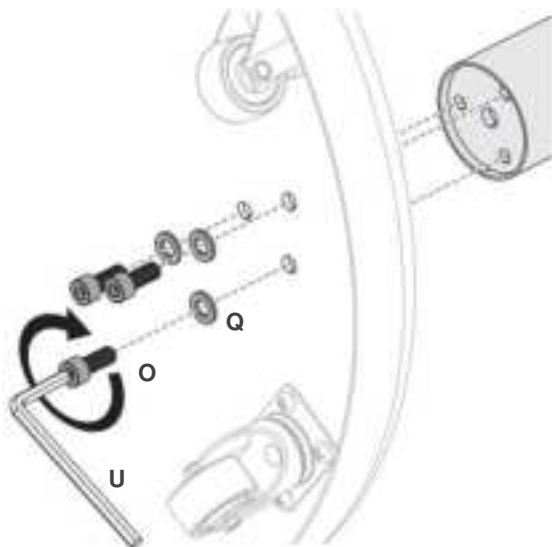
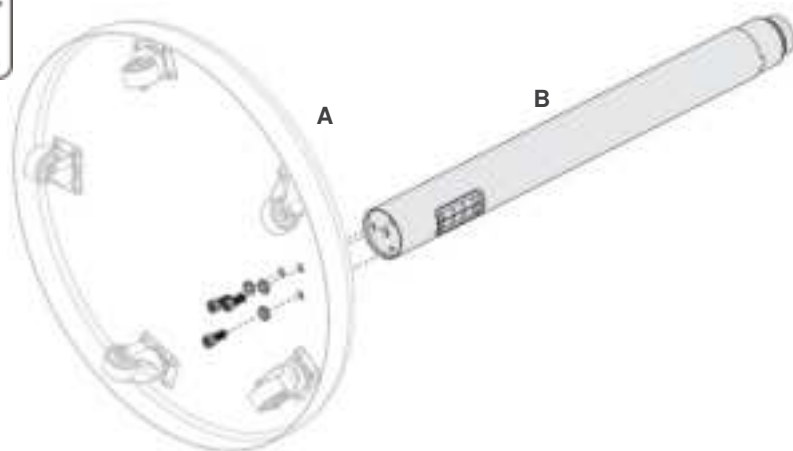

Step 2:

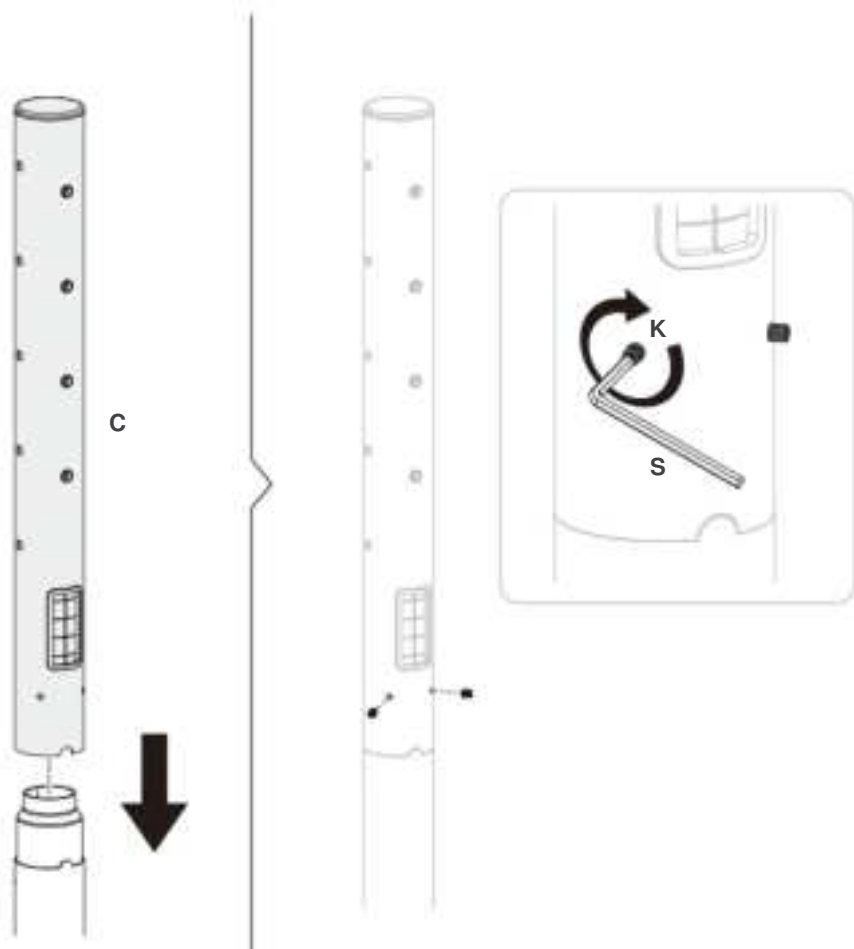

Step 3:

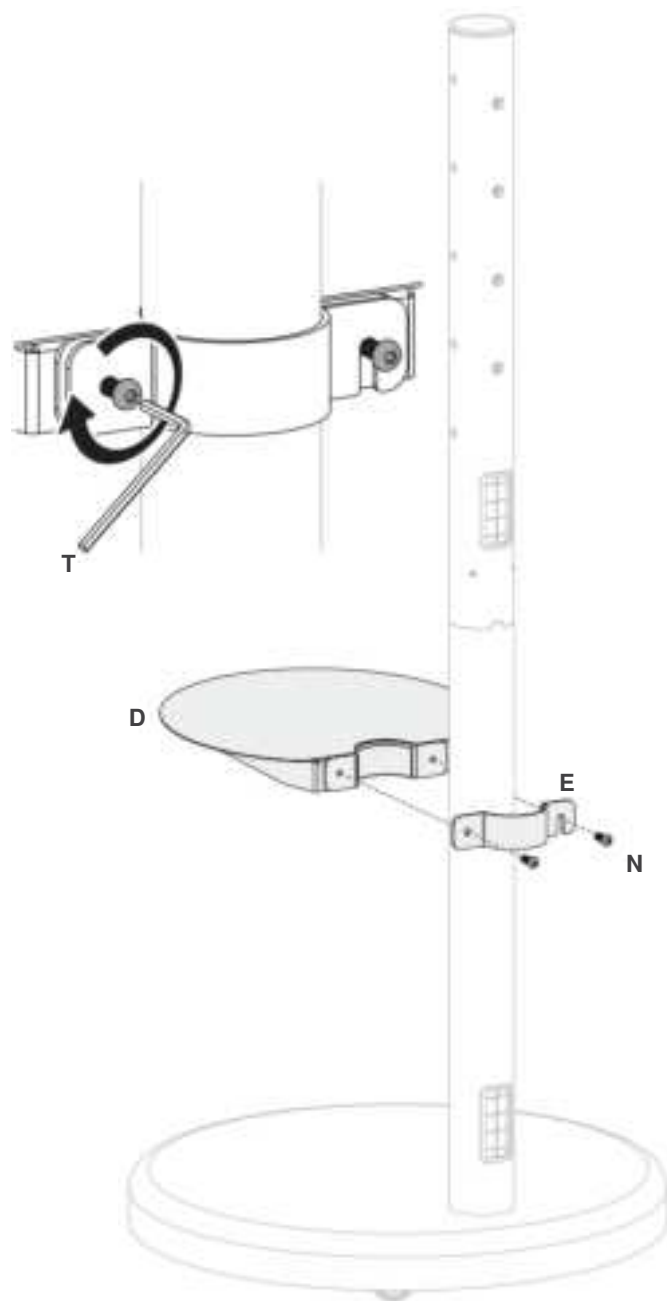

Step 4:

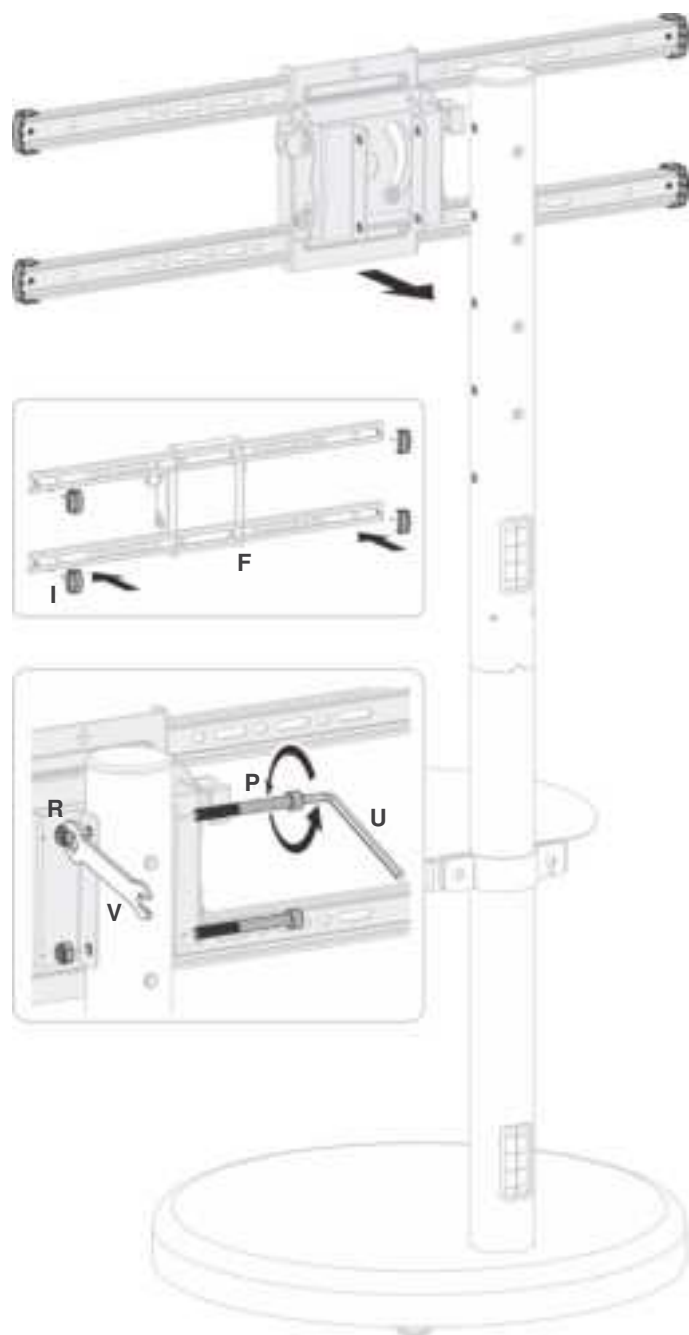

Step 5:

Align the brackets **(H)** with your TV's VESA holes and secure using supplied screws **(M-A)** set, Washer **(M-E)** and spacers **(M-F, M-G)** depending on required length.

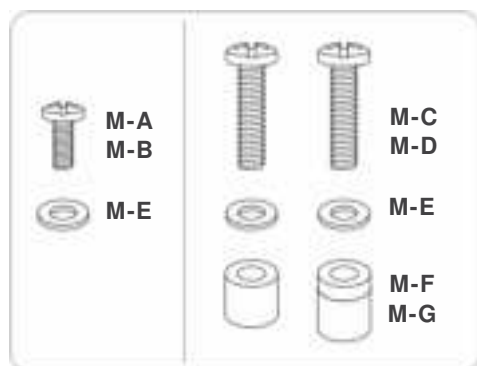
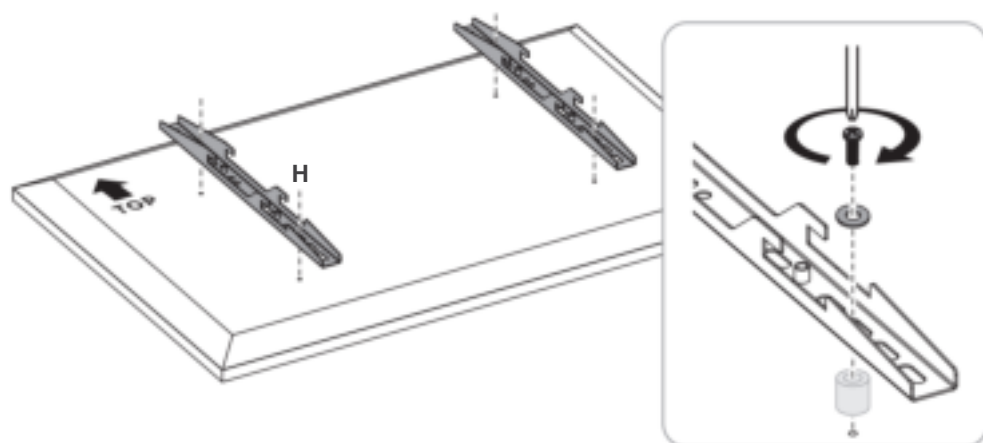

Step 6:

Hook the TV with brackets installed onto the floor mount. 2 people should carry the TV to prevent damage.

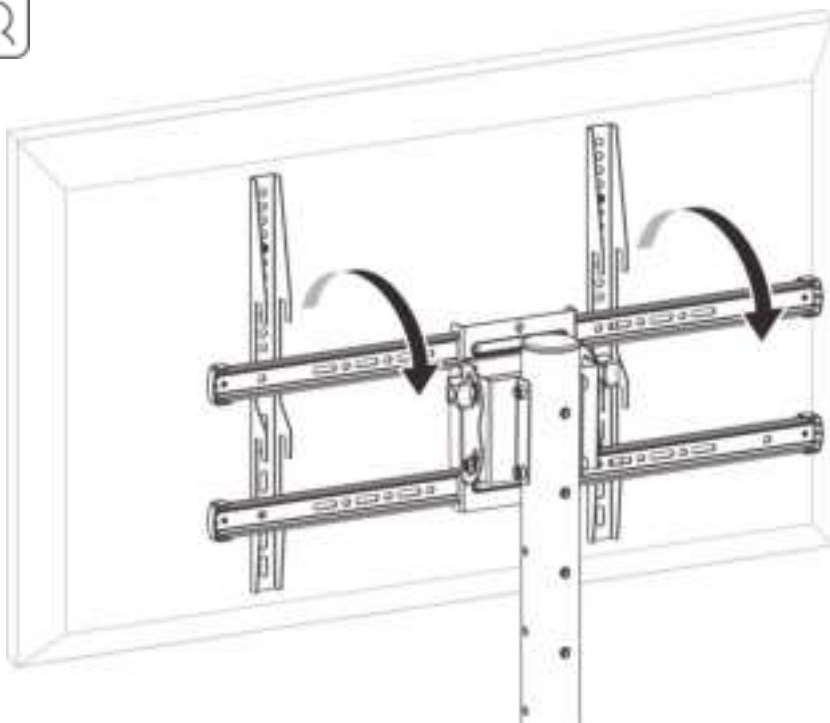

Step 7:

Once in place, fasten the 4 M6x12 Screws (**M**) to secure the brackets in place.

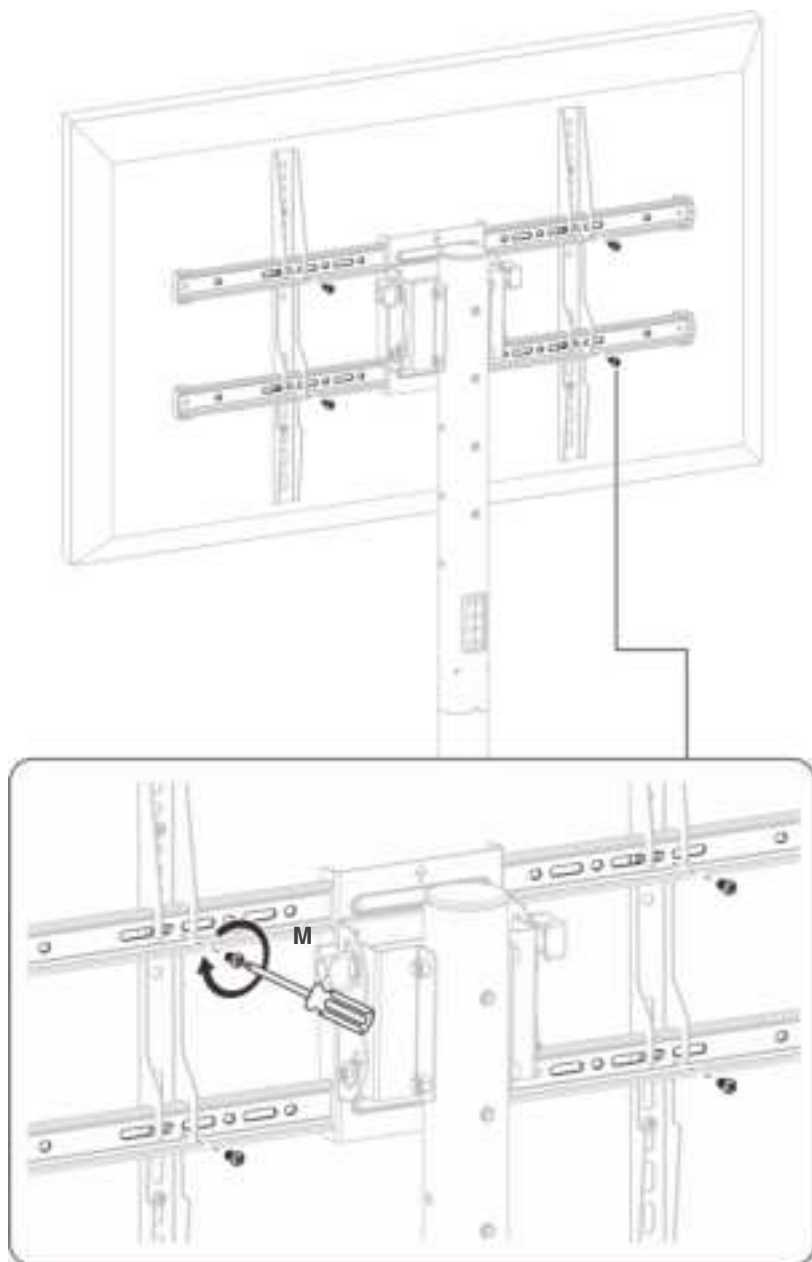

Step 8 : Adjusting the Vertical Tilt

Loosen the 4 Allen screws slightly and adjust the vertical tilt of the TV.



Note:

If the display does not stop at your desired position, adjust the screws as shown.

Step 9: Rotating the TV (Portrait/ Landscape mode)

- To keep the TV in landscape mode, secure it in place using the 2 M6x8 Screws (L).
- To switch the TV to portrait mode, rotate the TV 90° and secure it in place using the 2 M6x8 Screws (L).



0°

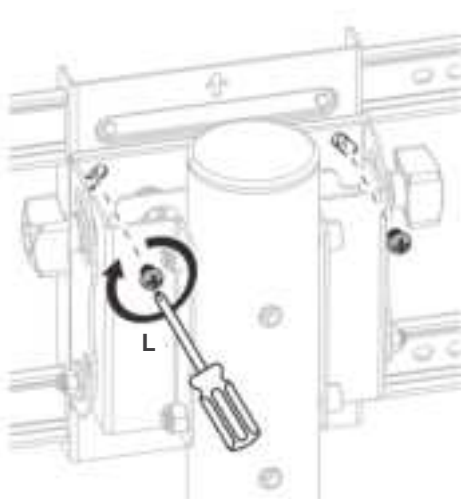

90°

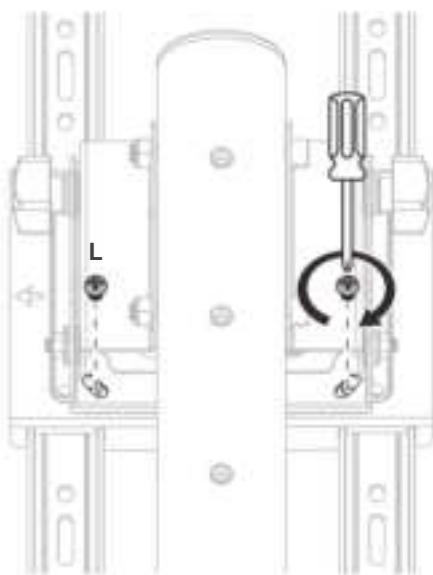

Step 10:

Secure the backing plate (**G**) in place using the 2 M6x16 Screws (**N**).

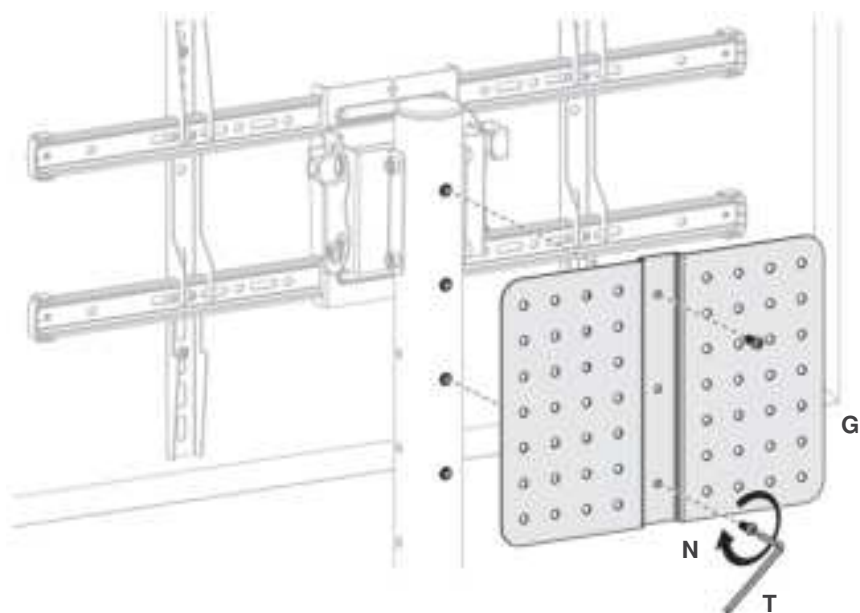

Step 11:

- Use the cable ties (**J**) to secure a power board or other accessories to the backing plate (**G**) on the rear of the TV.
- Route cables through the floor mount's vertical stand.

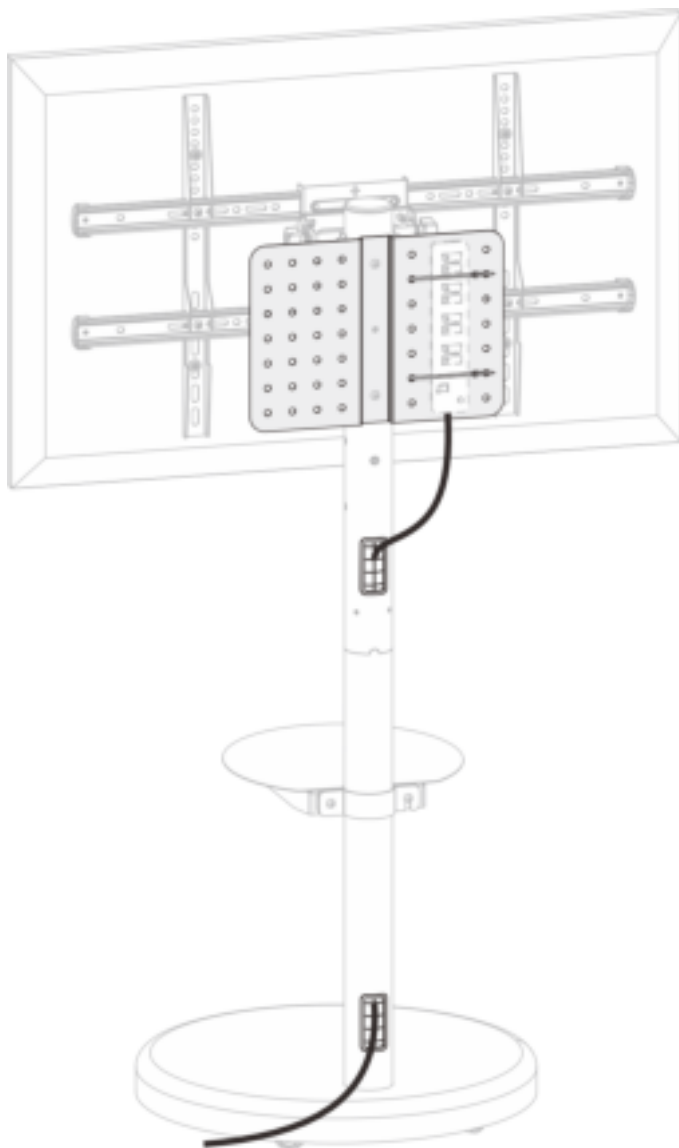

Need more information?

We hope that this user guide has given you the assistance needed for a simple setup.

For the most up-to-date guide for your product, as well as any additional assistance you may require, head online to help.kogan.com

kogan.com