

# MOBILE TV FLOOR STAND

(SUITABLE FOR 37-86" TVS)

KATVSFWS86A

# SAFETY & WARNINGS

Read the entire user guide before you start installation and assembly. If you have any questions regarding any of the instructions or warnings, contact your local distributor for assistance.

**CAUTION:** Use with products heavier than the rated weights indicated may result in instability causing possible injury.

- Please closely follow the assembly instructions. Improper installation may result in damage or serious personal injury.
- Safety gear and proper tools must be used. This product should only be installed by professionals.
- This product is designed to be installed on solid concrete walls, masonry walls or wood stud walls.
- Make sure that the supporting surface will safely support the combined weight of the equipment and all attached hardware and components.
- Use the mounting screws provided and **DO NOT OVER TIGHTEN** mounting screws.
- This product contains small items that could be a choking hazard if swallowed. Keep these items away from children.
- This product is intended for indoor use only. Using this product outdoors could lead to product failure and personal injury.
- Never exceed the maximum load capacity of 50kg (TV), 5kg (media shelves) or it may result in product failure or personal injury.

**IMPORTANT:** Ensure that you have received all parts according to the component checklist prior to installation. If any parts are missing or faulty, contact your place of purchase for a replacement.

**MAINTENANCE:** Check that the product is secure and safe to use at regular intervals (at least every three months).

VESA Compatible  
200x200 300x200  
400x200 300x300  
400x300 400x400  
400x600



50kg/110lbs



5kg/11lbs

# COMPONENTS

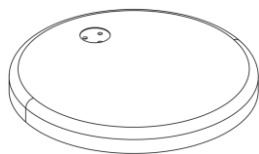

A (x1)

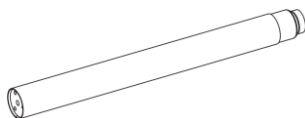

B (x1)

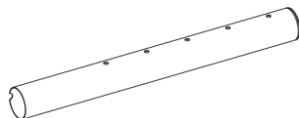

C (x1)



D (x1)

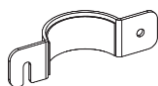

E (x1)



F (x1)

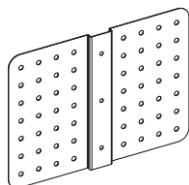

G (x1)

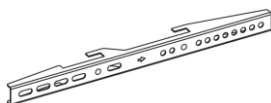

H (x2)



I (x4)

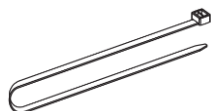

J Cable Ties (x5)



K M6x8 (x2)



L M6x8 Screw (x2)



M M6x12 Screw (x4)



N M6x16 Screw (x4)

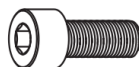

O M8x20 Hex Screw (x3)

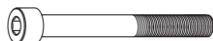

P M8x75 Hex Screw (x2)



Q D8 Washer (x3)



R M8 Nut (x2)



S Allen Key 3mm (x1)



T Allen Key 4mm (x1)



U Allen Key 6mm (x1)



V Open Spanner  
10-13mm (x1)

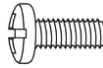

**M-A** M6x14  
Screw (x4)



**M-B** M8x16  
Screw (x4)



**M-C** M6x30  
Screw (x4)



**M-D** M8x35 Screw (x4)



**M-E** D8 Washer (x4)



**M-F** Spacer (x4)



**M-G** Spacer (x4)

# ASSEMBLY

Step 1:

Note: 2 people recommended for this step.

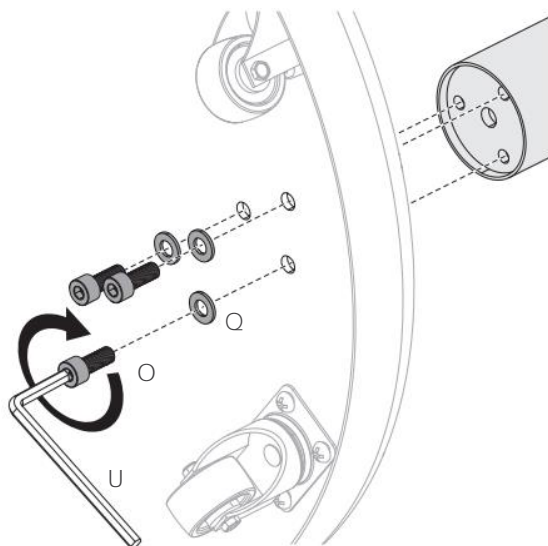
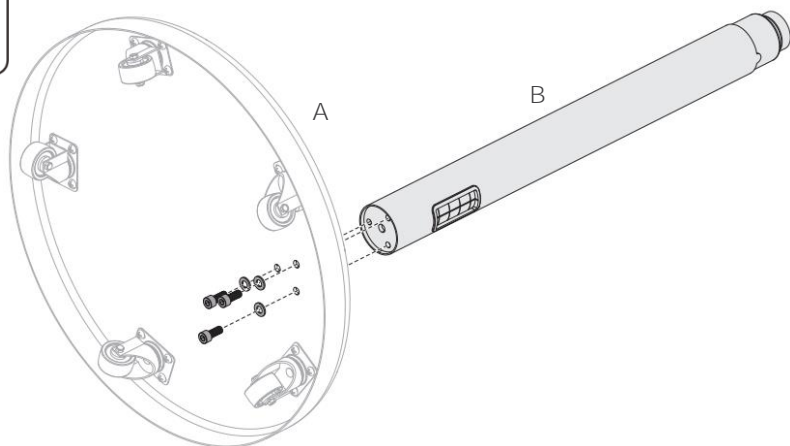

Step 2:

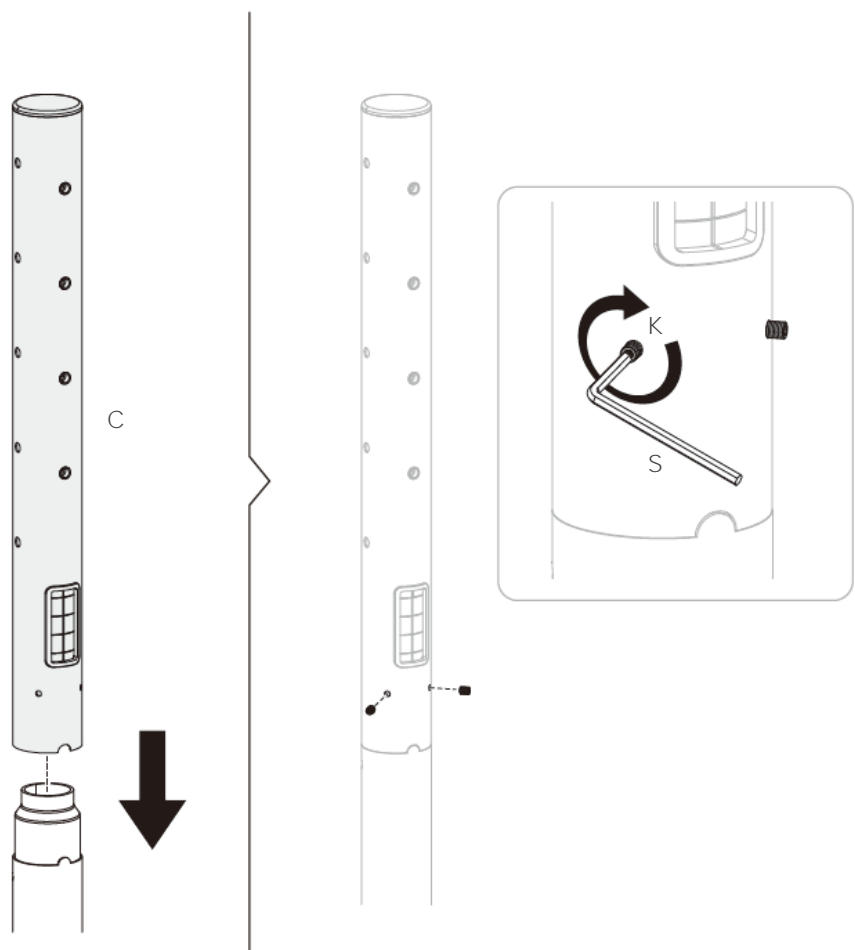

Step 3:

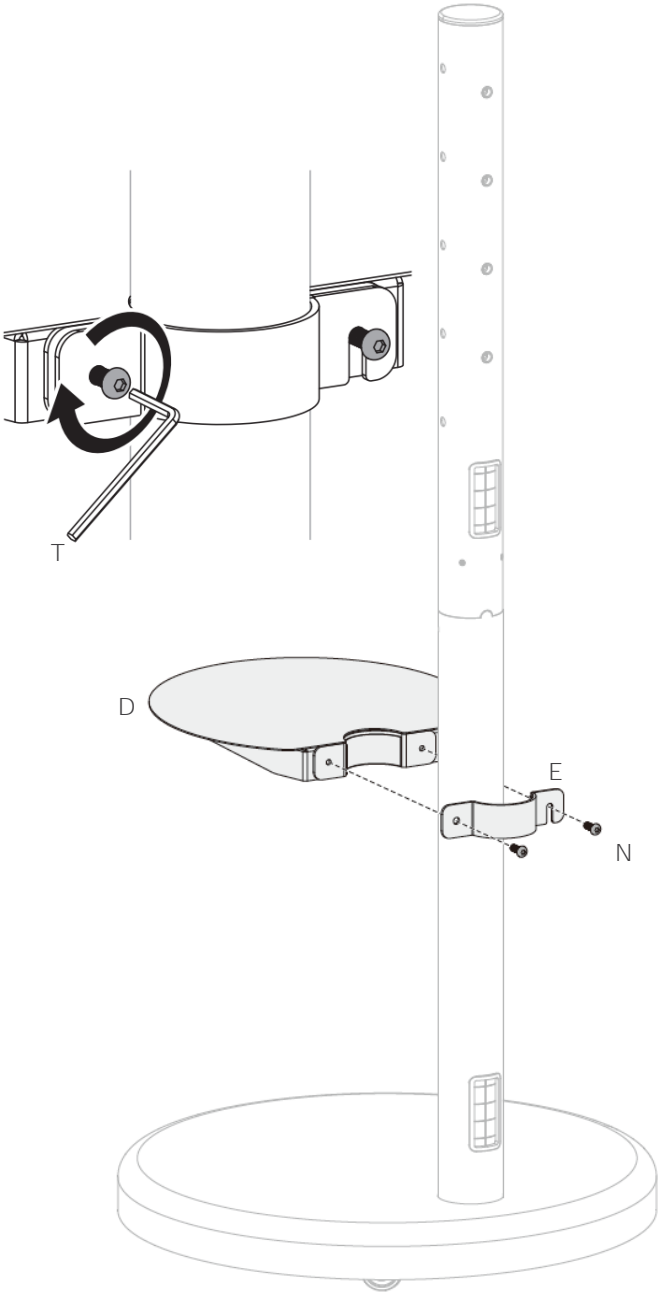

Step 4:

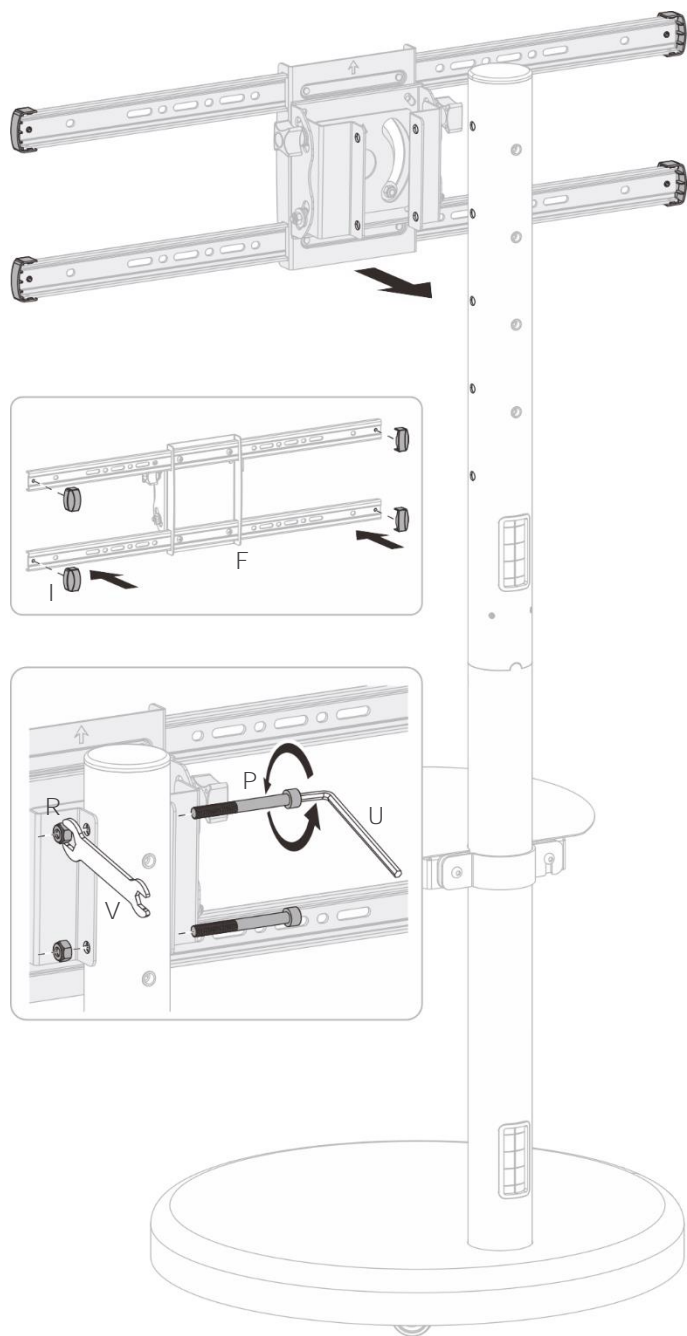



Step 5:

Align the brackets **(H)** with your TV's VESA holes and secure using supplied screws **("M-"** set), Washer **(M-E)** and spacers **(M-F, M-G)** depending on required length.

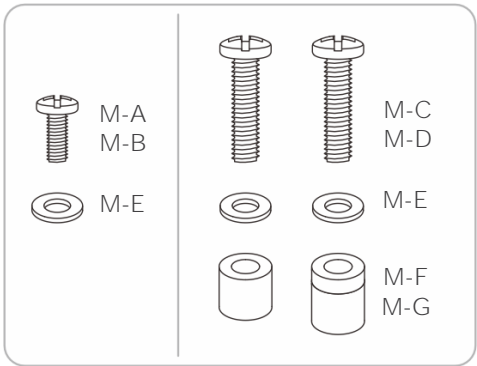
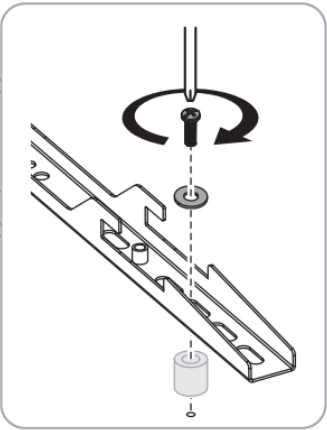
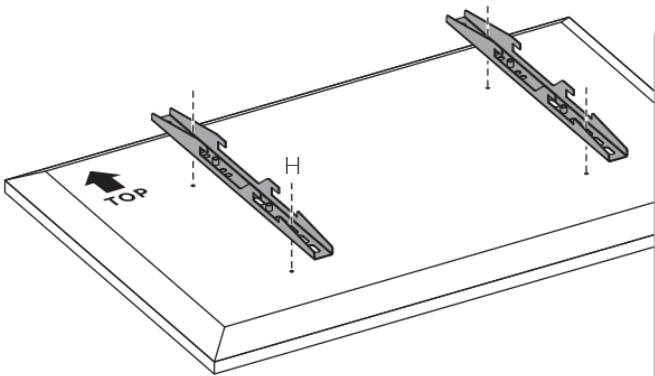
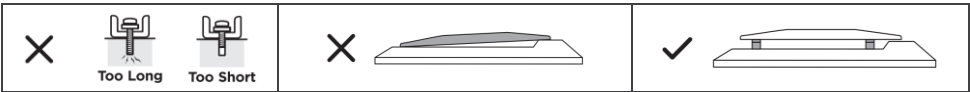

Step 6:

Hook the TV with brackets installed onto the floor mount. 2 people should carry the TV to prevent damage.

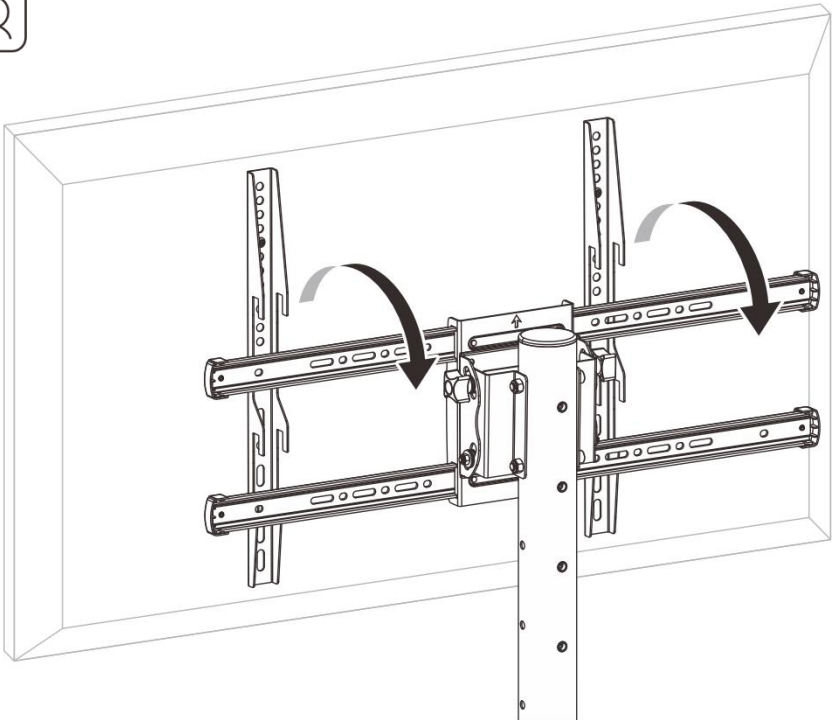

Step 7:

Once in place, fasten the 4 M6x12 Screws (M) to secure the brackets in place.

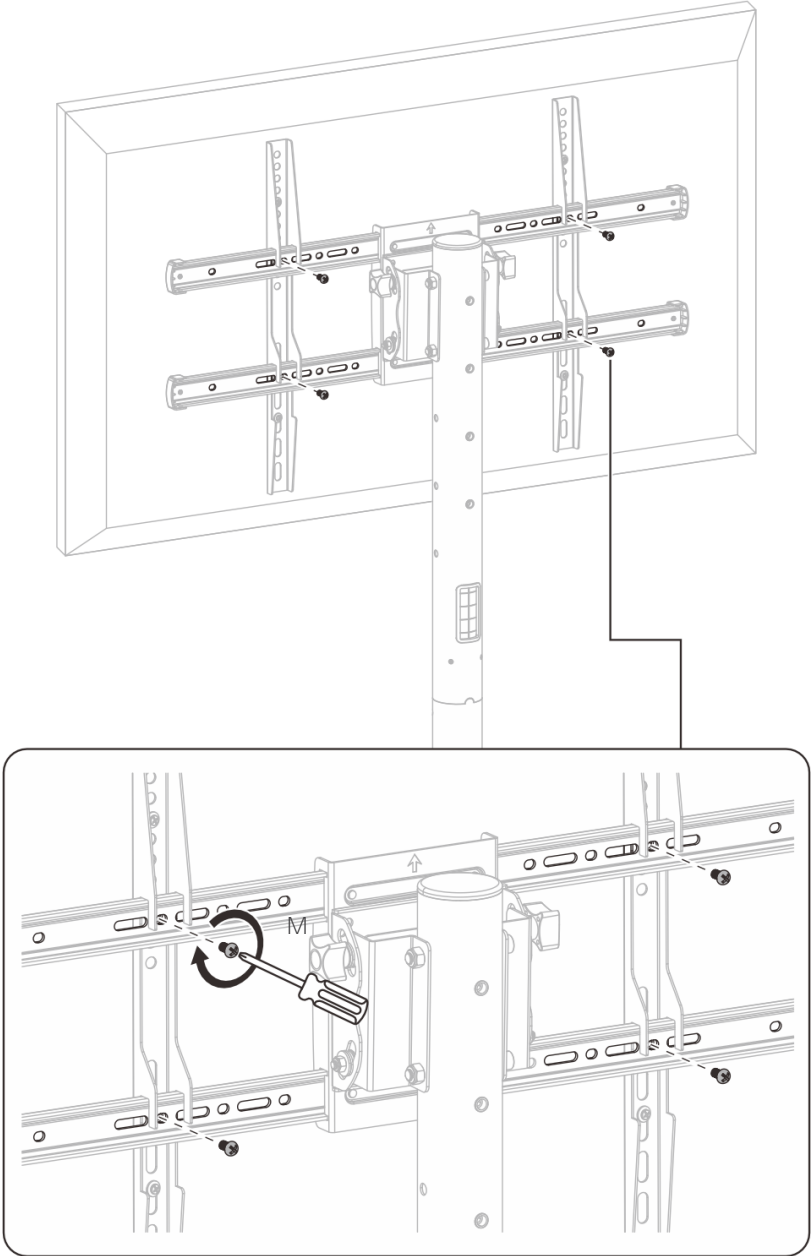

Step 8: Adjusting the Vertical Tilt

Loosen the 4 Allen screws slightly and adjust the vertical tilt of the TV.

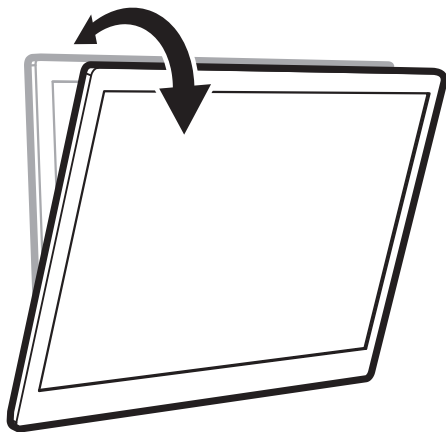
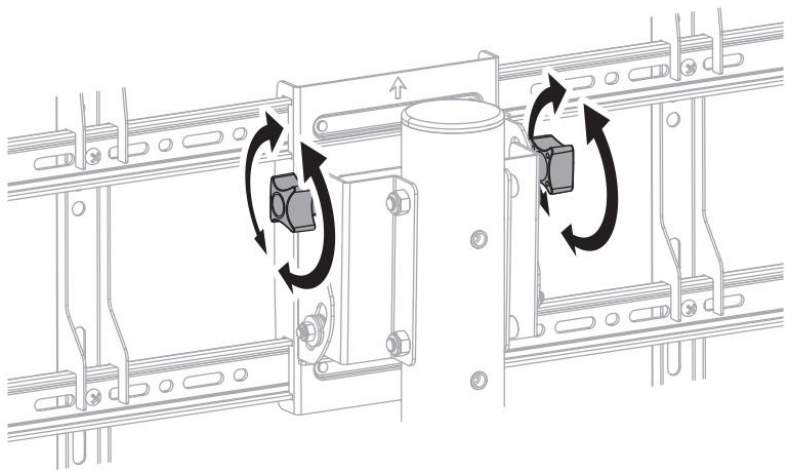

Note:

If the display does not stop at your desired position, adjust the screws as shown.

### Step 9: Rotating the TV (Portrait/Landscape mode)

- To keep the TV in landscape mode, secure it in place using the 2 M6x8 Screws (L).
- To switch the TV to portrait mode, rotate the TV 90° and secure it in place using the 2 M6x8 Screws (L).

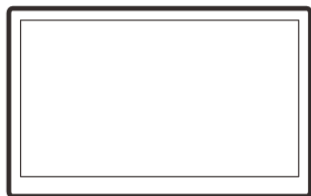

0°

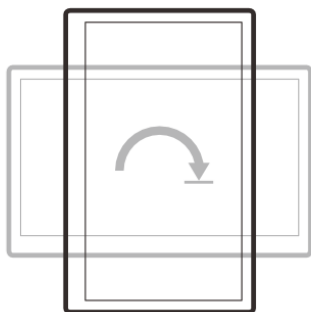
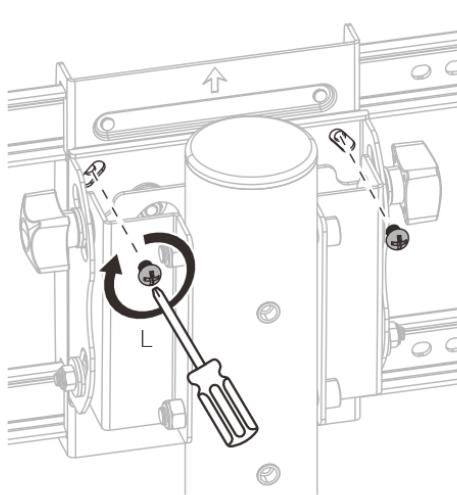

90°

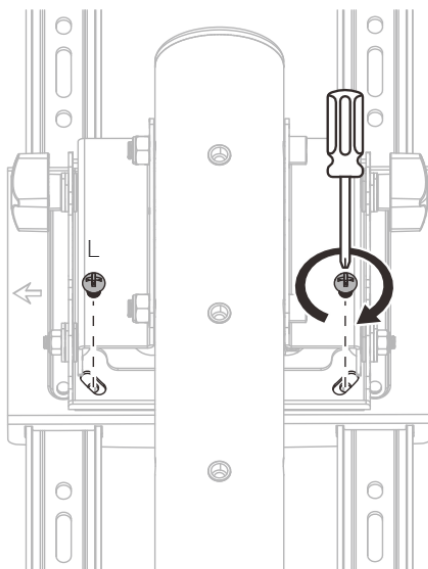

Step 10:

Secure the backing plate (G) in place using the 2 M6x16 Screws (N).

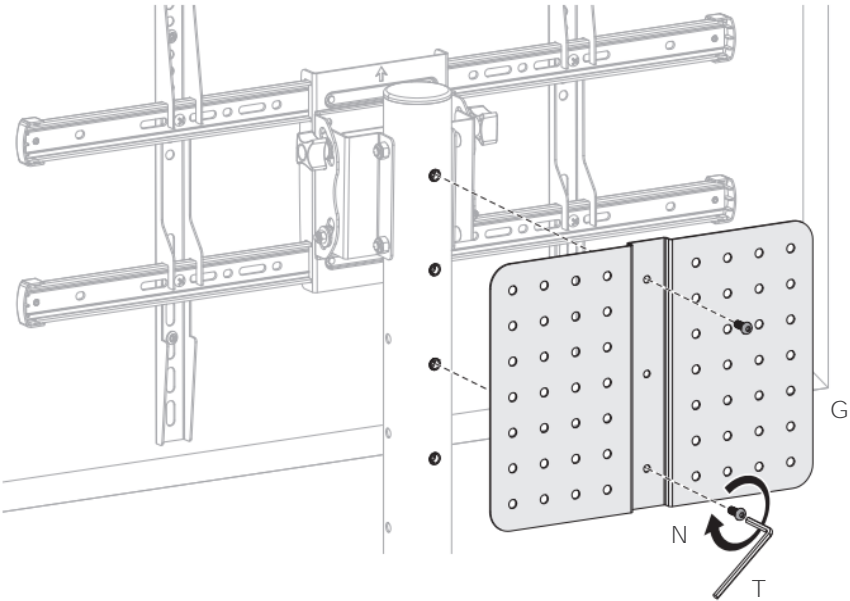

Step 11:

- Use the cable ties (J) to secure a power board or other accessories to the backing plate (G) on the rear of the TV.
- Route cables through the floor mount's vertical stand.

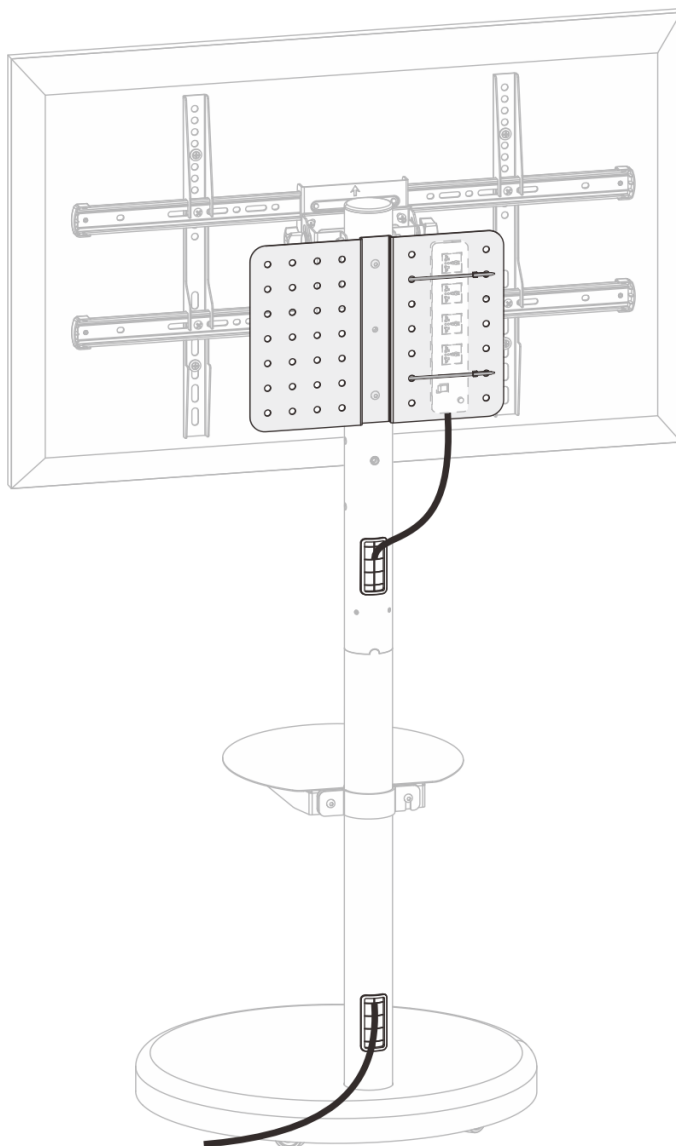

Need more information?

We hope that this user guide has given you  
the assistance needed for a simple set-up.

For the most up-to-date guide for your product,  
as well as any additional assistance you may require,  
head online to **help.kogan.com**

kogan.com