



# User Manual

Model: H5151,H5100

Smart Thermo-Hygrometer



English

01

Français

11

日本語

21

## At a Glance

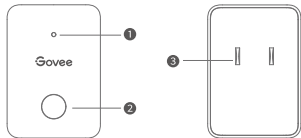

Wi-Fi Gateway

① Indicator Light

③ Power Prongs

② Function Button

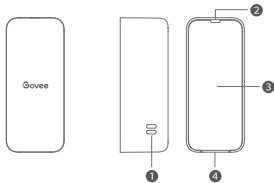

Thermo-Hygrometer

① Sensor Hole

② Lanyard Hole

③ Battery  
Compartment Cover

④ Open Slot

## Included in the Box

Item	B5151103	B5151104
Wi-Fi Gateway	1	1
Thermo-Hygrometers / Sensors	3	6
AAA Batteries (pre-installed)	3	6

Item	B5151103	B5151104
Lanyards	3	6
Label with Serial Numbers	1	1
User Manual	1	1

## LED Indicator Status Guides (For H5151 Wi-Fi Gateway Only)

Working Status	Indicator Status
Powered for the First Time	Slowly Flashes Red and Blue
Searching and Connecting to Wi-Fi	Quickly Flashes Blue

Working Status	Indicator Status
Wi-Fi Connected	Solid Blue
Wi-Fi Connection Failed	Solid Red

## Govee Home App

You can access more features using Govee Home App.

### Downloading Govee Home App

To download Govee Home App, scan the QR code or search for “Govee” in the Apple App Store® (iOS) or Google Play Store (Android).



Govee Home App



#### Note:

- Choose “Allow” to the permissions requested when opening Govee Home App for the first time. These permissions allow the app’s features to function normally and are not used to record personal, private information.
- Due to ongoing updates, Govee Home App may be slightly different than shown in this manual. In case of any differences, always follow the in-app instructions.

## Pairing with Govee Home App

### 1 Add the Wi-Fi Gateway

#### Note:

Make sure your 2.4GHz Wi-Fi network is functioning properly before pairing the Wi-Fi Gateway to the network.

- Turn on the Bluetooth on your phone and place it close to the Wi-Fi Gateway (Location Services/GPS should be turned on for Android users).
- Open Govee Home App, tap the "+" icon at the top right corner and select "H5151".
- Follow the in-app instructions to complete pairing.
- The Wi-Fi Gateway icon will show in the top left corner on the "My Devices" page when pairing is completed.
- Please check the above steps and try again if pairing fails.

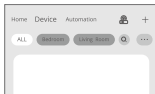

## ② Add the Thermo-Hygrometer (H5100)

- Pull out the battery insulator tab from the thermo-hygrometer.
- Stick the numbered stickers to the thermo-hygrometers for classification purpose (optional).
- Turn on the Bluetooth on your phone and place it close to the thermo-hygrometer (Location Services/GPS should be turned on for Android users).
- Open Govee Home, tap the "+" icon at the top right corner and select "H5100".
- Follow the in-app instructions to complete pairing. It is recommended to name the thermo-hygrometer with a corresponding number. For example, "②kitchen".
- Repeat the steps above to add other thermo-hygrometers.

### Note:

- Please check the above steps and try again if the pairing fails.
- If multiple sensors are found in the process of pairing, please keep those sensors that do not need to be paired away from the phone. When the sensor that needs to be paired is close to the phone, the name of corresponding sensor will flash.

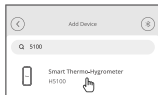
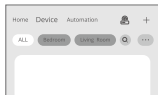



### 3 Pairing Sensors with the Wi-Fi Gateway

- Tap "📶" at the top right corner.
- Tap on your gateway.
- Add a new sub-device.
- Tap "⊕" to add sensor and "✓" to save.
- Pairing is successful when the "📶" icon appears.

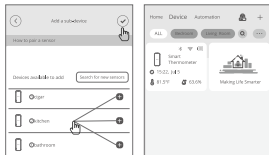

## Installing Your Device

- Remove the battery compartment cover from the open slot.
- Put the lanyard through the lanyard hole.
- Close the back cover.

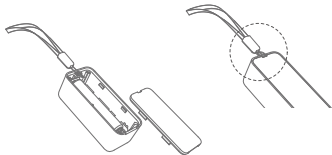

## Specifications

Thermo-Hygrometers	
Accuracy	Temp: $\pm 0.54^{\circ}\text{F}$ / $\pm 0.3^{\circ}\text{C}$ Humidity: $\pm 3\%$
Operating Temp	$-4^{\circ}\text{F}$ to $140^{\circ}\text{F}$ ( $-20^{\circ}\text{C}$ to $60^{\circ}\text{C}$ )
Operating Humidity	0 to 99%
Communication Distance (between the phone or the Wi-Fi Gateway)	230 feet / 70 m

Wi-Fi Gateway	
Input	100-240V~ 50/60Hz
Wi-Fi Frequency	2.4GHz
Max Amount of Connected Thermo-Hygrometers	10
Communication Distance (between the router)	328 feet / 100 m

### Note:

The communication distance will be shorter if there are obstacles in real circumstances. Please try to reduce barriers such as metal doors or thick walls.

## Troubleshooting

- ❶ The Wi-Fi gateway could not be connected to the Wi-Fi network or the connection is unstable.
  - Product supports only 2.4 GHz (not 5 GHz) Wi-Fi networks.
  - Check the name of the network and the password. Please try to avoid special characters.
  - The device should be placed within the coverage of the router signal. Please keep the distance between the gateway and the router within 100 meters (328ft).
  - Reduce barriers like metal doors or multiple thick walls.
- ❷ The thermo-hygrometer does not work & the thermo-hygrometer can not be found on the app.
  - Pull out the plastic insulator tab before using.
  - Check the battery condition or replace with a new one if necessary.
  - Keep the smartphone close to the thermo-hygrometer.
  - Shorten the distance and reduce the barriers between the thermo-hygrometer and Wi-Fi gateway.

- ③ The notification alert is delayed or there is no alert.
  - Turn on the relevant permissions for Govee Home App.
  - Shorten the distance and reduce the barriers between the thermo-hygrometer and the Wi-Fi gateway.
- ④ The thermo-hygrometer's readings are faulty or the thermo-hygrometer is disconnected.
  - Shorten the distance and reduce the barriers between the thermo-hygrometer and the Wi-Fi gateway.
  - Unpair all the H5100 thermo-hygrometers from the device list in the app and then pair again.
  - Replace the battery.

## Warning

- The thermo-hygrometer is rated to work in environments with temperatures ranging from 14°F to 140°F (-10°C to 60°C) and humidity from 0%RH to 99%RH.
- Please always handle these devices with care and do not attempt to disassemble.
- Do not immerse these devices in water.

## Customer Service

 Warranty: 12-Month Limited Warranty

 Support: Lifetime Technical Support

 Email: support@govee.com

 Official Website: [www.govee.com](http://www.govee.com)

 @Govee  @govee\_official  @govee.official

 @Goveeofficial  @Govee.smarthome