

91 CM SEALED BURNER RANGETOP - 4 BURNERS AND INFRARED  
TEPPANYAKI



ICBSRT364G



FEATURES

- Signature red infinite control knobs
- 4 dual-stacked burners plus powerful infrared teppanyaki
- Dual-stacked burners go from a powerful sear down to a mere breath of flame
- Heavy-gauge stainless steel
- Spark ignition system re-ignites if flame goes out
- Continuous cast-iron grates for easy movement of pots and pans
- Rigorously tested

ACCESSORIES

- 2-Burner Wok Grate
- 13 cm and 25 cm stainless steel risers, and 51 cm riser with shelf
- Signature red, black or stainless steel control knobs



KNOB OPTIONS



TOP CONFIGURATION

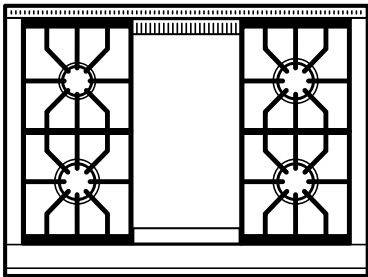

RANGETOP SPECIFICATIONS

- Stainless-steel island trim (included)
- Stainless-steel bezels
- 1 - 15.5 MJ/h Teppanyaki
- 1 - 9 MJ/h Burner
- 3 - 13 MJ/h Burners



PRODUCT SPECIFICATIONS

Model	ICBSRT364G
Dimensions	911mmW x 216mmH x 724mmD
Weight	100 kg

**NOTE:** Dimensions in parenthesis are in millimeters unless otherwise specified

DIMENSIONS

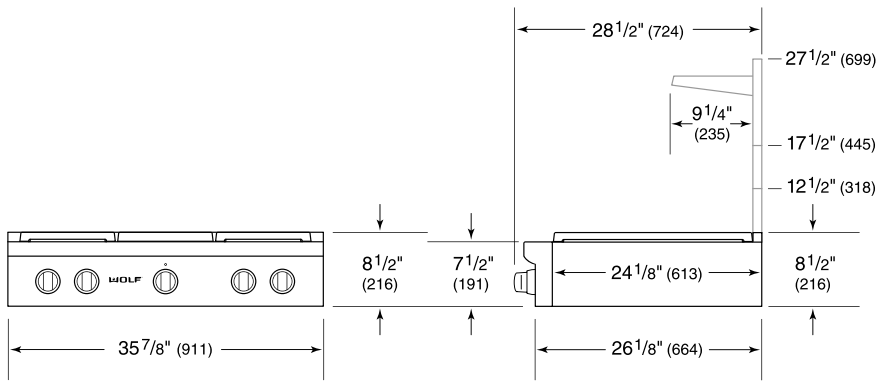

GUIDE  
ONLY.

THESE SPECIFICATIONS ARE A GUIDE ONLY. Not suitable for cabinetry, installation or services location.  
SUB-ZERO AND WOLF OFFER A CUSTOMISED DESIGN CHECK SERVICE to ensure your new appliances are installed perfectly. Please contact our Customer Care team for further information regarding our Design Check Service, or for detailed product specification and installation advice.  
Phone: 1300 808 859 Email: [enquiries@subzero.com](mailto:enquiries@subzero.com)  
Sub-Zero and Wolf Design Guides are also available via our website: [www.subzero-wolf.com.au](http://www.subzero-wolf.com.au)