

Read Before Assembly

- To assure that assembly is carried out properly, make sure to read these instructions before you begin the assembly. Please keep these instructions close at hand, so you can refer to them whenever you need.
 - To move the piano, lift it carefully—all the while keeping it level.
 - Be careful not to pinch your hands or drop this unit on your foot during assembly or transport.
 - Make sure to enlist the help of at least one other person when assembling this unit and moving it to a different location.
 - Make sure to keep screws and any other small parts in a safe location that is out of the reach of small children, so such small parts won't accidentally get swallowed.
 - All screws should be tightened provisionally first, then tightened later. To tighten a screw provisionally, screw it in until about half of its length is no longer visible. Do not use an electric screwdriver when tightly securing the screws. Otherwise, you risk stripping the threads.
- !

* The screwdriver needed to perform the assembly is not supplied. You'll need to have ready a Phillips screwdriver that matches the size of the screws.

* Continue checking the screw holes while you tighten the screws.

* After firmly tightening all the screws, place the unit at a location that is level and sure to remain stable. The unit must never be placed on top of deep-pile carpet. Otherwise, you risk causing damage to the pedals due to instability and unnecessary movement.

* The surface of the piano unit and the stand are very delicate; handle with care to avoid scratching them.

* Do not place the piano unit directly on the floor. Doing so will damage the connectors on the bottom of the piano.

Check the Parts

1

2

3

4

5

6

1

2

3

4

5

6

1

2

3

4

5

6

1

2

3

4

5

6

1

2

3

4

5

6

1

2

3

4

5

6

1

2

3

4

5

6

1

2

3

4

5

6

1

2

3

4

5

6

1

2

3

4

5

6

1

2

3

4

5

6

1

2

3

4

5

6

1

2

3

4

5

6

1

2

3

4

5

6

1. Stand Assembly

- * At first, assemble the entire stand in a temporary fashion, without really tightening the screws. Then, after checking the overall alignment of the boards (and gently shifting certain parts where necessary), go around and tightly fasten each of the screws.
- * If necessary, spread out a blanket or similar material to prevent the stand or floor from being scratched during assembly.
- * Be careful not to pinch the pedal cord during assembly.

1. Lay the pedal board 6 on top of the metal fittings of a side board (either 3 or 4).

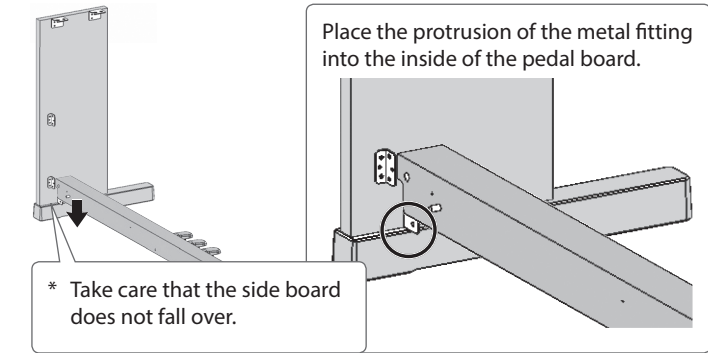

2. Align the screw holes of the metal fitting with the screw holes of the pedal board, and provisionally hand-tighten the large screw 9.

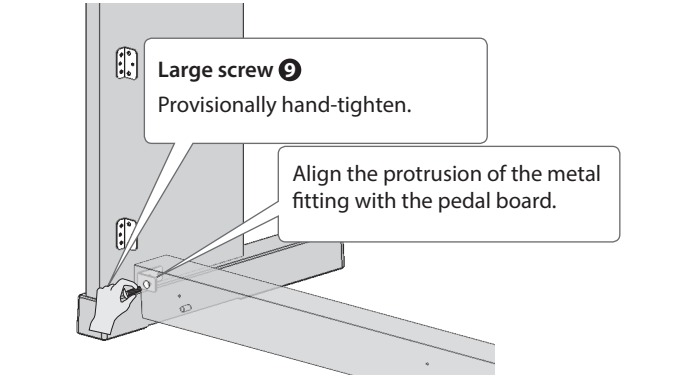

* If you did not hand-tighten it first, the screw threads will be damaged, making assembly impossible.

3. Attach the other side board to the pedal board in the same way as described in steps 1 and 2.

4. Use a screwdriver to tighten the large screws 9 (two locations) that you provisionally tightened, tightening them until the threads are slightly visible.

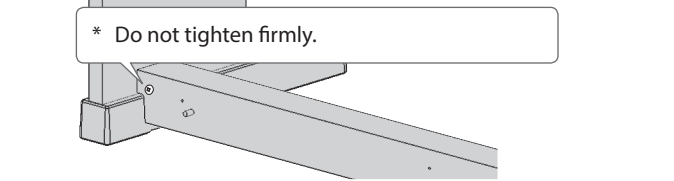

5. Place the rear board as shown in the illustration, so that it rests on the protruding dowels of the pedal board.

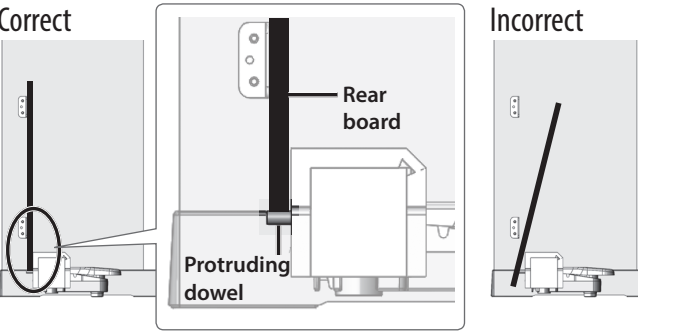
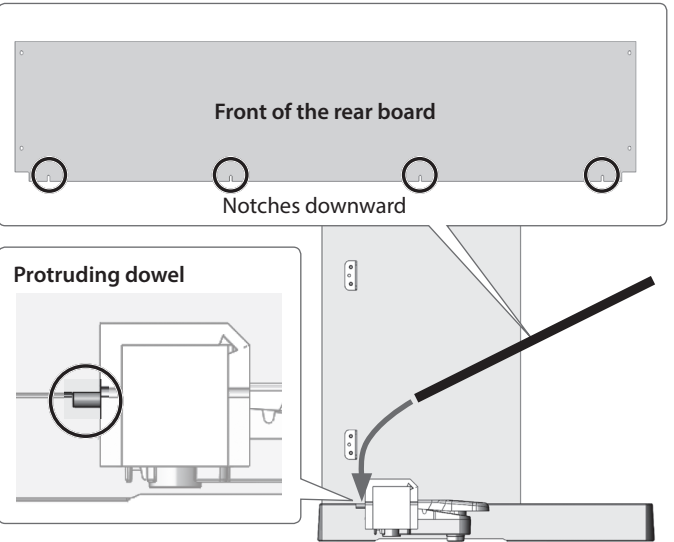

6. Fasten the small screws 7 from the front of the rear board into the metal fittings (four locations) on the inside of the side board.

Fasten the small screws in order starting with the upper screw holes. When doing so, apply pressure to the side board's metal fittings while you fasten the screws.

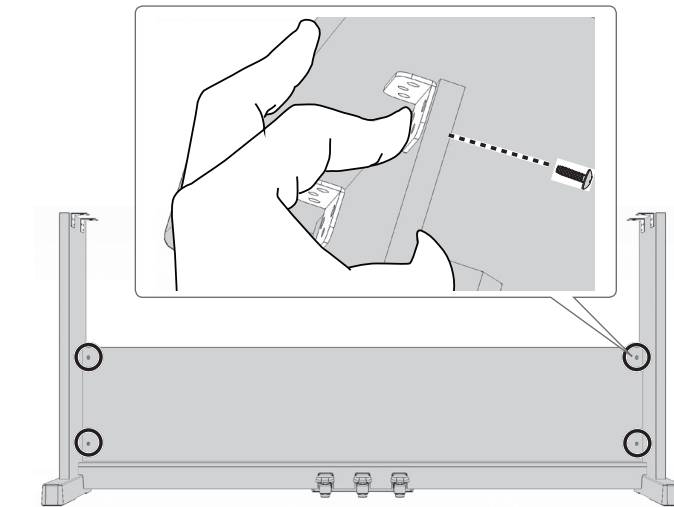

7. While applying pressure to the center of the pedal board, additionally tighten the large screws 9 that you loosely tightened in step 4, until they are firmly fastened. And make sure that the rubber feet on the bottom of the pedals are in contact with the floor.

* If the pedals are floating, the pedal board might be damaged.

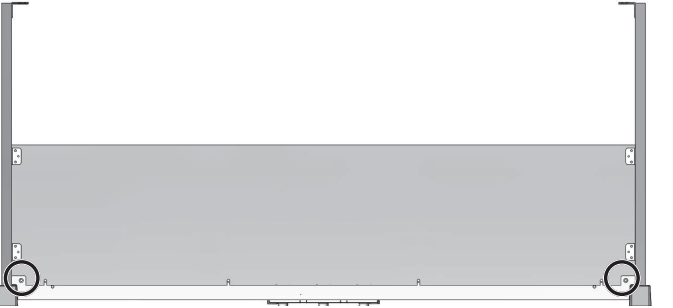
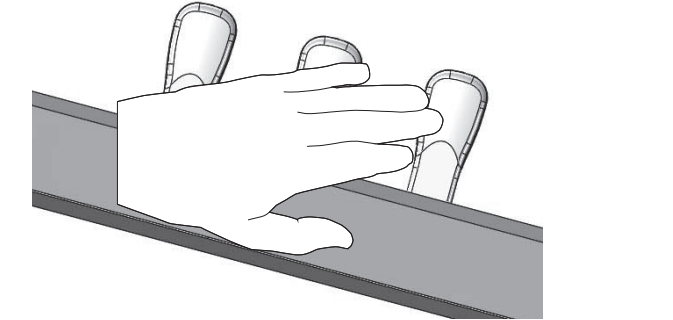

8. From the back of the rear board, use pointed screws 8 to fasten it to the pedal board (four locations).

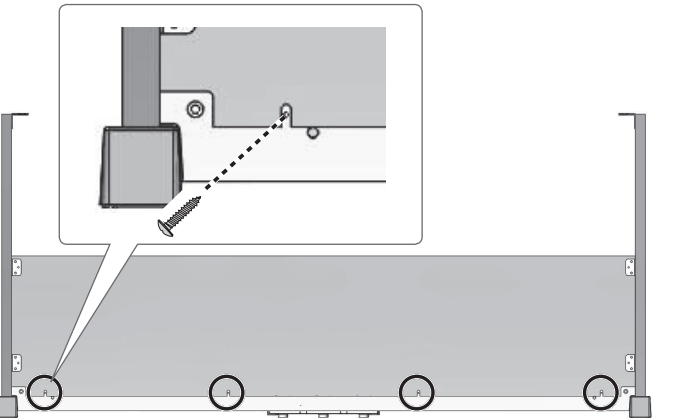

9. Extend the pedal cord out the back.

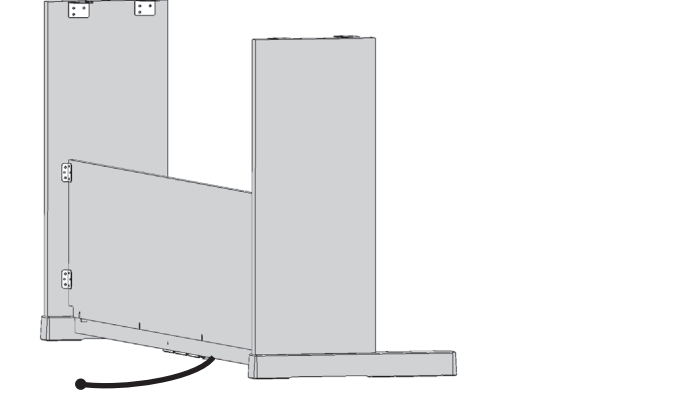

2. Assembling the Piano

1. With the help of another person, lift up the piano and place it on top of the side board.

Please don't get your fingers pinched.



Position the screws on the bottom of the piano (one each at left and right) so that they are behind the side board.

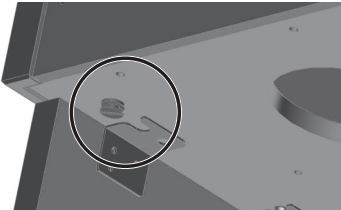

2. Align the screws on the bottom of the piano with the metal fittings of the side board.

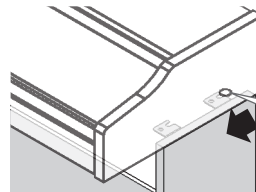

Align screws with side board's metal fittings

3. Slightly raise the piano at its front edge, and pull it toward the front to hook the screws onto the metal fittings.

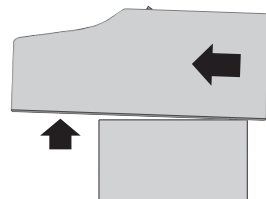

Raise front of piano and pull toward front

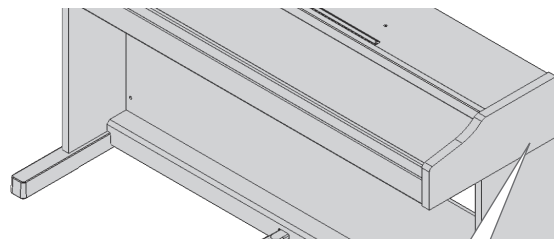

Pull until the screws are fully engaged with the fittings

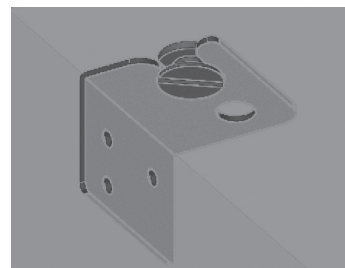

4. Adjust the position of the side boards so that the piano unit and the side boards are parallel.

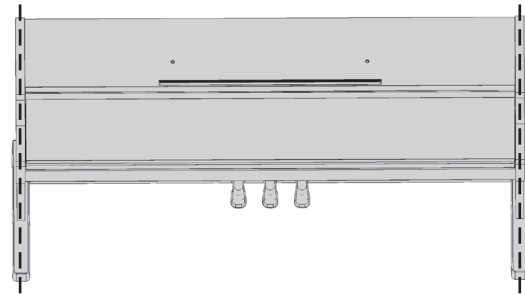

5. Install the two large screws ⑨ in the bottom of the piano. First use your hand to tighten the large screws ⑨ two or three rotations, and then use a screwdriver to tighten them firmly.



Large screw ⑨

First use your hand to tighten the screws two or three rotations.

* If you don't hand-tighten the screws first, the screw threads or the insert nut that is set into the piano might be damaged, making assembly impossible.

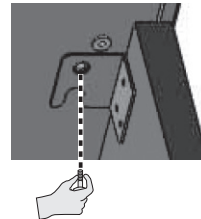

6. Connect the pedal cord to the Pedal jack.

* Be aware that if you move the piano without connecting the pedal cord, you might step on the pedal cord, causing injury or damage.

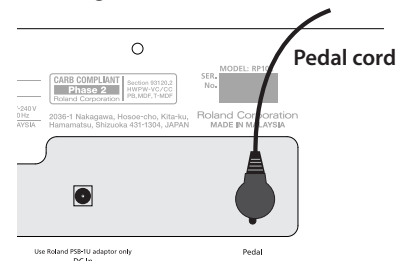

7. Move the piano to the location where it will be used.

8. Loosen the music rest screws slightly (2–3 mm), insert the music rest brackets between the screws and the body of the piano, and turn the screws to secure the music rest while using one hand to support the music rest.

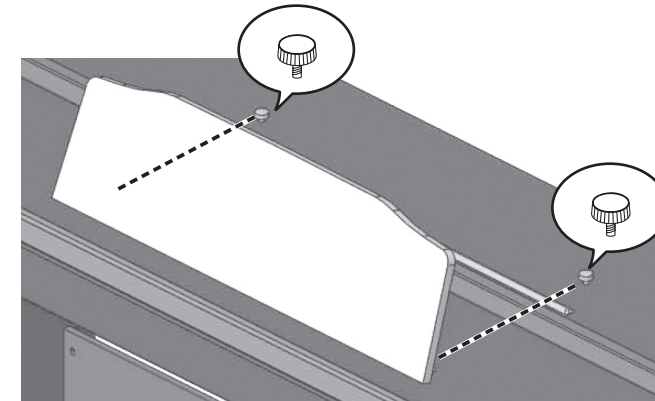

When attaching the music rest, make sure that it is firmly inserted all the way toward the back, and use your hand to support the music rest so that it does not fall. Also take care not to pinch your hand.

* Do not apply excessive force to the music rest.
* If you need to remove the music rest, loosen the screws while using one hand to support the music rest. Detach the music rest, and then firmly retighten the screws.

9. Connect the AC adaptor to the DC In jack on the bottom of the piano. As needed, use the coated clip on the bottom of the piano to fasten the AC adaptor and the pedal cord.

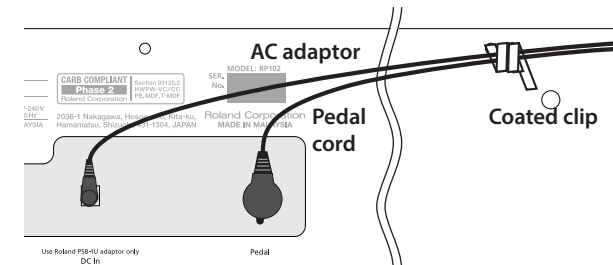

10. Connect the supplied AC adaptor and power cord, and plug the power cord into an AC outlet.

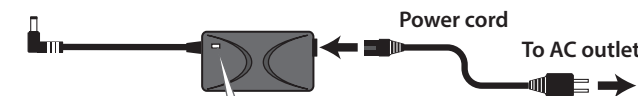

Place the AC adaptor so the side with the indicator faces upwards and the side with textual information faces downwards. The indicator will light when you plug the AC adaptor into an AC outlet.

When moving or transporting the piano

If you need to move the unit, you must first detach the music rest, close the keyboard cover, disconnect the AC adaptor. With at least one other person helping you, lift the unit horizontally and carry it, taking care not to pinch your hands or drop the unit on your feet.

At the new location, press the pedals and verify that the rubber feet are in contact with the floor.