

# Wireless Keyboard



**Note:** Please read the manual carefully before using

JP400

## Packing Included

- 1x Detachable wireless keyboard case for iPad Pro 12.9 5th/4th/3rd Gen
- 1x USB charging cable ( No Charger )
- 1x User manual

## No Backlight Keyboard

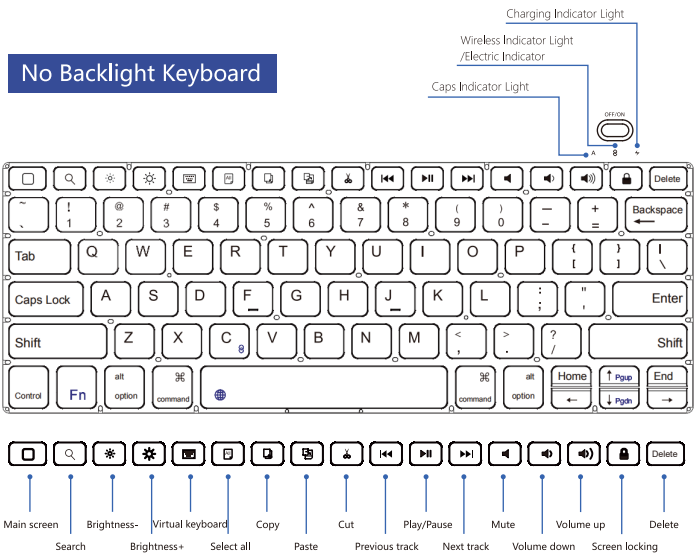

— 01 —

## Operation Instruction



1 Slide the key to "ON" to turn on the keyboard power.



3 Open BT on your iPad.

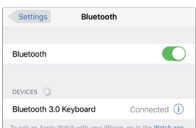

5 The connection is successful, the BT indicator stop flashing.



2 Press FN and C key together, the BT indicator light will flash.



4 Search keyboard name (BT 3.0 Keyboard) for matching device to keyboard.

**Note:**

The keyboard will automatically go into power savings mode after 10 minutes of inactivity. Press any key and wait 2-3 seconds to wake the keyboard.

## Specifications

Working Current	≤3.5 mA	Working Voltage	3.0 V ~ 4.2 V
Battery Standby Time	≥120 Days	Working Time	≥80 Hours
Charging Port	Micro USB	Sleeping Current	≤0.35mA
Charging Time	2-3 Hours	Battery Capacity	280 mAh
Awaken Time	≤2 Seconds	Connect Distance	≤33 feet
Working Temperature	-10 °C ~ + 55°C	Charging Current	≤200 mA

— 02 —

## Backlight Keyboard

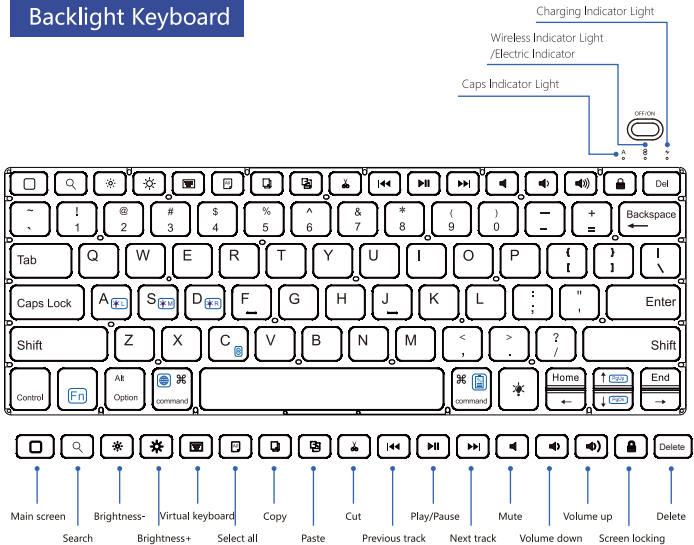

## How to change the backlight color

### Backlight control



— 03 —

## Operation Instruction



1 Slide the key to "ON" to turn on the keyboard power.

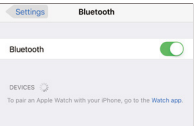

3 Open BT on your iPad.



5 The connection is successful, the BT indicator stop flashing.



2 Press FN and C key together, the BT indicator light will flash.



4 Search keyboard name (BT 3.0 Keyboard)for matching device to keyboard.

**Note:**

The keyboard will automatically go into power savings mode after 10 minutes of inactivity. Press any key and wait 2-3 seconds to wake the keyboard.

## Specifications

Working Current	≤3.0 mA	Working Voltage	3.0 V ~ 4.2 V
Battery Standby Time	150 Days	Working Time	4 to 20hours(with light function 200hours(without light function
Charging Port	Micro USB	Sleeping Current	≤0.3mA
Charging Time	3-5 Hours	Battery Capacity	≤650 mAh
Awaken Time	≤2 Seconds	Connect Distance	≤30 Feet
Working Temperature	15F ~ 130F	Charging Current	≤200 mA

— 04 —

## Second Connection

- You just need to press any key and wait 2-3 seconds to wake the keyboard. It will automatically go into power savings mode after 10 minutes of inactivity. (No need to click "BT 3.0 Keyboard" and press "Fn+C" key. Otherwise, it will show not connect) If you press "Fn+C" or "BT 3.0 Keyboard" key again before you wake the keyboard up, it will cause connection failed.
- If you still can't connect for the second time:
  - ~ Click "Forgive this device" to delete the "BT 3.0 Keyboard" signal on the iPad.
  - ~ Shutdown your iPad and keyboard, and restart them, pair it follow the steps of the first.
- If your problem has not been resolved or other issues, please contact us via our After-sales Email :chesonauus@163.com

## Indicator Light

Capital Indicator Light	Press the keyboard Caps Lock, the indicator light is on.
Wireless Connect Indicator	Press the "Connect" / "Fn + C" button, the indicator light will flash slowly and enter BT pairing mode. When the pairing completion light goes out.
Charging Indicator Light	Slow flashing red light means the battery is low, the charging status is bright for a long time, and it is off after charging is completed.
Electric Indicator Light	The power is turned on, and the light is off after 2-3 seconds.

**Remarks:**

- Fully charge your keyboard, or charge it for more than 2 hours, before using it for the first time.
- If the battery power is less than 20%, the power indicator will flash continuously, you need to charge it in time to avoid problems .

— 05 —

## Charging

Before first using, charge the keyboard fully.

To charge the keyboard:

- 1) Locate the micro-USB cable from the package or use your own.
- 2 ) Plug in the micro-USB (small tip) into the keyboard and the other end into a USB port.

## Installation and Removal

- 1) Removing back protective piece: hold iPad on both sides and use thumbs to gently push off the back cover (see photo.) Cover is held in place by two tabs.
- 2) Proceed to "peel" cover away from iPad.
- 3) Take iPad out.
- 4) Take iPad out upwards.

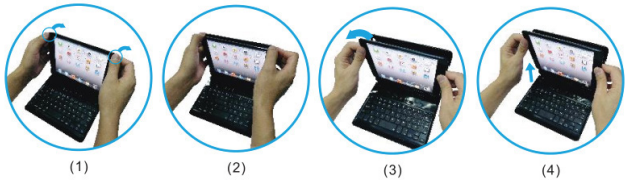

— 06 —

## Troubleshooting

If the keyboard is not working correctly, please check the following:

- 1) The BT function on the iPad (or other BT devices) is enabled
- 2) The BT keyboard is within 33 feet
- 3) The BT keyboard is charged

If certain keys or commands begin to fail, work sporadically or lag in response time, please restart your iPad (power on and power off).

This fixes 99% of these types of issues.

If a problem persists, please try the following steps:

- Delete all the BT devices on the iPad
- Switch off the BT function on the iPad
- Reboot the iPad
- Switch on BT on the iPad
- Switch the keyboard off and on
- Repeat the steps on pages 1 and 2 to connect the keyboard

— 07 —