

**Infinix**

**NOTE 50 Pro**

**X6855 User Manual (I&J)**

# Exploded diagram specification

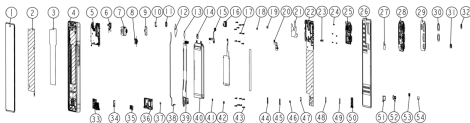

1	TP+LCM	2	TP HEAT FILM
3	VAPOR CHAMBER	4	MIDFRAME
5	MAINBOARD	6	FRONT CAMERA
7	REAR 50M CAMERA	8	REAR 8M CAMERA
9	50M GROUNDING AD	10	PROACTIVE BRACKET MYLAR
11	FRONT CAMERA MOUNT	12	50M GROUNDED COPPER FOIL
13	8M GROUNDED COPPER FOIL	14	8M GROUNDING AD
15	FLASH FPC	16	SQUARE RECEIVER
17	BLACK L2.5 SCREW	18	ANTI-CHANNELING SILICONE SHEET
19	FRONT CAMERA COPPER FOIL	20	RGB LIGHTING EFFECT FPC
21	MAIN PCB HEAT FILM	22	UP FRAME
23	FLASH BTB PRESS STEEL	24	BLACK L1.3 SCREW
25	REAR CAMERA FRAME	26	BATTERY COVER
27	LENS PROTECT AGAINST DUST MYLAR	28	ALLOY DECO
29	COMPOSITE PANEL TRIMS	30	50M LENS
31	RGB LENS	32	FLICKER LENS
33	SUB BOARD	34	LCM FPC RUBBER
35	USB RUBBER	36	HORN BRACKET
37	MAIN FPC BTB FOAM	38	COAXIAL CABLE
39	MAIN FPC	40	BATTERY

41	FINGERPRINT PRESSED FOAM	42	MAIN FPC BTB SILICONE SHEETS
43	SILVER L3.5 SCREW	44	FPC BTB SILICONE SHEETS
45	LCM FPC BTB SILICONE SHEETS	46	FINGERPRINT BTB SILICONE SHEETS
47	MOTOR PRESSES THE FOAM	48	FPC BTB PRESSED FOAM
49	LCM BTB CONDUCTIVE SPONGE	50	SIMCARD HOLDER
51	SQUARE MOTOR	52	FINGERPRINT MODULE
53	FLICKER RUBBER	54	MFPC PROTECT FOAM

# Know your phone

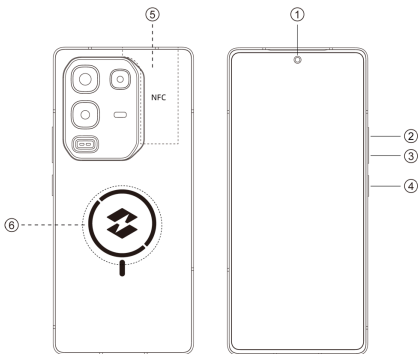

1. Front camera
2. Volume + button
3. Volume - button
4. Power button
5. NFC
6. Wireless charging

# SIM card installation

1. Power off your phone.
2. Refer to the following picture for SIM card installation.

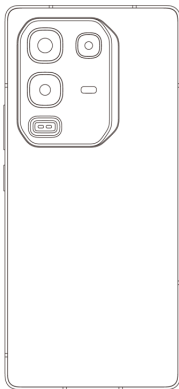
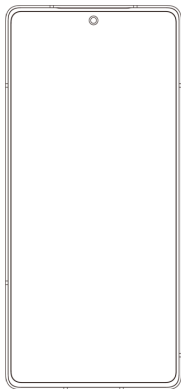

# Charging the phone

You can charge your phone with a charger or by connecting it to a computer using a USB cable (comes with the phone).

Use only Infinix chargers and cables. Other chargers or cables may damage the phone and invalidate its warranty.

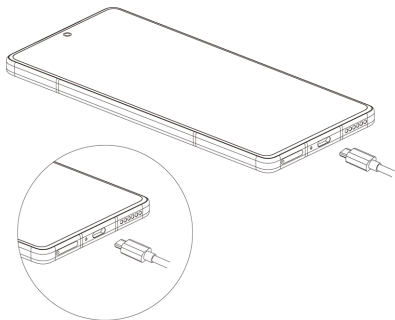

# FCC Caution

## **Labelling requirements.**

This device complies with Part 15 of the FCC Rules. Operation is subject to the following two conditions:

- (1) This device may not cause harmful interference.
- (2) This device must accept any interference received, including interference that may cause undesired operation.

## **Information to user.**

Any changes or modifications not expressly approved by the party responsible for compliance could void the user's authority to operate the device.

## **Information to the user.**

Note: This device has been tested and found to comply with the limits for a Class B digital device, pursuant to part 15 of the FCC Rules. These limits are designed to provide reasonable protection against harmful interference in a residential installation. This device generates, uses and may radiate radio frequency energy and, if not installed and used in accordance with the instructions, may cause harmful interference to radio communications. However, there is no guarantee that interference will not occur in a particular installation. If this device does cause harmful interference to radio or television

reception (able to be determined by turning the device off and on), the user is encouraged to try to correct the interference by one or more of the following measures:

- Reorient or relocate the receiving antenna.
- Increase the separation between the device and receiver.
- Connect the device to an outlet on a circuit different from that to which the receiver is connected.
- Consult the dealer or an experienced radio/TV technician for help.

### **Specific Absorption Rate (SAR) information:**

This mobile phone meets the government's requirements for exposure to radio waves. The guidelines are based on standards developed by independent scientific organizations through periodic and thorough evaluation of scientific studies. The standards include a substantial safety margin designed to assure the safety of all persons regardless of age or health.

FCC RF Exposure Information and Statement. The SAR limit of USA (FCC) is 1.6 W/kg averaged over one gram of tissue. Device types: X6855 (FCC ID: 2AIZN-YY5-X6855) has also been tested against this SAR limit. The highest SAR value reported under this standard during product certification for use at the ear is 0.87 W/kg and when properly worn on the body is 0.78 W/kg.



## **Body-worn Operation**

This device was tested for typical body-worn operations. To comply with RF exposure requirements, a minimum separation distance of 1.0 cm must be maintained between the user's body and the handset, including the antenna. Third-party belt-clips, holsters, and similar accessories used by this device should not contain any metallic components. Body-worn accessories that do not meet these requirements may not comply with RF exposure requirements and should be avoided. Use only the supplied or an approved antenna.

For DTS patents, see <http://patents.dts.com>. Manufactured under license from DTS Licensing Limited. DTS, the Symbol, & DTS and the Symbol together are registered trademarks or trademarks of DTS, Inc. in the United States and/or other countries. © DTS, Inc. All Rights Reserved.



Operating System: Android™

Android is a trademark of Google LLC.