

FULMINARE Air Purifier

T10 User Manual



Precautions before use

1. After opening the product package, there are 2 items:

A. Air purifier B. User manual

2. The air purifier of this product is only for indoor use, not outdoor use.

3. A space of more than 10 cm should be left around the machine.

Clothes, plastic bags and other sundries should not be placed at the inlet and outlet, so as not to hinder the entry and emission of air and affect the purification effect.

4. Do not spray any liquid or spray on the product or screen.

5. Avoid using AC/DC switching power supply in wet places.

Functions and Features

Air purifier [Deep and safe purification]: Filters 99.97% of harmful airborne pollutants including particulate matter PM2.5, allergens, dust, pollen, odors, pet dander and odor, cigarette and other smoke, cooking cake odor, VOCs and bacteria, 100% ozone-free, safe operation to improve indoor air quality.

Allergies: Remove allergens from the air, including dust, pollen, pet dander, and mold spores. Purify air: remove smoke and dust, purify air. To protect people from asthma and allergies caused by indoor pets. Activated charcoal filters remove household odors, the odor of cigarette smoke and volatile organic compounds such as paint smoke. Indoor air is recycled more than 2.5 times per hour. It can be used for air purification in bedrooms, living rooms, study rooms, bathrooms, cloakrooms, yachts, cars and other places. It is the first choice for air purification products in homes, offices and other environments.

Product technical specifications

Clean air volume:

Methanol : TVOC: CARD

Rated power : 24W

Machine weight : 2.18KG body

Volume : 200mm(diameter) x 327mm(height)

Intelligent control : When you need to replace the air filter, the red indicator blinks

Best working environment: indoor temperature above 15°C, relative humidity above 40%

WARRANTY

FULMINARE provides a two-year product warranty from the date of the purchase for all our products. We will take care of all quality-related issues with a REPLACEMENT or FULL REFUNDED including any return shipping costs. If your product is defective and under warranty, please feel free to contact us.

Please carefully follow our warranty process to minimize any delays:

1. Note the product model name. It can be found on a sticker located underneath or on the back of the product.

2. Provide the order number for a purchase made through Amazon.

The typical turnaround time to address Warranty claims is 14 business days, depending on your geographical location and type of damage or Warranty claim.

This warranty does not apply to the following:

Damage due to abuse, accident, alteration, misuse, tampering, or vandalism.

Improper or inadequate maintenance.

Damage in return transit.

Unsupervised use by children under 18 years of age.

Need help with assembly, technical support, or warranty?

Please contact us

FULMINARE-VIP@outlook.com

3. Place the clean screen into the product and screw the bottom cover.
【 Figure3 】

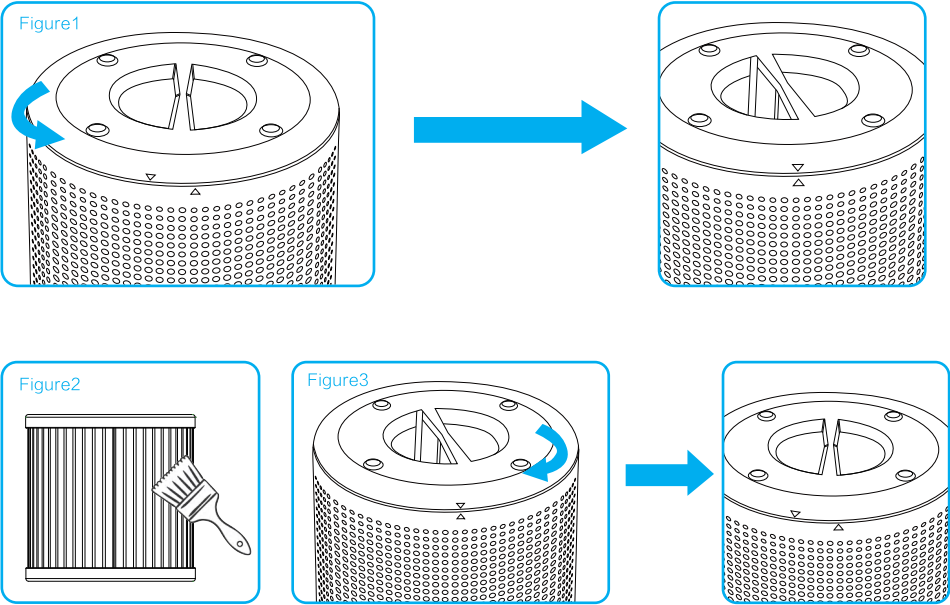

Common faults and troubleshooting methods

If the machine fails, please check the following possibilities before contacting the distributor or special service department:

Failure Phenomenon	Cause Analysis	Solution
The machine is not running	Power off	Turn on the power switch
	Power plug released	Plug in the power plug
The light flashes	The filter needs to be replaced	Replace the filter

Name of machine part

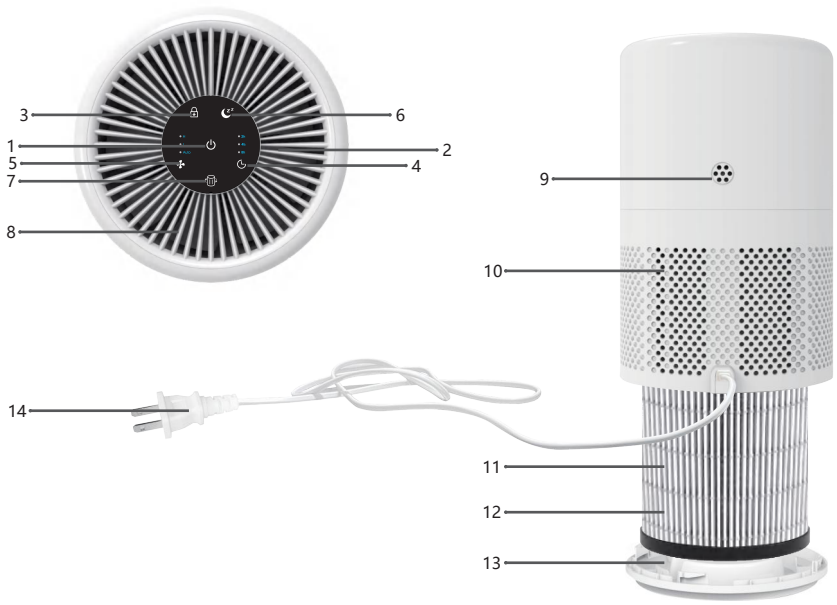

How to operate the machine

1. Connect the plug (14) to power socket at 100-240V 50-60Hz.
 2. Press the switch key (1) to start, the machine starts to work, the blue decorative light and switch key (1) light up at the same time, the boot fan default Auto operation, air will be discharged from the outlet (8).
- 【Figure 1】

3. After starting up, the fan works in Auto mode by default. Press the fan button once to adjust to L speed, the indicator light will be on. Press the button twice to adjust to H speed, then press it again to return to Auto mode.

4. After the device is powered on, the child lock function is not enabled by default. Tap the Child lock key (3) to enable it and the indicator will light up (as shown in Figure 3). Press the button again to turn off the function, and the Child lock key indicator is off.

5. Timer Function: press the timing button once for 2h customization, press twice for 4h customization, press three times for 8h customization, press four times for 10h customization(2h and 8h lights are on at the same time.), press five times for 12h customization(4h and 8h lights are on at the same time.). Press again to cancel the timing customization, and the indicator is off.

6. After the machine is turned on, after press the sleep mode button(6), the sound becomes smaller, the decorative light turns off, and the machine continues to work.

【Figure 2】.

7. When shutting down, please gently press the turn on key (1) The machine will stop working 【Figure 4】. If not used for a long time, please pull out the power plug (14).

8. The machine has the function of filter screen accumulated running time. When the total work of the machine reaches the theoretical value for 3 months, the filter element replacement prompt key (7) under the startup state is in the red flashing state, indicating the user should replace the filter element.

9. Please turn off the machine before replacing the filter screen, then unscrew the knob from the bottom of the machine, open the bottom cover (13), take out the filter screen (12), put the new filter screen back to the correct position in the machine, and screw on the bottom cover 【Figure 5】.

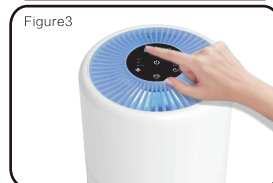
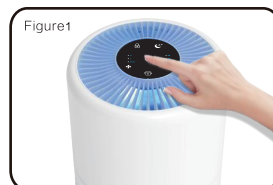

10. If you need to continue cleaning, restart the machine.

Filter core decomposition graph

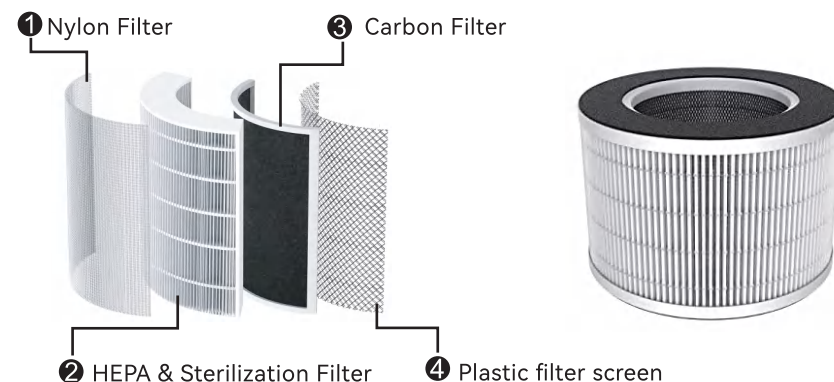

Daily cleaning and maintenance

1. When cleaning and maintaining the product, ensure that the power cable is disconnected.
2. Wipe the body with a moderately moist and clean soft rag, and then wipe dry with a dry rag. Please do not wet the machine with water directly.
3. Clean the inlet and outlet of the machine with a brush. If not used for a long time, the machine should be stored in a dry and ventilated place.

Clean and replace the screen

1. Unscrew the bottom knob of the product, open the bottom cover, and take out the filter screen. 【Figure 1】
2. Use a dry brush or vacuum cleaner to clean the surface of the filter. 【Figure 2】