



Quick Guide



售后客服

MTP Throttle Panel



User Manual 使用说明书

01 Product Features

- Realistic Design
- Aluminum Alloy Throttle Grip
- High-Resolution Encoder
- 27 Physical Switches
- Adjustable Gear Mechanism
- Adjustable Vibration Function

02 Connection Ports

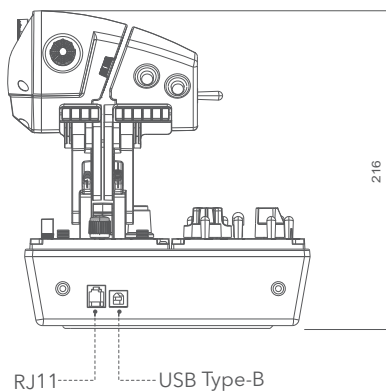

03 Parameters

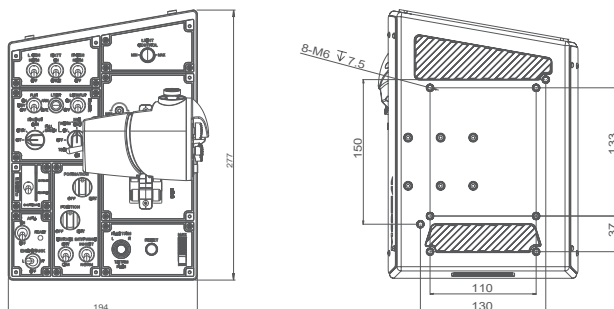

04 User Guide

Securing the Throttle

1. Stick the throttle to the desk.

Align and firmly press the included sticker onto the designated area below the MTP throttle, ensuring the surface is clean and dust-free.

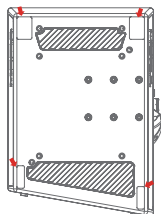

2. Installing the Mounting Plate

To mount the MTP throttle, align it with the 4 holes indicated in the diagram, secure it by tightening 4 M6 countersunk screws, and lock it into place according to the mounting holes on the bracket.

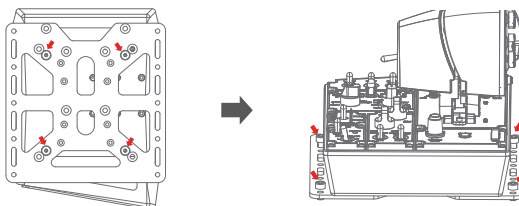

*The mounting plate must be purchased separately.

Connecting to PC

1. Direct Connection to PC

- Use the included USB cable to connect the Type-B end to the corresponding port on the MTP throttle, and the Type-A end to your PC. If connected successfully, the device's light will gradually illuminate, and the MOZA Cockpit will display that the device is connected and functioning correctly.

* If the device fails to light up, turn the light control button clockwise.

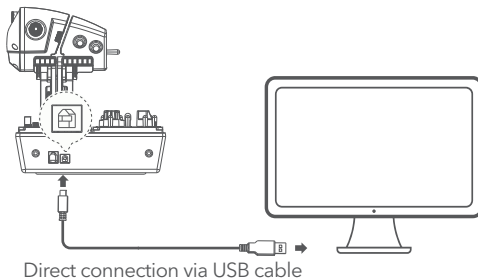

* If the device light flashes, it indicates BOOT mode. Please exit BOOT mode from the host computer.

2. Connecting to PC through MOZA Flight Base

- Connect one end of the included RJ11 cable to the corresponding port on the MTP throttle and the other end to the MOZA AB9 Base. Power on the base; if connected successfully, the device light will illuminate, and the MOZA Cockpit will indicate that the device is connected and functioning correctly.
- * If the device fails to light up, turn the light control button clockwise.

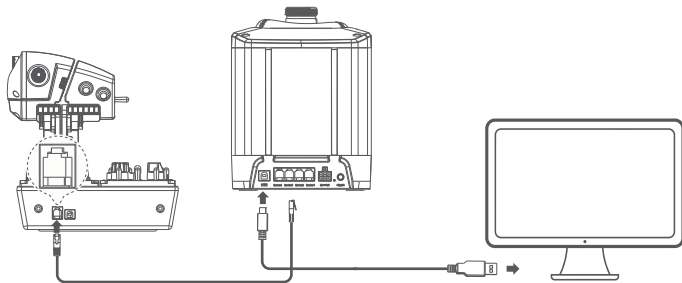

The Panel connects to the Base via RJ11, Then connect the Base to the PC via USB cable.

- * If the device's light is flashing slowly, it is in BOOT mode. Please exit BOOT mode on the host computer.

Gear Adjustment

1. If you wish to detach the throttle detent mechanism, use the included wrench to turn the screw (as shown below) on the detent adjustment mechanism counterclockwise to remove it.

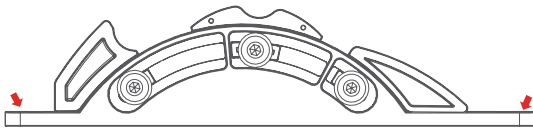

2. If you wish to adjust the position of afterburner and middle detent, use the included wrench to turn the screw on the detent adjustment mechanism counterclockwise, move the detent to desired position, and then tighten the screw by turning them clockwise.

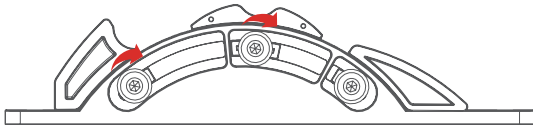

06 Throttle Grip Vibration Function

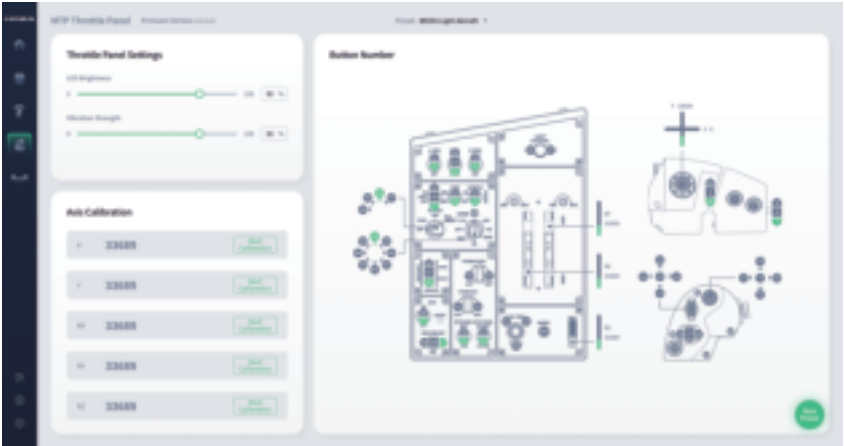

The throttle grip has a telemetry vibration function to indicate the aircraft's airspeed changes:

1. Launch the MOZA Cockpit software.
2. Go to the throttle settings page and select vibration settings.
3. In the settings page, you can adjust the following according to your preferences:
 - Vibration Strength: Adjust the strength of the vibration for more intense airspeed feedback.

Notes: Ensure the device is correctly connected and configured in the MOZA Cockpit.

07 Specifications

- Supported Platform: PC
- Resolution: 15-bit
- Throttle Grip Material: Aluminum Alloy
- Throttle Panel Material: Composite Material
- Rated Voltage: 5V
- Rated Current: 0.22A
- Connection Ports: USB Type-B, RJ11
- Mounting Method: Mounts on a desktop with desk clamp or directly onto flight simulator cockpits.
- Desktop Clamp: Optional
- Mounting Plate: Optional

08 Precautions

- Do not expose the device to liquids or humidity as it may cause fire or electric shock.
- Avoid using the device in direct sunlight.
- Do not use MOZA flight sim gear with the MOZA racing gear.
- Recommended indoor temperature: 5°C ~ 35°C.
- For your safety and well-being, please monitor your gaming time and take breaks as needed.
- The device is not suitable for children under the age of 6, small accessories may pose a choking hazard!
- Children under 13 should have adult supervision.
- It is strictly forbidden to disassemble the equipment by yourself, failure to adhere to this will result in loss of warranty.
- The equipment must be connected with the factory-supplied power supply to ensure the electrical safety and the protection of user rights and interests.
- In order to ensure user safety, parts repair or replacement can only be carried out by officially authorized repair centers.
- Non-standard power supplies are strictly prohibited even if data such as related voltages match.
- Use only AC power provided by a standard wall outlet to avoid damage to the product.
- Do not expose the device to heat sources.
- Unplug the power cord of the device if it will not be used for a long time.
- If you find any abnormality, please stop using it immediately and seek help from MOZA representatives or authorized repair centers.
- Stay tuned to our official website and social media platforms for the latest product updates.

01 产品介绍

- 拟真造型设计
- 铝合金油门握把
- 高分辨率编码器
- 27颗物理开关
- 可调节档位机构
- 可调震动功能

02 油门接口介绍

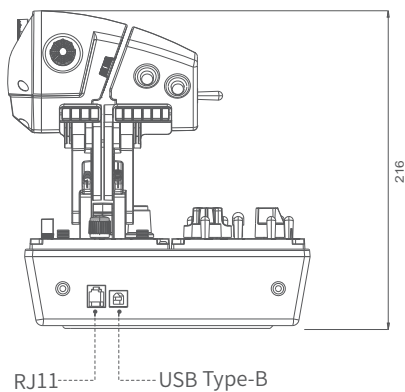

03 基本参数

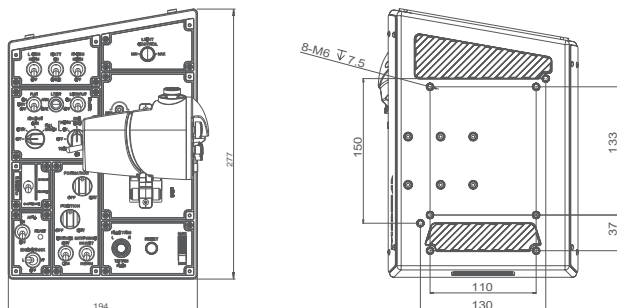

04 使用教程

固定油门

1. 桌面粘贴

将附赠的贴纸按照示意图粘贴在MTP油门的下方，确保对准指定位置并压紧粘贴处，同时保持粘贴表面清洁，无灰尘。

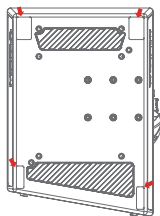

2. 安装支撑底板

对准图中4个孔位，使用4颗M6沉头螺丝固定住油门不松脱，再根据支架孔位锁定好油门

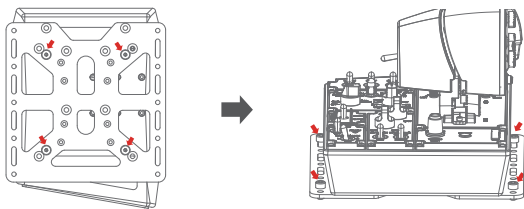

*支撑底板需额外购买

PC连接

1. 直接连接PC

使用附赠的USB线，将Type-B端分别插入MTP油门尾部对应接口上，另一头Type-A端接入PC，若成功连接则设备灯光逐渐亮起，MOZA Cockpit中将显示设备已连接

*若设备灯光无亮起，请顺时针旋转此处灯光控制按钮

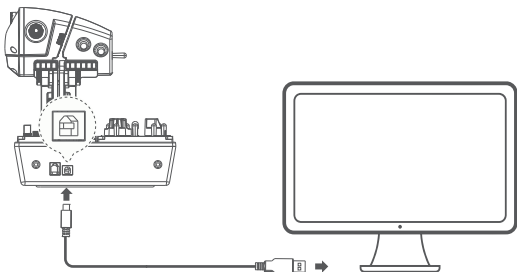

使用USB线直接连接

*若设备灯光慢闪，则设备处于BOOT状态，请在上位机中退出BOOT模式。

2.通过MOZA基座连接PC

使用附赠的RJ11线,将一段连接MTP油门尾部对应的接口上,另一头连接至MOZA飞行模拟基座,将基座通电,若成功连接则设备灯光亮起,MOZA Cockpit中将显示设备已连接

*若设备灯光无亮起,请顺时针旋转此处按钮

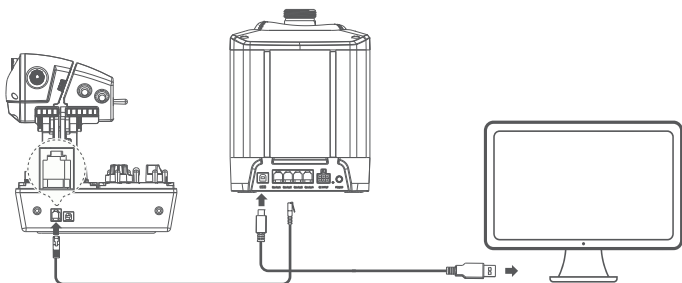

面板通过RJ11线连接至基座,再由基座通过USB线连接至PC

*若设备灯光慢闪,则设备处于BOOT状态,请在上位机中退出BOOT模式

油门档位调节

1. 如果需要调节不同的档位,使用附赠的扳手,逆时针拧下档位调节机构上的螺丝,拆下档位调节机构

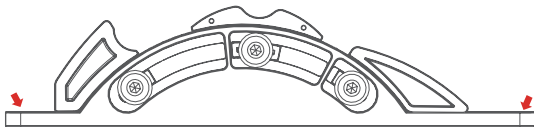

2. 如果需要调整加力燃烧锁位和中心位,请使用附赠扳手逆时针拧松图中螺丝,将两处滑块滑动至理想位置后,再顺时针拧紧螺丝

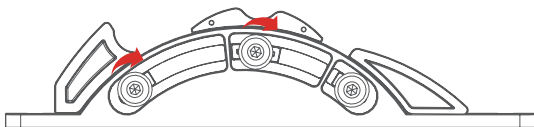

油门阻尼调节

- 1.如果需要增加杆头的滑动阻尼,使用附赠的扳手,顺时针旋转图中螺丝
- 2.如果需要减少杆头的滑动阻尼,使用附赠的扳手,逆时针旋转图中螺丝

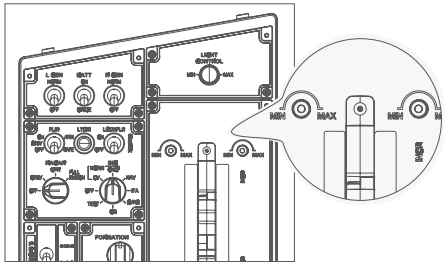

05 软件介绍

主页面可以查看已连接的设备工作状态,包含基座,操纵杆,油门,脚舵等,同时可以快捷启动游戏



06 油门握把震动功能

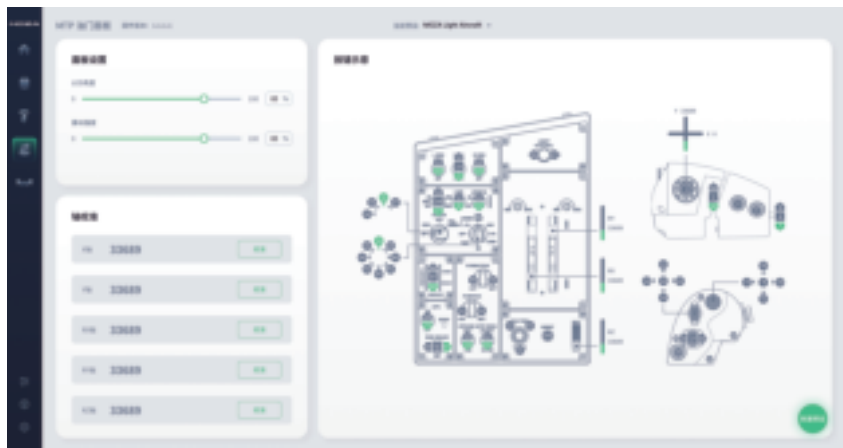

杆头带有遥测震动功能,用于指示用户飞机的空速变化:

- 1.打开MOZA Cockpit软件
- 2.进入油门设置页面,选择震动设置
- 3.在设置页面中,您可以根据个人偏好进行以下调整:
 - 震动强度:调节震动的大小,展示更强烈的空速提醒反馈。

注意:请确保设备正确连接并在MOZA Cockpit中完成配置

07 规格表

支持平台:PC

行程分辨率:15bit

油门握把材料:铝合金

油门面板材料:复合材料

额定电压:5V

额定电流:0.22A

接口:USB type-B 电源接口、RJ11 数据接口

固定方式:配合桌面夹(选配)分为桌面模式或悬挂模式,亦可配合专业模拟舱支架

桌面夹:选装

支撑底板:选装

08 注意事项

- 严禁将设备暴露在雨水以及潮湿的环境中, 以避免发生火灾/电击
- 严禁在太阳直射的条件下使用设备
- 严禁接入MOZA赛车模拟器生态产品
- 建议室内温度:5°C ~ 30°C
- 为了您的健康, 请合理控制游戏时间
- 设备不适用于6岁以下儿童, 小配件可能造成窒息的危险!
- 13岁以下孩童需在家长陪同下使用
- 严禁自行拆解设备, 否则将失去质保资格
- 设备必须使用配套出厂的电源进行连接, 以保障用电安全及用户权益得到保障
- 为保障相关安全, 零部件维修或者更换只能由官方授权维修中心进行
- 即使相关电压等数据匹配, 亦禁止使用非标准电源
- 只能使用标准壁式电源插座提供的交流电源以避免对产品造成损坏
- 禁止将设备暴露在热源中
- 长期不使用的情况下, 请拔出设备电源线断电
- 如发现有任何异常, 请立即停止使用并寻求 MOZA 官方或相关授权中心的帮助
- 请关注 MOZA 官网及公众平台以了解最新的相关产品信息

产品保修卡

产品型号		购买日期	
用户姓名		用户电话	
产品条码		通讯地址	

经销商信息(签章)

产品保修条例

保修期

自购机日起, 基座主体, 方向盘, 踏板和仪表显示屏保修12个月。设备外壳、说明书、线材、螺丝、扳手、包装等不在"一年免费保修服务"范围内, 但您可以选择有偿服务。

购买者在以下条件下不享受免费保修服务, 但您可以选择有偿服务。

1. 超过三包有效期的 ;
2. 无三包凭证及有效发票的, 但能够证明该产品在三包有效期内的除外 ;
3. 包修凭证上的型号与修理产品型号不符或者涂改的 ;
4. 非本公司特约维修人员拆动造成损坏的 ;
5. 因不可抗力造成损坏的 ;
6. 未按产品使用说明书要求使用、维护、保养而造成损坏的。

保修期限鉴于产品部位、不同国家法律法规等差异, 将有所不同。相关国家与区域的保修期限, 请咨询MOZA官方或购买时联系的MOZA授权经销商。





Manufacturer: Shenzhen Gudsen Technology Co., Ltd
Address: Room 1903-1904, Building 3, Nanshan
ZhiyuanChongwen Park, No. 3370 Liuxian Avenue,
Nanshan District, Shenzhen China
Web: www.mozaracing.com
E-mail: info@mozaracing.com
Made in China