





No modifications of the luminaire which the LED lamp is to be used with are to be made.

This lamp may not be suitable for use in all applications where a traditional fluorescent lamp has been used. The temperature range of this lamp is more restricted. In cases of doubt regarding the suitability of the application the manufacturer of this lamp should be consulted.

This lamp is designed for general lighting service (excluding e.g. explosive atmospheres).

- This lamp is not suitable to be used in emergency luminaires designed for double-capped fluorescent lamp(s)
- Do not touch the lamp until it cools down

SYMBOL	MEANING
	Lamp suitable for high frequency operation
	Lamp not suitable for emergency operation
	Lamp to be used in dry conditions or in a luminaire that provides protection
	DO NOT USE WITH DIMMERS

 Please inform yourself about the local waste disposal, separation and collection system for electrical and electronic products and packaging. Please act according to your local rules and do not dispose your old product and packaging with your normal household waste. The correct disposal of the packaging, your product and/or batteries will help prevent potential negative consequences for the environment and human health. Batteries should be disposed separately from the municipal waste stream via designated collection facilities. When disposing a product that contains non-user replaceable batteries, the non-user replaceable batteries shall be removed by a professional.



With electronic (HF) ballast

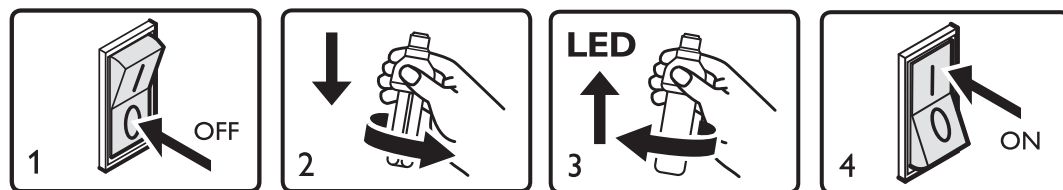

For AC Mains only

This fixture has been modified and can no longer operate to the original fluorescent lamp.

