

# ASSEMBLY INSTRUCTIONS – 3-WINDOW SHADOW BOX

**ASSEMBLY INSTRUCTIONS Shelf Display:** Carefully remove this piece, and the assembly-photos panel from the printed body by breaking the small connecting tabs.

**There are 5 pieces:** (1) printed body, and (4) internal supports (2 short and 2 long) on one sheet. The internal supports may also be attached to each other by an incomplete die-cut.

**Carefully separate.**

**STEP 1:** Fold each internal support into a rectangular shape, moving each panel towards a score line. Insert the tabs into the slots and push to lock.

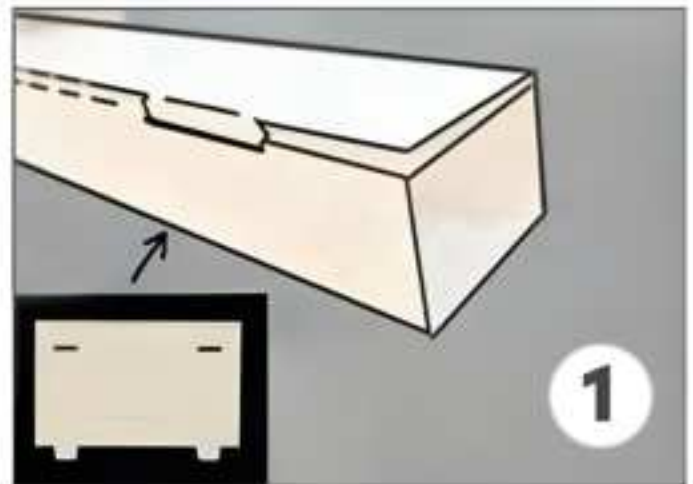

**STEP 2:** Ensure your work area is clean to avoid damaging the decorative exterior. Open the printed body so the vertical folding panels with 4 sets of "II" notch die-cuts is on your left, and the printing is facing down.

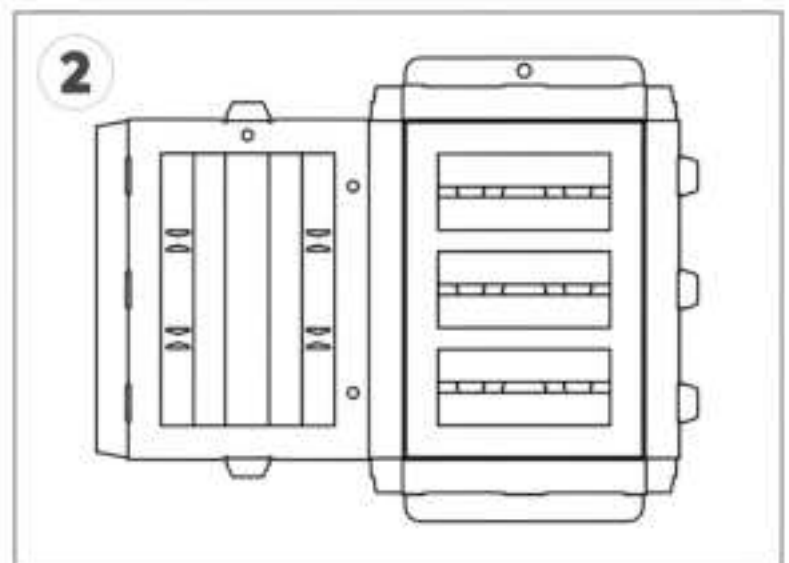

**STEP 3:** Gently fold the "II" notch panels upward and outward so they form right angles.



**STEP 4:** Moving left to right, gently fold over the entire panel so it starts forming a box with the front. As you fold, keep the inside pieces at right angles. These will form side walls inside the display.

**TIP:** Prior to folding over, carefully pre-fold the panels at each score line. This will help prevent the cardboard from breaking at unintended areas.



**STEP 5:** While holding the display together with your right hand, insert the short internal supports. The tabs on each end of the short support will insert into the "II" die-cut areas – stabilizing them in place.

**IMPORTANT:** The short supports have exposed slots once folded – 2 small slots on one side, and 1 large slot on the other. When inserting the short supports, ensure that the slots are not on the work-table side, **AND** ensure the slots **ALIGN** with the corresponding large and small tabs on the opposing panel. Once the short supports are in place, the corresponding 3 side tabs holding the front and back together can be inserted.

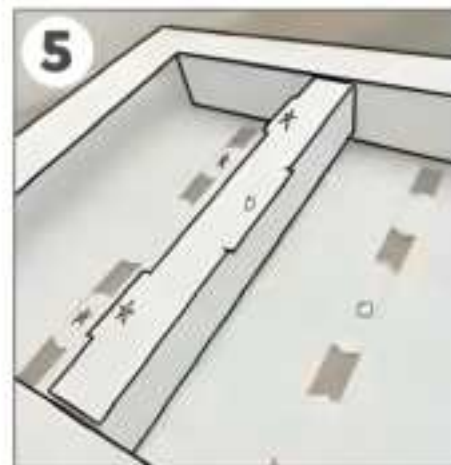



**STEP 6:** Insert the long supports into each open end, ensuring the exposed slot is away from the work-table side, **AND** the slots align with the tabs on the panels that will be locked into it. The long support with one large, centered slot will be on the side with one large center tab.

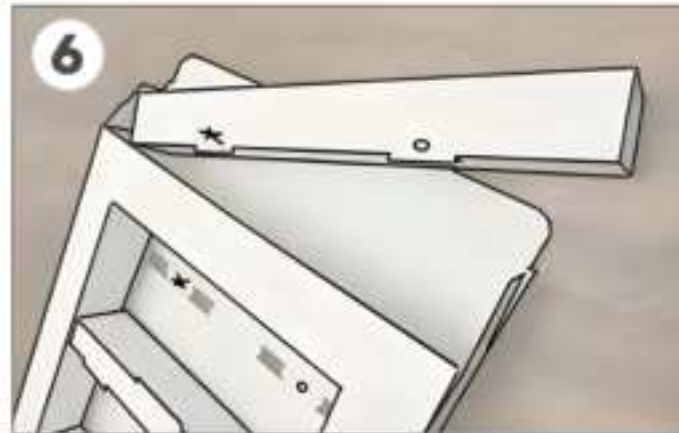

**STEP 7:** Close each end by folding in the side fins and main flap. Insert the tab into the slot and lock. (no diagram for step 7)

**STEP 8:** Fold the inside frame panels upward, fold the tabs inward, and insert into the internal support slots. When in place, these panels will form the shelf floor or ceiling for your collectible's space.

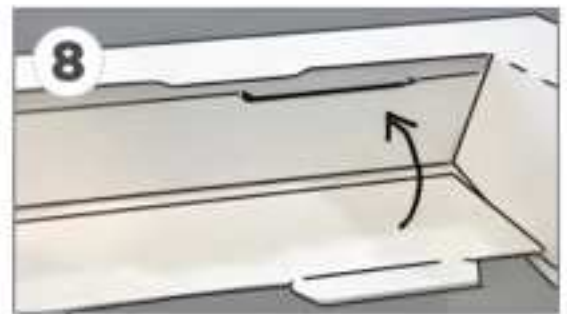

**STEP 9:** Printed background sheets can be inserted into die-cut notches on back, and held firmly with a clear tape.

