



COMPONENT REMOVAL

This section explains how to remove components from a Wolf CE Series. Depending on which component you are going to remove, you may have to remove other components first. Refer to the appropriate section in this manual that explains how to remove those various components. When reassembling, just reverse the steps that were used to remove the components.

NOTE: Before attempting to access or remove any components from a Wolf appliance, take note of the **WARNINGS** and **CAUTIONS** below.

WARNING

- **TO AVOID ELECTRIC SHOCK, POWER TO THE UNIT MUST BE DISCONNECTED WHENEVER SERVICING AND/OR ACCESSING COMPONENTS.**
- **KEEP IN MIND THAT COOKTOP SURFACES AND COMPONENTS GET HOT DURING USE OF THE APPLIANCE.**
- **PULLING A UNIT FROM ITS INSTALLATION SHOULD ONLY BE PERFORMED BY A CERTIFIED SERVICE TECHNICIAN OR INSTALLER.**

CAUTION

- **When working on the cooktop and components, be careful when handling sheet metal parts. They may have sharp edges.**

Tools Needed

- 6-Lobe Torx type driver size T-15
- 1/4" nut driver or socket
- 11/32" nut driver or socket
- Phillips screw driver
- Small Phillips screw driver
- Small flat blade screw driver
- Needle nose pliers

Glass Top

To remove the glass top, first remove the cooktop from the installation, then (See Figure 3-1):

1. Use a Phillips screw driver or a 1/4" nut driver to extract screws from front frame.
2. Use a Phillips screw driver or a 1/4" nut driver to extract screws from back frame.
3. Remove glass top.
4. Disconnect Low Voltage (LV) wire harness from power board.
5. Disconnect Element wire harness from power board.

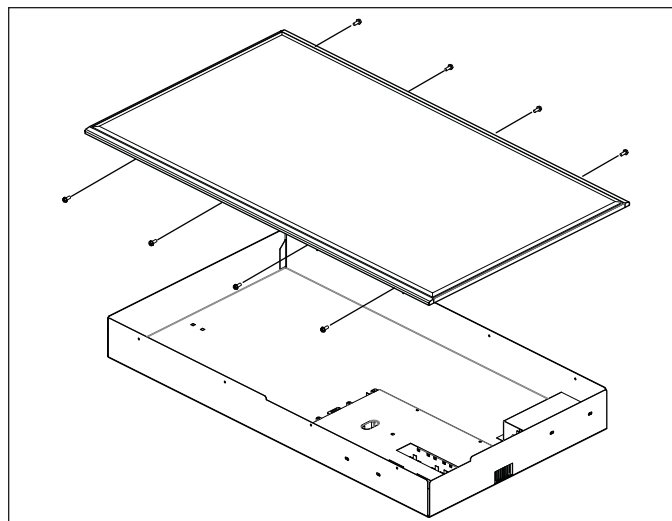

Figure 3-1. Glass Top Screws

Element Assembly

To remove the element assembly, first remove the glass top, then (See Figure 3-2):

1. Make note of wire locations first, then disconnect spade terminals from the element assembly.
2. Use a T-15 Torx driver to extract the screws that retain the element springs.
3. Remove the element springs.
4. Use a T-15 Torx driver to extract the screw holding the element bracket to the element assembly.
5. Remove the element brackets.
6. Remove element assembly.

Control Board

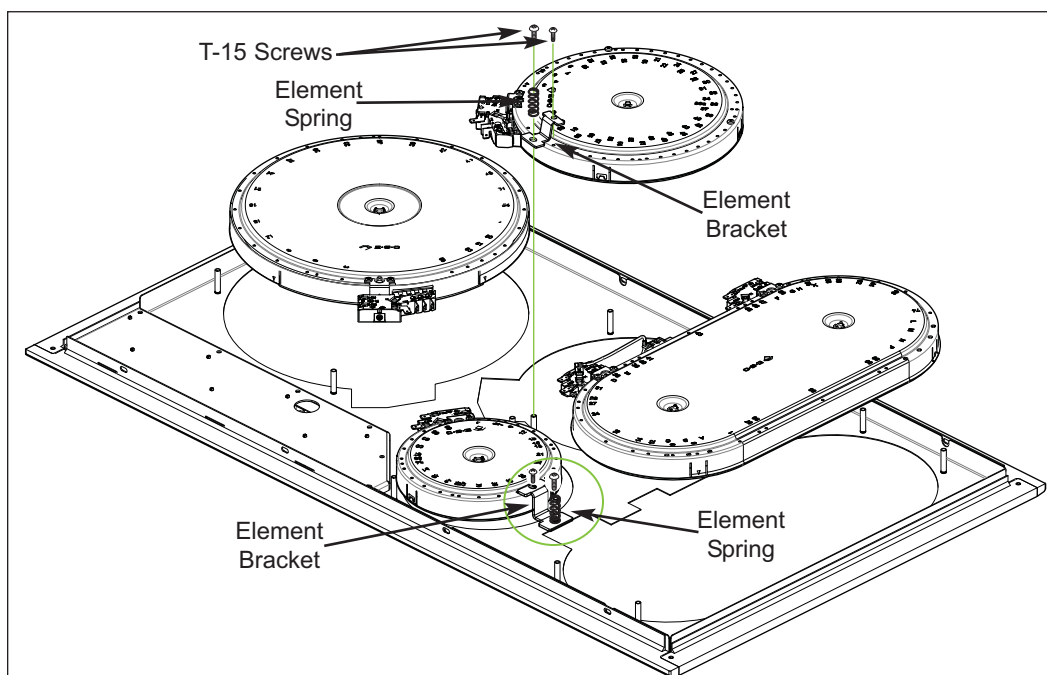

Figure 3-2. Element Assemblies

To remove the control board, first remove the glass top, then (See Figure 3-3):

1. Use a Phillips screw driver to extract the screws from the control board bracket.
2. Remove control board bracket and control board.
3. Use needle nose pliers to compress top of control board support and lift control board off of control board support.
4. Proceed to next control board support until control board is removed from all control board supports.
5. Disconnect LV wire harness from control board.
6. Remove control board.

NOTE: When installing a new control board assure the LV wire harness grommet is installed correctly.

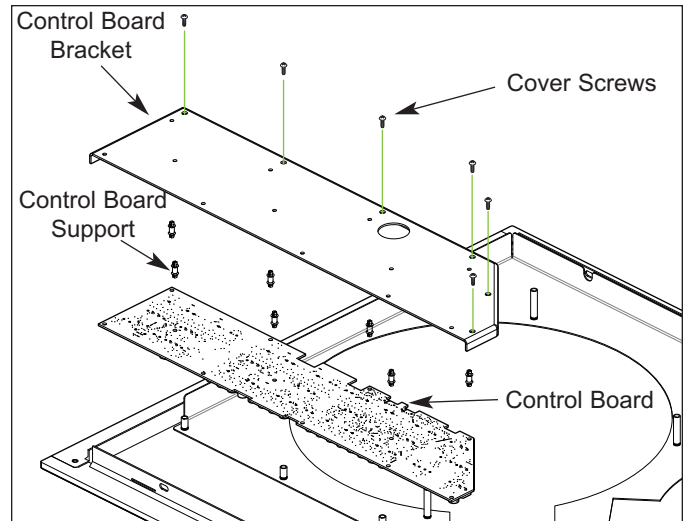

Figure 3-3. Control Board

LV Wire Harness

To remove the LV wire harness, first remove the control board, then:

1. Remove grommet from control board bracket.
2. Remove LV wire harness from power board.

NOTE: LV Wire Harness has a grommet on it. It is important to install the grommet to prevent moisture from entering the control board enclosure.

Power Board

To remove the power board first remove the glass top, then (See Figure 3-4):

1. Disconnect the LV wire harness from power board.
2. Disconnect the element wire harness from the power board.
3. Disconnect power wire harness from power board.
4. Use a 11/32" nut driver or socket to extract nuts from the power board cover.
5. Use a 1/4" nut driver or Phillips screw driver to extract screws from the power board cover.
6. Remove power board cover
7. Remove the power board.

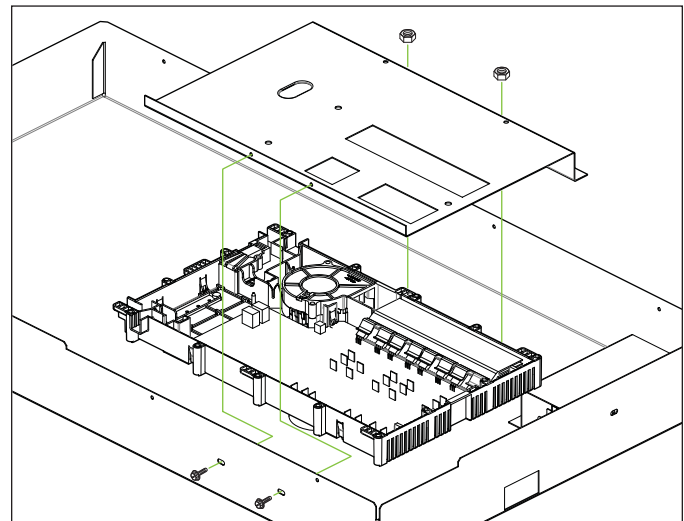

Figure 3-4. Power Board

Fan Assembly

To remove the fan assembly, first remove the power board bracket, then (See Figure 3-5):

1. Press connector tab in and disconnect fan assembly connector from power board.
2. Use a small flat blade screw driver to spread the fan assembly retainer tabs slightly to release fan assembly.
3. Remove the fan assembly.

Terminal Block and Power Conduit

To remove the terminal block or power conduit first remove the glass top, then (See Figure 3-6):

1. Use a 11/32" nut driver or socket to extract nuts from the cable cover.
2. Use a 1/4" nut driver or Phillips screw driver to extract screws from the cable cover.
3. Remove the cable cover.
4. Disconnect the power harness from the terminal block.
5. **For terminal block only:** use a Phillips screw driver to extract the Phillips screws.
6. Remove terminal block.
7. **For power conduit:** use a 11/32" nut driver to remove the nut from ground wire hold down stud.
8. Lift the front of conduit mounting bracket and remove conduit mounting bracket from burner box.

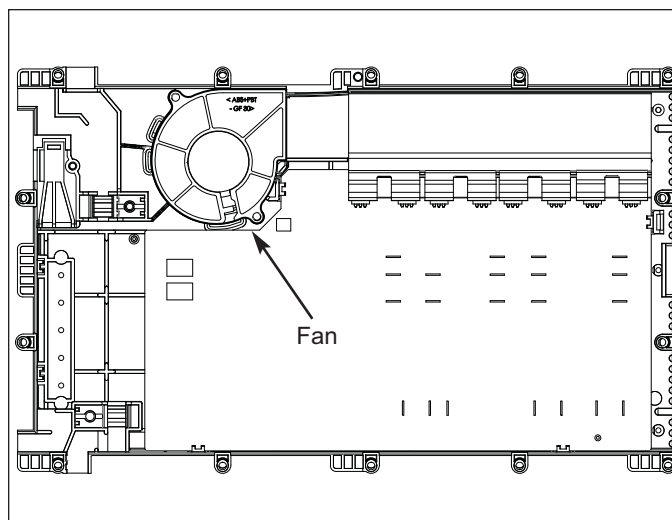

Figure 3-5. Fan Assembly

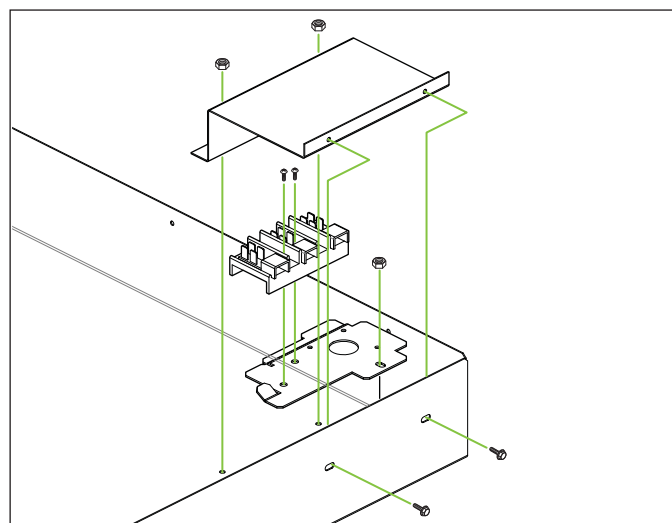

Figure 3-6. Terminal Block and Power Conduit