

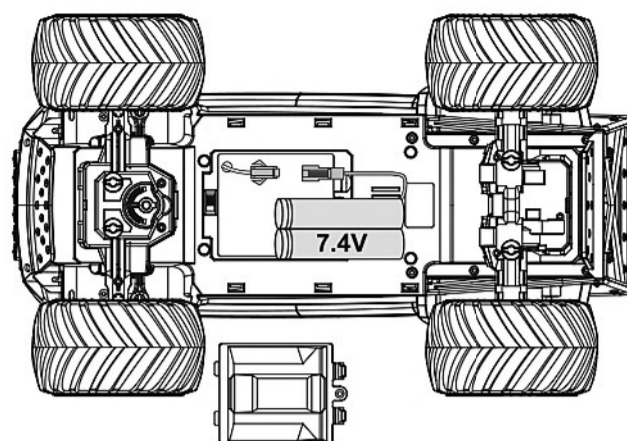

1. Know your remote control



3. The Installation of the RC car battery



RC car (battery included)

Accessories:

1. USB charging cable
2. Rechargeable battery (included)

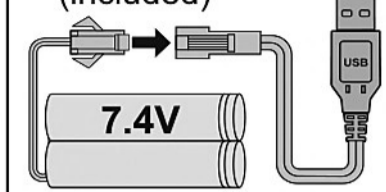

Note:

Remove the battery if you do not use it for a long time.

2. Installing batteries and pairing the controller

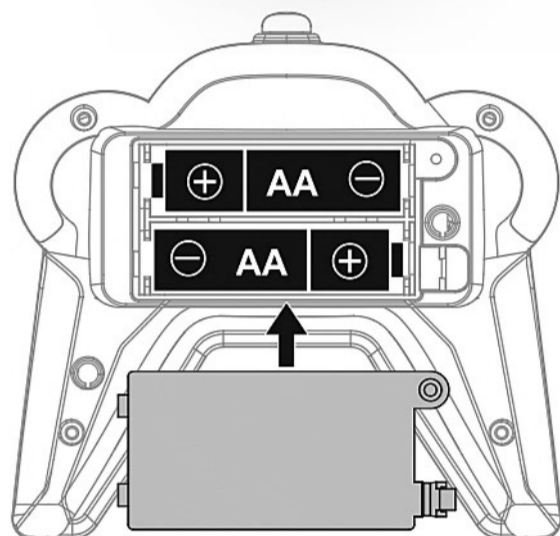

The remote uses
2x1.5V "AA" batteries
(batteries not included)

Attention for Charging via USB

1. Battery should be fully charged for the first time using. The battery will still self-discharge when not in use. If not in use for a long time, please ensure that the battery has about half of the power to prevent over discharge damage. Overcharging can shorten battery life.
2. Please regularly check the cord, plug, casing and other accessories and stop using before being repaired if any damages are found.
3. Do not connect the toys with the power that is not recommended. Charging conditions: Connect the USB smart charging cable with the original battery.
4. Please use appropriate adapter instead of fast charger for charging.
5. Please use the right adapter for charging. Input: 100-240V~50/60Hz 0.2A; output: 5.0V 500mA 0.5-1.5A.
6. Charging notes: To charge the battery, please connect the battery with smart USB charging cable, which has access to power media with USB interface, such as: desktop, laptop, mobile power, USB socket. Alternatively, you can use a USB adapter to connect with the power for charging.
7. Please remove the battery for the remote control truck and the remote controller if they are not expected to use for a long period of time.
8. When charging, the USB light is steady on. When fully charged, the light goes off.

4. Driving with the remote control

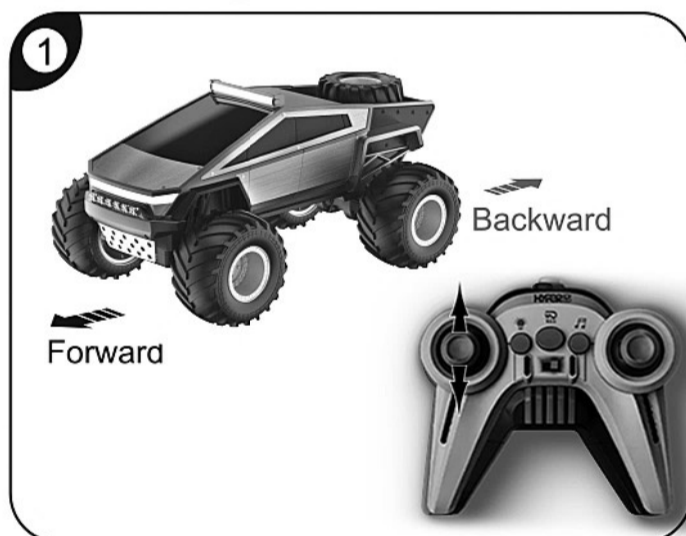

1. Forward/Backward

Push the left joystick up/pull it back to move the car forward/backward.

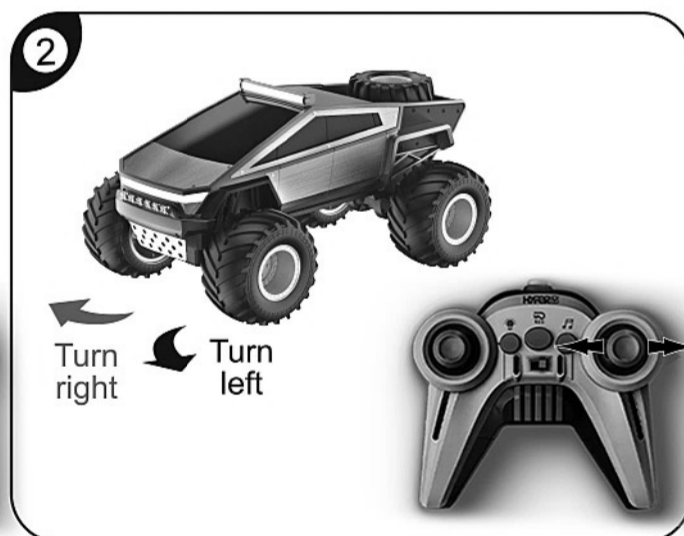

2. Turn left/Turn right

Push the right joystick to the left/right to make the RC car turn left/right.



3. Light switch

Press the light switch button on the remote to control the lights of the RC car to turn on/flash/stay on/turn off.



4. Auto demo

Press the auto demo button on the remote to start the auto demo.

Battery Storage

1. Do not fully charge the battery before keeping it for a long time, otherwise it would result in the passivation, which speeds up the process of self-discharge.
2. Place the battery in dry indoor space with appropriate temperature between 10°C-30°C.
3. Conduct a charge cycle every other 3 months to keep it active and perform well.

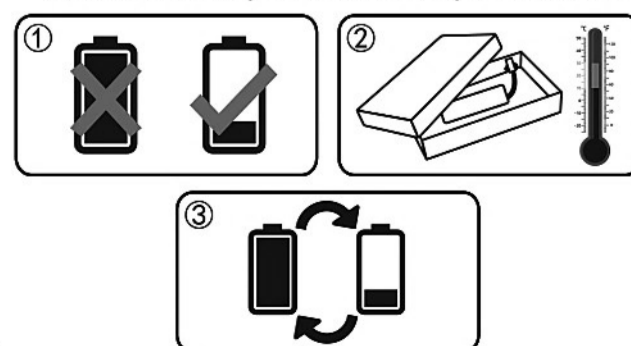

This device contains licence-exempt transmitter(s)/receiver(s) that comply with Innovation, Science and Economic Development Canada's licence-exempt RSS(s). Operation is subject to the following two conditions:

1. This device may not cause interference.
2. This device must accept any interference, including interference that may cause undesired operation of the device.

This equipment complies with IC RSS-102 radiation exposure limits set forth for an uncontrolled environment.

FCC Compliance Statements

This device complies with Part 15 of the FCC Rules. Operation is subject to the following two conditions: (1) this device may not cause harmful interference, and (2) this device must accept any interference received, including interference that may cause undesired operation.

Note: This equipment has been tested and found to comply with the limits for a Class B digital device, pursuant to Part 15 of the FCC Rules. These limits are designed to provide reasonable protection against harmful interference in a residential installation. This equipment generates, uses and can radiate radio frequency energy and, if not installed and used in accordance with the instructions, may cause harmful interference to radio communications. However, there is no guarantee that interference will not occur in a particular installation.

If this equipment does cause harmful interference to radio or television reception, which can be determined by turning the equipment off and on, the user is encouraged to try to correct the interference by one or more of the following measures:

- Reorient or relocate the receiving antenna.
- Increase the separation between the equipment and receiver.
- Connect the equipment into an outlet on a circuit different from that to which the receiver is connected.
- Consult the dealer or an experienced radio/TV technician for help.

Caution: Changes or modifications not expressly approved by the party responsible for compliance could void the user's authority to operate the equipment.

This equipment complies with FCC radiation exposure limits set forth for an uncontrolled environment. This transmitter must not be co-located or operating in conjunction with any other antenna or transmitter.