

Firmware Upgrade

The firmware can be upgraded in three ways: USB, SD card and OTA, so you can choose the appropriate upgrade way according to your device model.

	USB	SD card	Reset	OTA upgrade			Web-OTA
				ecowitt app	Other	ecowitt app	
ecowitt	○	×	×	×	×	×	×
HS2550 LS2550	×	○	○	×	×	×	×
SP300L	×	○	×	×	×	×	×
WS80	○	×	Not developed	×	×	×	×
ecowitt ecowitt	○	×	×	×	×	×	×
ecowitt Gateway (HS1000)	×	×	×	×	×	○	×
ecowitt Gateway (HS1000)	×	×	×	○	○	○	○
GW1000	×	×	×	×	×	○	×
ecowitt Gateway (HS1000) (HS1000)	×	×	×	○	○	○	○
WS1000, WS1000 WS1000, WS1000, WS1000	×	×	×	○	○	○	○

*note: 1. “○” means the firmware can upgrade by this way.

2. “×” means the firmware can not upgrade by this way.

3. If your device is upgraded via USB, you need to prepare a USB; if your device is upgraded via SD card, you need to prepare a SD card with RAM no more than 32G. For cards larger than 32GB, use the Rufus tool to format the SD card to FAT32. Download the tool from <https://rufus.ie/en/>.

Tip: When replacing it with a higher-capacity card, please be mindful of the memory card's maximum read/write cycles and lifespan.

4. You can upgrade your firmware on any network by the ecowitt app-Edit Gateway-way.

1. The USB and SD card upgrade way

Step 1: Search for "ecowitt" in your browser to access the ecowitt homepage.

Step 2: Search for the device name.

Step 3: Click to go to the product detail page.

Step 4: Scroll down and click on "Manual download" in the bottom left corner of the page.

Step 5: Click "Manual & Firmware Download" to view the upgrade help file and download the upgrade package.

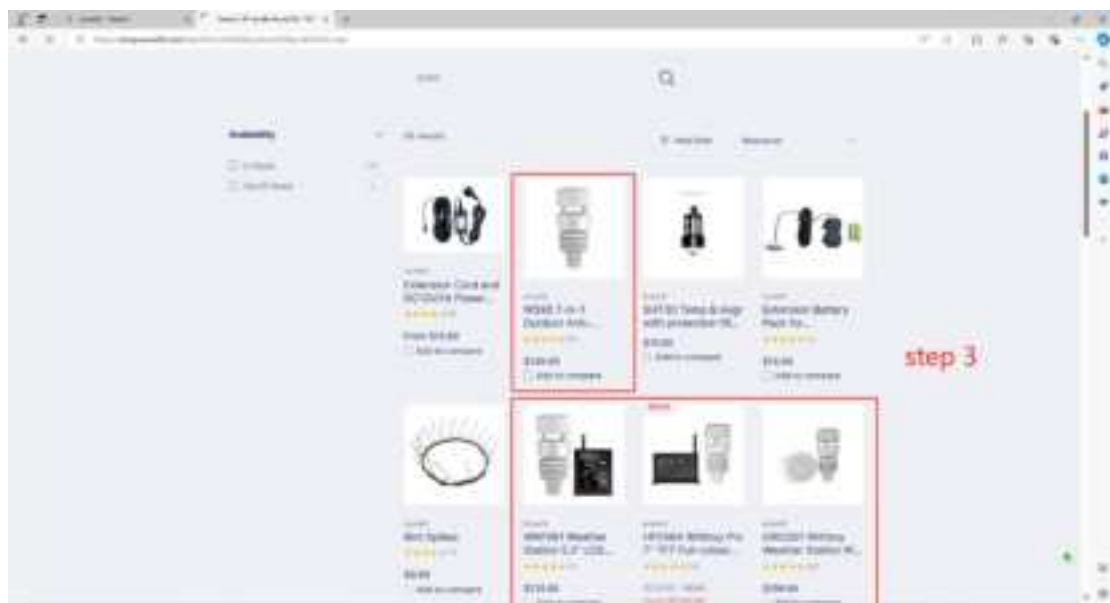
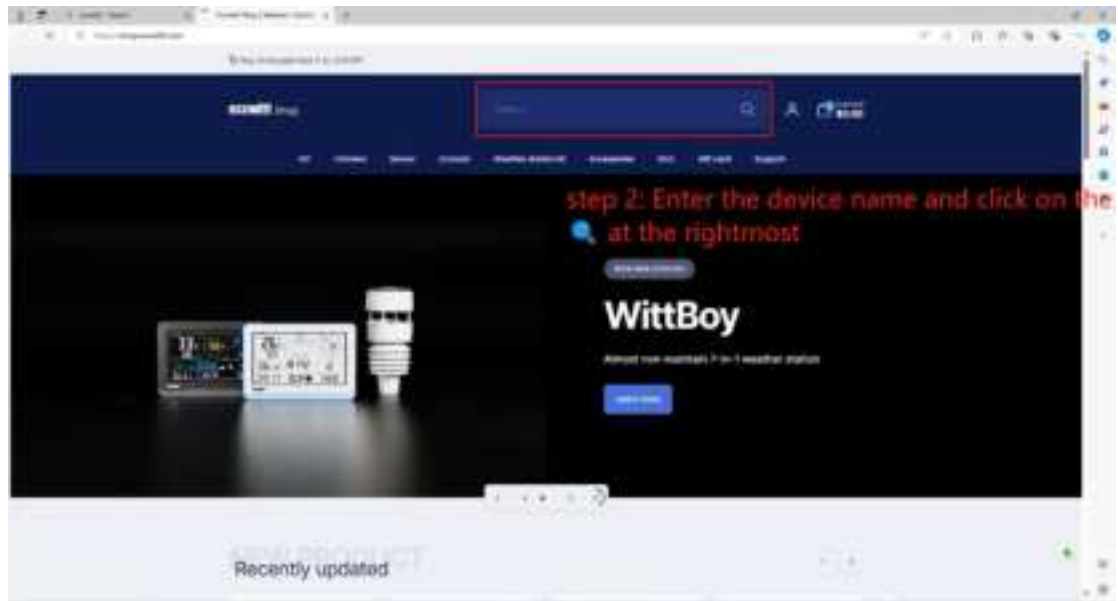

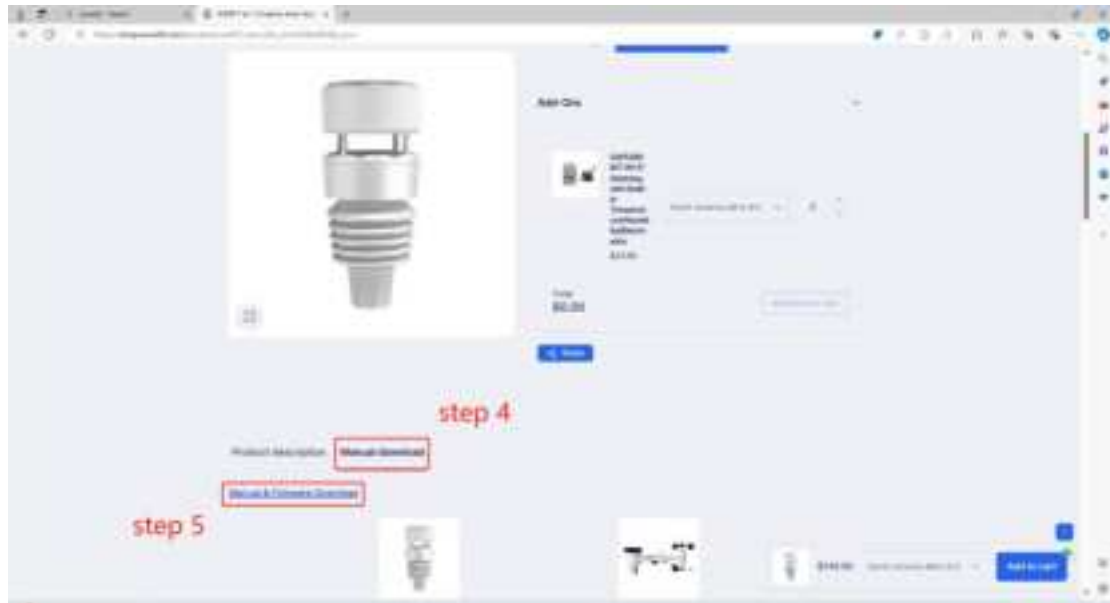

2. The OTA upgrade way

2.1 The host upgrade way

HP2550 and HP2560's host firmware upgrade steps are as follows:

Step 1: Click on the button below the settings until you reach the "Factory" screen.

Step 2: Select the "About".

Step 3: Select "Check firmware".

Step 4: Select "Download" to upgrade host firmware.



Factory

Automatic Clear Max/Min

Clear Max/Min

Reset to Factory

Backup data

Language

Clear History

About

step 2



***note:** The host firmware version should be 1.9.5 and above and the WiFi firmware EasyWeather Pro should be V5.1.4 and above. Otherwise please use the SD card option.

2.2 The ecowitt-Edit Gateway upgrade way

Step 1: Click on “≡” in the top left corner of the ecowitt app.

Step 2: Click on “My Device”.

Step 3: Click on “...” on the right of the device that needs to have its firmware upgrade.

Step 4: Click the blue button to the right of “Version”.

Step 5: Click “Upgrade” to upgrade WiFi firmware.



*note: Upgrade the WiFi firmware without connecting to the WiFi which the device connected to, EasyWeather Pro needs to be upgradd to version V5.1.1 and above, GW1100 and GW2000 need to be upgraded to version V2.2.1 and above.

2.3 The ecowitt-Others upgrade way

Step 1: Confirm your phone WiFi is connected to is the WiFi that the device connected to.

Step 2: In the main interface of the ecowitt app, use the “<” and “>” button at the top to switch the device to which needs to upgrade the firmware.

Step 3: Click on “...” in the upper right corner.

Step 4: Click on “Others”.

Step 5: Click “UPGRADE” to upgrade the WiFi firmware.

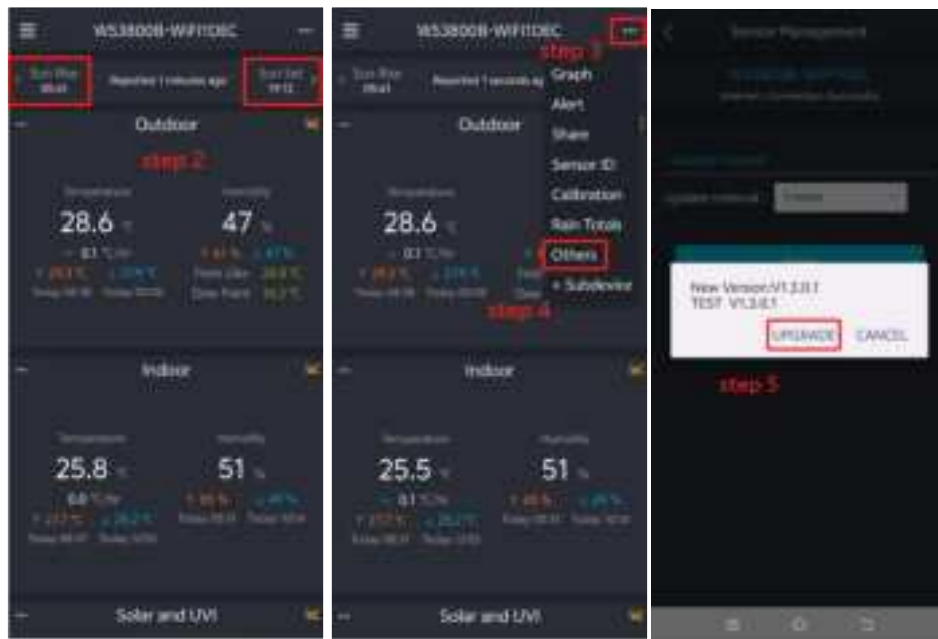

2.4 The WSVIEW Plus app upgrade way

Step 1: Confirm your phone WiFi is connected to is the WiFi that the device connected to.

Step 2: On the "My Device" screen of the WSVIEW Plus app, click on the device which you want to upgrade the WiFi firmware.

Step 3: Click "OK" to upgrade the WiFi firmware.

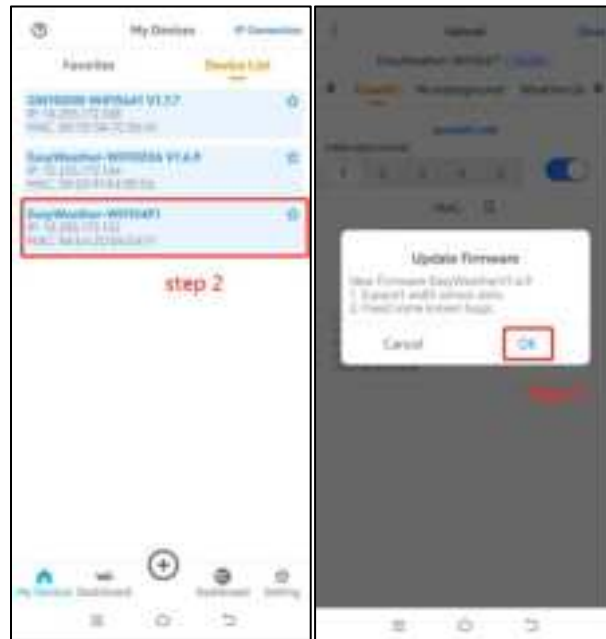

2.5 The Web UI upgrade way

Step 1: Connect your phone WiFi to the device that needs to be upgraded with WiFi firmware.

Step 2: Enter "192.168.4.1" in the search box of your browser to enter the webpage. After entering the webpage, please do not enter your ID and password, and log in directly.

Step 3: If your device is EasyWeather Pro, please see Step 3.1; if your device is not EasyWeather Pro, please see Step 3.2.



Step 3.1: Click "Upgrade Version" on the right side of "Version" to upgrade the WiFi firmware.



Step 3.2: Click "Device Setting".

Step 4: Click "Upgrade Version" on the right side of "Version" to upgrade the WiFi firmware.

