

WORKPRO

W125077A

ORIGINAL OPERATING INSTRUCTIONS 12V GARDEN PRUNING SAW

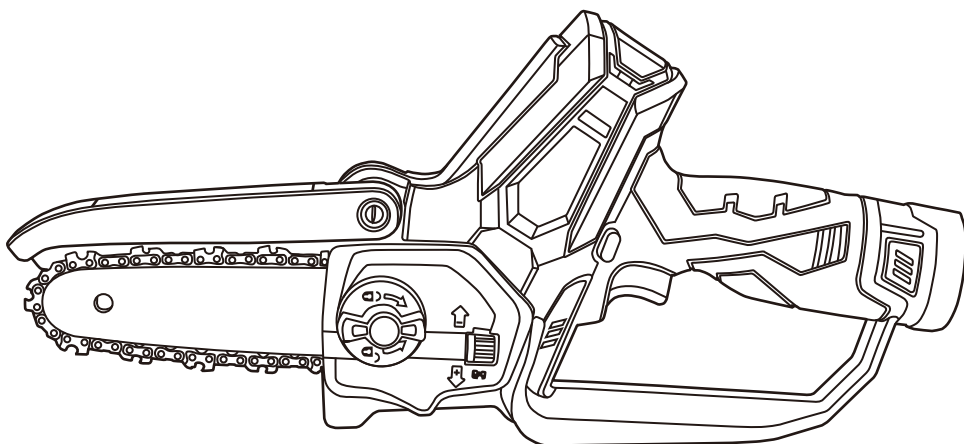







Model #: CPS703-12

Distributed by:
Hangzhou GreatStar Industrial Co., Ltd.
No.35 Jiuhuan Road, Jiubao Town,
Hangzhou 310019, China
www.greatstartools.com
Made in China

SYMBOLS

	To reduce the risk of injury, user must read instruction manual
	Wear ear protection
	Wear eye protection
	Wear dust mask
	Wear head protection
	Beware of pruning saw kickback and avoid contact with bar tip
	Do not expose to rain
	Wear protective gloves
	Wear protective footwear
	Warning of danger from overhead electric-power lines

	Do not burn
	Batteries may enter water cycle if disposed improperly, which can be hazardous for ecosystem. Do not dispose of waste batteries as unsorted municipal waste.
	Waste electrical products must not be disposed of with household waste. Please recycle where facilities exist. Check with your local authorities or retailer for recycling advice.
	Li-Ion battery. This product has been marked with a symbol relating to 'separate collection' for all battery packs and battery pack. It will then be recycled or dismantled in order to reduce the impact on the environment. Battery packs can be hazardous for the environment and for human health since they contain hazardous substances.
	Lock
	Unlock

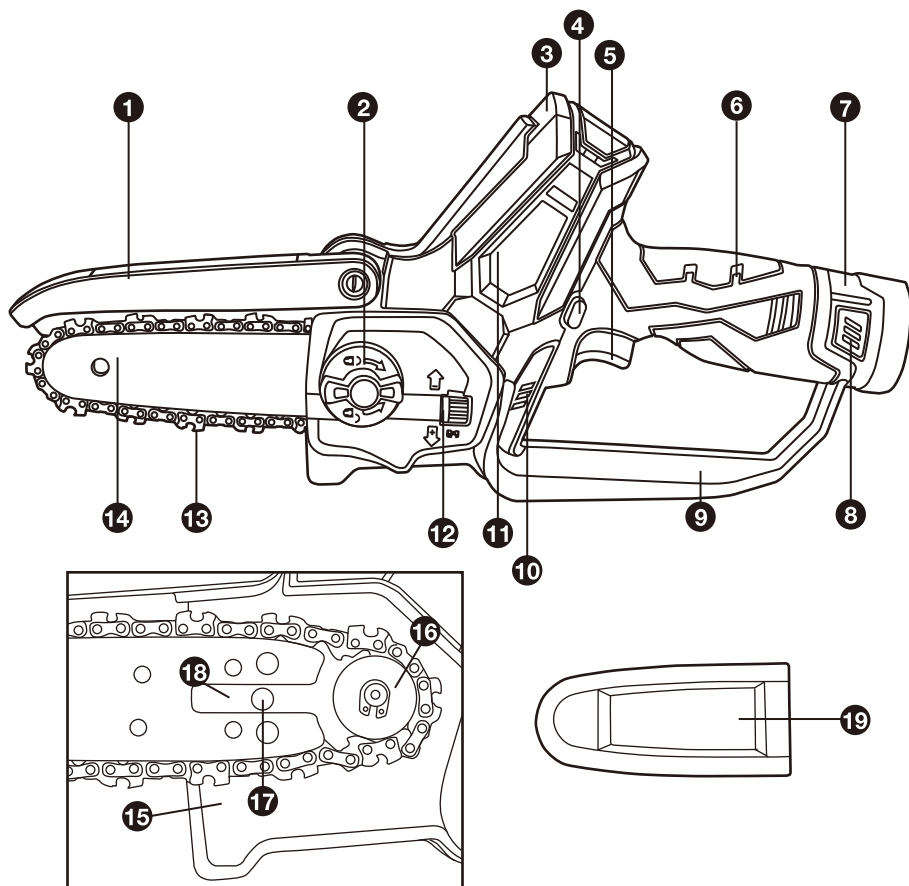

COMPONENT LIST

1. CHAIN GUARD	11. HOUSING-COVER
2. HOUSING-COVER KNOB	12. CHAIN TENSIONING KNOB
3. SECONDARY GRIP AREA	13. CHAIN
4. LOCK-OUT BUTTON	14. GUIDE BAR
5. ON/OFF SWITCH	15. BAR PAD
6. GRIP AREA	16. DRIVE SPROCKET
7. BATTERY PACK*	17. FASTENING BAR BOLT
8. BATTERY PACK RELEASE BUTTON*	18. BAR LOCATING TAB
9. HAND GUARD	19. BAR AND CHAIN SHEATH/SCABBARD
10. INDICATOR LIGHT	

* Not all the accessories illustrated or described are included in standard delivery.

Danger!

When using the equipment, a few safety precautions must be observed to avoid injuries and damage. Please read the complete operating instructions and safety regulations with due care. Keep this manual in a safe place, so that the information is available at all times. If you give the equipment to any other person, hand over these operating instructions and safety regulations as well. We cannot accept any liability for damage or accidents which arise due to a failure to follow these instructions and the safety instructions.

SAFETY REGULATIONS

Warning!

Read all safety warnings, instructions, illustrations and specifications provided with this power tool. Failure to follow all instructions listed below may result in electric shock, fire and/or serious injury.

Save all warnings and instructions for future reference.

The term "power tool" in the warnings refers to your mains-operated (corded) power tool or battery-operated (cordless) power tool.

1) Work area safety

- **Keep work area clean and well lit.** Cluttered or dark areas invite accidents.
- **Do not operate power tools in explosive atmospheres, such as in the presence of flammable liquids, gases or dust.** Power tools create sparks which may ignite the dust or fumes.
- **Keep children and bystanders away while operating a power tool.** Distractions can cause you to lose control.

2) Electrical safety

- **Power tool plugs must match the outlet. Never modify the plug in any way.** Do not use any adapter plugs with earthed (grounded) power tools. Unmodified plugs and matching outlets will reduce risk of electric shock.
- **Avoid body contact with earthed or grounded surfaces, such as pipes, radiators, ranges and refrigerators.** There is an increased risk of electric shock if your body is earthed or grounded.
- **Do not expose power tools to rain or wet conditions.** Water entering a power tool will increase the risk of electric shock.
- **Do not abuse the cord. Never use the cord for carrying, pulling or unplugging the power tool.** Keep cord away from heat, oil, sharp edges or moving parts. Damaged or entangled cords increase the risk of electric shock.

- **When operating a power tool outdoors, use an extension cord suitable for outdoor use.** Use of a cord suitable for outdoor use reduces the risk of electric shock.
- **If operating a power tool in a damp location is unavoidable, use a residual current device (RCD) protected supply.** Use of an RCD reduces the risk of electric shock.

3) Personal safety

- **Stay alert, watch what you are doing and use common sense when operating a power tool.** Do not use a power tool while you are tired or under the influence of drugs, alcohol or medication. A moment of inattention while operating power tools may result in serious personal injury.
- **Use personal protective equipment. Always wear eye protection.** Protective equipment such as a dust mask, non-skid safety shoes, hard hat or hearing protection used for appropriate conditions will reduce personal injuries.
- **Prevent unintentional starting. Ensure the switch is in the off-position before connecting to power source and/or battery pack, picking up or carrying the tool.** Carrying power tools with your finger on the switch or energising power tools that have the switch on invites accidents.
- **Remove any adjusting key or wrench before turning the power tool on.** A wrench or a key left attached to a rotating part of the power tool may result in personal injury.
- **Do not overreach.** Keep proper footing and balance at all times. This enables better control of the power tool in unexpected situations.
- **Dress properly.** Do not wear loose clothing or jewellery. Keep your hair and clothing away from moving parts. Loose clothes, jewellery or long hair can be caught in moving parts.
- **If devices are provided for the connection of dust extraction and collection facilities, ensure these are connected and properly used.** Use of dust collection can reduce dust-related hazards.
- **Do not let familiarity gained from frequent use of tools allow you to become complacent and ignore tool safety principles.** A careless action can cause severe injury within a fraction of a second.

4) Power tool use and care

- **Do not force the power tool.** Use the correct power tool for your application. The correct power tool will do the job better and safer at the rate for which it was designed.
- **Do not use the power tool if the switch does not turn it on and off.** Any power tool that cannot be controlled with the switch is dangerous and must be repaired.

- **Disconnect the plug from the power source and/or remove the battery pack, if detachable, from the power tool before making any adjustments, changing accessories, or storing power tools.** Such preventive safety measures reduce the risk of starting the power tool accidentally.
- **Store idle power tools out of the reach of children and do not allow persons unfamiliar with the power tool or these instructions to operate the power tool.** Power tools are dangerous in the hands of untrained users.
- **Maintain power tools and accessories. Check for misalignment or binding of moving parts, breakage of parts and any other condition that may affect the power tool's operation.** If damaged, have the power tool repaired before use. Many accidents are caused by poorly maintained power tools.
- **Keep cutting tools sharp and clean.** Properly maintained cutting tools with sharp cutting edges are less likely to bind and are easier to control.
- **Use the power tool, accessories and tool bits etc.** in accordance with these instructions, taking into account the working conditions and the work to be performed. Use of the power tool for operations different from those intended could result in a hazardous situation.
- **Keep handles and grasping surfaces dry, clean and free from oil and grease.** Slippery handles and grasping surfaces do not allow for safe handling and control of the tool in unexpected situations.

5) Service

- Have your power tool serviced by a qualified repair person using only identical replacement parts. This will ensure that the safety of the power tool is maintained.

6) Battery tool use and care

- a. Ensure the switch is in the off position before inserting battery pack. Inserting the battery pack into power tools that have the switch on invites accidents.
- b. Recharge only with the charger specified by the manufacturer. A charger that is suitable for one type of battery pack may create a risk of fire when used with another battery pack.
- c. Use power tools only with specifically designated battery packs. Use of any other battery packs may create a risk of injury and fire.
- d. When battery pack is not in use, keep it away from other metal objects like paper clips, coins,

keys, nails, screws, or other small metal objects that can make a connection from one terminal to another.

Shorting the battery terminals together may cause burns or a fire.

e. Under abusive conditions, liquid may be ejected from the battery; avoid contact. If contact accidentally occurs, flush with water. If liquid contacts eyes, additionally seek medical help. Liquid ejected from the battery may cause irritation or burns.

ADDITIONAL SAFETY INSTRUCTIONS FOR THE CHARGER

Your WORKPRO tool with Lithium Ion batteries may only be charged with the specific designed WORKPRO Lithium Ion battery charger purchased with the tool.

IT IS DANGEROUS TO USE ANY OTHER BATTERY CHARGER TO CHARGE YOUR TOOL.

Do not attempt to charge the battery pack with any other charger than the one supplied.

Before using the charger, read all the instructions, labels and cautionary markings on the charger and battery pack as well as the instructions on using the battery pack.

Do not use the charger if it has been subjected to a heavy knock, dropped or otherwise damaged in anyway. Take the charger to an authorised service centre for a check or repair.

Do not disassemble the charger. Opening or removing covers may expose you to dangerous voltages or other risks. Incorrect reassembly can cause electric shock when you use the tool or charger again. Take the charger to a power tool repair centre when service or repair is required.

 **DANGER.** If the battery pack is cracked or damaged in any other way, do not insert it in the charger.

Do not plug anything other than your WORKPRO tool into the charger, as other objects may touch dangerous voltage points or short out parts, which could result in fire or electric shock.

Do not place the tool or charger on an uneven surface, as a fall may cause serious damage.

Never place the tool or charger near or over a heat source such as a radiator or heater.

Do not operate the charger in a cabinet or other enclosure unless proper ventilation is provided.

Use the battery charger indoors only.

 **WARNING.** Do not allow any liquid to come into

contact with the charger. There is a danger of electric shock. Do not position the tool or battery charger near water; for example, near a sink, wash bowl or toilet. Do not spill liquid of any kind on the tool or charger. Doing so may short out parts, causing damage to the product and creating the risk of fire or electric shock.

To reduce the risk of an electric shock, unplug the charger from the power supply before attempting to clean it. To clean tool or charger, wipe with a damp cloth. Use of any other cleaners is not recommended.

Do not place any object on to, or allow anything to rest on the charger.

Make sure that the charger cable is positioned where it will not be stepped on, tripped over or otherwise subjected to damage or stress. Keep the lead away from operating machinery.

Do not pull on the lead of the charger to disconnect it from the mains power socket.

Do not use an extension cord unless it is absolutely necessary. The use of an improper extension cord could cause the risk of fire, electric shock or electrocution.

Never attempt to connect two chargers together.

Do not charge batteries or use the tool and battery pack in locations where the temperature may be below 40°F(4°C) or exceed 104°F(40°C) such as alongside sheds or metal structures.

If you wish to charge a second battery pack, unplug the charger from the mains supply and leave it for at least 15 minutes. After this time you can charge a second battery pack.

ADDITIONAL SAFETY INSTRUCTIONS RELATED TO THE BATTERY PACK AND BATTERY SAFETY

Use only the WORKPRO batteries supplied with the WORKPRO Tool or WORKPRO-approved replacements.

Do not use the battery to power any device other than the WORKPRO tool it was sold with.

Charge the battery only with the WORKPRO charger supplied with the tool or WORKPRO-approved replacements and according to the instructions in the WORKPRO Instruction Manual.

Do not charge the battery in a place where static electricity is generated nor let the battery touch something that is statically charged.

The battery can be stored at temperatures between 40°F(4°C) and 104°F(40°C).

Never store or leave your lithium ion battery in temperatures over that recommended otherwise fire may occur.

DO NOT store the Lithium Ion battery anywhere

that the temperature can easily reach higher temperatures than recommended -this includes garden type sheds, and vehicles where the inside temperature can climb to dangerous levels in the direct sunlight and on high temperature days. **THINK BEFORE LEAVING YOUR LITHIUM ION BATTERY PACK IN STORAGE.**

The battery can be charged or operated at temperatures between 40°F(4°C) and 104°F(40°C). **NEVER CHARGE YOU LITHIUM ION BATTERY BELOW OR ABOVE TEMPERATURES RECOMMENDED OTHERWISE FIRE OR SERIOUS DAMAGE TO THE BATTERY PACK MAY OCCUR.**

The most suitable temperatures to charge the battery pack are between 68°F(20°C) -77°F(25°C).

Always allow the battery pack to cool down after charging, do not place it in a hot environment such as a metal shed or open trailer left in the sun.

Take care where the tool is stored. Do not store in areas of corrosive fumes, or salt air or similar conditions. Try and store the tool in the packaging supplied with the tool.

Do not dispose of the battery in a fire or put the battery into a microwave oven, conventional oven, dryer, or high-pressure container. Under these conditions, the battery may explode.

Never attempt to open the battery pack, puncture the battery or subject the battery to strong physical shock.

If the plastic housing of the battery pack breaks open or cracks, immediately discontinue its use and do not recharge it. Ensure the battery pack clip is in good condition and will not allow the pack to fall free from the tool. If the clip is damaged or for any reason is not locking the pack in place, Do Not continue to use.

Stop using the battery if it exhibits abnormal heat, odour, colour, deformation, or is in an abnormal condition.

If you detect leakage or a foul odour, it is especially important to keep the battery away from fire. If battery liquid leaks onto your skin or clothes, wash well with clean water immediately. If liquid leaking from the battery gets into your eyes, do not rub your eyes. Rinse your eyes well (for at least 10 minutes) with clean water, and consult a doctor immediately.

Do not use a leaking battery.

Handle batteries with care to avoid shorting the battery with conducting materials, such as nails, screws, metal watch bands, rings, bracelets, and keys. The battery may overheat and could burn you.

After the battery has reached the end of its useful life, we recommend recycling the materials at your local municipal council recycling centre. DO NOT attempt to replace the battery cells in the battery pack, repair or modify any part of the battery pack

assembly.

When recycling, make it nonconductive by applying insulating tape to the terminals located on the battery.

WHEN TO CHARGE THE BATTERY

New batteries are shipped in a low charged condition and should be fully charged before Use. The battery pack can be recharged at any time during use, provided the pack is not overheated.

If the battery pack starts to cut out due to low voltage, or previous tasks undertaken can no longer be performed, it is suggested to stop using the tool and recharge the battery.

For storage, it is suggested to recharge the battery between 50% and 75% charge.

SAFETY INSTRUCTION FOR PRUNING SAW

⚠ WARNING: Drilling, sawing, sanding or machining wood products can expose you to wood dust, a substance known to the State of California to cause cancer. Avoid inhaling wood dust or use a dust mask or other safeguards for personal protection. For more information go to www.P65Warnings.ca.gov/wood.

- a) Keep all parts of the body away from the saw chain when the pruning saw is operating. Before you start the pruning saw, make sure the saw chain is not contacting anything. A moment of inattention while operating pruning saws may cause entanglement of your clothing or body with the saw chain.
- b) Always hold the pruning saw with your one hand on the Grip Area (6) and your other hand on the Secondary Grip Area (3). Holding the pruning saw improperly increases the risk of personal injury and should never be done.
- c) Hold the pruning saw by insulated gripping surfaces only, because the saw chain may contact hidden wiring. Saw chains contacting a live wire may make exposed metal parts of the pruning saw live and could give the operator an electric shock.
- d) Wear safety glasses protection. Further protective equipment for hearing, head, hands, legs and feet is recommended. Adequate protective clothing will reduce personal injury by flying debris or accidental contact with the saw chain.
- e) Do not operate a pruning saw in a tree, on a ladder, from a rooftop, or any unstable support. Operation of a pruning saw in this manner could result in serious personal injury.
- f) Always keep proper footing and operate the pruning saw only when standing on fixed, secure and level surface. Slippery or unstable surfaces may cause a loss of balance or control of the

pruning saw.

- g) When cutting a limb that is under tension, be alert for spring back. When the tension in the wood fibers is released, the spring loaded limb may strike the operator and/or throw the pruning saw out of control.
- h) Use extreme caution when cutting brush and saplings. The slender material may catch the saw chain and be whipped toward you or pull you off balance.
- i) Carry the pruning saw with the pruning saw switched off and away from your body. When transporting or storing the pruning saw, always fit the guide bar cover. Proper handling of the pruning saw will reduce the likelihood of accidental contact with the moving saw chain.
- j) Follow instructions for lubricating, chain tensioning and changing the bar and chain. Improperly tensioned or lubricated chain may either break or increase the chance for kickback.
- k) Cut wood only. Do not use pruning saw for purposes not intended. For example: do not use pruning saw for cutting metal, plastic, masonry or non-wood building materials. Use of the pruning saw for operations different than intended could result in a hazardous situation.
- l) This pruning saw is not intended for tree felling. Use of the pruning saw for operations different than intended could result in serious injury to the operator or bystanders.
- m) Follow all instructions when clearing jammed material, storing or servicing the pruning saw. Make sure the switch is off and the battery pack is removed. Unexpected actuation of the pruning saw while clearing jammed material or servicing may result in serious personal injury.
- n) Recommendation that the first-time user should, as a minimum, practice cutting logs on a saw-horse or cradle.
- o) Recommendation to have sharpening and maintenance of the saw chain performed by authorized service centers.

CAUSES AND OPERATOR PREVENTION OF KICK-BACK

Kickback may occur when the nose or tip of the guide bar touches an object, or when the wood closes in and pinches the saw chain in the cut.

Tip contact in some cases may cause a sudden reverse reaction, kicking the guide bar up and back towards the operator.

Pinching the saw chain along the top of the guide bar may push the guide bar rapidly back towards the operator.

Either of these reactions may cause you to lose control of the saw which could result in serious personal injury. Do not rely exclusively upon the safety devices built into your saw. As a pruning saw user, you should take several steps to keep your cutting jobs free from accident or injury.

Kickback is the result of pruning saw misuse and/or incorrect operating procedures or conditions and can be avoided by taking proper precautions as given below:

- a) Maintain a firm grip, with thumbs and fingers encircling the pruning saw handles, with both hands on the saw and position your body and arm to allow you to resist kickback forces. Kickback forces can be controlled by the operator, if proper precautions are taken. Do not let go of the pruning saw.
- b) Do not overreach and do not cut above shoulder height. This helps prevent unintended tip contact and enables better control of the pruning saw in unexpected situations.
- c) Only use replacement bars and chains specified by the manufacturer. Incorrect replacement guide bars and saw chains may cause chain breakage and/or kickback.
- d) Follow the manufacturer's sharpening and maintenance instructions for the saw chain. Decreasing the depth gauge height can lead to increased kickback.

RESIDUAL RISKS

Even with the intended use of the appliance there is always a residual risk, which can not prevent. According to the type and construction of the appliance the following potential hazards might apply:

- Contact with exposed saw teeth of the saw chain (cutting hazards)
- Access to the rotating saw chain (cutting hazards)
- Unforeseen, abrupt movement of the guide bar (cutting hazards)
- Flung out of parts from the saw chain (Cutting / injection hazards)
- Flung out of parts of the work piece
- Skin contact with the oil
- Loss of hearing, if no required ear protection used during work

CONTENTS OF PACKING

- 1× WORKPRO garden pruning saw
- 1× Guide bar cover
- 3× Chains
- 2× Guide bars
- 1× Charge base

- 1× Adaptor
- 1× Instruction manual
- 1× Lubricant bottle
- 2× 2.0Ah Battery packs
- 1× Carrying case

Technical Data

Rated voltage	12V DC
Battery type	Lithium ion
Battery rated voltage	Maximum 12V nominal 10.8V
Battery capacity	2000mAh
Charging time	Around 1 hour
Charger output	13.5V~2.0A
Guide bar length	158.5mm
Cutting ability	110mm
Chain pitch	7.6 mm
Number of chain drive links	28
Machine weight (chain & bar included)	1.45kg

NOISE INFORMATION

A weighted sound pressure	LpA = 78 dB(A)
KpA	3 dB(A)
A weighted sound power	LwA = 89 dB(A)
KwA	3 dB(A)
Wear ear protection	

VIBRATION INFORMATION

Vibration total values (triaux vector sum) determined according to EN 62841:

Vibration emission value:	ah < 2.6 m/s ²
Uncertainty	K = 1.5 m/s ²

The declared vibration total value and the declared noise emission value have been measured in accordance with a standard test method and may be used for comparing one tool with another.

The declared vibration total value and the declared noise emission value may also be used in a preliminary assessment of exposure.

⚠ WARNING. The vibration and noise emissions during actual use of the power tool can differ from the declared value depending on the ways in which the tool is used especially what kind of workpiece is processed dependant on the following examples and other variations on how the tool is used:

How the tool is used and the materials being cut or drilled.

The tool being in good condition and well maintained.

The use of the correct accessory for the tool and ensuring it is sharp and in good condition.

The tightness of the grip on the handles and if any anti vibration and noise accessories are used.

And the tool is being used as intended by its design and these instructions.

This tool may cause hand-arm vibration syndrome if its use is not adequately managed.

⚠ WARNING. To be accurate, an estimation of exposure level in the actual conditions of use should also take account of all parts of the operating cycle such as the times when the tool is switched off and when it is running idle but not actually doing the job. This may significantly reduce the exposure level over the total working period.

Helping to minimise your vibration and noise exposure risk.

Always use sharp chisels, drills and blades.

Maintain this tool in accordance with these instructions and keep well lubricated (where appropriate).

If the tool is to be used regularly then invest in anti vibration and noise accessories.

Plan your work schedule to spread any high vibration tool use across a number of days.

INTENDED USE

- The pruning saw is intended for cutting only wood and branches up to a diameter corresponding to the length of the pruning saw guide bar.
- The pruning saw must be used at ground level or from a suitable platform that is completely stable and secure.
- During using, the pruning saw should be held in both hands, right hand on the Grip Area and left hand on the Secondary Grip Area.
- The pruning saw is intended for outdoor use only.

- The pruning saw is not intended for any other use.
- Mounting of parts on the pruning saw is authorized only for original or manufacturer-approved spare parts (chain guides or saw chains for example) as well as for authorized chain guide / saw chain combinations as indicated in the manual.
- The user is responsible for any accident resulting from improper use or unauthorized modification of the pruning saw.

ASSEMBLY

⚠ WARNING. Do not install the battery pack before it has been completely assembled.

Always use gloves when handling the chain.

MOUNTING THE SAW CHAIN (See Fig. A1—Fig. D)

- 1) Unpack all parts carefully. Remove the Housing-Cover by turning the Housing-Cover Knob in a counterclockwise direction. (See Fig. A1)

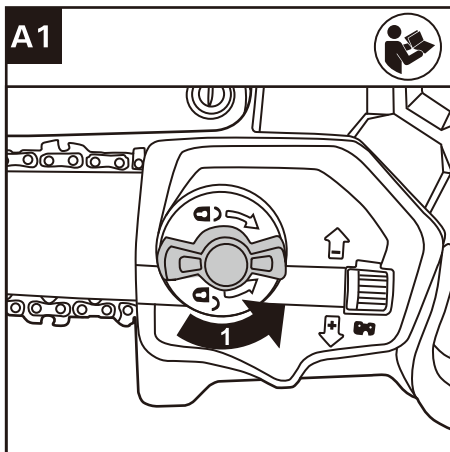

- 2) Place the pruning saw on a solid, level surface.
- 3) Use only recommended saw chain for Guide Bar.
- 4) Slide the Chain in the slot around the Guide Bar. Ensure the Chain is in correct running direction by comparing it to the chain icon on the Guide Bar, or referring to the chain direction symbol found on the saw body. (See Fig. A2)

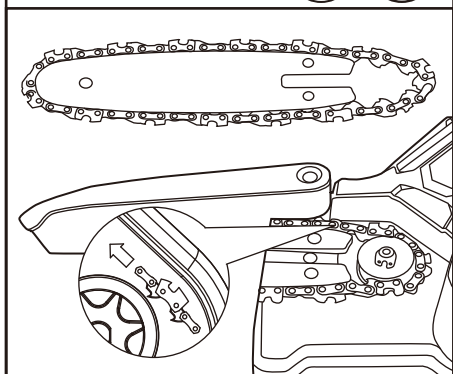
A2

5) Fit the Chain onto the Drive Sprocket, so that the Fastening Bar Bolt and the Bar Locating Tab on the Bar Pad fit into the keyway of the opening on the Guide Bar. (See Fig. B1, B2)

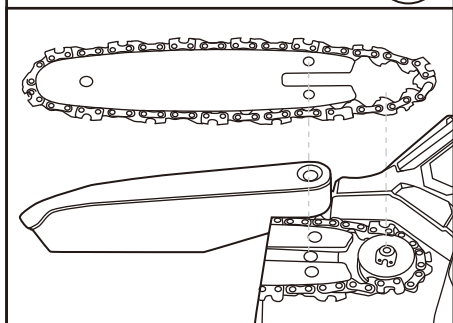
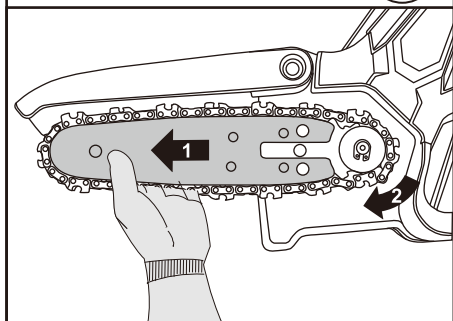
B1**B2**

6) Assure all parts are seated properly. Make sure the drive links are fully seated in the Drive Sprocket (See Fig. C1), avoiding a kink as shown in Fig. C2. If kink occurs, pick up the Chain at the Guide Bar just ahead of the kink and then pull the kink out.

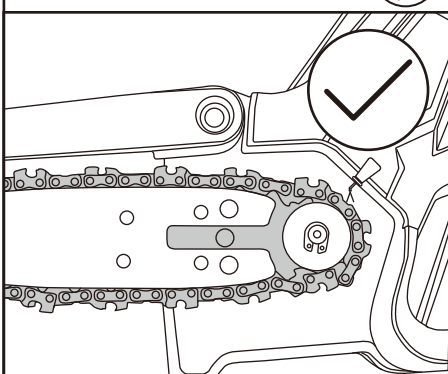
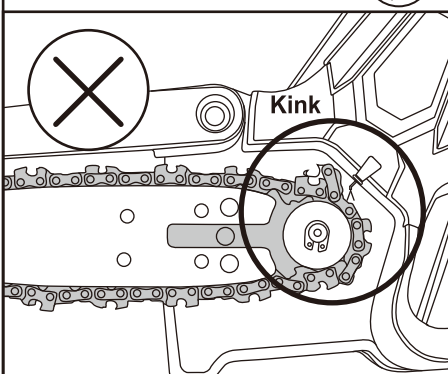
C1**C2**

7) **NOTE:** Chain should rotate freely and be free of kinks.

8) Fit the Chain Cover and tighten the Chain Cover by turning the Housing-Cover Knob clockwise until it is tight, (See Fig. D)

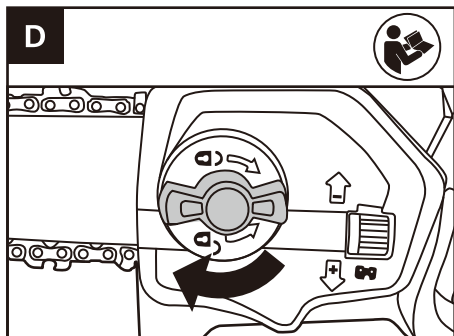

⚠ WARNING: The Chain is not yet tensioned. Tensioning the Chain applies as described under "TENSIONING CHAIN". The Chain now needs to be inspected to make sure it is properly tensioned.

TENSIONING CHAIN (See Fig. E1—E3)

NOTE: New saw chains will stretch. Check the chain tension frequently when first used and tighten when the Chain becomes loose around the Guide Bar.

⚠ WARNING:

- Removing the battery pack before adjusting saw chain tension.
- Cutting edges on chain are sharp. Use protective gloves when handling chain.
- Maintain proper chain tension always. A loose chain will increase the risk of kickback. A loose chain may jump out of guide bar groove. This may injure operator and damage chain. A loose chain will cause chain, bar, and sprocket to wear rapidly.

- 1) Place the pruning saw on any suitable flat surface.
- 2) Loosen the Housing-Cover Knob a bit to loosen the Chain Cover lightly.
- 3) Adjust the chain tension. Turn the Chain Tensioning Knob in "+" direction to tighten, (See Fig. E1)

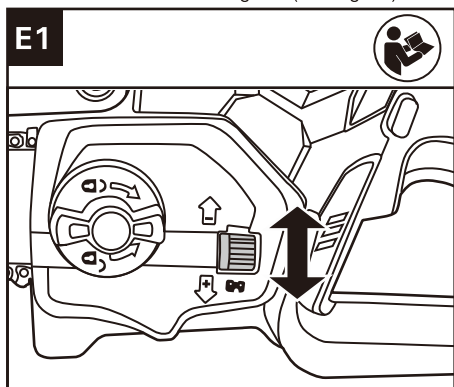

- 4) The correct chain tension is reached when the Chain can be raised approx. half the driveline depth from the Guide Bar in the center. (See Fig. E2)

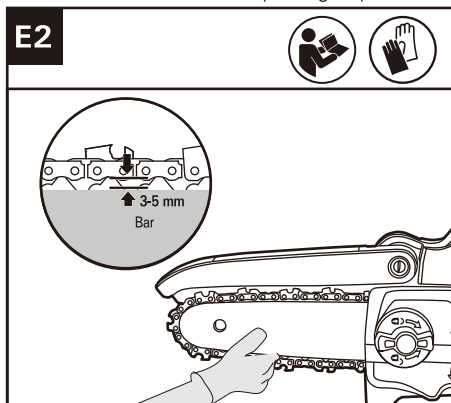

- 5) Tighten the Housing-Cover Knob to secure the Chain Cover. (See Fig. E3)

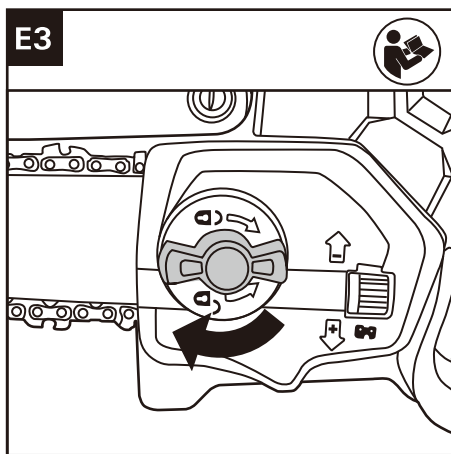

NOTE: The Chain is properly tensioned when it can be lifted off of the Guide Bar and the driveline is within the rail of the Guide Bar.

NOTE: The chain will naturally stretch and lose proper tension under general use. To re-tension, repeat steps 1-5 listed above.

LUBRICATION

NOTE: Chain life and cutting capacity depend on optimum lubrication. Therefore, the chain should be oiled before operation.

NOTE: Because of transportation restrictions, only an empty lubricant bottle is provided.

⚠ IMPORTANT: It is important to use bar and chain lubricant that is formulated to perform over a wide temperature range with no dilution required. This can be found at your local hardware store. Do not use dirty, used or otherwise contaminated oil. Damage may occur to the bar or chain. Use of non-approved oil will void the warranty.

Do not swallow. If swallowed, call a physician immediately. Keep out of reach of children. Store away from heat or open flame.

- 1) Switch off the pruning saw and remove the battery.
- 2) Place the pruning saw on a level surface with the Housing-Cover facing up.
- 3) Clean the Guide Bar and Chain with a soft brush or solvent.
- 4) Apply lubrication oil in area (a) between Guide Bar and Chain. (See Fig. F)

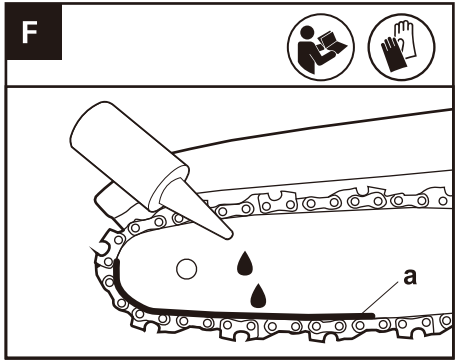

- 5) Fit the battery. Switch on the pruning saw. Lubrication oil is evenly distributed over the chain. The saw chain is lubricated.

OPERATION

1. BEFORE USING YOUR CORDLESS TOOL

⚠ WARNING! The charger and battery pack are specially designed to work together so do not attempt to use any other devices. Never insert or allow metallic objects into your charger or battery pack connections because of an electrical failure and hazard will occur.

NOTE: Your battery pack is UNCHARGED and you must charge once before use.

The battery charger supplied is matched to the Li-ion battery installed in the machine. Do not use another battery charger.

a) CHARGING YOUR BATTERY PACK

(See Fig. G1, G2)

The Li-ion battery is protected against deep discharging. When the battery is empty, the machine is switched off, by means of a protective circuit.

In a warm environment or after heavy use, the battery pack may become too hot to permit charging. Allow time for the battery to cool down before recharging.

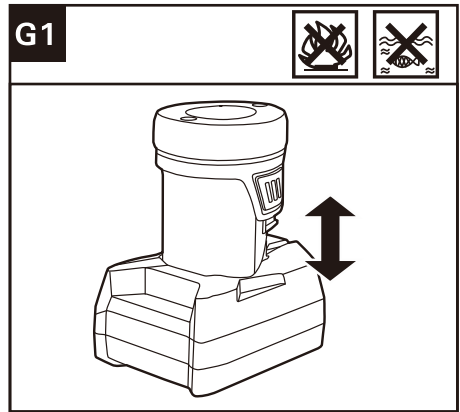

Battery Charge Remaining Indication

The three LEDs of the battery charge remaining indicator indicate the charge condition of the battery.

LED	Meaning
Continuous lighting 1 x green, 1 x yellow, 1 x red	Battery Capacity $\geq 2/3$
Continuous lighting 1 x yellow, 1 x red	Battery Capacity $\geq 1/3$
Continuous lighting 1 x red	Battery Capacity $< 1/3$
Flashing in 1 x green, 1 x yellow, 1 x red	Start protection status. If the battery pack is inserted when the switch is closed, the situation will happen.

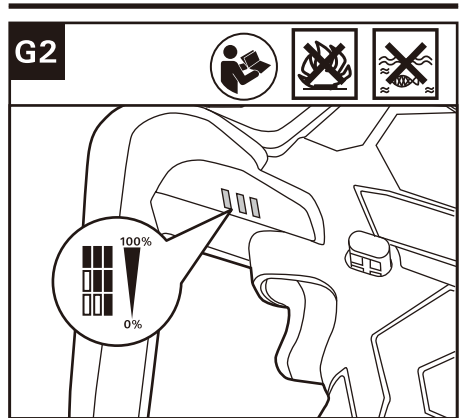

b) TO REMOVE OR INSTALL BATTERY PACK

(See Fig. H)

Depress the Battery Pack Release Button to remove the Battery Pack from your tool. After recharging, insert the Battery Pack into the battery port. A simple push and slight pressure will be sufficient until a click is heard. Check to see if the battery is fully secured.

NOTE: When removing the battery pack, hold it firmly to avoid dropping and injury.

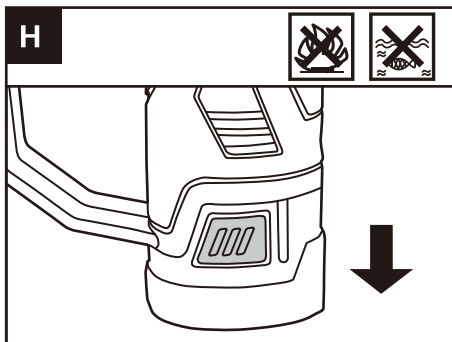

C) HOLDING AND CONTROLLING THE ELECTRIC CHAIN SAW (See Fig. I)

Hold and control the electric chain saw with one hand on the Grip Area – wrap your thumb around the Grip Area.

Hold and control the electric chain saw with your other hand on the Secondary Grip Area.

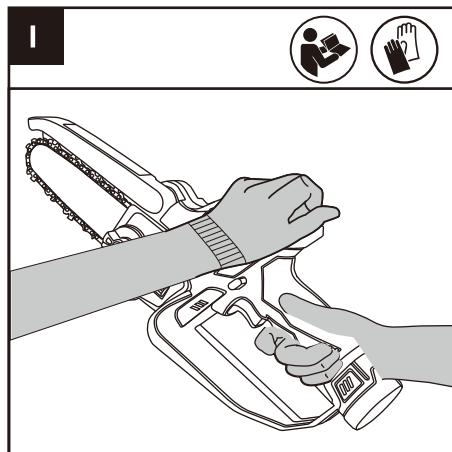

2. SWITCHING ON AND OFF (See Fig. J)

⚠ ATTENTION: Check the battery pack before using your cordless tool. Only use the battery pack supplied with the tool or recommended by the manufacturer. For switching on the tool, press the Lock-Out Button, then fully press the On/Off Switch

and hold in this position. The Lock-Out Button can now be released.

For switching off, release the On/Off Switch.

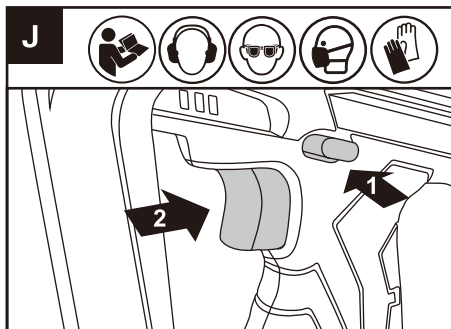

3. CUTTING

IMPORTANT: Check recent replaced chain, tension about every 10 minutes during operation.

(1) Installing the battery pack into the machine.

Make sure section of log to be cut is not laying on the ground. This will keep the chain from touching the ground as it cuts through the log.

(2) Touching the ground while the Chain is moving is dangerous and will dull the Chain.

(3) When ready to make a cut, push the Lock-Out Button completely in with the right thumb and squeeze the trigger. This will turn saw on. Releasing the trigger will turn the saw off. Make sure the saw is running at full speed before starting a cut.

(4) When starting a cut, slowly place moving chain against the wood. The wood should be as close to the saw body as possible. Hold saw firmly in place to avoid possible bouncing or skating (sideways movement) of saw.

(5) Guide the saw using light pressure and do not put excessive force on the saw, letting the saw do its work. The motor will overload and can burn out. It will do the job better and safer at the rate for which it was intended.

(6) Remove the saw from a cut with the saw running at full speed. Stop the saw by releasing the On/off Switch. Make sure the chain has stopped before setting the saw down.

(7) Keep practicing on scrap logs in a secure working area until you are comfortable, using a fluid motion and a steady cutting rate.

4. KICKBACK SAFETY DEVICES ON THIS SAW

This saw has a low-kickback chain and reduced kickback Guide Bar. Both items reduce the chance of kickback. However, kickback can still occur with this saw.

The following steps will reduce the risk of kickback.

- Keep all safety items in place on saw. Make sure they work properly.
- Do not overreach or cut above shoulder height.
- Keep solid footing and balance at all times.
- Stand slightly to the left side of saw. This keeps your body from being in direct line with chain.
- Do not let Guide Bar nose touch anything when chain is moving.
- Never try cutting through two logs at same time. Only cut one log at a time.
- Do not bury the Guide Bar nose or try plunge cut (boring into wood using Guide Bar nose).
- Watch for shifting of wood or other forces that may pinch chain.
- Use extreme caution when reentering a previous cut.
- Use only the low-kickback chain and Guide Bar that were supplied with this pruning saw or recommended.
- Never use a dull or loose chain. Keep chain sharp with proper tension.

5. HOW TO USE SAW SAFELY

- a) Use the pruning saw only with secure footing.

Hold the pruning saw at the right-hand side of your body (See Fig. K).

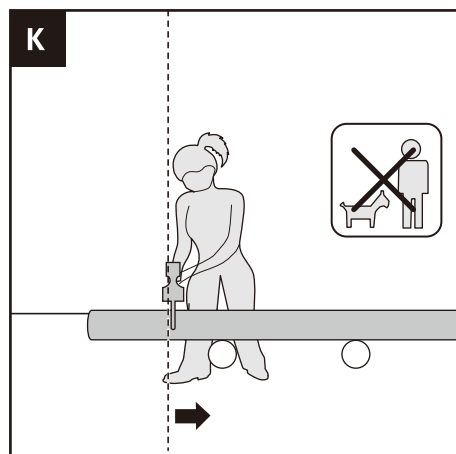

- c) The Chain must be running at full speed before it
b) makes contact with the wood.

- d) Use the Cutting base panel to secure the saw onto the wood before starting to cut.

- e) Use the Cutting base panel as a leverage point while cutting. (See Fig. L)

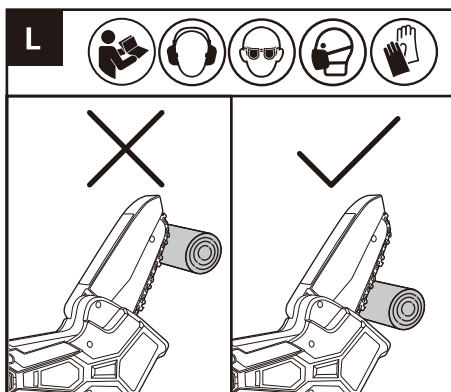

- f) Raise the Chain Guard when cutting from bottom to top of material. (See Fig. M)

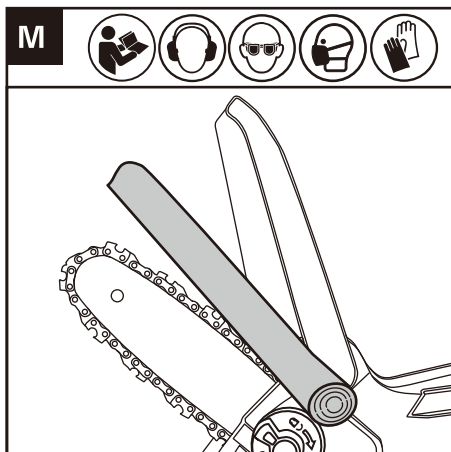

- g) Do not operate the saw with arms fully extended, attempt to saw areas which are difficult to reach, or stand on a ladder while sawing. (See Fig. N)

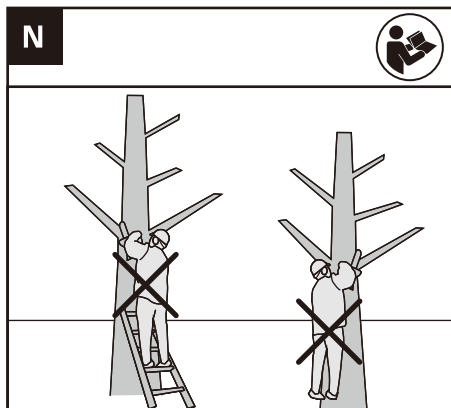

Never use the electric chain saw above shoulder height.

Cutting wood under tension (See Fig. O)

⚠ WARNING: When cutting a limb that is under tension, use extreme caution. Be alert for woodspringing back. When wood tension is released, limb could spring back and strike operator causing severe injury or death.

When sawing logs supported on both ends, start the cut from above (Y) about 1/3 of the diameter into the log (overbuck) and then finish the cut (Z) from below, in order to avoid contact of the electric chain saw with the ground. When sawing logs supported on only one end, start the cut from below (Y) about 1/3 of the diameter into the log (underbuck) and finish the cut from above (Z) in order to avoid log splitting or jamming of the electric chain saw.

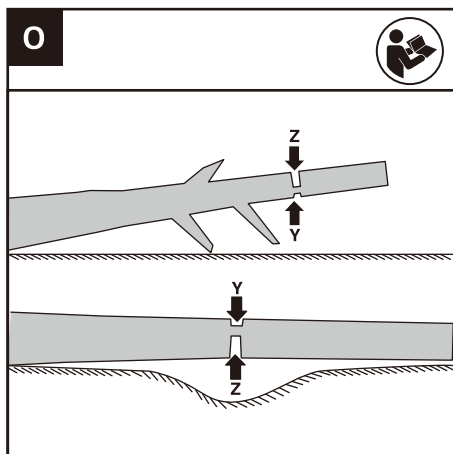

SAW MAINTENANCE

Follow maintenance instructions in this manual. Proper cleaning of saw and chain and Guide Bar maintenance can reduce chances of kickback. Inspect and maintain saw after each use. This will increase the service life of your saw.

NOTE: Even with proper sharpening, risk of kickback can increase with each sharpening.

MAINTENANCE AND STORAGE OF ELECTRIC CHAIN SAW

1) Remove the battery pack

- When not in use
- Before moving from one place to another
- Before servicing
- Before changing accessories or attachments, such as saw chain and guard

2) Inspect electric chain saw before and after each use. Check saw closely if guard or other part has

been damaged. Check for any damage that may affect operator safety or operation of saw. Check for alignment or binding of moving parts. Check for broken or damaged parts. Do not use electric chain saw if damage affects safety or operation. Have damage repaired by authorized service center.

3) Maintain electric chain saw with care.

- Never expose saw to rain or direct moisture.
 - Keep chain sharp, clean, and lubricated for better and safer performance.
 - Follow steps outlined in this manual to sharpen chain.
 - Keep handles dry, clean, and free of oil and grease.
- 4) When servicing, use only identical replacement parts.

5) When not in use, always store electric chain saw

- in a high or locked place, out of children's reach
- in a dry place
- with Bar and Chain Cover in place

Bar Maintenance

To maximize bar life, the following bar maintenance is recommended.

The bar rails that carry the chain should be cleaned before storing the tool or if the bar or chain appear to be dirty.

The rails should be cleaned every time the chain is removed.

To clean the Bar rails.

- 1) Remove Housing-Cover, Bar and Chain. (see section ASSEMBLY)
- 2) Using a wire brush, screwdriver or similar tool, clear the residue from the inner groove of the bar. (See Fig. R)
- 3) Make sure to clean oil passages thoroughly.

Conditions which require Chain and Guide Bar maintenance:

- Saw cuts to one side or at an angle.
- Saw has to be forced through the cut.
- Inadequate supply of oil to the bar and chain.

Check the condition of the Guide Bar each time the chain is sharpened. A worn Guide Bar will damage the chain and make cutting difficult.

After each use, remove the battery pack, clean all sawdust from the Guide Bar and sprocket hole.

When rail top is uneven, use a flat file to restore square edges and sides.



Replace the Guide Bar when the groove is worn, the Guide Bar is bent or cracked, or when excess heating or burring of the rails occurs. If replacement is necessary, use only the Guide Bar specified for your saw in the repair parts list or on the decal located on the electric chain saw.

Replacing Chain

Replace chain when cutters are too worn to sharpen or when chain stops. Only use replacement chain noted in this manual.

Only handle the saw chain with gloves and remove the battery first!

Inspect the saw chain and the guide bar for damage or signs of wear.

Never put a new saw chain on a worn guide bar.

- Unscrew the Housing-cover knob (2) counter-clockwise in order to remove the Housing-cover (11).
- Unscrew the Chain tensioning knob (12) to release saw Chain (13).
- Remove the old saw Chain (13).
- Round the new saw chain over the Drive sprocket (16) and Guide bar (14).
- Please note the running direction of the saw chain.
- The saw chain icon is shown on housing nearby Drive sprocket (16).
- Use an oiler to oil the saw Chain (13) and the Drive sprocket (16).
- Tighten the saw Chain (13) with the Chain tensioning knob (12).
- Re-tighten the Housing-cover (11) with the Housing-cover knob (2) on the Housing-cover (11).
- Let each new saw chain break-in first!
- When attaching the saw chain, observe the running direction!

SHARPENING SAW CHAIN

⚠WARNING:

Remove the battery pack before servicing. Severe injury or death could occur from electrical shock or body contact with moving chain. Cutting edges on chain are sharp. Use protective gloves when handling chain. Keep chain sharp. Your saw will cut faster and more safely. A dull chain will cause undue sprocket, Guide Bar, chain, and motor wear. If you must force chain into wood and cutting creates only sawdust with few large chips, chain is dull.

INSTRUCTIONS CONCERNING THE PROPER TECHNIQUES FOR LIMBING AND CROSS-CUTTING

1). Limbing a tree

Limbing is removing the branches from a fallen tree. When limbing leave larger lower limbs to support the log off the ground. Remove the small limbs in one cut as illustrated in Figure 1. Branches under tension should be cut from the bottom up to avoid binding the electric chain saw.

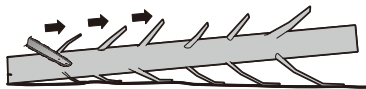

Figure 1

2). Bucking a log

Bucking is cutting a log into lengths. It is important to make sure your footing is firm and your weight is evenly distributed on both feet. When possible, the log should be raised and supported by the use of limbs, logs or chocks. Follow the simple directions for easy cutting.

When the log is supported along its entire length as illustrated in Figure 2, it is cut from the top (overbuck), avoid contacting ground as this will greatly reduce the chain sharpness.

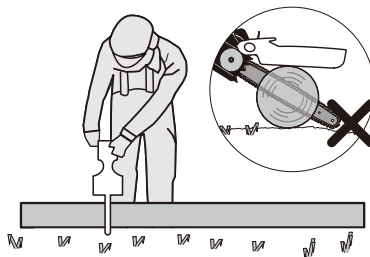

Figure 2

When the log is supported on one end, as illustrated in Figure 3, cut 1/3 the diameter from the underside (underbuck) (1). Then make the finished cut by overbucking (2) to meet the first cut.

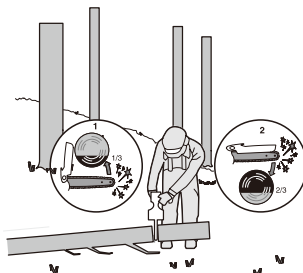

Figure 3

When the log is supported on both ends, as illustrated in Figure 4, cut 1/3 the diameter from the top overbuck) (1). Then make the finished cut by underbucking (2) the lower 2/3 to meet the first cut.

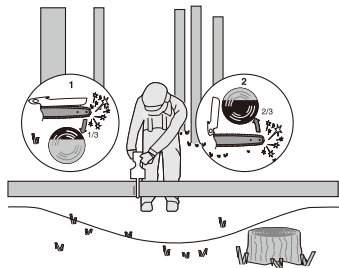

Figure 4

When bucking on a slope always stand on the uphill side of the log, as illustrated in Figure 5. When “cutting through”, to maintain complete control release the cutting pressure near the end of the cut without relaxing your grip on the electric chain saw handles. Don’t let the chain contact the ground. After completing the cut, wait for the saw chain to stop before you move the electric chain saw. Always stop the motor before moving from tree to tree.

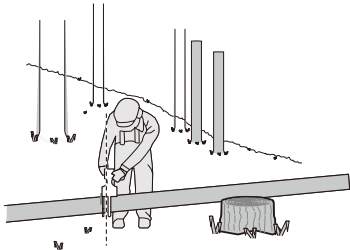

Figure 5

TROUBLESHOOTING TABLE

The following table gives checks and actions that you can perform if your machine does not operate correctly. If these do not identify/remedy the problem, contact your service agent.

⚠ WARNING: Switch off and remove the battery pack before investigating fault.

Symptom	Possible Cause	Remedy
Pruning Saw fails to operate	Out of battery.	Charge the battery pack.

Pruning Saw operates intermittently	Over heating Applying too much pressure while cutting. Loose connection. Internal wiring defective. On/Off switch defective.	Place the machine in a cool,ventilated place to cool it down Applying relatively less pressure while cutting Contact service agent.
Chain/chain bar over-heats	Chain is over tensioned Dull chain	Adjust chain tension Sharpen chain or replace
Pruning Saw rips, vibrates, does not saw properly	Chain tension too loose Dull chain Chain worn out Chain teeth are facing in the wrong direction	Adjust chain tension Sharpen chain or replace Replace chain Reassemble with chain in correct direction

DISPOSAL

Do not dispose of electric power tools with domestic refuse.

 The electric power tool is shipped in packaging to reduce transport damage.

This packaging is a raw material and as such can either be reused or can be fed back into the raw material cycle. The electric power tool and its accessories are made from various materials such as metals and plastics. Take defective components to a special refuse collection point. Ask about these at your specialist shop or local council.

Batteries

Think of the environment when disposing of batteries. Contact your local authorities to find out where your nearest disposal area is.

Do not dispose of batteries with domestic refuse. Do not dispose of by burning, risk of explosion.

Manufacturer:
 Zhejiang Jiahong Tools Manufacture Co.,LTD
 NO.2-1 xinzhong dong Road,Xinbi District,Jinyun Town
 Lishui, Zhejiang, China

WORKPRO