

# Tron TR30 GMDSS, Tron TR30 AIR radio

## Product Dismantling and Recycling

Part Number: 87950, 87950-JRC, 101700

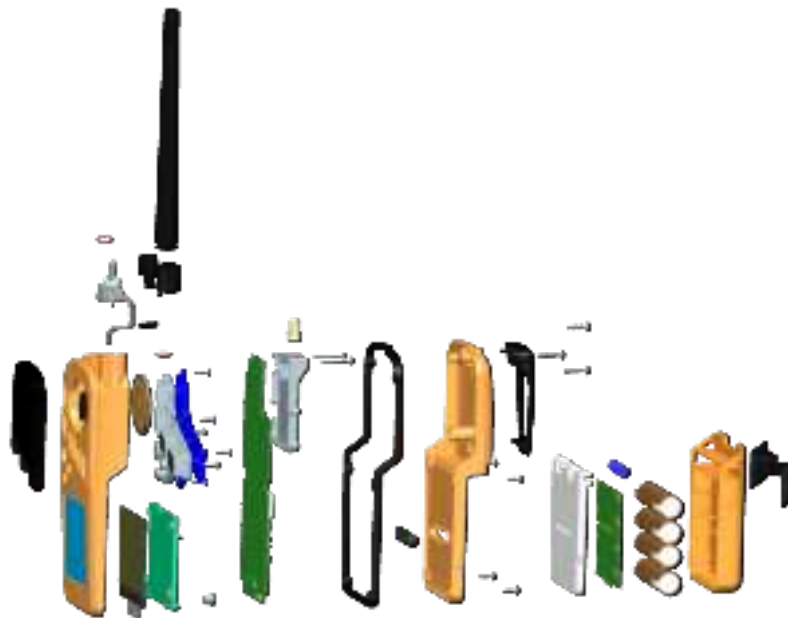

- 1) Tools are required to disassemble the radios and battery, illustrated in the drawing above.
- 2) Separate the battery and the antenna from the radio.
- 3) To disassemble the radio, remove the screws and access the printed circuit board.
- 4) Recycle battery pack, printed circuit boards, plastic parts and metal accordingly.
- 5) If the Tron TR30 GMDSS radio charger or Tron TR30 AIR holder needs to be disassembled, remove the screws under the charger/holder to access the printed circuit board. Recycle the plastic parts and printed circuit board properly.

# Tron TR30 GMDSS, Tron TR30 AIR radio

## Product Dismantling and Recycling

Part Number: 87950, 87950-JRC, 101700



### MECHANICAL / HOUSING



### ELECTRONICS



### BATTERY

<p>The mechanical housing for the radio and the battery unit are made of plastic granulate. Inside the radio there are metal parts.</p>	<p>There is 1 printed circuit board inside the radio and 1 printed circuit board inside the battery module. The radio charger contains 1 printed circuit board.</p> <p>Some of the boards may contain critical materials which should be recycled.</p>	<p>The emergency battery unit and the test battery unit contain 4 lithium battery cells of type Energizer L-91. These cells are configure in serial and parallel. The rechargeable battery unit contains Lithium Polymer cells.</p> <p>Specific information about the different battery modules can be found on <a href="http://www.jotron.com">www.jotron.com</a>, under the specific product and download. Select download category "dangerous goods".</p>
---	--	--

### PROPER PRODUCT RECYCLING

For proper product disposal and recycling, please:

- Consult your local authorities about your country's disposal and recycling rules and regulations.
- Observe the applicable WEEE (Waste from Electrical and Electronic Equipment) rules.

### CRITICAL RAW MATERIAL (CRM) CONTENT PER COMMODITY TYPE

Critical raw materials (CRMs) are of high economic importance and have a high risk of supply chain disruption. In 2023, EU published a fifth list of 34 CRMs in the Annex II of [the Regulation proposal COM\(2023\)](#) based on the [Study on the Critical Raw Materials for the EU 2023 – Final Report](#).

Based on the fifth list from 2023 of critical raw materials for the EU, Jotron has conducted an analysis of CRM content in the company's products. The content is limited to information sourced by responses and documentation from suppliers and manufacturers. The sourcing of documentation was done by questions on email, phone calls, meetings and searching verified online pages. The CRM content is limited to commodity group, not part specific.

The table below lists Jotron's commodity types that may contain critical raw materials (CRMs).

Capacitor	Connector	Diode	Fasteners	Fuse
Aluminium (bauxite) Copper	Brass (copper) Nickel	Copper Silicon	NA	Aluminium (bauxite) Copper Nickel
Inductive parts	Integrated circuit	Memory	Metal sheet	Opto
Magnesium Titanium dioxide	Aluminium (bauxite) Copper	Aluminium (bauxite) Baron Copper	Aluminium (bauxite) Copper Nickel	Fluorine Possible terbium* in display
Printed circuit boards	Relay	Resistor	Switchers	Batteries
Copper	Aluminium (bauxite) Copper Nickel	Aluminium (bauxite) Bismuth Boron Nickel Silicon Titanate (titanium)	Aluminium (bauxite) Copper Manganese Nickel Silicon	Aluminium Cobolt Copper Gallium Lithium Manganese Nickel

\*heavy rare earth element