



User Guide

Kasa Smart Wi-Fi Light Switch, Motion-Activated
KS200M

Contents

About This Guide	1	Create Scenes.....	30
Introduction	2	Smart Actions.....	32
Appearance	3	Discover Kasa.....	43
Set Up Your Smart Light Switch	4	Authentication.....	44
Main Device Controls	6		
Configure Smart Control	7		
Set Schedules	13		
Set Timer.....	15		
Set Away Mode.....	16		
Manage Device Settings	17		
Reset Your Smart Light Switch.....	23		
Create Groups	26		

About This Guide

This guide provides a brief introduction to Kasa Smart Wi-Fi Light Switch and the Kasa Smart app, as well as regulatory information.

Features available in Kasa Smart Wi-Fi Light Switch may vary by model and software version. Kasa Smart Wi-Fi Light Switch availability may also vary by region. All images, steps, and descriptions in this guide are only examples and may not reflect your actual experience.

Conventions

In this guide, the following convention is used:

Convention	Description
Teal	Key information appears in teal, including management page text such as menus, items, buttons and so on.
<u>Underline</u>	Hyperlinks are in teal and underlined. You can click to redirect to a website.

More Info

- Specifications can be found on the product page at <https://www.tp-link.com>.
- Our Technical Support and troubleshooting information can be found at <https://www.tp-link.com/support>.
- A TP-Link Community is provided for you to discuss our products at <https://community.tp-link.com>.
- Frequently Asked Questions (FAQs) can be found at <https://www.tp-link.com/support/faq/>.

Introduction

TP-Link Smart Wi-Fi Light Switch is a standard wall light switch that can be controlled via your iOS or Android devices. Built-in motion and ambient light sensors work together to realize hands-free control. Kasa smart switch automatically turns your lights on and off, saving you effort and electricity bills. Create smart modes to customize your light settings to follow your routine with the easy-to-use app. Just set it then forget it. The Kasa Smart app also provides easy step-by-step installation instructions and enables convenient remote control from anywhere, anytime.



- **Advanced Sensing** - The equipped sensors detect motion and ambient lighting so your lights only trigger on at night.
- **Smart Control** - Set different light triggers based on your routine for effortless control.
- **Easy Installation** - The detailed in-app guide and unique circuit design make installation simple.
- **Energy Saving** - Turn off the light automatically after you leave the room for a set time.
- **Control from Anywhere** - Control anything connected to your smart light switch, like lights, ceiling fans or other fixtures, from anywhere using the Kasa Smart app.
- **No Hub Required** - Connect to your existing Wi-Fi router.
- **Away Mode** - Set your smart light switch to turn connected fixtures on and off at random intervals to give the appearance you're home even while you're away.
- **Scheduling** - Set lights to automatically turn on and off throughout the day or night whether you're home or away.

Appearance

The Smart Light Switch is compatible with incandescent, LED, Halogen, and compact fluorescent light bulbs. The switch also includes a white backlight LED indicator to easily locate the switch at night. See the explanation below:

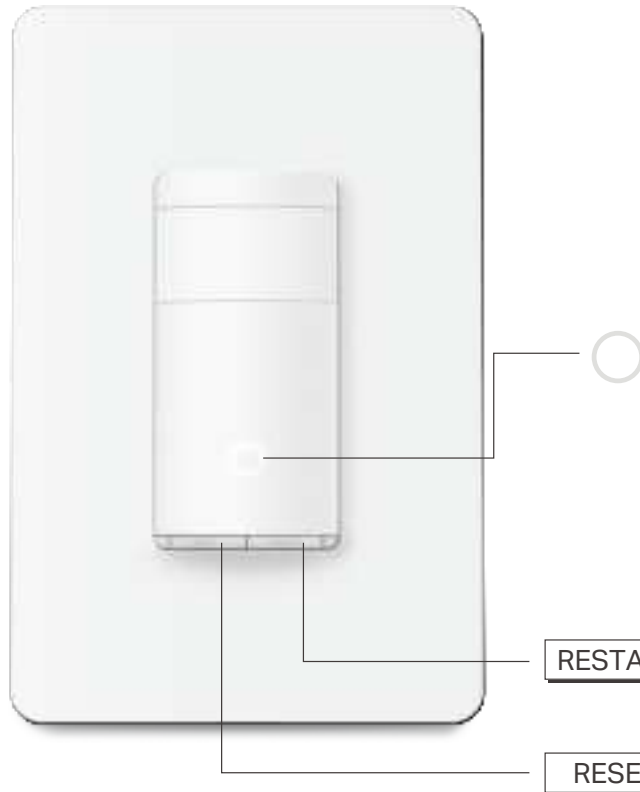

Flashing amber & green: Ready for setup.

Flashing green: Connecting to Wi-Fi.

Stay green for 30s: Connected to Wi-Fi.

Solid red: Disconnected from Wi-Fi.

Flashing amber: The switch is being reset to factory default settings.

White: Light fixture is off.

RESTART

Press to reboot the Smart Switch.

RESET

Press and hold for about **5** seconds to initiate the setup mode while keeping previous settings.

Press and hold for about **10** seconds to factory reset the switch.

Set Up Your Smart Light Switch

Follow the steps below to set up your Smart Light Switch via [Kasa Smart](#) app.

1. Download and install Kasa app

Go to Google Play or the App Store or scan the QR code below to download the Kasa Smart app on your Android or iOS device.



OR



2. Log in or sign up

Open the app. Use your TP-Link ID to log in.

If you don't have a TP-Link ID, tap [Create Account](#) and the Kasa app will guide you through the rest.



3. Add Device

Tap the + button in the Kasa app, select [Smart Switches](#) > [Smart Switch](#).

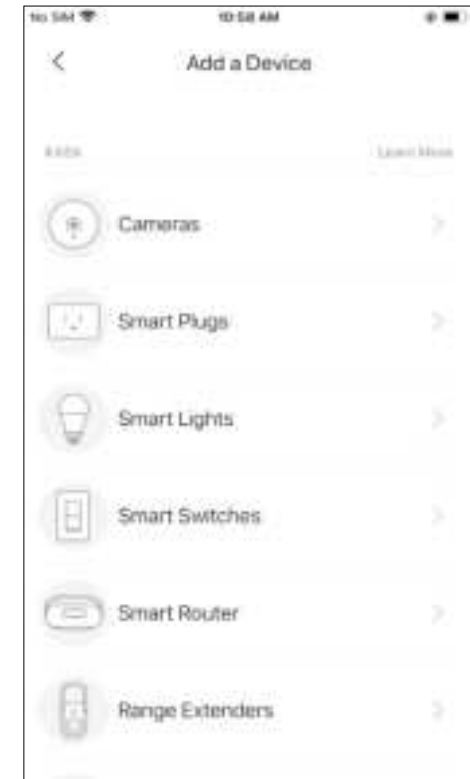

4. Install the Switch

Follow step-by-step app instructions to complete the installation. Make sure you turn off power first.



5. Set Up the Switch

After installation, follow step-by-step app instructions to complete the setup.

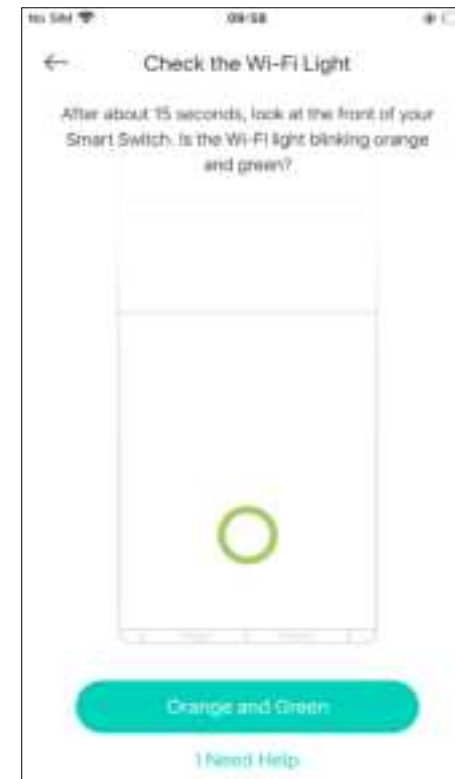

Main Device Controls

After you successfully set up your Smart Light Switch, you will see the home page of the Kasa Smart app. Here you can view and manage all devices that you've added to Kasa. Tap your switch to control and manage it.

Home Page

You can see all your Kasa devices listed in the Home page.



Turn on/off the light switch

Turn on/off your Smart Light Switch quickly by tapping the on/off switch in the home page. Tapping the device to enter its Status page, you can also check or change its status.

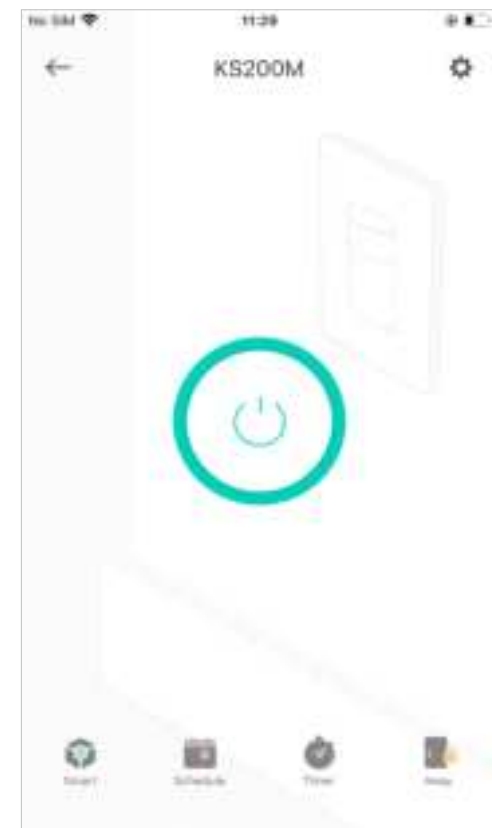

Configure Smart Control

Smart Control: Set different light triggers to enjoy effortless control of your switch with the built-in ambient light sensor and motion sensor. For example, you want your light to turn on automatically when you go to the bathroom at night.

1. Tap  in the status page.

2. Tap [Create Rule](#).

3. Tap [Add Time](#) to add an effective period of time for your Smart Control to take effect.

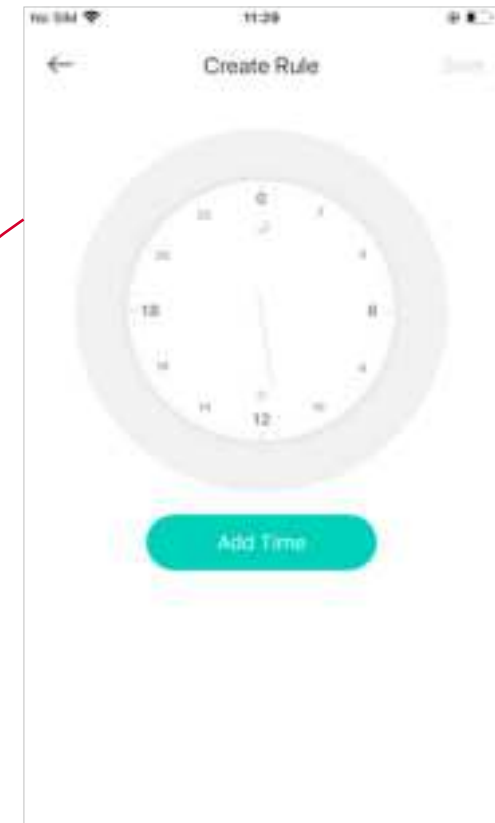
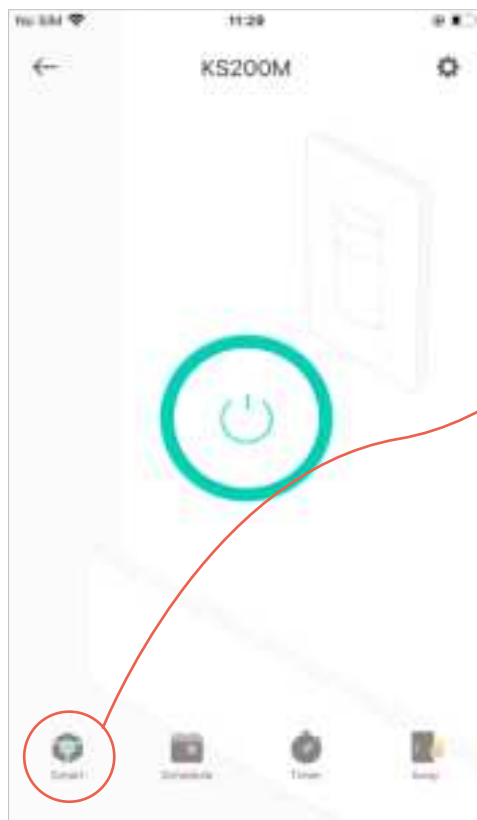

4. A time period appears automatically. Drag the end points or the whole segment to adjust time, or enter the start and end time. The specific rule settings are listed down below.

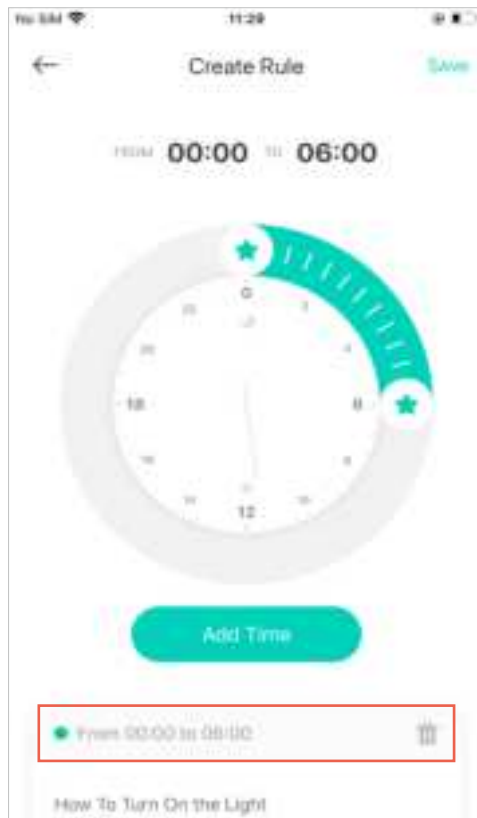

5. Slide up to see the rule settings. Tap to change the settings.

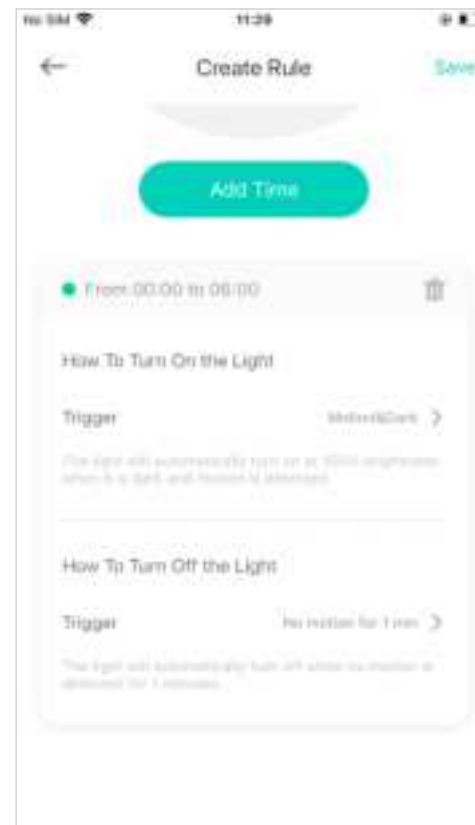

6. Set the trigger that turns on your light during the set time period.

Manual Only: Only turn the light on manually.

Motion Detected: Turn on the light automatically when motion is detected.

Motion Detected When It's Dark: Turn on the light automatically when motion is detected and it is dark as

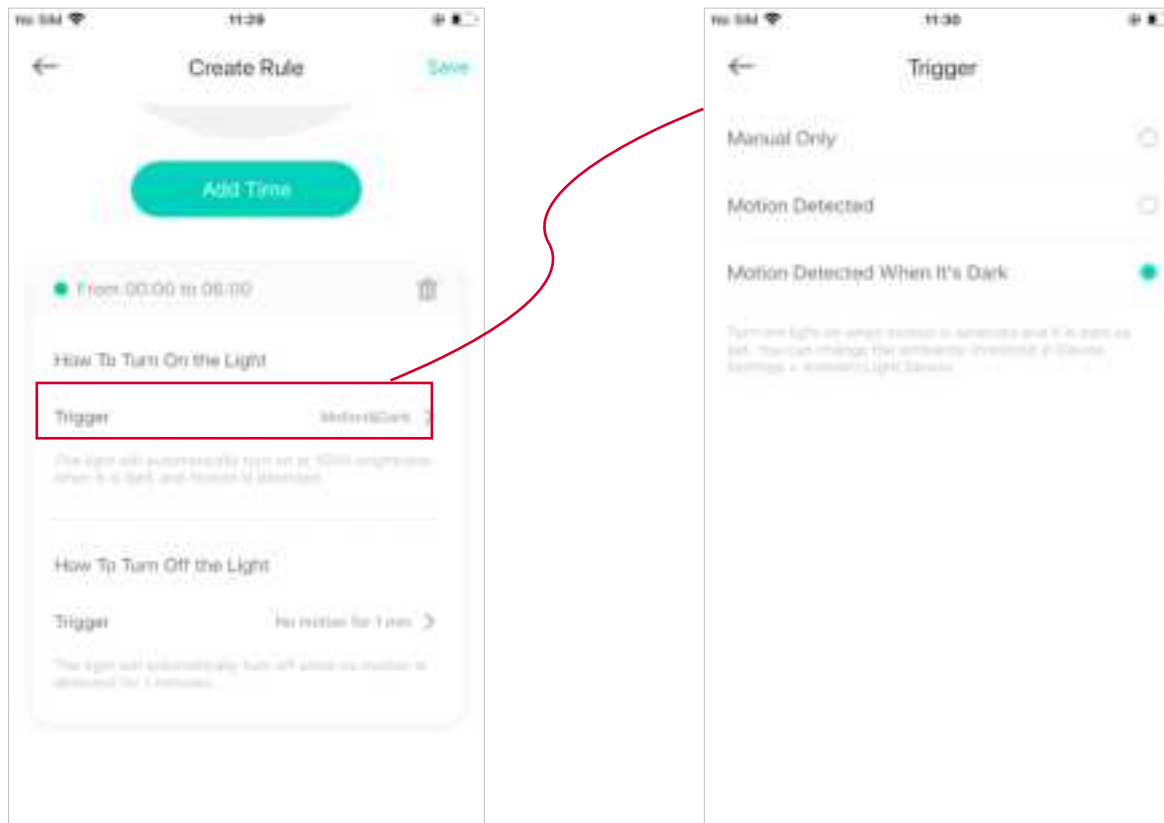

7. Set the trigger that turns off your light during the set time period.

Manual Only: Only turn the light on manually.

No motion detected: Choose a time period, and the light will be off automatically if no motion is detected during the selected time period.

No need to worry that your light will stay on.

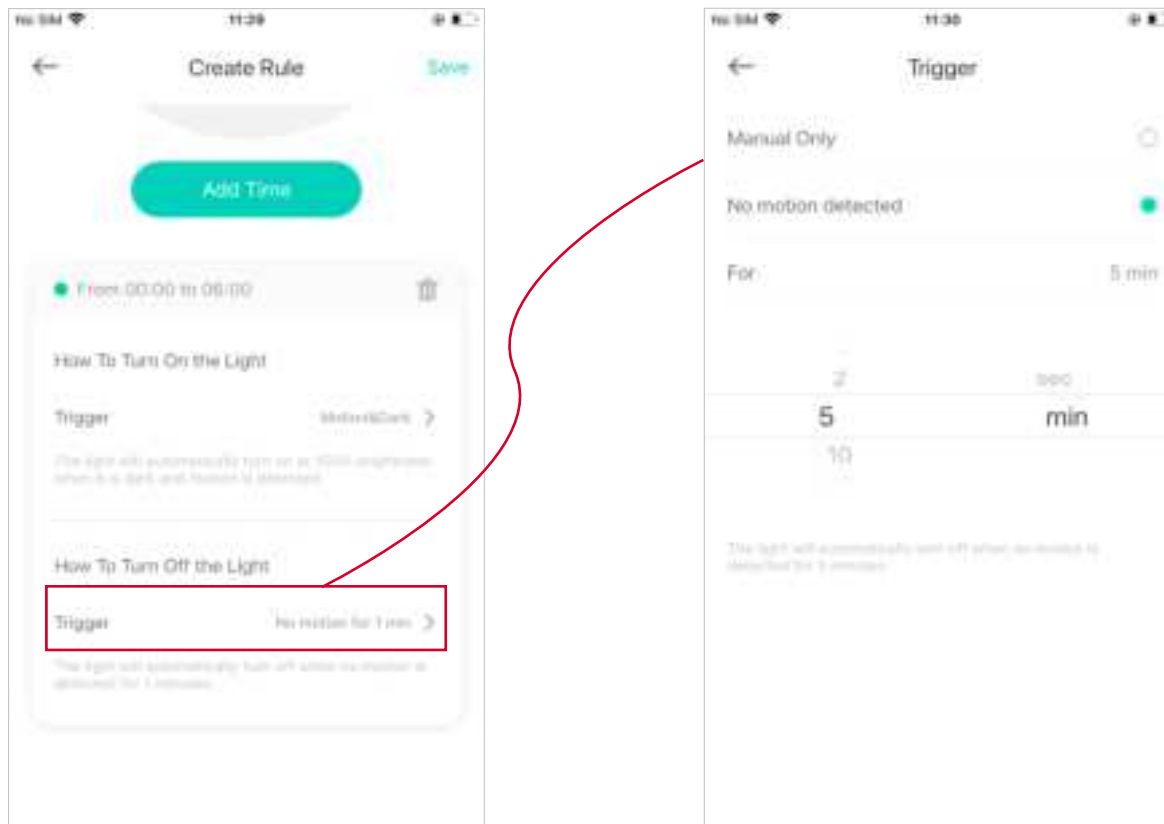

8. Tap [Add Time](#) to add more effective time periods and customize its settings if you want. Then tap [Save](#) on the top right corner to save your Smart Control rules.

Note: Smart Control can work differently in different time periods and repeats every day.

9. Change rule settings.

Tap [Edit Rule](#) to change the settings of each time period.

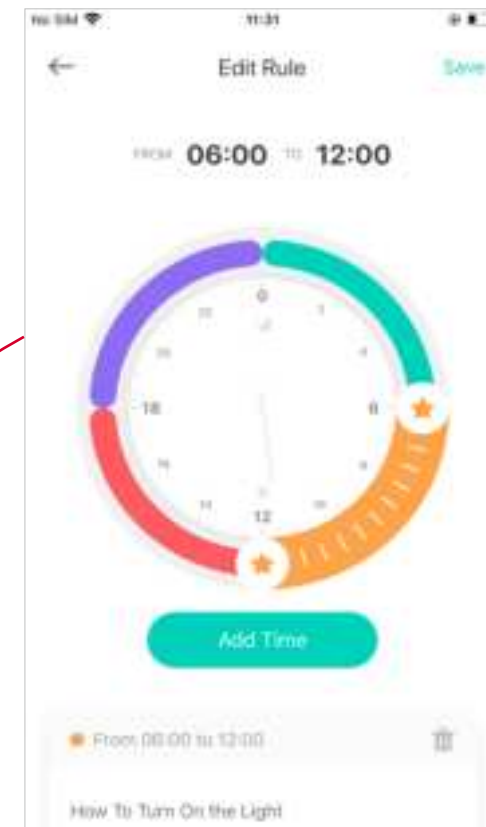
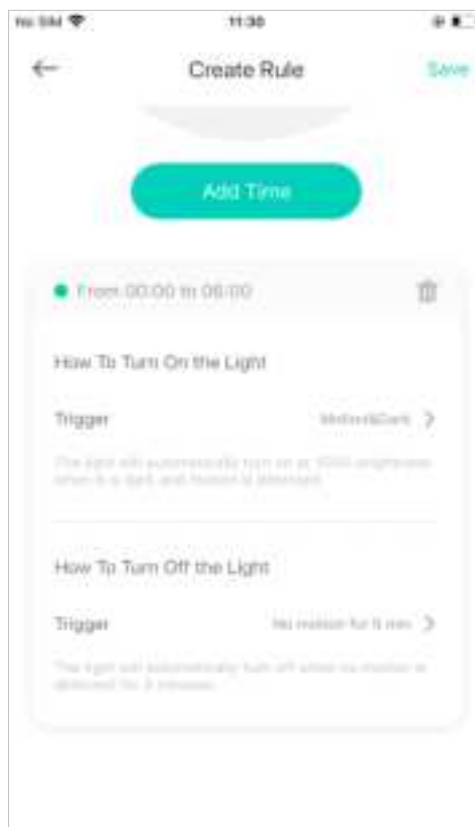

10. Turn the Smart Control off in one tap.



11. Delete the Smart Control.

Tap [Edit Rule](#), then slide up, and tap [Delete](#) at the bottom.

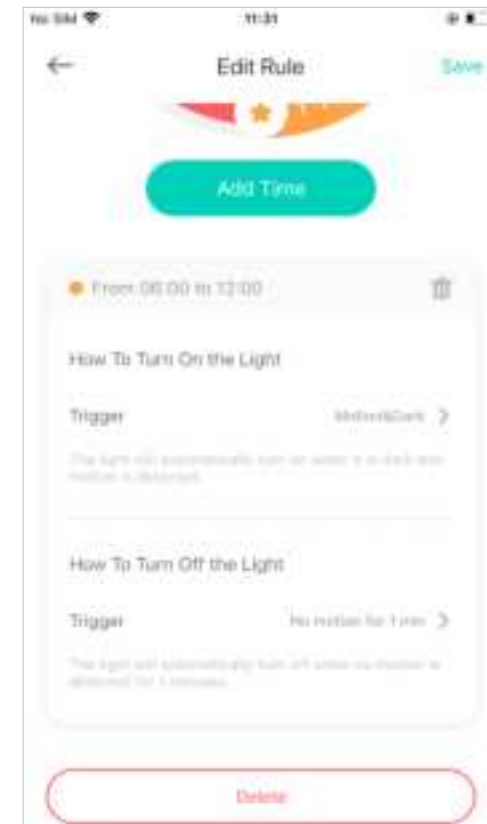

Set Schedules

Schedule: Set schedules to automatically turn on/off the light at set times according to your daily routine.

1. Tap your Smart Light Switch in the Home page, and then tap .

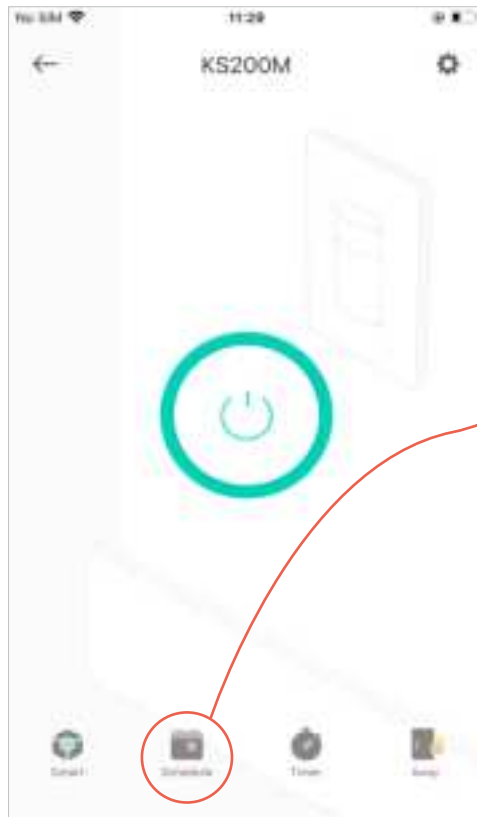

2. Tap + on the top right corner.



2. Set a schedule to turn the light on or off. For example, I want to turn off the light at 11:00 PM every day.



4. You can also choose to turn on/off the light at Sunrise or Sunset. Please note that the Sunrise and Sunset times are based on your location.



5. Tap [Save](#) and you'll see your schedule listed in the [Schedule](#) Page. You can add more schedules following the same steps.

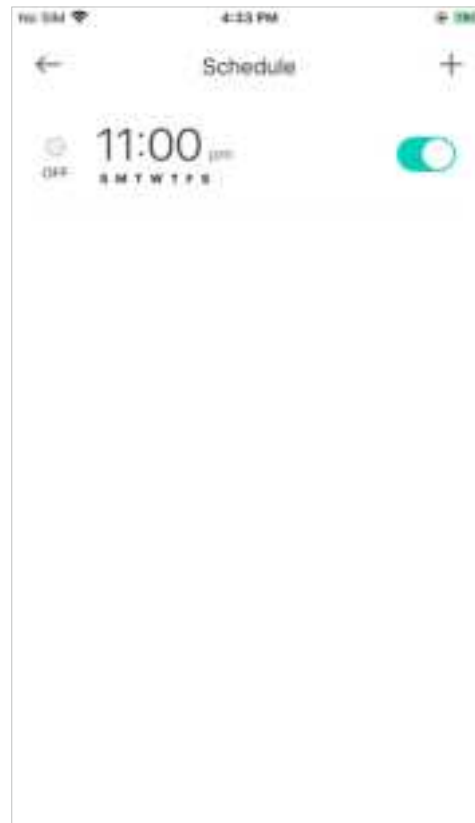

6. You can turn off your schedule any time at the [Schedule](#) page.

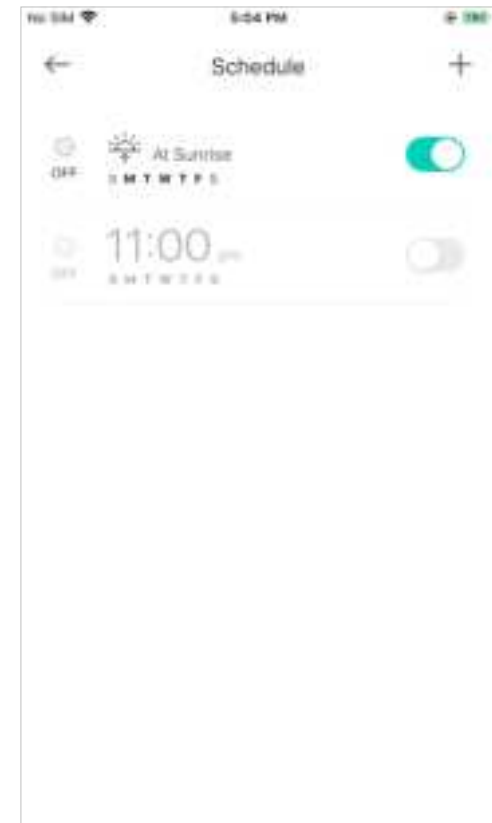

Set Timer

Timer: Set the timer for your light to automatically turn on/off after the time ends.

1. Tap your Smart Light Switch in the Home page, and then tap .

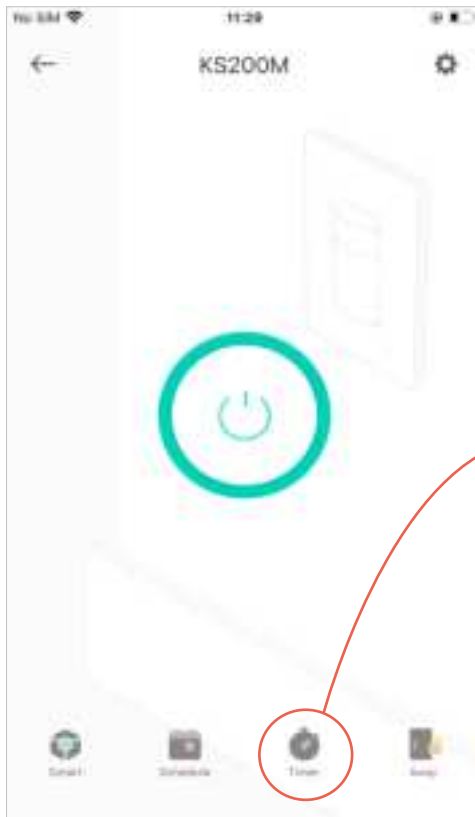

2. Set the time after which the light will be automatically turned on/off.

For example, when I turn on the light, I want it to be off after 30 minutes.

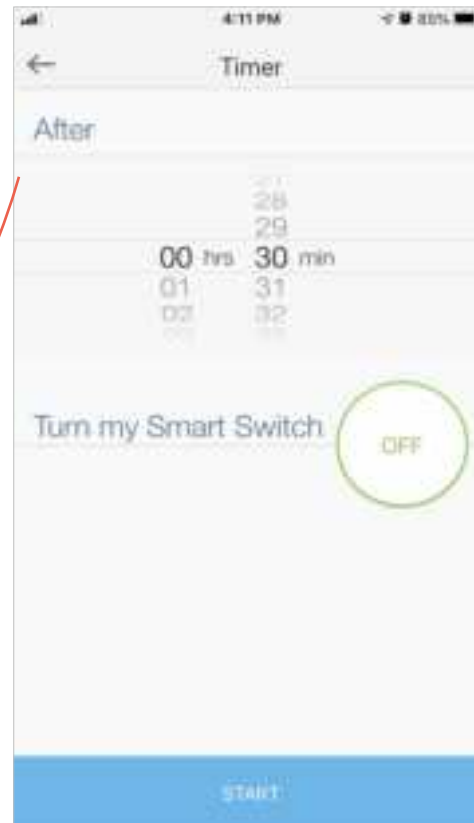

2. Tap **START** and you'll see the timer is counting down. Tap **Stop** to stop the Timer at any time.

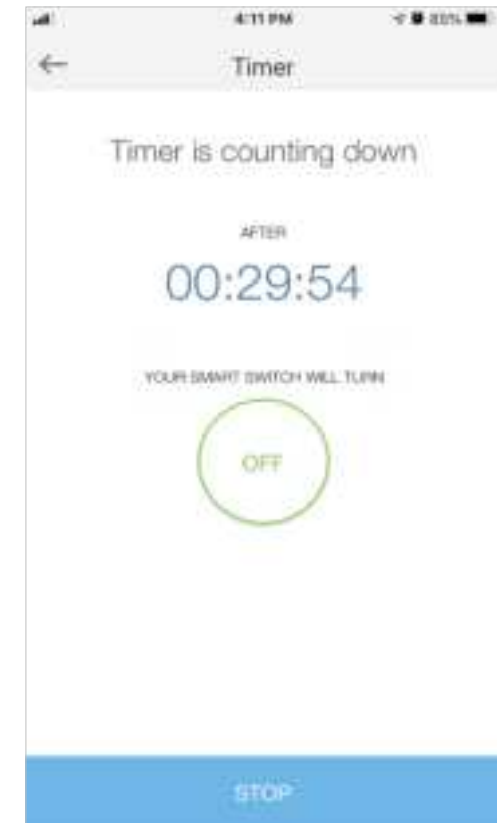

Set Away Mode

Away Mode: Set Away Mode for your light to turn on/off the light automatically at random intervals while you are away to make the appearance that someone is at home.

1. Tap your Smart Light Switch in the Home page, and then tap .

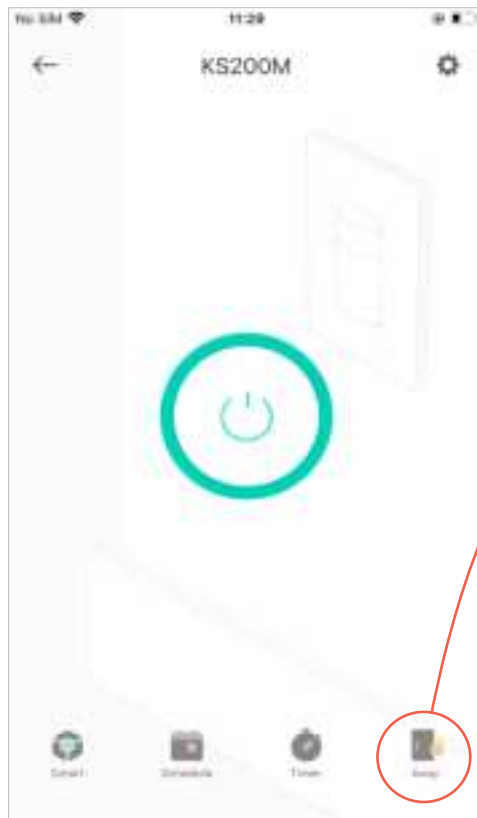

2. Set the start and end time during which the light will be automatically turned on and off at random intervals, and the repeating frequency.

For example, I want the light to turn on and off between 7:00 PM to 11:50 PM every Friday and Saturday.

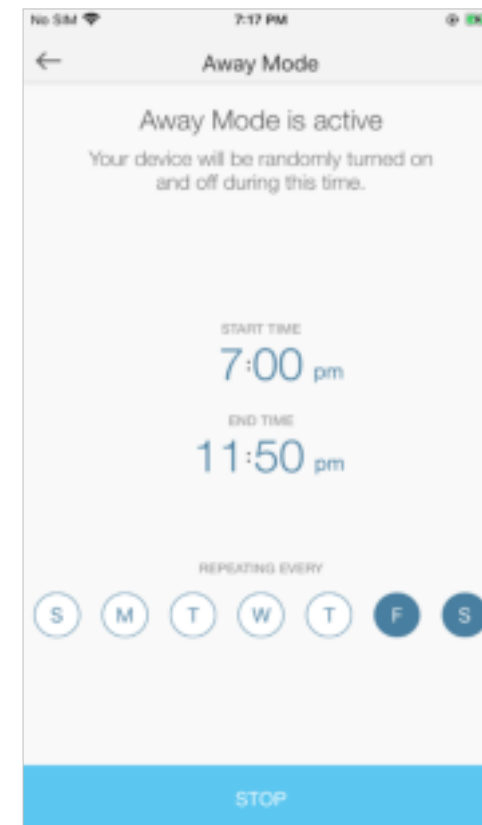
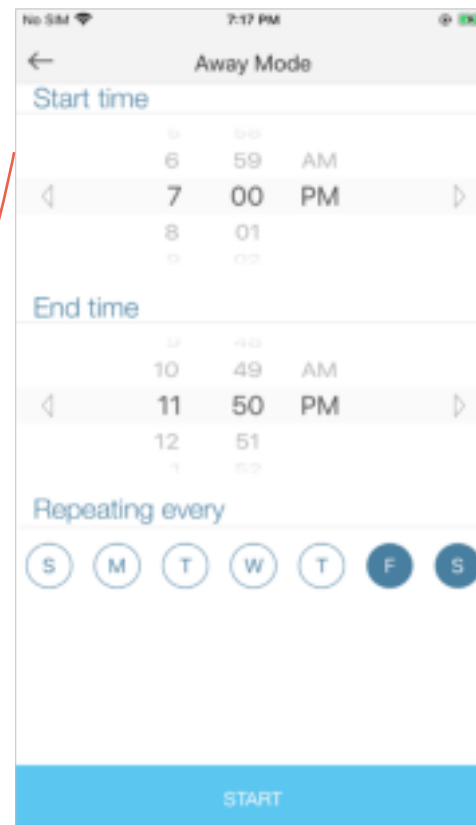

Manage Device Settings

You can change the settings in the [Device Settings](#) page.

Tap your Smart Light Switch in the Home page and then tap  to enter the [Device Settings](#) page.

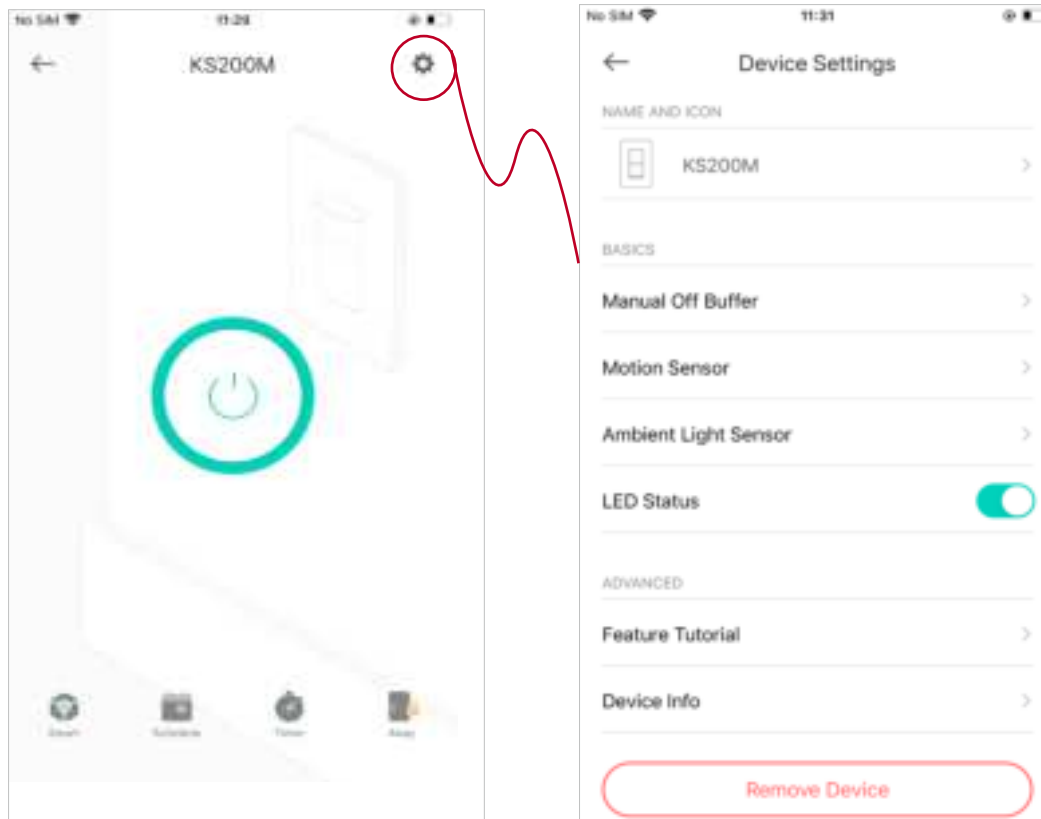

Change the name and icon of the switch.

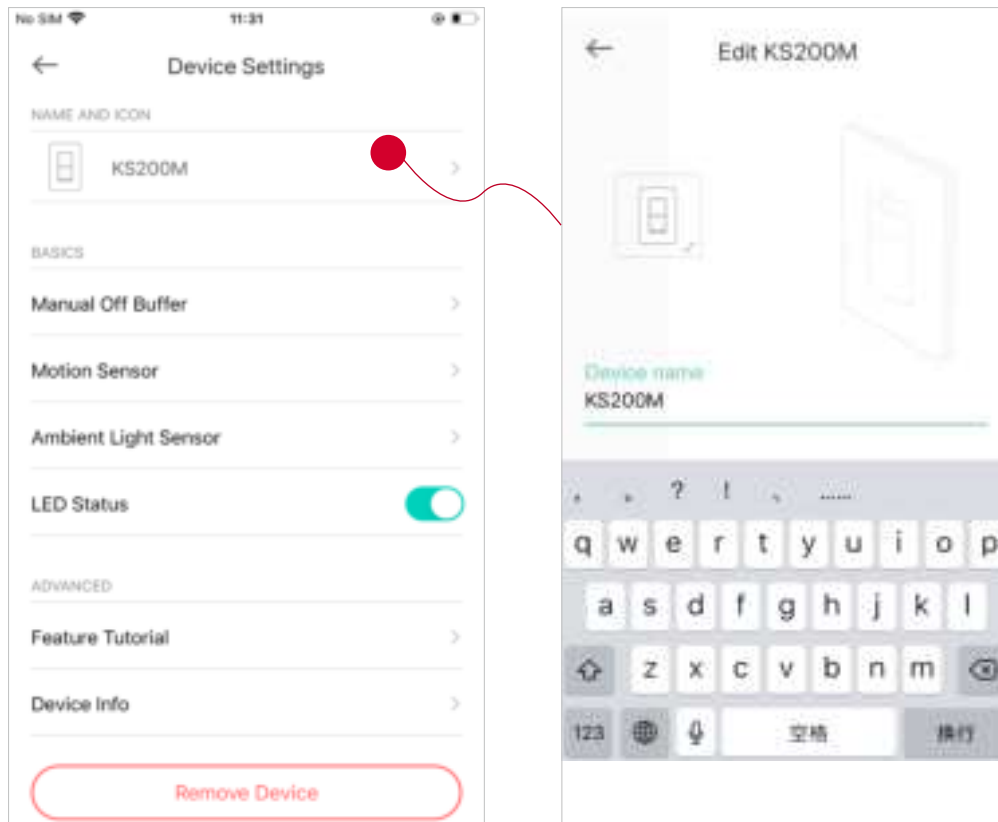

Set [Manual Off Buffer](#) time.

If you have set Smart Control for your light to be automatically turned on when motion is detected (or when motion is detected and it's dark), you don't want your steps to trigger the light on immediately after you manually turn off the light. Then you can set a buffer time before the Smart Control will activate to give you time to leave the room.

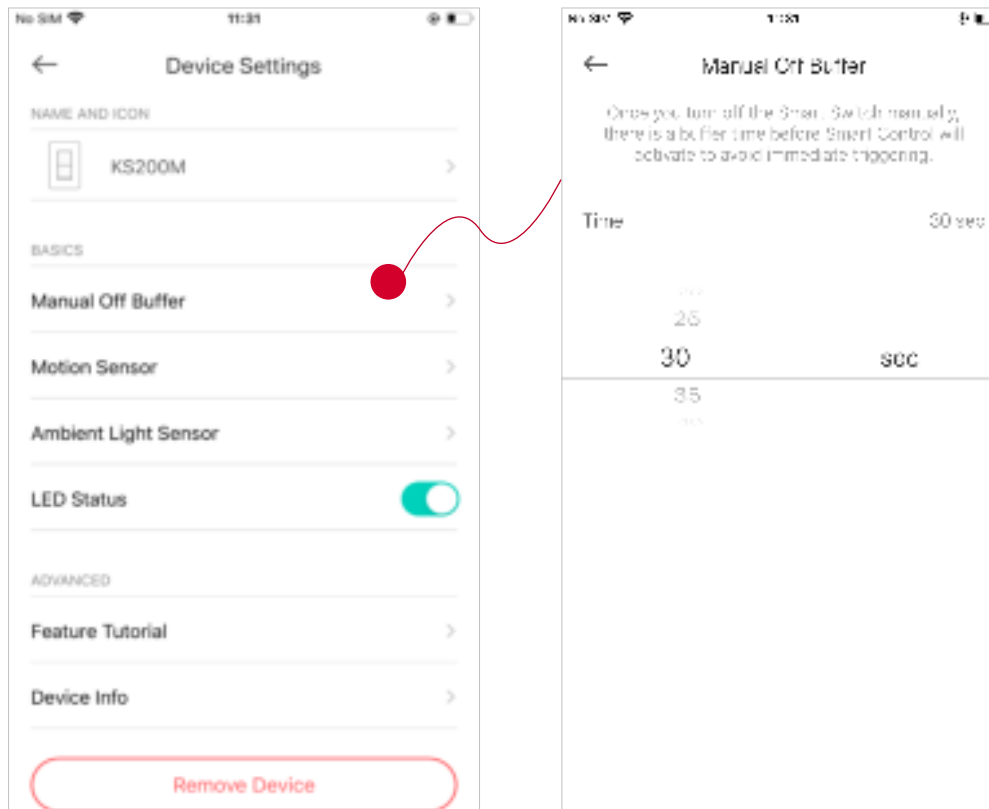

Edit [Motion Sensor](#) settings.

[Motion Sensor](#) is enabled by default. If you have set Smart Control and chosen the motion trigger, your light will be triggered on when motion is detected during the time period you set. You can change the sensitivity of the motion sensor.

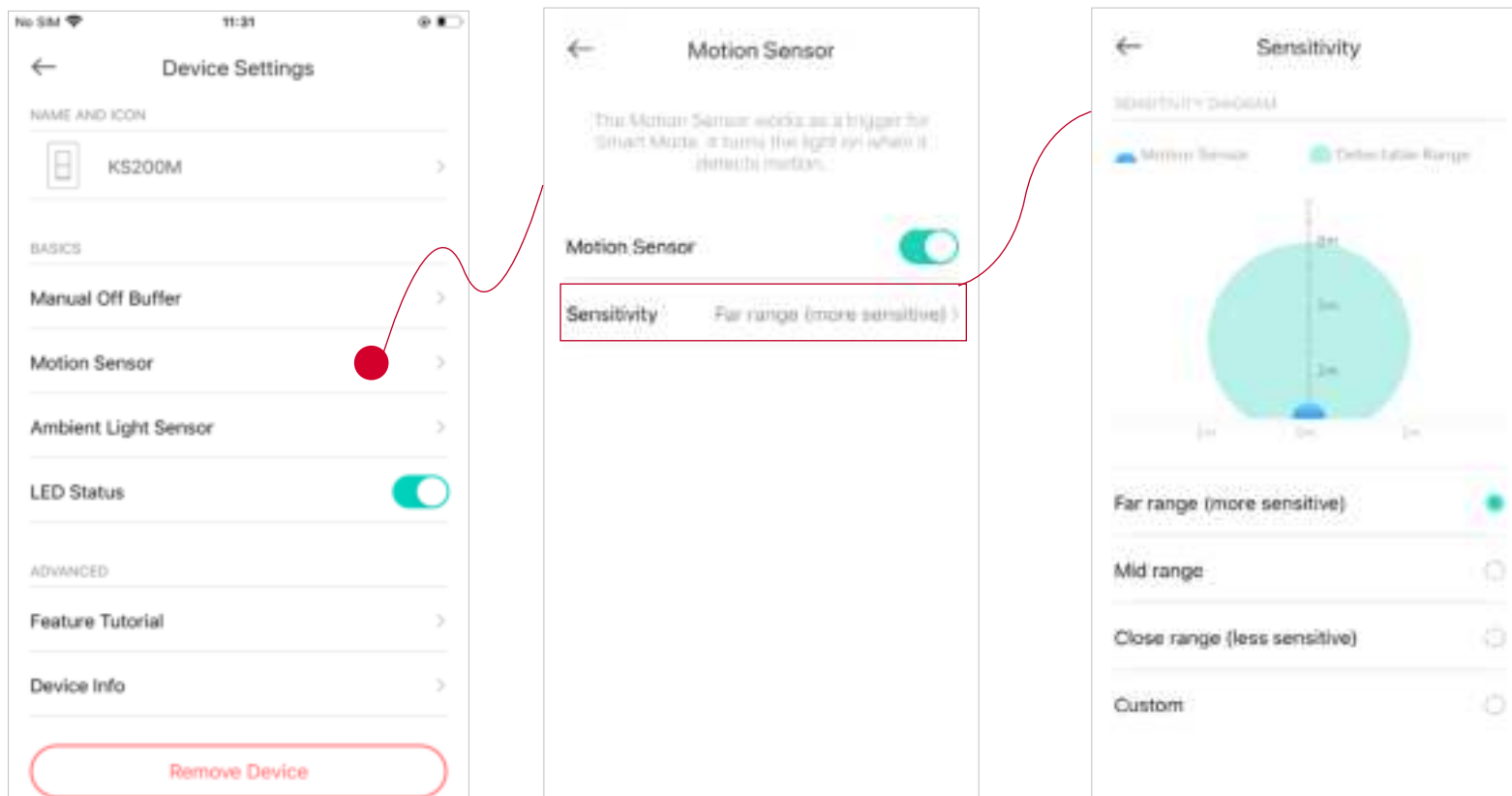

Edit [Ambient Light Sensor](#) settings.

It is enabled by default. If you have set Smart Control and chosen the trigger [Motion Detected When It's Dark](#), your light will be triggered on when ambient setting is reached and motion is detected. Preset ambient brightness in different environment is provided and can be changed. [Current Ambiance](#) is detected by your switch, which is a reference for you to adjust the preset ambient values. You can also customize the ambient setting.

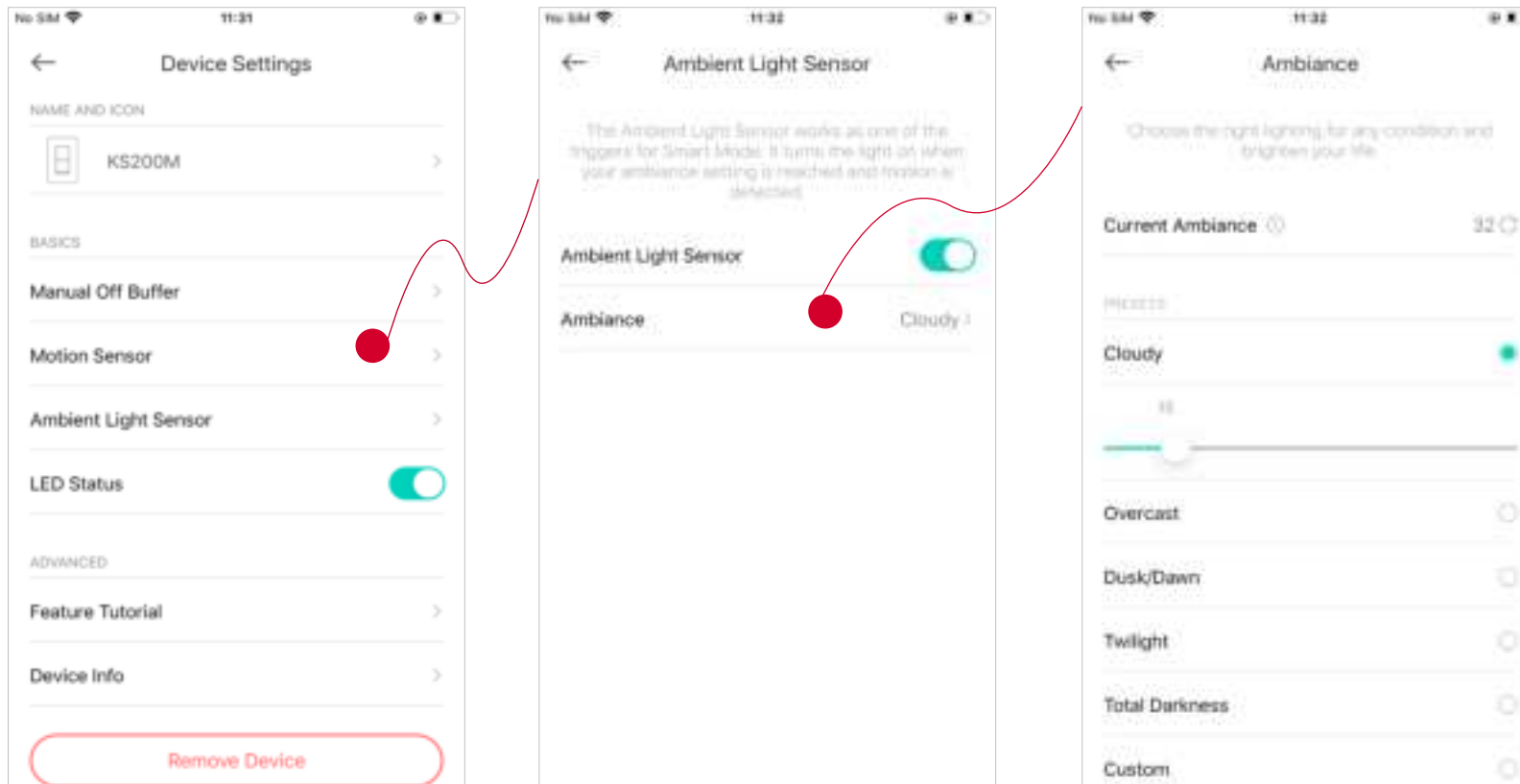

Turn on or off LED.

If you have set to turn off the switch if no motion is detected for a specific time period, the LED of the switch will flash as a sign when it's about to be off. Turning off [LED Status](#) will disable that feature.

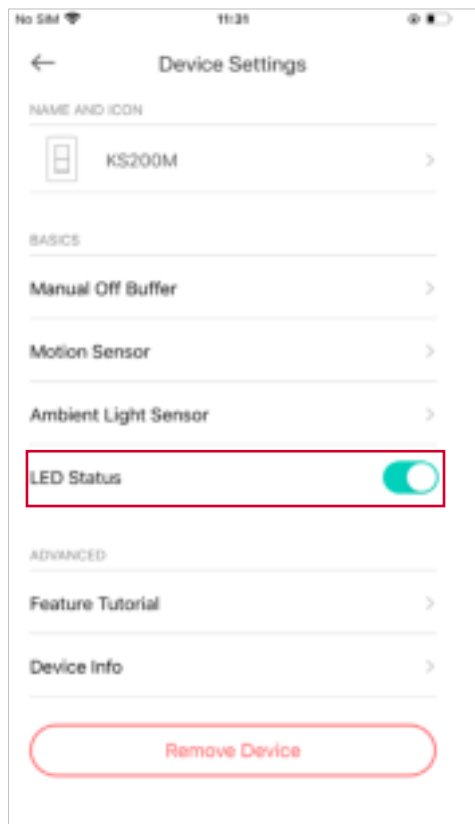

Reset Your Smart Light Switch

There are provides three methods to reset your Smart Light Switch.

Method 1

Swipe left any of your Smart Light Switch and tap [Delete](#). Then tap [Remove Device](#). Your Smart Light Switch will be removed from your Kasa account and restored to factory settings.

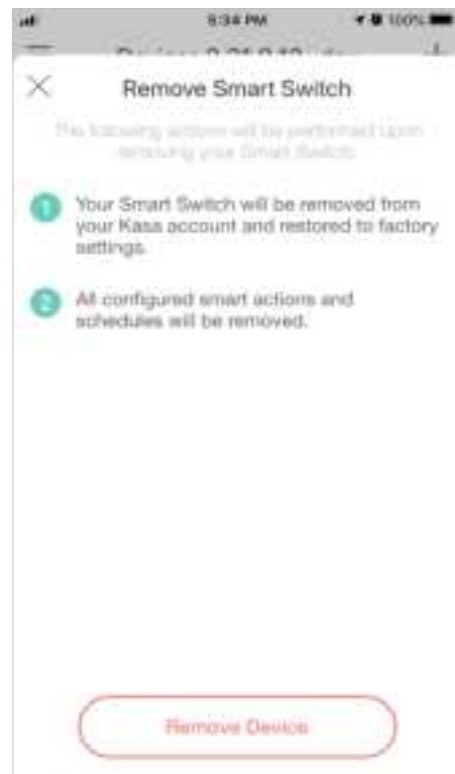

Method 2

Tap your Smart Light Switch and go to the [Devices Settings](#) page. Then tap [Remove Device](#) in the bottom. Your Smart Light Switch will be removed from your Kasa account and restored to factory settings.

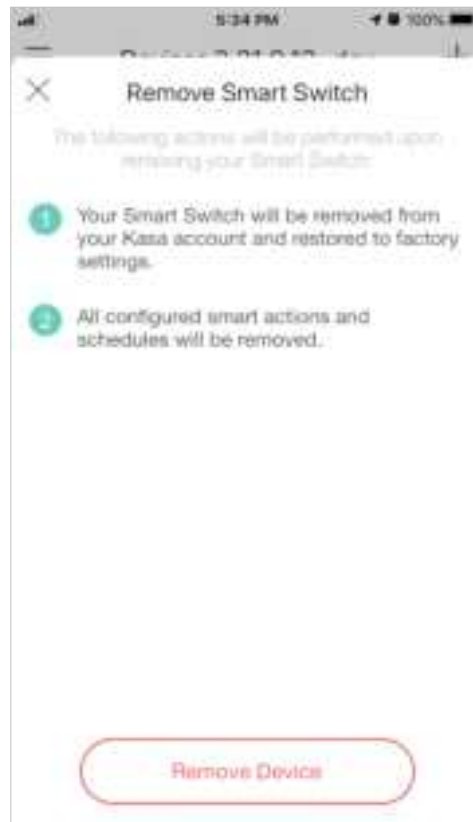
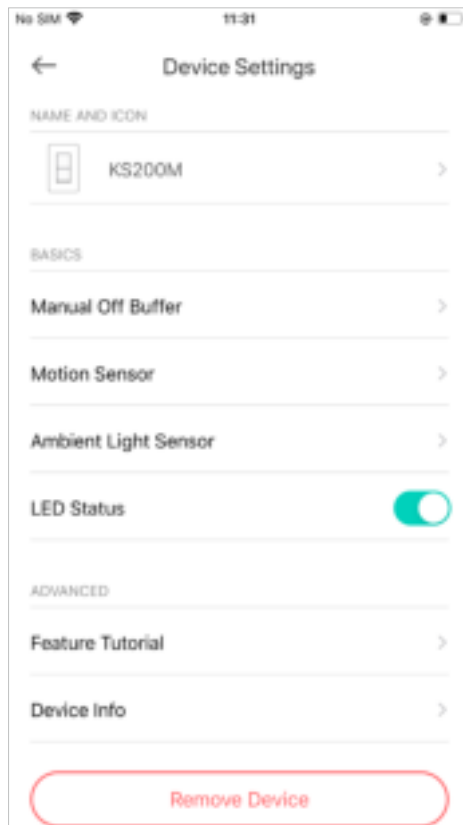

Method 3

Press and hold the **Reset** button on the panel of the switch for **10s** to restore your it to factory default settings.

Press and hold the **Reset** button on the panel of the switch for **5s** to reset Wi-Fi while keep previous settings.

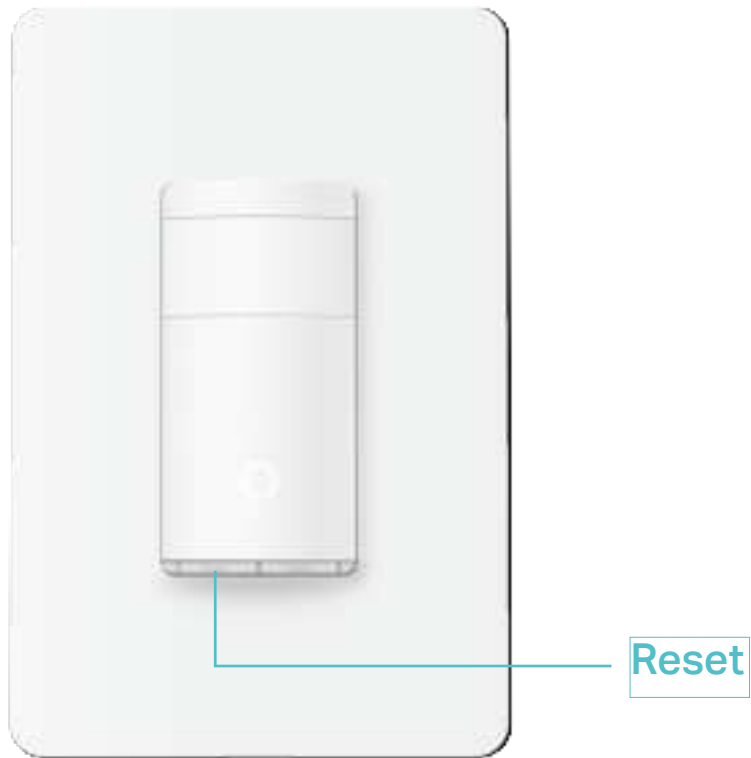

Create Groups

With groups, you can control multiple devices simultaneously. This page allows you to add your Smart Light Switch and your other Kasa smart devices to a group for unified management.

1. Create groups for your Smart Light Switch

1. Tap the  button in the Home page of the Kasa Smart app, and select [Group](#).

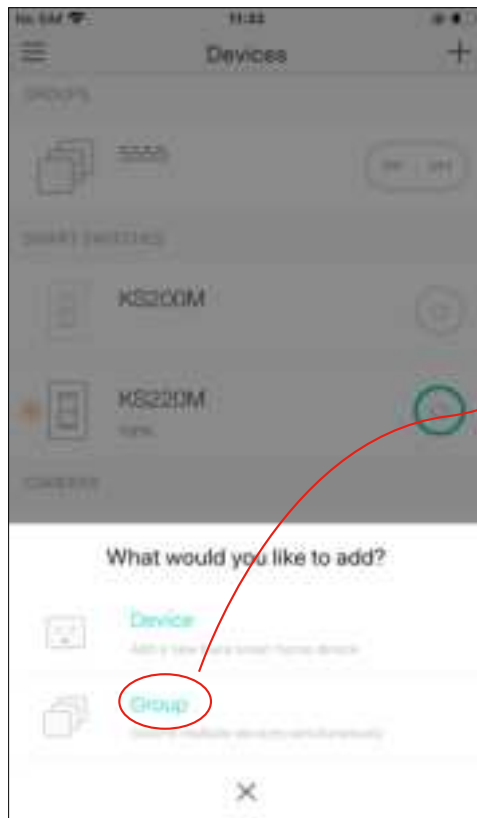

2. Select your switch and other Kasa smart devices and tap [Save](#).

e.g. I want to group my switch and my Kasa smart dimmer to turn on/off simultaneously.

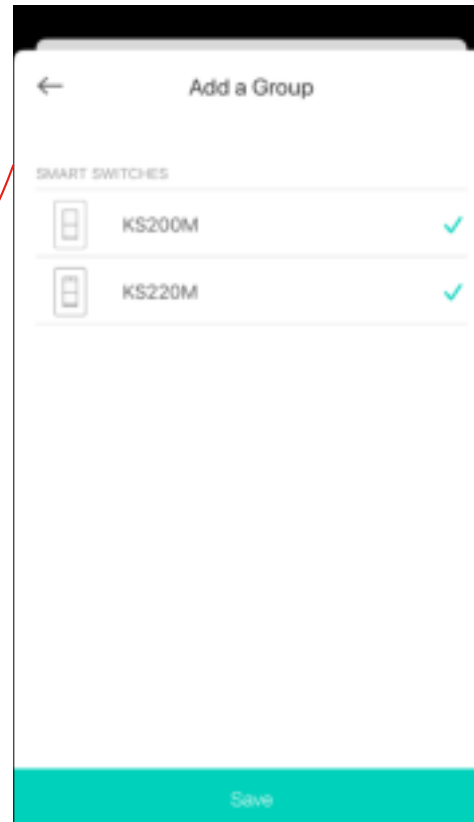

3. Name the group.

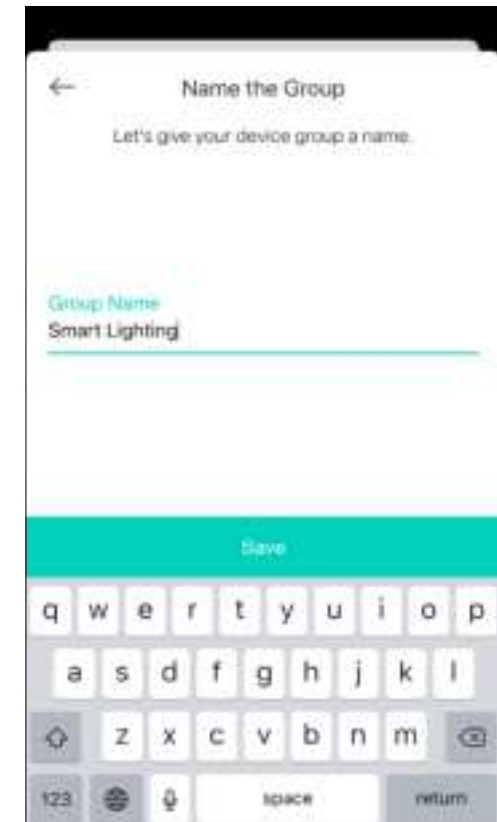

4. The created group is listed in the Home page. You can tap **ON** or **OFF** to turn on or off the devices together in the group.



2. Manage the group

1. Tap the group you want to manage.

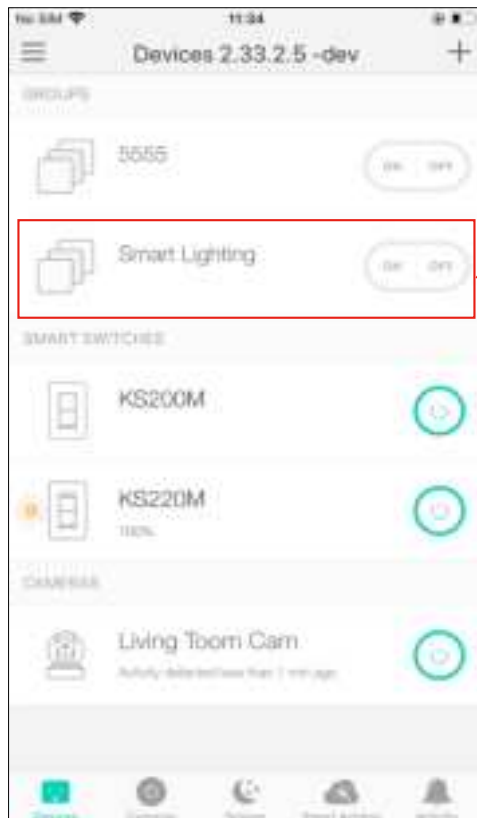



2. Turn on or off the Group in the status page.

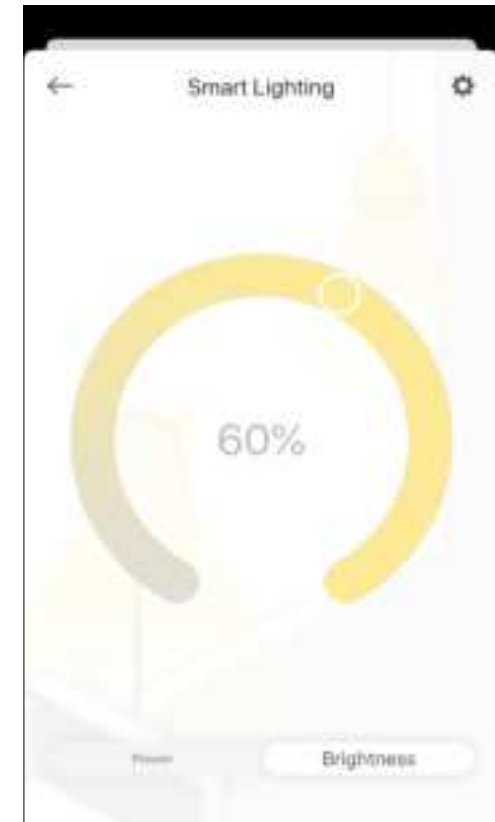

3. Tap Brightness to adjust the brightness of the smart dimmer.

Note: This is available only when the other Kasa device (here KS220M) supports brightness adjustment.



4. Tap  in the top right corner to enter the settings page. You can change the group name or devices in the group as you like.

5. Tap [Remove Group](#) if you want to remove the group from your device list. Then double confirm it. All devices in the group will remain accessible on the device list.

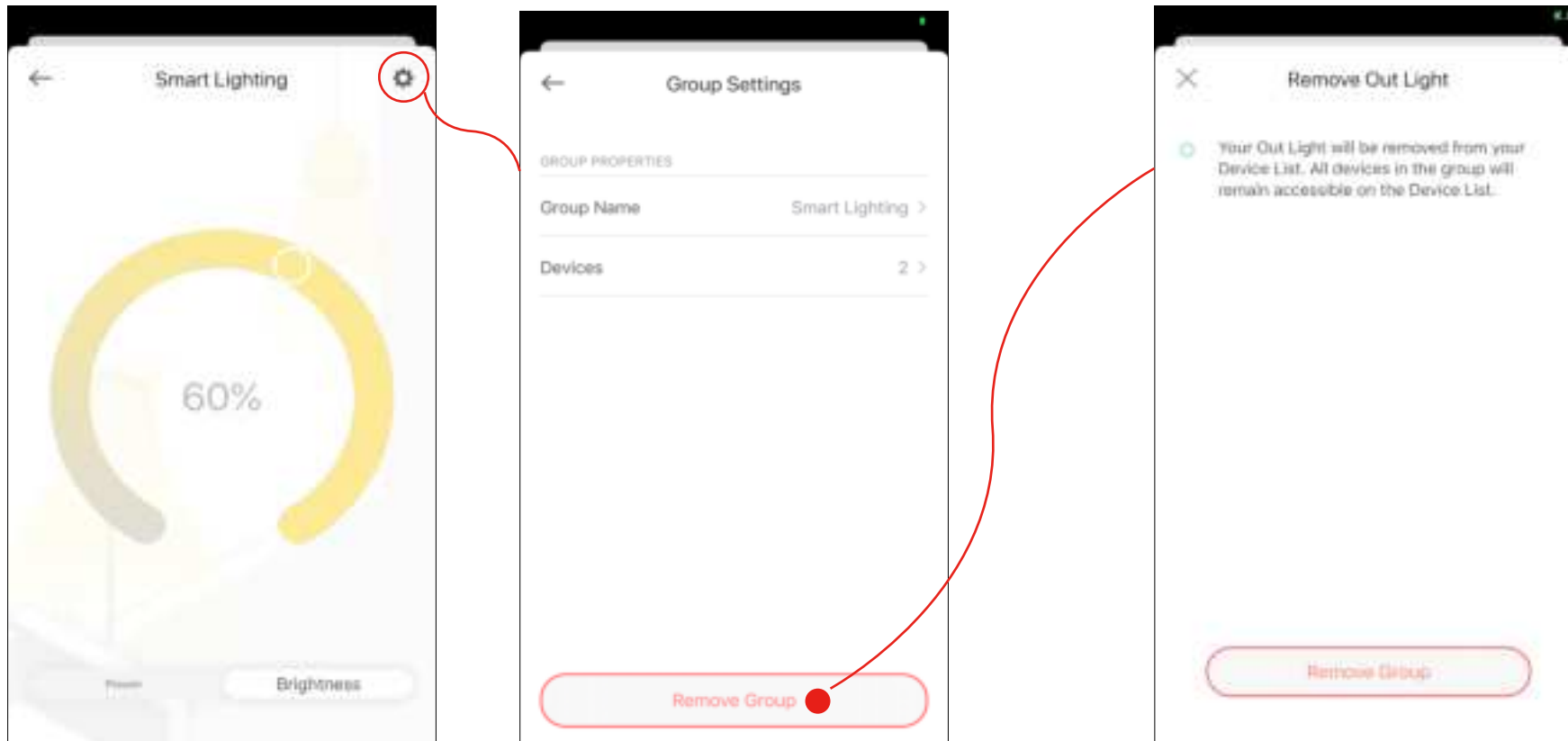

Create Scenes

A scene is a preset group of smart devices that can be programmed, customized and activated simultaneously at the touch of a button from your smartphone or tablet, allowing you to easily set your mood, activity or fit any special occasion. To create a scene with your Smart Light Switch, you need other Kasa smart devices, a smart plug for example.

1. Tap  at the bottom, then tap + at the top right corner.

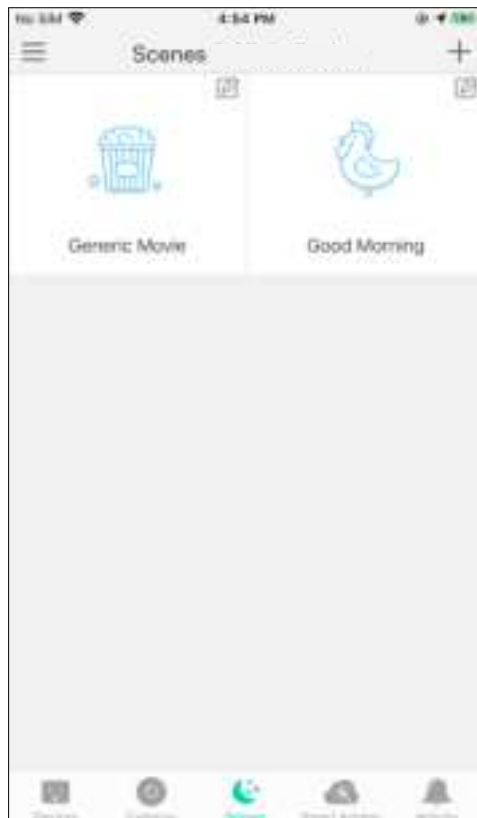

2. Select a scene or create your own scene.

For example: I want to turn on the light and the the speaker simultaneously in the morning with just a tap in the Kasa Smart app .

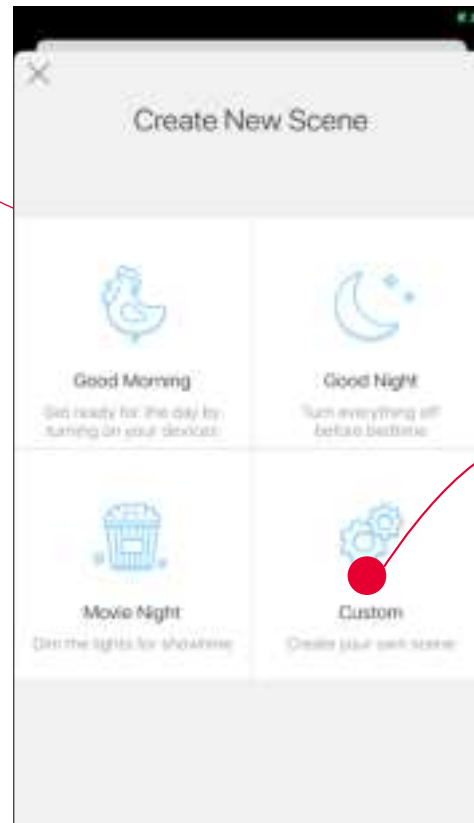

3. Select devices for the scene to work on and set their status respectively.

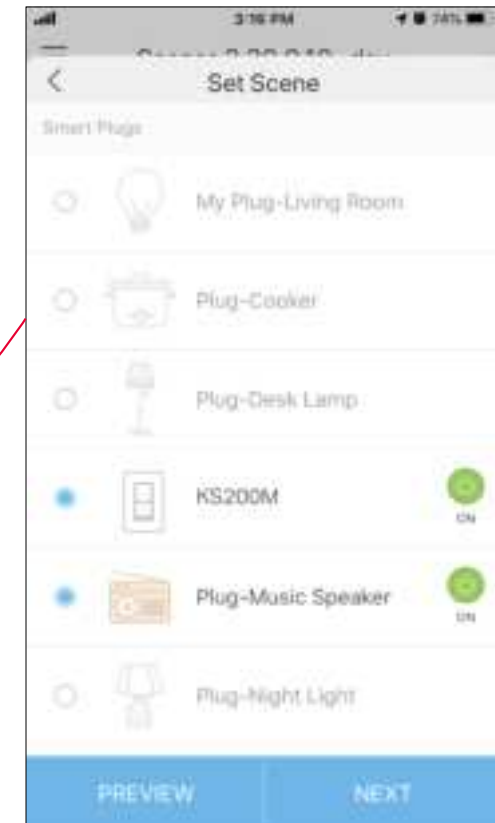

4. Pick an icon for your scene.



5. Name your scene.

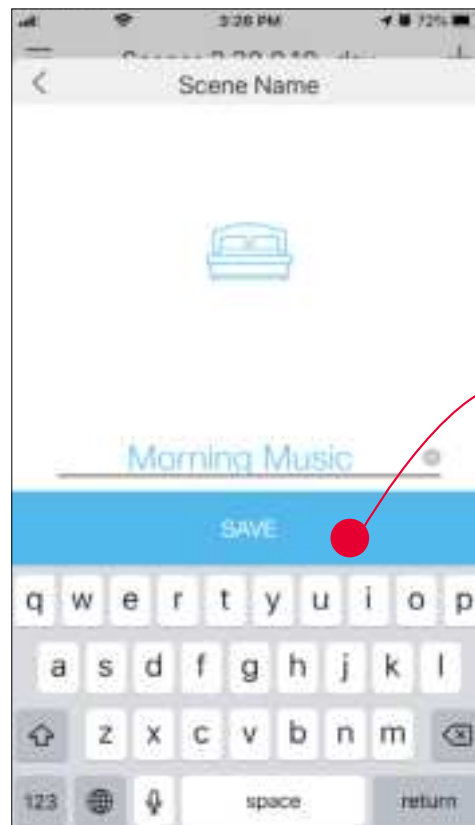

6. Your scene is created and is displayed in the scene list. Just tap the scene to activate it.

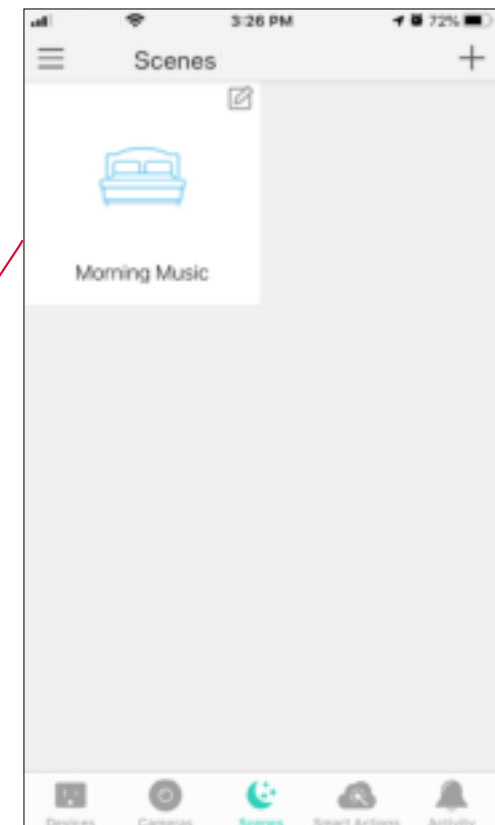

Smart Actions

Smart Actions is a function provided that enables device interconnections and home automations. With Smart Actions, your Kasa devices can work together to create a smarter smart home. From the moment you wake up to the moment you drift asleep, Smart Actions make your home safer and more comfortable.

1. Tap  at the bottom, then tap [Add an Action](#).

2. Select an automation type for your Smart Actions.

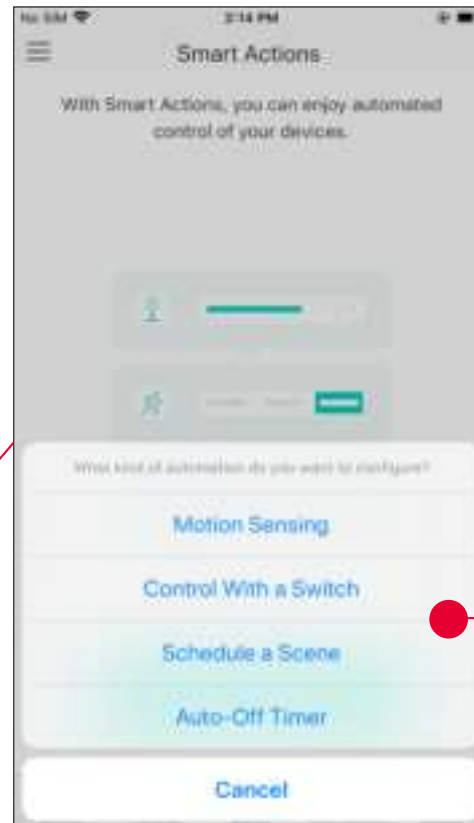
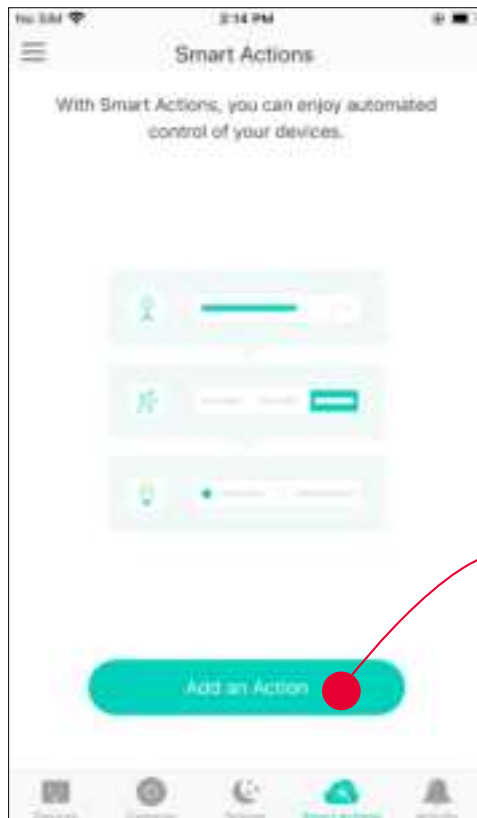

Motion Sensing: Take actions when a Kasa camera senses a motion.

Control With a Switch: Extend the Smart Switch control to other Kasa Smart devices. Turn on/off a group of devices with the Smart Switch all together.

Schedule a Scene: Schedule a "Scene" to be turned on automatically at the time specified.

Auto-off Timer: Whenever a smart device is turned on, turn it off after the designated amount of time.

1. Configure Motion Sensing If you already have a Kasa Camera

e.g. I want to turn the light on when my Kasa camera senses a motion.

1. Tap [Motion Sensing](#) then select a camera.

2. Select your Smart Light Switch.

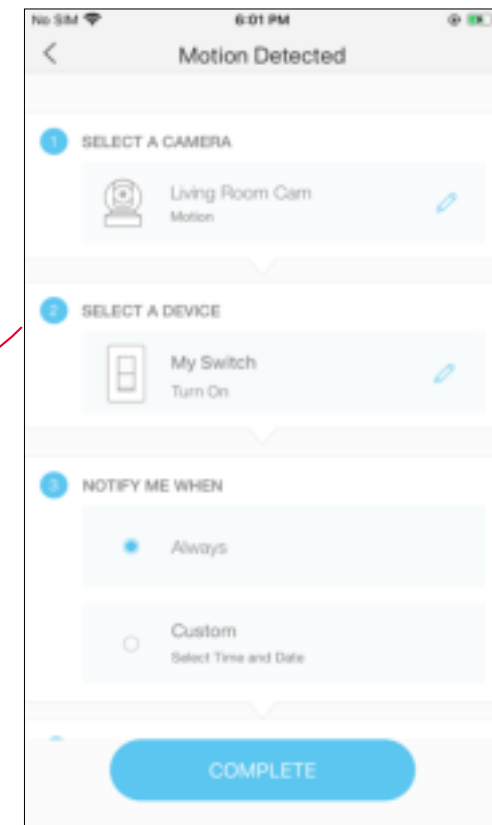
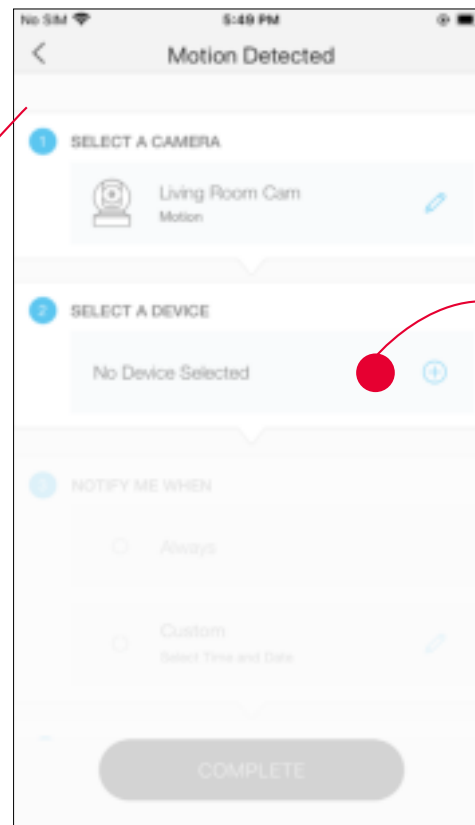
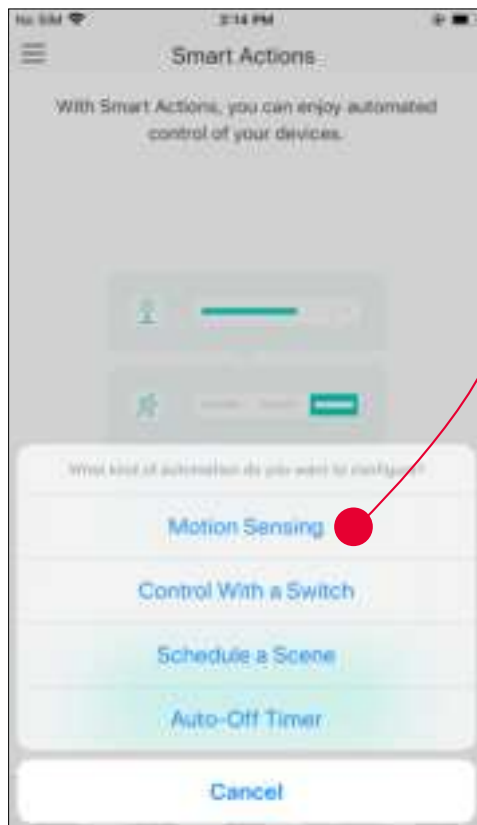

3. Set the time when you want the action to run. You can choose [Always](#) or tap [Custom](#) to choose time according to your needs.

For example: I want the motion to trigger the light on from 11:00 PM to 7:00 AM every day.

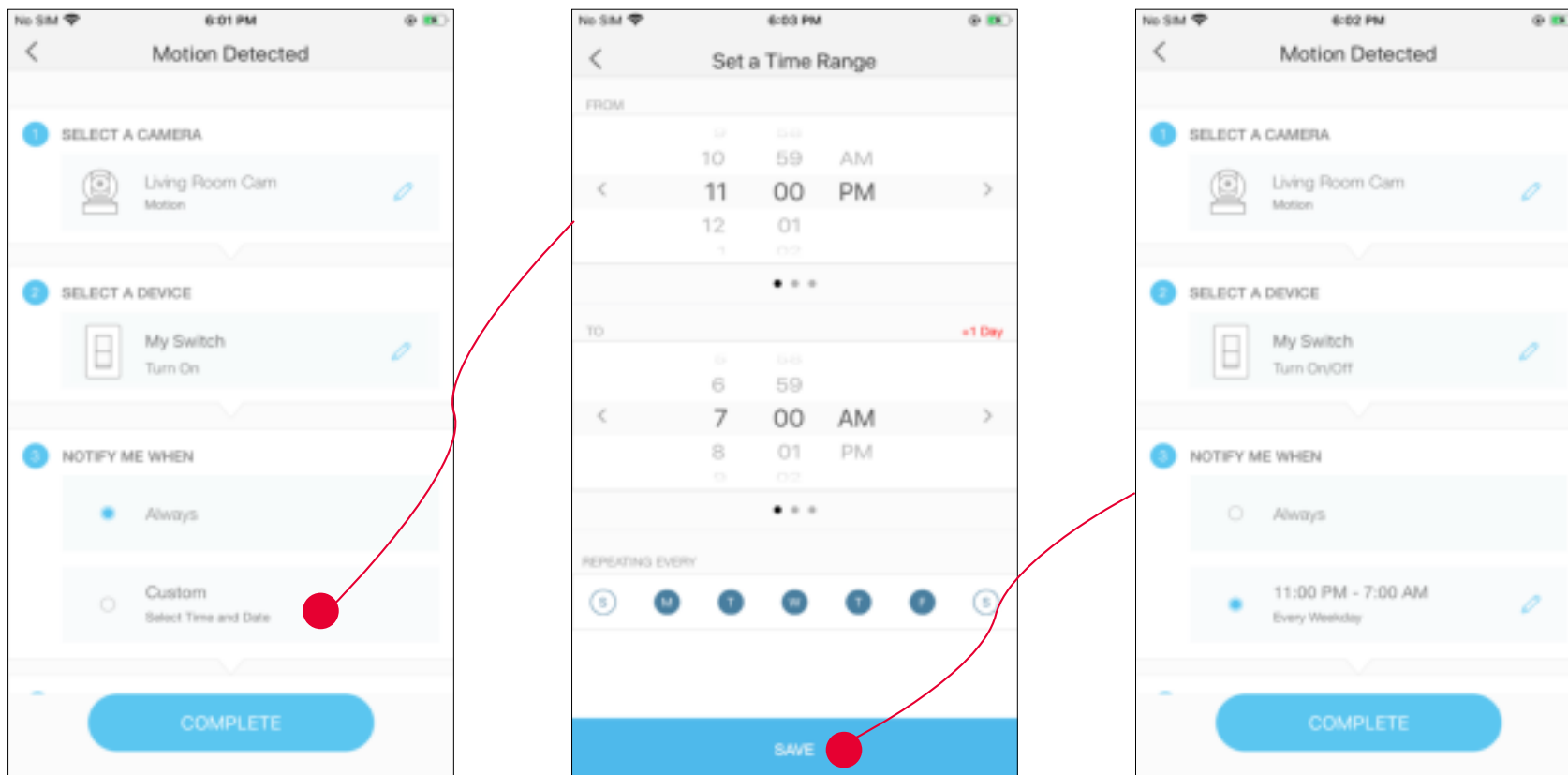

4. (Optional) Set an auto-off timer then tap [Complete](#). Then your living room light will be turned off after the time you set.

5. Name your action for easy identification.

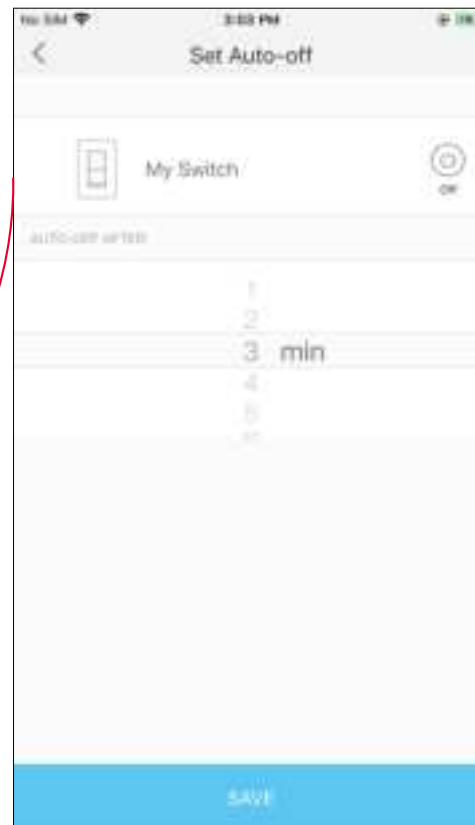
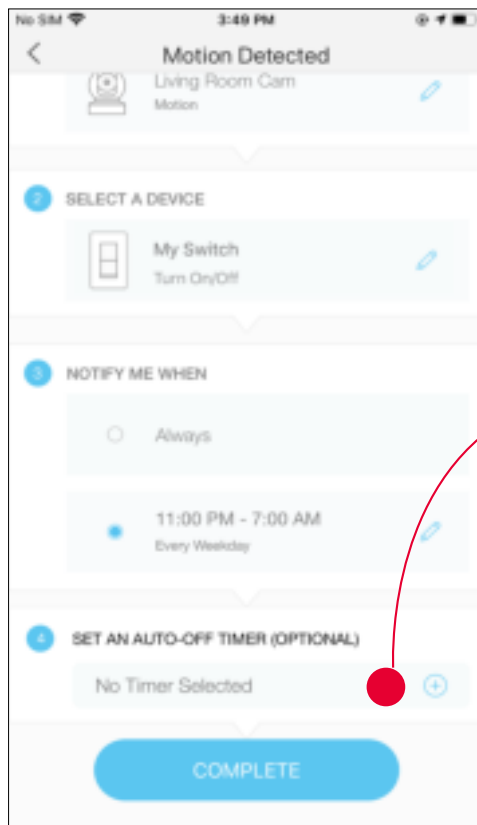

6. The Smart Action is created successfully and displayed in the Smart Actions list.

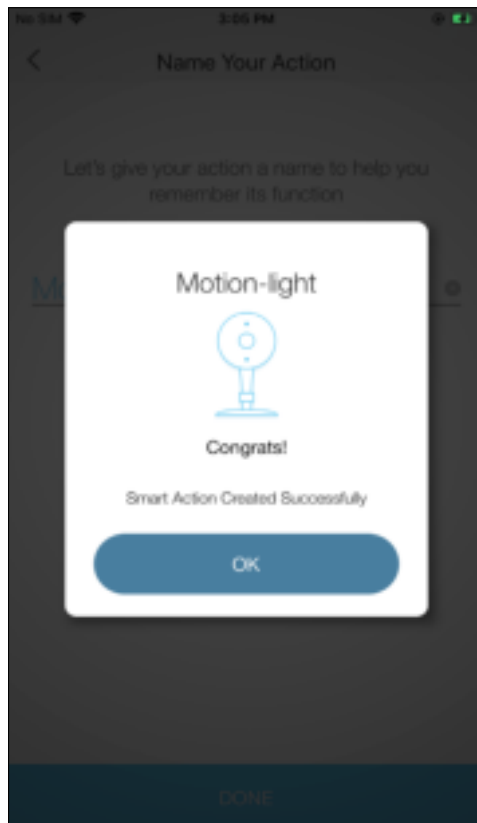

2. Configure Control With a Switch If you already have other Kasa smart devices

e.g. When I turn on my switch, I also want to turn on the living room light, which is plugged in my Kasa smart plug; when I turn off my switch, I also want the living room light off.

1. Tap [Control With a Switch](#).

2. Add your smart switch. Then select your Kasa smart plug which your living room light is plugged in.

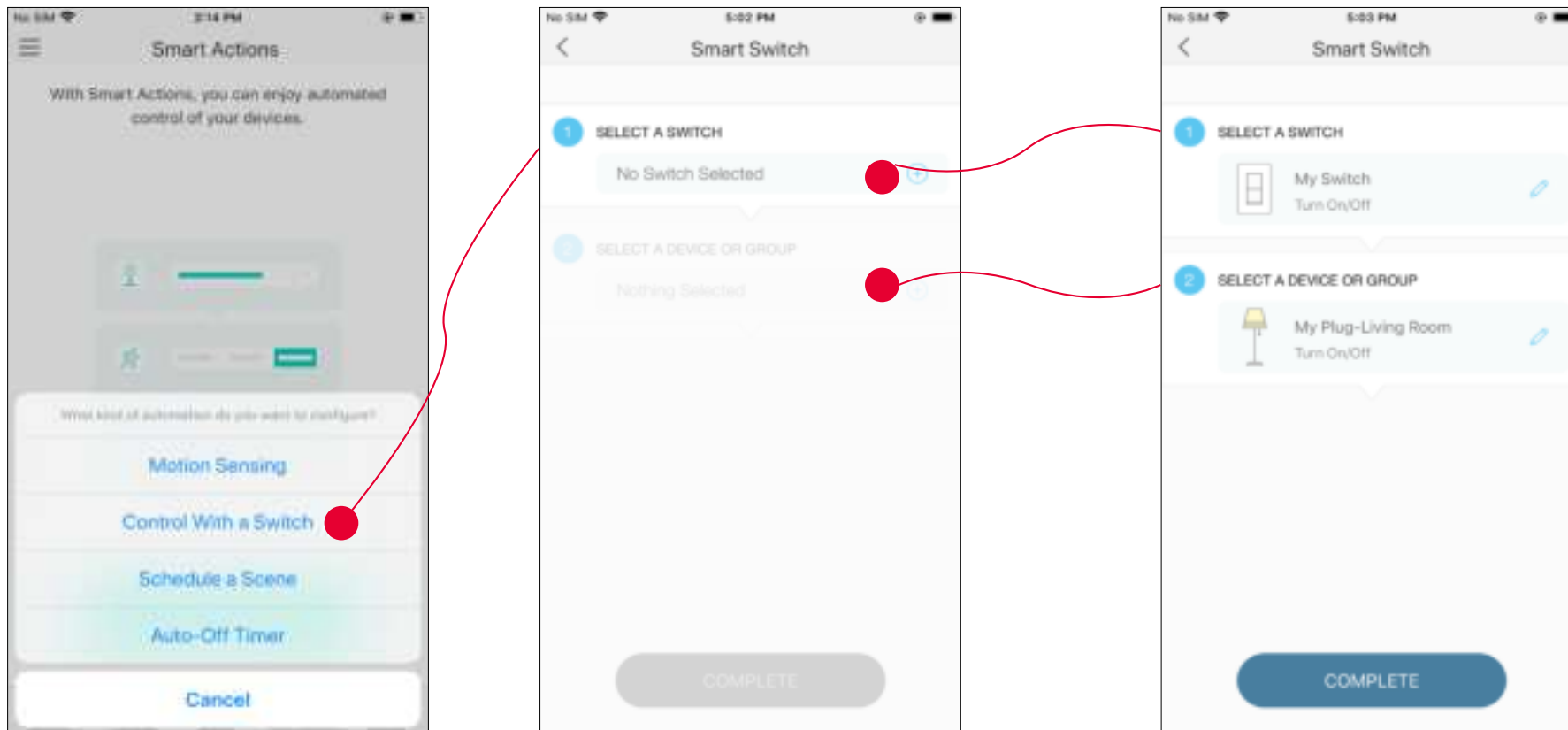

3. Name your action for easy identification.

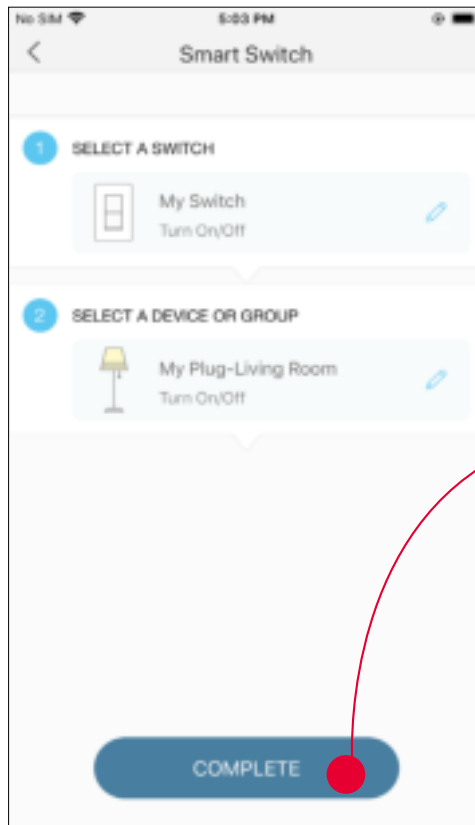

4. Now Your Smart Action is created successfully and is displayed in the smart actions list.



3. Configure Schedule a Scene

e.g. I want to turn on the scene I have created automatically at scheduled time.

1. Tap [Schedule a Scene](#) then select a scene you have created.

For example: I want to turn on my [Good Morning](#) scene, which turns on my switch and my music speaker (plugged in to a Kasa smart plug) with just a tap, at 7: 20 AM every weekday.

2. Set the time and frequency at which you want your scene to be activated.

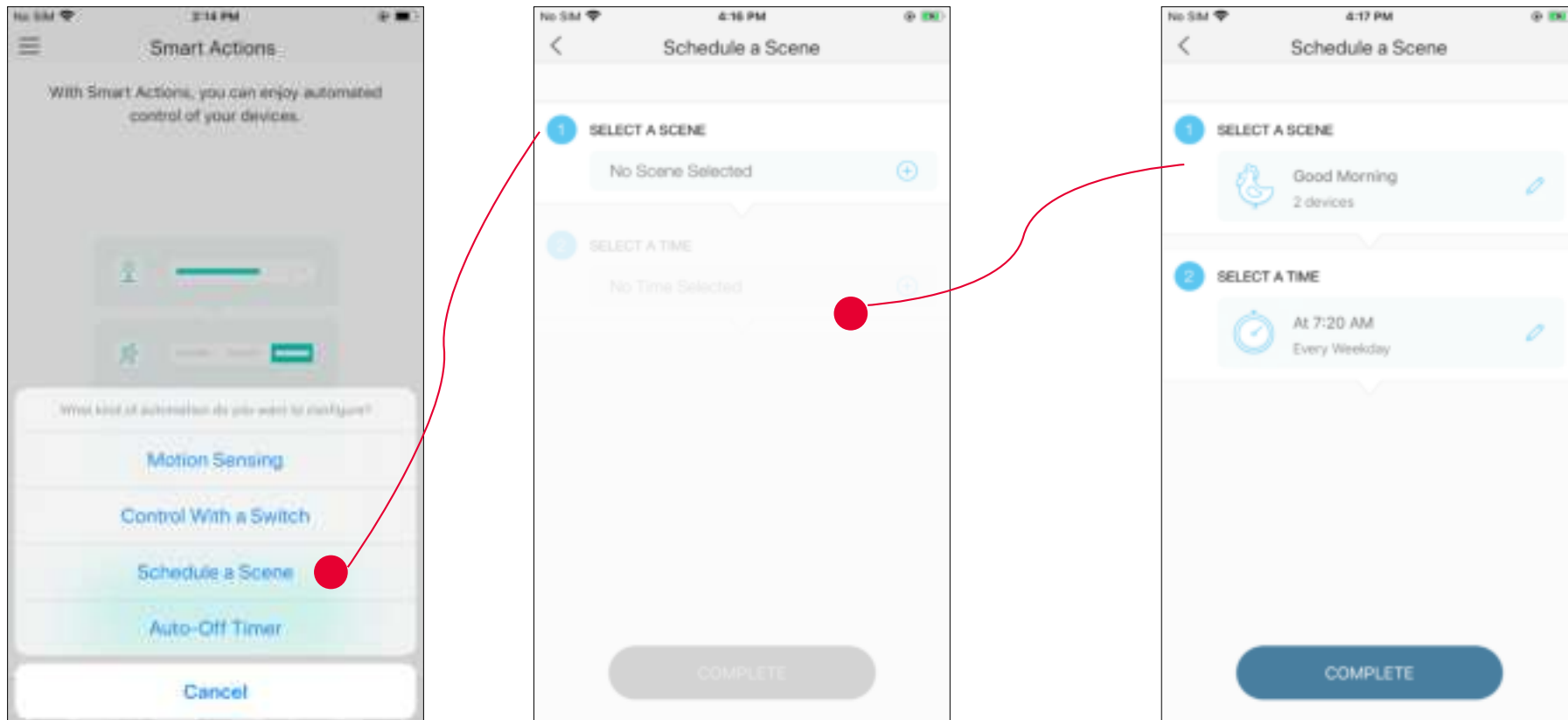

3. Name your action for easy identification.



4. The Smart Action is created successfully and displayed in the Smart Actions list.



4. Configure Auto-Off Timer

e.g. I want to turn off my Kasa Smart Light Switch after 30 minutes whenever it turns on.

1. Tap [Auto-Off Timer](#) then select your smart switch.

2. Set the time after which your smart switch will be off.

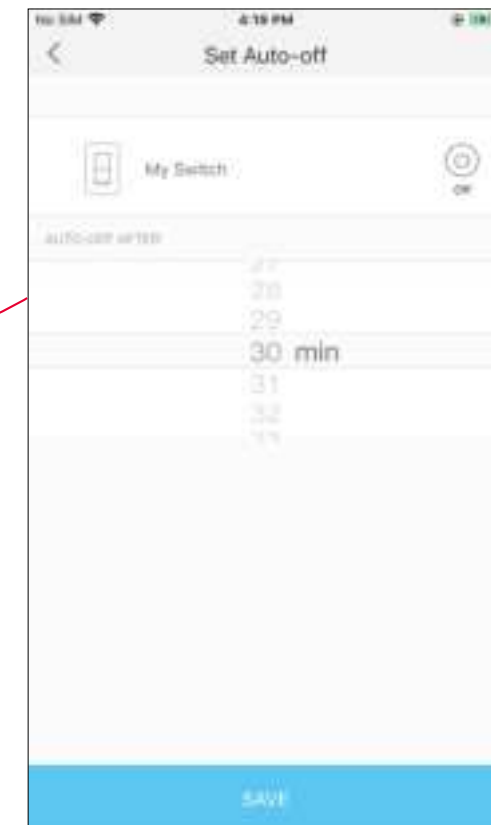
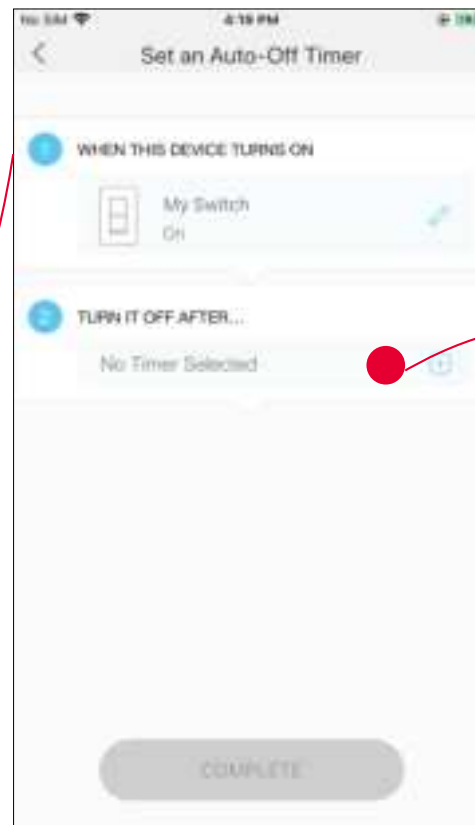
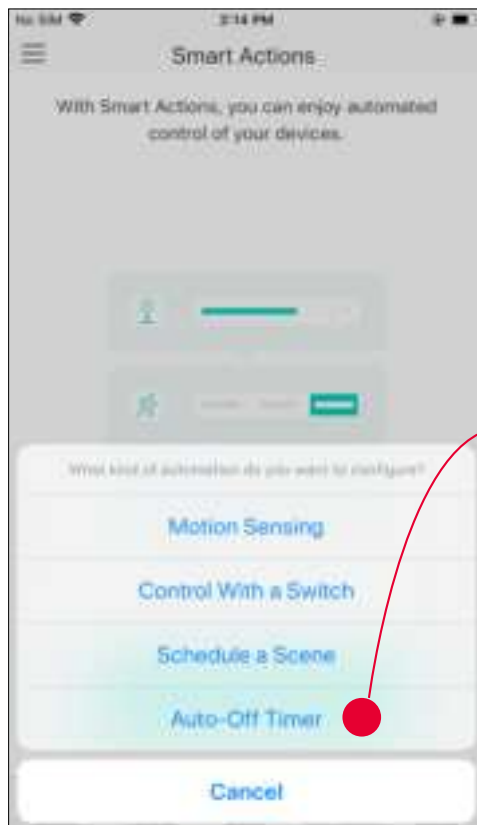

3. Name your action for easy identification.



4. The Smart Action is created successfully.

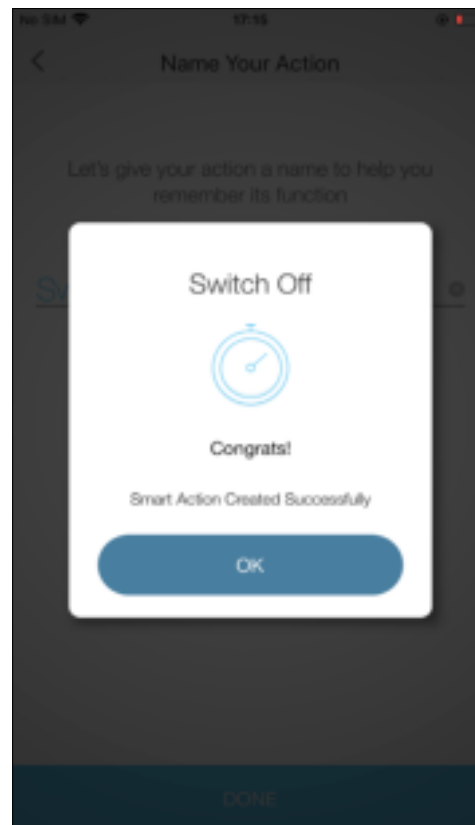

Discover Kasa

Use the Kasa Smart app to pair your Smart Wi-Fi Power Strip with Amazon Alexa or Google Home Assistant, and enjoy a full hands-free experience. Kasa helps manage the rest of your smart home too, working with Samsung SmartThings to trigger changes when you arrive home or leave for the day.

Launch the **Kasa Smart** app. Go to the sidebar and tap **Works with Kasa**. You can choose [Amazon Alexa](#) / [Google Assistant](#) / [IFTTT](#) / [Samsung SmartThings](#) for detailed instructions.

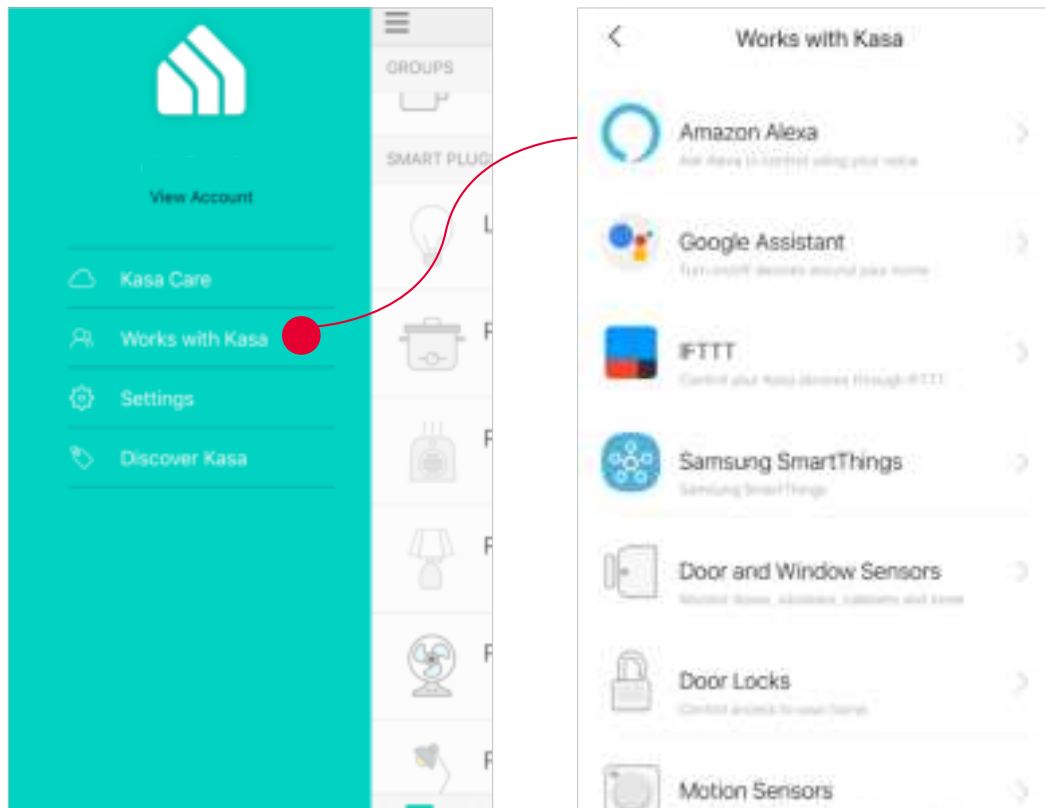

Authentication

FCC compliance information statement



Product Name: Kasa Smart Wi-Fi Light Switch, Motion Activated

Model Number: KS200M

Responsible party:

TP-Link USA Corporation

Address: 10 Mauchly, Irvine, CA 92618

Website: <http://www.tp-link.com/us/>

Tel: +1 626 333 0234

Fax: +1 909 527 6804

E-mail: sales.usa@tp-link.com

This equipment has been tested and found to comply with the limits for a Class B digital device, pursuant to part 15 of the FCC Rules. These limits are designed to provide reasonable protection against harmful interference in a residential installation. This equipment generates, uses and can radiate radio frequency energy and, if not installed and used in accordance with the instructions, may cause harmful interference to radio communications. However, there is no guarantee that interference will not occur in a particular installation. If this equipment does cause harmful interference to radio or television reception, which can be determined by turning the equipment off and on, the user is encouraged to try to correct the interference by one or more of the following measures:

- Increase the separation between the equipment and receiver.
- Connect the equipment into an outlet on a circuit different from that to which the receiver is connected.
- Consult the dealer or an experienced radio/ TV technician for help.

This device complies with part 15 of the FCC Rules. Operation is subject to the following two conditions:

1. This device may not cause harmful interference.

2. This device must accept any interference received, including interference that may cause undesired operation.

Any changes or modifications not expressly approved by the party responsible for compliance could void the user's authority to operate the equipment.

Note: The manufacturer is not responsible for any radio or TV interference caused by unauthorized modifications to this equipment. Such modifications could void the user's authority to operate the equipment.

FCC RF Radiation Exposure Statement

This equipment complies with FCC RF radiation exposure limits set forth for an uncontrolled environment. This device and its antenna must not be co-located or operating in conjunction with any other antenna or transmitter.

"To comply with FCC RF exposure compliance requirements, this grant is applicable to only Mobile Configurations. The antennas used for this transmitter must be installed to provide a separation distance of at least 20 cm from all persons and must not be co-located or operating in conjunction with any other antenna or transmitter."

We, **TP-Link USA Corporation**, has determined that the equipment shown as above has been shown to comply with the applicable technical standards, FCC part 15. There is no unauthorized change is made in the equipment and the equipment is properly maintained and operated.

Issue Date: 2021.06.28

Canadian Compliance Statement

This device contains licence-exempt transmitter(s)/receiver(s) that comply with Innovation, Science and Economic Development Canada's licence-exempt RSS(s). Operation is subject to the following two conditions:

(1) This device may not cause interference.

(2) This device must accept any interference, including interference that may cause undesired operation of the device.

L'émetteur/récepteur exempt de licence contenu dans le présent appareil est conforme aux CNR d'Innovation, Sciences et Développement économique Canada applicables aux appareils radio exempts de licence. L'exploitation est autorisée aux deux conditions suivantes :

1) L'appareil ne doit pas produire de brouillage;

2) L'appareil doit accepter tout brouillage radioélectrique subi, même si le brouillage est susceptible d'en compromettre le fonctionnement.

Radiation Exposure Statement:

This equipment complies with IC radiation exposure limits set forth for an uncontrolled environment. This equipment should be installed and operated with minimum distance 20cm between the radiator & your body.

Déclaration d'exposition aux radiations:

Cet équipement est conforme aux limites d'exposition aux rayonnements IC établies pour un environnement non contrôlé. Cet équipement doit être installé et utilisé avec un minimum de 20 cm de distance entre la source de rayonnement et votre corps.

Industry Canada Statement

CAN ICES-3 (B)/NMB-3(B)

NCC & BSMI Notice

注意！

取得審驗證明之低功率射頻器材，非經核准，公司、商號或使用者均不得擅自變更頻率、加大功率或變更原設計之特性及功能。

低功率射頻器材之使用不得影響飛航安全及干擾合法通信；經發現有干擾現象時，應立即停用，並改善至無干擾時方得繼續使用。

前述合法通信，指依電信管理法規定作業之無線電通信。

低功率射頻器材須忍受合法通信或工業、科學及醫療用電波輻射性電機設備之干擾。

安全諮詢及注意事項

- 請使用原裝電源供應器或只能按照本產品注明的電源類型使用本產品。
- 清潔本產品之前請先拔掉電源線。請勿使用液體、噴霧清潔劑或濕布進行清潔。
- 注意防潮，請勿將水或其他液體潑灑到本產品上。
- 插槽與開口供通風使用，以確保本產品的操作可靠並防止過熱，請勿堵塞或覆蓋開口。
- 請勿將本產品置放於靠近熱源的地方。除非有正常的通風，否則不可放在密閉位置中。
- 不要私自拆開機殼或自行維修，如產品有故障請與原廠或代理商聯繫。

限用物質含有情況標示聲明書

設備名稱： Equipment name Kasa Smart Wi-Fi Light Switch, Motion Activated			型號（型式）： Type designation (Type) KS200M			
單元 Unit	限用物質及其化學符號 Restricted substances and its chemical symbols					
	鉛 Lead (Pb)	汞 Mercury (Hg)	鎘 Cadmium (Cd)	六價鉻 Hexavalent chromium (Cr+6)	多溴聯苯 Polybrominated biphenyls (PBB)	多溴二苯醚 Polybrominated diphenyl ethers (PBDE)
PCB	○	○	○	○	○	○
外殼	○	○	○	○	○	○
電源供應板	—	○	○	○	○	○
其他及其配件	—	○	○	○	○	○
備考 1. “超出 0.1 wt %” 及 “超出 0.01 wt %” 係指限用物質之百分比含量超出百分比含量基準值 Note 1: “Exceeding 0.1 wt %” and “exceeding 0.01 wt %” indicate that the percentage content of the restricted substance exceeds the reference percentage value of presence condition. 備考 2. “○” 係指該項限用物質之百分比含量未超出百分比含量基準值。 Note 2: “○” indicates that the percentage content of the restricted substance does not exceed the percentage of reference value of presence. 備考 3. “—” 係指該項限用物質為排除項目。 Note 3: The “—” indicates that the restricted substance corresponds to the exemption.						

Safety Information

- Keep the device away from water, fire, humidity or hot environments.
- Do not attempt to disassemble, repair, or modify the device.
- Do not use the device where wireless devices are not allowed.
- The socket-outlet shall be installed near the equipment and shall be easily accessible.
- Operating temperature: 0°C ~40°C (32 °F ~104 °F)
- Storage Temperature: -40°C~60°C (-40 °F ~140 °F)

Follow all national and local safety regulations and practices. If you are uncertain or uncomfortable when performing the installation, consult a qualified electrician.

- Install only in a suitable UL or equivalent Listed outlet box.(suitable dimensions: W > 2.83in./72mm, H > 1.81in./46mm, D > 3.15in./80mm).
- CAUTION – Risk of electric Shock – More than one disconnect switch may be required to de-energize the equipment before servicing. A circuit breaker which disconnects the Live and Neutral conductor simultaneously is suitable. Ensure power is off at the circuit breaker before removing or installing any wall switch.
- Do not install the Smart Switch with wet hands or when standing on wet or damp surfaces.
- The Smart Switch must be installed and used in accordance with the National Electric Code (NEC) or your local electrical code. If you are unfamiliar with these codes and requirements, or are uncomfortable performing the installation, consult a qualified electrician.







CAUTION

Electronic switch integrated in this product is only intended for functional purposes. De-energized the product at the circuit breaker before servicing.

Please read and follow the above safety information when operating the device. We cannot guarantee that no accidents or damage will occur due to improper use of the device. Please use this product with care and operate at your own risk.

Explanation of the symbols on the product label

Symbol	Explanation
	Indoor use only
	AC voltage
	DC voltage
	<p>RECYCLING</p> <p>This product bears the selective sorting symbol for Waste electrical and electronic equipment (WEEE). This means that this product must be handled pursuant to European directive 2012/19/EU in order to be recycled or dismantled to minimize its impact on the environment.</p> <p>User has the choice to give his product to a competent recycling organization or to the retailer when he buys a new electrical or electronic equipment.</p>