

FIRSTECH, LLC.
SUPPORT - 1(888) 820-3690, EXT. 203

Covered vehicle use **BLADE-AL-SUB9** firmware and the following required accessories, Weblink Hub & ACC RFID1. Flash module, and update the controller firmware. ***Please follow the directions for RFID programming before attempting to program the BLADE module to the vehicle.***

Immobilizer: Type B IMMO requires connecting the black and white 2-pin connectors at marker [C] of the illustration.

ACC-RFID1 (REQUIRED): SUB9 firmware does not provide immobilizer data, an ACC-RFID1 is therefore required for remote start

I/O Changes: None required

Advisory 2: Secure all 2-pin connections, both used and unused, to the main harness body.

- A** REQUIRED ACCESSORY
- B** ADAPTER REQUIRED
- C** REQUIRED CONFIGURATION (TYPE B IMMO)
- D** NO CONNECTION
- E** NO CONNECTION

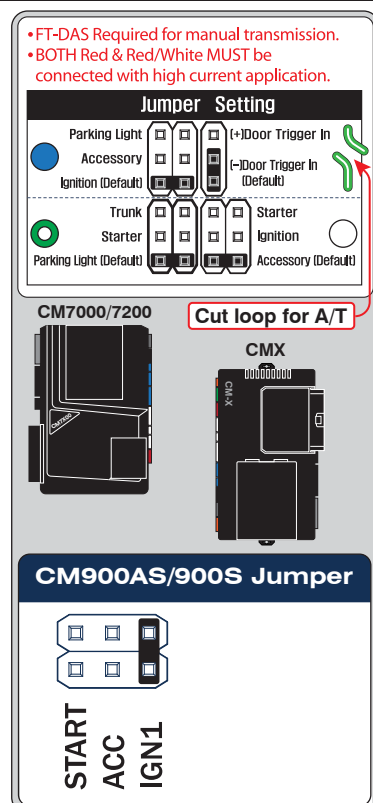
[illegible]

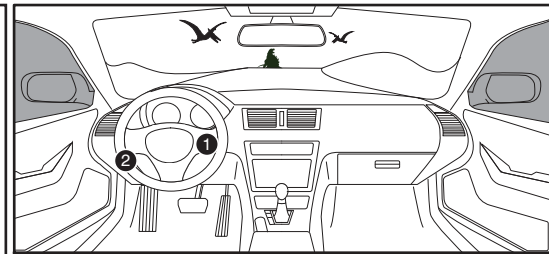

Diagram 1 shows the lock assembly with the key inserted. The key is turned to the 'LOCK' position, and the 'ASS.' (Assurance) label is visible on the lock body. The lock is mounted on a wall plate.

2

WHITE

20 40 1 21

GRAY

10 20 1 11

**BCM/FUSEBOX
DRIVER SIDE DASH**

REAR VIEW

- 1x RED = Unable to communicate with RFID or immobilizer data.
- 2x RED = No CAN activity. Check the CAN wire connections.
- 3x RED = No ignition detected. Check the ignition wire connection and CAN.
- 4x RED = Required ignition output diode not detected.

CARTRIDGE INSTALLATION

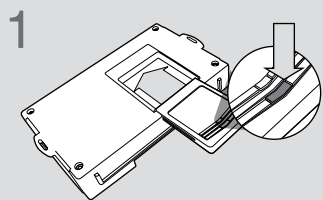

Slide cartridge into unit. Notice button under LED.

2

Ready for Module Programming Procedure.

MODULE PROGRAMMING PROCEDURE



For this installation, the Weblink HUB is required.



Remove OEM key 1 from keychain.



Place all other keyfobs at least 1 foot away from the Weblink HUB. Failure to comply may result in damage to other keyfobs or interfere with the keyfob reading process.



Flash the module using the Weblink HUB. Follow the on screen instructions to complete the keyfob reading process.

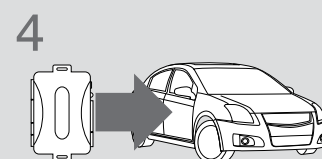

WARNING:
Do not press the module programming button.
Connect power first.
Connect module to vehicle.



Using OEM key 1, turn key to ON position.

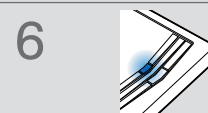

Wait, LED will turn solid BLUE for 2 seconds



Turn key to OFF position.

Module Programming Procedure completed.