

## INSTALLATION INFORMATION

This section of the manual covers some of the installation issues a service technician may need to know when servicing a Wolf Wall Oven. If additional information is needed after reviewing this section of the manual, please refer to the Installation Guide or contact the Wolf Appliance Customer Service Department.

### Electrical Requirements:

#### Single Oven

- 208/220-240 volts AC, 60 Hertz, 30 Ampere fused electrical supply.

#### Double Oven

- 208/220-240 volts AC, 60 Hertz, 50 Ampere fused electrical supply.

### Minimum Wire Size:

- L1, L2 and Ground: 10 AWG
- Neutral: 12 AWG

This appliance must be properly grounded. This appliance is equipped with a 60" conduit consisting of two insulated hot lead copper conductors, one insulated neutral copper conductor and one uninsulated ground copper conductor.

### WARNING

**THIS APPLIANCE MUST BE PROPERLY GROUNDED AT ALL TIMES WHEN ELECTRICAL POWER IS APPLIED.**

**DO NOT GROUND THE APPLIANCE WITH THE NEUTRAL (WHITE) HOUSE SUPPLY WIRE. A SEPERATE GROUND WIRE MUST BE UTILIZED.**

**IF ALUMINUM HOUSE SUPPLY WIRING IS UTILIZED, SPLICE THE APPLIANCE COPPER WIRE TO THE ALUMINUM HOUSE WIRING USING SPECIAL CONNECTORS DESIGNED AND CERTIFIED FOR JOINING COPPER AND ALUMINUM. FOLLOW THE CONNECTORS MANUFACTURERS RECOMMENDED PROCEDURE CAREFULLY. IMPROPER CONNECTION CAN RESULT IN A FIRE HAZARD.**

### Oven Installation

Use the upper edge of the cavity opening and the bottom of the oven chassis side as gripping points to lift the oven into the cabinet cutout. Slide the oven into the recessed area until the unit is approximately six inches from being fully installed. This will allow for installation of the oven trim kit.

**NOTE:** The oven door(s) may be removed to reduce the weight of the oven when lifting into cabinet opening.

### ⚠ CAUTION

Do not lift or carry the oven door(s) by the door handle.

### Trim Installation

Attach the left and right side trim to the bottom and middle trim prior to installing on the oven. (See Figure 2-1).

**NOTE:** The middle trim is for double ovens only.

Peel off the adhesive backing on the flat washers. Attach the flat washers centered over the holes of the raised sides of the oven cavity frame.

**NOTE:** Four washers for single oven and eight washers for double oven.

Install the trim to the oven using the screws provided in the trim kit. Now, locate the mounting holes found on the sides of the oven trim. Then, use a drill with a 1/16" drill bit and drill four pilot holes for the cabinet mounting screws. Install the mounting screws through the oven side trim and into the cabinet. (See figure 2-2).

**NOTE:** Do not overtighten the mounting screws.

### ⚠ WARNING

**FAILURE TO INSTALL THE MOUNTING SCREWS MAY RESULT IN MOVEMENT OR TIPPING OF THE OVEN DURING USE.**

### ⚠ CAUTION

Do not block the oven air exhaust located at the bottom of the oven. Blocking the exhaust may result in cabinet damage and poor baking performance.

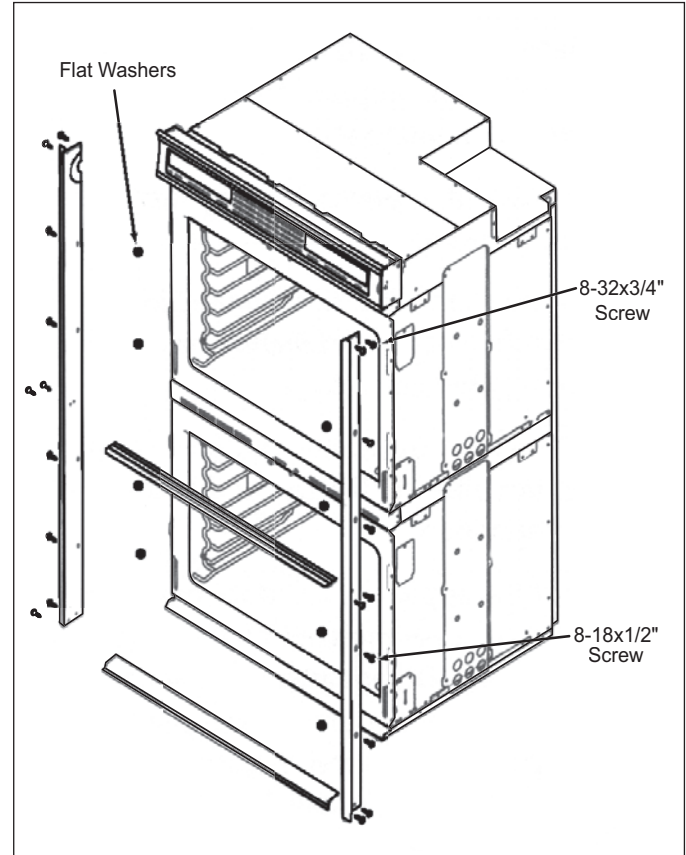

Figure 2-1. Trim Installation

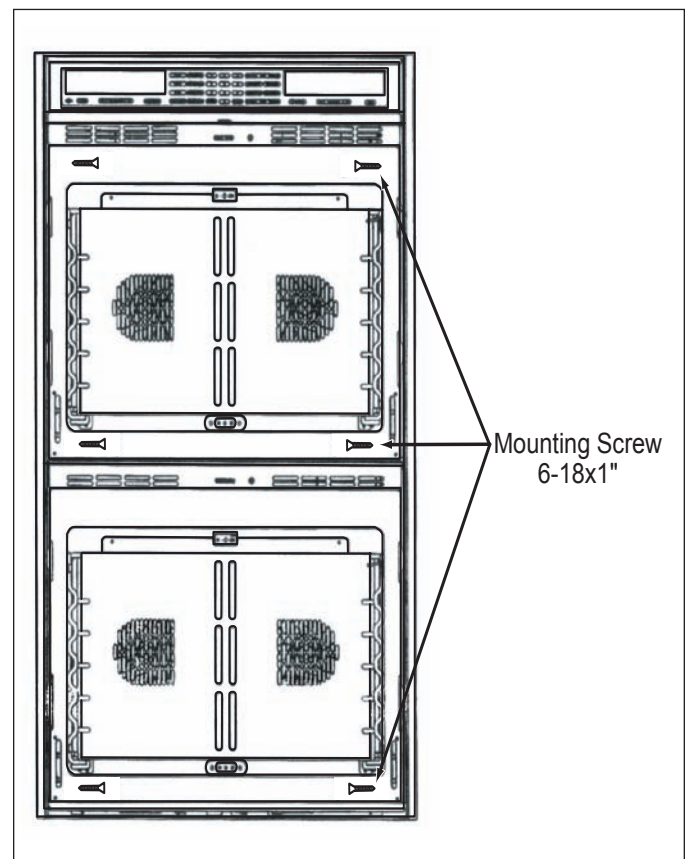
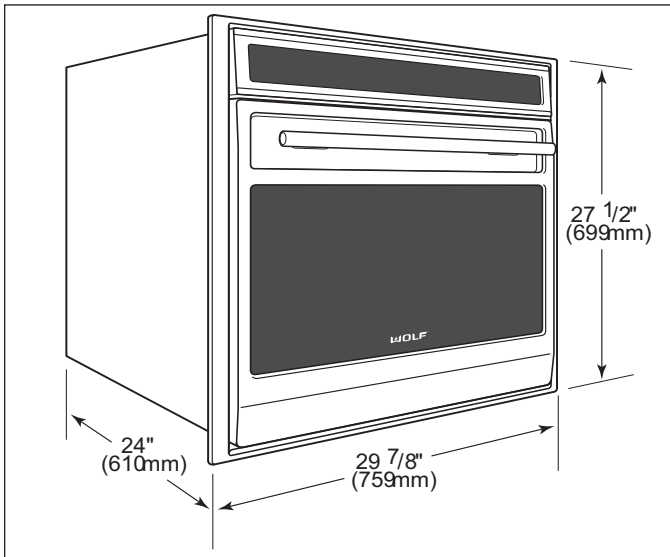
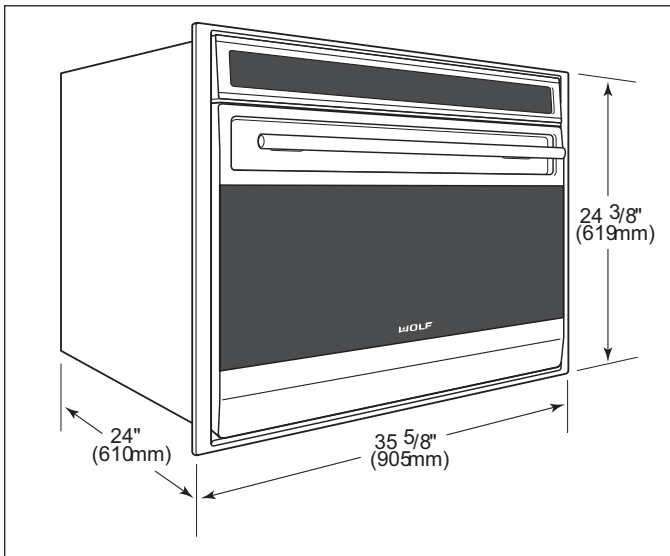

Figure 2-2. Cabinet Mounting Screws

## WALL OVEN DIMENSIONS



**Figure 2-3. 30" Single Oven Overall Dimensions**



**Figure 2-4. 36" Single Oven Overall Dimensions**

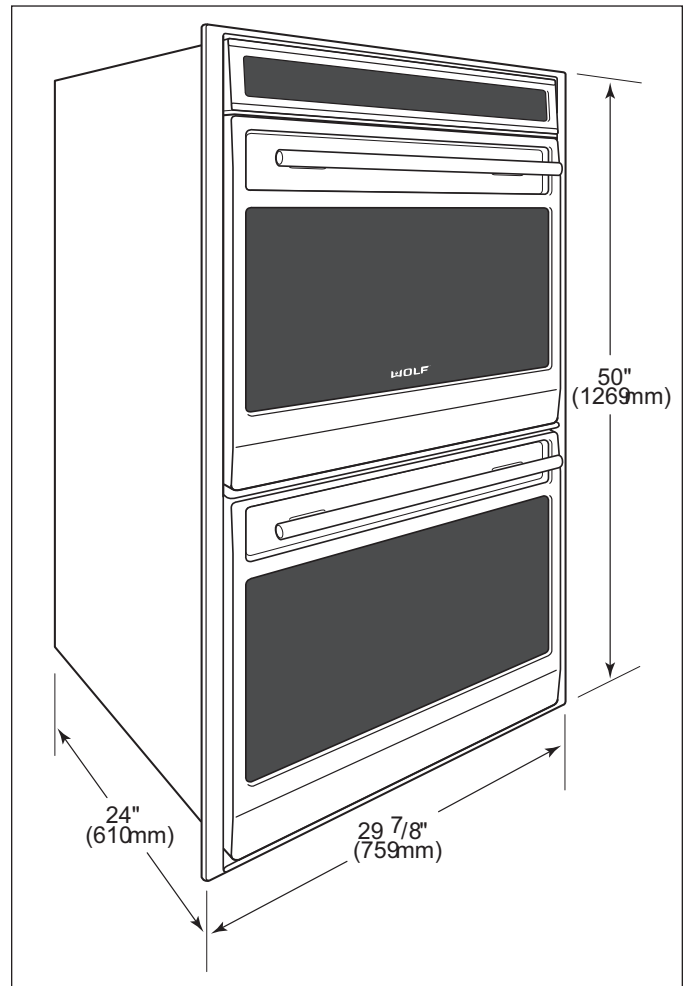

**Figure 2-5. 30" Double Oven Overall Dimensions**

## CABINET CUTOUT DIMENSIONS

### Single 30 Inch Wall Oven

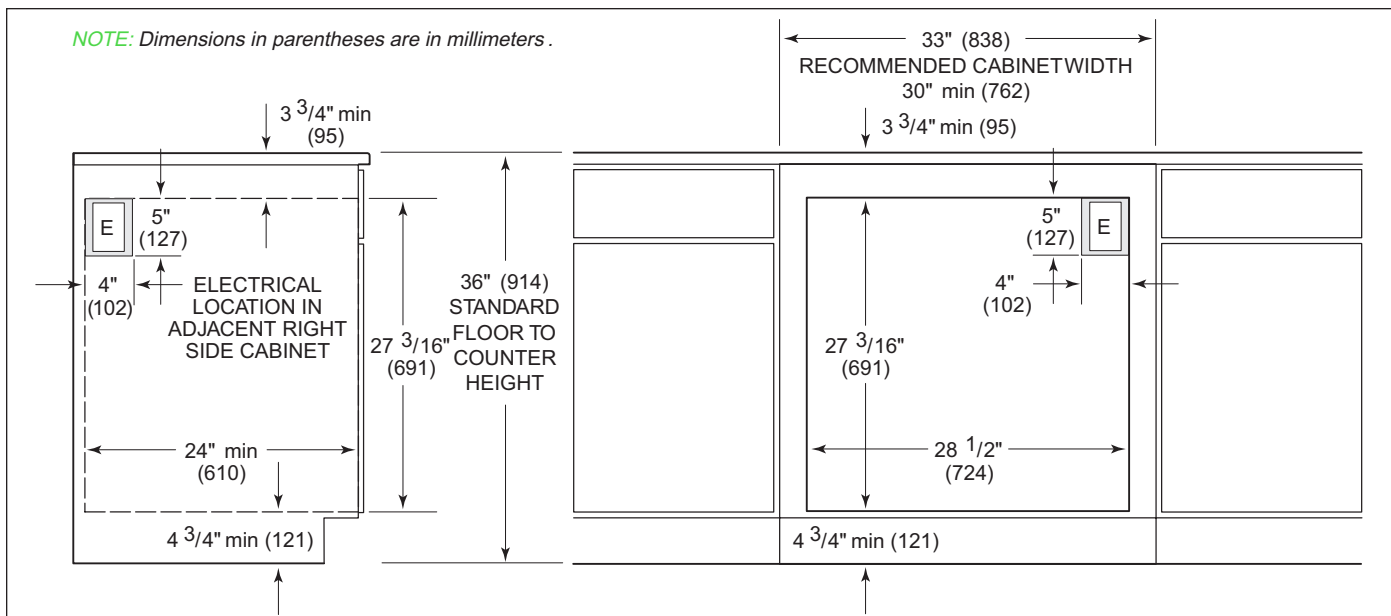

**Figure 2-6. Undercounter Cutout Dimensions and Electrical Placement**

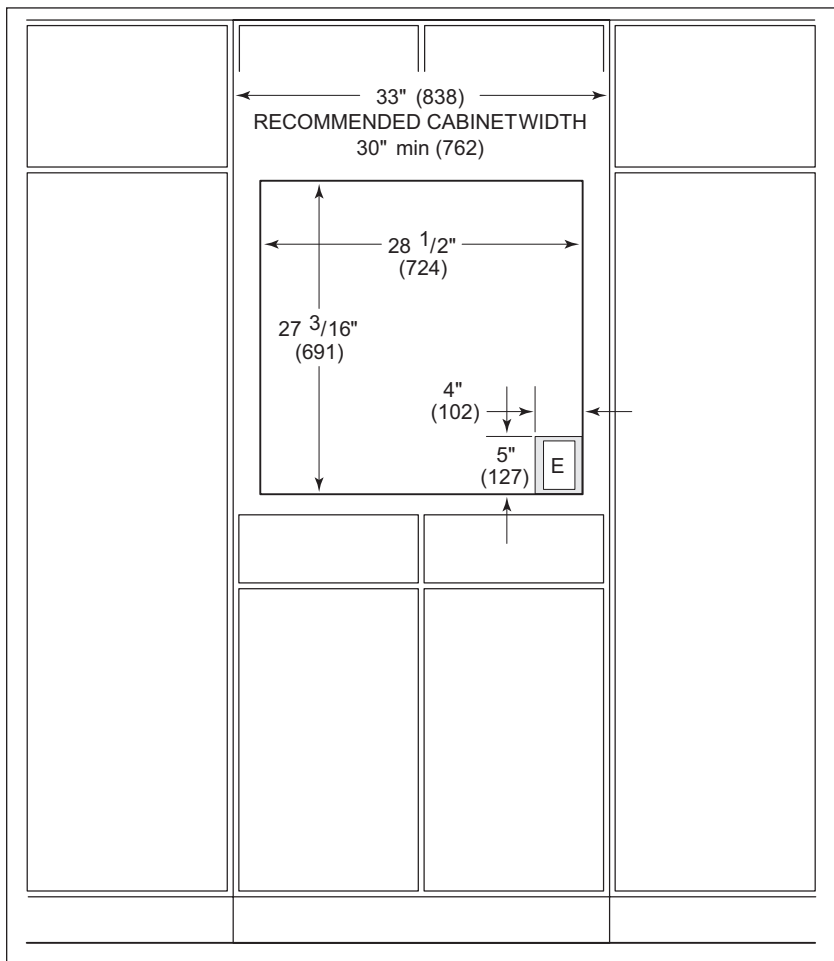

**Figure 2-7. Front Cutout Dimensions and Electrical Placement**

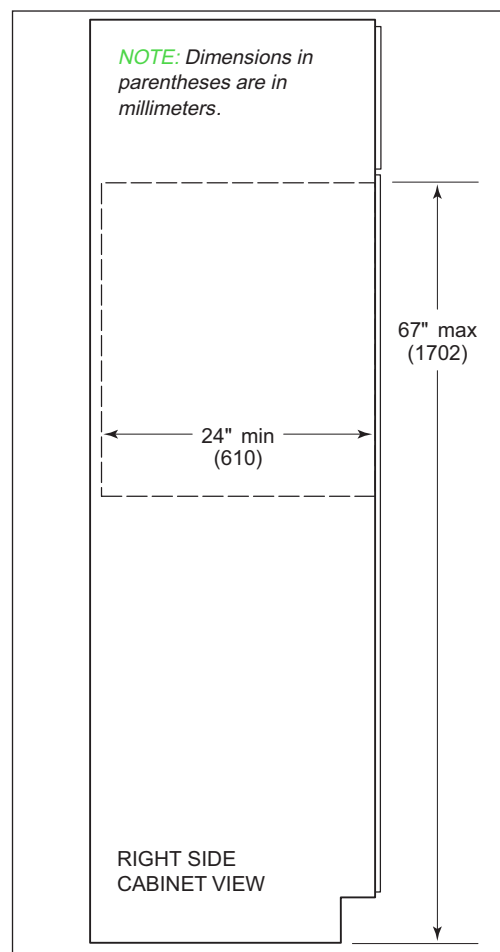

**Figure 2-8. Side View**

## CABINET CUTOUT DIMENSIONS

### Single 36 Inch Wall Oven

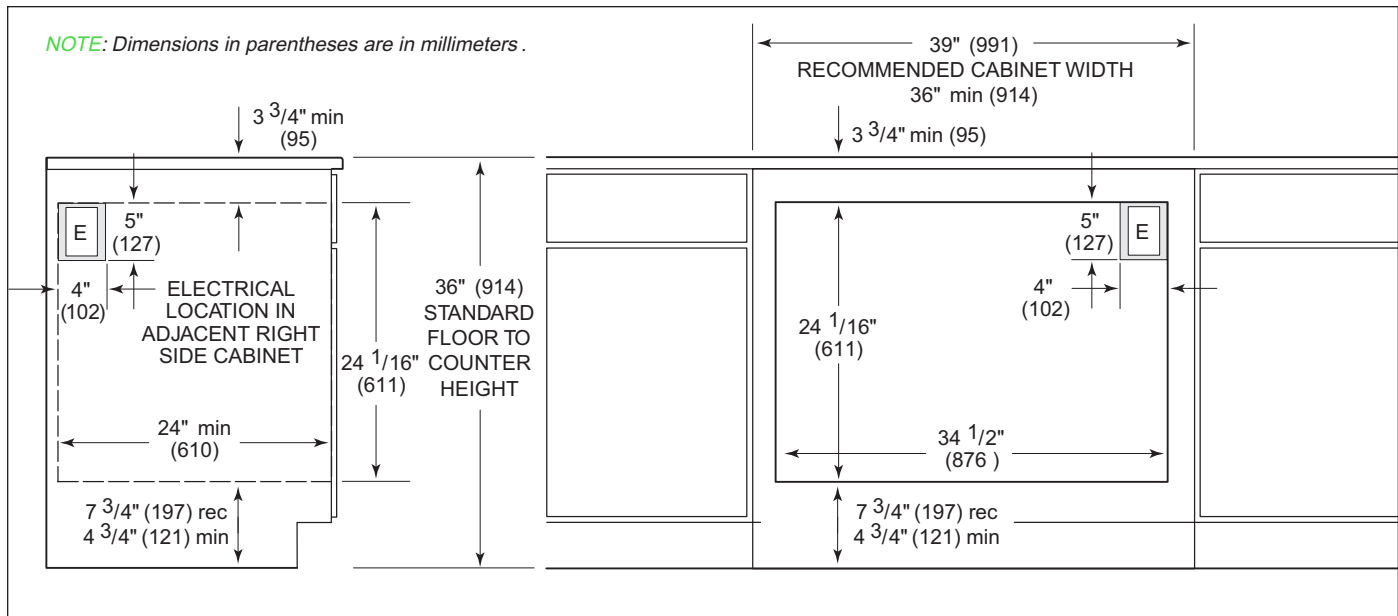

**Figure 2-9. Undercounter Cutout Dimensions and Electrical Placement**

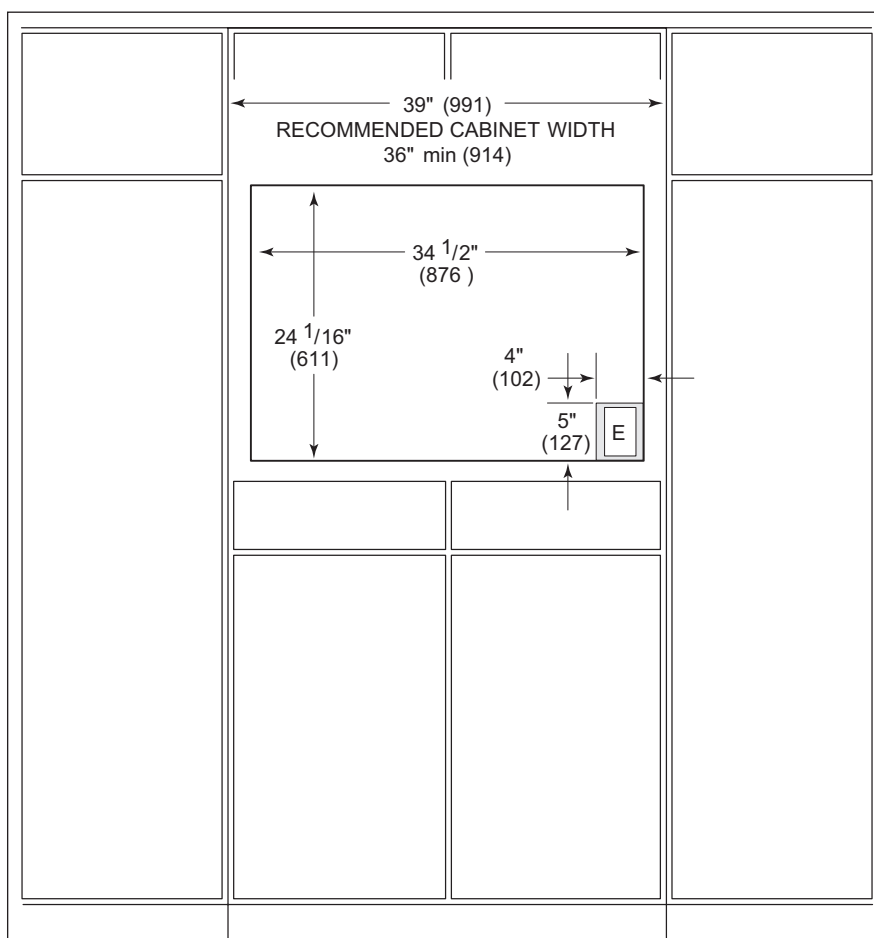

**Figure 2-10. Front Cutout Dimensions and Electrical Placement**

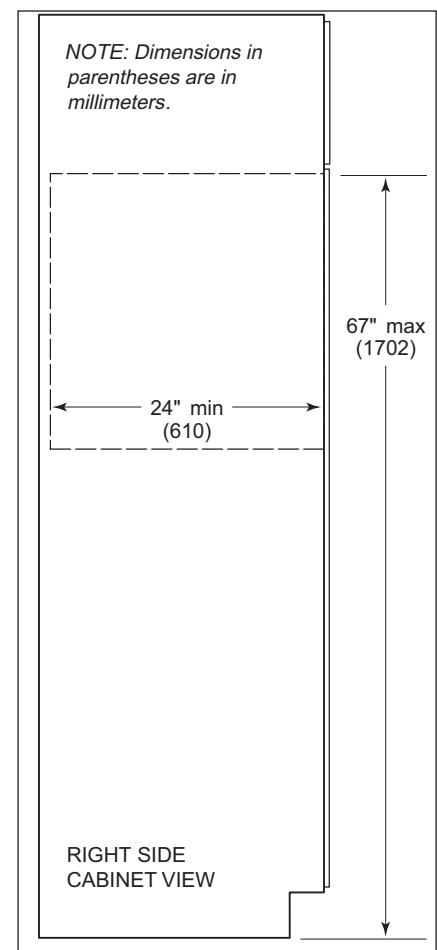

**Figure 2-11. Side View**

**CABINET CUTOUT DIMENSIONS**

**Double 30 Inch Wall Oven**

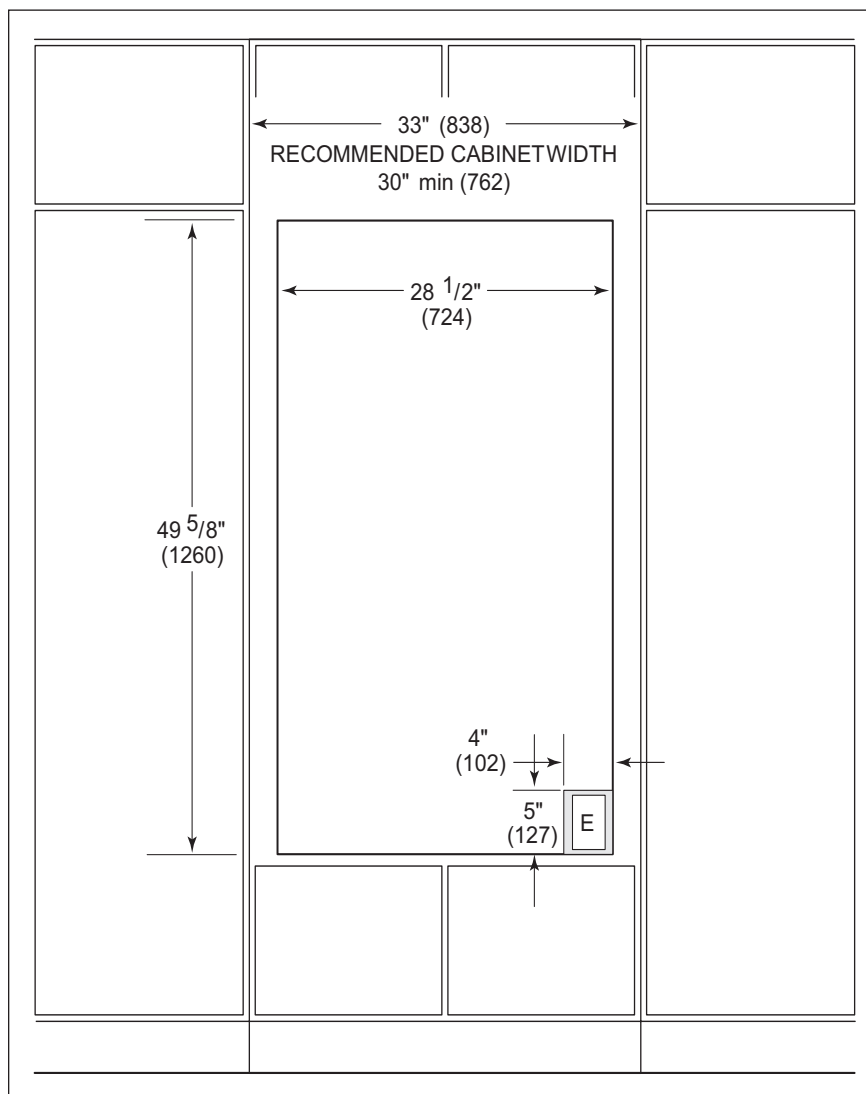

**Figure 2-12. Front Cutout Dimensions and Electrical Placement**

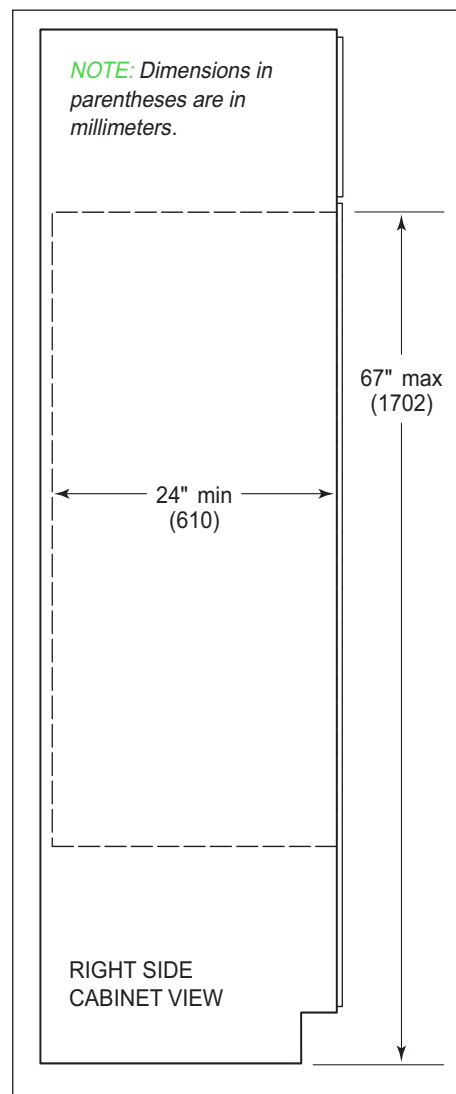
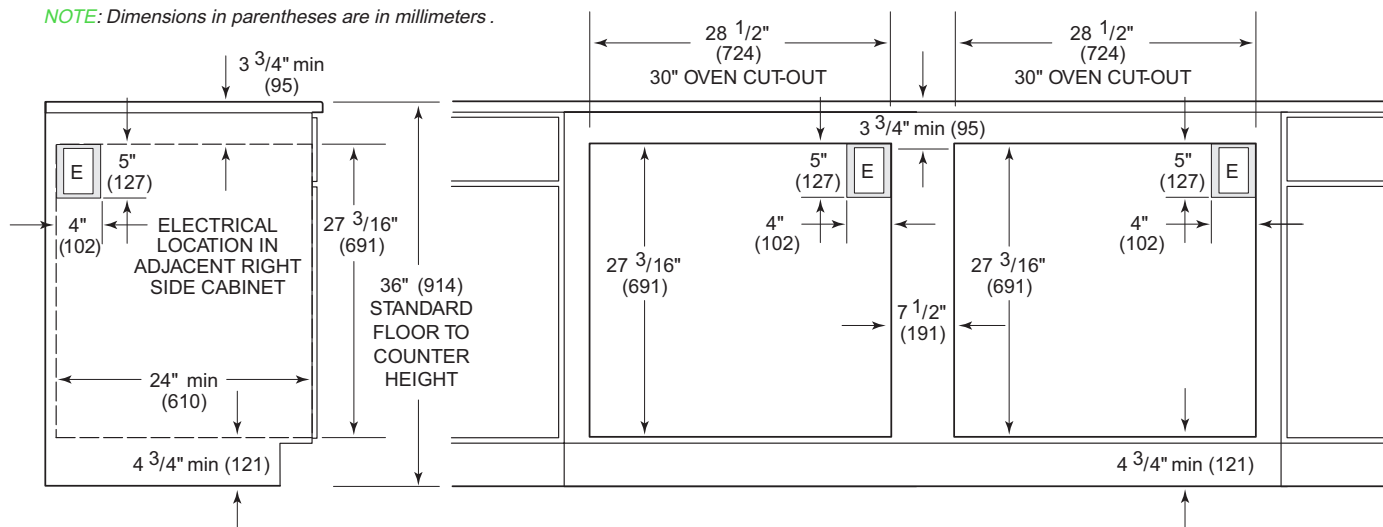

**Figure 2-13. Side View**

## CABINET CUTOUT DIMENSIONS

### Side-by-Side Wall Oven

*NOTE: Dimensions in parentheses are in millimeters.*



**Figure 2-14. Undercounter Cutout Dimensions and Electrical Placement for SO30**

*NOTE: Dimensions in parentheses are in millimeters.*

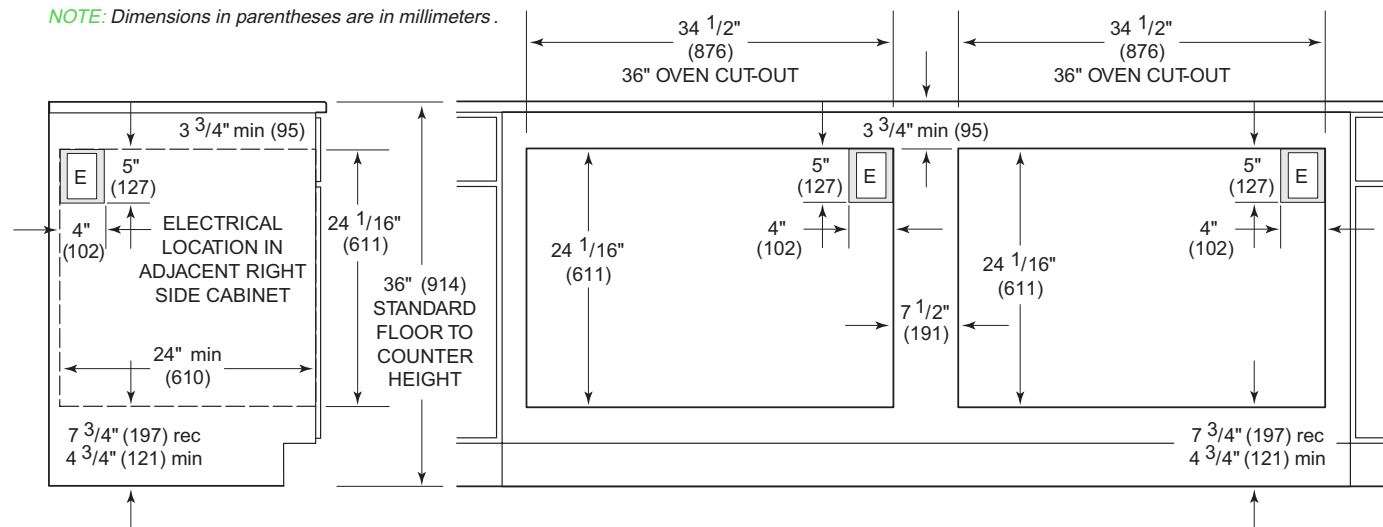

**Figure 2-15. Undercounter Cutout Dimensions and Electrical Placement for SO36**