



注：此页为技术说明，非印刷内容

刀模线： 
内折线： 

展开尺寸图：

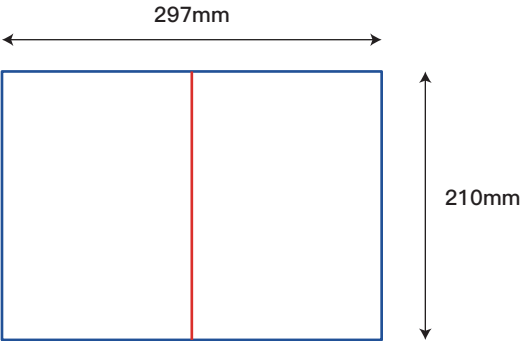

装订效果图：

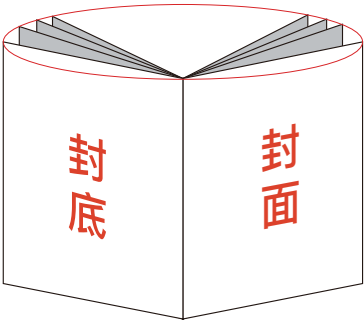

- 技术要求：
- 1、材质：封页105g 铜板纸；内页80g双胶纸
 - 2、展开尺寸：A4，如图所示装订成型为A5，16P
 - 3、颜色：单色
 - 4、印刷：印刷图档见后续页，双面印刷
 - 5、装订方式：骑马钉

符号标识



关键尺寸

XXX

编号

(XXX)

参考尺寸

(XXX)

除 非 另 有 说 明						名 称	PGTVMC14-Manual(单 英文)-XS	PLM 号 860-02092-00		
								投影法	第一角投影法	
										
		标记	处数	ECO#	发行时间	图号		版 本	重量G	比例
0-30	±1	设 计		P M		材料		01		
30-150	±2	绘 图	Max	日期	2023.08.02			共 1 页		第 1 页
150-300	±3	审 批		日期		规格		深圳市倍思奇 创新科技有限公司		
300-450	±4									
>450	±5		除去所有利边，尖点，毛刺							

INSTRUCTION MANUAL

PERLEGear

Rev01

PGTVMC14

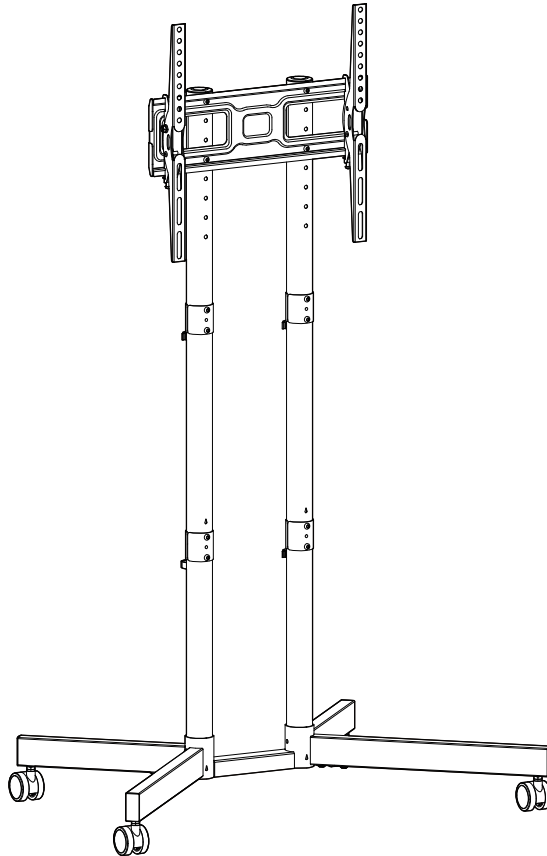

TV Cart



1-800-456-5231 (US/CA)
44-808-196-4165 (UK)



support@perlegear.com



www.perlegear.com

Before getting started, let's make sure this cart is compatible.

1 Is the VESA pattern of your TV 100 x 100mm (3.9 x 3.9") to 400 x 400mm (15.7 x 15.7")?

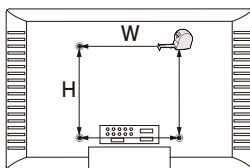

- ☐ Yes – Perfect!
- ☐ No – This TV cart is NOT compatible.

2 Does your TV (including accessories) weigh less than 88 lbs (40kg) ?



- ☐ Yes – Perfect!
- ☐ No – This TV cart is NOT compatible.

3 Tools Needed (NOT Included)



Phillips Screwdriver

4 Important Safety Information

NOTE

- Please carefully read all instructions before attempting installation. If you DO NOT understand the instructions or have any questions or concerns, please call technical support or email customer service.
- Not all hardware included in this package will be used.

CAUTION

- Avoid the risk of personal injury and property damage!
- DO NOT use this product for any purpose that is NOT explicitly specified in this manual. DO NOT exceed weight capacity. We are NOT liable for damage or injury caused by improper mounting, incorrect assembly or inappropriate use.
- Before starting assembly, verify all parts are included and undamaged. DO NOT use damaged or defective parts. If you require replacement parts, please call technical support or email customer service.

⚠ WARNING

- This package contains small parts that may pose a choking hazard.

⚠ TIP-OVER WARNING

Serious or fatal crushing injuries can occur from a tip-over accident. To help prevent a tip-over accident:

- Never allow children to climb, stand, hang, or play on any part of the TV or TV cart.
- Use tip-over restraints (not included) or anchors (not included) to attach the TV cart to the wall.
- Tip-over restraints may reduce but not eliminate the risk of a tip-over accident.

Supplied Parts and Hardware

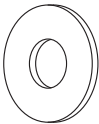

Washer
M4/M5
[B1] x 4

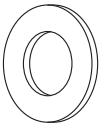

Washer
M6/M8
[B2] x 4



Spacer
L2.5mm
[F1] x 4

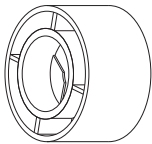

Spacer
L10mm
[F2] x 8

M4



TV Bolt
M4 x 12mm
[C1] x 4



TV Bolt
M4 x 30mm
[C2] x 4

M6

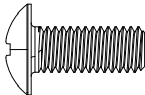

TV Bolt
M6 x 15mm
[D1] x 4

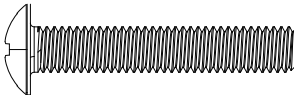

TV Bolt
M6 x 35mm
[D2] x 4

M8

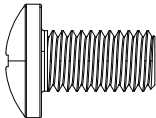

TV Bolt
M8 x 15mm
[E1] x 4

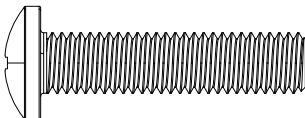

TV Bolt
M8 x 35mm
[E2] x 4

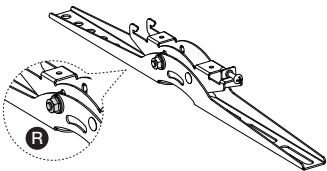

Right TV Bracket
[R] x 1

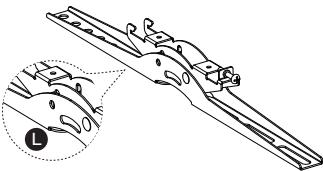

Left TV Bracket
[L] x 1

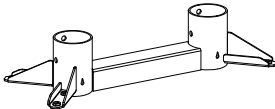

Base Section
01 x 1

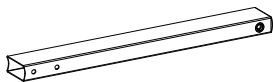

Long Square Tube

02 x 2



Short Square Tube

03 x 2



Caster

04 x 4

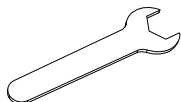

35/64" (14mm)
Wrench

[04-1] x 1

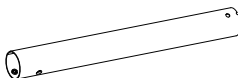

Lower Pole

05 x 2

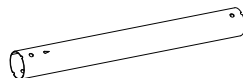

Middle Pole

06 x 2

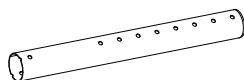

Upper Pole

07 x 2



Pole Connector

08 x 8



TV Plate

10 x 1



M6 x 10mm
Bolt

[a] x 14



6 x 16 x 1.5mm
Washer

[b1] x 8



M6 x 55mm
Bolt

[c] x 12



Nut
M6
[b2] x 12

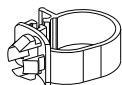

Cable Clip

[e1] x 4

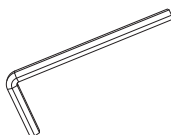

5/32" (4mm)
Allen Key

[e2] x 1

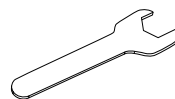

7/16" (11mm)
Wrench

[e3] x 1

Step 1 Attach TV Brackets to TV

1-1 Select TV Bolts

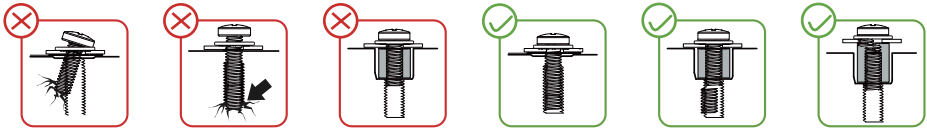
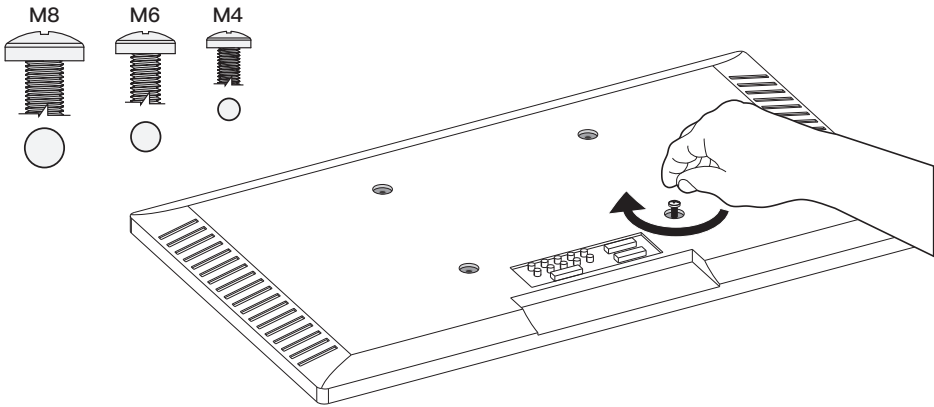

Hand thread bolts into the threaded inserts on the back of your TV to determine which bolt (M4, M6 or M8) to use. A minimum of 4-5 turns into the threading is required. Do not turn past the bottom of the hole.

1-2 Spacer and Bolt Configurations

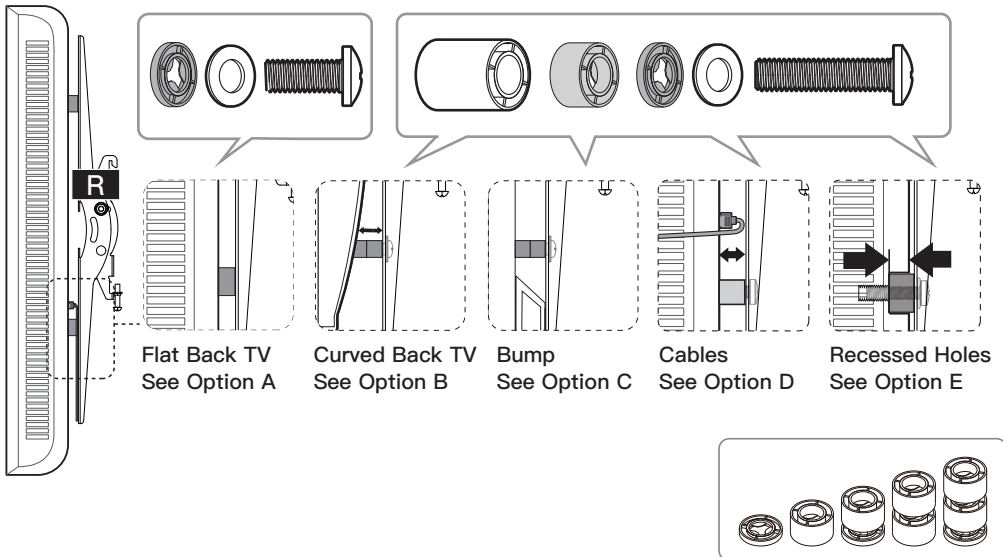

1-3 Attach the TV Brackets to Your TV

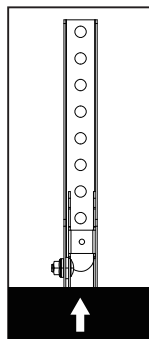
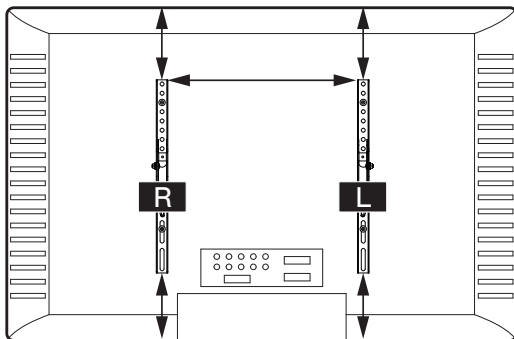

Round holes should be directed toward the top.

Option A: For Flat Back TVs

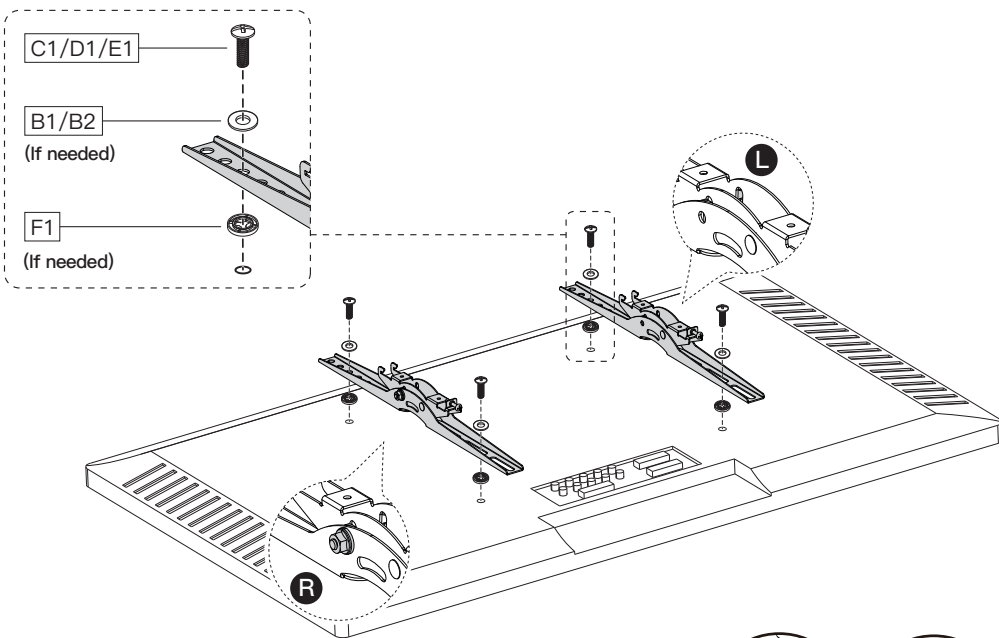

Add spacers if needed to fit the bolt length and TV back.

Option B: For Curved Back TVs

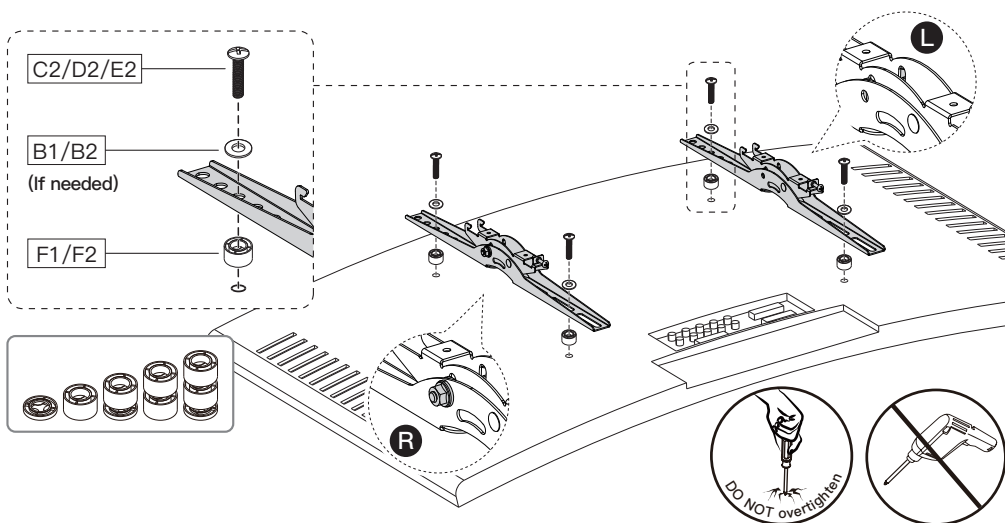

Spacers must be tall enough so that the curved back of the TV does not interfere with the mounting plate.

Option C: For TVs With a Bump

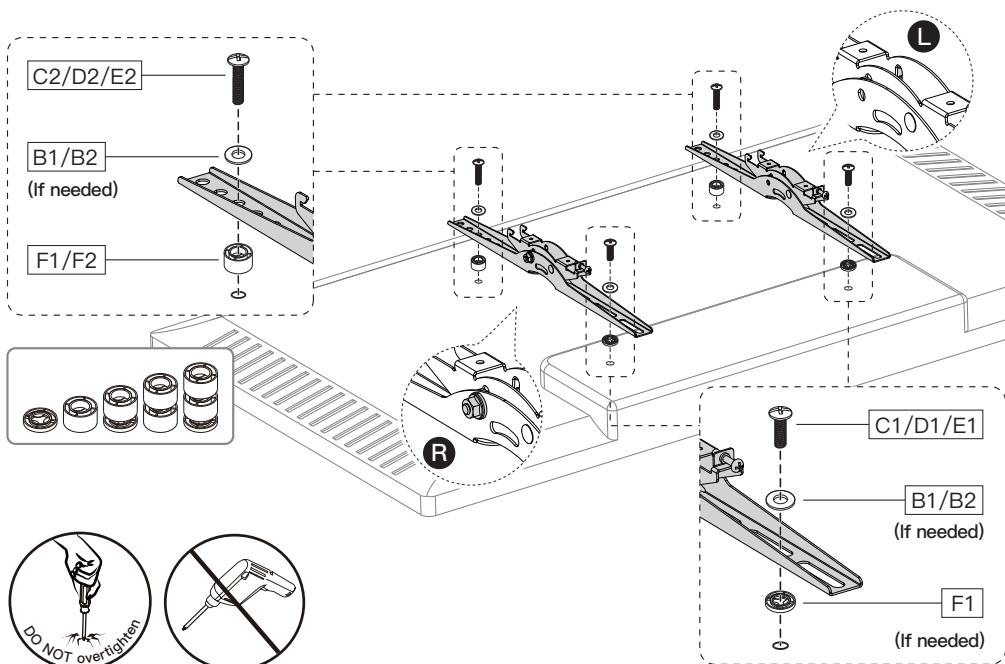

The TV brackets must be flush on the bump and leveled by spacers on the gap.

Option D: For TVs With Protruding Cables

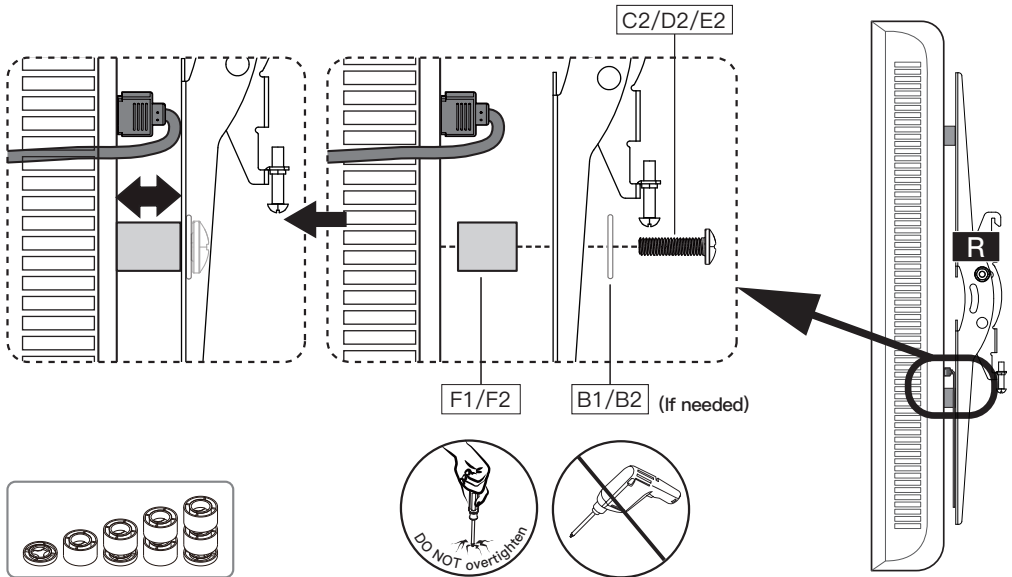

Use spacers to create extra space between the TV and TV brackets.

Option E: For TVs With Recessed Holes

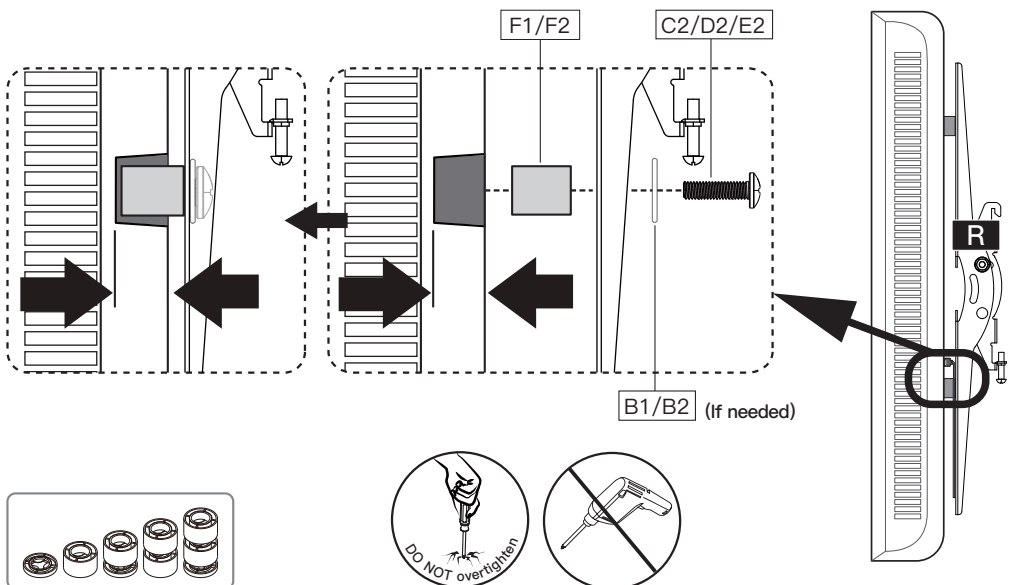

Spacers need to fill in the recessed holes on the back of the TV, while keeping the TV brackets as close to the TV as possible.

Step 2 Install the Base

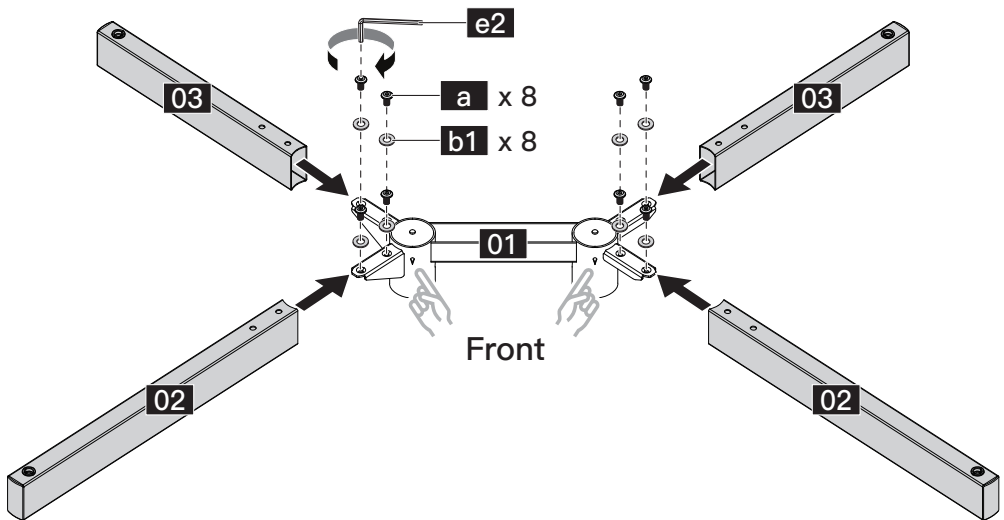

Insert the long square tubes [02] onto the side of base section [01] with droplet holes. Insert the short square tubes [03] onto the other side. Secure the tubes with bolts [a] and washers [b1].

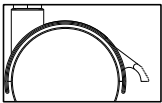

Brake On

NOTE: Flip the brakes down to avoid movement during assembly.

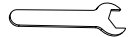

35/64" (14mm)
Wrench

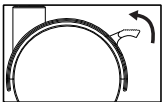

Brake Off

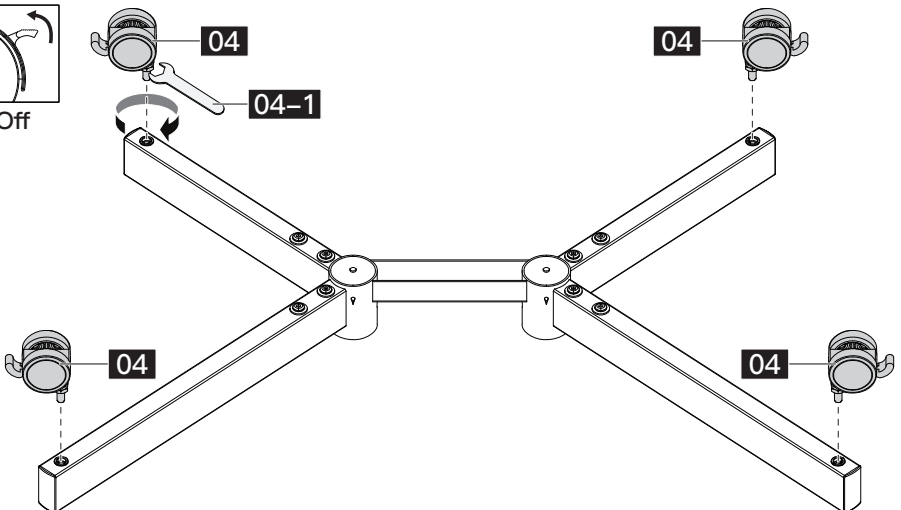

Screw the casters [04] into the base using the wrench [04-1].

Step 3 Secure the Poles to the Base

3-1

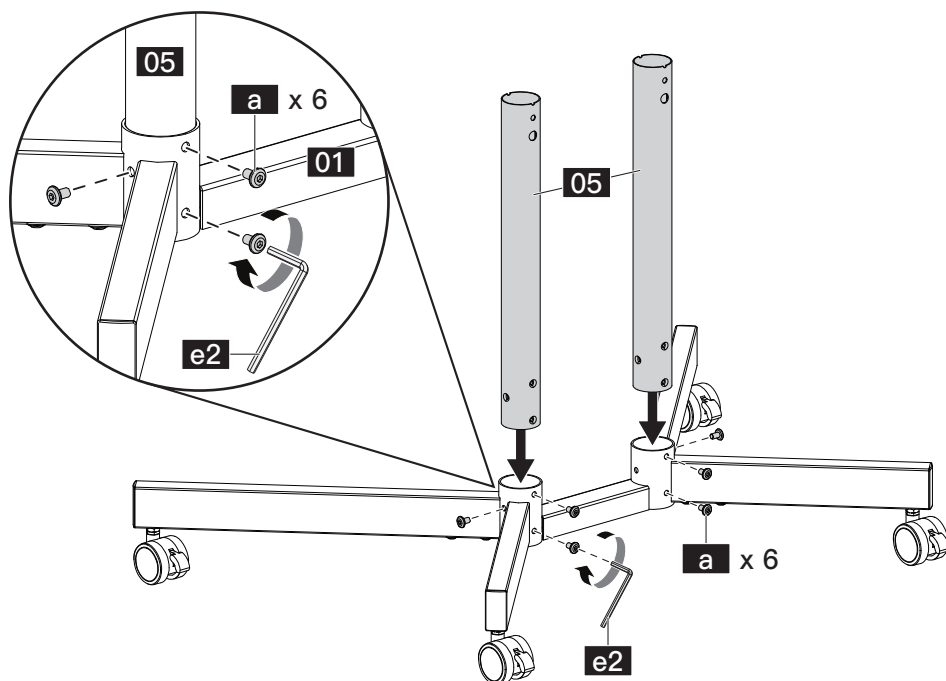

Insert lower poles [05] into the base and secure with bolts [a].

3-2

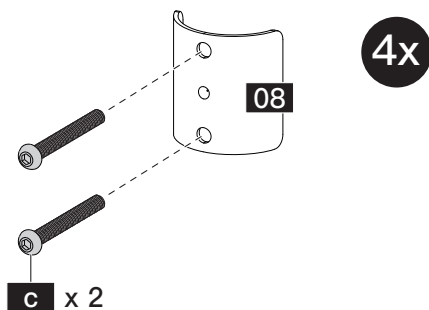

Insert bolts [c] into four pole connectors [08] as the front pole connectors. Keep them for Step 3-3 and Step 3-4.

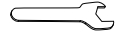

7/16" (11mm)
Wrench

Front

NOTE: The droplet holes in the middle poles should face forward.

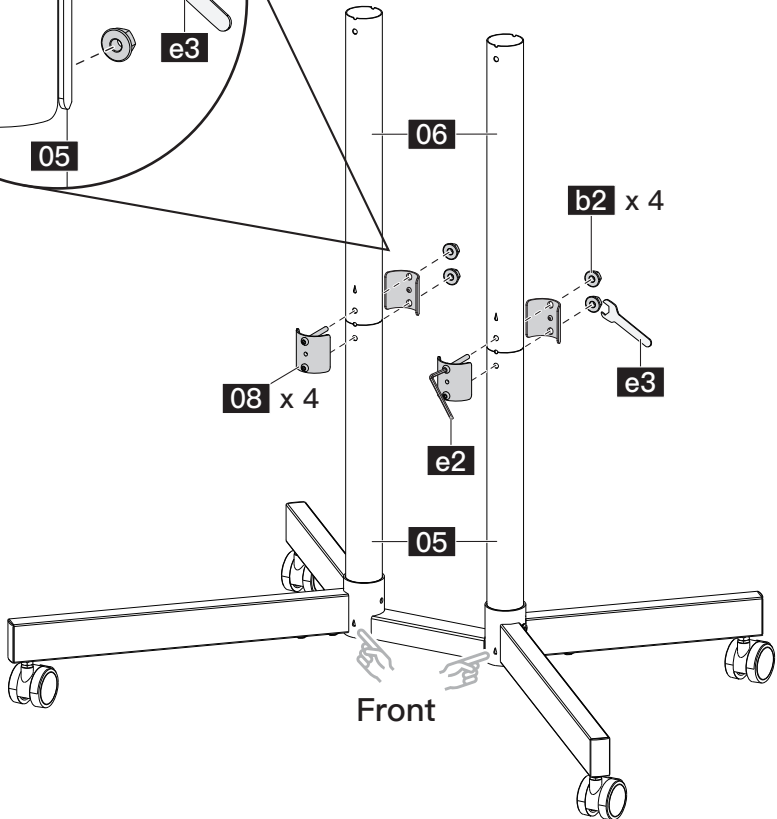
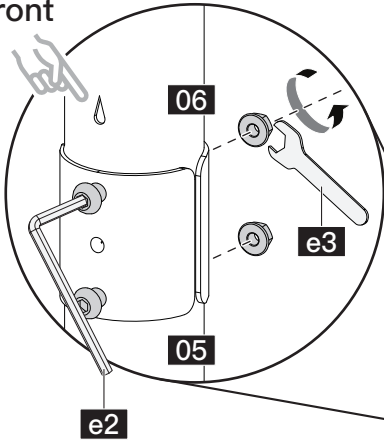

Front

Place the middle poles [06] on top of the lower poles [05]. With the front pole connectors attached, pass bolts [c] through the holes and thread them into the other pole connectors [08] on the opposite side. Firmly tighten nuts [b2] to secure the poles together.

3-4

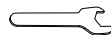

7/16" (11mm)
Wrench

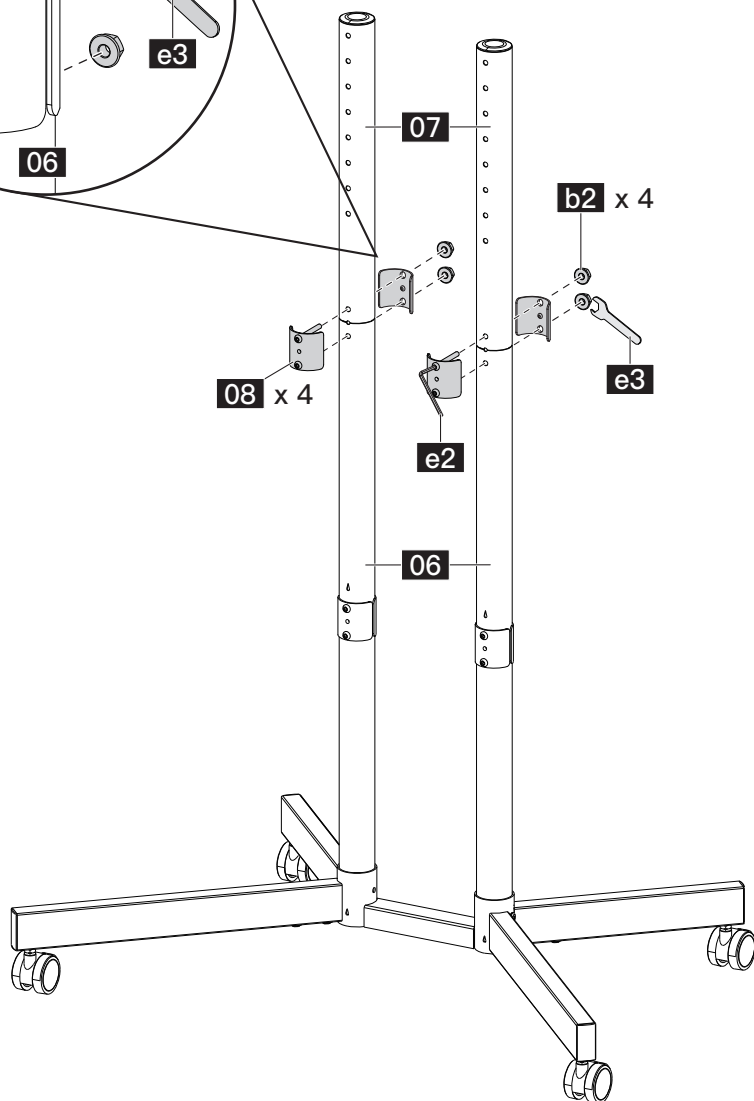
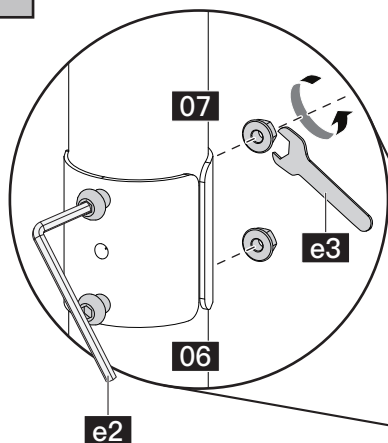

Place the upper poles [07] on top of the middle poles [06]. Repeat steps from 3-3 using the pole connectors [08] to secure the upper and middle poles together.

Step 4 Secure the TV Plate to the Upper Poles

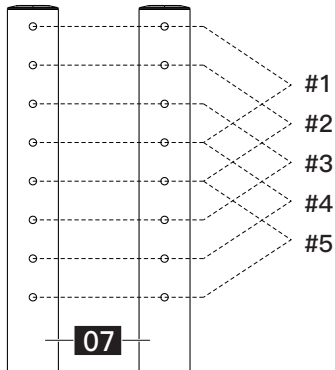

The upper poles [07] have 5 height options. Determine the best height for your TV before moving on to attach your TV to the poles.

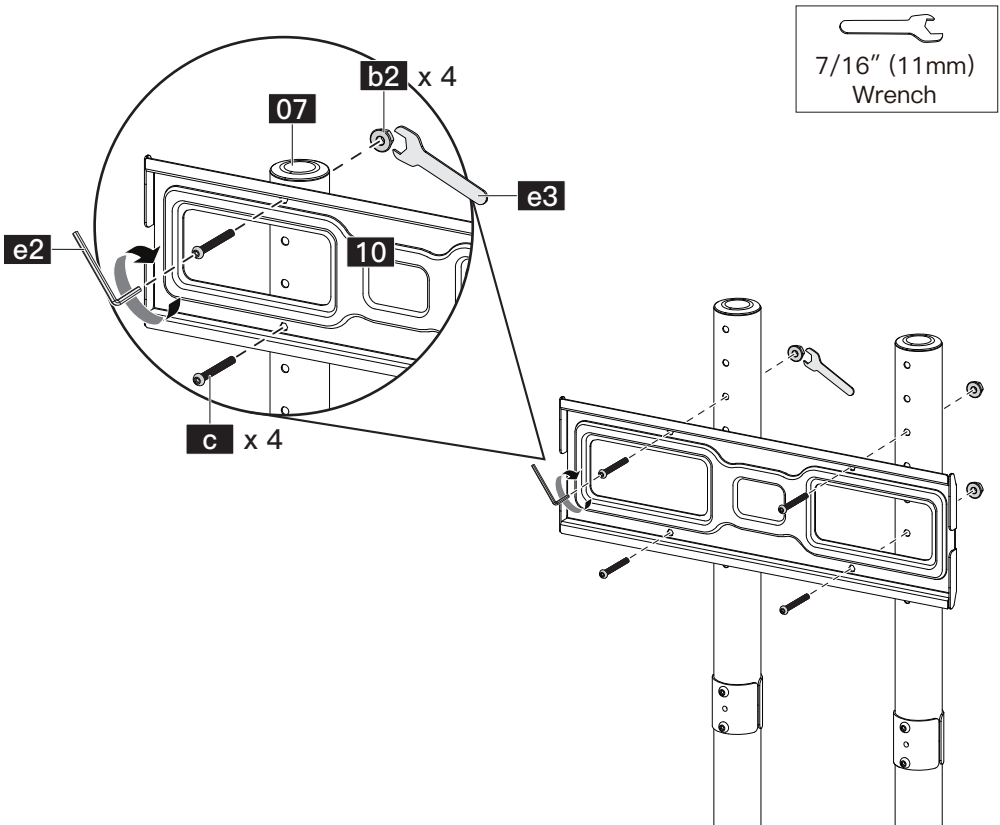

Secure the TV plate [10] to the upper poles [07] with bolts [c] and nuts [b2].

Step 5 Hang the TV on the TV Plate

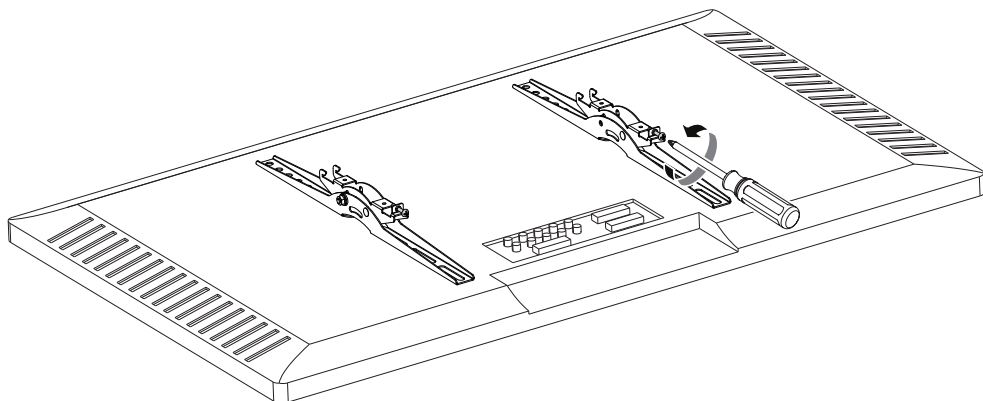

Slightly loosen the preassembled bolts on both TV brackets until they are seated flush with the plate.



HEAVY! You may need assistance with this step.



Phillips Screwdriver
NOT included

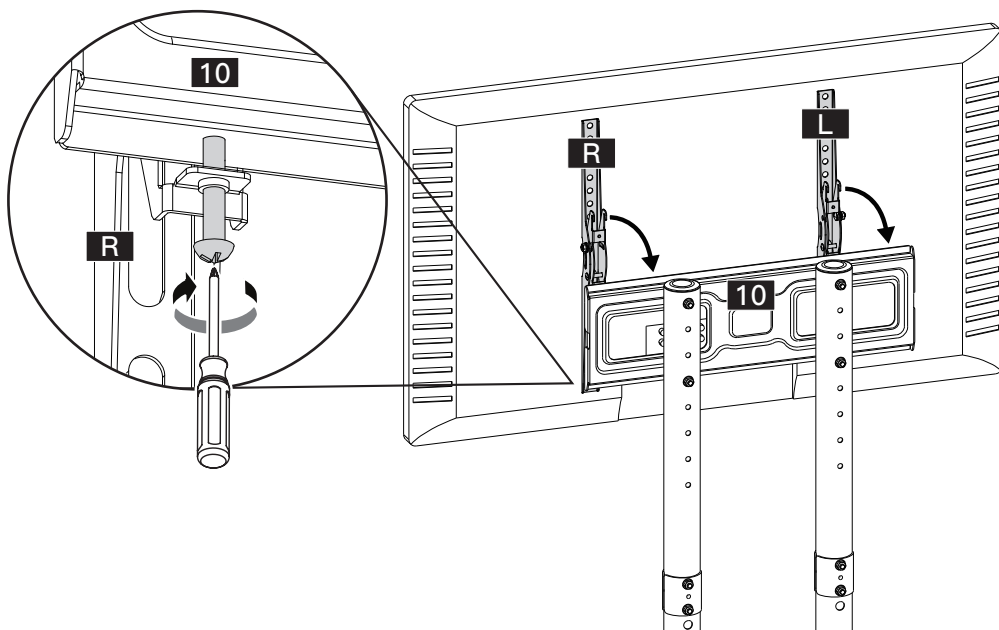

Hang the TV on the TV plate [10]. Retighten the bolts on the brackets until they are pulled firmly against the TV plate.

Step 6 Adjust the Tilt Angle of the TV

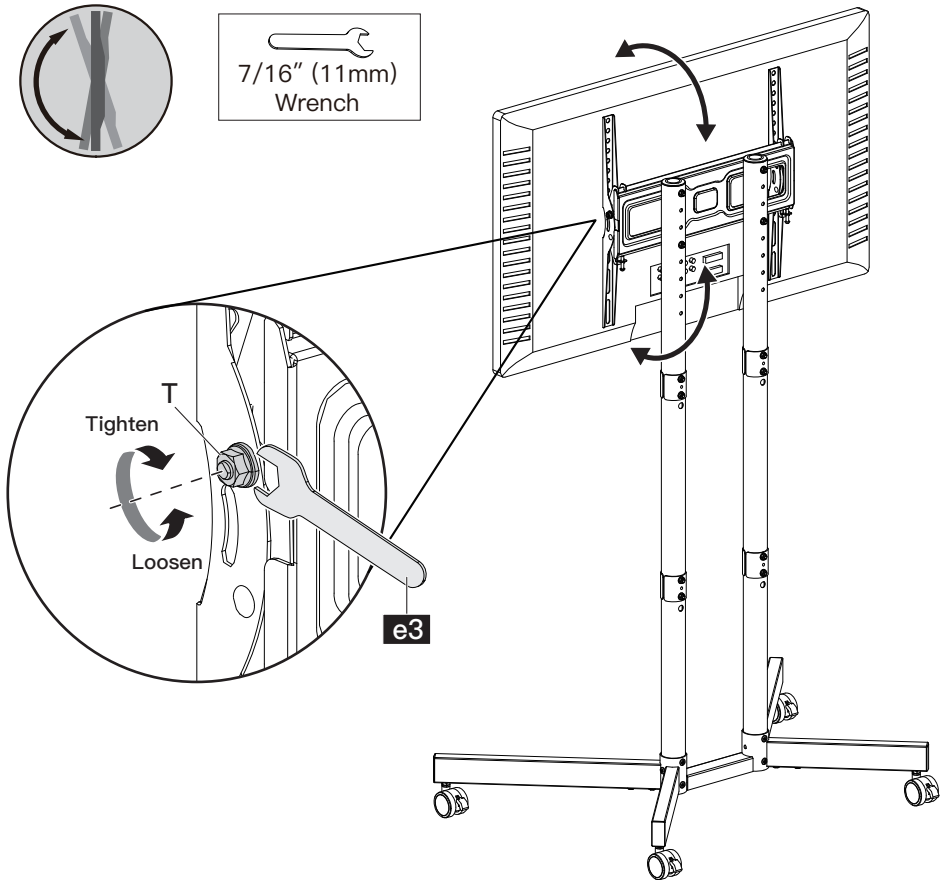

Slightly loosen nuts [T]. Adjust the TV to your desired tilt angle. Retighten nuts [T] to lock the tilt angle.

Step 7 Adjust the Height of the Casters

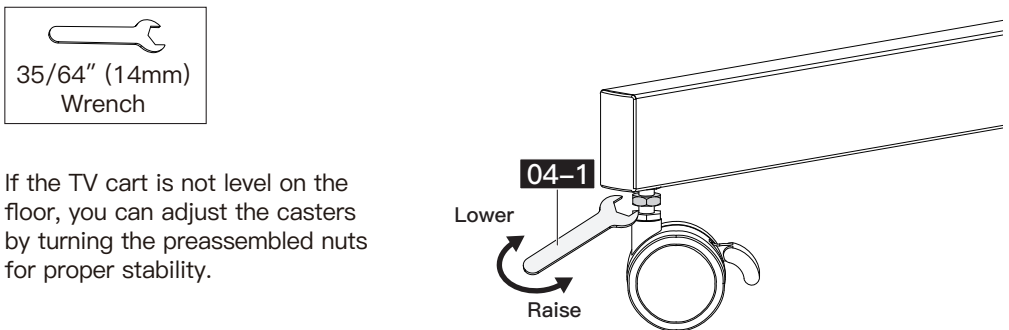

If the TV cart is not level on the floor, you can adjust the casters by turning the preassembled nuts for proper stability.

Step 8 Cable Management

