

# READ ME FIRST

Everything you need to know about setting up included

Quick Start Guide

Model: P15

## WE ARE READY TO HELP



### Prefer video tutorials ?

Take a look at our official Youtube Channel for the set up guidance



## 1 CHECKING THE COMPONENTS

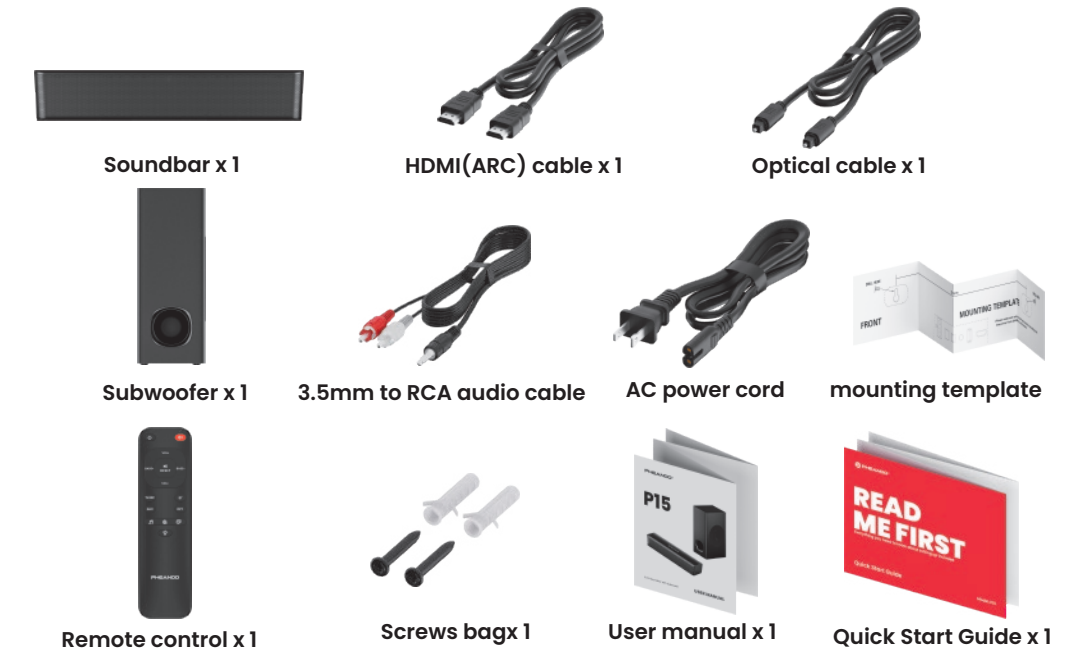

## 2 CONNECTING A TV

### OPTION 1 (Preferred) : HDMI ARC

If the TV has an ARC (Audio Return Channel) label on one of its HDMI ports, connect the HDMI cable to your TV's **HDMI ARC** jack and the soundbar's **HDMI ARC** jack.

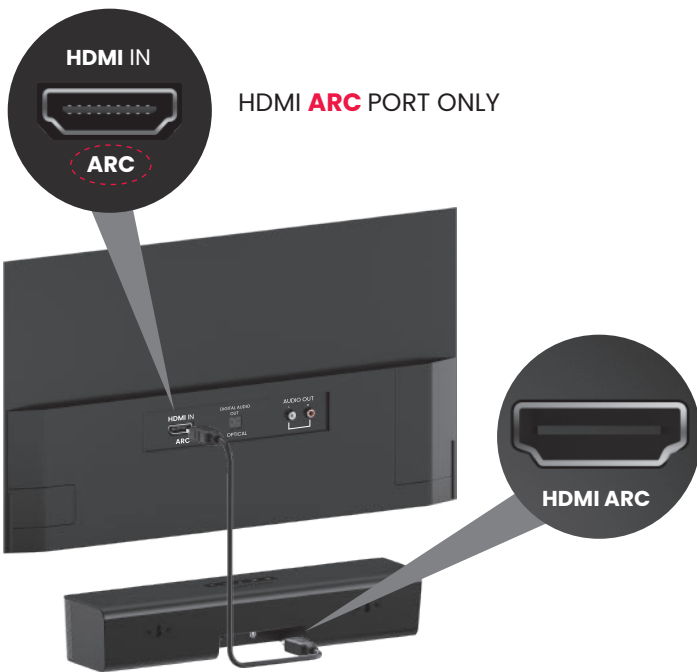

OR

### OPTION 2 : OPTICAL

If the TV has no ARC label on its HDMI ports, connect the optical cable to your TV's **OPTICAL OUT** jack and the soundbar's **OPTICAL IN** jack.

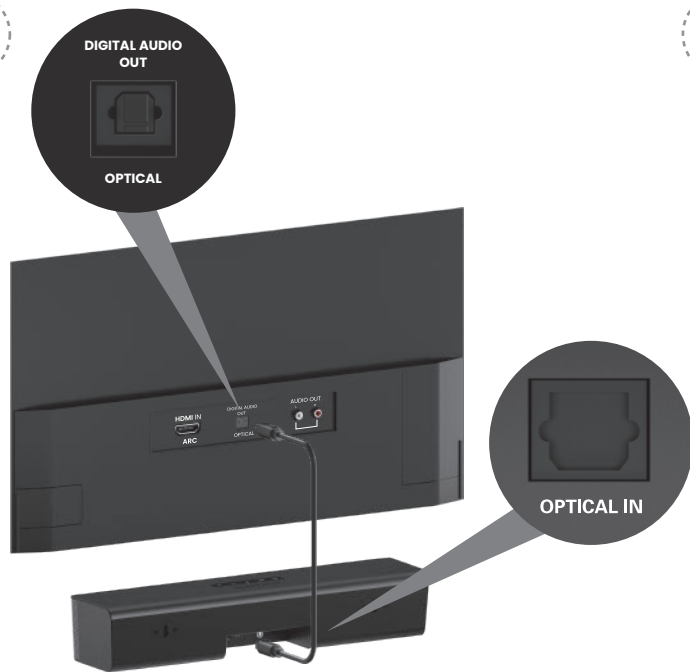

OR

### OPTION 3 : AUX

If the TV has no ARC label on its HDMI ports, connect the 3.5mm to RCA audio cable to your TV's **AUDIO OUT** jack and the soundbar's **AUX IN** jack.



#### NOTE

- HDMI connection is unavailable if your TV does not have a HDMI port labeled "ARC"
- Connecting via HDMI(ARC) enable the following functions using the TV's remote control:
  - Turn the power on and off
  - Both the TV and the sound bar turn on/off at the same time.
  - Volume adjustment

The sound bar's volume can be adjusted when the TV's audio output is set to the sound bar.

#### NOTE

- If you hear audio coming from TV's internal speaker, make sure TV speaker off or min volume

#### NOTE

- Make sure that the cable ends match the color of the ports.
- Some TV models have AUDIO IN jack only. It can't deliver audio signal to soundbar.

## 3 POWER YOUR SYSTEM

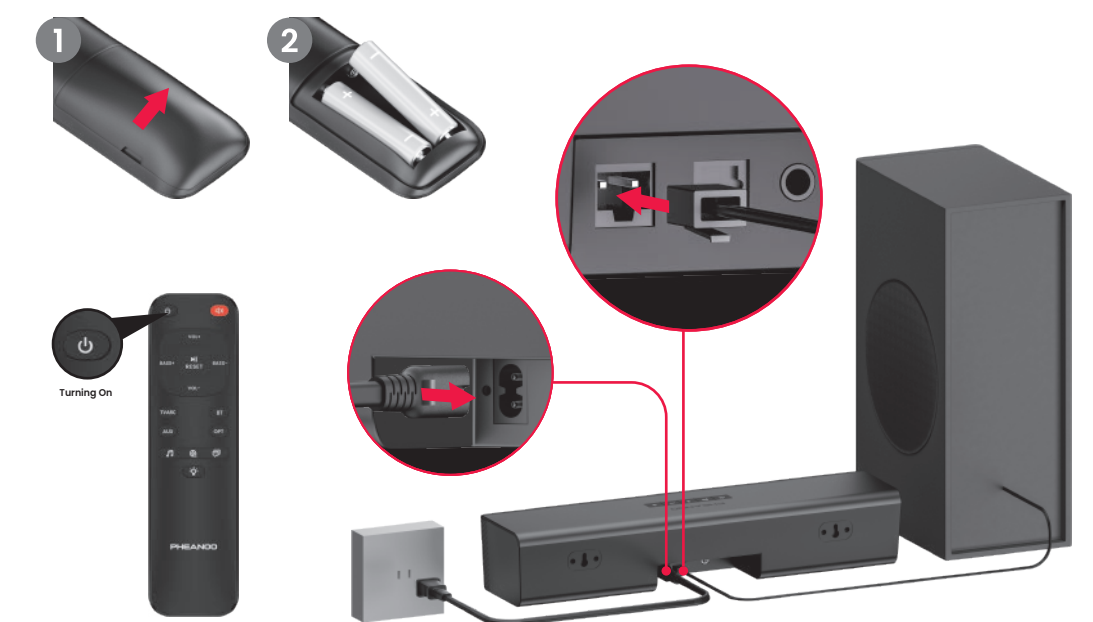

## 4 CHOOSE INPUT MODE



INPUT MODE INDICATORS	TV CONNECTION
TV ARC mode	Option 1 (Preferred) : HDMI ARC
OPT mode	Option 2 : OPTICAL
AUX mode	Option 3 : AUX
BT mode	BLUETOOTH CONNECTION

Select the soundbar input mode by pressing the **TV ARC**, **OPT**, **AUX**, and **BT** mode button on the remote control

LED Indicators are located here



#### NOTE

- Input mode on soundbar needs to match the connected external device (TV, Projector, Cable box, etc.) output mode.
- Make sure LED light on soundbar matches TV connection method.

## 5 CHANGE AUDIO SETTINGS ON YOUR TV

**Very Important!!!**

TV

- Change the TV audio output format to **PCM**
- Enable **Consumer Electronics Control (CEC)** on your TV

#### NOTE

- Only Option 1: HDMI ARC connection needs to enable CEC
- These are names different brands might use for HDMI-CEC: Samsung(AnyNet++), Vizio(CEC), Sony(Bravia Sync), LG(Simplink), Sharp(Aquos Link), Philips(EasyLink), Roku(1-Touch Play)

Below we have listed the sound settings of some most popular TV brands for your reference. If your TV brand is not included in the list, please contact us at [support@pheanoo.com](mailto:support@pheanoo.com) for recommended sound settings or refer to your TV manual

#### Samsung TV

- Settings > Sound > Sound Output > select Receiver (HDMI)
- Settings > Sound > Expert Settings > Digital Output Audio Format > PCM
- Settings > General > External Device Manager > Anynet+(HDMI-CEC) > ON

#### Vizio TV

- Settings > Audio > TV Speakers > Off
- Settings > Audio > Digital Audio Out > PCM
- Settings > System > CEC > Enabled

#### Sony TV

- Settings > Display & Sounds > Audio Output > Speakers > Audio System
- Settings > Display & Sounds > Audio Output > Digital Sound Output > PCM
- Settings > Display & Sounds > Audio Output > Pass Through Mode > OFF
- Settings > Channels&Inputs > External inputs > BRAVIA Sync > BRAVIA Sync control > ON

#### LG TV

- All Settings > General-Devices > HDMI Settings > SIMPLINK(HDMI-CEC) > ON
- All Settings > Sound > Advances Settings > Digital Sound Output > PCM
- All Settings > Sound > Sound Out > Use Wired Speaker > HDMI(ARC)Device

#### TCL ROKU TV

- Settings > Audio > Audio output > Auto
- Settings > Audio > Digital audio format > Select Stereo

#### Hisense ROKU TV

- Settings > Audio > TV Speakers > Select Disabled
- Settings > Audio > Digital Audio out > Select Stereo

#### ONN ROKU TV

- Settings > Audio > TV Speakers > Select Disabled
- Settings > Audio > Digital Audio Format > Select Stereo

#### Toshiba Fire TV / Amazon Fire TV 4-Series and Omni Series / Insignia Fire TV

- Settigs > Display & Sounds > Audio Output > TV Speakers > select OFF
- Settings > Display & Sounds > Audio Output > Digital Audio Format > select PCM
- Settings > Display & Sounds > HDMI CEC Device Control > ON

#### TCL TV(Powered by Android)

- TV Settings > Audio > Advanced Settings > Digital Audio Out > Select PCM
- TV Settings > System > T-Link > Select ON

#### Hisense TV (Powered by Android)

- Settings > Sound > Speakers > select ARC
- Settings > Sound > Advanced Settings > Digital Audio Out > select PCM

#### Sharp TV

- Settings > sound > Advanced audio settings > TV Speaker & ARC > select ARC
- Settings > sound > Advanced audio settings > Digital Audio Out > select PCM

#### Sharp TV (Powered by Android)

- settings > devices preferences > sound > Digital Output > select PCM
- settings > devices preferences > sound > Speakers > External audio system

#### Roku TV Stick

- Settings > Audio > Digital Output Format > Stereo
- Settings > Audio > Audio Mode > Select Stereo

#### Fire TV stick

- Settings > Display & Sounds > Audio > Surround Sound > PCM
- Settings > Display & Sounds > HDMI CEC Device Control > ON

#### Panasonic TV

- Menu > Audio Settings > Advanced Audio > TV Speakers > select OFF
- Menu > Audio Settings > Advanced Audio > HDMI > select DIGITAL
- Menu > Audio Settings > Advanced Audio > Digital Audio Out > select PCM

Continued on back page



## 6 “VOLUME BEEF UP” FUNCTION

After testing on a variety of TV models, we found that the soundbar’s volume is limited by the audio output power of the TV itself. The audio output power of different brands of TVs will vary. For TVs with low audio output power, we have developed a “VOLUME BEEF UP” function to increase the soundbar volume level.

If the the sound bar is no louder than your TV speakers even at the max volume level, please kindly try to enable the Volume+ function following the below steps.

### NOTE

- If your TV’s audio output power is high enough, after activating the “VOLUME BEEF UP” function, the soundbar may experience distortion, crackling, static, noise, unexpected poor sound quality or trigger power protection. In this case, please disable the “VOLUME BEEF UP” function

#### How to enable the “VOLUME BEEF UP” function

1. Long press the  (MUTE) button on the soundbar remote control for 3-5 seconds
2. Then the soundbar will go to “VOLUME BEEF UP” function enable/disable surface



3. **Press** the **VOL+** (VOL+) button on the soundbar remote control **twice** to enable the “VOLUME BEEF UP” function

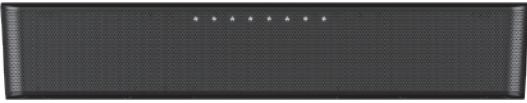

#### How to disable the “VOLUME BEEF UP” function

1. Long press the  (MUTE) button on the soundbar remote control for 3-5 seconds
2. Then the soundbar will go to “VOLUME BEEF UP” function enable/disable surface



3. **Press** the **VOL-** (VOL-) button on the soundbar remote control **twice** to disable the “VOLUME BEEF UP” function

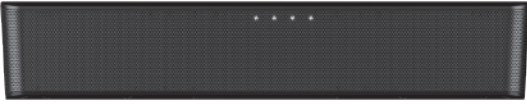

## 7 CONTROL YOUR SOUNDBAR

### 7a. Top panel

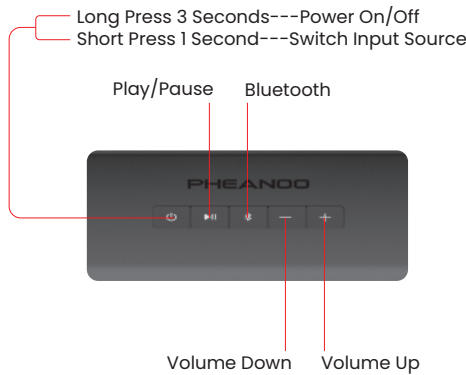

### 7b. Remote control

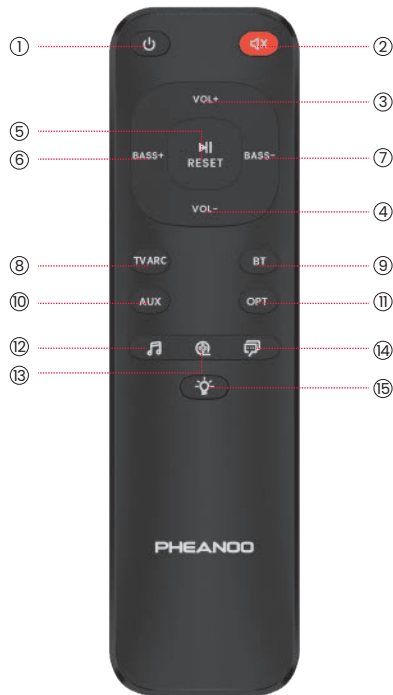

- 1. POWER**  
Turns on the Sound Bar or sets it to standby mode.
- 2. MUTE**  
Turns off the sound temporarily
- 3. VOL+**  
Increase volume
- 4. VOL-**  
Decrease volume
- 5. RESET(PLAY/PAUSE)**  
Start, pause or resume play in BT Mode Press and hold for about 2 seconds to reset the volume level and switch to the Movie EQ effect.
- 6. BASS+**  
Increase bass level
- 7. BASS-**  
Decrease bass level

- 8. TV ARC**  
Set the input source for the Soundbar to HDMI ARC mode
- 9. BT**  
Set the input source for the Soundbar to Bluetooth mode
- 10. AUX**  
Set the input source for the Soundbar to AUX mode
- 11. OPT**  
Set the input source for the Soundbar to Optical mode
- 12. MUSIC**  
Selects MUSIC for the sound effect
- 13. MOVIE**  
Selects MOVIE for the sound effect
- 14. DIALOGUE**  
Selects DIALOGUE for the sound effect
- 15. INDICATOR**  
Press to turns on/off the indicators on the Bar Speaker.

## 8 WALL MOUNT YOUR SOUND BAR

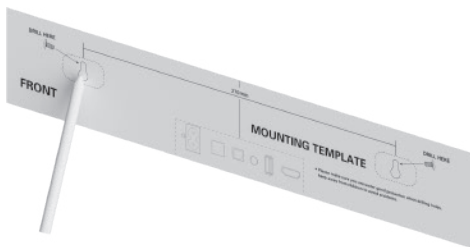

1. Mark the wall using template provided



2. Drill screw holes at markings



3. Insert the wall anchors



4. Insert the screws into the wall anchors



5. Hang the soundbar on the wall

## 9 FIRMWARE UPDATE

Occasionally, PHEANOO provides important firmware updates for your soundbar. Updating the firmware on your soundbar gives you all the benefits of the latest improvements. If an update is available from PHEANOO, you can download it onto a USB device, and then upload it to your soundbar.

### Step 1. Download the Firmware Version from [www.pheanoo.com/firmware.html](http://www.pheanoo.com/firmware.html)

1. Important Specs for USB Drive: **USB2.0; Max Drive Size: 32GB**
2. Plug an USB drive into your PC / Mac
3. **Reformat** the USB drive to “**FAT16**” or “**FAT32**” format.

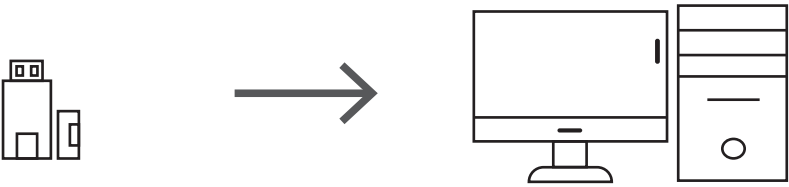

Recommended USB 2.0 Drives

PC/MAC

**Step 2. Once downloaded, extract the “P15 FIRMWARE.zip” file, and place the “ota.bin” file onto a USB drive. Make sure there is nothing else on the USB drive and do not put the files in any kind of folder. PHEANOO recommends using a 2gb flash drive and the flash drive must be FAT formatted.**



- A** Download the “P15 FIRMWARE”

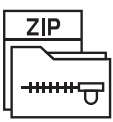

- B** Unzip the download file



- C** Open the folder to locate “ota.bin” firmware files



- D** Copy and Paste the “ota.bin” files into your USB drive. Do not change the name of the files.

**Step 3. Turn the Sound Bar on using the soundbar remote and Insert the flash drive into the USB(SERVICE) slot on the back of the Sound Bar.**

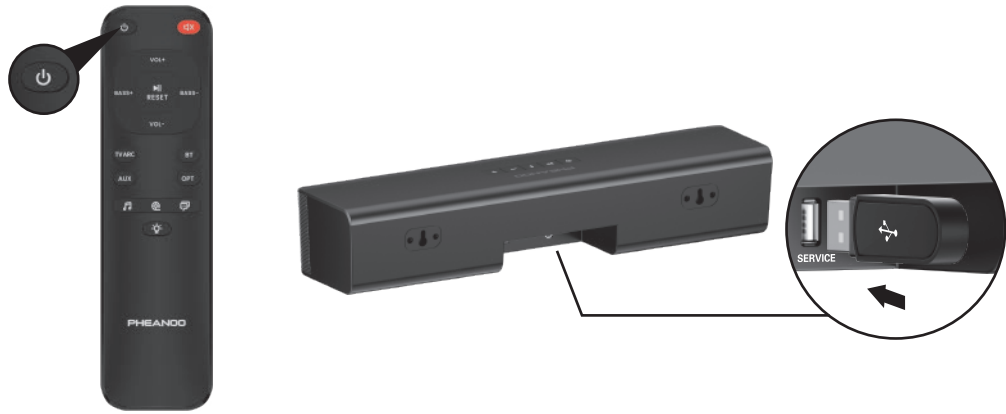

**Step 4. The light on the Sound Bar will begin to flash in white for a few seconds during the installation process**

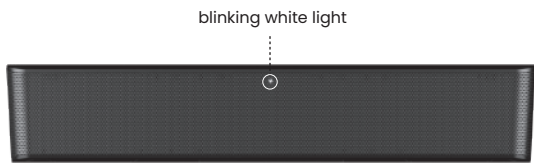

**Step 5. Once the firmware is installed the Sound Bar lights will stop flashing and turn into solid Red light. It is now safe to remove the USB drive.**

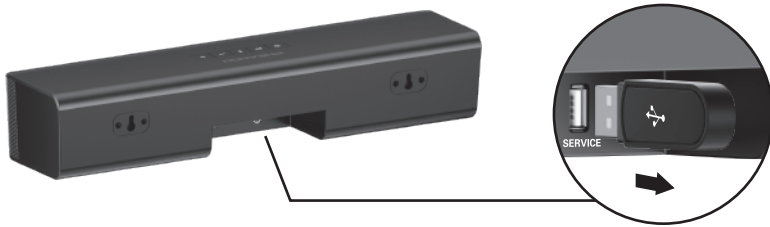

### IMPORTANT

1. Only drives with these specs will work: USB2.0; Max Drive Size: 32GB.
2. Do not remove USB drive or turn off your Soundbar while upgrading.  
\* If soundbar system does not work after the firmware upgrade, please contact our support immediately at [support@pheanoo.com](mailto:support@pheanoo.com)

## 10 BLUETOOTH CONNECTION (OPTIONAL)

1. Press the (Bluetooth) button on the Soundbar (or remote control unit) until the Bluetooth LED blinks in blue.
  2. Go to the Bluetooth settings on your device and make sure Bluetooth is turned ON.
  3. Select “**PHEANOO P15**”.
- The Bluetooth LED turns blue to indicate that the Soundbar is being paired with your Bluetooth device



## 11 TROUBLESHOOTING

ISSUES	PROBLEMS	SOLUTIONS
Sound	No sound from SoundBar speakers	1. Make sure that the soundbar is plugged into a power source 2. Make sure the soundbar’s HDMI cable is inserted into an HDMI ARC or Audio Return Channel connector on your TV, not a standard HDMI connector. 3. If the soundbar is connected to your TV’s HDMI ARC connector, make sure that Consumer Electronics Control (CEC) is enabled in your TV system menu. Your TV may refer to CEC by a different name. Refer to your TV owner’s guide. 4. On the remote control, select the correct audio input. 5. Ensure the audio output format is set to PCM
	Distorted sound or echo	Distorted sound or if you play audio from the TV through the SoundBar, make sure that the TV is muted.
Bluetooth	A device cannot connect with the SoundBar	You have not enabled the Bluetooth function of the device. See the user manual of the device on how to enable the function.
		The SoundBar is already connected with another Bluetooth device. Disconnect the connected device, then try again.