



### P129-BK

Thank you for purchasing this SKNSL product.  
Please read this manual carefully before use and keep it  
for future reference!

## IN THE BOX

Before using this product, please check whether the contents of the package are complete.

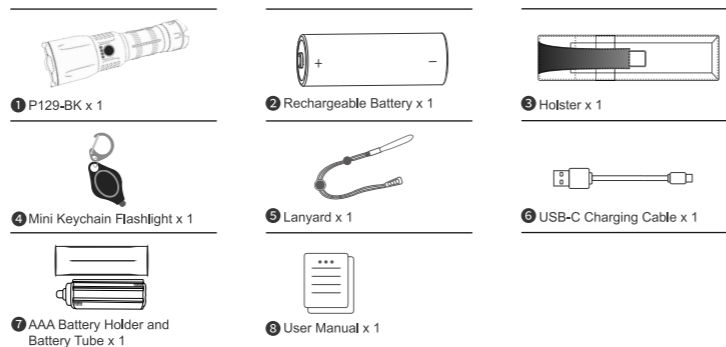

## ⚠ WARNINGS

- Please read the user manual carefully before using the flashlight.
- Please don't shine into eyes directly to avoid harm to eyes.
- Product will generate heat while working, please be cautious with that to avoid any possible harm.
- Do not use damaged, deformed battery, or with broke sleeve.
- This is not a dlving product, please don't use It underwater for a long time.
- Fully charge the battery before storing the light for a long period of time.
- Please don't disassemble the flashlight or it will not be covered by SKNSL warranty policy.

## PRODUCT OVERVIEW

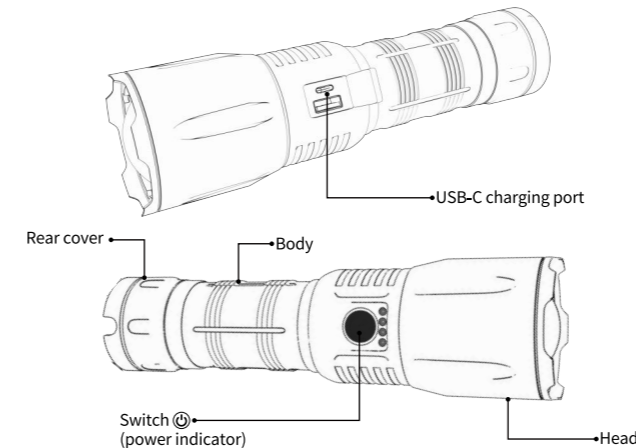

## BATTERY INSTALLATION

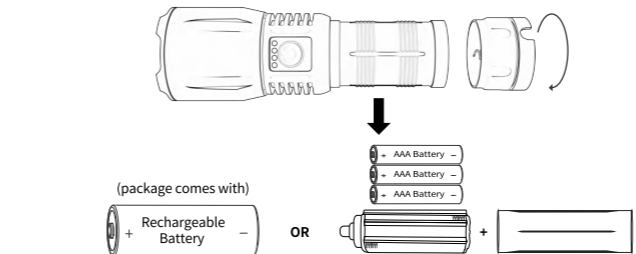

When inserting the battery, please make "+" face towards the inside and "-" towards the outside.

## OPERATION

- Press the power switch to enter the high light mode
- Press again to enter the medium light mode
- Press the third time to enter the low light mode
- Press the fourth time to enter the strobe mode
- Press the fifth time to enter the SOS mode
- Press the sixth time to turn off the power

In any mode long-press and hold switch 2-3s to tum off the light.

## CHARGING

Before first use please fully charge the product. An indicator light represents 25% battery.

Connect USB-C charging cable with the light and adapter of 5V/1A to charge. It takes about 4-6h to fully charge the light(based on 5V /1A adapter).

Power 25%	A blue light constant on
Power 50%	Two blue lights constant on
Power 75%	Three blue lights constant on
Power 100%	Four blue lights constant on

Make sure the rubber cap covered well after charging finished to promise the IPX6 waterproof level.

## WARRANTY SERVICE

- 60-day money-back guarantee for any reason For 60 days after the date of purchase, return your undamaged SKNSL product and receive a full refund for ANY reason.
- 24-month warranty for quality-related issues For 24 months after the date of purchase, we take care of all quality-related issues with a REPLACEMENT or REFUND.

## EXCLUSION CLAUSE

- SKNSL is not liable for damages or injuries sustained resulting from the usage of the product inconsistent with the warnings in the manual.

## NOTICE

- When the flashlight is in use, it is necessary to ensure heat dissipation! When the flashlight is lit, it should dissipate heat or turn it off in time according to the fever, and use it after the temperature has dropped.
- Before charging, please make sure that the battery is installed in the correct direction, otherwise the flashlight will be damaged.
- When the flashlight Indicates low power, please charge or replace the battery in time to avoid affecting the durability of the battery.
- Please do not mix old and new batteries, batteries of different batteries and brands.
- Keep the inner wall of the lampshade clean, do not wipe with your hands and hard things, use cotton swabs and professional tools to wipe the fingerprint on the lens.

## FAQs

Abnormal situation	Reasons	Solution
The flashlight does not work or cannot be charged	1.The positive and negative poles of the battery are reversed 2.Battery drained	1. How to put the battery: the positive pole faces inward, the negative pole faces outward 2.Please charge the flashlight with a USB cable
Flashlight smoking	Charge the flashlight with the battery's positive and negative poles reversed	1. Please ensure that the batteries are placed in the correct direction 2.Recharge the batteries when they are properly placed
The flashlight is not bright or the brightness is very dim	Low battery	Please charge the flashlight before use
The flashlight will not stay on	Flash mode may be on	Please press the switch again to switch t other modes

If you encounter any problems with the flashlight, you can contact us at any time and we will give you a 100% satisfactory answer.

## PARAMETERS

Lamp beads	White laser
Material	Aluminum
Charging method	USB-C charging
Time to fully charge	4-6 hours or so
Lighting time	8-12 hours or so
Waterproof	IPX6
Irradiation distance	Up to about 1500m
Charge voltage/current	5V/1A
Resistant drops	3m
Product weight	326g/ 11.49oz (without battery) 404g/ 14.25oz (with battery)
Product dimensions	170.9mm * 50.3mm * 30.7mm 7.04in * 2.08in * 1.45in

All above specifications are test results based on ANSI/NEMA FL1-2009 Standard. The tests are performed using the battery included in the flashlight.