

# BH10

## Instruction manual

### 1、 Packing list

- BH10 Wireless headset
- Audio cables
- Charging cables
- Product instructions

### 2、 Use environment requirements and

#### product parameters

- Product model: BH10
- Charging time: 2-3 hours
- Charging voltage: 5V
- Speaker impedance: 32Ω
- Communication distance: 10 meters
- Input: 5V= 0.3A
- Working temperature: 0°C~45°C

### 3、 Operating instructions

#### 1. Wireless Bluetooth connection

Press and hold the power button for 3-5 seconds, after the headset flashes red and blue lights alternately, turn on the phone's bluetooth, Search and find the device name "BH10" to connect. Set after successful connection The blue light flashes slowly.

#### 2. Switch on and off

Press and hold the switch button for 3 seconds, the blue light flashes, that is The device will automatically pair and connect. Press and hold the power button for 3-5 seconds to shut down.

### 4、 Appearance buttons

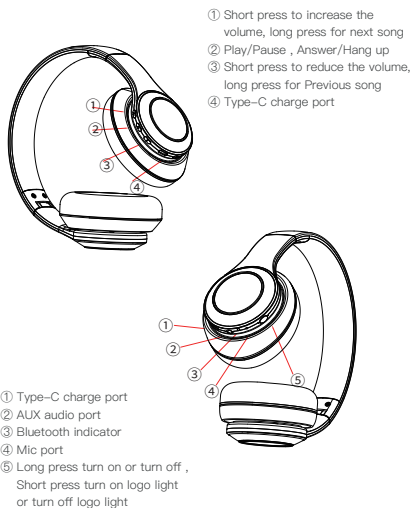

### 1. Charging

Use the complimentary charging cable or TYPE-C charging cable to connect to the device. Charging process, the red light of the middle indicator light is always on, and the indicator light is off when the battery is fully charged.

### 2. Wired mode

To use the wired mode, turn off the Bluetooth mode and perform shutdown operations. Plug in and deliver the 3.5mm audio cable is ready for use. (The headset button and microphone cannot be used in this state.)

### 3. Buttons Description

Button name	Action	The Effect	In view of the equipment
Power Button	Press and hold for 3-5 seconds	Turn on	This Machine
Power Button	Press and hold for 3-5 seconds	Turn off	This Machine
Power Button	Short press 1 time	Turn on logo light or turn off logo light	This Machine
Play Button	Short press (when music is playing)	Play/pause	Mobile phone
Play Button	Short press (when a call comes in)	Answer/hang up	Mobile phone
Play Button	Long press for 3 seconds (when a call comes in)	Reject the phone	Mobile phone
V+ key	Short press (when music is playing)	Volume increase	Mobile phone
V-key	Short press (when music is playing)	Volume down	Mobile phone
V+ key	Long press (when music is playing)	Next song	Mobile phone
V-key	Long press (when music is playing)	Previous song	Mobile phone

### 5、 Common problems

#### 1. The device cannot be found

The phone cannot search for the device, try to turn off the headset and then turn it on again, And Also try to turn off the bluetooth of the mobile phone and then turn it on again. The dental equipment is cleared, and the search and pairing is performed again.

#### 2. The device is connected but there is no sound

Adjust the volume of the headset , check if the volume on the headset is adjusted to the lowest.

#### 3. There is no sound from the headset when the audio cable is plugged in

Plug the audio cable back into the headset and mobile phone.

**FCC Caution:**

This device complies with part 15 of the FCC Rules. Operation is subject to the following two conditions: (1) This device may not cause harmful interference, and (2) this device must accept any interference received, including interference that may cause undesired operation.

Any Changes or modifications not expressly approved by the party responsible for compliance could void the user's authority to operate the equipment.

**Note:** This equipment has been tested and found to comply with the limits for a Class B digital device, pursuant to part 15 of the FCC Rules. These limits are designed to provide reasonable protection against harmful interference in a residential installation. This equipment generates uses and can radiate radio frequency energy and, if not installed and used in accordance with the instructions, may cause harmful interference to radio communications. However, there is no guarantee that interference will not occur in a particular installation. If this equipment does cause harmful interference to radio or television reception, which can be determined by turning the equipment off and on, the user is encouraged to try to correct the interference by one or more of the following measures:

- Reorient or relocate the receiving antenna.
- Increase the separation between the equipment and receiver.
- Connect the equipment into an outlet on a circuit different from that to which the receiver is connected.
- Consult the dealer or an experienced radio/TV technician for help.

The device has been evaluated to meet general RF exposure requirement. The device can be used in portable exposure condition without restriction.