

Lumo-X xCube4-NA

User Manual



Lumo·X³

Before using the product, please read this carefully.

Product Introduction

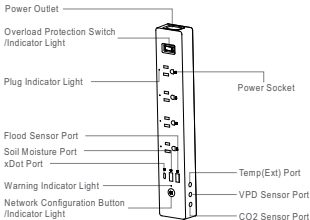

Product Introduction

Explanation of Network Indicator Light Status:

- Fast blinking blue light: Wi-Fi EZ mode, waiting for network configuration.
- Slow blinking blue light: Hotspot mode, waiting for network configuration.
- Steady blue light: Network connected.
- Blue light off: Network disconnected.

Explanation of Network Configuration Button:

- When the network indicator light is blinking, long-pressing for 5 seconds will switch the network configuration mode.
- When the network indicator light is steady on or off, long-pressing for 5 seconds will reset the network configuration, and you will need to perform the network setup process again.

Important Disclaimer: This product is a precision electronic device. Please do not use it in environments where water exposure is possible. If the product is used in a way that causes malfunction, any resulting issues with product usage, or safety concerns, our company will not be held responsible.

Warning

This device complies with Part 15 of the FCC Rules. Operation is subject to the following two conditions:

- (1) this device may not cause harmful interference
- (2) this device must accept any interference received, including interference that may cause undesired operation.

Changes or modifications not expressly approved by the party responsible for compliance could void the user's authority to operate the equipment.

NOTE:

This equipment has been tested and found to comply with the limits for a Class B digital device, pursuant to Part 15 of the FCC Rules. These limits are designed to provide reasonable protection against harmful interference in a residential installation. This equipment generates, uses and can radiate radio frequency energy and, if not installed and used in accordance with the instructions, may cause harmful interference to radio communications. However, there is no guarantee that interference will not occur in a particular installation.

Warning

If this equipment does cause harmful interference to radio or television reception which can be determined by turning the equipment off and on, the user is encouraged to try to correct the interference by one or more of the following measures:

- Reorient or relocate the receiving antenna.
- Increase the separation between the equipment and receiver
- Connect the equipment into an outlet on a circuit different from that to which the receiver is connected.
- Consult the dealer or an experienced radio/TV technician for help

NOTE:

This device and its antenna(s) must not be co-located or operation in conjunction with any other antenna or transmitter

RF Exposure Statement

To maintain compliance with FCC's RF Exposure guidelines, this equipment should be installed and operated with minimum distance of 20cm the radiator your body. This device and its antenna(s) must not be co-located or operation in conjunction with any other antenna nr transmitter.

Basic Parameters

Product Name	Lumo-X xCube4
Product Model	xCube4-NA
Specifications	1800W , 15A MAX , 120V
	2200W , 10A MAX , 220V
Port Output	1200W , 10A MAX , 120V
	2200W , 10A MAX , 220V
Operating Temp	0℃ to 40℃
Supported Systems	Android5.0 or iOS13.0 or higher
Wireless Connection	Wi-Fi IEEE 802.11 b/g/n 2.4GHz

Manufacturer	Canbridge Tech Ltd.
Service Email	Service@Lumo-X.com
Service Website	www.Lumo-X.com

Quick Setup

This product requires an internet connection and can be controlled through the "Lumo-X" app, which supports Android and iOS systems. It can be paired with various Lumo-X environmental sensors and, in combination with backend automatic/timed strategies, can control peripherals such as fans, heaters, and other devices.

1. Power On

Connect the power cord to the main unit's power outlet. Plug the power cord into the power source, then turn on the overload protection switch. When the overload protection switch indicator light is illuminated, that the main unit is powered on.

2. Download the App

Method 1: Search for "Lumo-X" on Google Play or the App Store and install the App.

Method 2: Scan the QR code to download and install the Lumo-X App.



Quick Setup

3. Register/Login Account

To register, use your email to create an account. After successfully registering, you can log in using either your username or email address.

4. Create a Grow Room

Once you've successfully logged in, navigate to the App's main page. Click on the "Weather" tab, and press the "ADD A ROOM" button. Input the room's name and information, then click "NEXT" to create a Grow Room.

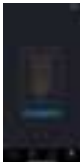

Quick Setup

5. Connect xCube

On the App's main page, click on the "Weather" tab. At the top of the page, click "Add a Socket" to initiate the network configuration process.

Ensure that your phone is connected to a 2.4GHz Wi-Fi network and that the xCube's network configuration indicator light is blinking blue. Follow the app's instructions to proceed. Once successfully connected, the xCube's network configuration indicator light will remain steady blue.

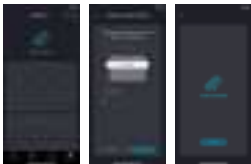

Quick Setup

6. Connect Lumo-X Environmental Sensors

Refer to the product introduction to connect the appropriate Lumo-X environmental sensor. In the app, you can view real-time sensor data to monitor the environment.

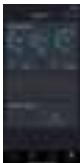

More Information

For more information and other great products, please visit the following link or scan the QR code.

Website: <https://www.Lumo-X.com>

xCommunity: <https://community.Lumo-X.com>

Instagram: <https://www.instagram.com/lumoxgrow>



Website



xCommunity



Instagram