

Please make sure to read the enclosed Ninja® Safety Instructions prior to using your unit.

# QUICK START GUIDE

# NINJA®

**PROFESSIONAL XL**

**FOOD PROCESSOR**



## GET TO KNOW THE ATTACHMENTS

### BLADE ASSEMBLIES



**CHOPPING BLADE ASSEMBLY**



**DOUGH BLADE ASSEMBLY**

### 3-PART FOOD PUSHER

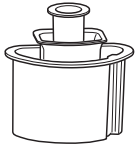

**3-PART FOOD PUSHER:**

The 3-part food pusher separates into small, medium, and large food pushers to guide ingredients through the different-sized feed chute openings. Use the small feed chute opening (which also doubles as a measuring cup) for ingredients like carrots, the medium feed chute for ingredients like cucumbers and zucchini, and the large feed chute for ingredients like potatoes.

**NOTE:** As a safety feature, the large food pusher must be inserted in the feed chute for the unit to run. **DO NOT** exceed the **CHUTE MAX FILL** line on the large feed chute. Unit will not run if ingredients exceed this line.

### DISC ASSEMBLIES

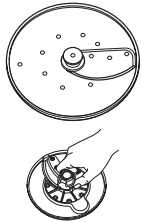

**ADJUSTABLE SLICING:**

The adjustable slicing disc allows you to customize the slice thickness (0.3–8mm). Great for mushrooms, zucchini, cucumbers, and potatoes. The disc has 8 main settings with  $\frac{1}{3}$ -mm micro settings between each (for a total of 24 individual settings) ranging from 0.3mm–8mm.

**IMPORTANT:** Ensure disc is **NOT** on the **S** (storage) setting before installing it. Return disc to **S** position after use.



**REVERSIBLE SHREDDING:**

The reversible shredding disc is ideal for different thicknesses of shredding. Place the **FINE** side up for outputs such as shredded carrots, or place the **COARSE** side up for outputs such as shredded cabbage.



**DISC SPINDLE:**

Install disc spindle onto the gear shaft of the Precision Processor® Bowl to use the disc assemblies or 4.5 Cup Nesting Workbowl.

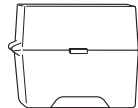

**STORAGE BOX:**  
**(not included with all models)**

Easily and safely store the disc assemblies, disc spindle, and dough blade assembly in the storage box.

### 4.5 CUP NESTING WORKBOWL

(not included with all models, available for purchase on [ninjaaccessories.com](http://ninjaaccessories.com))



**4.5-CUP NESTING WORKBOWL**

The 4.5-Cup Nesting Workbowl is perfect for smaller quantities of output. Place inside the Precision Processor Bowl and you will be ready to make all the delicious recipes in smaller quantities.



**SMALL CHOPPING BLADE ASSEMBLY**

## AUTO-IQ® PROGRAMS

Intelligent preset programs combine unique blending and pausing patterns that do the work for you. Once an Auto-iQ program is selected, it will start immediately and automatically stop when processing is complete. To stop processing before the end of a program, press the currently active button again.

**NOTE:** Program run times vary from a few seconds to just over a minute.

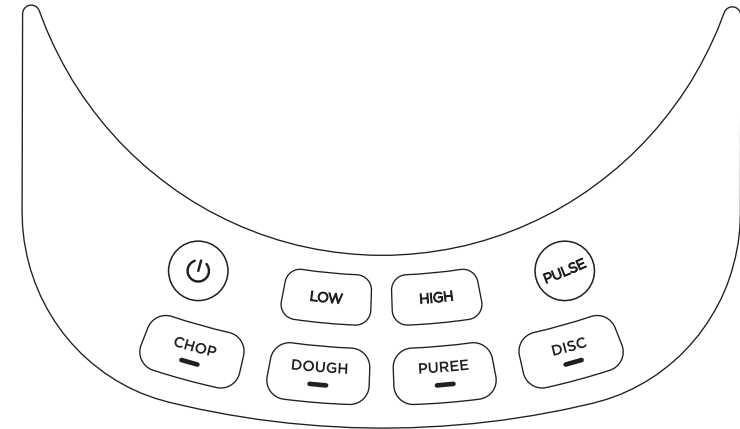

**CHOP**

Timed pulses and pauses give you consistent chopping results. Run program once for a large chop, twice for a small chop, and three times for a mince. Use with chopping blade assembly.

**DOUGH**

Ideal for creating delicious dough, from pie to pizza to cookie doughs. Use with dough blade assembly.

**NOTE:** Use PULSE to add mix-ins, such as chocolate chips or raisins, after dough program has completed.

**PUREE**

Create anything from silky-smooth sauces to the perfect hummus. Use with chopping blade assembly or nesting workbowl with small chopping blade assembly.

**DISC**

Slice and shred a variety of ingredients, such as vegetables, cheese, and potatoes. Use with adjustable slicing or reversible shredding disc.

## MANUAL PROGRAMS

**LOW and HIGH:** When selected, each of these speeds runs continuously for 60 seconds. They do not work in conjunction with any Auto-iQ programs.

**PULSE:** Offers greater control of pulsing and processing. Operates only when PULSE is pressed. Use short presses for short pulses and long presses for long pulses.

**IMPORTANT: DO NOT** run the unit on HIGH if using the dough blade or disc assemblies. The unit is **NOT** intended to crush ice. Refer to the warnings in the Safety Instructions.

## USING THE CHOPPING & DOUGH BLADE ASSEMBLIES

### PARTS

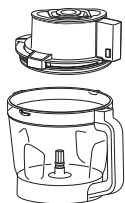

**PRECISION PROCESSOR®  
BOWL & LID WITH  
3-PART FOOD PUSHER**



**CHOPPING BLADE  
ASSEMBLY**

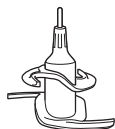

**DOUGH BLADE  
ASSEMBLY**

### BLADE ASSEMBLY

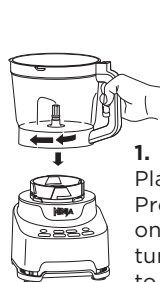

1. Place Precision Processor Bowl on base and turn clockwise to lock in place.

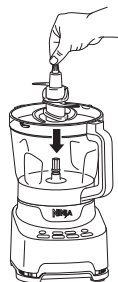

2. Holding the blade assembly by the top of the shaft, install it in bowl.



3. Place ingredients in bowl. Place lid on bowl and turn clockwise to lock in place.

### PROCESS & ENJOY

Once the Precision Processor Bowl is locked onto the base, plug in the unit, then press the Power button  to turn the unit on.



1. Select desired program to begin processing.



2. When processing is complete, press button on feed chute lid near handle to unlock. Turn lid counterclockwise and lift from bowl.  
Remove blade assembly before emptying bowl.

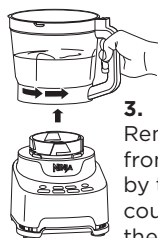

3. Remove bowl from base by turning it counterclockwise, then lifting it up.

**NOTE:** Large food pusher must be inserted in the feed chute for the unit to run. For thinner recipes such as sauces and chopping, make sure all 3 parts of the pusher are installed to avoid splatter.

**WARNING:** Chopping Blade Assembly is sharp and not locked in place. Before pouring, carefully remove Chopping Blade Assembly. Failure to do so will result in a risk of laceration. Refer to the Ninja Safety Instructions for additional information.

## NESTING BOWL (not included with all models)

### PARTS



**PRECISION PROCESSOR®  
BOWL & LID WITH  
3-PART FOOD PUSHER**



**4.5-CUP NESTING  
WORKBOWL**



**SMALL CHOPPING  
BLADE ASSEMBLY**



**DISC  
SPINDLE**

**NOTE:** Nesting workbowl not included with all models. Available for purchase on [ninjaaccessories.com](http://ninjaaccessories.com).

### NESTING WORKBOWL



1. Place Precision Processor Bowl on base and turn clockwise to lock in place.



2. Place the nesting workbowl in the processor bowl with the arrow on the workbowl aligned with the arrow on the processor bowl handle.  
Place the disc spindle through the opening in the middle and sit it on the drive gear. Then place the small chopping blade over the spindle inside the workbowl.



3. Place ingredients in bowl. Place lid on bowl and turn clockwise to lock in place.

### PROCESS & ENJOY

Once the Precision Processor Bowl is locked onto the base, plug in the unit, then press the Power button  to turn the unit on.



1. Select either a manual program (LOW, HIGH, PULSE) or the PUREE Auto-iQ program to begin processing.



2. When processing is complete, press button on feed chute lid near handle to unlock. Turn lid counterclockwise and lift from bowl.  
Remove blade assembly before emptying nesting workbowl.

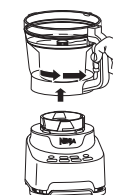

3. Remove workbowl by grasping the textured center and lifting up.  
Remove bowl from base by turning it counterclockwise, then lifting it up.

**NOTE:** Do not make dough with the 4.5-Cup Nesting Workbowl.

**NOTE:** Large food pusher must be inserted in the feed chute for the unit to run. For thinner recipes such as sauces and chopping, make sure all 3 parts of the pusher are installed.

**WARNING:** Chopping Blade Assembly is sharp and not locked in place. Before pouring, carefully remove Chopping Blade Assembly. Failure to do so will result in a risk of laceration. Refer to the Ninja Safety Instructions for additional information.

## USING THE DISC ASSEMBLIES

### PARTS

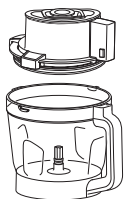

**PRECISION PROCESSOR®  
BOWL & LID WITH  
3-PART FOOD PUSHER**



**DISC  
SPINDLE**

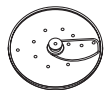

**ADJUSTABLE  
SLICING  
DISC**



**REVERSIBLE  
SHREDDING  
DISC**

### DISC ASSEMBLY

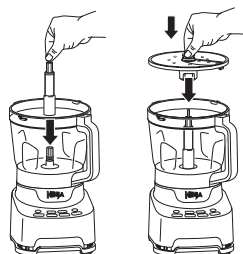

1. Place Precision Processor® Bowl on base and turn clockwise to lock in place. Install the spindle, then choose the appropriate disc (2A or 2B).

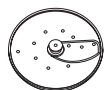

#### 2A. ADJUSTABLE SLICING

Use dial on disc to select the desired thickness (0.3–8mm). Then use plastic grip to carefully place disc over disc spindle.

**IMPORTANT:** Ensure disc is **NOT** on the **S** (storage) setting before installing it. Return disc to **S** position after use.



#### 2B. REVERSIBLE SHREDDING

Use the plastic grip to place the disc over the disc spindle with the desired shredding size (either **COARSE** or **FINE**) facing up.



### FOOD PREP

If using the small or medium feed chute, trim ingredients to fit the feed chute height.

If using the larger feed chute, **DO NOT** exceed the **CHUTE MAX FILL** line on the large feed chute. Unit will not run if ingredients exceed this line.



Cut both ends off ingredients to create flat surfaces. Trim tapered ingredients like carrots to make them more symmetrical.

**NOTE:** Ensure cheese is well chilled before slicing/shredding. **DO NOT** slice or shred frozen cheese.

**NOTE:** Keep ingredients as steady as possible when pushing through the feed chute. This will help minimize waste.

## PROCESS & ENJOY (DISCS)

Once the Precision Processor® Bowl is locked onto base, plug in the unit, then press the Power button to turn the unit on.

**IMPORTANT:** As a safety feature, the large food pusher must be inserted in the feed chute for the unit to run.

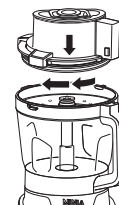

1. Place feed chute lid on bowl and turn clockwise. Based on the ingredient, use the smallest possible feed chute opening for best slicing and shredding results.



- 2A. If using the small or medium feed chute opening, select **DISC** or **LOW**. The disc will begin spinning. Add ingredients through the feed chute on the lid.



- 2B. If using the large feed chute opening, place ingredients up to, but not exceeding, the **CHUTE MAX FILL** line. Insert the pusher into the feed chute, then select **DISC** or **LOW**. The disc will begin spinning.

**IMPORTANT:** Use only the **DISC** program or **LOW** setting when using the disc assemblies.



3. The disc will automatically stop spinning at the end of the program. Wait for disc to stop turning, then press the button on the feed chute lid near the handle to unlock. Turn lid counterclockwise and lift lid from bowl.

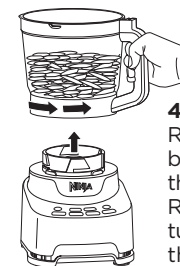

4. Remove the disc assembly by grasping the plastic grip, then remove the disc spindle. Remove bowl from base by turning it counterclockwise, then lifting it up.

### CLEANING



**Dishwasher:** The bowl, lid, discs, nesting workbowl, and blade assemblies are dishwasher safe. Ensure the blade assembly is removed from the bowl before placing in the dishwasher. Exercise care when handling blade assemblies.



**Hand-washing:** Wash bowl, lid, discs, nesting workbowl, and blade assemblies in warm, soapy water. Exercise care when washing the blade assemblies. Use a dishwashing utensil with a handle to avoid direct hand contact with blades. Rinse and air-dry thoroughly.



**WARNING:** Always unplug the base before cleaning.

# NINJA<sup>®</sup>

PROFESSIONAL

## XL FOOD PROCESSOR

Scan the code for online help, FAQs, and How-To Videos.  
[ninjakitchen.com](http://ninjakitchen.com)

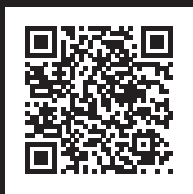

For questions or to register your product,  
visit us online at [ninjakitchen.com](http://ninjakitchen.com)



@ninjakitchen

© 2022 SharkNinja Operating LLC.

AUTO-IQ, NINJA, and PRECISION PROCESSOR are registered trademarks of SharkNinja Operating LLC.  
NF701Series\_QSG\_MP\_Mv5