

说明书

USER MANUAL

磁吸无线充移动电源

Magnetic suction wireless mobile power supply



100% 屏幕电量显示
100%LED screen power display

简介

本移动电源采用铝合金+塑胶材质外壳，支持苹果、Type-C 输入，使用内置 Type-c PD 输出口连接其他移动设备和磁吸无线充可为设备充电。

产品说明

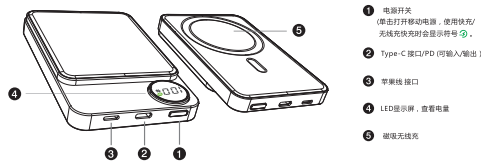

规格

输入电压/电流：5V/2A(Lightning)
输入电压/电流：5V/3A 9V/2A 12V/1.5A(Type-c接口/PD)
输出电压/电流：5V/2A 9V/2.22A 12V/1.5A(Type-c接口/PD)
输出电流/电压：5W/7.5W/15W (无线输出)

电池：锂聚合物电池
可循环充电次数：500次
适宜环境温度：0℃-40℃

使用说明

1. 自带Type-c 和苹果输入口可连接为产品蓄电。
2. 使用内置 Type-c PD 输出口连接其他移动设备和磁吸无线充可为设备充电。
3. 单击打开移动电源设备，使用快充/无线快充时会显示符号

常见问题及解决方法

故障	原因	解决方法
对本产品长时间充电，电量LED显示屏不能显示充满	1.充电时间不够 2.充电器或本产品故障	1.对本产品5000容量的宽裕充5小时以上，10000容量的宽裕充8小时以上。 2.向经销商或售后服务咨询
无法检测本产品剩余电量	1.剩余电量为零 2.电量低按钮指示灯故障 3.本产品电源故障	1.重新充电 2.向经销商或售后服务咨询
本产品对其他设备充电时，可充电或供电但不能对其充满	本产品电量用尽	重新对本产品充电
本产品尚余一定电量时，使用其对外供电，出现本产品忽然停止工作无法显示电量现象	外部短路或出现负载过大，导致本产品自动保护	对本产品重新充电以激活

注意事项

第一次使用本产品，循环充放电一次，可以更好的提高产品使用寿命！
使用产品前请仔细阅读所有提示说明！
请勿随意拆卸产品，否则将导致保修无效！

保修服务卡/Warranty service

感谢购买本产品
Thank you for purchasing this product

产品型号 MODEL		姓名 Name	
		电话 Telephone	
地址 Address			
故障原因 Failure cause			
购买日期 Purchase date			

注意：请勿随意拆卸本产品，否则将导致保修无效！

Introduction

The mobile power supply adopts aluminum + plastic material shell, support the apple, the Type - C input, use the built-in Type - C PD Connect to other mobile devices and magnetic suction wireless charger can charge the battery for the equipment.

Product description

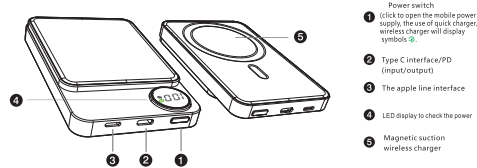

Specifications

Input: 5V=2A(Lightning)
Input: 5V=3A 9V=2A 12V=1.5A (Type-c interface/PD)
Output: 5V/2A 9V/2.22A 12V/1.5A (Type-c interface/PD)
Output: 5W/7.5W/15W (Wireless output)

Battery: Lithium polymer battery
Number of cycles to be recharged: 500 times
Suitable environmental temperature: 0℃-40℃

User manual

1. The built-in Type - c and apple input port can be connected to battery products.
2. Use the built-in Type - c PD other mobile devices and magnetic suction outlet connection wireless charger can charge the battery for the equipment.
3. Click to open the mobile power supply equipment, the use of quick charger/wireless charger will display symbols

Common problems and Solutions

Fault	Reason	Resolvent
Charge the product for a long time The LED screen does not display full	1., the charging time is not enough 2. charger or this product malfunction	1. Our product capacity of 5000 cumulative charge more than 5 hours. The capacity of 10000 cumulative charge more than 8 hours. 2. consultation with distributors or after sales service
Unable to check the remaining power of this product	1., the remaining power is zero 2. power button or indicator light failure 3. the power failure of this product	1. recharge 2. consultation with distributors or after sales service
When charging for other equipment, the product can charging or powering, but not full of it	The power consumption of this product is exhausted	Recharge the product again
This product still has a certain amount of electricity, the use of its external power supply, the emergence of this product suddenly stop working and unable to display power	External short-circuit or excessive load, Cause automatic protection of this product	Recharge the product to activate it

Matters needing attention

The first use of this product, cycle, charge and discharge once, can better improve the service life of the product!
Please read all the instructions carefully before using the product!
Please do not disassemble the product, or it will cause the warranty invalid!