



Technical Support and E-Warranty Certificate  
[www.vevor.com/support](http://www.vevor.com/support)

## **UTILITY CARTS USER MANUAL**

**MODEL:JYUP2**

We continue to be committed to provide you tools with competitive price. "Save Half", "Half Price" or any other similar expressions used by us only represents an estimate of savings you might benefit from buying certain tools with us compared to the major top brands and does not necessarily mean to cover all categories of tools offered by us. You are kindly reminded to verify carefully when you are placing an order with us if you are actually Saving Half in comparison with the top major brands.

# VEVOR®

TOUGH TOOLS, HALF PRICE

## UTILITY CARTS

MODEL:JYUP2



Photo for reference

### NEED HELP? CONTACT US!

Have product questions? Need technical support? Please feel free to contact us:

**Technical Support and E-Warranty Certificate**  
**[www.vevor.com/support](http://www.vevor.com/support)**

This is the original instruction, please read all manual instructions carefully before operating. VEVOR reserves a clear interpretation of our user manual. The appearance of the product shall be subject to the product you received. Please forgive us that we won't inform you again if there are any technology or software updates on our product.

# PRODUCT PARAMETERS

Specifications	
Load Capacity:	250kg
Castor Size:	123mm
Dimensions (L x W x H):	1015mm x450mm x 850mm



1. Read carefully and understand all **ASSEMBLY AND OPERATION INSTRUCTIONS** before operating.
2. Failure to follow the safety rules and other basic safety precautions may result in serious personal injury.

## ASSEMBLY PRECAUTIONS

1. Assemble needs to follow these instructions. Improper assembly can cause personal injury and/or property damage
2. Do not assemble when tired or under the influence of alcohol, drugs, or medication.
3. Weight capacity and other product capabilities only apply to a wholly and correctly assembled product.
4. Do not overload the cart. See specifications for load capacity (Distributed evenly).
5. Keep the assembly area clean and well-lit.
6. Keep bystanders out of the area during assembly.
7. The weight of the plate is heavy; pay attention to the installation to avoid hurting it, and if necessary, find someone to assist with the installation.

# USE PRECAUTIONS



## **WARNING: TO PREVENT SERIOUS INJURY AND DEATH FROM TIPPING:**

1. This product is not a toy. Do not allow children to play with or approach this item.
2. Use as intended only. Do not sit or stand on the product.
3. Inspect before every use. Do not use it if parts are loose or damaged.
4. Use on flat, level, and hard surfaces only.
5. Do not exceed the listed weight capacity. Tighten all knobs securely before applying load. Be aware of dynamic loading! The sudden load movement may briefly create an excess load, causing product failure.
6. When the heavy load is moving for a long time, it is necessary to check whether the screw is loose to avoid the body shaking when moving.

## ASSEMBLY STEPS

Tools required: Cross-point screwdriver, and rubber or wood mallet.

Use the mallet to tap down the parts to ensure they are seated properly before fastening them with screws.

1. Turn the upper platform upright (#2) and install the handle (#1).
2. Turn the upper platform assembly upside down and install legs (two left and two right, #4 and #5)
3. Install lower platform (#3) and castors (#6, #7). Tighten all screws and hex nuts. (#8, #9, #10)

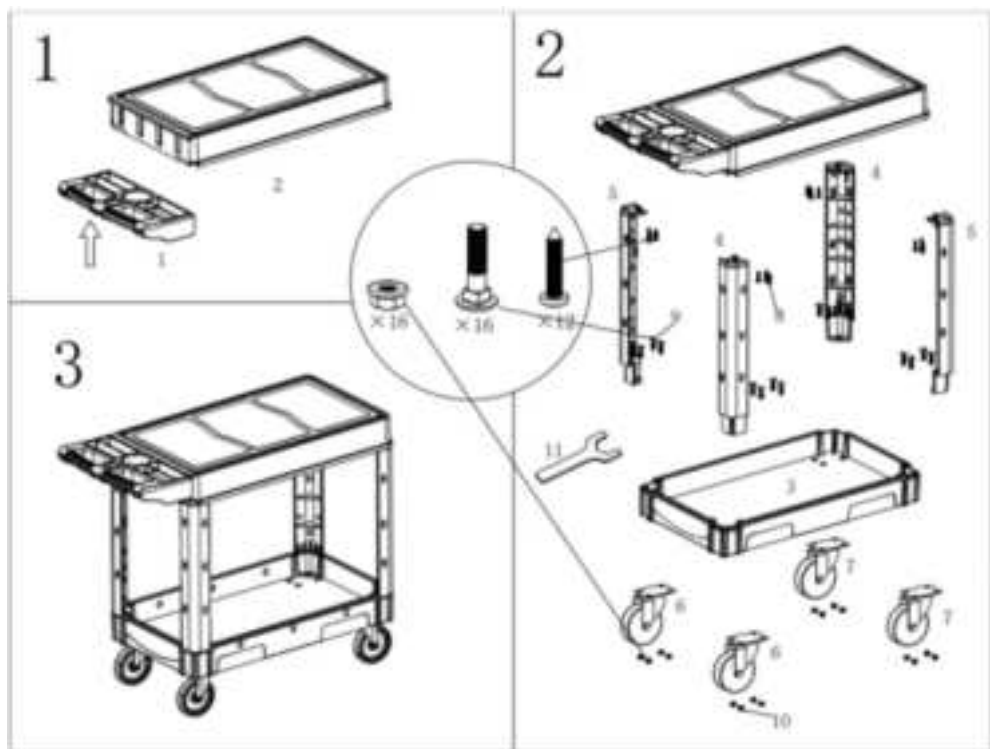

Parts Breakdown		
Index NO.	Description	Qty
1	Handle	1
2	Upper Platform	1
3	Lower Platform	1
4	left Leg	2
5	Right Leg	2
6	Brake Castor Assembly $\Phi 5$ in	2
7	Fixed Castor Assembly $\Phi 5$ in	2
8	Tapping Screw 16*24mm	12
9	Screw Bolt I8*33Im	16
10	Hex Nut I8	16
11	Trench	1

**Manufacturer:** Shanghaimuxinmuyeyouxiangongsi

**Address:** Shuangchenglu 803nong11hao1602A-1609shi, baoshanqu, shanghai 200000 CN.

**Imported to AUS:** SIHAO PTY LTD. 1 ROKEVA STREETEASTWOOD NSW 2122 Australia

**Imported to USA:** Sanven Technology Ltd. Suite 250, 9166 Anaheim Place, Rancho Cucamonga, CA 91730

<b>EC</b>	<b>REP</b>
-----------	------------

E-CrossStu GmbH  
Mainzer Landstr.69, 60329 Frankfurt am Main.

<b>UK</b>	<b>REP</b>
-----------	------------

YH CONSULTING LIMITED.  
C/O YH Consulting Limited Office 147, Centurion House,  
London Road, Staines-upon-Thames, Surrey, TW18 4AX





Technical Support and E-Warranty Certificate  
[www.vevor.com/support](http://www.vevor.com/support)