



# ALL EASY Pro

1 screw, 1 minute  
for simplified installation & maintenance



## All Easy Pro

Superior Cooling/Heating Performance and Airflow.  
Outstanding Energy Efficiency with A+++ rating on both Cooling & Heating.



1 screw  
1 minute



Easy  
Installation



Easy  
Clean



Energy  
Efficiency



Follow  
Me



Smart  
Kit



Split/Multi-Split  
Functions



# ALLEASY Pro

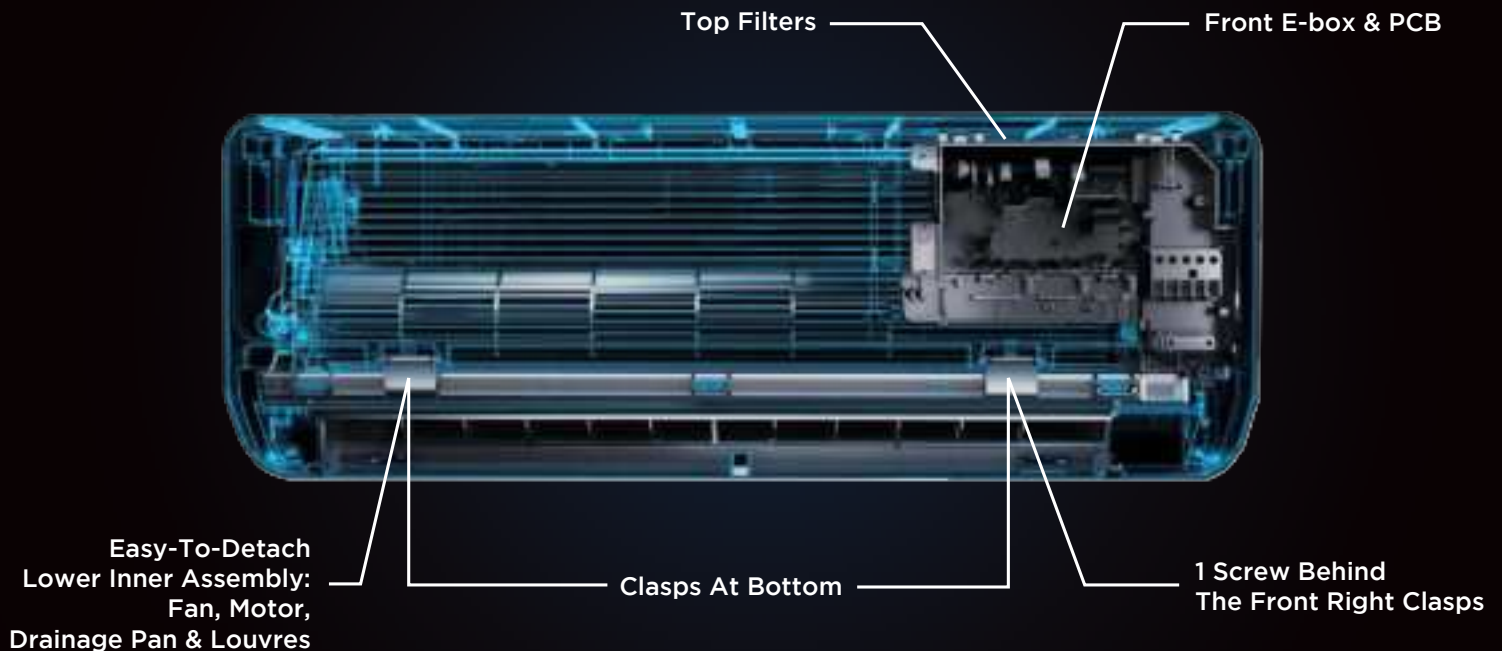

**We Explore The New Possibilities of AC Structure  
And So A New Way To Cool Your Home**

## All Easy Pro vs. Others

### Fast Installation



All Easy Pro: **6 min 47 sec**  
Others: **11 min 33 sec**

### Fan Motor Assembly



All Easy Pro: **1 min 12 sec**  
Others: **17 min 37 sec**

### PCB Replacement



Fan Motor: **1 min 12 sec**  
Assembly: **21 min 3 sec**

= **1/5** time for 1 AE Pro Maintenance Compare to Regular AC unit

# ALL THE INSTALLATION WORKS GET EASY

## Easy Measure and Fix Without Extra Tools

Super slim mounting plate with built-in scale and horizontal meter. Measure, mark and fix with just one plate.



DO NOT NEED



**STEP 1:** Mark the **SPOT A** according to the instruction of scale-on-plate



**STEP 2:** Move down the plate until the punch hole to the **SPOT A**



**STEP 3:** Locate the punch hole on other side with the Horizontal Meter on plate for precise levelling

## Easy Wiring In 3 Seconds

**176mm** large piping space with installation support clip.

Front-placed E-BOX for convenient access wiring just opening the front panel.



## Flexible Space Cooling Solution

Max. **15M** Piping Height and **30M** Piping Length. Requires Min. **5CM** Of Ceiling Distance

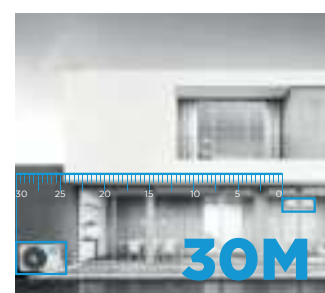

## Impeccable Installation Done In 10 Steps

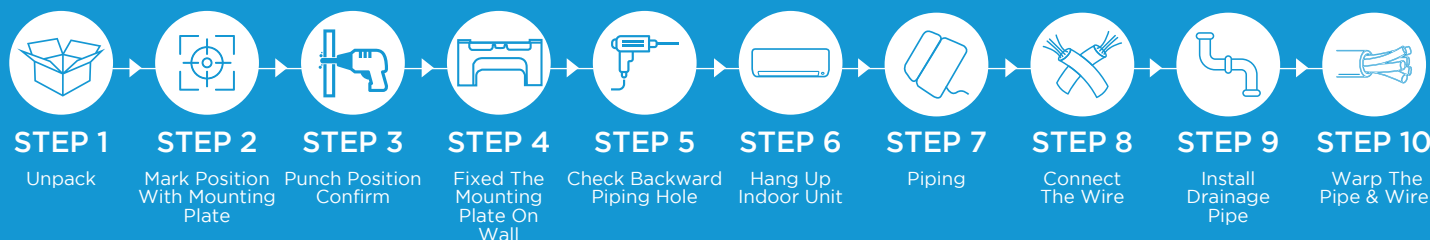

# SAVE ENERGY

## Minimal Structure, Minimalize Your Bill

Thanks to the front E-box and PCB design that releases more space for a larger air volume in and out, the AE Pro delivers you the stronger cooling performance with lower monthly energy bills.

+23.5%

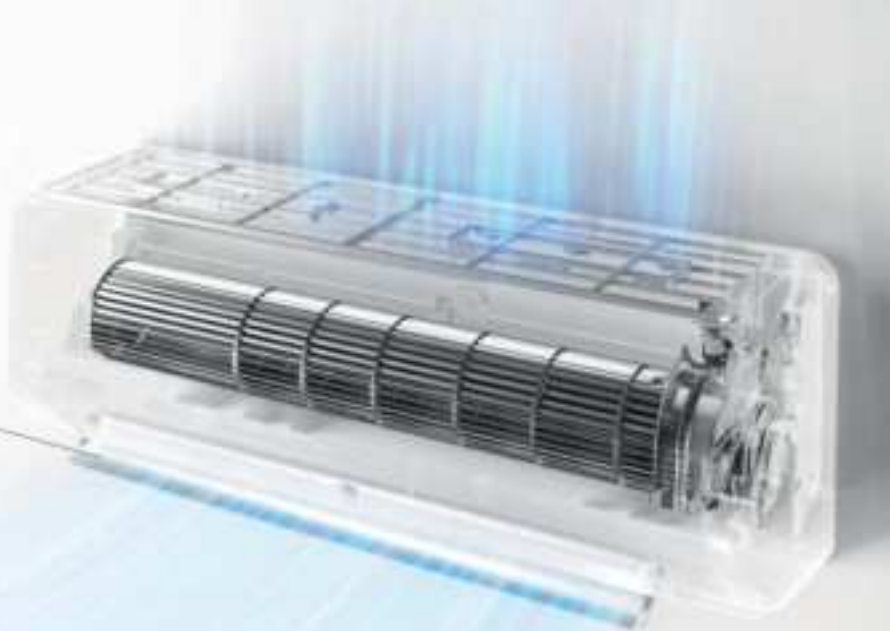

### TURBO MODE

Achieve the setting temperature with cool air in maximum speed with just a touch of the Turbo button.



### 3D AIRFLOW

The deflectors swing automatically in all directions to intentionally direct airflow to every corner of the room.



### INTELLIGENT EYE

This unique feature automatically activates energy-saving mode or turns the unit off when detecting an empty room, reducing your energy costs by up to 25%.

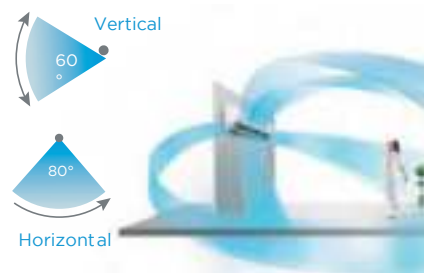

## DURABILITY

### Designed with Innovation, Built to Last

Equipped with the best protection against the natural elements, Midea air conditioners are primed and designed to last.



### PRIMEGUARD™ GOLDEN FIN

Get more resistance from water, rust, adherent grease, oxidation and other corrosive elements with a steadier cooling performance with our signature Golden Fin protection.

- The Golden Fin coated cover protects the motor and prevents water from seeping into the indoor unit, preventing mould and rust.
- Our signature Golden Fin repels water, making it more durable and less likely to breakdown.

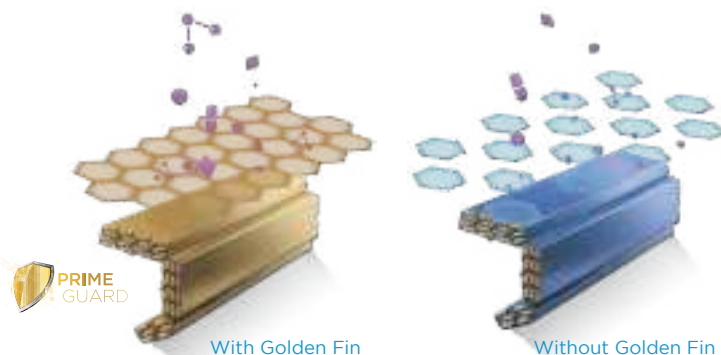





## Every breath is protected

There's nothing more important than the health of you and your loved ones. Midea has integrated crucial technology that will produce cleaner and fresher air from its range of air conditioners. With an innovative air protection system, say goodbye to dust, bacteria and unpleasant odours from the air you breathe; it's all efficiently taken care of to protect everyone at home.



### DUAL FILTRATION

The Dual Filtration system thoroughly eliminates harmful substances to provide you with fresh and clean air.

#### STEP 1:

##### Full High Density (HD) Filter

Blocks out dust particles and other airborne impurities as an initial screening.



Dog hair



Dead mite feces



Fungi



Flower pollen



Bacteria



Smoke

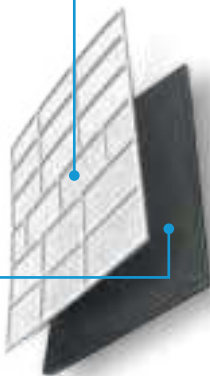

#### STEP 2:

##### Activate Carbon Filter with Vitamin C Filter Cover

This forms positive positions on the filter surface and traps small dust particles, smoke and pet fur to prevent allergies. The Vitamin C filter releases particles in the air to help rejuvenate your skin.



### MOISTURISING SKIN

A 3-in-1 filter designed with a special vitamin C component helps soften and moisturise your skin.



### ANTI-MOULD SELF-CLEANING

Our self-sustaining indoor units has a cooling coil that cleverly switches to dry operation and runs at a very low speed for 15 to 20 minutes. This eradicates any growth of mould or bacteria and also helps to extend the life of the air conditioner.



### DEEPER ACCESS

The remarkable detachable fan wheel design increases access for deep cleaning by up to 50% and can be easily disassembled in just 1 minute to thoroughly clean the fan and heat exchanger.



# COMFORT

## Your comfort comes first

Apart from the innovative technology that drives Midea air conditioners to be the best, we strive to always produce a product that has the comfort of its users as a top priority. Key comfort features in our air conditioners maintain temperatures, keep you cool on the move and is quietly calming for the ideal environment in your home or office.



### “FOLLOW ME”

Keep your remote close to you and let the “Follow Me” mode measure the air temperature around you. This allows for cool air to be delivered directly to your position in an effortless way.

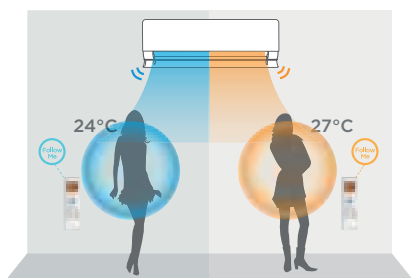

### ON UNIT LED DISPLAY

The LED display illuminates at the center of the unit so you'll always know what temperature is set.



### QUIETER OPERATION

Operating as quiet as 21dB allows you to rest peacefully and maintains a calm ambience in your spaces. The only sound that's heard, is the cool air circulating the room.

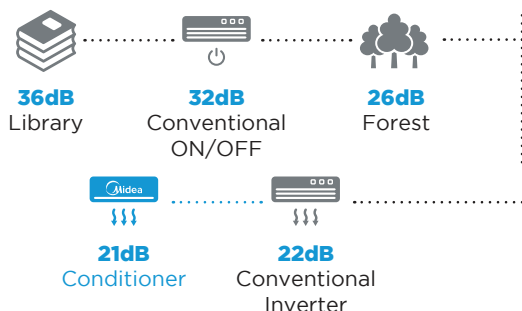

### SLEEP MODE

Keeping with the theme of ultimate comfort, sleep mode adjusts the room temperature after you've fallen asleep to make sure you're not too cold. By doing this, it also saves energy.



## INTELLIGENTIZE In Built Innovation



### Control Your AC, Anytime and Anywhere WIFI Control

Wherever you are, you can keep your home comfortable using the Midea SmartHome App.

Start up your air conditioner on the way home to enjoy crisp, cool air the moment you walk in the door. The possibilities for comfort and convenience are endless.

|                            |                                     |                         |                        |                |                |                |
|----------------------------|-------------------------------------|-------------------------|------------------------|----------------|----------------|----------------|
| Internal Unit Code         |                                     |                         | MSEPB0-09HRFN8         | MSEPB0-12HRFN8 | MSEPC0-18HRFN8 | MSEPD0-24HRFN8 |
| External Unit Code         |                                     |                         | MOX330-09HFN8          | MOX330-12HFN8  | MOX430-18HFN8  | MOX430-24HFN8  |
| Maximum Cooling Capacity   |                                     |                         | 13,000 Btu             | 14,510 Btu     | 21,000 Btu     | 29,000 Btu     |
| Maximum Heating Capacity   |                                     |                         | 15,000 Btu             | 15,500 Btu     | 23,100 Btu     | 32,415 Btu     |
| Power Supply               |                                     |                         | Monofase 220-240V 50Hz |                |                |                |
| Cooling                    | Cooling Capacity                    | kW<br>(Min-Nom-Max)     | 1,31-2,73-3,81         | 1,31-3,52-3,96 | 3,75-5,57-6,13 | 2,11-7,03-8,21 |
|                            | Absorbed Power                      | W<br>(Min-Nom-Max)      | 130-600-1200           | 130-880-1250   | 587-1318-1787  | 420-1760-3200  |
|                            | Current                             | A<br>(Nom)              | 2,6                    | 3,8            | 5,7            | 7,7            |
|                            | Theoretical Load (PdesignC)         | kW                      | 2,6                    | 3,5            | 5,3            | 7,0            |
|                            | SEER                                |                         | 8,6                    | 8,5            | 8,5            | 8,5            |
|                            | Energy Efficiency Rating            |                         | A+++                   | A+++           | A+++           | A+++           |
|                            | Annual Energy Consumption           | kWh/A                   | 106                    | 144            | 220            | 288            |
| Heating                    | Heating Capacity                    | kW<br>(Min-Nom-Max)     | 0,88-3,14-4,40         | 0,88-3,96-4,54 | 2,57-5,57-6,77 | 1,55-7,33-9,21 |
|                            | Absorbed Power                      | W<br>(Min-Nom-Max)      | 120-690-1400           | 120-990-1450   | 943-1500-1695  | 300-1975-3100  |
|                            | Current                             | A (Nom)                 | 3,0                    | 4,3            | 6,5            | 8,7            |
|                            | Theoretical Load (PdesignH)         | kW                      | 2,5                    | 2,5            | 4,3            | 5,5            |
|                            | SCOP                                |                         | 5,1                    | 5,1            | 5,4            | 5,3            |
|                            | Energy Efficiency Rating            |                         | A+++                   | A+++           | A+++           | A+++           |
|                            | Annual Energy Consumption           | kWh/A                   | 686                    | 686            | 1400           | 1666           |
|                            | Temperature Operating Limit (Tol)   | °C                      | -15                    | -15            | -15            | -15            |
| Energy Efficiency          | E.E.R./C.O.P.                       | W/W                     | 4,54/4,55              | 4,00/4,00      | 4,22/3,71      | 4,00/3,71      |
| Indoor Unit                | Dimensions (W-D-H)                  | mm                      | 795-225-295            | 795-225-295    | 965-239-319    | 1140-275-370   |
|                            | Net Weight                          | Kg                      | 10,2                   | 10,2           | 12,3           | 20,0           |
|                            | Packaging dimensions (W-D-H)        | mm                      | 870-370-305            | 870-370-305    | 1045-400-325   | 1230-355-455   |
|                            | Gross Weight                        | Kg                      | 13,0                   | 13,0           | 16,4           | 25,3           |
|                            | Air Flow (Min-Med-Max)              | m³/h                    | 280-360-530            | 290-380-560    | 400-580-685    | 379-724-1092   |
|                            | Sound Pressure (Min-Med-Max)        | dB(A)                   | 21,5-32-39             | 22-33-40       | 23-35-41       | 33-40-44,5     |
|                            | Sound Power (Min-Med-Max)           | dB(A)                   | 58                     | 59             | 59             | 65             |
| Outdoor Unit               | Dimensions (W-D-H)                  | mm                      | 805-330-554            | 805-330-554    | 890-342-673    | 890-342-673    |
|                            | Net Weight                          | Kg                      | 28,4                   | 28,4           | 38,8           | 45,6           |
|                            | Packaging dimensions (W-D-H)        | mm                      | 915-370-615            | 915-370-615    | 995-398-740    | 995-398-740    |
|                            | Gross Weight                        | Kg                      | 31,0                   | 31,0           | 41,9           | 48,8           |
|                            | Air Flow                            | m³/h                    | 2200                   | 2200           | 3500           | 3500           |
|                            | Sound Pressure (Max)                | dB(A)                   | 57                     | 57,5           | 56             | 58,5           |
|                            | Sound Power (Max)                   | dB(A)                   | 64                     | 65             | 65             | 68             |
| Refrigerant Circuit        | Compressor Type                     |                         | ROTARY                 | ROTARY         | ROTARY         | ROTARY         |
|                            | Piping Connection - Liquid          | mm                      | 6,35                   | 6,35           | 6,35           | 9,52           |
|                            | Piping Connection Gas               | mm                      | 9,52                   | 9,52           | 12,7           | 15,88          |
|                            | Pre-Charged Pipe Length             | m                       | 5                      | 5              | 5              | 5              |
|                            | Maximum Pipe Length                 | m                       | 25                     | 25             | 30             | 50             |
|                            | Additional Refrigerant Charge       | g/m                     | 12                     | 12             | 12             | 24             |
|                            | Maximum Level Difference            | m                       | 10                     | 10             | 20             | 25             |
| Refrigerant                | Refrigerant Type                    |                         | R32                    | R32            | R32            | R32            |
|                            | GWP                                 |                         | 675                    | 675            | 675            | 675            |
|                            | Refrigerant Charge                  | Kg                      | 0,69                   | 0,69           | 1,10           | 1,50           |
|                            | Emmissions CO <sub>2</sub>          | Ton                     | 0,466                  | 0,466          | 0,743          | 1,013          |
|                            | Test Pressure (High Side/ Low Side) | MPa                     | 4,3/1,7                | 4,3/1,7        | 4,3/1,7        | 4,3/1,7        |
| Electrical Characteristics | Main Power Supply                   |                         | External Unit          | External Unit  | External Unit  | External Unit  |
|                            | Indoor-Outdoor Unit Connection      | n° Conductors           | 4P + Earth             | 4P + Earth     | 4P + Earth     | 4P + Earth     |
|                            | Maximum Absorbed Power              | W                       | 2300                   | 2300           | 2800           | 3700           |
|                            | Maximum Current                     | A                       | 10,0                   | 10,0           | 12,2           | 16,8           |
| Operation Temperature      | Indoor Temperature                  | Cool.(Min-Max) °C B.U.  | +16 - +32              | +16 - +32      | +16 - +32      | +16 - +32      |
|                            |                                     | Heat. (Min-Max) °C B.S. | 0 - +30                | 0 - +30        | 0 - +30        | 0 - +30        |
|                            | Outdoor Temperature                 | Cool.(Min-Max) °C B.S.  | -15 - +50              | -15 - +50      | -15 - +50      | -15 - +50      |
|                            |                                     | Heat. (Min-Max) °C B.U. | -20 - +24              | -20 - +24      | -20 - +24      | -20 - +24      |

