

SRPMT

USER MANUAL

Dear customers;

Congratulations and thanks for purchasing our product. We wish you good and safe riding at all time.

This manual should be considered a permanent part of the dirt bike, and should remain with the dirt bike when it is resold.

This publication includes the latest production information available before printing. **Throne Cycles** reserves the right to make changes at any time without notice and without incurring any obligation.

No part of this publication may be copied, translated, reproduced, or transferred without written permission from **Throne Cycles**. The dirt bike pictured in this manual may not match your actual dirt bike.

To ensure your safety and riding pleasure, please

- Read this manual carefully
- Follow all recommendations and procedures contained in this manual.
- Pay close attention to safety messages contained in this manual and on the dirt bike.

To protect your property, we highly recommend you take responsibility for keeping your dirt bike well-serviced and maintained. Also, observe the break-in guidelines and always perform the pre-ride inspection and other periodic checks in this manual. Your safety, and the safety of others, is very important. Operating this vehicle safely is an important responsibility.



CONTENTS

1 General Information

- 1.1 Vehicle Identification Number (VIN) & Motor Number
- 1.2 Degrees of risks and symbols
- 1.3 Transport and Storage
- 1.4 Illustration of vehicle parts.
- 1.5 Technical Specifications

2. Vehicle Safety

- 2.1 Safety Guidelines
- 2.2 Before riding
- 2.3 Pre-ride inspection
- 2.4 Safety information regarding battery and charger
- 2.5 Safety information regarding the use
- 2.6 Safety information regarding maintenance and repairs
- 2.7 California Proposition 65 Warning

3. Operation Guide

- 3.1 Quick Installation Guide
- 3.2 Ride preparation
- 3.3 Starting and operating
- 3.4 ABS (Anti-Lock Brake system)
- 3.5 How to charge

4. Maintenance Guide

- 4.1 Torque Management
- 4.2 Checking before and after every ride
- 4.3 Cleaning

5. Troubleshooting

6. Warranty Policy

7. Appendixes

- 7.1 Regular Maintenance Record Card
- 7.2 Maintenance record card

1 Introduction

1.1 Vehicle Identification Number (VIN) & Motor Number

- The VIN is a 17-digit number stamped on the head tube of the frame. Do not alter or remove this number as it is the legal identifier for your electric dirt bike.
- The motor number is stamped on the motor enclosure.

1.2 Degrees of risks and symbols

You will find important safety information in a variety of forms, including:

- Safety labels on the vehicle
- Safety Messages preceded by a safety alert symbol and one of three signal words: DANGER, WARNING, or CAUTION. These signal words mean

DANGER: Identifies a danger that will immediately and invariably lead to fatal or serious permanent injury if the appropriate measures are not taken.

WARNING: Identifies a danger that is likely to lead to fatal or serious injury if the appropriate measures are not taken.

CAUTION: Identifies a danger that may lead to considerable machine and material damage if the appropriate measures are not taken.

1.3 Transport and Storage

Transport

- Move the dirt bike onto a horizontal trailer with sufficient capacity and the ability to stabilize both wheels and/or the frame.
- Use adequate cargo straps around the forks and over the lower triple clamp to each side of the trailer to secure the bike against shocks.
- Make sure the clamping straps are tightened properly and there is no possibility of sudden movements and or instability.
- Make sure to observe the weight distribution in accordance with the trailer specifications

CAUTION:

- When moving the dirt bike for riding or service, do not attempt to lift the dirt bike alone to avoid any injury or damage to the dirt bike.
- It is recommended to have the proper protection for the dirt bike and movers at all times when moving and lifting the dirt bike. Stay away from sharp and moving parts of the dirt bike when moving the dirt bike, including but not limited to wheels, handlebars, gears, chains, footpegs, and any other parts that may hurt.

CAUTION:

- Make sure that the battery charge is between 30% and 50%.
- Check the charge of the battery regularly. If the charge drops below 30%, recharge the battery to 50%.
- Store the bike in a dry area free from frost.
 - 1 Discharge the battery to 30%.
 - 2 Recharge it to 50% to balance the cells.
 - 3 Disconnect the charger

DANGER:

- **Risk of injury or death!** Do not use the product if the battery pack is damaged. When the battery pack is damaged, it may present a fire hazard.
- **Risk of explosion!** The battery and the charger must be dry before operation. Dry the battery and the charger with a soft cloth.
- Do not charge or use a battery that is damaged. If the battery is damaged, it must be discarded immediately.
- **Risk of damage!** After charging, the charger must be disconnected from the bike and the AC power socket immediately.
- Always charge and store the battery in a dry environment.
- Do not charge a battery at temperatures below (40°F).
- Do not charge a battery that has been exposed to seawater.
- Do not charge the battery with charger cables that may be damaged.
- Do not charge the battery near flammable materials.
- Do not leave the battery unattended while charging.
- If the product appears to be bulging or shows other undesirable phenomena (e.g. excess noise), stop using the product immediately.
- Do not cover the product while charging the battery. Charge the product in a well-ventilated environment.
- Batteries produce heat when charging and discharging. If the product becomes too hot to touch, switch the product off and unplug immediately.
- If the battery leaks avoid contact with skin and eyes. Rinse affected areas immediately with plenty of clean water, then consult a doctor.

1.4 Illustration of vehicle parts.

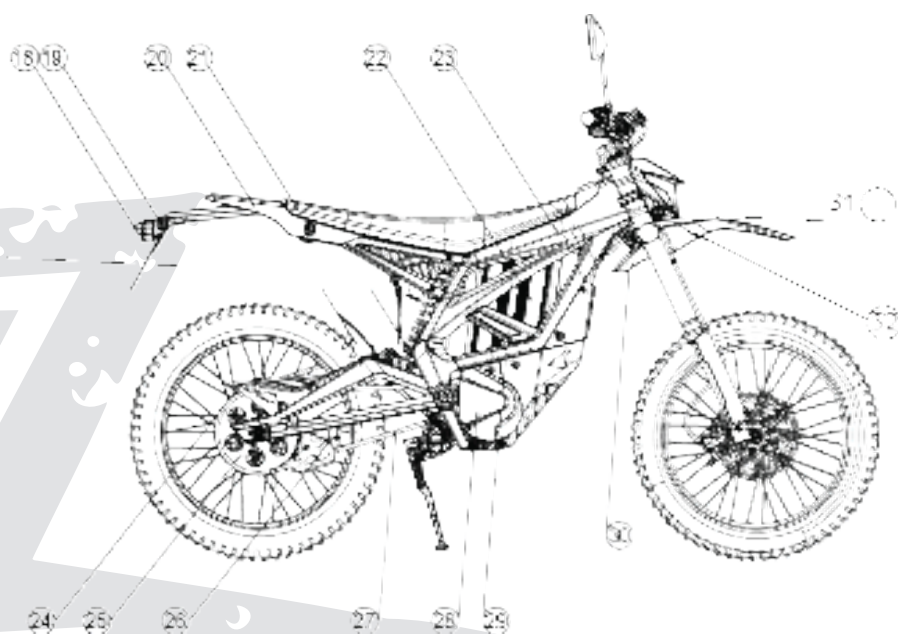
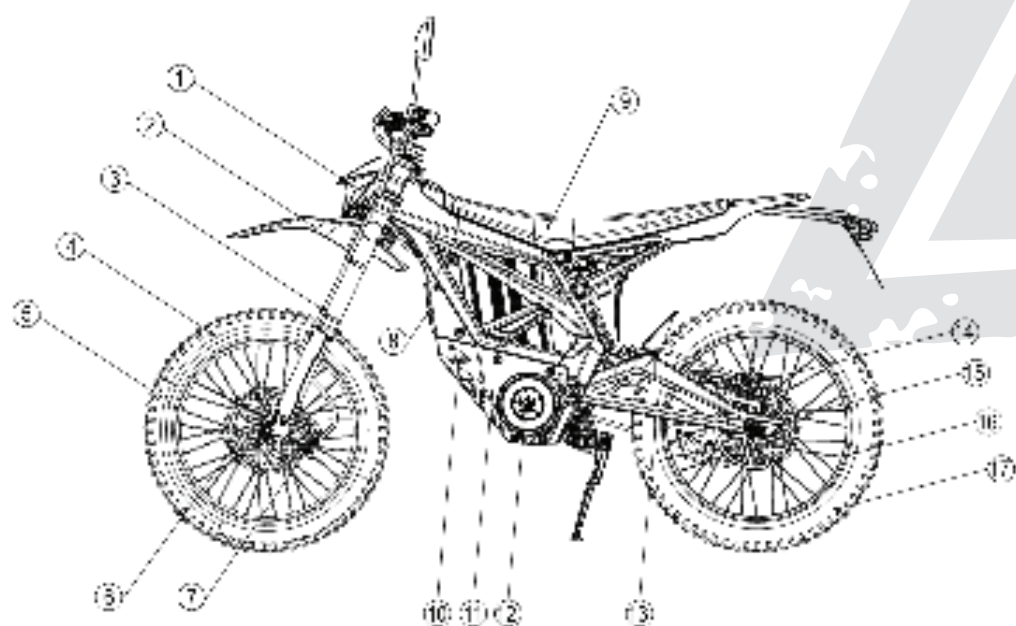

1.- HEADLIGHT	2.- FRONT MUDGUARD	3.- FRONT FORK	4.- FRONT TIRE	5.- FRONT RIM	6.- FRONT DISC BRAKE
7.- FRONT BREAK PUMP	8.- CONTROLLER	9.- SEAT	10.- LOGO LIGHT	11.- SKIT PLATE	12.- MOTOR
13.- REAR FORK	14.- REAR BRAKE PUMP	15.- REAR DISC BRAKE	16.- REAR TIRE	17.- REAR RIM	18.- REAR LIGHT
19.- TURN SIGNAL (REAR)	20.- REAR FENDER	21.- SEAT LOCK	22.- BATTERY	23.- FRAME	24.- CHAIN PROTECTOR
25.- CHAIN PLATE	26.- CHAIN GUIDE	27.- CHAIN	28.- MOTOR PROTECTOR	29.- FRAME LIGHT	30.- STEERING LOCK



No	Function
1	Speed
2	Energy recovery
3	Current
4	Power percentage
5	Trip
6	ODO
7	Steering indication
8	Controller
9	Undervoltage indication
10	Steering hand a fault
11	Brake fault
12	Motor fault
13	Fault code display
14	Low battery indicator
15	High beam indicator
16	Gear indication



22-1	Charge port
22-2	Discharge port
22-3	Power indicator light
22-4	Power button
22-5	Exhaust valve

1.5 Technical Specifications

ITEM	PARAMETER
Overall Vehicle Weight	160 Lb.
Carrying Capacity	300 Lb.
Rear Shock/Wheel Travel	76/190mm
Max. Torque	460 N.M.
Acceleration	0-40 MPH / 3.7s
Charging Time	3.5 hrs
Max Climbing Angle	45 Degrees
Front Tire	70-100/19
Rear Tire	80-100/19
Charger	84V 9AH
Front Rim	19 x 1.40
Rear Rim	19 x 1.60
Battery	72V 40AH
Max Power	10,000 Watts
Max Speed	55-60 Miles
Range	80 Miles
Ground Clearance	10.5 IN
Wheel Base	50 IN
Dimensions	75 IN x 32 IN x 45 IN
Front Fork Travel	200 MM
Frame	Treated Alloy

2. Vehicle Safety

DANGER: Read and understand this manual and its safety instructions before using this product. Failure to do so can result in serious injury or death.

2.1 Safety Guidelines

- Always Wear a Helmet and protective apparel. [**Danger:** Risk of injury or death!]
- Never ride the bike under the influence of alcohol or drugs.
- Never ride the bike on public roads.
- Keep your vehicle properly maintained and in safe riding condition. Inspect your vehicle before every ride and perform all recommended maintenance. [**Danger:** Risk of injury or death!]
- Never permit a guest to ride your electric dirt bike without proper instruction.
- Prior to each use the rider must check everything carefully, and the charge level of the batter pack as indicated on the battery pack display or dash display charge indicator.
- Repairs shall only be done by a qualified and trained technician who is familiar with repairing similar products. [**Danger:** Risk of damage!]

WARNING: Inspect the packaging and product for any damages, before assembling the product. If there are any damages, contact us.

2.2 Before riding

- Make sure the dirt bike is in perfect condition.
- Please use the dirt bike in accordance with local regulations.
- Make sure you are trained for riding a dirt bike and know all its control functions.
- Do not overweight.
- Make sure that you and any passenger always wear an approved helmet and protective apparel.
- Make sure that you are physically fit, mentally focused, and free of alcohol and drugs

WARNING:

- Overloading or improper loading can cause a crash and you can be seriously hurt or killed. Follow all load limits and other loading guidelines in this manual.
- The product is not intended for use by persons (including children) with restricted physical, sensory or intellectual capability or lack of experience and/or knowledge.

2.3 Pre-ride inspection

Brake: Check the brake for proper function. When you squeeze the lever, the brake should provide positive braking action. When you apply the brake with the speed control on, the brake cut-off switch will stop the motor.

Tire : Check tire pressure and wear regularly, and inflate or replace tires as needed.

Chain: Check the chain tension and condition, adjust or replace if necessary.

Battery pack: Check that the battery level displayed on the battery pack or dashboard is sufficient enough to support your riding. It is highly recommended that to fully charge before your next trip.

Electric system: Check whether the lights, display, throttle and horn are functioning properly.

2.4 Safety information regarding battery and charger

Danger:

- Risk of injury or death! Do not use the product if the battery pack is damaged. When the battery pack is damaged, it may present a fire hazard.
- Risk of explosion! The battery and the charger must be dry before operation. Dry the battery and the charger with a soft cloth.
- Risk of explosion! Do not charge or use a battery that is damaged. If the battery is damaged, it must be discarded immediately.
- Risk of damage! After charging, the charger must be disconnected from the bike and the AC power socket immediately.
- Always charge and store the battery in a dry environment.
- Do not charge a battery at temperatures below 4°C (40°F).
- Do not charge a battery that has been exposed to seawater.
- Do not charge the battery with charger cables that may be damaged.
- Do not charge the battery near flammable materials.
- Do not leave the battery unattended while charging.
- If the product appears to be bulging or shows other undesirable phenomena (e.g. excess noise), stop using the product immediately.
- Do not cover the product while charging the battery. Charge the product in a well-ventilated environment.
- Batteries produce heat when charging and discharging. If the product becomes too hot to touch, switch the product off and unplug immediately.
- If the battery leaks avoid contact with skin and eyes. Rinse affected areas immediately with plenty of clean water, then consult a doctor.

2.5 Safety information regarding the use

Racing

- Racing always contains potential safety hazards, no matter how professional or well-trained a rider is.

Parking

- Always Park the dirt bike on a firm, level, and safe surface with 4 easy access for the rider

Parking procedures.

To park: 1. Stop the motor.

2. Step down the side stand.

3. Slowly lean the dirt bike to the side stand until it's firmly stood.

4. Turn the handlebar fully in the same direction as the side stand.

5. Lock the dirt bike and remove the key.

- If you must park on an uneven or loose surface, park firmly so that the dirt bike cannot move or fall.

- Do not touch the motor, battery, brakes, and other parts that may get high temperatures during the ride.

- Always lock the handlebar and remove the key from the dirt bike (All-Terrain Bike) to reduce the chance of theft or start-up by accident. We recommend you use other anti-theft devices as well.

- This dirt bike (All-Terrain Bike) is an electric offroad all-terrain bike with many electrical parts. Avoid submerging parts and the bike in water. Also, avoid prolonged exposure of parts and components to water or rain.

2.6 Safety information regarding maintenance and repairs

Danger:

- **Risk of injury or death!** Use only original parts. These parts have been tested and approved by the manufacturer. Under no circumstances should you try to replace the components such with components of another brand, at the risk of causing irreversible damages to your product. The manufacturer does not assume any responsibility for the adaptation of unapproved parts.

- **Risk of injury or death!** The high voltage components on the dirt bike should only be serviced by specially trained technicians. Do not probe, tamper with, cut, or modify high voltage cables or wiring.

- **Risk of injury or death!** Alterations to the product and technical modifications are not permitted. Failure to do so may result in damage or severe or fatal injuries and it will invalidate the warranty.

- **Risk of injury!** Always turn the **SRPNT** off completely before performing any cleaning or maintenance tasks.

- **Risk of damage!** Repairs shall only be done by a qualified and trained technician who is familiar with repairing similar products.

2.7 California Proposition 65 Warning

WARNING:

• California Proposition 65

Lithium-ion batteries and products that contain lithium-ion batteries can expose you to chemicals including cobalt lithium nickel oxide, and nickel, which are known to the State of California to cause cancer and birth defects or other reproductive harm.

• California Perchlorate Advisory

Certain components of this dirt bike such as lithium batteries may contain perchlorate material. Special handling may apply for service or end of life disposal.



1. Use the Hexwrench (#4) to loosen the bolts on the brakes.

2. Fix the brakes on the handlebar by tightening bolts with the hexwrench (#4).

• Switch installation (Left)



1. Use the hexwrench (#5) to loosen the bolts on the switch.

2. Fix the switch on the handlebar by tightening bolts with the Hexwrench. (Note: there is a location hole must be in place.)

Front fender installation



• Pegs installation

1. Fix the front fender on the connection board under the direction column.

2. Tighten the bolts with the hexwrench (#5).

Right Footrest Installation

1. Put the pegs at the installation position
2. Using #14 open wrench to tighten the installation nuts of the pegs

• Front wheel installation

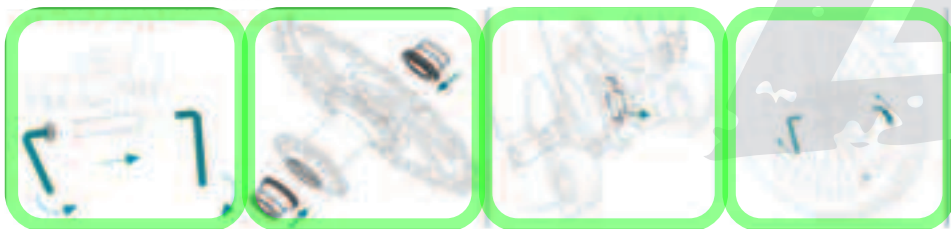

1. Use the Hexwrench (#5) to loosen 4 front axle locking bolts at the lower end of the front fork.
2. Use the Hexwrench (#8) to loosen the bolts locking front axle, then give it taps with a rubber mallet to get off the front axle.
3. Take out brake caliper clamp block, take the front tire into the installation position of the front fork (please make sure the front tire mounting will be well matched with the disc brake's clipper).
4. Insert the front tire axle, make sure the axle will go through the front tire and fork.
5. Use the Hexwrench (#8) to tighten the front tire axle.
6. Use the Hexwrench (#5) to tighten the 4 front axle locking bolts at the lower end of the front fork.

• Battery installation



1. Open the seat by key, get off the seat.



2. Place the battery from the top and pay attention to the front and rear direction of the battery (the charging socket is on the left of the vehicle body).

(The same situation when you receive it.)

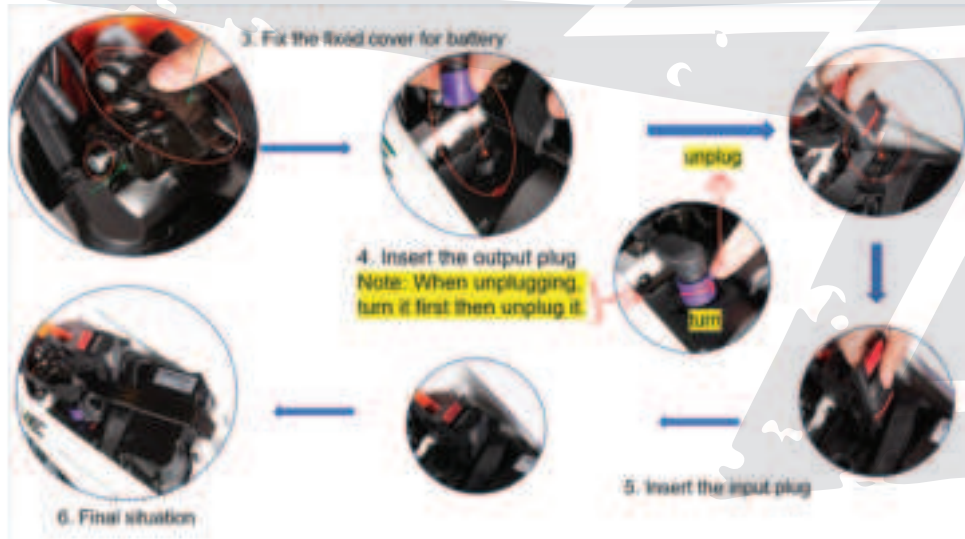

• Rear view mirrors installation



1. Get off the plastic covers for bolts, loosen the bolts with the open wrench (#14).
2. Install the mirrors on both ends of the handlebar with the proper angle. Tighten the bolts.

• Turn signals installation (Front)



1. Install the turn signals in place by tightening the bolts with the Phillips screwdriver (2 bolts per side.)

1. Tires are in good condition, with no abnormalities.
2. Normal tire pressure is 200 ~ 220Kpa. If the tire pressure is not enough, it will be abnormal wear, steering, low riding speed, short range; tire pressure is too high will lead to tire tread local abnormal wear, tire adhesion is reduced, riding comfort is reduced, and even a blowout, causing safety risks.

Check the handlebars The handlebars need to be tightened without wobbling, flexible steering, no interference, and no strange noise.

Shock absorber adjustment: Shock absorber adjustment: Please adjust the front and rear shock absorbers to meet your riding needs according to the actual situation.

Chain: Check the chain tension and condition, adjust or replace if necessary.

Battery pack: Check that the battery level displayed on the battery pack or dashboard is sufficient enough to support your riding. It is highly recommended that to fully charge before your next trip.

Electric system:

Check the LCD meter, horn, and brake:

1. Check whether the function display of each part of the instrument is normal.
2. Check whether the horn is working normally.
3. Hold the front, and rear brake handles respectively, and check whether the front and rear brakes are braking normally and whether the front and rear wheels are working normally.

Key Switch

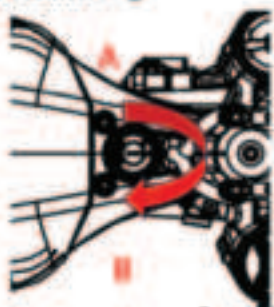

This is a two-position switch located on the right side of the dashboard. The functions listed below:

OFF A

ON B

OFF position

This position is to turn off the electric dirt bike, thereby turn off all the electrical system. The key can also be removed from this position.

ON position

This position is to turn on the electric dirt bike. The following changes occur when switch to this location:

Display ON

Headlight ON

Operate Key Switch:

1. Insert the key into the key switch and turn clockwise to switch the key from OFF position to ON position, then start the electric dirt bike.
2. When the electric dirt bike is started, turn the key counterclockwise to switch the key from ON position to OFF position, then the electric dirt bike is turned off.

CAUTION: Remove the key immediately after twisting the key switch and safety park the dirt bike to prevent the vehicle been stolen.

Steering lock

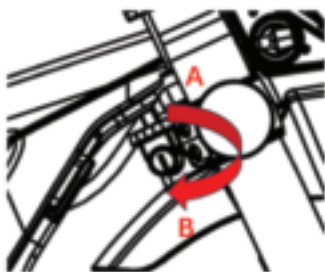

This is a two-position switch located on the back side of the lower triple clamp. The function is as follows:

Lock A

Unlock B

Lock Steering Lock:

1. Turn the handlebar to the left till the limit.
2. Lock the electric dirt bike by inserting the key into the steering lock and turn it clockwise.
3. Remove the key.

Unlock Steering Lock:

1. Unlock the electric dirt bike by inserting the key into the steering lock and twisted it counterclockwise.
2. Remove the key

CAUTION: Lock the steering lock after parking the dirt bike to prevent unauthorized use or been stolen.

Seat lock

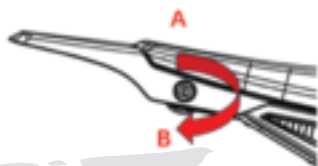

WARNING:

- Please make sure to wear a helmet and other protective gear. For your safety, please choose a full-covered off-road helmet and off-road protective equipment.
- Please do not let other people who are not familiar with the electric dirt bike ride.

3.4 Starting and operating

1. Insert the key into the electric lock hole and rotate clockwise to power it.
2. Check whether the switches, instruments, horn, front and rear brakes are working properly.
3. Before the vehicle starts: get on the bike and sit firmly, collect the side stand. Then press the "start" button.

WARNING: Acceleration must be smooth and gentle. Do not over operate to avoid danger or damage to the dirt bike. Make sure first-time riders use ECO mode. Only use HIGH mode after becoming fully familiar with the dirt bike.

4. Turn the speed control handle slowly, inward for acceleration, outward for stopping acceleration.
Note: You need to release the brake handle when accelerating, otherwise it will trigger the brake power-off function.
WARNING: Please operate the brake handle according to the actual situation and gradually increase the force. To prevent the wheel from locking and slipping and resulting in injury, do not grip it suddenly. Try to pre-judge and avoid sharp braking, hard steering, and other operations that can easily cause side slips and falls. It is especially dangerous when the road is slippery in the rain.
5. Parking:
 - When the throttle is in the closed position, press the motor stop switch to the closed position.
 - Put side stand down in case of the vehicle tilt over.
 - Turn the key switch to the off position and remove the key, and keep it in a safe place.
 - Lock the parking brake to prevent the dirt bike from moving due to the gradient.

WARNING:

- when parking (before leaving the dirt bike), please make sure to stand the side bracket, enter the P-gear parking function, and ensure the dirt bike has lost power to avoid touching the speed control handle and causing accidents.
- Do not drive in bad weather or when extremely tired. And do not wade deeply into the water, otherwise the battery will be damaged or cause personal injury.
- Please do not attach or tow other vehicles or bikes.

3.5 ABS (Anti-Lock Brake system)

WARNING:

- The ABS anti-lock braking system maximizes the braking efficiency in emergency situations and the safety during riding. Under certain conditions, ABS can shorten the braking distance, but it cannot be replaced by good riding habit and skills.
- Please ride safely follow the local traffic rule and regulations and respect the legal speed limit on the road.
- Ride cautiously when turning. If you braking while turning, ABS may not be able to offset the centrifugal force of inertia, such activities will cause unsafe riding and easily cause accidents.
- Certain riding conditions and environments may reduce the braking efficiency of ABS and make its braking distance longer or even similar to the dirt bike without ABS.

ABS Switching ON/OFF conditions

1. The electric dirt bike is powered on;
2. The speed of the front and rear wheels of the dirt bike is zero;
3. The electric dirt bike is not in diagnostic mode.

ABS operation method

1. After turn the key switched ON, ABS is turned on by default.
2. When the ABS is in the OFF condition, the ABS indicator flashes slowly, when the ABS is in the ON condition, the ABS indicator is off.
3. When the ABS button is pressed for more than 3 seconds and not released within 5 seconds, the ABS ON/OFF switch request will be ignored and the ABS keeps the current state.
4. When the ABS button is pressed for more than 30s, the ECU of the ABS treats the switch signal as a fault signal, and the ABS returns to default ON state, the ABS indicator illuminate. The ABS can only be turned off after the power is switched OFF and ON again.

Disable ABS

1. In the parking state, put down the side stand.
2. Place the motor stop switch in the OFF position.
3. Turn the key to the ON position.
4. Press and hold the ABS button for 3 seconds and released within 5 seconds, now all ABS functions are turned off, and the ABS indicator flashes slowly,

Reactivate ABS

1. Every time the key switch is turned ON, the ABS system is activated by default.
2. Activating and deactivating the ABS system are the same operations, which can restore the ABS system from the OFF state to the ON state.

WARNING: When ABS is disabled, the electric dirt bike will be able to operate as a dirt bike without ABS function, and the braking distance may increase.

CAUTION: When the ABS system is disabled, the ABS Indicator will continue to flash slowly.

ABS indicator

1. When the ABS system detects a fault, the ABS fault indicator will illuminate. If the fault is eliminated, the ABS indicator will disappear when the dirt bike speed reaches 5km/h in the current states or turn on the key switch and reaches the speed of 5km/h next time.
2. When the ABS is in the ON mode and the speed of the electric dirt bike reaches 5km/h, the ABS indicator light goes out.
3. When the ABS is in the OFF mode, the ABS indicator flash slowly.
4. When the ABS button is been pressed, the ABS indicator flash rapidly, but when the ABS button is pressed and hold for more than 30seconds, the ABS indicator always on.
5. When the ABS is in the diagnosis mode, the ABS indicator is on.

WARNING:

- ABS indicator flash slowly with frequency of 1time per second, flash rapidly with frequency of 2 times per second.

- When the electric dirt bike exceeds 5km/h, if the ABS indicator light is still on, it indicates that the ABS system is malfunctioning, and the ABS may not work normally. Please contact the THRONE CYCLE authorized dealer or workshop for service in time.

When the ABS system is not working, the electric dirt bike will operate as a dirt bike without ABS, which may increase the braking distance and may even cause unpredictable conditions.

- ABS work requires comparing the relative speed of the front and rear wheels. Failure to use the tires specified by the manufacturer may affect the ABS functions and also the braking distance of the dirt bike.

- If the speed of the front and rear wheels is greatly different, experience a wheel damaged accident or offroad riding, the ABS indicator will light up and ABS will be disabled.

3.6 How to charge

Charging and Charger information

Charge the whole dirt bike

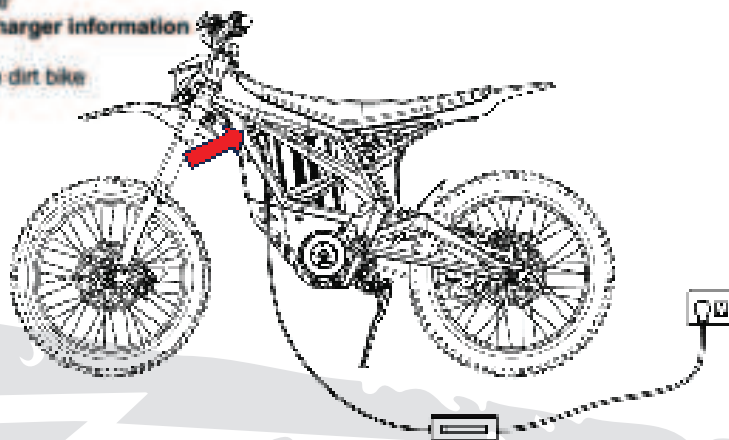

CHARGE THE BATTERY

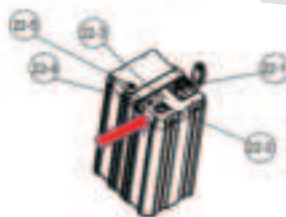

- Only charge the **SRVAT** battery pack with the approved **SRVAT** accessory charger. Any other unapproved chargers may cause damages to the battery pack, and lead to serious hazards.

- Check the charger to make sure the input voltage marked on the charger is correct for the local power supply voltage (AC 110V / AC 220V).

- **Caution:** When you charge the battery pack, firstly please connect the DC input connector with the battery pack charging interface. Then, connect the AC power cord with the power supply socket. Once the battery pack is fully charged, please disconnect the AC power cord. Once the indicator is extinguished, disconnect the DC input connector.

- When the battery pack is charging, the red indicator will twinkle. Once the battery pack is fully charged, the green indicator will remain on. Usually, it will take about 4 hours to fully charge the battery pack.

- Once the battery pack is fully charged, the charging will shut down automatically. However, in consideration of safety, we suggest you disconnect the AC power cord from the power supply socket within 6 hours after the battery pack is fully charged.

- Unqualified or unskilled people should not disassemble the battery pack, as damage may be caused to the battery pack leading to serious hazards.

- When the battery pack is inactive, you can activate it via the activation button on the battery pack or by connecting the charger.

CAUTION:

- Please ensure children are not able to reach the battery pack while charging. • Once the battery pack has finished discharging, it will have a high internal temperature. Please do not charge the battery pack immediately. Before charging, it is suggested to cool down the battery pack in a well-ventilated place for 30 minutes.

- We suggest allowing the battery pack to rest for 10 minutes before use, after being charged.

- Please ensure the battery pack is not covered while charging. The charger is designed for use in-doors, and the charger should be used and stored in a dry, ventilated place.

- If there is a strange smell, the temperature becomes too high while charging, or another issue arises that prevents the battery from being fully charged, please stop charging immediately and send the battery pack to the qualified maintenance store for checking.

4. Maintenance Guide

In order to keep your dirt bike in good condition it must be inspected and maintained at regular intervals.

4.1 Torque Management

Check regularly and tighten the following fasteners on the electric dirt bike according to the specified torque.

1. Put the dirt bike on the support stand to lift the front wheel off the ground;
2. Loosen the steering tube lock nut and the front fork lock bolt on the upper triple clamp;
3. Tighten the steering tube adjusting nut to 20N.m and then loosen it by 1/4 turn;
4. Tighten the steering tube locking bolts and the front fork mounting bolts on the upper triple clamp;
5. Check whether the handlebar turns smoothly or not and repeat the above operation if necessary.

Note: Steering tube lock nut adjustment method.

Recommended torque for installation of important parts

No.	Installation Location	Recommended torque
1	Front wheel axle fastening	25-30N.m
2	Switch lock cover fastening	3-5 N.m
3	Rear wheel sprocket fastening	18-20 N.m
4	Front and rear wheel disc fastening	5-7 N.m
5	Front and rear brake caliper fastening	7-9 N.m
6	Tension wheel fastening	18-20 N.m
7	Tension arm fastening	20-22 N.m
8	Side stand fastening	30-35 N.m
9	Motor fixing fastening	20-22 N.m
10	Rear fork fastening	55-65 N.m
11	Rear shock absorber fastening	40-45 N.m
12	Rear tail stock fastening	18-20 N.m
13	Rear wheel axle fastening	60-70 N.m
14	Handle bar fastening	7-9 N.m
15	Steering column slotted nuts	3-5 N.m
16	Steering column cap nuts	40-45 N.m

4.2 Checking before and after every ride

In principle, with normal riding, you can do the first check at 10-30Km (can also be understood as the first warranty).

Inspection content.

1. front and rear wheel wire spokes tightness.
2. whether there is a gap in the front steering column bearing.
3. chain tightness check.
4. Tension wheel check (whether the chain is in the tension wheel guide groove).
5. Check whether the shock absorber is leaking oil and whether the compression and rebounds are in the correct position; (Note: Do not screw the adjustment knob to the left or right in the adjustment process).
6. Check the tightness of the screws fixing the handlebars.

Special Note: Be sure to turn the power off before starting any maintenance.

Pay full attention to safety when checking.

1. choose a wide and flat place and park the vehicle.
2. when it is necessary to drive for the inspection, do it in a safe place while paying attention to the surrounding environment and situation.
3. If the inspection finds any abnormality, please only drive after eliminating the abnormality, and if you cannot solve the problem by yourself, please contact the after-sales service or designated authorized service outlet.

4.3

1. front and rear brakes are disc brakes. The brake friction pad should be replaced before it becomes seriously worn.

2. Pay attention to the cleanliness of the disc brake system in daily use to avoid prolonged adhesion of mud and sand, especially to avoid oil pollution.

Inspection of operating parts

1. Check if the shock absorber is bent, deformed, or damaged.

If the front shock absorber is damaged or leaking oil, shake the handlebar up and down to check if the front shock absorber causes any abnormal sound.

2. Brake inspection

Check whether the free gap of the brake handle is within the specified range (15-30mm), and adjust it if it does not meet the requirement after measurement.

3. Inspection of braking effect

Please check the braking effect by riding at low speed on a dry and flat road, and use the front and rear brakes separately.

4. Inspection of tires, spokes, tensioning wheels, and chains

The tires of your dirt bike (All-Terrain Bike) are in contact with the ground for a long time, and foreign objects such as stones, glass, and nails on the ground can cause damage to your tires, so you should pay attention to the road when riding and avoid riding in places that may damage your tires. In addition, you should always check whether the tires have obvious cracks and other damage, whether they are embedded with stones, glass, and other foreign objects, and whether there is unreasonable and abnormal wear.

- 1) check the air pressure with a tire pressure gauge while the tires are cool.
- 2) check for cracks, damage, and abnormal wear.
- 3) check whether the wheel rim spokes are loose.
- 4) Check the tension of the chain. Chain up and down range 10~20mm;
- 5) Check the depth of tire grooves

Check the tire wear, check the groove depth, and replace the tire when the wear amount reaches 2/3 of the bump. When there is a strange noise or fluttering in the tire ride, please contact the aftermarket or designated authorized outlets to check and repair.

Recommended: rear axle nut locking torque 40N.m, front axle nut locking torque depends on the front fork.

Note: Hold the brake handle tightly. If it still cannot give the ideal braking effect, check the disc brake pad cleanliness and thickness size. If it still cannot be solved, please contact the authorized service outlet for after-sales inspection

Battery check

1. Check the power The bike uses a sealed ternary lithium battery. Check the battery needs to be full, and then use a multimeter to measure the positive and negative voltage of the electric port. The full voltage should be between 66.2 ~ 67.2V for normal operation.

2. Check the appearance of the battery Check if it is damaged. For example, if the battery's upper and lower sealing covers and power indicator break, it will lead to the risk of water after the seal failure. Then please contact the aftermarket or designated authorized service outlets.

Note:

1. close the switch lock and air switch before taking and installing the battery, cover the charging port sealing rubber cap.

2. If you find that the battery cannot be put into the battery compartment, please do not force it in. Remove the battery to check whether the battery is stuck due to foreign objects.

3. winter battery storage, it is recommended that the battery is stored indoors, with temperature conditions above 0 ℃. Also, regularly check the power.

CAUTION:

1. Battery packs are lithium-ion systems that do not require maintenance but need to be recharged from time to time. When not in use for a long time, please charge the battery pack to about 60% ~ 80% of the power storage. You will need to check the remaining power every month. If the battery pack power drops below 30%, it should be recharged to 60%~ 80% to prevent the battery pack from losing activity, which will affect performance and cause damage.

2. The battery pack should be kept away from high temperature environments. Do not store it in high temperature environment or under direct sunlight. When not used for a long time, please store the battery pack in an ambient temperature of 10~30℃.

3. Only a service agent authorized by the manufacturer can be qualified to repair or dismantle the battery pack.

4. Dispose of the battery packs please according to your local laws. The used battery pack is encouraged to be handled and recycled by professional company or organization and not discarded at will.

Battery charging and charger use

1. The dirt bike must be charged with the original model compatible charger. Do not use other models that do not match the charger so as not to damage the battery or be dangerous.

2. Check whether the charger input voltage is consistent with the grid voltage.

3. The charger will automatically turn off when it is fully charged, but try to avoid connecting the charger to the grid for a long time. The maximum time after a full charge should not exceed 6 hours.

4. It is strictly forbidden for users to disassemble the battery to avoid damage and danger. 5. When the battery over-discharged protection has occurred, it needs to be activated by charging with the charger. The activation method is described in P35 (fault phenomenon and troubleshooting method), Article 7.

6. Use and maintenance of electrical appliances

1) regularly check the motor fixing screws for looseness.

2) regularly check the motor and controller wiring for looseness and insulation condition. 3) periodically check whether the air switch wiring is loose.

4) Do not drive in water that is too deep so as not to affect the brake friction life and motor working.

Note: When the motor temperature or controller temperature is too high, or the battery power is too low, the dirt bike (All-Terrain Bike) will automatically reduce power operation, which is not a fault.

4.3 Cleaning

1. Use a sponge or clean soft cloth, neutral detergent and water to gently clean the dirt bike.

2. Be extra careful when cleaning the dashboard, it's easier to scratch than other parts of the dirt bike.

3. After cleaning, rinse the dirt bike thoroughly with water to remove all detergent residues.

4. Dry the dirt bike with a soft dry towel.

5. After cleaning, check for damage, wear or any leakage.

After cleaning the dirt bike, please maintain the chain and other parts that need to be lubricated.

Please let all electrical components completely dry before operation. If the Ultra Bee electric dirt bike is to ridden immediately after cleaning, use the brakes several times at a safe and low speed to remove the water or other objects on the brake pads.

1. Improper cleaning can damage dirt bike parts:

Do not use high-pressure washer to flush bearings, seals, electrical components and plugs. In order to extend the service life of the Ultra Bee electric dirt bike, it should be cleaned and maintained regularly and it is recommended to wipe it dry as soon as possible after cleaning.

2. Do not use any harsh chemical products on plastic parts. Avoid using strong corrosive cleaners, solvents or thinners, fuel (gasoline), rust removers or inhibitors, brake fluid, antifreeze in contact with electric dirt bike to avoid damaging certain parts. We recommend that you carefully use the high-pressure washer to clean the electric dirt bike to avoid damaging the dirt bike parts. After cleaning and before starting to ride, make sure the brakes system function properly.

CONTROLLER ALARM CODE LIST

CODE	FAULT NAME	ACTION	REASON	SOLUTION
001	Software Over Current	Shutdown	Current Exceeds Predetermined limit	Re-Start The Bike
002	Motor Over Speed	Shutdown	Motor Speed Exceeds Predetermined limit	Re-Start The Bike
003	Battery Over-voltage	Shutdown	Battery Cell Exceeds Predetermined Limit	Re-Start The Bike
004	Key Power Abnormality	Shutdown	Key Voltage Exceeds the Set Range	Re-Start The Bike
005	12V Power Supply abnormality	Shutdown	Auxiliary Current Output	Re-Start The Bike
006	5V Power Supply Abnormality	Shutdown	5V Voltage Out Of Setting Range	Re-Start The Bike
007	Angle Sensor Disconnection	Shutdown	Motor Angle Sensor Signal Abnormal	Re-Start The Bike
008	Hardware Overcurrent	Shutdown	Current Exceeds The Hardware Protection Range	Re-Start The Bike
009	Current Closed Loop Failure	Shutdown	Motor Phase Wire Not Connected or Controller Damged	Re-Start The Bike
010	Battery undervoltage	Frequency Reduction	Battery Voltage Is Below The Predetermined Range	1. Charge The Battery 2.Replace The Battery 3.Re-Start The Bike
011	Controller Overtemperature	Frequency Reduction	Controller Temperature Exceeds Predetermined Limit	Turn Off The Bike, Wait For The Controller To Cool Down
012	Motor Overtemperature	Frequency Reduction	Motor Temperature Exceeds Predetermined Range	Turn Off The Bike, Wait For The Motor To Cool Down
013	Current Sensor Abnormal	Shutdown	Current Sensor Signal Interfered	Re-Start The Bike
014	Angle Signal Interference	Shutdown	Angle Sensor Disturbed	Re-Start The Bike
015	Turnbuckle Signal Overlimit	Shutdown	Toggle Signal Input	Re-Start The Bike
016	Turnbuckle Not Reset	Shutdown	Power-on Toggle Not in 0	To Reset The Turnbuckle, Re-start the bike
017	Motor Blocking	Frequency Reduction	Motor Block Age Exceeds Predetermined Protection Time	Re-Start The Bike
018	BMS Failure	Shutdown	Battery internal Abnormality	Re-Start The Bike
019	BMS Communication Disconnection	Shutdown	BMS Communication is Not Connected	Re-Start The Bike
021	Brake Fault	Shutdown	Brake Damaged or Controller Fault	Check The Brake, Re-start the Bike
101	Over Charge Current Error	Shutdown	Charging Current Is Higher Than The Protection Charge Current Value	Make Sure Charger for the Same Type of battery as the SRPNT.
102	Over Discharge Current Error	Shutdown		Replace The Battery
103	Battery Cells High Voltage	Shutdown		Re-Start The Bike
106	High Voltage (Main Power Cable)	Shutdown		Disable REGEN Function
108	High Temperature (Battery Pack)	Shutdown		Replace The Battery
109	Low Temperature (Battery Pack)	Shutdown		Replace The Battery

6. Warranty Policy

SRPNT dirt bike after-sales service Specific services are as follows

Warranty Rules

One-year warranty for the entire dirt bike (All-Terrain Bike); including motor, controller, battery and charger, and other difficult-to-damage parts; non-human damage performance failure, can enjoy free repair. Refer to this manual. If there is no quality problem, do not support the return of goods for exchange. If the occurrence of functional failure or commodity quality problems, the company designated authorized service outlets to test and confirm that the issue belongs to the quality of non-human caused by the commodity quality problems. Can choose to return or have the goods exchanged.

Warranty Start Date

Offline purchase users to the invoice date purchase voucher date shall prevail (calculated from the date of the first occurrence); online purchase users to the date of the sign-off sheet shall prevail (calculated from the date of the customer sign-off row). The delivery sign-off sheet and purchase invoice are valid vouchers. If there is no voucher or a scribbled voucher is unclear, the system record of the date of sale shall prevail.

The warranty does not cover: (i) any failures resulting from, or caused by lack of proper maintenance, (ii) modification, alterations and installation of parts or accessories that have not been manufactured or delivered by SRPNT as original equipment, (iii) damages due to accident, collision, abuse or neglect, (iv) damages to the paint, coatings or corrosion of metal parts due to external influences such as stones, salt, industrial exhaust gasses, inadequate cleaning with inadequate cleaning products, (v) fading of painted or metal coated surfaces or damages due to water submersion, (vi) vehicles that have been used in sporting official competition or have been used in rental services or for commercial purposes, (vii) damages caused by ordinary wear and tear, (viii) vehicles that have not been properly maintained in accordance with the prescriptions of the Owner's Manual or (ix) vehicles that have been repaired by unauthorized parties disregarding specific instructions of SRPNT.

7. Appendixes

Regular Maintenance Record Card		
Maintenance period	Maintenance requirements	Maintenance Personnel:
3000Km/1month	Whole dirt bike (All-Terrain Bike) fasteners, check chain, tension wheel tensioning check (motor, brake, spokes, etc.)	
1000Km/3months after the first warranty	Whole dirt bike (All-Terrain Bike) safety parts fastening inspection, high current circuit inspection, chain and tension wheel tensioning degree inspection motor, brake, spokes, etc.	
2000Km/6months	High-current circuit check, brake oil circuit check, brake pad check, spoke chain and tensioner wheel tensioning course magnetic check.	

SRPNT

POWERED BY



THRONE