

# ULTRA LOW PROFILE FIXED WALL MOUNT WITH ANTI-THEFT

(43" - 90")

KAWLM90FIXT



# SAFETY & WARNINGS

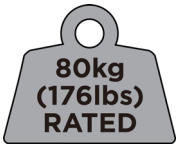

**CAUTION:**

Rated weight is 80kg (176 lbs).

Use with products heavier than the rated weights indicated may result in instability causing possible injury.

- Please closely follow the assembly instructions. Improper installation may result in damage or serious personal injury.
- Safety gear and professional tools must be used.
- This product is suitable for installation on solid concrete walls, masonry walls or wood stud walls.
- Make sure that the supporting surface will safely support the combined weight of the equipment and all attached hardware and components.
- Use the mounting screws provided and **DO NOT OVER TIGHTEN** mounting screws.
- Do not allow children to play near this stand.
- This product contains small items that could be a choking hazard if swallowed. Keep these items away from children.
- This product is intended for indoor use only. Using this product outdoors could lead to product failure and personal injury.
- A minimum of two people are recommended for this installation. Failure to use safety gear and safe working methods may result in property damage, serious injury or death.

**IMPORTANT:** Ensure that you have received all parts according to the component checklist prior to installation. If any parts are missing or faulty, contact your place of purchase for a replacement.

**MAINTENANCE:** Check that the product is secure and safe to use at regular intervals (at least every three months).



Suitable for TVs 43" – 90" maximum

VESA compatibility:
200x200, 300x200, 300x300, 400x200, 400x300, 400x400, 600x400, 800x400

# COMPONENTS

Wall mount assembly:

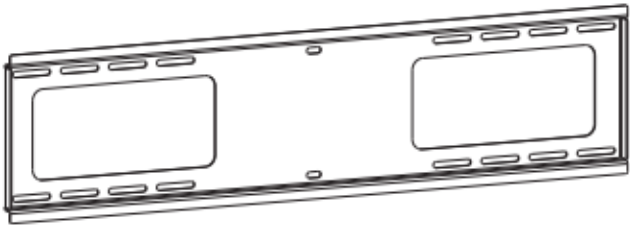

**A** (x1)



**B** (x2)



**C** (x1)



**D** (x1)



**E** (x1)



**W-A** ST6.3x55 (x6)



**W-B** Ø10x45 (x6)



**W-C** (x6)

Adapters (depends on TV):



**M-A** M5x14 (x4)



**M-B** M6x14 (x4)



**M-C** M6x30 (x4)



**M-D** M8x30 (x4)



**M-E** M8x50 (x4)



**M-F** (x4)



**M-G** (x8)



**M-H** (x8)

Additional Tools Required (Not Supplied):



Phillips head  
screwdriver



Stud finder



Spirit level



Pencil



Electric drill



Socket wrench

# ASSEMBLY

## Step 1: Drywall, plaster or timber walls (with studs)

Use a stud finder to locate safe and suitable locations to install into wall. Use a spirit level to double check the correct angle of the mount and mark the intended hole positions with a pencil. Drill holes in the desired locations (55mm deep, 4.5mm wide).

With the wall mount held in place, insert the washers and screws (W-C, W-A), tightening with a socket wrench. When installing on a drywall, plaster or timber wall, do not use the screw anchors (W-B).

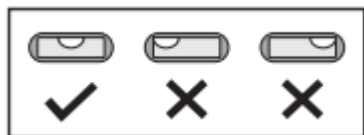
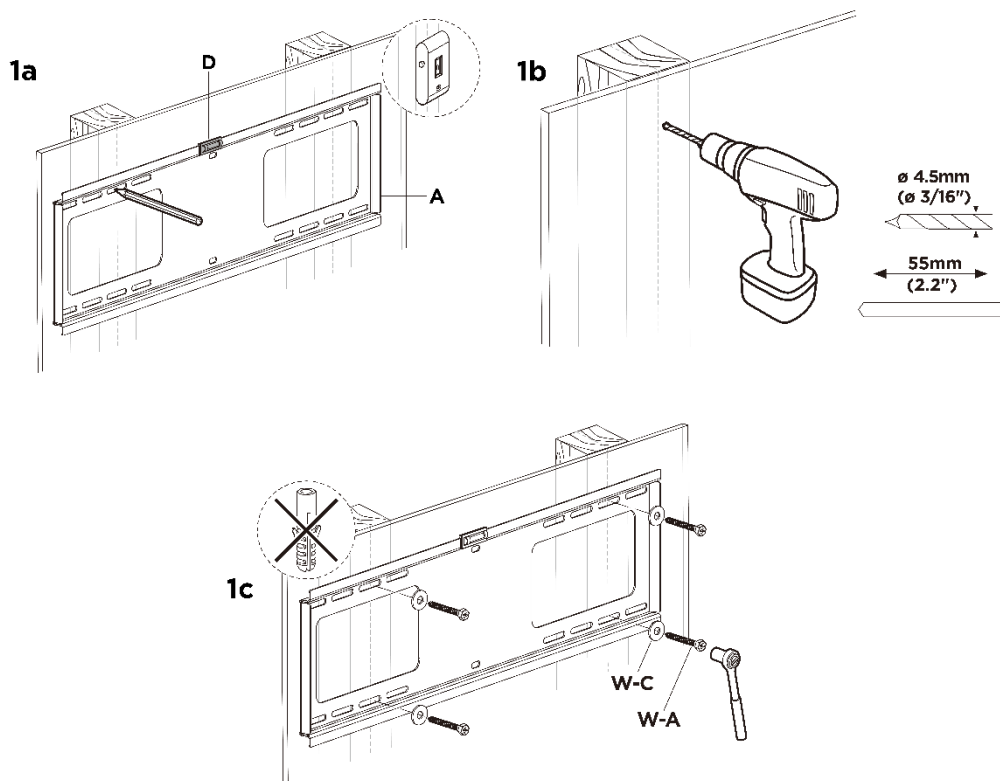

Ensure washers and screws are aligned in the centre of opening. Do not install with washers and screws off to either side.

**Step 1:** Concrete and masonry walls

Use a spirit level to double check the correct angle of the mount and mark the intended hole positions with a pencil. Drill holes in the desired locations (60mm deep, 10mm wide).

Insert the screw anchors (W-B) into each pre-drilled hole. With the wall mount held in place, insert the washers and screws (W-C, W-A), tightening with a socket wrench.

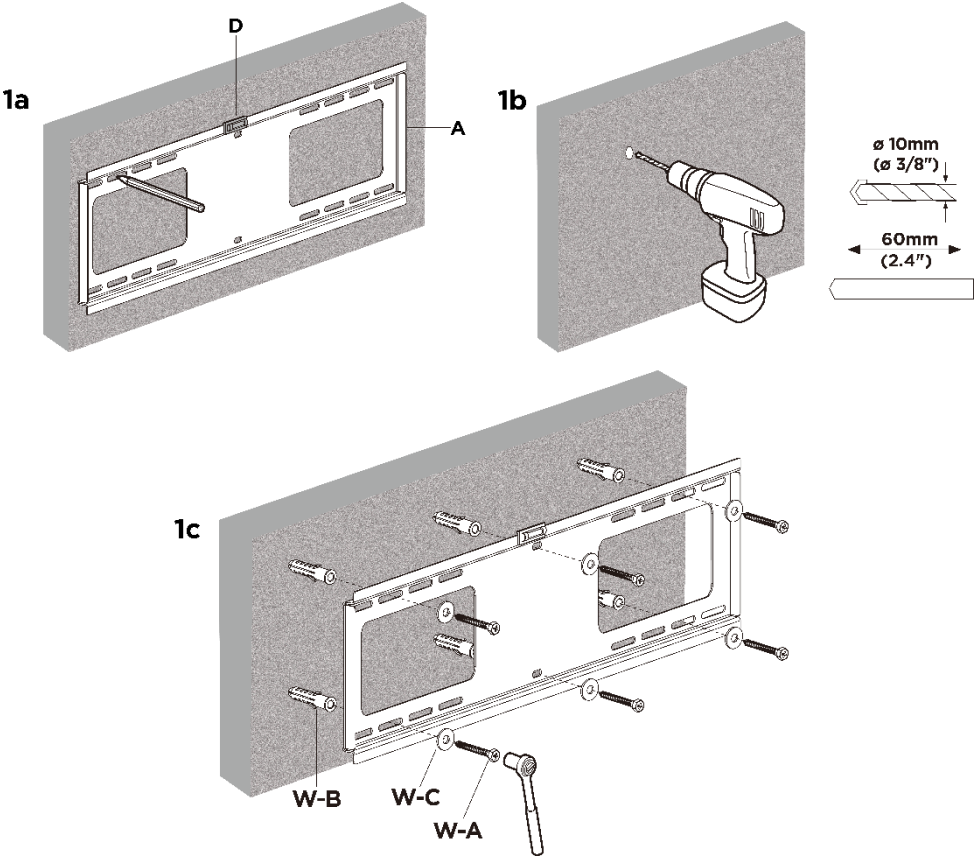

Ensure washers and screws are aligned in the centre of opening. Do not install with washers and screws off to either side.

**Step 2:** Attaching the mounting brackets to your TV.

Depending on your TV, a combination of spacers (M-G, M-H) may be required to help create the correct amount of space for the brackets. Ensure the screws are fitted correctly into your TV's VESA mount holes, and are not too long or too short in the back of the TV.

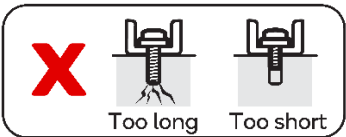
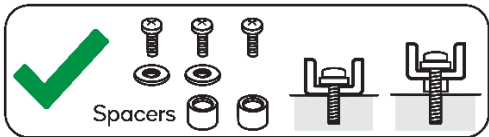
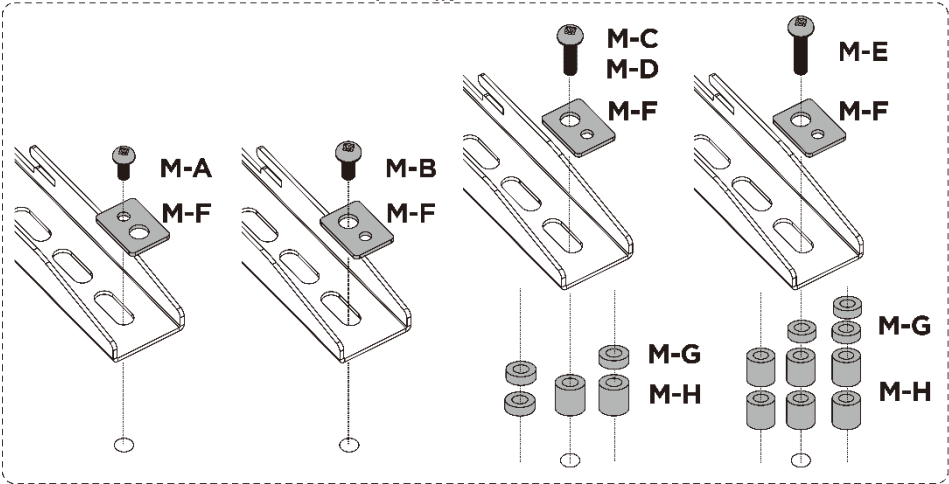
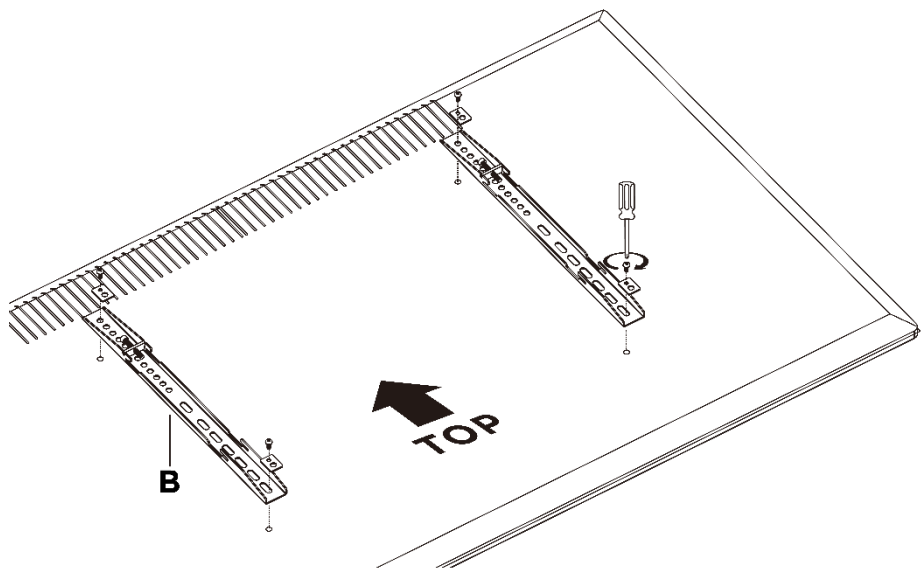

**Step 3** Attaching the TV to the wall mount.

With two people, lift the TV up and above the installed wall mount and gently lower down into place, ensuring the TV is positioned evenly in the middle of the mount.



A minimum of two people are recommended for this installation. Failure to use safety gear and safe working methods may result in property damage, serious injury, or death.

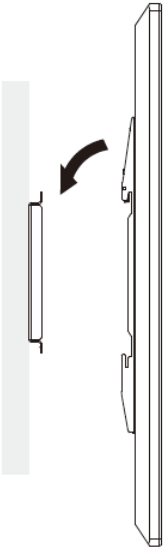

**Step 4:** Anti-theft rail

Once the TV is secured to the wall mount, the anti-theft rail (C) can be inserted through the bottom of the mount brackets. When fitted with a locking device (such as a padlock, chain, carabiner, or other locking device – not supplied), this will secure the anti-theft rail in place, disabling the ability to detach the mount brackets and remove the TV.

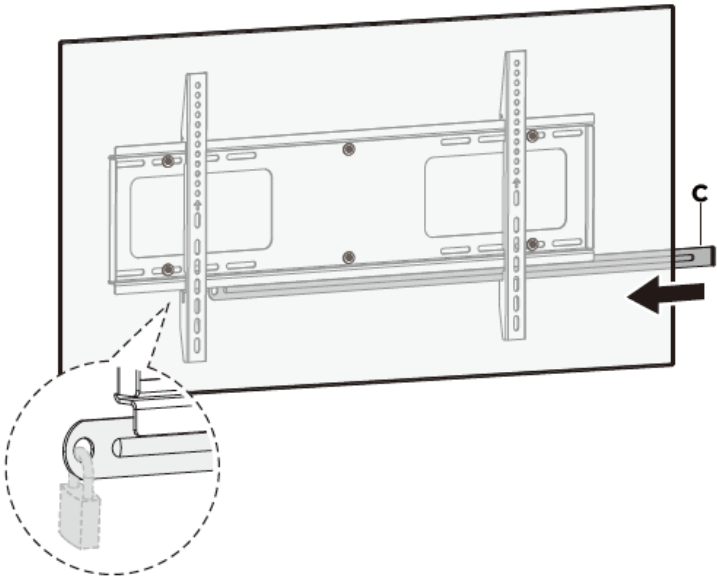



## ADJUSTING

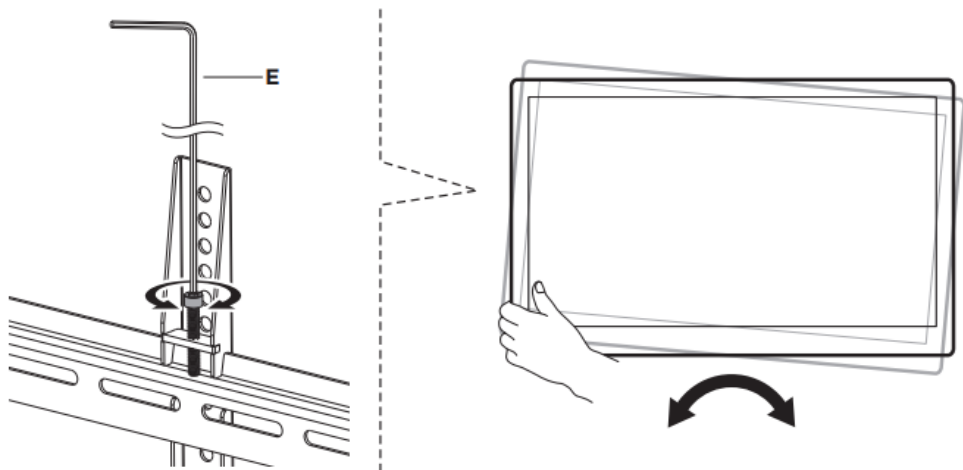

NOTES

[illegible]



### **Need more information?**

We hope that this user guide has given you the assistance needed for a simple set-up. For the most up-to-date guide for your product, as well as any additional assistance you may require, head online to **help.kogan.com**

kogan.com