

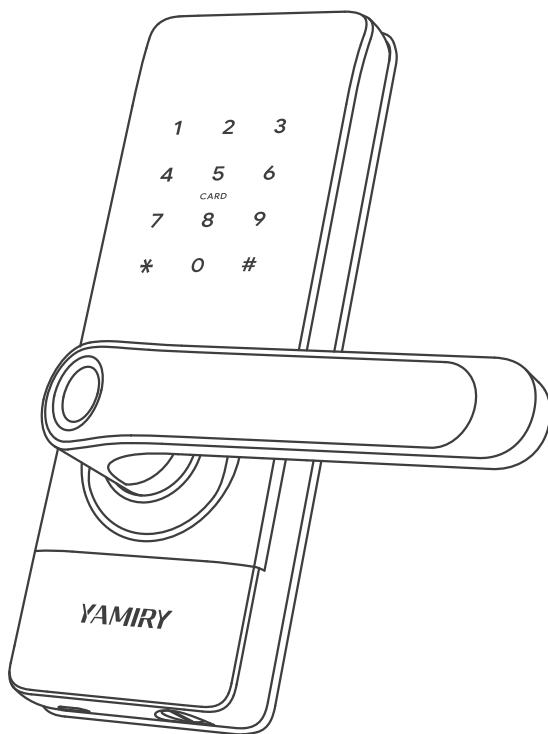

SMART LOCK USER MANUAL

MODEL: H1B



IMPORTANT NOTES

Install and test the lock with the door open to avoid being locked out.

Please read all the instructions before contacting customer support.

Please contact customer support before returning the product to the store.

DO NOT install the batteries before installing the lock!

Follow the instructions in sequential order!

Please must use AA Alkaline Battery and don't use Lithium Battery or Rechargeable Battery.

YAMIRY TERMS & POLICIES

Before use all YAMIRY products, please read all applicable terms, rules, polices and usage provision found at

www.yamiry.com/pages/privacy. By using your YAMIRY products, you agree to be bound by the YAMIRY Privacy Policy.

NEED HELP?

For technical documents and more

Please visit www.yamiry.com/pages/support

Email: support@yamiry.com

1 Product Overview

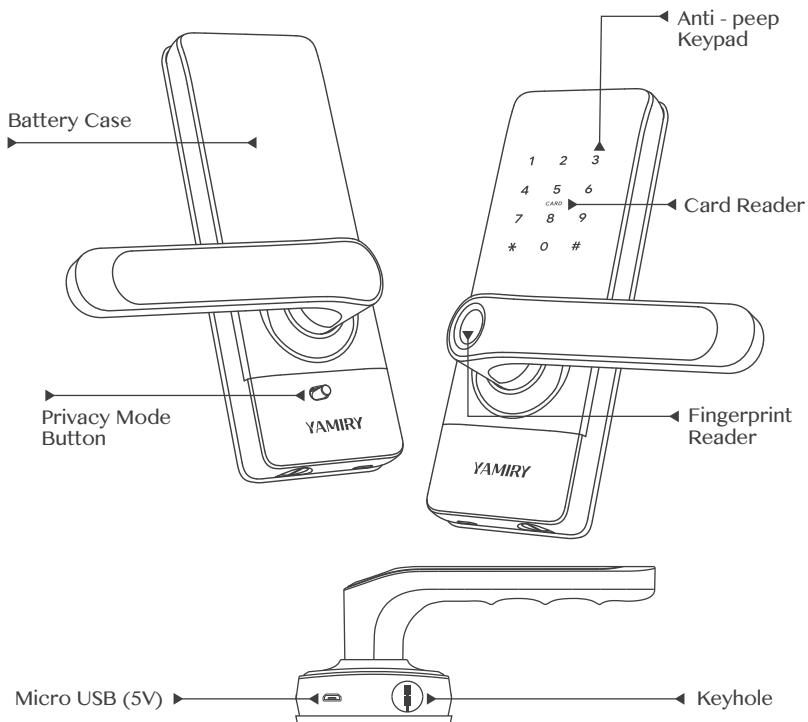

Fingerprint Reader

Used to verify your finger and unlock from outside.

Card Reader

Used to read the card and unlock from outside.

Keyhole

Used to insert key to unlock in emergency situations.

Micro USB (5V)

Used to connect power bank to activate the lock when battery runs out.
(It can't charge the battery of lock)

Anti-peep Keypad

Used to enter the code and unlock from outside.

Battery Case

Used to insert 4 AA Alkaline Batteries.

Privacy Mode

Turn on Privacy Mode button.
After the privacy mode is enabled, all users except the administrator of the lock cannot unlock it from outdoor.

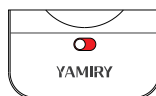

Turn on

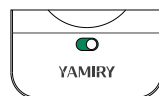

Turn off

2 Packing List

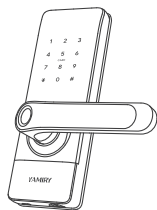

Exterior Assembly * 1

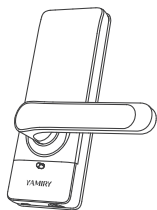

Interior Assembly * 1

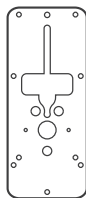

Mounting Plate * 1



Rubber Plate * 2



User Manual * 1

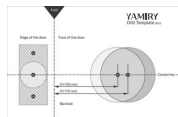

Punch Diagram * 1



Mechanical Key * 2

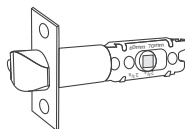

Latch * 1

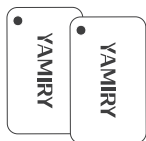

IC Card * 2

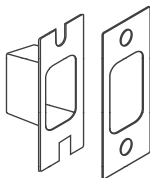

Strike & Strike Box * 1



Square Shaft * 1

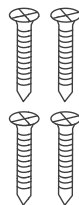

Screw A * 4

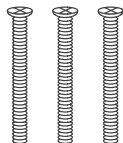

Screw B * 3

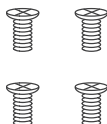

Screw C * 4



Screw Casing * 3



Pin * 1





3 Installation

Please scan this QR code to watch the easy step by step installation video before attempting to install your Smart lock.



3.1 Preparing Door

Check the door's dimensions

-  Measure to confirm that the door is between $1\frac{3}{8}$ " to $2\frac{5}{32}$ " (35mm-55mm) thick.
-  Measure to confirm that the hole in the door is 2" (50mm).
-  Measure to confirm that the door is between $2\frac{3}{8}$ " to $2\frac{3}{4}$ " (60mm-70mm) thick.
-  Measure to confirm that the hole in the door edge is 1" (25mm).

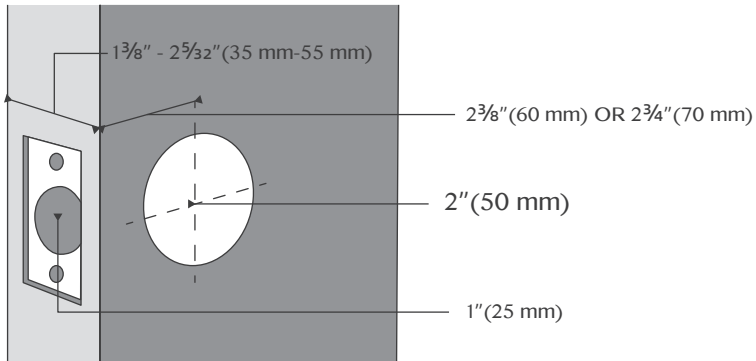

3.2 Adjust Latch Backset Length

Measure your door backset, then adjust to the corresponding latch length.

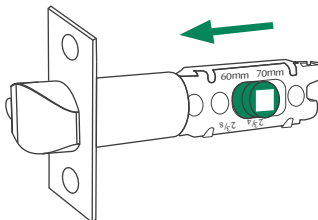

$2\frac{3}{8}$ " (60mm)

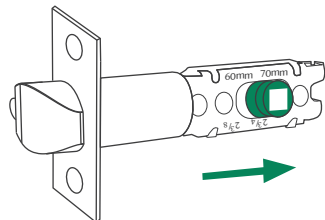

$2\frac{3}{4}$ " (70mm)

3.3 Install Latch and Strike & Strike Box

1 Install strike & strike box on door frame with Screw A.

2 Install latch into door with Screw A.

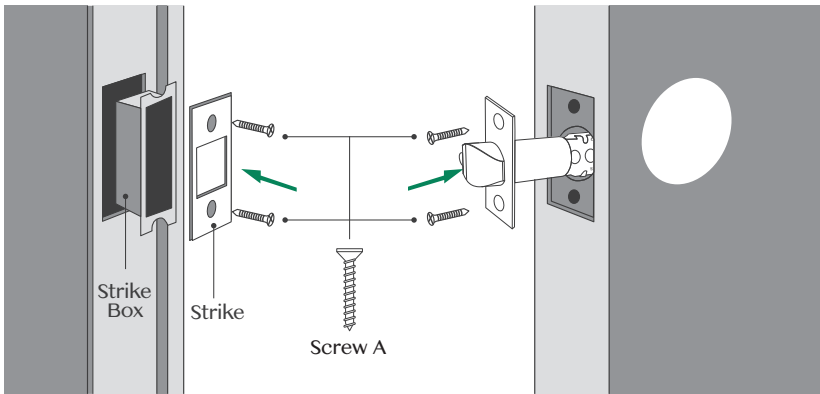

Attention

Check Latch's Status

1) Latch's square hole should place horizontal.

2) If square hole is inclined ,smart lock will get stuck when unlocked.

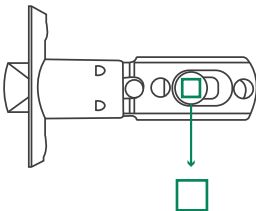

Correct: Horizontal

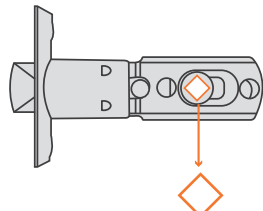

Error: Inclined

3.4 Adjust the Handles Direction

1 Confirm the opening direction of your door.

2 Adjust Handles According to Door Opening Direction.

Left-Handed Door

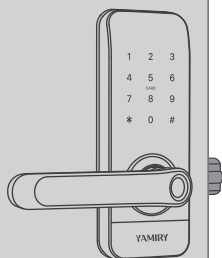

Right-Handed Door

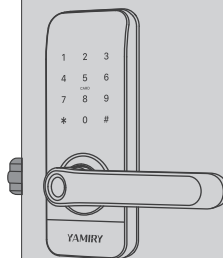

1. For Exterior Assembly

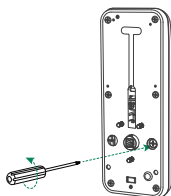

Step1 :
Loosen the screw

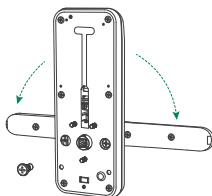

Step2:
Adjust the door handle
direction

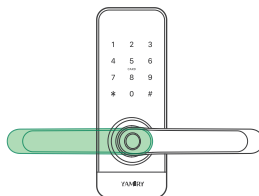

Step3:
Tighten the screws after
adjusting the handle
direction and complete.

2. For Interior Assembly

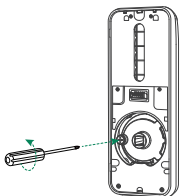

Step1 :
Loosen the screw

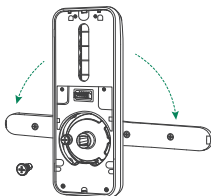

Step2:
Adjust the doorhandle
direction

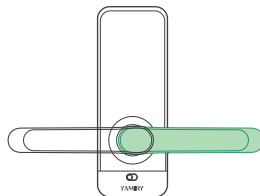

Step3:
Tighten the screws after
adjusting the handle
direction and complete.

3.5 Install Exterior Assembly

- 1 Install the waterproof rubber plate to exterior assembly.
- 2 Install square shaft into spindle hub.
- 3 Install exterior assembly with screw casings.
- 4 Install exterior assembly.

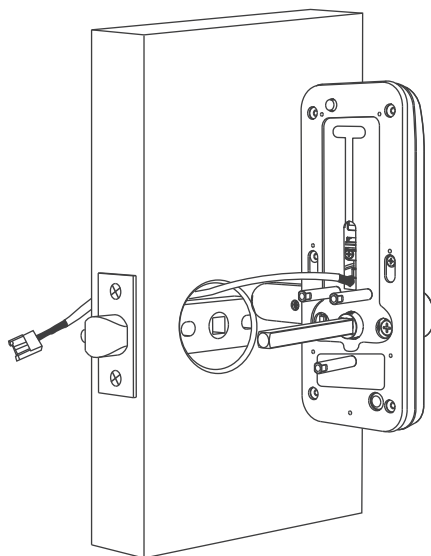
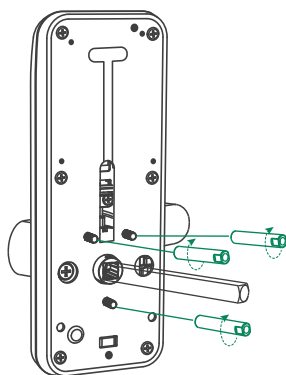
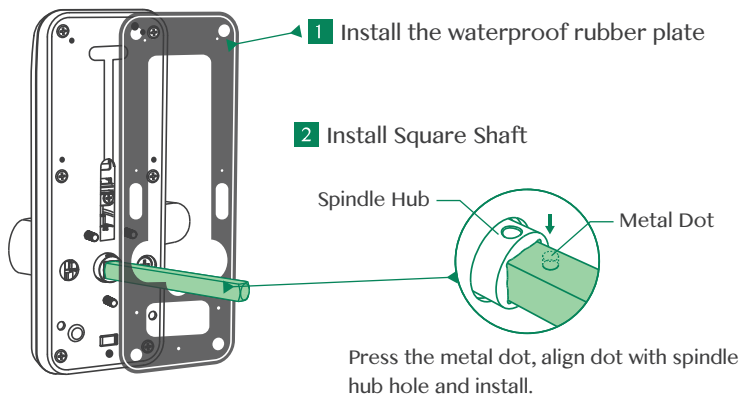

3.6 Install Interior Assembly

- 1 Secure Mounting plate with screw B.
- 2 Connect the wire.
- 3 Secure exterior assembly with screw C.

- 1** Secure Mounting Plate
Screw B screw into Screw Casings

Screw B

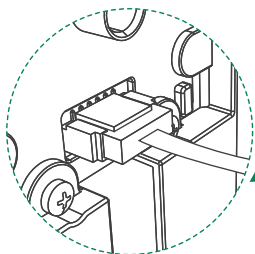

- 2** Connect the Wire

- 3** Install Exterior Assembly

Screw C

3.7 Installing Batteries

- 1 Insert 4 AA alkaline batteries.
- 2 Install the battery cover.
- 3 Installation Complete.

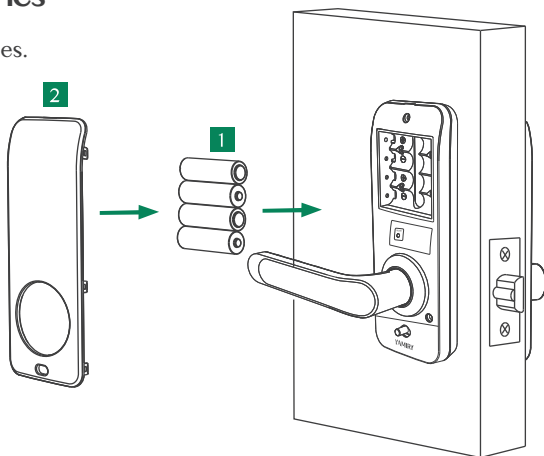

4 User Guide

Please scan this QR code to watch the simple step by step User Guide video to set up your smart lock.



4.1 System Initialization

- 1 Open the back panel cover and make sure that batteries are installed and working.
- 2 Long press the Reset Button for more than 5 seconds to wake up the lock.
- 3 Hear the prompt for entering the initial password, touch the keypad and enter "000 #" to initialize successful.
- 4 Complete the initialization, and start to add the door lock to TLock App.

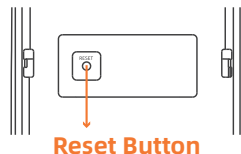

4.2 Download the TLock App

Scan the TLock QR Code to download the app
Or search "TTLock".
in APP Store (ios) and Google play (Android) for download.



TTLock QR Code

4.3 Registration and Login Your TTLock Account

Register a new account (phone number or email) or login with an existing account.

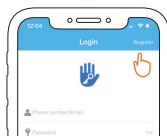

4-1

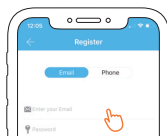

4-2

4.4 Pair the lock in the APP

- 1 Turn on Bluetooth on your smart phone, stay near the lock (within 3 meters).
- 2 Click "+" on the App and choose "All Locks" to search the lock. (Refer to Picture 4-3 & 4-4)
- 3 Touch the keypad of lock to light it up and then click the one with "+" on the App search results list to pair it in your App. (Refer to Picture 4-5)
- 4 Rename your lock. (Refer to Picture 4-6)
- 5 You have paired the lock in your App. Then just start to control the lock by your App.



4-3

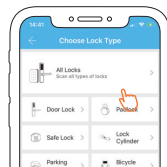

4-4

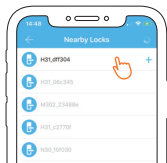

4-5

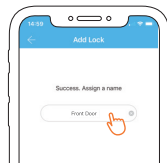

4-6



Caution:

It's necessary to touch the keypad of lock to light it up during the step 3 operation.

4.5 User Management

4.5.1 Unlock & Lock via Bluetooth

Touch "🔓" to unlock, or long press "🔒" to lock.
(Your phone needs to be within three meters of the lock)

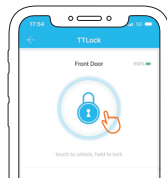

4.5.2 Generate Passcode

Touch "Generate Passcode" to add user passcode. There are 6 different password types to choose from.

You can enter the password you generated on the App on the keyboard of lock, and don't forget to enter "#" after passcode to confirm for unlocking.

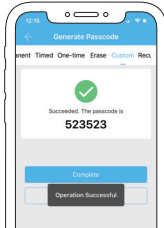
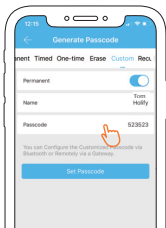
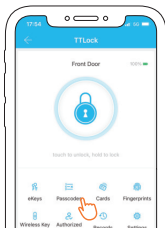

4.5.3 Send e-Key

Touch **"Send eKey"** on App, you can send the ekey to other users of TTLock to authorize the App unlock function

(The Receiver must be download the App and set up an account).

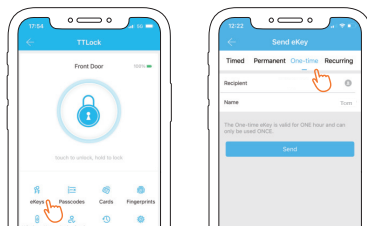

4.5.4 Add Card

Touch **"IC Card"** to add user card for your lock. You can create permanent card or timed card as your need. Name the card and touch **"OK"**, and then place a card on the keypad of lock.

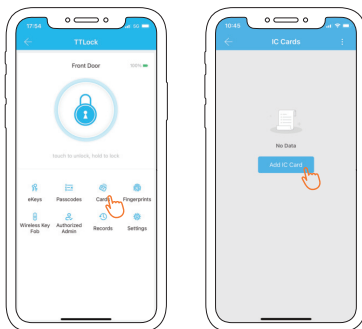

4.5.5 Add Fingerprint

Touch **"Fingerprint"** to add user fingerprint for your lock. You can add permanent fingerprint or timed fingerprint as your need. Name the fingerprint and place your finger on the fingerprint reader as prompted by the App.



Warm Tips:

For the elderly and children or people with lighter fingerprints, create more fingerprint files and enter different angles of their fingerprints, which will help improve the fingerprint recognition rate.

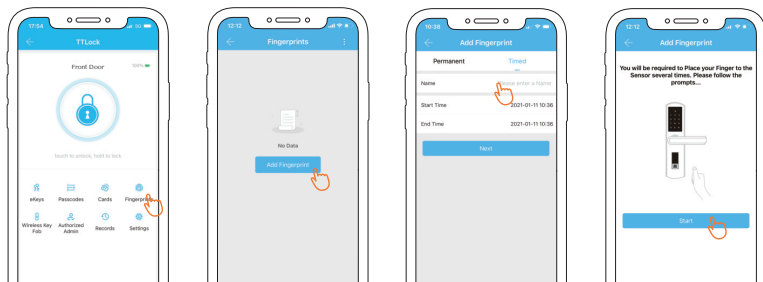

4.5.6 Unlock Record

1. Click **"Records"** you can query your unlock record as shown in figure.
2. Refresh door lock record
 - (1) Within Bluetooth distance, you can refresh and view all unlocking record;
 - (2) Beyond the Bluetooth distance, you need to connect the extra Wi-Fi Gateway (YAMIRY sold separately) to remotely refresh and view all unlocking activities of the door lock.

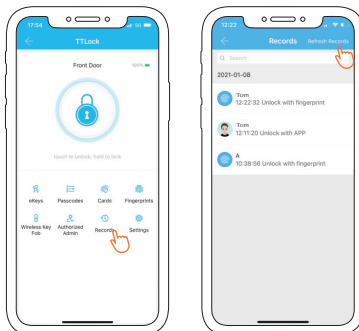

4.5.7 Remote Unlock via WiFi (Option)

If you want to remote control your lock via APP anywhere, you need a extra WiFi Gateway (YAMIRY sold separately) for connect your lock to WiFi network. (Refer to the manual of WiFi Gateway to connect)

Touch **"Settings"** and find the **"Remote Unlock"** option. Turn on the Remote Unlock function. And then back to homepage of App, you can touch **"🔓"** for remote unlock via WiFi.

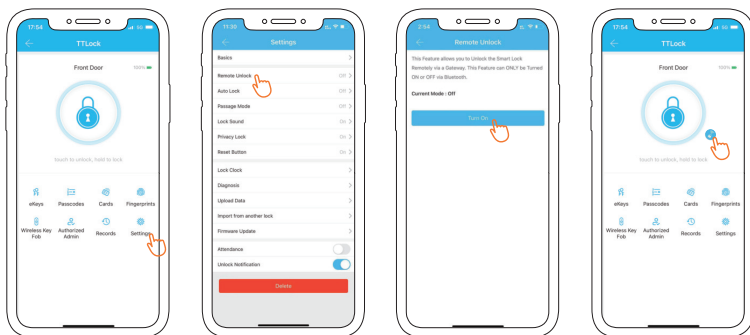

5.Using Your Lock

5.1 Unlock From Outside

1.Fingerprint

Place your finger on fingerprint reader to unlock.

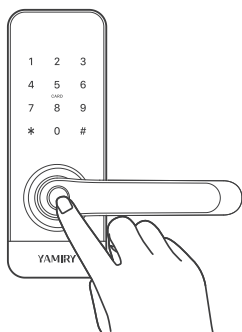

2.User Code

Enter 6-9 digit code and press “#” to unlock.

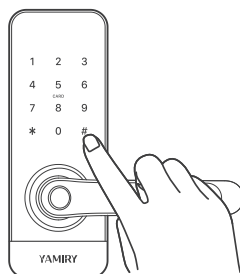

3.Card

Swipe your card on the keypad of the lock to unlock.

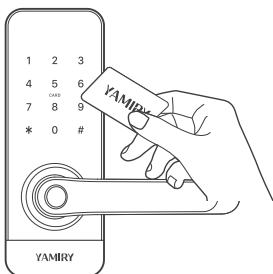

4.Smartphone

Use your smartphone to unlock.
Please refer to the guide in TLock App.



5.2 Reset the Lock

Please note all data will be erased if you reset your lock to factory default.

1. If you are using TTLock App as administrator, please click **"Delete"** in the App's Settings screen and enter your passcode of TTLock account to remove your lock from TTLock App.
2. You can also long press the Reset Button on the back of the Interior Assembly until hear the prompt for entering the initial password, touch the keypad and enter **"000 # "** to reset your lock. (Refer to 4.1)

5.3 Replace Batteries

Please use 4 high-quality alkaline AA batteries for replacement when the battery is dead.

5.4 5V Emergency Power

Micro USB interface is used to connect regular 5V power bank to activate the lock in case the battery is dead.

Note: The Micro USB interface is only used for emergency unlock and cannot be used for battery charging.

5.5 Emergency Key Unlock

Emergency key can be used when the battery is dead.

Note: Keep at least one key outside your house so you can get it to unlock in case of emergency.

5.6 Anti-peep Keypad

The lock supports up to 16-digit Vague Code. Just enter any 16-digit code, as long as a correct code is include in what you entered, you can open the door.

Example
User Code:123456
Vague Code

1: 123456XXXXXX
2: XXXXXX123456
3: XXX123456XXX

FAQ

1. Why can't I search for the lock on App when I'm pairing it with the App?

A: Please complete the initialization of lock before pair it in App (Refer to Manual 4.1).
Connect to Network or WiFi, turn on your phone's Bluetooth and location service to find near locks.
Touch keypad to wake the lock up during pairing process.

2. How can I unlock the door if batteries run out?

A: Insert a micro USB cable into the micro USB port as emergency power.
And then you can unlock the door and replace the batteries.
Please do not power smart locks through micro USB port.

3. Why does the lock always indicate low battery, even when I get a new battery?

A: Please must use new AA Alkaline Battery and install in a correct direction. Sometimes there will be inaccurate reading of the battery after replace batteries, which does not affect your normal use.
Generally, it will return to correct after using the App to unlock for several times.

4. What if I lost the paired smartphone?

A: You can login TTlock App via another smartphone to change your account password.

5. How can I unlock the door if the smart lock doesn't work?

A: You can use the mechanical key to unlock.

YAMIRY

If there are any issues with products,
please contact tech support:

support@yamiry.com