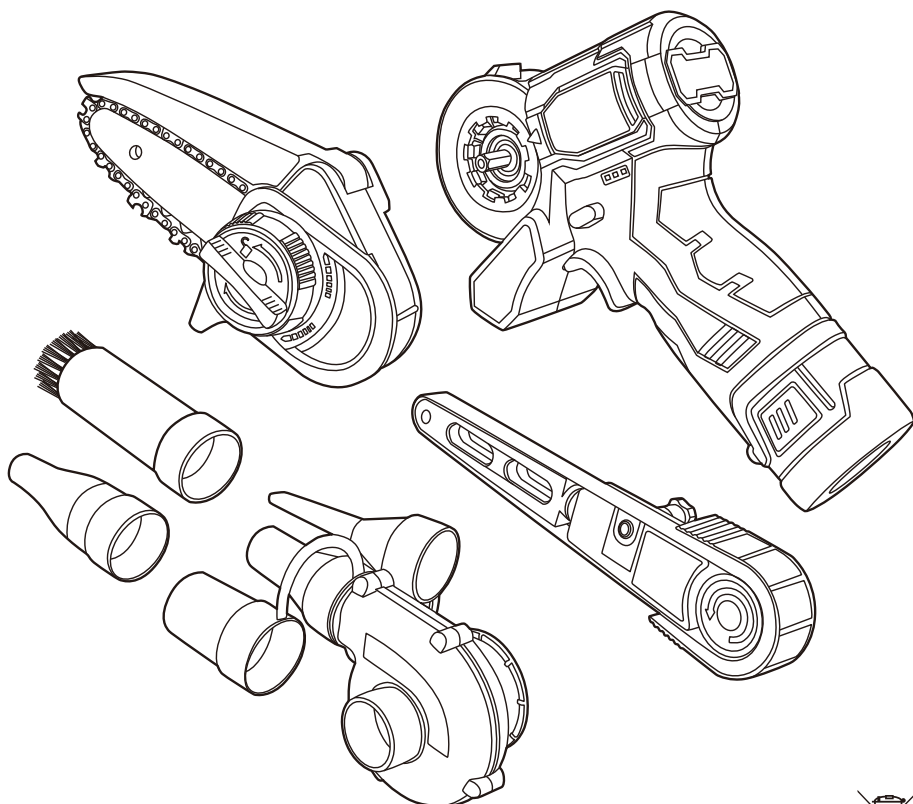


# WORKPRO

---

W125176A

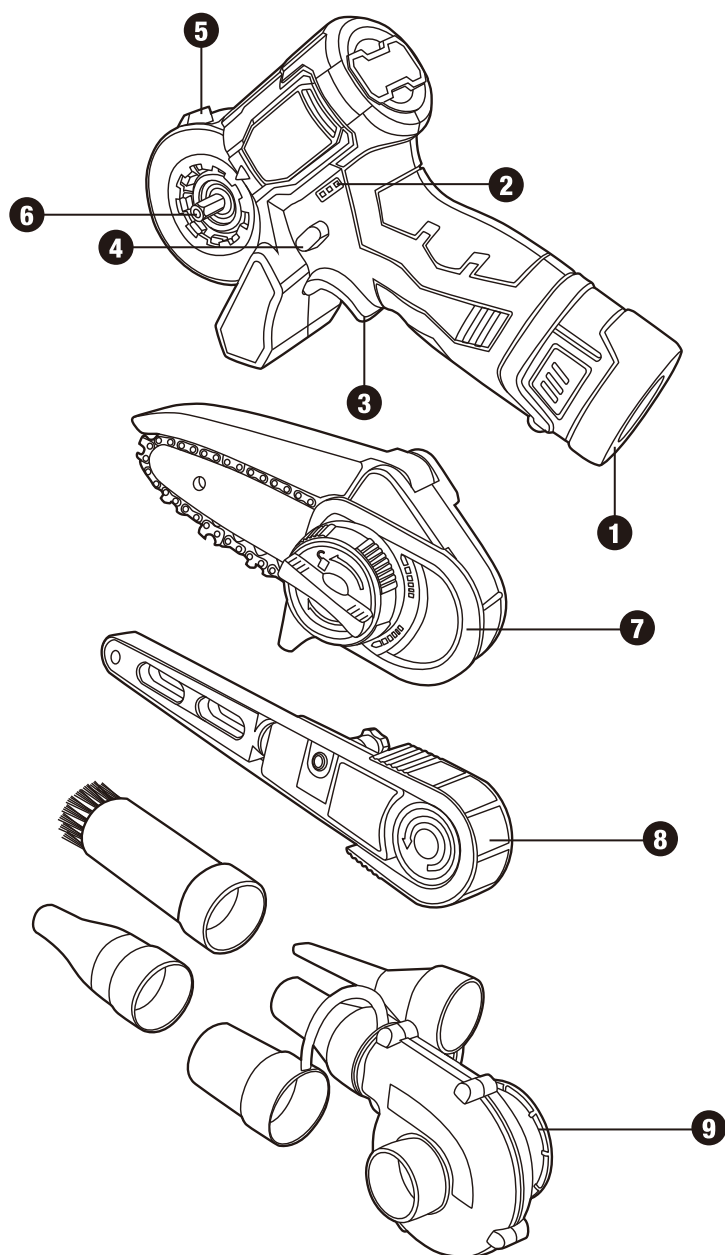
## ORIGINAL OPERATING INSTRUCTIONS 12V BRUSHLESS CORDLESS 3-IN-1 MULTI-HEAD POWER TOOL SET



---


Distributed by:  
Hangzhou GreatStar Industrial Co., Ltd.  
No.35 Jiuhuan Road, Jiubao Town,  
Hangzhou 310019, China  
[www.greatstartools.com](http://www.greatstartools.com)  
Made in China

**Fig. 1**



**SYMBOLS**

	To reduce the risk of injury, user must read instruction manual
	Wear ear protection
	Wear eye protection
	Wear dust mask
	Do not expose to rain
	Wear protective gloves
	Wear protective footwear
	Do not burn

	Batteries may enter water cycle if disposed improperly, which can be hazardous for ecosystem. Do not dispose of waste batteries as unsorted municipal waste.
---	--

## **Danger!**

When using the equipment, a few safety precautions must be observed to avoid injuries and damage. Please read the complete operating instructions and safety regulations with due care. Keep this manual in a safe place, so that the information is available at all times. If you give the equipment to any other person, hand over these operating instructions and safety regulations as well. We cannot accept any liability for damage or accidents which arise due to a failure to follow these instructions and the safety instructions.

## **1. GENERAL POWER TOOL SAFETY WARNING**

### **WARNING!**

**Read and understand all instructions.** Failure to follow the warnings and instructions may result in electric shock, fire and/or serious injury.

**Save all warnings and instructions for future reference.**

The term "power tool" in the warnings refers to your mains-operated (corded) power tool or battery-operated (cordless) power tool.

### **1) Work area safety**

- **Keep work area clean and well lit.** Cluttered or dark areas invite accidents.
- **Do not operate power tools in explosive atmospheres, such as in the presence of flammable liquids, gases or dust.** Power tools create sparks which may ignite the dust or fumes.
- **Keep children and bystanders away while operating a power tool.** Distractions can cause you to lose control.

### **2) Electrical safety**

- **Power tool plugs must match the outlet. Never modify the plug in any way.** Do not use any adapter plugs with earthed (grounded) power tools. Unmodified plugs and matching outlets will reduce risk of electric shock.
- **Avoid body contact with earthed or grounded surfaces, such as pipes, radiators, ranges and refrigerators.** There is an increased risk of electric shock if your body is earthed or grounded.
- **Do not expose power tools to rain or wet conditions.** Water entering a power tool will increase the risk of electric shock.
- **Do not abuse the cord. Never use the cord for carrying, pulling or unplugging the power tool.** Keep cord away from heat, oil, sharp edges or moving parts. Damaged or entangled cords increase the risk of electric shock.
- **When operating a power tool outdoors, use an extension cord suitable for outdoor use.** Use of a cord suitable for outdoor use reduces the risk of electric shock.
- **If operating a power tool in a damp location is unavoidable, use a residual current device (RCD) protected supply.** Use of an RCD reduces the risk of electric shock.

### **3) Personal safety**

- **Stay alert, watch what you are doing and use common sense when operating a power tool.** Do not use a power tool while you are tired or under the influence of drugs, alcohol or medication. A moment of inattention while operating power tools may result in serious personal injury.
- **Use personal protective equipment. Always wear eye protection.** Protective equipment such as a dust mask, non-skid safety shoes, hard hat or hearing protection used for appropriate conditions will reduce personal injuries.
- **Prevent unintentional starting. Ensure the switch is in the off-position before connecting to power source and/or battery pack, picking up or carrying the tool.** Carrying power tools with your finger on the switch or energising power tools that have the switch on invites accidents.
- **Remove any adjusting key or wrench before turning the power tool on.** A wrench or a key left attached to a rotating part of the power tool may result in personal injury.
- **Do not overreach.** Keep proper footing and balance at all times. This enables better control of the power tool in unexpected situations.
- **Dress properly.** Do not wear loose clothing or jewellery. Keep your hair and clothing away from moving parts. Loose clothes, jewellery or long hair can be caught in moving parts.
- **If devices are provided for the connection of dust extraction and collection facilities, ensure these are connected and properly used.** Use of dust collection can reduce dust-related hazards.
- **Do not let familiarity gained from frequent use of tools allow you to become complacent and ignore tool safety principles.** A careless action can cause severe injury within a fraction of a second.

### **4) Power tool use and care**

- **Do not force the power tool.** Use the correct power tool for your application. The correct power tool will do the job better and safer at the rate for which it was designed.
- **Do not use the power tool if the switch does not turn it on and off.** Any power tool that cannot be controlled with the switch is dangerous and must be repaired.
- **Disconnect the plug from the power source and/or remove the battery pack, if detachable, from the power tool before making any adjustments, changing accessories, or storing power tools.** Such preventive safety measures reduce the risk of starting the power tool accidentally.
- **Store idle power tools out of the reach of children and do not allow persons unfamiliar with the power tool or these instructions to operate the power tool.** Power tools are dangerous in the hands of untrained users.
- **Maintain power tools and accessories. Check for misalignment or binding of moving parts, breakage of parts and any other condition that may affect the power tool's operation.** If damaged, have the power tool repaired before use. Many accidents are caused by poorly maintained power tools.
- **Keep cutting tools sharp and clean.** Properly maintained

cutting tools with sharp cutting edges are less likely to bind and are easier to control.

■ **Use the power tool, accessories and tool bits etc.** in accordance with these instructions, taking into account the working conditions and the work to be performed. Use of the power tool for operations different from those intended could result in a hazardous situation.

■ **Keep handles and grasping surfaces dry, clean and free from oil and grease.** Slippery handles and grasping surfaces do not allow for safe handling and control of the tool in unexpected situations.

## 5) Service

Have your power tool serviced by a qualified repair person using only identical replacement parts. This will ensure that the safety of the power tool is maintained.

## 6) Battery tool use and care

- a. Ensure the switch is in the off position before inserting battery pack. Inserting the battery pack into power tools that have the switch on invites accidents.
- b. Recharge only with the charger specified by the manufacturer. A charger that is suitable for one type of battery pack may create a risk of fire when used with another battery pack.
- c. Use power tools only with specifically designated battery packs. Use of any other battery packs may create a risk of injury and fire.
- d. When battery pack is not in use, keep it away from other metal objects like paper clips, coins, keys, nails, screws, or other small metal objects that can make a connection from one terminal to another.

Shorting the battery terminals together may cause burns or a fire.

- e. Under abusive conditions, liquid may be ejected from the battery; avoid contact. If contact accidentally occurs, flush with water. If liquid contacts eyes, additionally seek medical help. Liquid ejected from the battery may cause irritation or burns.

### ADDITIONAL SAFETY INSTRUCTIONS FOR THE CHARGER

Your WORKPRO tool with Lithium Ion batteries may only be charged with the specific designed WORKPRO Lithium Ion battery charger purchased with the tool.

**IT IS DANGEROUS TO USE ANY OTHER BATTERY CHARGER TO CHARGE YOUR TOOL.** Do not attempt to charge the battery pack with any other charger than the one supplied.

Before using the charger, read all the instructions, labels and cautionary markings on the charger and battery pack as well as the instructions on using the battery pack.

Do not use the charger if it has been subjected to a heavy knock, dropped or otherwise damaged in anyway. Take the charger to an authorised service centre for a check or repair.

Do not disassemble the charger. Opening or removing covers may expose you to dangerous voltages or other risks.

Incorrect reassembly can cause electric shock when you use the tool or charger again. Take the charger to a power tool repair centre when service or repair is required.

 **DANGER.** If the battery pack is cracked or damaged in any other way, do not insert it in the charger.


Do not plug anything other than your WORKPRO tool into the charger, as other objects may touch dangerous voltage points or short out parts, which could result in fire or electric shock.

Do not place the tool or charger on an uneven surface, as a fall may cause serious damage.

Never place the tool or charger near or over a heat source such as a radiator or heater.

Do not operate the charger in a cabinet or other enclosure unless proper ventilation is provided.

Use the battery charger indoors only.

 **WARNING.** Do not allow any liquid to come into contact with the charger. There is a danger of electric shock. Do not position the tool or battery charger near water; for example, near a sink, wash bowl or toilet. Do not spill liquid of any kind on the tool or charger. Doing so may short out parts, causing damage to the product and creating the risk of fire or electric shock.

To reduce the risk of an electric shock, unplug the charger from the power supply before attempting to clean it. To clean tool or charger, wipe with a damp cloth. Use of any other cleaners is not recommended.

Do not place any object on to, or allow anything to rest on the charger.

Make sure that the charger cable is positioned where it will not be stepped on, tripped over or otherwise subjected to damage or stress. Keep the lead away from operating machinery.

Do not pull on the lead of the charger to disconnect it from the mains power socket.

Do not use an extension cord unless it is absolutely necessary. The use of an improper extension cord could cause the risk of fire, electric shock or electrocution.

Never attempt to connect two chargers together.

Do not charge batteries or use the tool and battery pack in locations where the temperature may be below 40°F(4°C) or exceed 104°F(40°C) such as alongside sheds or metal structures.

If you wish to charge a second battery pack, unplug the charger from the mains supply and leave it for at least 15 minutes. After this time you can charge a second battery pack.

### ADDITIONAL SAFETY INSTRUCTIONS RELATED TO THE BATTERY PACK AND BATTERY SAFETY

Use only the WORKPRO batteries supplied with the WORKPRO Tool or WORKPRO-approved replacements.

Do not use the battery to power any device other than the WORKPRO tool it was sold with.

Charge the battery only with the WORKPRO charger supplied with the tool or WORKPRO-approved replacements and according to the instructions in the WORKPRO Instruction Manual.

Do not charge the battery in a place where static electricity is generated nor let the battery touch something that is statically charged.

The battery can be stored at temperatures between 40°F(4°C) and 104°F(40°C).

Never store or leave your lithium ion battery in temperatures over that recommended otherwise fire may occur.

DO NOT store the Lithium Ion battery anywhere that the temperature can easily reach higher temperatures than recommended -this includes garden type sheds, and vehicles where the inside temperature can climb to dangerous levels in the direct sunlight and on high temperature days. **THINK BEFORE LEAVING YOUR LITHIUM ION BATTERY PACK IN STORAGE.**

The battery can be charged or operated at temperatures between 40°F(4°C) and 104°F(40°C). **NEVER CHARGE YOU LITHIUM ION BATTERY BELOW OR ABOVE TEMPERATURES RECOMMENDED OTHERWISE FIRE OR SERIOUS DAMAGE TO THE BATTERY PACK MAY OCCUR.**

The most suitable temperatures to charge the battery pack are between 68°F(20°C) -77°F(25°C).

Always allow the battery pack to cool down after charging, do not place it in a hot environment such as a metal shed or open trailer left in the sun.

Take care where the tool is stored. Do not store in areas of corrosive fumes, or salt air or similar conditions. Try and store the tool in the packaging supplied with the tool.

Do not dispose of the battery in a fire or put the battery into a microwave oven, conventional oven, dryer, or high-pressure container. Under these conditions, the battery may explode.

Never attempt to open the battery pack, puncture the battery or subject the battery to strong physical shock.

If the plastic housing of the battery pack breaks open or cracks, immediately discontinue its use and do not recharge it. Ensure the battery pack clip is in good condition and will not allow the pack to fall free from the tool. If the clip is damaged or for any reason is not locking the pack in place, Do Not continue to use.

Stop using the battery if it exhibits abnormal heat, odour, colour, deformation, or is in an abnormal condition.

If you detect leakage or a foul odour, it is especially important to keep the battery away from fire. If battery liquid leaks onto your skin or clothes, wash well with clean water immediately. If liquid leaking from the battery gets into your eyes, do not rub your eyes. Rinse your eyes well (for at least 10 minutes) with clean water, and consult a doctor immediately.

Do not use a leaking battery.

Handle batteries with care to avoid shorting the battery with conducting materials, such as nails, screws, metal watch bands, rings, bracelets, and keys. The battery may overheat and could burn you.

After the battery has reached the end of its useful life, we recommend recycling the materials at your local municipal council recycling centre. DO NOT attempt to replace the battery cells in the battery pack, repair or modify any part of the battery pack assembly.

When recycling, make it nonconductive by applying insulating tape to the terminals located on the battery.

## WHEN TO CHARGE THE BATTERY

New batteries are shipped in a low charged condition and should be fully charged before Use. The battery pack can be recharged at any time during use, provided the pack is not overheated.

If the battery pack starts to cut out due to low voltage, or previous tasks undertaken can no longer be performed, it is suggested to stop using the tool and recharge the battery.

For storage, it is suggested to recharge the battery between 50% and 75% charge. Charge the device at least once in 3-6 months to preserve battery life span.

## Safety instruction for pruning saw

- a. Keep all parts of the body away from the saw chain when the pruning saw is operating. Before you start the pruning saw, make sure the saw chain is not contacting anything. A moment of inattention while operating pruning saws may cause entanglement of your clothing or body with the saw chain.
- b. Always hold the pruning saw with your one hand on the Grip Area and your other hand on the Secondary Grip Area. Holding the pruning saw improperly increases the risk of personal injury and should never be done.
- c. Hold the pruning saw by insulated gripping surfaces only, because the saw chain may contact hidden wiring. Saw chains contacting a live wire may make exposed metal parts of the pruning saw live and could give the operator an electric shock.
- d. Wear safety glasses protection. Further protective equipment for hearing, head, hands, legs and feet is recommended. Adequate protective clothing will reduce personal injury by flying debris or accidental contact with the saw chain.
- e. Do not operate a pruning saw in a tree, on a ladder, from a rooftop, or any unstable support. Operation of a pruning saw in this manner could result in serious personal injury.
- f. Always keep proper footing and operate the pruning saw only when standing on fixed, secure and level surface. Slippery or unstable surfaces may cause a loss of balance or control of the pruning saw.
- g. When cutting a limb that is under tension, be alert for spring back. When the tension in the wood fibers is released, the spring loaded limb may strike the operator and/or throw the pruning saw out of control.
- h. Use extreme caution when cutting brush and saplings. The slender material may catch the saw chain and be whipped toward you or pull you off balance.
- i. Carry the pruning saw with the pruning saw switched off and away from your body. When transporting or storing the pruning saw, always fit the guide bar cover. Proper handling of the pruning saw will reduce the likelihood of accidental contact with the moving saw chain.
- j. Follow instructions for lubricating, chain tensioning and changing the bar and chain. Improperly tensioned or lubricated chain may either break or increase the chance for kickback.
- k. Cut wood only. Do not use pruning saw for purposes not intended. For example: do not use pruning saw for cutting

metal, plastic, masonry or non-wood building materials. Use of the pruning saw for operations different than intended could result in a hazardous situation.

- m. This pruning saw is not intended for tree felling. Use of the pruning saw for operations different than intended could result in serious injury to the operator or bystanders.
- n. Follow all instructions when clearing jammed material, storing or servicing the pruning saw. Make sure the switch is off and the battery pack is removed. Unexpected actuation of the pruning saw while clearing jammed material or servicing may result in serious personal injury.
- l. Recommendation that the first-time user should, as a minimum, practice cutting logs on a saw-horse or cradle.
- o. Recommendation to have sharpening and maintenance of the saw chain performed by authorized service centers.

### Causes and operator prevention of kick-back

Kickback may occur when the nose or tip of the guide bar touches an object, or when the wood closes in and pinches the saw chain in the cut.

Tip contact in some cases may cause a sudden reverse reaction, kicking the guide bar up and back towards the operator.

Pinching the saw chain along the top of the guide bar may push the guide bar rapidly back towards the operator.

Either of these reactions may cause you to lose control of the saw which could result in serious personal injury. Do not rely exclusively upon the safety devices built into your saw. As a pruning saw user, you should take several steps to keep your cutting jobs free from accident or injury.

Kickback is the result of pruning saw misuse and/or incorrect operating procedures or conditions and can be avoided by taking proper precautions as given below:

- a. Maintain a firm grip, with thumbs and fingers encircling the pruning saw handles, with both hands on the saw and position your body and arm to allow you to resist kickback forces. Kickback forces can be controlled by the operator, if proper precautions are taken. Do not let go of the pruning saw.
- b. Do not overreach and do not cut above shoulder height. This helps prevent unintended tip contact and enables better control of the pruning saw in unexpected situations.
- c. Only use replacement bars and chains specified by the manufacturer. Incorrect replacement guide bars and saw chains may cause chain breakage and/or kickback.
- d. Follow the manufacturer's sharpening and maintenance instructions for the saw chain. Decreasing the depth gauge height can lead to increased kickback.

### Residual risks

Even with the intended use of the appliance there is always a residual risk, which can not prevent. According to the type and construction of the appliance the following potential hazards might apply:

- Contact with exposed saw teeth of the saw chain (cutting hazards)
- Access to the rotating saw chain (cutting hazards)

- Unforeseen, abrupt movement of the guide bar (cutting hazards)
- Flung out of parts from the saw chain (Cutting / injection hazards)
- Flung out of parts of the work piece
- Skin contact with the oil
- Loss of hearing, if no required ear protection used during work

### Safety Instruction For Belt Sanders

- Danger of fire from flying sparks ! Sanding metal creates flying sparks. For this reason, always make sure that nobody is placed in any danger and that there are no inflammable materials near the working area.
- When undertaking prolonged sanding of wood, and in particular when working on materials that give rise to dusts that are hazardous to health, the sander must be connected to a suitable external dust extraction device.
- Ensure that there is adequate ventilation when working on plastic, paint, varnish etc.
- The belt sander is designed for the dry sanding of large surfaces of wood, plastic, metal and plaster and painted surfaces. The device is to be used for dry sanding only.
- Securely support the workpiece. Use clamps or a vice to grip the workpiece firmly. This is much safer than holding it with your hand.
- Never support yourself by placing your hands near or in front of the device or the workpiece surface. A slip can result in injury.
- Avoid contact with the moving sanding belt.
- Do not work on moistened materials or damp surfaces.
- Always switch on the device before placing it against the workpiece. After sanding, lift the device from the workpiece before switching it off.
- When always keep proper footing and balance.
- Switch the device off and allow it to come to a complete standstill before you put it down.
- When taking a break from your work, before carrying out any tasks on the device itself (e.g. changing the sanding belt) and when you are not using the device, always switch the device off.

### Leaf blower safety warnings

- When working with the device, always maintain a safe distance and natural body position.
- Always hold the device firmly in hand.
- Before starting to work, check the working area for animals and objects. Remove all objects that may be slung away or become jammed in the cutting tool.
- No other persons or animals may be present within an area of 5 m around the working area, as they may otherwise be injured by objects being slung away.
- Only work in good light and vision conditions.
- Do not work above head height! Do not lean forward or back!

- The operator must wear tightly fitting clothing. Avoid wearing loose clothing. Wear sturdy shoes and long trousers.
- Take care when walking backwards. Danger of stumbling!
- Never work in the rain.
- Blowing of heavy materials such as metal, stones, branches, fir cones or broken glass is expressly forbidden.
- When working with the device, ensure that there is sufficient lighting.
- Always wear the required personal protective equipment.
- Be careful of the dust you have raised and flying objects. Especially dangerous is the rebound effect on walls or walls of houses.
- Do not direct the device at people or animals when blowing.
- Before starting to blow, loosen foreign bodies with a rake or broom.
- The machine may only be operated during sensible hours – not too early in the morning or too late in the evening, as it may disturb other people.
- The times listed by the local authorities must be adhered to.
- The whole blower nozzle piece must be used so that the airstream can work close to the ground.
- Heed children, pets, open windows, and blow the foreign bodies safely away.

## 2. LAYOUT AND UNPACKING

### 2.1 Layout (Fig. 1)

1. Battery pack
2. Battery capacity indicator
3. ON/OFF trigger
4. Lock-out button
5. Accessory mouting switch lock button
6. Transmission shaft
7. Pruning saw accessory
8. Belt sander accessory
9. Blower accessories

### 2.2 Items supplied

Please check that the article is complete as specified in the scope of delivery. If parts are missing, please contact our online service center.

- Open the packaging and take out the equipment with care.
- Remove the packaging material and any packaging and/or transportation braces (if available).
- Check to see if all items are supplied.
- Inspect the equipment and accessories for transport damage.
- If possible, please keep the packaging until the end of the guarantee period

### Danger!

**The equipment and packaging material are not toys. Do not let children play with plastic bags, foils or small parts. There is a danger of swallowing or suffocating!**

## 3. PROPER USE

- The pruning saw is intended for cutting only wood and branches up to a diameter corresponding to the length of the pruning saw guide bar.
- The belt sander can be used for spot welding grinding, burr removal, chamfering removal, coating operation, surface grinding, rough grinding, surface polishing, roughing and rust removal.
- The blower is suited solely for the blowing of light and dry materials such as small branches, and small pieces of paper.

This appliance is intended for use on private properties only.

This product is not intended for commercial use. Generally acknowledged accident prevention regulations and enclosed safety instructions must be observed.

Only perform work described in these instructions for use. Any other use is improper. The manufacturer will not assume responsibility for damage resulting from such use.

## 4. Technical Data

Charger	Input:100-240V~, 50/60Hz 0.8A, Output:13.5VDC,2.0A
Battery capacity	2000mAh/pack
Battery voltage	Maximum 12V/Nominal 10.8V
Charging time	Approx. 1 hour
No load speed	0 - 4000 rpm
Weight	0.75kg(1.65lbs)

### Accessory

Pruning saw	
Guide bar length	112mm
Cutting ability	80mm
Chain pitch	5.5mm
Number of chain drive links	28
Belt sander	
Sanding belt	1/2x18"
Belt speed	6.7m/s
Blower	
Blowing Speed	46m/s
Blowing capacity	82m³/h

### **⚠ Caution!**

#### **Residual risks**

Even if you use this electric power tool in accordance with instructions, certain residual risks cannot be ruled out. The following hazards may arise in connection with the equipment's construction and layout:

- Lung damage if no suitable protective dust mask is used.
- Damage to hearing if no suitable ear protection is used.
- Health damage caused by hand-arm vibrations if the equipment is used over a prolonged period or is not properly guided and maintained.

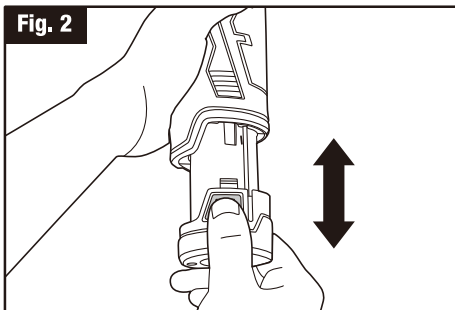
## **5. ASSEMBLY**

**⚠ WARNING:** Do not use this product if it is not completely assembled or if any parts appear to be missing or damaged. Use of a product that is not properly and completely assembled or with damaged or missing parts could result in serious personal injury.

### **5.1 Inserting/Removing the Battery (Fig. 2)**

- To remove the battery, push in the release buttons and pull the battery pack away from the tool.
- To insert the battery, slide the pack into the body of the tool. Make sure it latches securely into place.

**Fig. 2**



**⚠ Caution! Removing the battery pack before installing any accessories.**

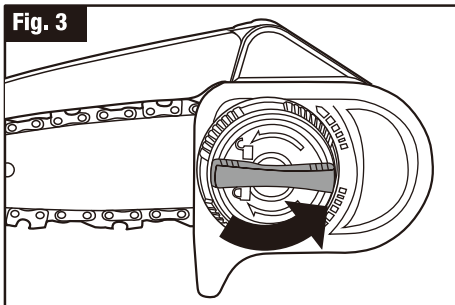
### **5.2 Assembly for pruning saw**

#### **5.2.1 Mounting the saw chain**

**⚠ Warning!** Only handle the saw chain with gloves.

- 1) Remove the Housing-Cover by turning the Housing-Cover Knob in a counterclockwise direction. (Fig.3)

**Fig. 3**

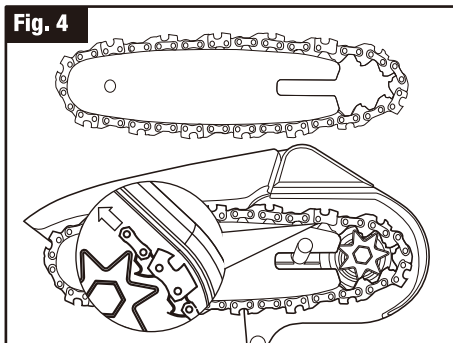


- 2) Place the pruning saw on a solid, level surface.

- 3) Use only recommended saw chain for Guide Bar.

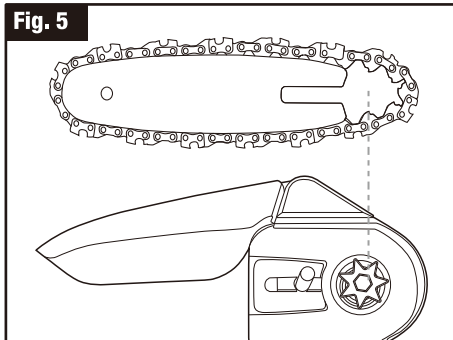
- 4) Slide the Chain in the slot around the Guide Bar. Ensure the Chain is in correct running direction by comparing it to the chain icon on the Guide Bar. (Fig. 4)

**Fig. 4**

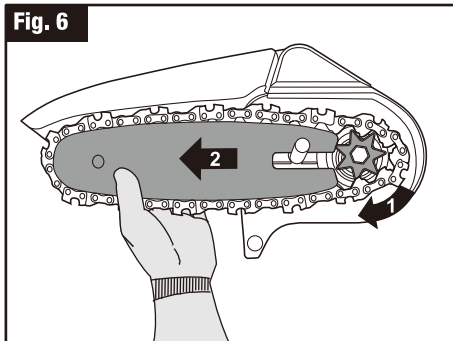


- 5) Fit the Chain onto the Drive Sprocket, so that the Fastening Bar Bolt and the Bar Locating Tab on the Bar Pad fit into the keyway of the opening on the Guide Bar. (Fig. 5, 6)

**Fig. 5**

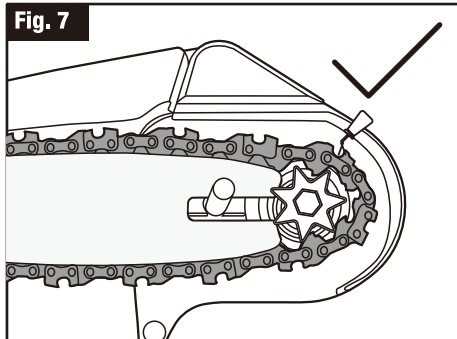


**Fig. 6**

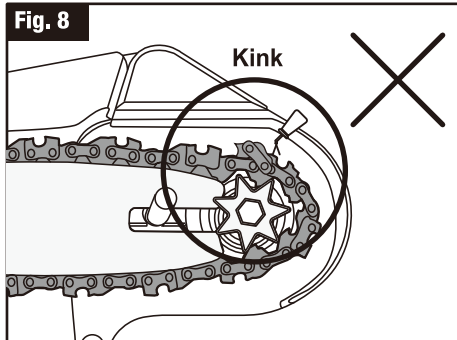


- 6) Assure all parts are seated properly. Make sure the drive links are fully seated in the Drive Sprocket (Fig. 7), avoiding a kink as shown in (Fig. 8). If kink occurs, pick up the Chain at the Guide Bar just ahead of the kink and then pull the kink out.

**Fig. 7**



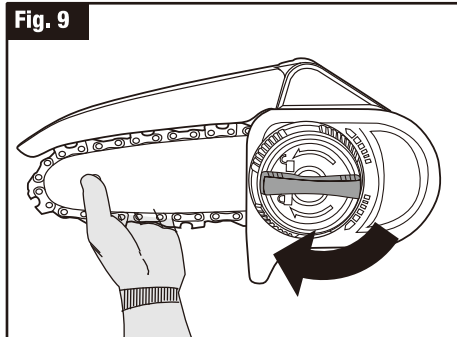
**Fig. 8**



- 7) NOTE: Chain should rotate freely and be free of kinks.  
 8) Fit the Chain Cover on the Drive Sprocket and tighten the Chain Cover by turning the Housing-Cover Knob clockwise. (Fig. 9) Please be careful not to tighten the Knob completely.

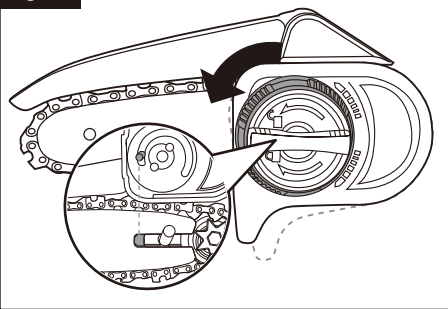
**⚠ Caution! Hold and control the Chain and the Guide Bar with one hand when tightening the Chain Cover.**

**Fig. 9**



- 9) Turn the Chain Tensioning Knob in counterclockwise direction to loose until hearing a click. Make sure the bar on the inner surface of cover slip into the slot of Guide Bar. (Fig. 10)

**Fig. 10**



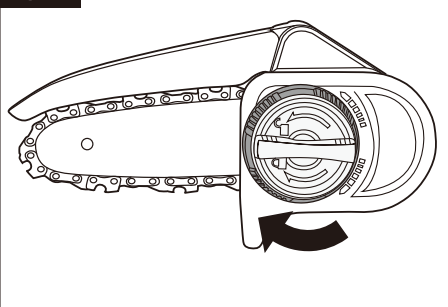
- 10) Adjust the chain tension. Turn the Chain Tensioning Knob in clockwise direction to tighten. (See Fig. 11)

NOTE: New saw chains will stretch. Check the chain tension frequently when first used and tighten when the Chain becomes loose around the Guide Bar.

**⚠ WARNING:**

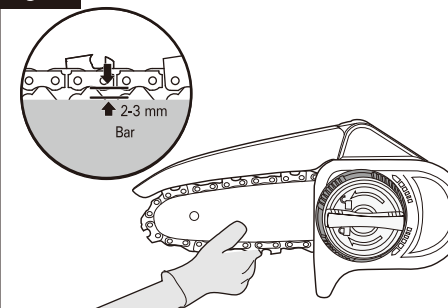
- Cutting edges on chain are sharp. Use protective gloves when handling chain.
- Maintain proper chain tension always. A loose chain will increase the risk of kickback. A loose chain may jump out of guide bar groove. This may injure operator and damage chain. A loose chain will cause chain, bar, and sprocket to wear rapidly.

**Fig. 11**



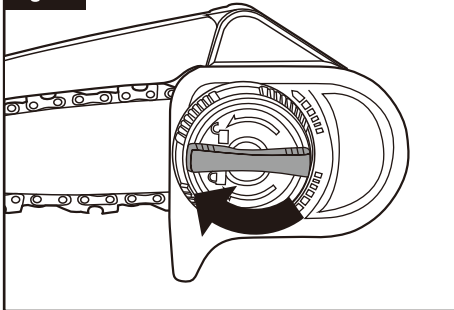
- 11) The correct chain tension is reached when the Chain can be raised approx. half the driveline depth from the Guide Bar in the center. (Fig. 12)

**Fig. 12**



- 12) Tighten the Housing-Cover Knob to secure the Chain Cover.  
(See Fig. 13)

**Fig. 13**



**NOTE:** The Chain is properly tensioned when it can be lifted off of the Guide Bar and the driveline is within the rail of the Guide Bar.

**NOTE:** The chain will naturally stretch and lose proper tension under general use. To re-tension, repeat steps 1-5 listed above.

### 5.2.2 Lubrication

**NOTE:** Chain life and cutting capacity depend on optimum lubrication. Therefore, the chain should be oiled before operation.

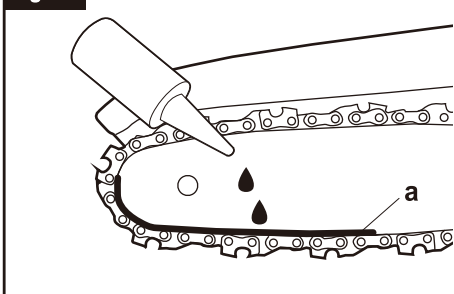
**⚠ IMPORTANT:** It is important to use bar and chain lubricant that is formulated to perform over a wide temperature range with no dilution required.

Lubricant bottle and oil are not provided. These can be found at your local hardware store. Do not use dirty, used or otherwise contaminated oil. Damage may occur to the bar or chain. Use of non-approved oil will void the warranty.

Do not swallow. If swallowed, call a physician immediately. Keep out of reach of children. Store away from heat or open flame.

- 1) Switch off the pruning saw and remove the battery.
- 2) Place the pruning saw on a level surface with the Housing-Cover facing up.
- 3) Clean the Guide Bar and Chain with a soft brush or solvent.
- 4) Apply lubrication oil in area (a) between Guide Bar and Chain. (Fig. 14)

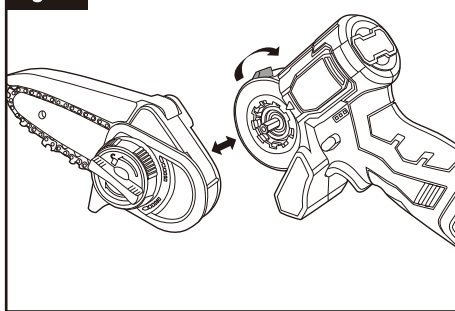
**Fig. 14**



### 5.2.3 Installing/Removing the pruning saw accessory (Fig. 15)

- Push accessory mouting switch lock button(5), then install the pruning saw accessory(7), until the accessory mouting switch lock button reboudns and resets.
- Push accessory mouting switch lock button(5) reversly, then remove the pruning saw accessory(7).

**Fig. 15**

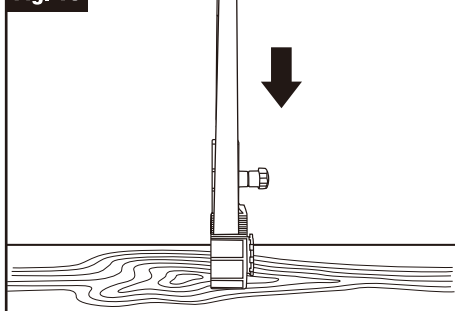


### 5.3 Assembly for belt sander

#### 5.3.1 Mounting and removing abrasive belt

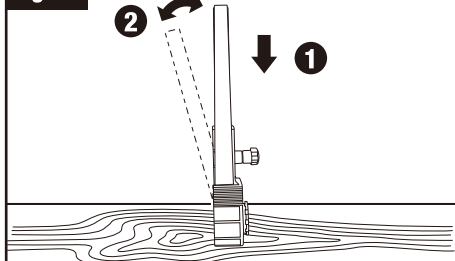
- 1) Make sure that the tool is properly supported.
- 2) Press down the Tracking arm with one hand. (Fig. 16)

**Fig. 16**



- 3) Remove and replace the sanding belt with the other hand, then release the Tracking arm to regain tension in the belt.(Fig. 17)

**Fig. 17**



4) Adjust belt tracking by turning the knob to the left or right as needed, while the tool is running.

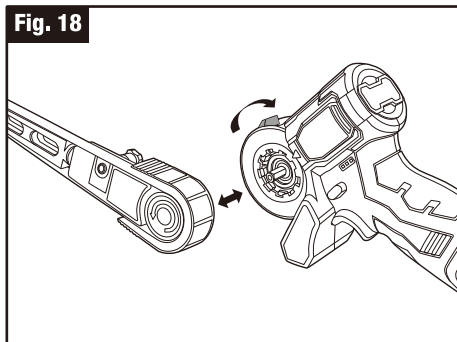
**⚠ Caution!**

- Never use the same sanding belt to sand wood and metal.
- Worn or ripped sanding belts can damage the workpiece. Change sanding belts at the appropriate time.
- Keep the sanding belt properly tensioned so that it does not hang down too much and become unusable due to nicks, creases etc.

### 5.3.2 Installing/Removing the belt sander accessory (Fig. 18)

- Push accessory mouting switch lock button(5), then install the belt sander accessory(8), until the accessory mouting switch lock button reboundns and resets.
- Push accessory mouting switch lock button(5) reversly, then remove the belt sander accessory(8).

**Fig. 18**

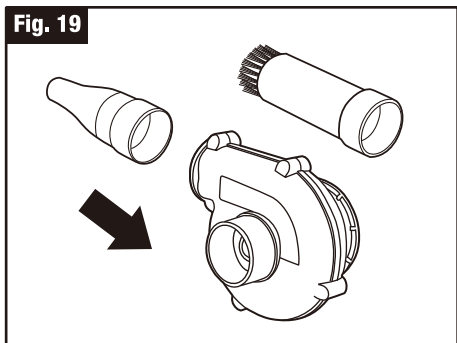


## 5.4 Installing/Removing blower accessories

### 5.4.1 Fitting the nozzle (Fig. 19)

Different nozzles are suitable to dust surfaces. A short nozzle is more powerful.

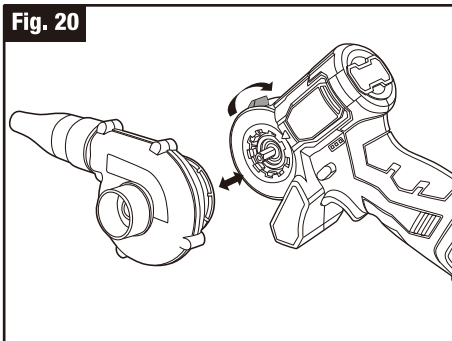
**Fig. 19**



### 5.4.2 Installing/Removing the blower accessories (Fig. 20)

- Push accessory mouting switch lock button(5), then install the blower accessories(7), until the accessory mouting switch lock button reboundns and resets.
- Push accessory mouting switch lock button(5) reversly, then remove the the blower accessories(7).

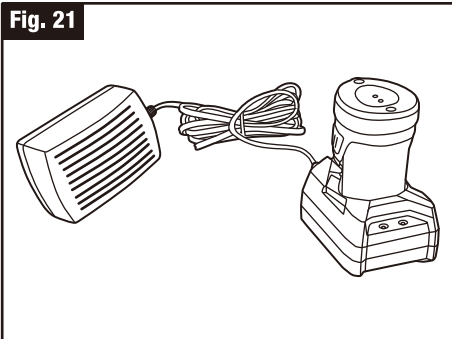
**Fig. 20**



## 6. OPERATION

### 6.1 Charging (Fig.21)

**Fig. 21**



- Assure that the charger you use are applicable to the battery pack.
  - Insert the charger into power supply.
  - Insert the battery into the slot of charger. Make sure the contact with the charger is correct
- The charging status is displayed by the control lights. Power indicator will turn on.
- Red light=charging.
- Green light=Ready for charging or charging completed.
- Charger will automatically stop when charging is completed.
- Unplug the charger and disconnect it from the battery pack when finished.
  - Allow the battery pack to cool completely before using it.
  - Store the charger and battery pack indoors, out of reach of children.

### Battery capacity indicator

There are battery capacity indicators on the tool, you can check the capacity status of the battery if you press the ON/OFF switch. Those 3 LED show the status of the capacity level of the battery.

All 3 LEDs(RED/YELLOW/GREEN) are lit:

The battery is fully charged.

2 LEDs (RED/YELLOW) are lit:

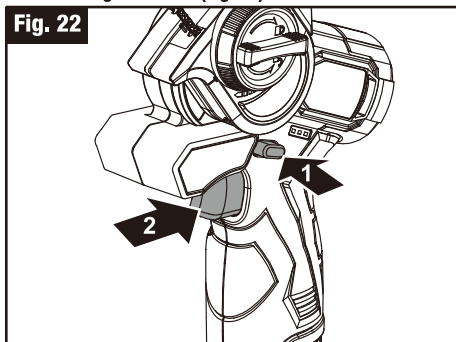
The battery has an adequate remaining charge.

1 LED(RED) is lit:

The battery is in low power, please recharge the battery.

### 6.2 Switching on and off (Fig. 22)

Fig. 22



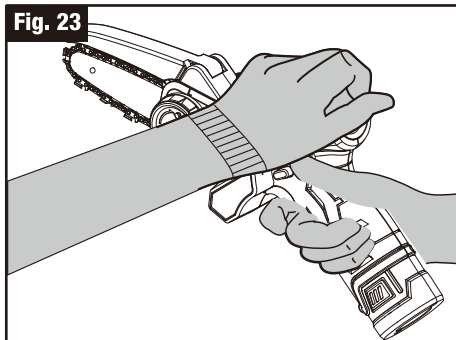
**ATTENTION: Check the battery pack before using your cordless tool. Only use the battery pack supplied with the tool or recommended by the manufacturer.** For switching on the tool, press the Lock-Out Button, then fully press the On/Off Switch and hold in this position. The Lock-Out Button can now be released. For switching off, release the On/Off Switch.

### 6.3 Operation for pruning saw

1) Use the pruning saw only with secure footing.

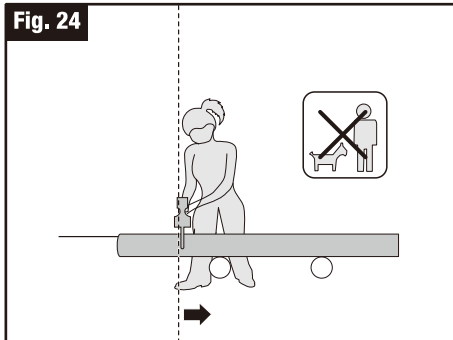
2) Hold and control the electric chain saw with one hand on the Grip Area – wrap your thumb around the Grip Area and your other hand on the Secondary Grip Area.(Fig. 23)

Fig. 23



3) Hold the pruning saw at the right-hand side of your body.(Fig. 24)

Fig. 24

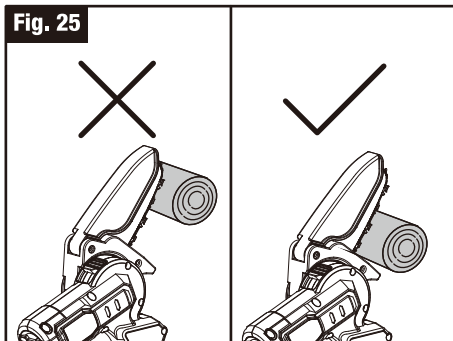


4) The Chain must be running at full speed before it makes contact with the wood.

5) Use the Cutting base panel to secure the saw onto the wood before starting to cut.

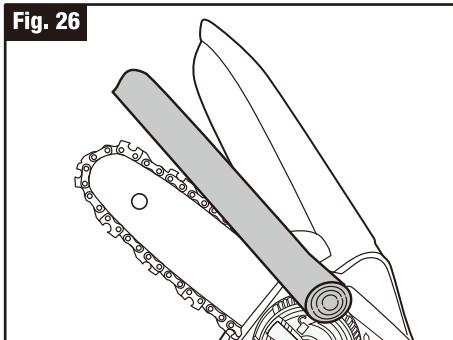
6) Use the Cutting base panel as a leverage point while cutting. (Fig. 25)

Fig. 25



7) Raise the Chain Guard when cutting from bottom to top of material. ( Fig. 26)

Fig. 26



Never use the electric chain saw above shoulder height.

**⚠ WARNING:** When cutting a limb that is under tension, use extreme caution. Be alert for wood springing back. When wood tension is released, limb could spring back and strike operator causing severe injury or death.

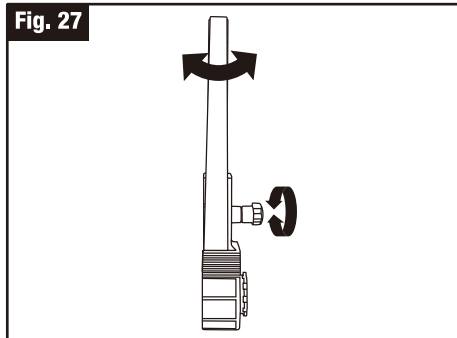
## 6.4 Operation for belt sander

- 1) Turn the tool on. Wait until it has reached maximum speed before placing it onto the work piece. Make sure the surface to be sanded is free of any debris before placing the running sander onto the surface.
- 2) Move the sander slowly forward and backward.
- 3) Do not put additional pressure on the sander. This will slow down the speed of the pad and reduce sanding efficiency, as well as put an additional burden on the tool.
- 4) Always remove the sander from the work piece before shutting the sander off.

**⚠ Caution!** To Adjust belt tracking (Fig. 27):

- While the tool is running, turn the Tracking Knob to the left or right, so the abrasive belt runs centered over contact arm wheel.
- Always apply the returning side of the sanding belt to the workpiece to maintain proper tracking.

**Fig. 27**



## 7. CLEANING, MAINTENANCE

**⚠ Danger!**

**Always remove the battery pack before making adjustments to the equipment.**

### 7.1 Cleaning

- Keep all safety devices, air vents and the motor housing free of dirt and dust as far as possible. Wipe the equipment with a clean cloth or blow it with compressed air at low pressure.
- We recommend that you clean the device immediately each time you have finished using it.
- Clean the equipment regularly with a moist cloth and some soft soap. Do not use cleaning agents or solvents; these could attack the plastic parts of the equipment. Ensure that no water can seep into the device. The ingress of water into an electric tool increases the risk of an electric shock.

### 7.2 Maintenance

- Keep tool clean and free of dust. Wipe clean with a dry cloth; do not use harsh chemicals to clean.
- The bar rails that carry the chain should be cleaned before storing the tool or if the bar or chain appear to be dirty.
- Replace chain when cutters are too worn to sharpen or when chain stops. Only use replacement chain noted in this manual.
- Replace sand belt when cutters are too worn to sand. Only use replacement sand belt noted in this manual.

## 8. STORAGE

Store the equipment and accessories in a dark and dry place at above freezing temperature. The ideal storage temperature is between 5°C(41°F) and 30°C(86°F). Store the electric tool in its original packaging.

For storage, it is suggested to recharge the battery between 50% and 75% charge. Charge the device at least once in 3-6 months to preserve battery life span.

## 9. DISPOSAL AND RECYCLING

The equipment is supplied in packaging to prevent it from being damaged in transit. The raw materials in this packaging can be reused or recycled. The equipment and its accessories are made of various types of material, such as metal and plastic. Never place defective equipment in your household refuse. The equipment should be taken to a suitable collection center for proper disposal. If you do not know the whereabouts of such a collection point, you should ask in your local council offices.



### Environmental protection

This product has been marked with a symbol relating to removing electric and electronic waste. This means that this product shall not be discarded with household waste but that it shall be returned to a collection system. It will then be recycled or dismantled in order to reduce the impact on the environment. Electric and electronic equipment can be hazardous for the environment and for human health since they contain hazardous substances.



### Disposal of an exhausted battery pack

To preserve natural resources, please recycle or dispose of the battery pack properly. This battery pack contains Li-ion batteries. Consult your local waste authority for information regarding available recycling and/or disposal options. Discharge your battery pack by operating your tool, then remove the battery pack from the tool housing and cover the battery pack connections with heavy-duty adhesive tape to prevent short circuit and energy discharge. Do not attempt to open or remove any of the components.