

EMOTORAD

doodle^{PRO}

QUICK START GUIDE

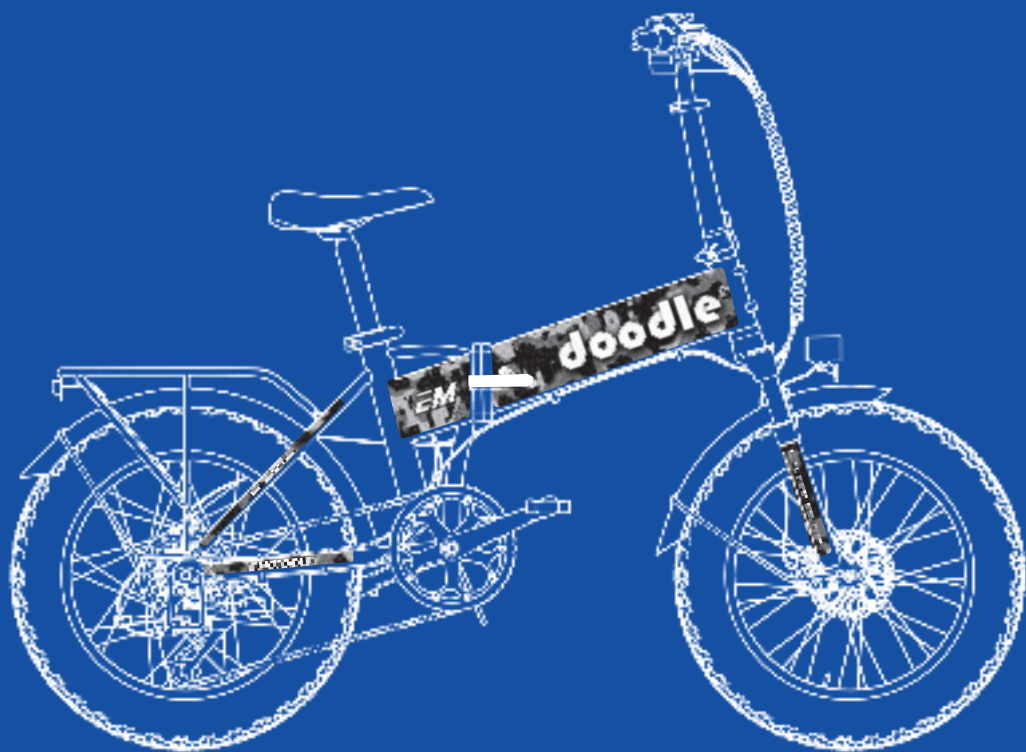

www.emotorad.com



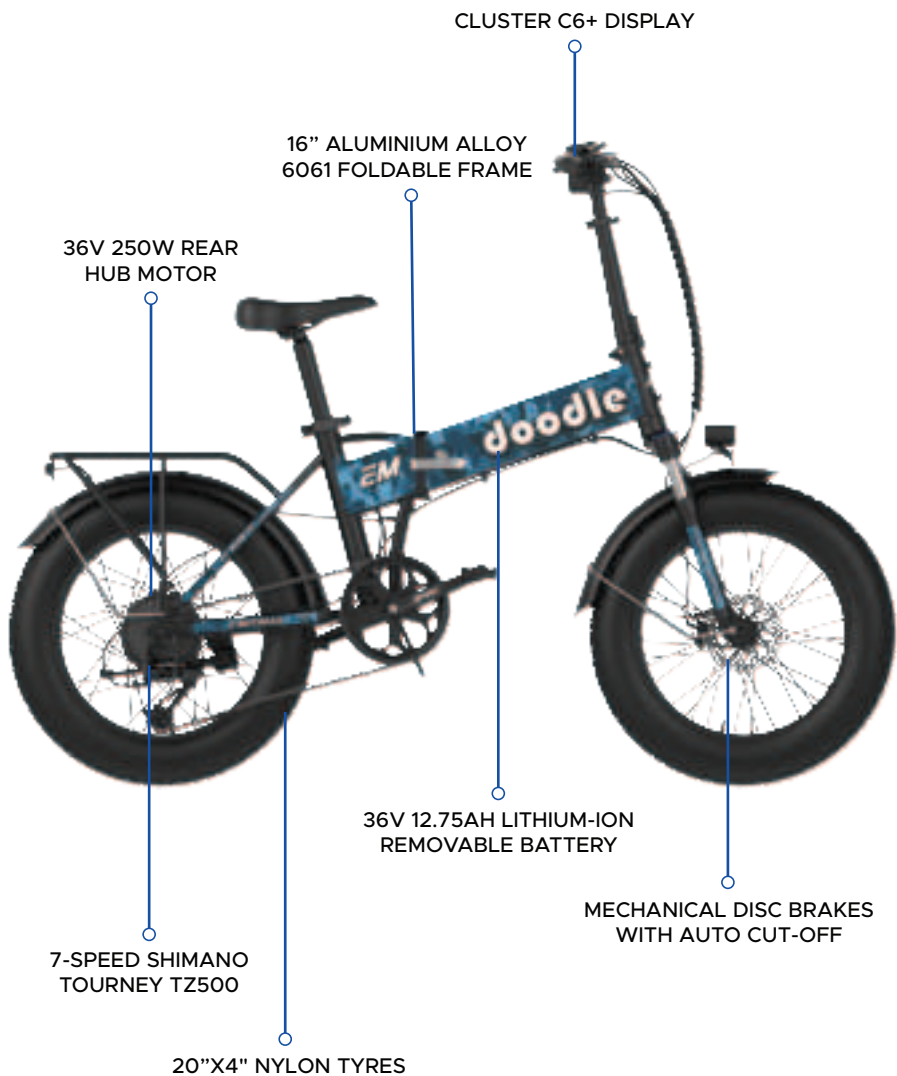

TABLE OF CONTENT

01.	Introduction _____	03
02.	The Tool Guide _____	04
03.	Unboxing & Assembly _____	05
04.	How to Fold & Unfold _____	08
05.	Features _____	09
06.	Care For Your E-bike _____	11
07.	Operating the Battery _____	13
08.	Operating the Display _____	15
09.	A Note on Wear and Tear _____	17
10.	Service Checklist _____	18
11.	Warranty Cover _____	20
12.	E-bike Range _____	25

INTRODUCTION

Hey there, rider!

Welcome to the world of e-cycling with EMotorad Doodle Pro!

We're excited to have you join our tribe of riders who are not just embracing urban mobility but also doing so in style. This manual is designed to help you assemble your electric cycle and get to know its features so you can fully enjoy your riding experience. Safety is our top priority, so please read this manual carefully before you start pedalling. If you have any questions or need assistance, don't hesitate to contact our customer support team.

Happy riding!

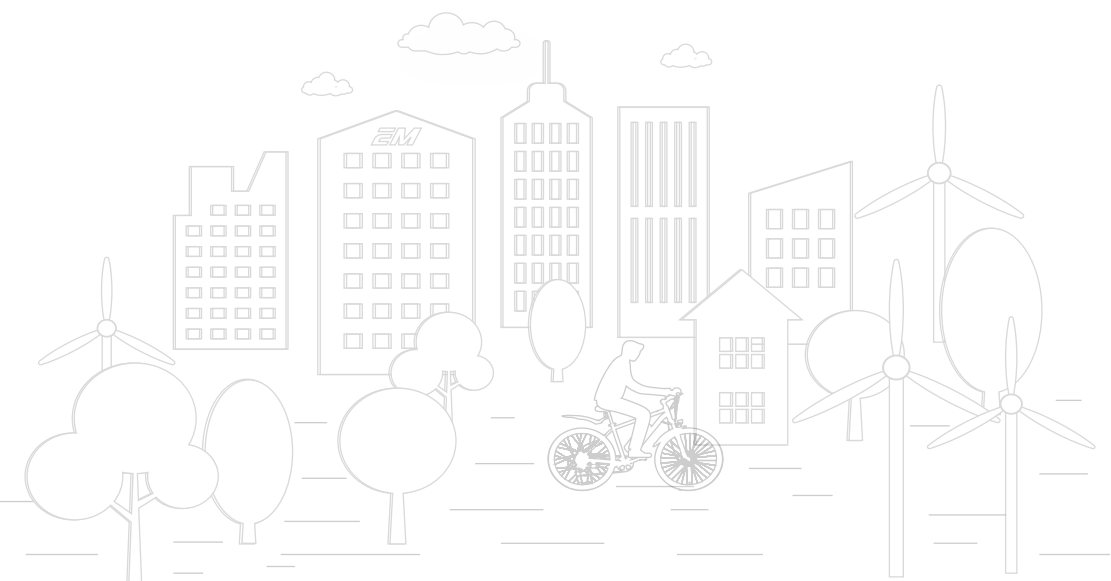

THE TOOL GUIDE

Tools you must keep handy before assembly:

- A Pair of Scissors (Not Included)
- Kit Box (Included)

KIT BOX

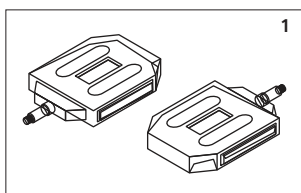

Pair of Pedals

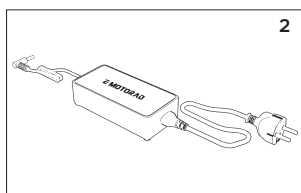

Charger

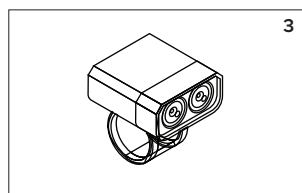

Front LED Light

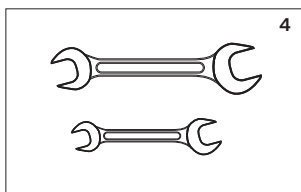

2 x Spanner

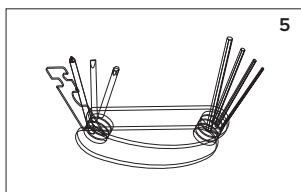

Multi Tool

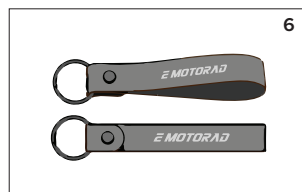

Key chain

UNBOXING & ASSEMBLY

- Open the box and take out the e-bike, accessories and charger box, including the front wheel. Remove all the protective wrapping from the e-bike.

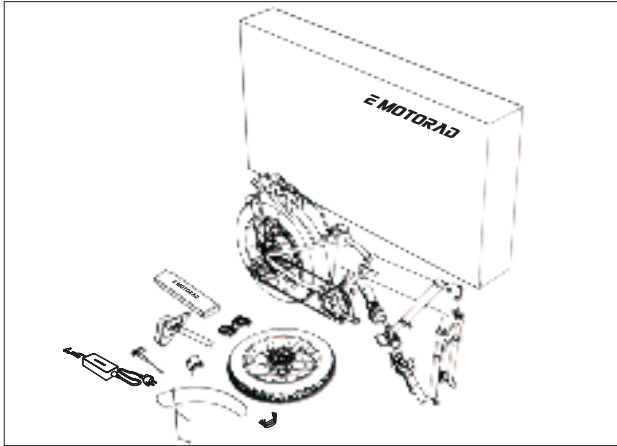

- To align the e-bike's front fork, turn the handlebar stem 180 degrees.
- Insert and align the handlebar neck, secure it with the lever near the stem, pull the handlebar upright, and close the lever near the hinge.

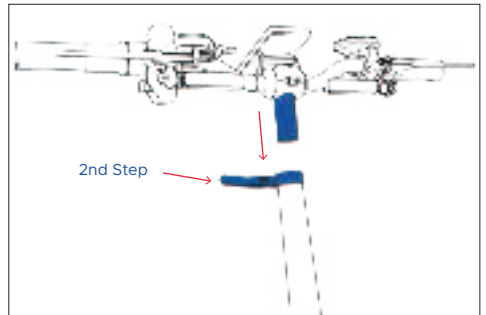
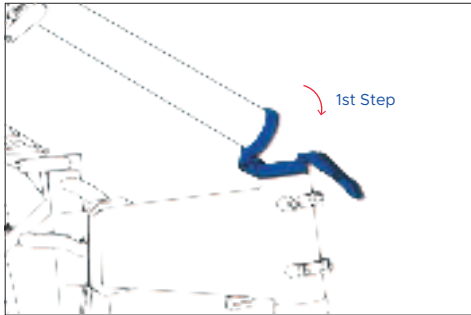

- ▶ Unpack the mudguard and front light, unfasten the screw on the top bar of the front suspension, place the mudguard and front light in front of the fork U bracket, and secure both by tightening the screws with the spanner and multi-tool.

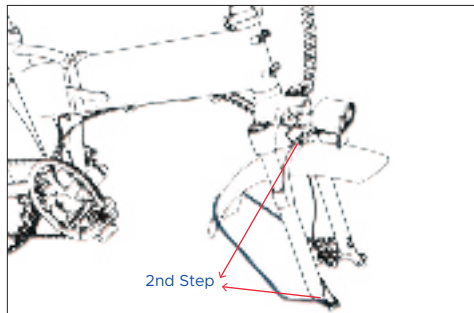
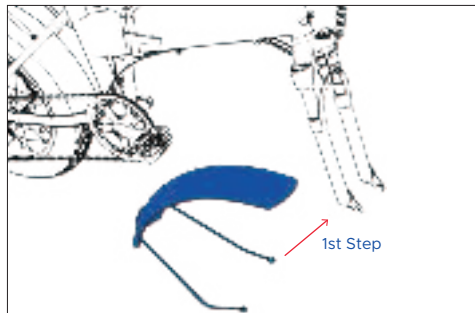

- ▶ For this step, you'll need a friend to help lift the front of the e-bike to install the wheel. Since this is a bolt and nut axle, there are two parts: the washer with the hook and the bolt.
- ▶ Make sure the hook on the washer fits into the hole on the dropout, then install the nut.

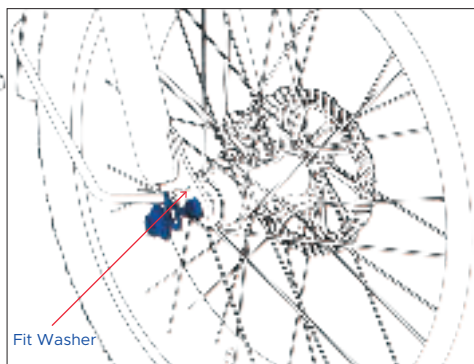
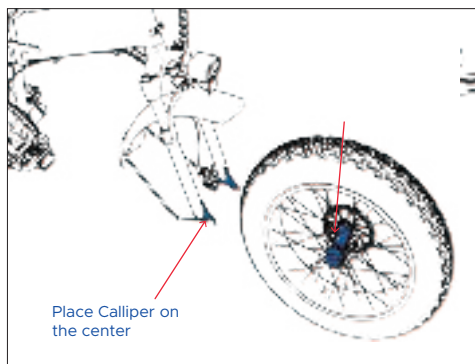

- ▶ Installing the pedals is straightforward. Use the 15mm wrench provided in the toolkit.
- ▶ For your convenience, the pedals are marked "Left" and "Right." Note that the left pedal tightens anti-clockwise while the right pedal tightens clockwise.

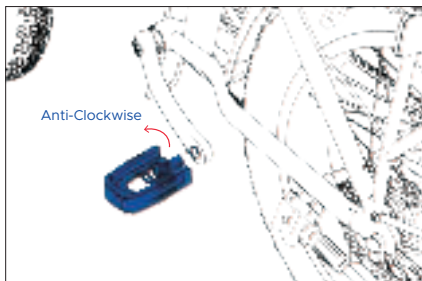
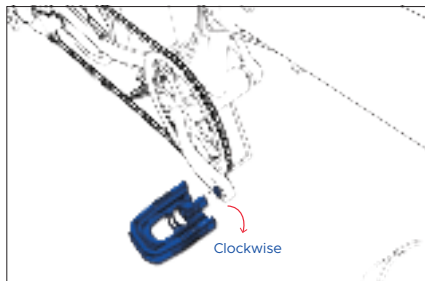

- ▶ Open the quick-release lever to insert the seat post, adjust the seat to be level with your hip height, and tighten the clamp.

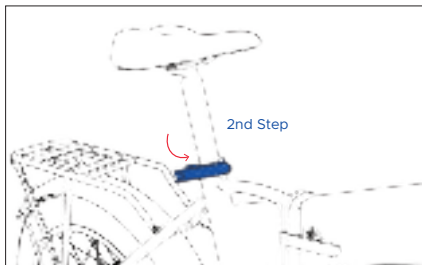
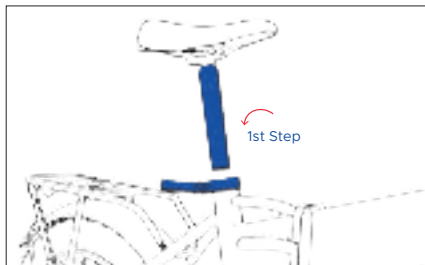

That's it! Your Doodle Pro e-bike is now assembled and ready to ride!

HOW TO FOLD & UNFOLD

To fold your Doodle Pro e-bike, follow these steps:

- Pull the pedal mechanism to fold the pedals inwards.
- Release the latch on the top tube to fold it.
- Lift the frame of the e-bike to prepare for folding.
- Pull the handlebar left to clear the folding path.
- Release the clamp that secures the handlebar.
- Fold the handlebar down by lowering it to complete the folding process.

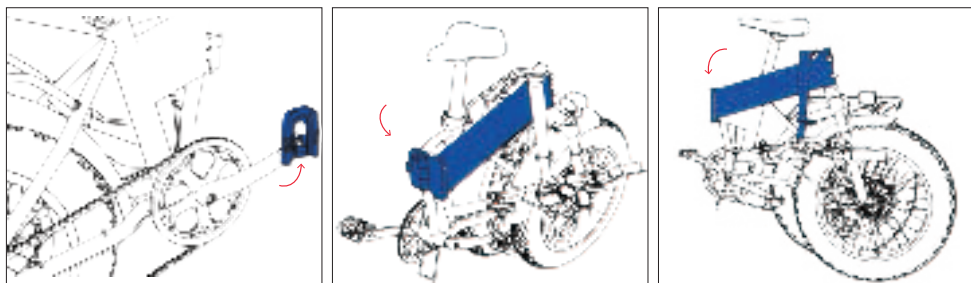

To unfold your Doodle Pro e-bike, follow these steps:

- Unfold the handlebar by lifting it up, and secure it by tightening the handlebar release clamp.
- Pull the handlebar right to align it properly with the frame.
- Straighten the frame into position until it clicks into place.
- Secure the top tube latch to lock the frame in place.
- Unfold the pedals by pushing the pedal mechanism and lock them in.



Note: Ensure all the levers and clamps are set firmly.

FEATURES



STAY INFORMED

The Doodle Pro e-bike has a top-notch Cluster C6+ Display with a waterproof cover and an integrated USB port for charging. It is easy to use and shows real-time riding data, helping you adjust your ride as you like. It also shows the battery status, so you always know how much power you're left with. With 5 different riding modes, you can control the way you ride at all times. Whether you're commuting or exploring new trails, the Cluster C6+ Display keeps you informed and in control of your e-bike experience.



KNOWING PEDAL ASSIST

The pedal assist feature on the Doodle Pro makes e-cycling easier and more fun. It offers five levels of assist, so you can save battery power or get extra support for uphill rides. The Doodle Pro pedal assist adapts to your needs, giving you a mix of traditional cycling and modern convenience. This way, you can choose how much electric assistance you want and enjoy a ride that suits you perfectly.



REMOVABLE BATTERY

Experience extended rides hassle-free. With a 12.75Ah semi-integrated removable battery, you have the power to last you for so long you'd have breezy rides always. And if you run out of charge? No worries there, either! The battery is portable and lightweight and can be carried along to charge anywhere, like a smartphone. Charge anytime, anywhere with ease, allowing you to get back on the road faster and hassle-free. Its compact size also ensures it seamlessly fits into the e-bike's frame, maintaining a sleek and stylish appearance.



FAT-TYRES

Doodle Pro comes with a set of heavy-duty 20" x 4" nylon tyres. Whether cruising through the urban jungles or riding through the beaches of Goa, it can easily absorb shocks for enhanced comfort and durability. Break a sweat, but only when it's necessary.



FOLDABLE FRAME

Designed for versatility and easy storage, it's perfect for urban commuting or spontaneous adventures. The foldable frame combines practicality with effortless portability. Ideal for navigating tight spaces, it's perfect for when you want to squeeze through the traffic with ease. Your rides are not just smoother; they just got better. Fold, unfold, and roll away!





HIGH-PERFORMANCE MOTOR

Feel the power of the 250 watt motor, delivering smooth and robust performance. It's engineered to provide optimal assistance, making uphill climbs and long-distance rides easier and more enjoyable. The motor operates quietly, ensuring a peaceful and pleasant riding experience. Whether you're navigating city streets or exploring off-road trails, the 250 watts motor offers the perfect balance of power and efficiency.



7-SPEED GEAR SHIFT

Experience the peak of performance with a 7 speed Shimano Tourney TZ500 drivetrain. Depending on the terrain and speed of cruising, change the gear to make your rides smoother. No matter what terrain you're on, the gear shift helps to maintain consistent performance throughout.



THROTTLE

Take full control of your ride with the Doodle Pro throttle feature. The throttle allows you to accelerate effortlessly without pedalling, providing an extra boost when needed. Perfect for those moments when you need a quick start or want to take a break from pedalling, the throttle enhances convenience and versatility. Whatever terrain you're on, the throttle ensures a smooth and enjoyable ride.



LIGHTS & DUAL INDICATORS

The Doodle Pro e-bike is equipped with bright front lights with integrated horn and rear lights for maximum visibility, enhancing safety during night rides and low-light conditions. The front and rear indicators allow you to signal turns easily, while the rear light is connected to the brake system, which turns on when the brakes are applied. Additionally, the e-bike features hazard lights which blinks rapidly for added safety during emergencies.



FRONT SUSPENSION

The Doodle Pro e-bike is equipped with a front suspension featuring 60mm travel and a lockout function. This allows you to adjust your ride for maximum comfort and control on various terrains. This ensures a smooth and stable ride, no matter the terrain. Experience superior comfort without compromising on performance.



SUPERIOR BRAKING

Safety and reliability are at the forefront with the Doodle Pro mechanical disc brakes, which feature an auto cut-off system that immediately disengages the motor when the brakes are applied, providing an extra layer of safety. Whether it's a sudden stop in traffic or a quick halt on a steep descent, it provides superior braking performance and control, enhancing your overall riding experience.

CARE FOR YOUR E-BIKE

Regular maintenance and proper care are essential to ensure the longevity and optimal performance of your e-bike. This guide provides practical tips and recommendations to help you keep your e-bike in top condition. From cleaning techniques to lubrication tips, we've got you covered. Read on to learn the best practices for maintaining your e-bike and ensuring a smooth, enjoyable ride every time.



REGULAR CLEANING

- **Wipe Down:** Regularly clean your e-bike with a damp microfiber cloth to remove dirt, dust, and debris. Avoid using high-pressure water, as it can damage electrical components.
- **Frame Cleaning:** Use a frame cleaner solution to clean the frame for a thorough cleanse.
- **Chain Maintenance:** Clean and lubricate the chain regularly to prevent rust and ensure smooth operation. Use a chain lubricant for best results.
- Consider cleaning your e-bike every 300-500 km for more thorough maintenance.
- When washing your e-bike, please avoid the brake rotor as much as possible and prevent oil or liquid spills on it.



BATTERY CARE

- Only use the charger provided by EMotorad.
- Avoid storing the battery at full charge or completely empty for extended periods.
- Periodically check the battery's charge level and top it up to around 60-80% if not in use for an extended period. This helps maintain battery health.
- The battery should not be difficult to attach or remove. Do not force it to avoid damage or injury.
- If the battery has trouble charging, discontinue charging and contact EMotorad immediately.
- Only grab the charger by the plug, not the cable, when plugging and unplugging.



BRAKE MAINTENANCE

- **Inspection:** Regularly inspect brake pads for wear and tear and replace them when necessary.
- Ensure that the brake lever does not touch the handlebar. If it does, please contact our helpline for assistance.



TYRE MAINTENANCE

- **Pressure Check:** Check tyre pressure regularly and maintain it within 20-25 PSI. Proper tyre pressure ensures better traction and ride comfort.
- Replace tyres if they show signs of damage or significant wear and tear. Keep in mind that different types of terrains affect the tyres differently.



ELECTRICAL COMPONENTS

- **Connection Check:** Periodically check all electrical connections and wiring for any signs of wear and tear, damage, or loose connections.
- **Display and Controls:** Ensure the display and control buttons are clean and functioning correctly.
- Avoid exposing them to excessive moisture.



STORAGE

- **Indoor Storage:** Store your e-bike indoors in a dry, cool place to protect it from natural elements.
- **Long-Term Storage:** If you plan to store your e-bike for an extended period, clean it thoroughly, charge the battery to 60-80%, and store it in a cool, dry place.
- Keep the tyres inflated even when the e-bike is not in use to prevent wear and tear.



DISPLAY CARE

- **Cleaning:** Use a soft, dry cloth to gently wipe the display. Avoid using harsh chemicals or abrasive materials that could scratch the screen.
- **Avoid Extreme Temperatures:** Do not expose the display to extreme temperatures, as this could affect its functionality.
- **Regular Inspection:** Periodically check the display for any signs of damage or malfunction. If you notice any issues, contact EMotorad for assistance.

OPERATING THE BATTERY

Your Doodle Pro e-bike comes with a 36V 12.75Ah lithium-ion battery, which features a unique set of keys for locking/unlocking it to the frame. This section provides instructions on how to charge and maintain the battery effectively without breaking a sweat.

BATTERY POSITIONS:

- Insert the key into the keyhole located at the bottom of the top tube.
- Turn it anti-clockwise once to lock the battery and a second time to switch on the ebike. This signifies that the battery is now locked and fixed in its position.

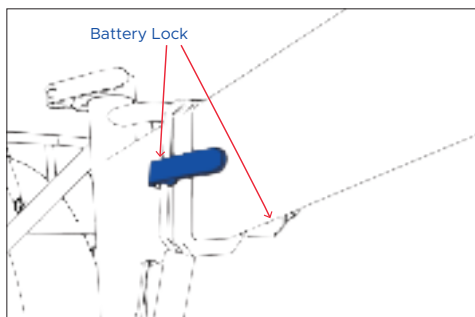
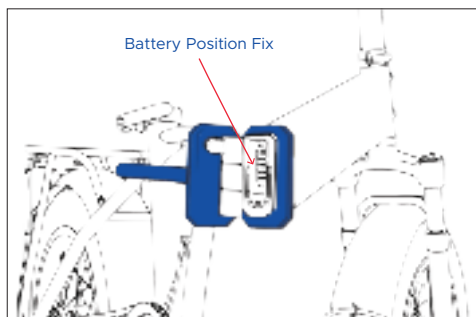

CHARGING YOUR BATTERY

Locate the charge port on the side of the battery. You can charge the battery while it is attached or detached from the E-bike.





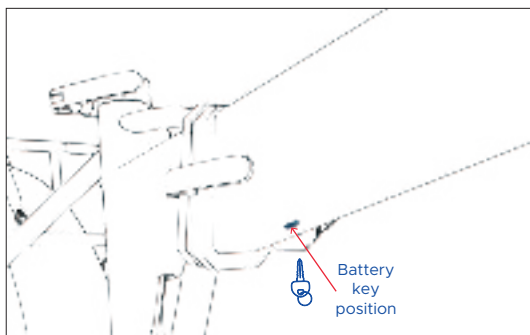
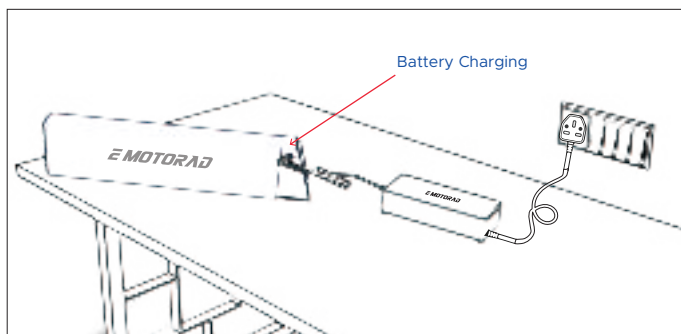



- **Initial Charge:** The battery comes with a charge between 20-60%. Plug it in to ensure it is fully charged before your first ride.
- **Battery Removal:** Remove the key and pull the safety clip to fold the e-bike. Grab the battery clip and gently slide it out of the frame.
- **Battery Locking:** Insert the key into the keyhole located at the bottom of the top tube and turn it anti-clockwise.
- **Charger:** Use only the provided EMotorad charger.
- **Charging Indicators:** The charger light is red while charging and turns green when charging is complete. Charging takes approximately 4-5 hours if the battery is mostly empty.

- **Safety:** Ensure no dirt, debris, or flammable items are near the charger. Avoid leaving the charger plugged in when the battery is fully charged.
- Do not charge the battery if it is damaged, excessively hot, leaking, smells, or is discoloured.



OPERATING THE DISPLAY

The Doodle Pro e-bike features a Cluster C6+ Display, providing a detailed dashboard with ride information, including speed, odometer readings, charge level, and more. The display is controlled through the console located on the left side of the handlebar, allowing you to easily toggle between ride modes, adjust PAS (Pedal Assist System) levels, and monitor your ride data. Below are the key functions and instructions for using your display effectively.

FUNCTION	INSTRUCTIONS
 Turning the bike ON/OFF	Hold the power button until the display turns on
 Increase Pedal Assist Level	Press the up arrow button
 Decrease Pedal Assist Level	Press the down arrow button
 Turn ON/OFF front/rear lights	Hold the top left button for 3 seconds until the lights turn on; repeat to turn it off
 Turn ON/OFF the Left Indicator	Press the left arrow button to turn on; repeat to turn it off
 Turn ON/OFF the Right Indicator	Press the right arrow button to turn on; repeat to turn it off
 Turn ON/OFF the Hazard Light	Hold either the left or right arrow for 3 seconds to turn on; press either arrows to turn it off
 Toggle Odometer, Trip A, Trip B, Voltage, Current, Trip Timer (TM)	Press and let go of the mode button

Note: The trip metre will reset when the bike is powered off. The maximum and average speed will be calculated for a given trip, and will reset when the bike is powered off. When the bike has not been used for 10 consecutive minutes the display will automatically shut down. The pedal assist and throttle features will no longer work when the display is turned off.

ERROR CODES AND TROUBLESHOOTING

The Doodle Pro e-cycle features an advanced error code system to help identify and troubleshoot issues effectively. Each error code corresponds to a specific problem, providing a clear indication of what needs attention. By understanding these codes, you can quickly diagnose and address any issues, ensuring your e-cycle remains in optimal condition for a safe and enjoyable ride. Consult this section for guidance on interpreting error codes and performing necessary troubleshooting steps.

STATUS CODE	DISPLAY ERROR CODES
E06	Battery under voltage
E07	Motor failure
E08	Turn Malfunctioning
E09	Controller failure
E10	Communication reception failure
E11	Communication dispatch failure

Reach out to the service team once the error is discerned through self-initiated troubleshooting.

DISPLAY INFORMATION

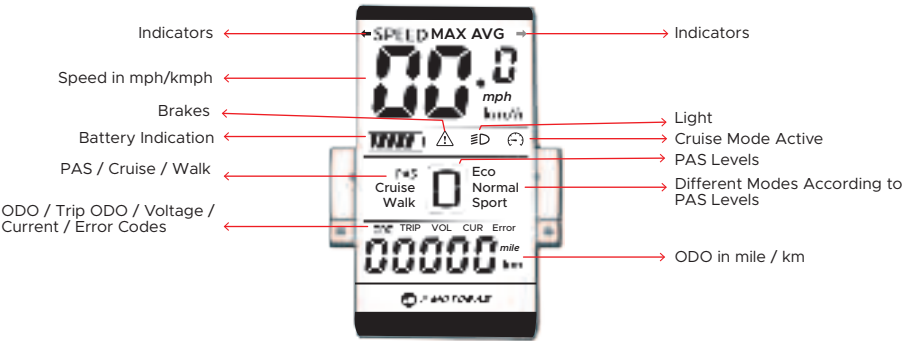

OPERATION CONSOLE

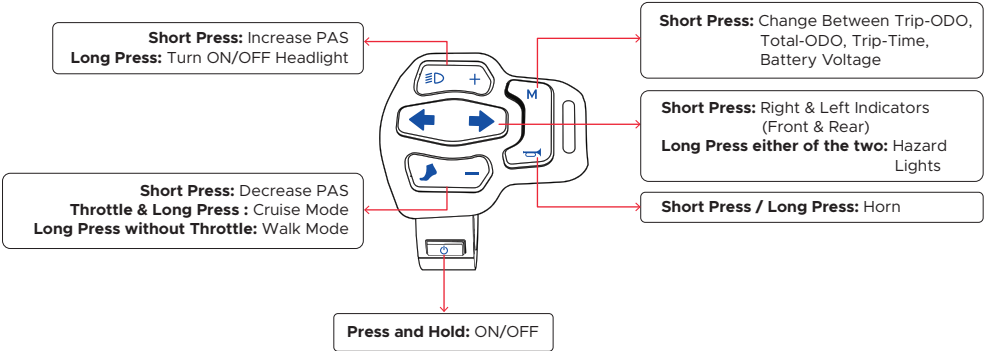

RIDING MODES

CRUISE MODE

After switching on the display, use the throttle to set the ebike in motion. Once it reaches a favourable speed, press the '-' button for 3 seconds, and the cruise mode will be activated.

WALK MODE

After switching on the display mentioned above, keep the ebike stationary and press the '-' button for 3 seconds. The ebike is now in walk mode and will be mentioned on display too.

THROTTLE MODE

After switching on the ebike, twist the throttle on the right side of the handlebar to activate the Throttle Mode.

Note: Remember that the PAS level should be at least at level 1 to use throttle mode.

PEDAL ASSIST MODE

After switching on the display as mentioned above, you can use the '+' and '-' buttons to set the level of the pedal assist between 1 to 5. With 1 being the lowest and 5 being the highest.

PEDAL MODE

You can ride conventionally by simply switching off the display and using the pedals to propel yourself.

A NOTE ON WEAR AND TEAR

Some components of your e-bike are subject to wear and tear due to their function. This is a natural part of using your e-bike. The rate of wear and tear depends on the care and maintenance of your e-bike as well as on the way of your usage. Kilometres travelled, rides in the rain, dirt, and gravelly terrains all affect the condition of your e-bike. If the e-bikes are left standing out in the open often, they may be subject to increased wear and tear through weathering.

Some components require regular care and maintenance. Nevertheless, depending on conditions and intensity of use, they will eventually reach the end of their service life. Parts that have reached their limit of wear and tear must be replaced.

This applies to the following parts:

- › Chain
- › Grip coverings or bar tape
- › Chain rings
- › Sprockets
- › Pulleys
- › Brake, Gear cables and housing
- › Tyres and tubes
- › Saddle covering (leather)
- › Disc rotor and Brake pads
- › All bearings (Headset, Hubs, and Bottom Bracket)

Caution: Do not use your e-bike for high-strain cycling, such as competitive events, or in hilly terrain, as this can damage it.

Note: The overall performance of your e-bike will be affected by the condition of its specific components. Please ensure that you are not straining any component excessively, carry out regular maintenance checks, and adhere to the replacement suggestions provided in this manual. If you have any doubts, contact your dealer or any other expert immediately.

SERVICE CHECKLIST

MONTHLY		
Regular Cleaning	Frame	Use a low-pressure water stream or a damp cloth, scrub gently, and then dry. Avoid getting electrical components wet. Advisable to do so after every ride. Use a frame cleaner for best results.
	Drivetrain	Use a bicycle drivetrain degreaser on the chain, flywheel, and chainrings. Clean deeply to remove dirt and dust. Clean before lubricating the chain. Advisable to do so every 3 months for regular riders. Use a drivetrain cleaner for optimal performance.
	Chain	Use a low-pressure water stream or a damp cloth, scrub gently, and then dry. Avoid getting electrical components wet. Use a chain lubricant for a smoother ride. For dry conditions, it's recommended to apply chain lube every 300 to 500 kilometres. For wet conditions, it's recommended to apply chain lube every 250 to 300 kilometres.
	Wheels	Check for loose spokes every 1000 km.
	Tyres	Check tyre pressure weekly and before every ride. Maintain per the specified limits on the tyres.
	Bolts	Tighten any loose bolts and screws immediately. If you hear any unusual sounds after dropping your e-bike from the height of your knee, tighten the bolt accordingly. Advisable to do so after every 2000 km run to ensure a safe and smooth ride.
	Forks	Please lubricate the fork stanchions whenever you lube the chain with a chain lubricant. Advisable to do so after every e-bike wash and ride in rainy weather.
EVERY 6 MONTHS (AT AUTHORISED DEALER)		
Thorough Cleaning	Brakes	Clean brakes and brake pads to avoid squeaks. Replace worn brake pads.
	Tyres	Check for worn-out treads and replace tyres if necessary. It is advisable to replace them after covering 3000 km to 5000 km for optimal performance.



	Chain	Check the chain wear and tear using a chain wear indicator tool. Replace the chain after covering 3000 km to 5000 km for smoother rides.
	Front Hub	Clean and regrease the bearing inside the hub. Advisable to do so pre-summer and every rainy season to avoid wear and tear.
EVERY YEAR (AT AUTHORISED DEALER)		
Complete Overhaul	All components	Disassemble the e-bike completely. Clean and regrease all threaded components upon assembly.
		Inspect the frame, suspension, and all components. Repair/replace parts as needed. Advisable to do so pre-summer and every rainy season to avoid wear and tear.
		Degrease the drivetrain and replace the chain, considering weather conditions.

WARRANTY COVER



EMOTORAD WARRANTY POLICY

At EMotorad, our first guiding principle is "The Rider is the Boss." We stand behind the products that we sell. For this reason, we're pleased to offer one of the industry's most generous and rider-friendly warranty policies.

REPAIR OR REPLACEMENT OF COMPONENTS

IMPORTANT!

To validate this warranty, the retail customer must register the e-bike at www.emotorad.com within 15 days of purchase.

- ▶ We offer a lifetime warranty on aluminium alloy frames for EMotorad e-bikes, ensuring lasting peace of mind against structural defects in material or workmanship for the original owner.
- ▶ Other EMotorad branded products (as well as frame paint and graphics) are covered by a one-year warranty.
- ▶ This warranty is limited to the original purchaser only. Proof of purchase is required to validate protection under warranty. Transport costs are not included.
- ▶ We offer a 12-Month warranty on the motor from the date of original Purchase, a 12-Month warranty on the controller, and a 24-month warranty on the battery.
- ▶ The battery warranty does not include damage from power surges, use of non-original chargers, improper maintenance, or water immersion.
- ▶ Accessories (for example, helmet, wire lock, pump.) are not covered by this warranty policy

Only use this product in accordance with this user manual. EMotorad offers a warranty on the following items.



Mainframe (Aluminium Alloy 6061)	Lifetime Warranty
Motor shell, Hub motor, Controller	One year
Battery	Two years
Electronic handlebar controls and electrical connections, Battery Charger*	Six Months
Paintwork (excluding accidental or deliberate damage)	One year
Lights and lighting system	Six Months

- ▶ All Mechanical parts are only covered for Manufacturing Defects. There is no warranty period on handlebars, stems, bearings, drivetrain parts, brakes, wires, wire housings, tyres, tubes, rims or wheels, hubs, seat or saddle, seat post, clamps, grips, headset parts, pedals, brake callipers, bottom bracket, disk, brake pads, and mudguards.
- ▶ Display, Throttle, LED Light, Pedal Sensor, Charger come with a 6 Months warranty.

If any manufacturing defect(s) is found in our product, the company will repair or replace the defective part(s) with new part(s) or equivalent at no cost, provided the product is within warranty period of 1 year and the malfunction is caused due to faulty material or workmanship during manufacturing. The decision to replace or repair the defective part will rest solely with the company. We also reserve the right to replace the defective part with parts, similar or different to the defective part, as per the availability of such parts.

TERMS & CONDITIONS

1.	If the product has a quality fault within 15 days of delivery, the part will be repaired or replaced.
2.	The period of assurance shall commence from the day delivery was made to the retail customer, or from the day the retail customer collected the bike from the retailer.
3.	To validate this warranty, the retail customer must register their e-bike within 15 days of purchase.

All parts that have been replaced under warranty must be returned to the Company and will be company's property. Parts replacement will be subjected to below terms & conditions:

-
- The Company or our authorised dealers will repair or replace only the parts that are failing due to faulty material.
 - Only the Company or its authorised dealers can repair, service or assemble/ reassemble Product and it shall be the responsibility of the customer or purchaser to bring the faulty Product to our dealer premises.
 - This warranty does not cover corrosive parts, plastic, PVC and rubber components or the accessories adding to the decorative value of the Product.
 - Photocopy of sales invoice and serial number of the Product has to be shared with the Company.
 - Battery used in Product is a special application battery meant only for electric cycles. Do not use these for any other application or product.
 - The Company reserves the right to change or withdraw any or all terms of the warranty policy without any prior intimation.
 - All Products should be periodically checked as per the recommended service schedule by our authorised dealer for indications of potential failures including cracks, wire damage, corrosion, dents, deformation, paint peeling and any other indications of potential problems, inappropriate use or abuse. These are important safety checks and very important to help prevent accidents, bodily injury to the rider and shortened useful product life cycle of a Product.
 - Since Lithium ion batteries have the tendency to self-degrade, mileage per charge will reduce with ageing.

This warranty is not applicable in any of the following conditions:

- If any repair work is carried out privately or by any Unauthorised dealer or personnel or irregular maintenance.
- Damage resulting from misuse, not maintaining the vehicle or not following the guidelines within our user guide or using the vehicle for any kind of competitive sport.
- Failure to register the e-bike within 15 days of purchase.
- Spare parts and components worn in normal use.
- Any special equipment or accessories added by the customer with an intention to enhance the performance, speed or comfort of the Product, is not included in this warranty. In the event of any such alteration or addition, the warranty will stand null and void.
- If a photocopy of the sales invoice is not received with defective Product, warranty will be counted from date of manufacturing till define time period as above.
- Fading of parts like paint, stickers and plastic parts due to direct exposure of sunlight is not covered under the warranty.

-
- This warranty is void in its entirety by any modification of the frame, fork or components. This warranty is expressly limited to the repair or replacement of a defective item and is the sole remedy of warranty. This warranty extends from the date of purchase, only to the owner and is not transferable. Transportation cost and labour charges incurred in the replacement of parts are not covered under this warranty.
 - The Company is not responsible for loss or damage whatsoever (including incidental or consequential damages) arising from use of the Product. Any claims under this warranty must be made through an authorised dealer.
 - The warranty stands null and void if :
 - The serial number /identification code is deleted, defaced, altered, effaced or removed
 - Used for more than permissible load of 110kgs.
 - Used for stunts, competition or jumping, acrobatics, bicycle moto-cross, dirt biking or similar activities as all units are not designed or intended for such purpose or usage
 - Any kind of tampering observed with the parts/Product
 - Modified/altered components for any specific use other than a personal transport
 - Transportation, delivery, labour and handling charges incurred in the replacement of parts are not covered under this warranty, and shall be borne by the customer
 - This warranty is void in its entirety by any modification of the frame, fork or components
 - Resold to any other person/company
 - Damage caused by an accident or malfunction or misuse caused to the Product by the acts of persons, intentional or otherwise, including but not limited to misuse or mishandling, fire or any act of God
 - Nonfunctional parts due to natural wear and tear, ageing, defects resulting from misuse/ improper handling or negligence by the rider or Product is altered by component parts substitution are not covered under the warranty.

-
- Misuse of the battery includes, but is not limited to:
- Intentional or accidental damage, such as punctures, cracks, or exposure to impact forces
 - Signs of tampering, such as opening or modifying the battery pack
 - Exposing the battery to extreme temperatures (hot or cold) beyond recommended ranges
 - Rough handling, improper storage, or neglect leading to battery failure
 - Operating the battery in systems or applications not recommended by the manufacturer
 - Repurposing the battery for other equipment without manufacturer approval
 - Using or storing the battery in excessively humid, wet, or dusty environments
 - Submerging the battery in water or exposing it to unprotected liquids
 - Intentional short-circuiting of the positive (+ve) and negative (-ve) terminals
 - Attempting to repair or modify the battery by unqualified personnel
 - Leaving the battery on overnight charging or unattended for extended periods

This warranty is valid only within the geographical boundaries of the Republic of India. Company reserves the right to change this warranty policy at its sole discretion without any notice. In case of any dispute with the customer, the courts of Mumbai, Maharashtra, India shall have exclusive jurisdiction to settle any dispute.



SHIPPING DAMAGE CLAIMS

Immediately inspect whether the packaging is intact when receiving the goods. If you see obvious damage to the product, you can choose to reject and contact us in time. We will not accept claims for shipping damage later than 24 hours from the receipt of the product.

WARRANTY REGISTRATION



HOW TO REGISTER?

Registering your EMotorad Doodle Pro e-bike for warranty is a simple and essential step to ensure you receive the best support and coverage for your new purchase. Follow these easy steps to complete your warranty registration:

- Find the frame number of your e-bike. It is typically located on the frame, near the crankset or on the rear of the e-bike.
- Ensure you have proof of purchase, such as a receipt or invoice, which includes the date of purchase and the retailer's information.
- Go to the EMotorad official website and navigate to the 'Warranty Registration' section. You can find this under the 'Assurance' section on the website.
- Complete the online registration form with your full name, contact information (email address and phone number), e-bike model and frame number, select source of purchase, invoice number, and upload a copy of your invoice file.
- Double-check all the information you have entered to ensure accuracy. Once you are confident everything is correct, submit the form.
- If you encounter any issues during the registration process, or if you do not receive a confirmation email within a reasonable timeframe, please contact EMotorad customer support at **contactus@emotorad.com** or call **+91 8686050590**.

By registering your EMotorad Doodle Pro e-bike, you ensure that you are protected under our warranty policy and can enjoy peace of mind while riding.

Thank you for choosing EMotorad!

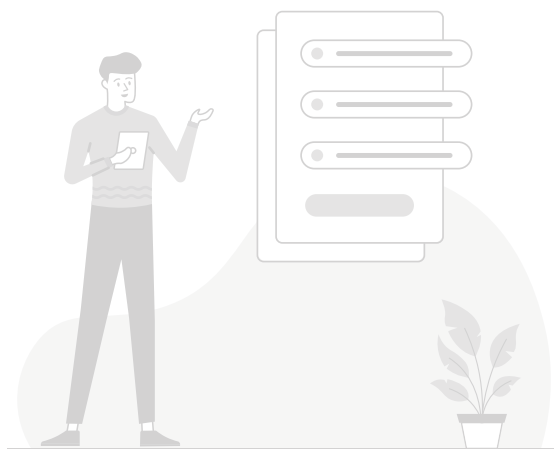

E-BIKE RANGE

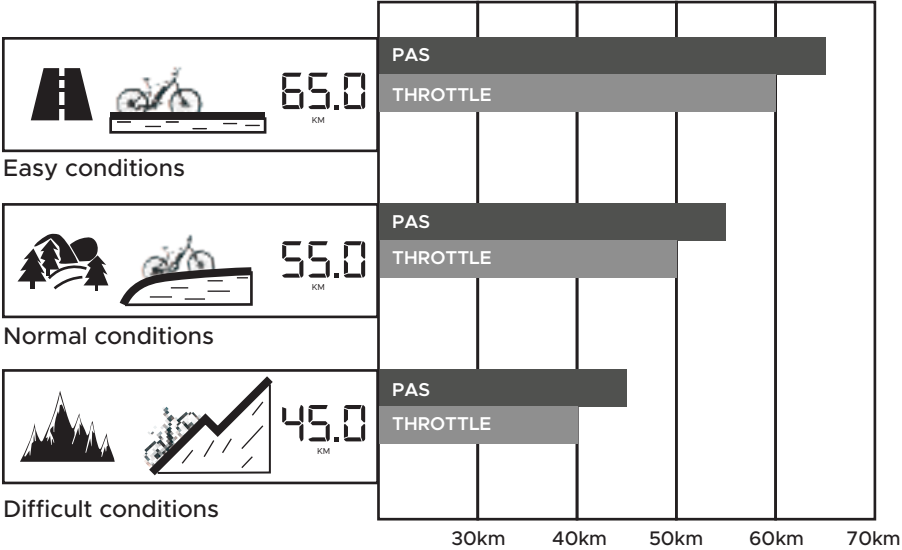

*The above mentioned range is subject to vary depending on rider weight and other conditions.
**The PAS varies from 1 to 5 levels. At each level the range output will change accordingly.

SAFETY GUIDE

Thank you for choosing the Cargo G-1. Your safety is our top priority.

IMPORTANT NOTICE

This manual is intended to promote safe usage of your e-cycle for you, other road users, your vehicle, surrounding property, and the environment. Please note:

- ▶ The content of this manual may be updated without prior notice.
- ▶ The manufacturer assumes no responsibility for any errors or omissions in this document.
- ▶ Reproduction, distribution, or unauthorised use of this document or its contents is strictly prohibited without written consent.

USAGE GUIDELINES

Before using your Cargo G-1, read this manual thoroughly to ensure proper operation and safety. Keep the manual in a secure location for future reference. Improper use or handling of the e-cycle may lead to injury or damage. The manufacturer is not liable for harm caused by misuse or failure to follow the guidelines in this manual.

SAFETY SYMBOLS

DANGER

This symbol indicates a hazardous situation which, if not avoided, will cause serious injury.

WARNING

This symbol indicates information that, if ignored, could possibly result in personal injury or even death due to incorrect handling.

CAUTION

This symbol indicates information that, if ignored, could possibly result in minor or moderate personal injury. It may also alert against unsafe practices.

CAREFULLY OBSERVE THE FOLLOWING INSTRUCTIONS:

PROTECTIVE GEAR

WARNING

Always wear a certified helmet, gloves, and appropriate riding attire. This ensures your safety while riding.

CHECK BEFORE YOU RIDE

WARNING

Conduct a pre-ride check:

- Ensure tyres are properly inflated
- Confirm the battery is securely mounted, locked, and fully charged

AVOID OVERLOADING

WARNING

Do not exceed the maximum weight capacity of 150kg, including the rider and any cargo.

CAUTION

Dual sitting is not recommended. The rear carrier is designed only to hold goods and is not intended to support a second passenger.

BATTERY HANDLING

DANGER

- **DO NOT** connect the positive and negative terminals directly; this can cause a short circuit
- Keep the battery away from high temperatures, heating equipment, and fire
- Avoid exposing the battery to water, salty, acidic, or alkaline liquids, and do not use it in the rain
- **DO NOT** disassemble the battery
- Store the battery in a cool, dry place. If not used for an extended period, recharge it monthly
- Use only the Xcape-recommended Li-ion charger

WARNING

DO NOT disassemble any battery component. Unauthorized tampering voids the warranty and may cause injury or damage.

CONTROLLER HANDLING

WARNING

- Protect the controller from rain, water, or any liquids to avoid short circuits or damage
- **DO NOT** disassemble the controller. Unauthorized tampering voids the warranty and may result in damage or injury.
- Keep the controller clean and dry. Wipe it gently with a dry cloth and avoid aggressive cleaning agents.
- **DO NOT** use a pressure washer

ELECTRONICS HANDLING

(Motor, Throttle, Lights, Display, Control Panel, Harnesses, etc.)

WARNING

Protect all electronics from heavy rain, water, or liquids to prevent short circuits or damage

DO NOT disassemble any electronic components. Unauthorized tampering voids the warranty and may cause injury or damage.

Keep electronics clean and dry. Wipe dust and dirt gently with a dry cloth; avoid harsh cleaning products.

DO NOT use a pressure washer

GEARS AND SHIFTERS

WARNING

(While Shifting)

Avoid forceful gear changes, as this can snap the chain

CAUTION

(When Stuck in Gear)

If you accidentally shift while stationary, spin the crank gently to realign the chain properly

EM



www.emotorad.com

For General Enquiries
+91 8686050590 | contactus@emotorad.com

For Service Related Queries
+91 8956248161 | service@emotorad.com