

---

# ANTI-STATIC CONICAL BURR COFFEE GRINDER

CG203S

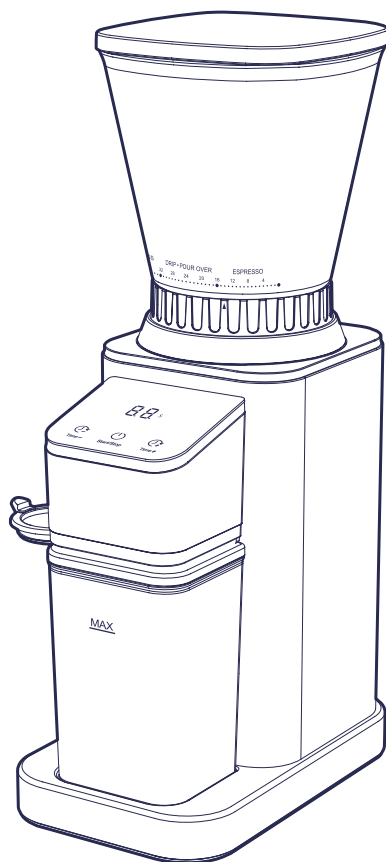

USER MANUAL

---



# CONTENTS

■ Important Safeguards .....	1
■ Warning .....	2
■ Know Your Coffee Grinder .....	3
■ Product Specification .....	4
■ Before First Use .....	4
■ How to Use the Coffee Grinder .....	5
■ Assemble and Disassemble the Bean Hopper ..	6
■ Grind Size Setting Recommendations .....	7
■ Care and Cleaning .....	8
■ Making Better Quality Coffee.....	10
■ Troubleshooting .....	11
■ Disposal .....	11

# IMPORTANT SAFEGUARDS

Before using the electrical appliance, the following basic precautions should always be followed including the following:

1. **Read all instructions.**
2. Before using please check that the voltage of wall outlet corresponds to the one shown on the rating plate.
3. **Do not** operate any appliance with a damaged cord or plug or after the appliance malfunctions, or is dropped or damaged in any manner. Return appliance to the nearest authorized service facility for examination, repair or electrical or mechanical adjustment.
4. If the supply cord is damaged it must be replaced by the manufacturer or an authorized service agent or a qualified technician in order to avoid a hazard.
5. Switch off the appliance and disconnect from supply before changing accessories or approaching parts that move in use.
6. **Do not** let cord hang over the edge of table or hot surface.
7. **Do not** immerse the motorized base in liquid, or place it in dishwasher.
8. Close supervision is necessary when your appliance is being used near children or infirm persons.
9. Ensure fingers are kept well away from the moving parts.
10. **Do not** remove the lid until the blade has completely stopped.
11. **Do not** attempt operation without the lid in place.
12. The use of attachments not recommended or sold by the manufacturer may cause fire, electric shock or injury.
13. Check the bean box for the presence of any foreign objects before using.
14. To protect against risk of electrical shock, do not put the Coffee Grinder in water or other liquid.
15. Appliance can be used by persons with reduced physical, sensory or mental capabilities or lack of experience and knowledge if they have been given supervision or instruction concerning use of the appliance in a safe way and understand the hazards involved.
16. This appliance shall not be used by children. Keep the appliance and its cord out of reach of children.
18. Misuse may cause potential injury.
19. Care shall be taken when handling the sharp cutting blades and during cleaning.

20. Turn the appliance OFF, then unplug from the outlet when not in use, before assembling or disassembling parts and before cleaning. To unplug, grasp the plug and pull from the outlet. Never pull from the power cord.
21. Make sure the appliance is OFF when not in use, before putting on or taking off parts, and before cleaning.
22. Avoid contacting moving parts.
23. **Do not** operate the appliance for other than its intended use.
24. **Do not** use outdoors.

# SAVE THESE INSTRUCTIONS

## Warning

This appliance is **for household use only**. Any servicing other than cleaning and user maintenance should be performed by the nearest authorized Service Center.

- Do not immerse appliance in water.
- To reduce the risk of fire or electric shock, do not dismantle the appliance. Repair should be done by an authorized Service Center only.

# Know Your Coffee Grinder

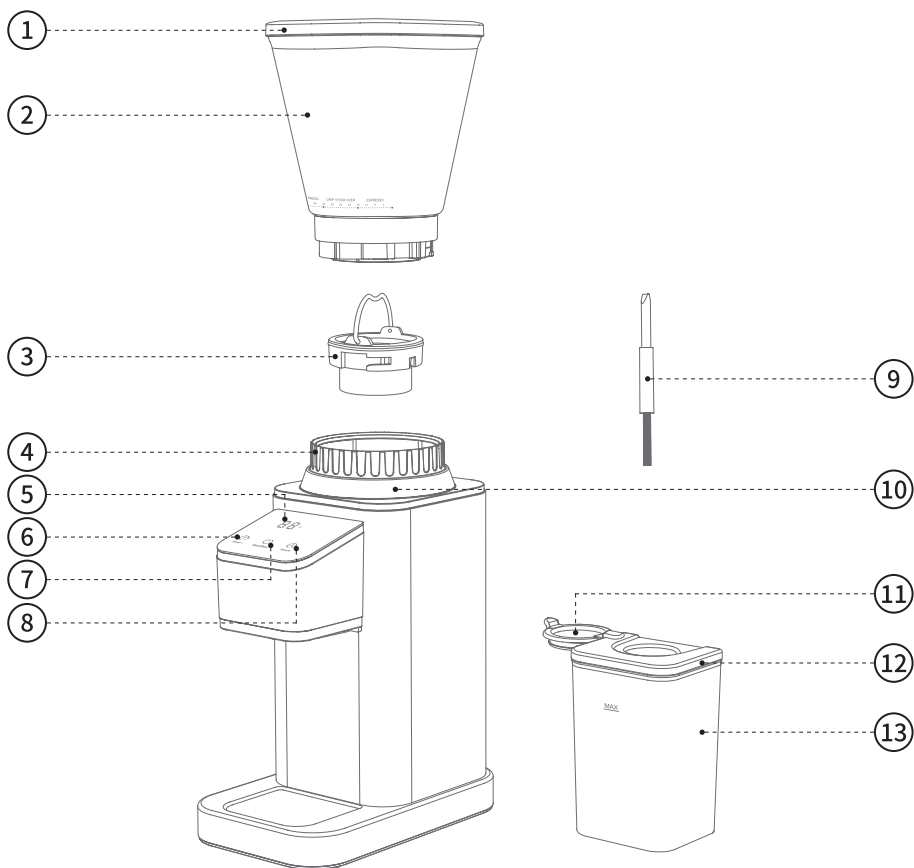

① Bean Hopper Lid

③ Stainless Steel Conical Burrs

⑤ LED Panel

⑦ Start/Stop Button

⑨ Cleaning Brush

⑪ Sealing Cover

⑬ Grinding Chamber

② Bean Hopper

④ Grind Size Dial

⑥ Time "-" Button

⑧ Time "+" Button

⑩ Ring of the Base

⑫ Grinding Chamber Lid

## Product Specification

Model	CG203S
Power Supply	120V~ 60Hz
Rated Power	150W
Bean Hopper Capacity	9.7 oz
Grinding Chamber Capacity	2.7 oz
Net Weight	4.5 lb
Dimensions	7.1*4.5*13.9 in

## Before First Use

Before using the coffee grinder, wash Bean Hopper, Grinding Chamber, and Grinding Chamber lid in warm soapy water and dry thoroughly. Wipe exterior of grinder with a soft damp cloth and dry thoroughly. Place grinder on flat level surface and plug power cord into 120V outlet.

## How to Use the Coffee Grinder

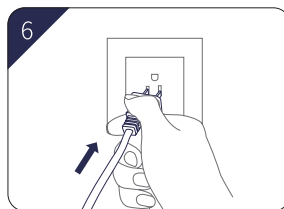
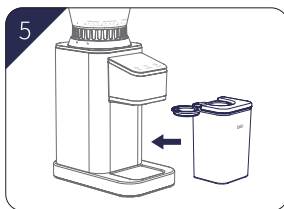
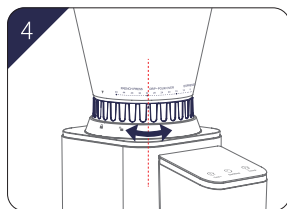
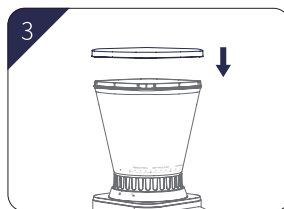
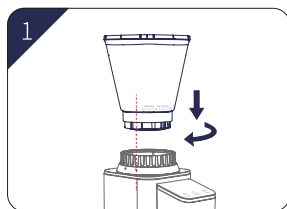

1. Assemble the Bean Hopper ( Refer to the "Assemble and Disassemble the Bean Hopper" ).
2. Fill coffee beans into Bean Hopper.
3. Close the lid.
4. Select your Grind Size

The coffee grinder has 48 grind size options. To adjust the grind size, rotate the Grind Size Dial, **align the arrow ▲ on the Grind Size Dial with the number on the Bean Hopper**. Adjust from fine to coarse according to the type of coffee you want. ( Refer to the "Grind Size Setting Recommendations" ).

5. Place the Grinding Chamber under the powder outlet.
6. Plug into a power outlet.
7. Setting grinding time

After power on, the LED Panel will display for 20 seconds. You can set your wanted grinding time by using the Time "-" Button and Time "+" Button. Each short press decreases or increases 1 second. Each long press, the time decreases or increases rapidly. The maximum setting time is 40 seconds.

8. Press the START/STOP Button to start grinding. Grinding will automatically stop while the grinding is done. If you need to pause during grinding, press the START/STOP Button.



## ENERGY SAVING FEATURE

The grinder will automatically switch off if not used for 60 seconds.

To reactivate the machine whilst in POWER SAVING/SLEEP MODE, press the START/STOP Button.



## CAUTION

Do not grind continuously for more than 3 minutes, or the screen will display "E1" because the appliance overheats, and the three buttons of the machine cannot work. Please wait for 10 minutes to cool down then restart.

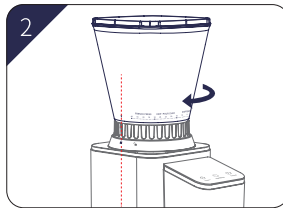
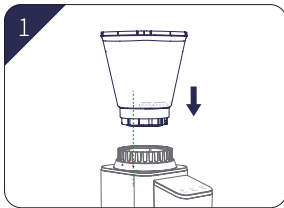
## Assemble and Disassemble the Bean Hopper



### How to assemble the Bean Hopper:

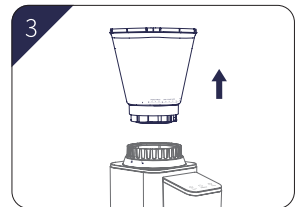
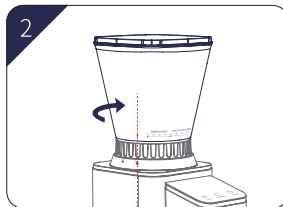
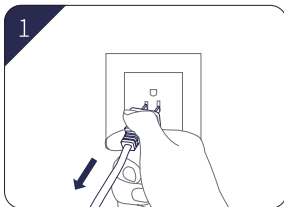

1. Align the arrow ▼ on the Bean Hopper with the unlock icon  on the Ring of the Base.
2. Turn the Bean Hopper clockwise until the arrow ▼ is aligned with the lock icon  on the Ring of the Base.



### How to disassemble the Bean Hopper:

1. Make sure the coffee grinder is unplugged.
2. Turn the Bean Hopper counter-clockwise until the arrow ▼ is aligned with the unlock icon  on the Ring of the Base.
3. Lift the Bean Hopper up.

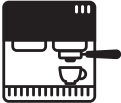
# Grind Size Setting Recommendations

Coffee Type	Espresso	Drip/Pour Over	French Press
			
Grind Size	Fine	Medium	Coarse
Grind Setting	1-16	17-32	33-48
Maximum Grinding Time	10S	40S	40S

**NOTE:**

- This chart is for reference only. Your experiment with different grinding size, dose, and time setting is important for you to achieve your desired taste.
- For Espresso, please set the grinding time lower than "10 seconds" to avoid waste of coffee grounds.

## Care and Cleaning

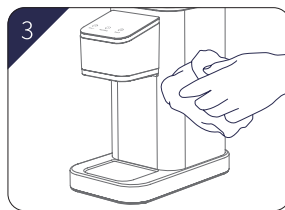
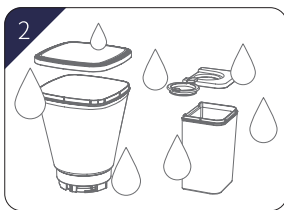
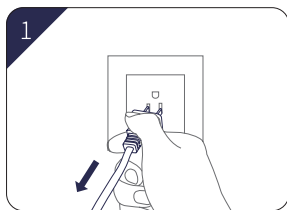

### Cleaning the Grinder

1. Unplug power cord from power outlet before cleaning.
2. Wash the Bean Hopper, Grinding Chamber, and Grinding Chamber lid in warm soapy water and dry thoroughly.
3. Wipe and polish exterior of appliance with a soft damp cloth and dry thoroughly.





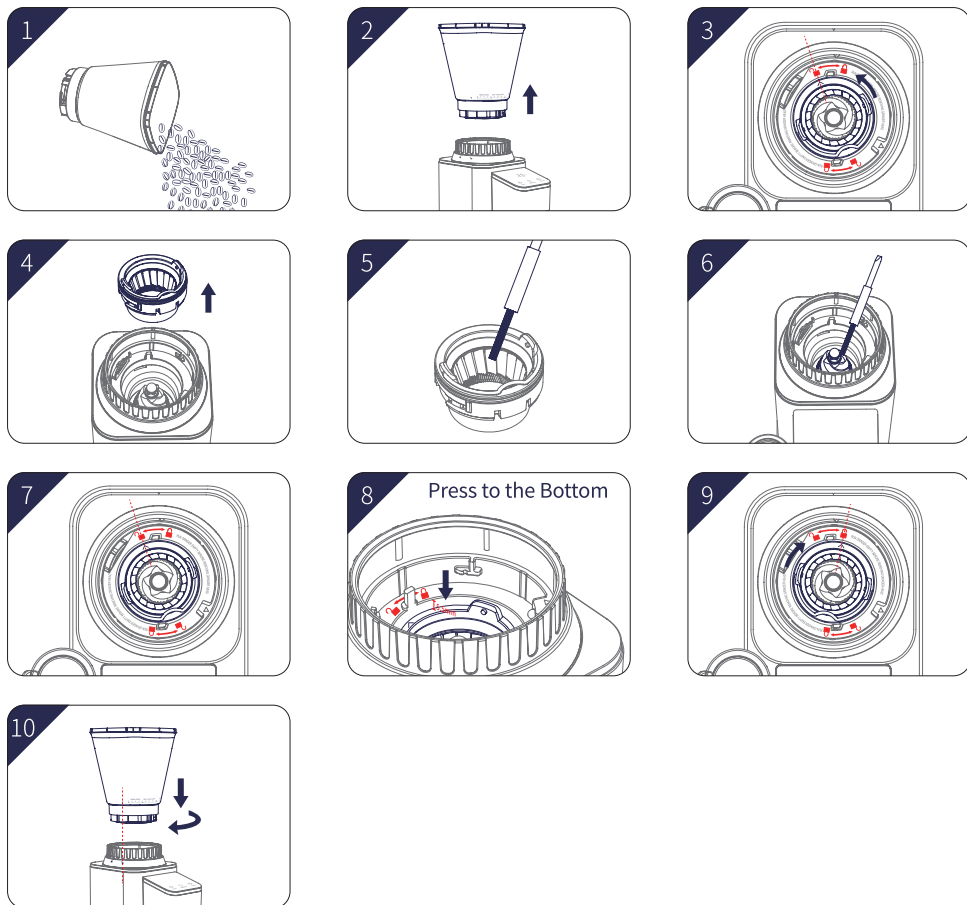

#### **NOTE:**

Please do not clean any grinder parts or accessories in the dishwasher.



## Cleaning Conical Burrs

Regular cleaning helps the burrs achieve consistent grinding results.

1. Empty beans from the Hopper and grind out any excess beans.
2. Remove Hopper.
3. Turn the Upper Burr counter-clockwise until the arrow  is aligned with the unlock icon .
4. Lift the Upper Burr up.
5. Clean Upper Burr with Cleaning Brush.
6. Clean Lower Burr with Cleaning Brush.
7. Align the arrow  on the Upper Burr with the unlock icon .
8. Put down and press the upper burr to the bottom.
9. Turn the Upper Burr clockwise until the arrow  is aligned with the lock icon .
10. Install the Bean Hopper.

## Making Better Quality Coffee

- Freshly ground coffee is the key to making coffee with more flavor and body.
- Coffee flavor and strength is a personal preference. Vary the type of coffee beans, amount of coffee and fineness of grind to achieve the flavor you prefer.
- Use freshly roasted coffee beans with a 'roasted on' date to maximize flavor, not a use-by or best before date.
- Use coffee beans between 5 and 20 days after the 'roasted on' date for optimal freshness.
- Store coffee beans in a dark, cool and dry place. Vacuum seal if possible.
- Buy in small batches to reduce storage time.
- Once coffee is ground, it quickly loses its flavor and aroma. For the best results, grind beans immediately before brewing.
- Do not store beans in the bean hopper. Place them back in an airtight container.
- When storing the appliance, run grinder empty to clear ground beans left in Chamber.
- Run grinder for 2 seconds to purge some coffee before each use, for maximum freshness.
- Clean the bean hopper and conical burrs regularly.

## Troubleshooting

Problem	Possible Cause	What to Do
The grinder does not start after pressing ON/OFF Button.	Grinder is not plugged in.	Plug power cord into power outlet.
The screen display "E1" and the three buttons on the machine can't work.	Grinder has overheated.	Remove power plug from power outlet. Leave for 10 minutes to cool down before using again.
The screen display "E3".	The Bean Hopper is not installed in place.	Lock Bean Hopper into position. (refer to " <b>How to assemble the Bean Hopper</b> ")
The motor starts but no ground coffee comes from the grind outlet or Grinder stops abruptly during operation.	Grinder is blocked with foreign items.	Turn off / plug off the Coffee Grinder. Remove Bean Hopper, inspect burrs and remove any foreign body. Clean burrs and chute (refer to " <b>Cleaning Conical Burrs</b> ").

If your problem is not listed, please contact **Customer Support** at [support@shardor1.com](mailto:support@shardor1.com).

## Disposal

This product should not be disposed of with other household wastes. To prevent possible harm to the environment or human health from uncontrollable waste disposal, it should be recycled responsibly.



Thank you for purchasing the **Coffee Grinder**