

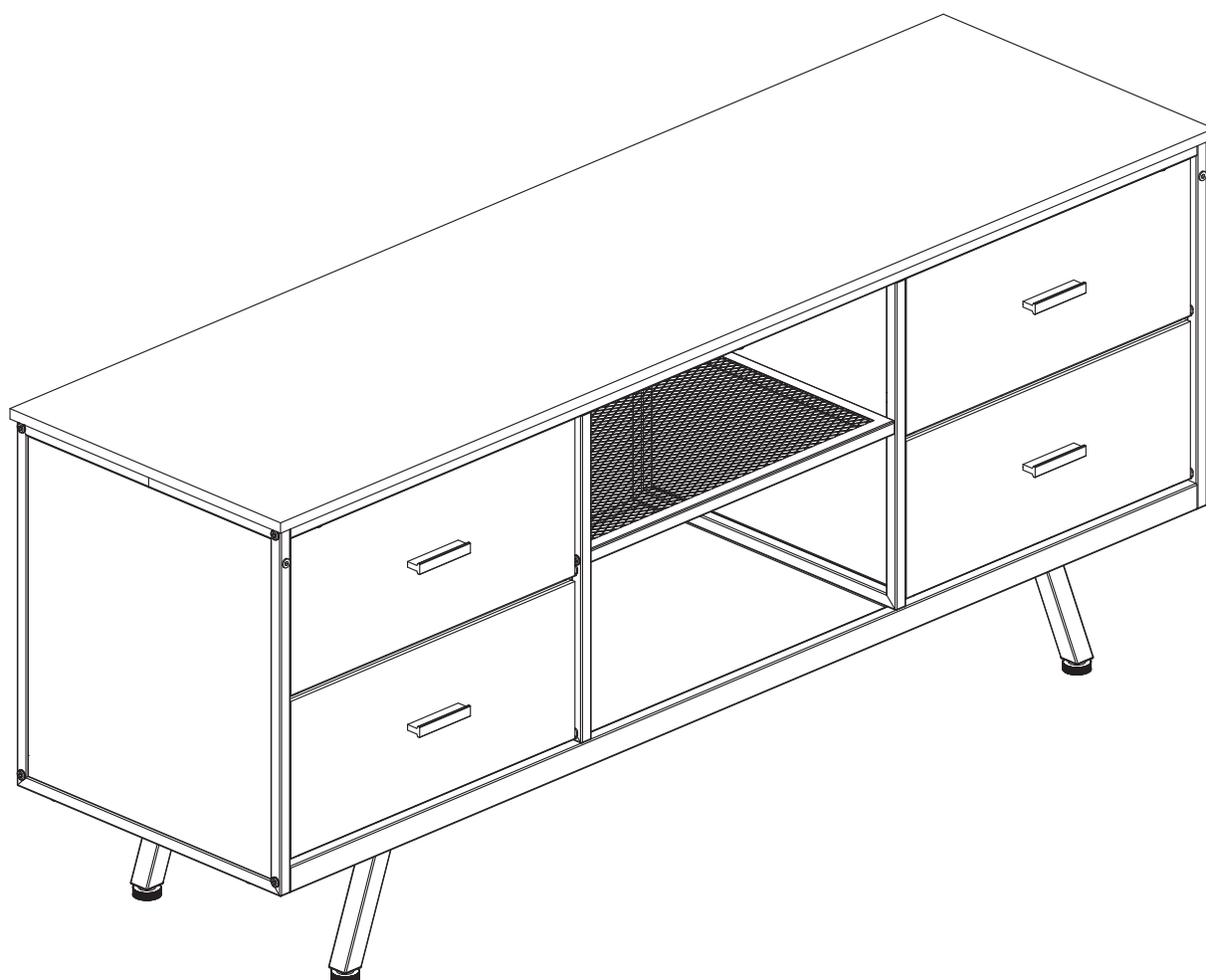

INSTRUCTION MANUAL

Rev00(A)

PIRTS06WN



TV Console

 (US/CA) 1-800-556-9829
(UK) 44-808-196-3885



support@pipishell.net

www.pipishellav.com

Important Safety Information

Please carefully read all instructions before attempting installation. If you DO NOT understand the instructions or have any questions or concerns, please contact our technical support line at 1-800-556-9829 (US/CA) / 44-808-196-3885 (UK) or customer service at support@pipishell.net.

CAUTION: Avoid potential injuries and property damage!

- DO NOT use this product for any purpose that is NOT explicitly specified in this manual. We are NOT liable for damage or injury caused by improper mounting, incorrect assembly or inappropriate use.

WARNING: This product contains small items that may pose a choking hazard.

Before starting assembly, verify all parts are included and undamaged. DO NOT use damaged or defective parts. If you require replacement parts, please contact our technical support line at 1-800-556-9829 (US/CA) / 44-808-196-3885 (UK) or customer service at support@pipishell.net.

Weight Restrictions

Verify that the items you intend to store do not exceed the listed weight capacity.



Top Shelf Weight Capacity:
150 lbs (68kg)



Middle Shelf Weight Capacity:
30 lbs (13.6kg)

Drawer Weight Capacity:
11 lbs (5kg)



Bottom Shelf Weight Capacity:
60 lbs (27.2kg)

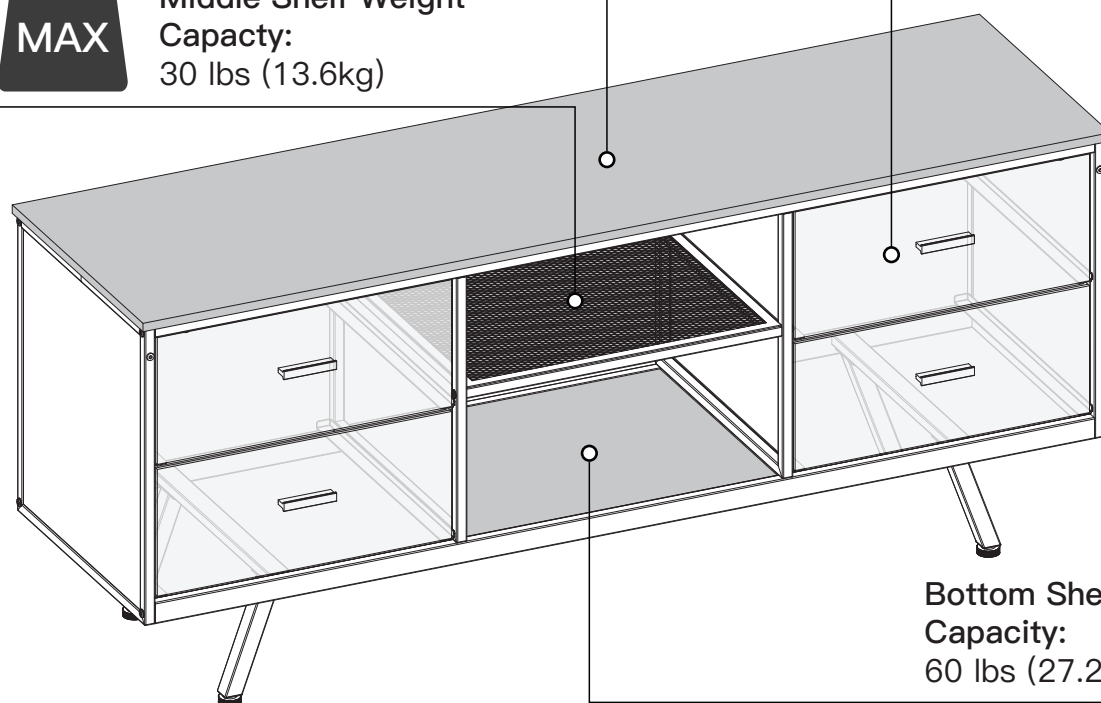

Tools Needed (Not Included)

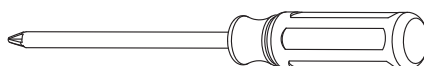

Phillips Screwdriver

Contents

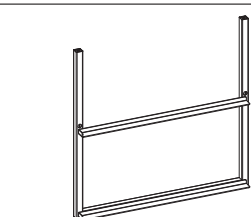
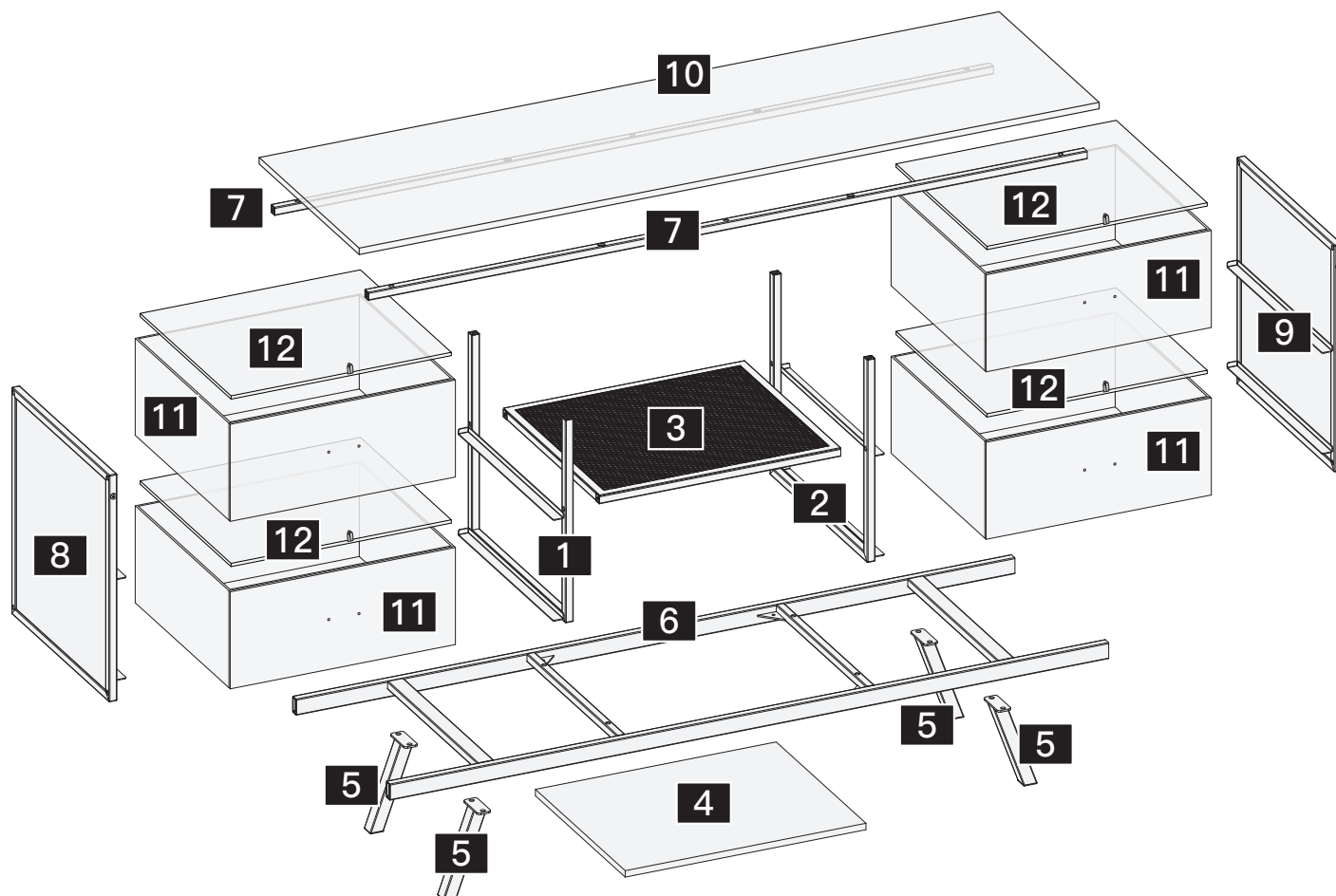

Left Middle Frame
[1] x 1

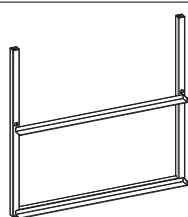

Right Middle Frame
[2] x 1

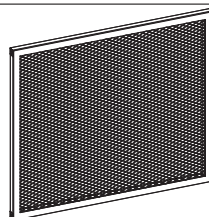

Mesh Panel
[3] x 1

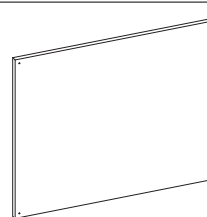

Bottom Panel
[4] x 1

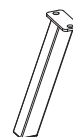

Leg
[5] x 4

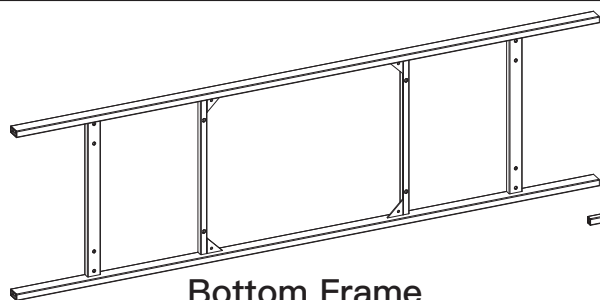

Bottom Frame
[6] x 1

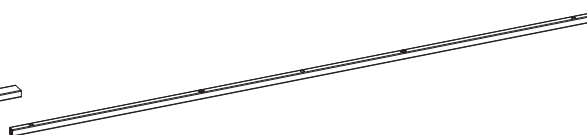

Top Support Bar
[7] x 2

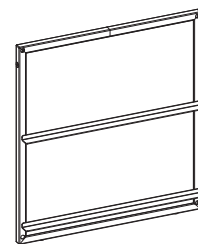

Left End Frame
[8] x 1

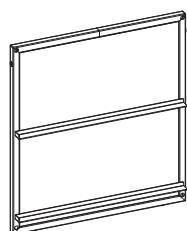

Right End Frame
[9] x 4

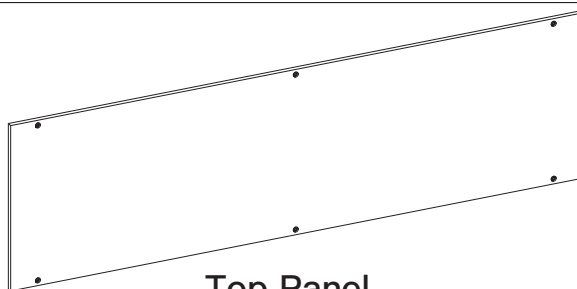

Top Panel
[10] x 1

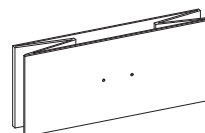

Fabric Drawer
[11] x 4

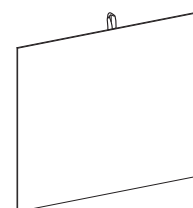

Drawer Bottom
[12] x 4

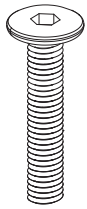

M6 x 30mm
Bolt
[A] x 12



M3.5 x 12mm
Screw
[B] x 4



M6 x 12mm
Bolt
[C] x 8

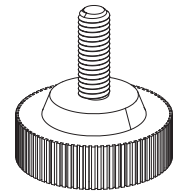

Adjustable Foot
[D] x 4

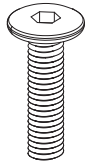

M6 x 23mm
Bolt
[E] x 14



M4 x 12mm
Screw
[F] x 8

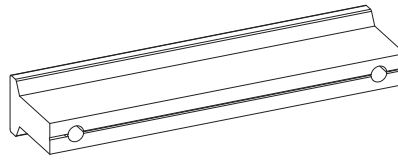

Handle
[G] x 4



5/32'' (4mm)
Allen Key
[H] x 1



IMPORTANT INSTALLATION TIP: Align and loosely thread all bolts into the corresponding holes before fully tightening each bolt one by one.

STEP 1

NOTE: Please note the distinction between two sides of mesh panel.

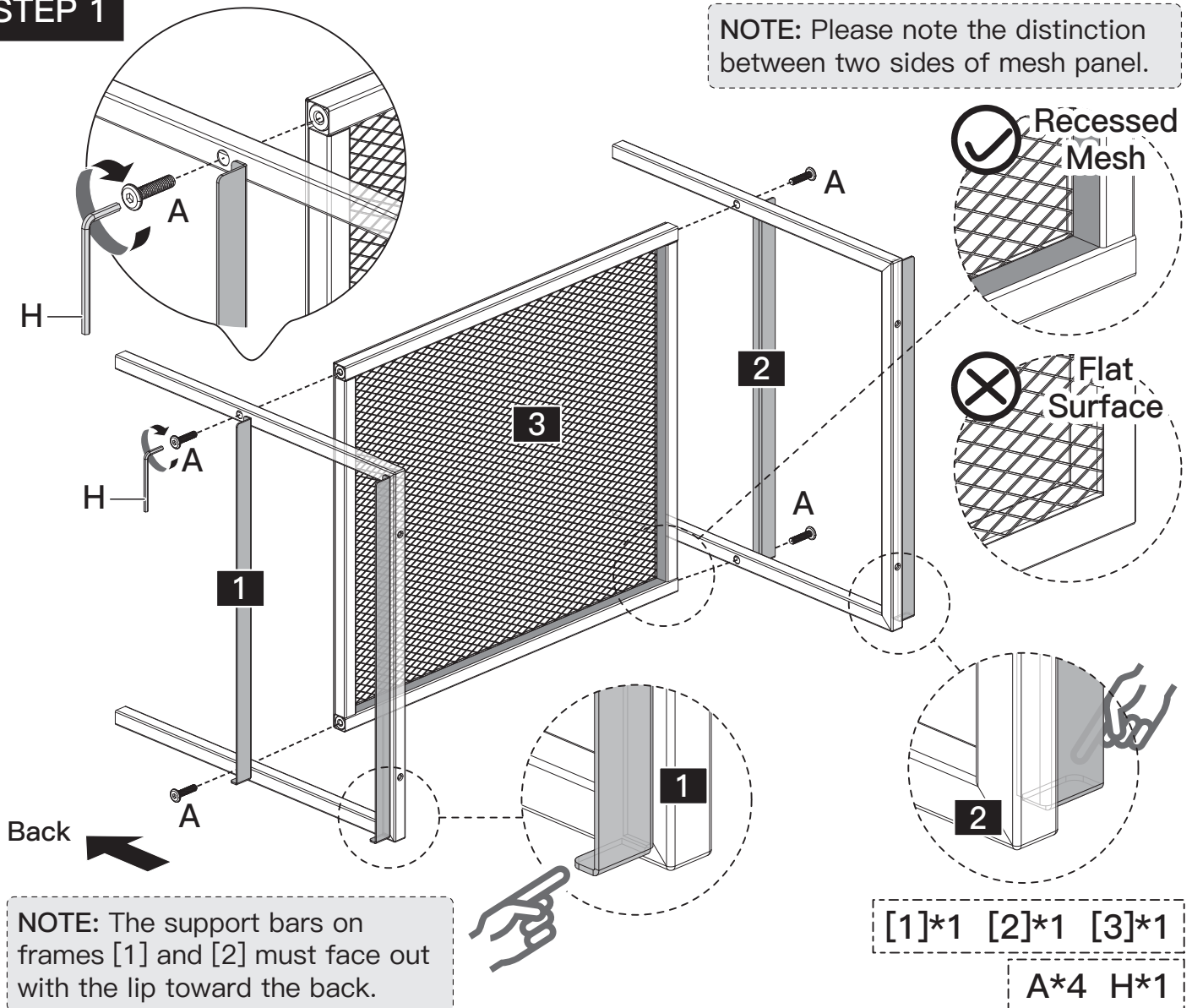

STEP 2

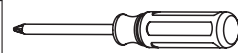

Phillips
Screwdriver
(Not Included)

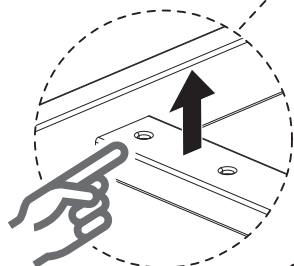
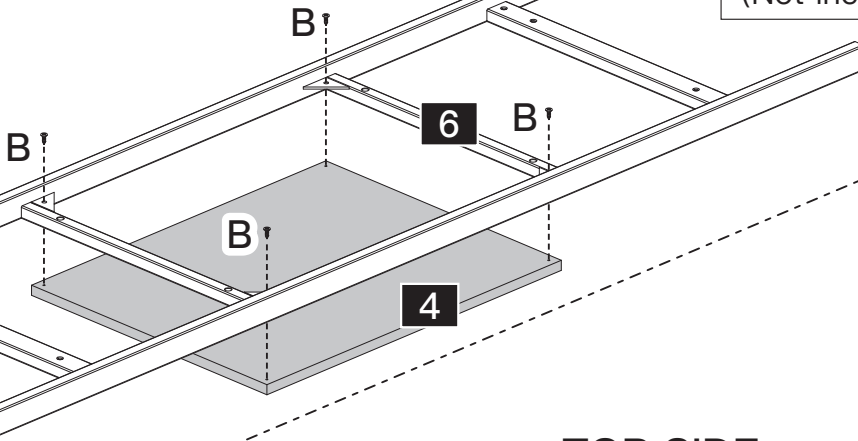
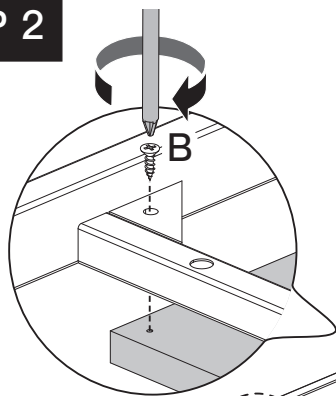

TOP SIDE

NOTE: The feet
should face out.

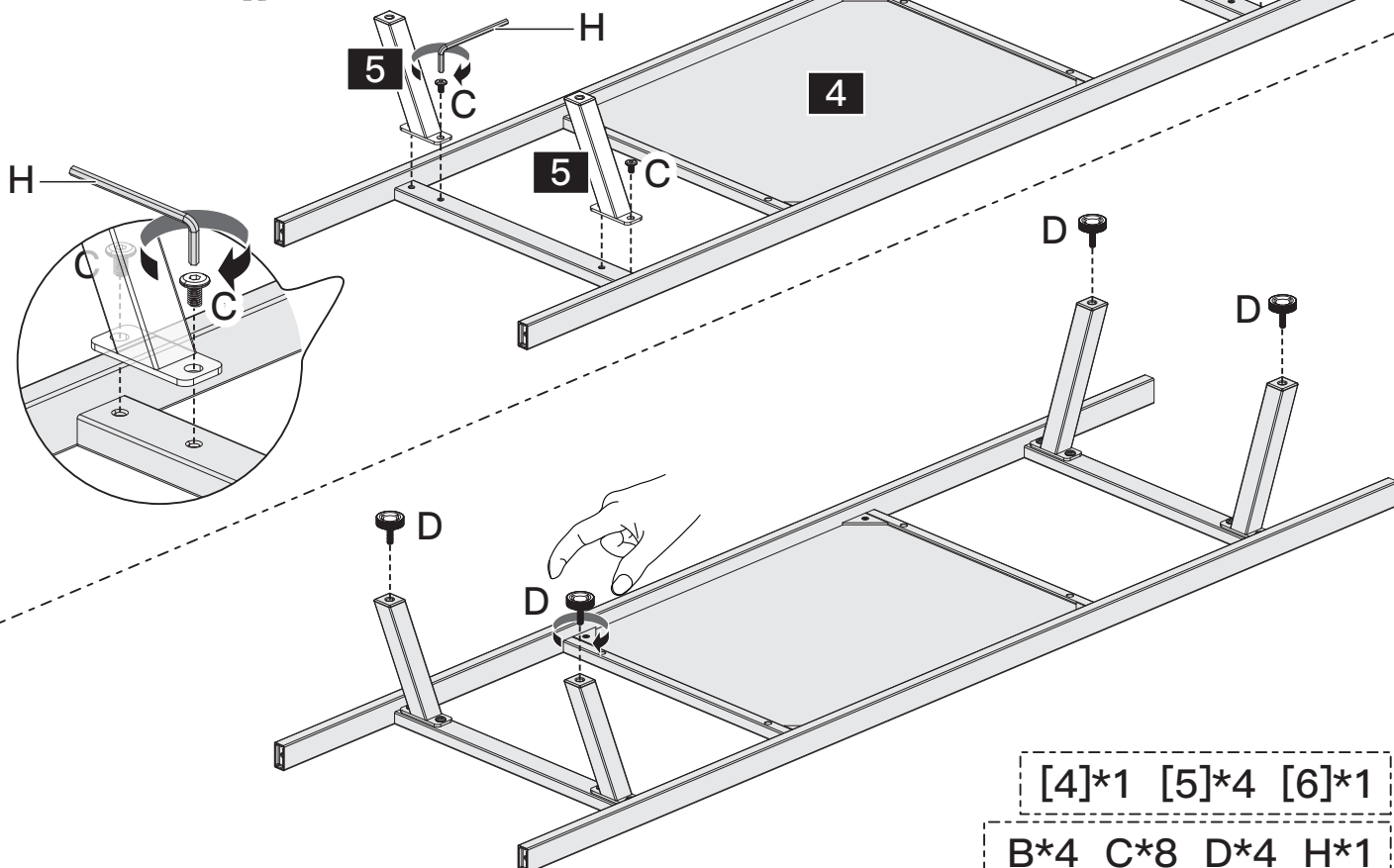
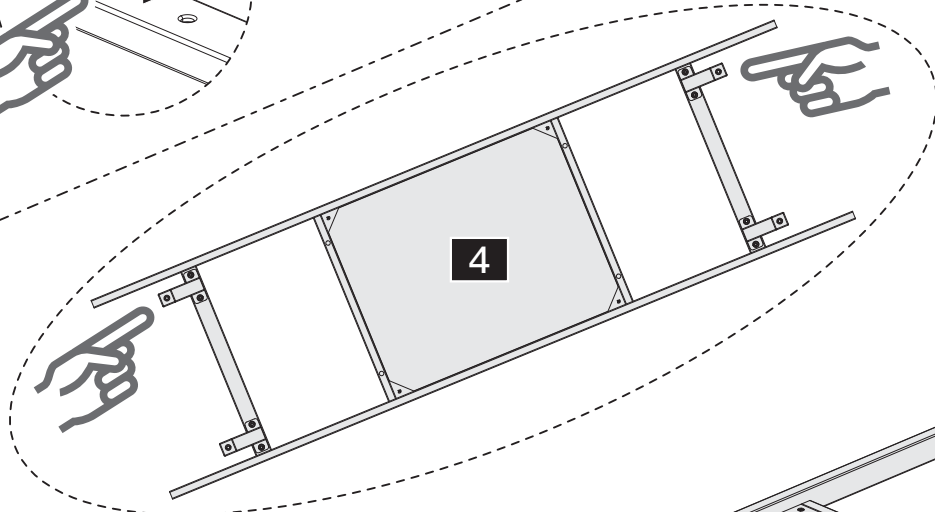

[4]*1 [5]*4 [6]*1
B*4 C*8 D*4 H*1

STEP 3

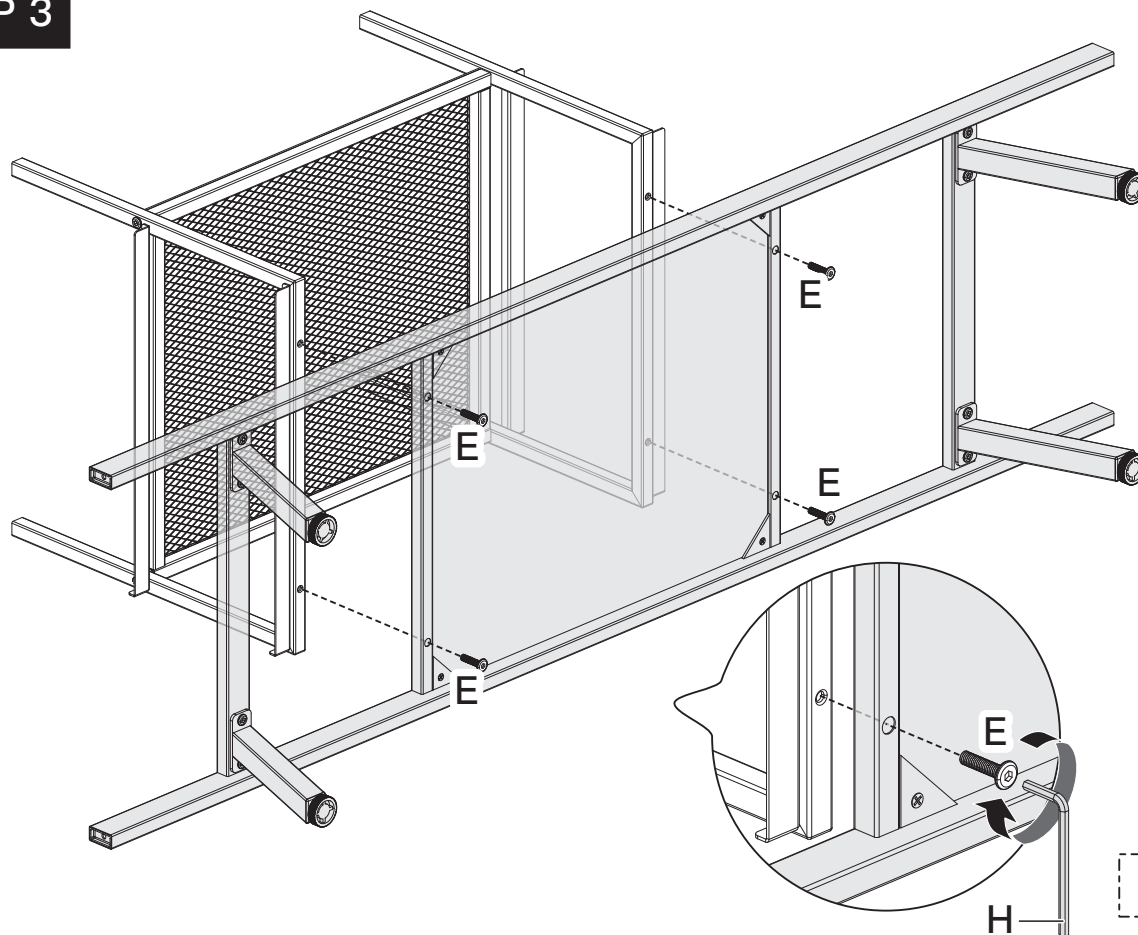

E*4 H*1

STEP 4

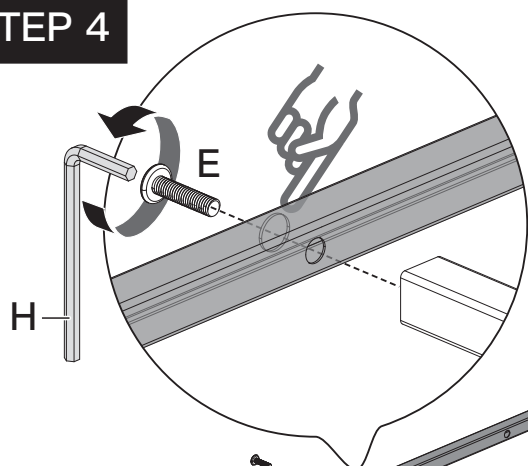

NOTE: The large holes on support bars [7] must face out.

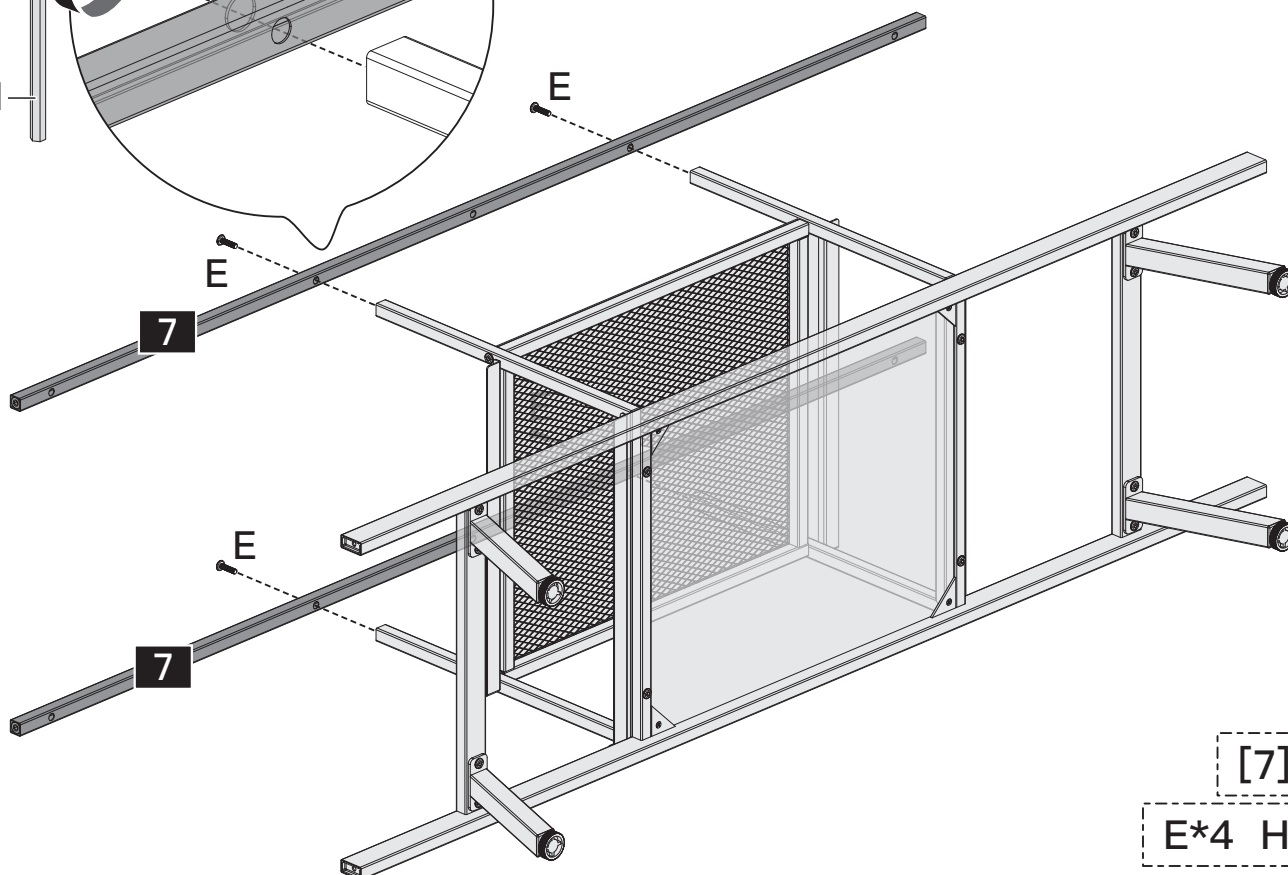

[7]*2

E*4 H*1

STEP 5

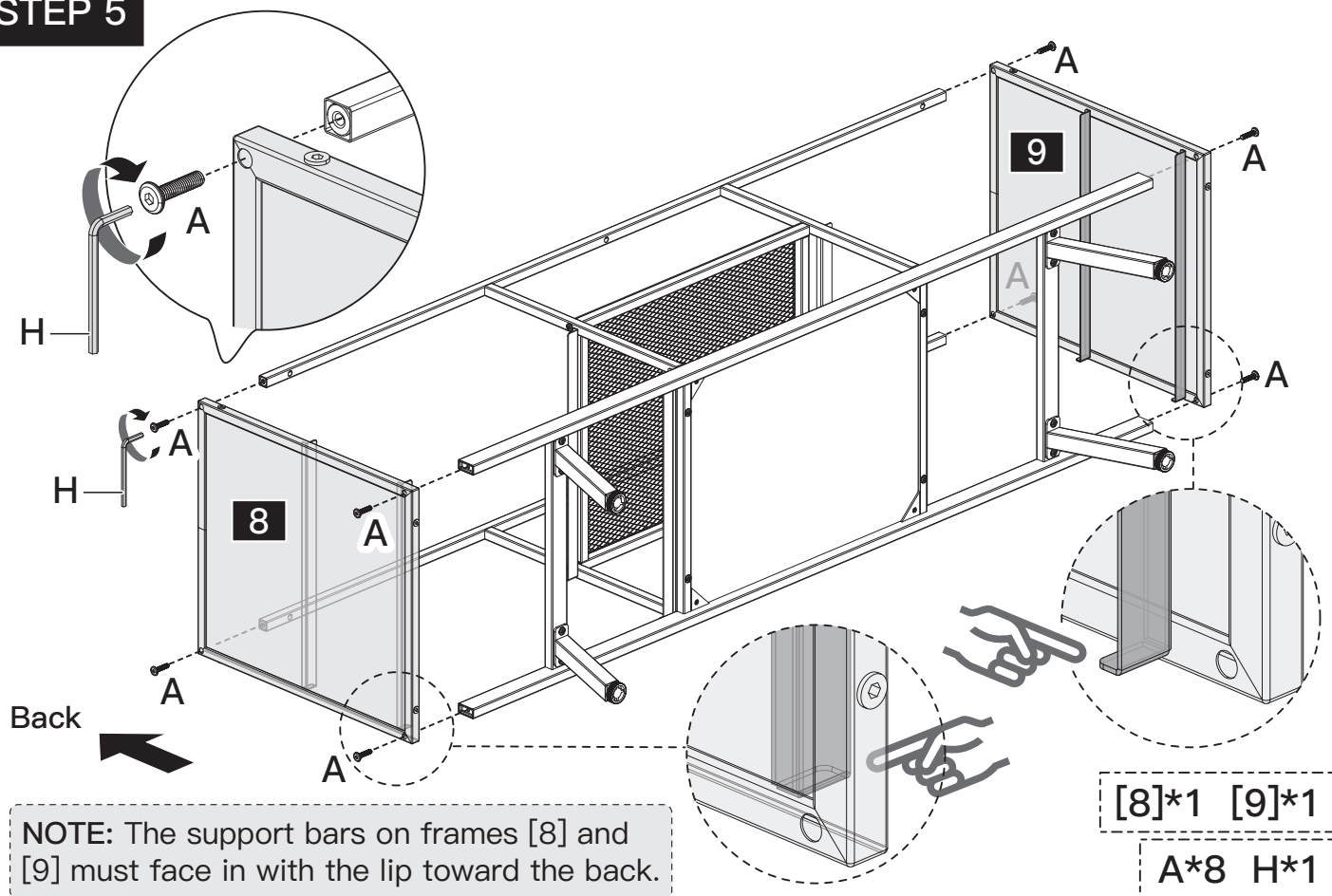

STEP 6

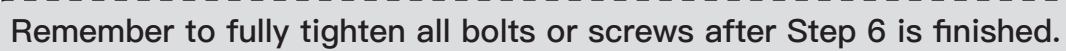
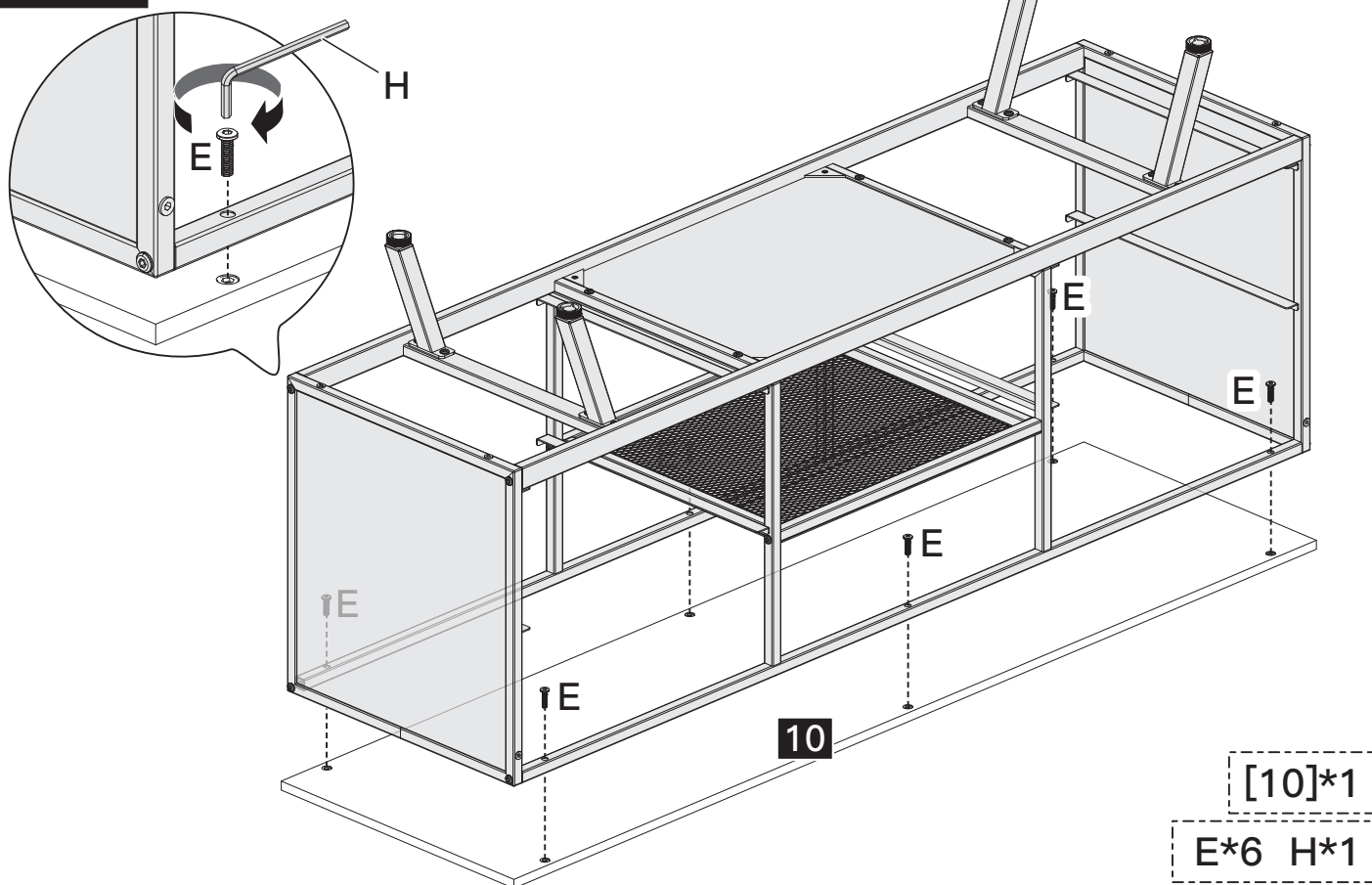

STEP 7

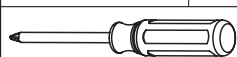
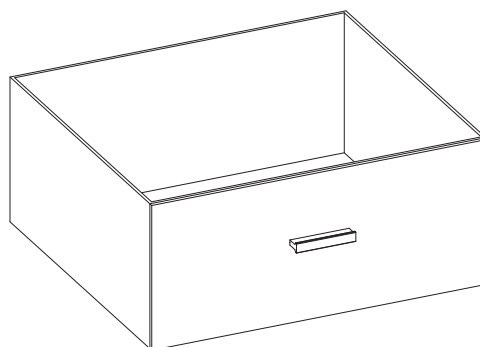
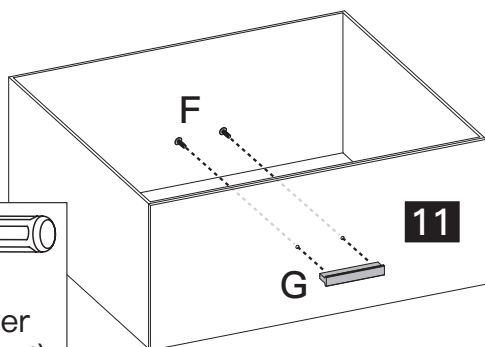
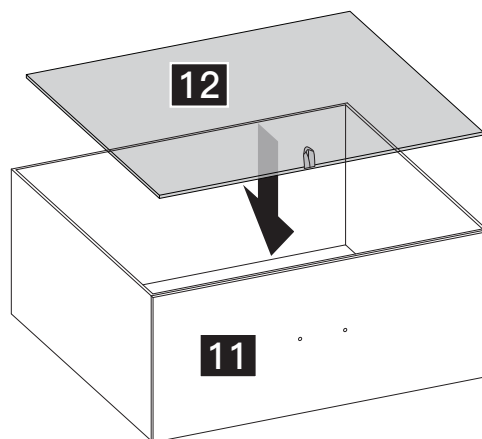
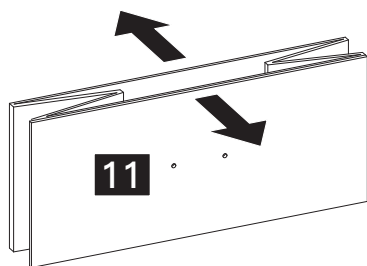

Phillips
Screwdriver
(Not Included)

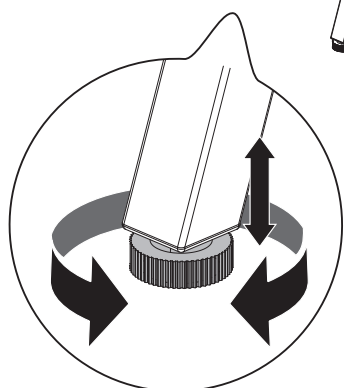
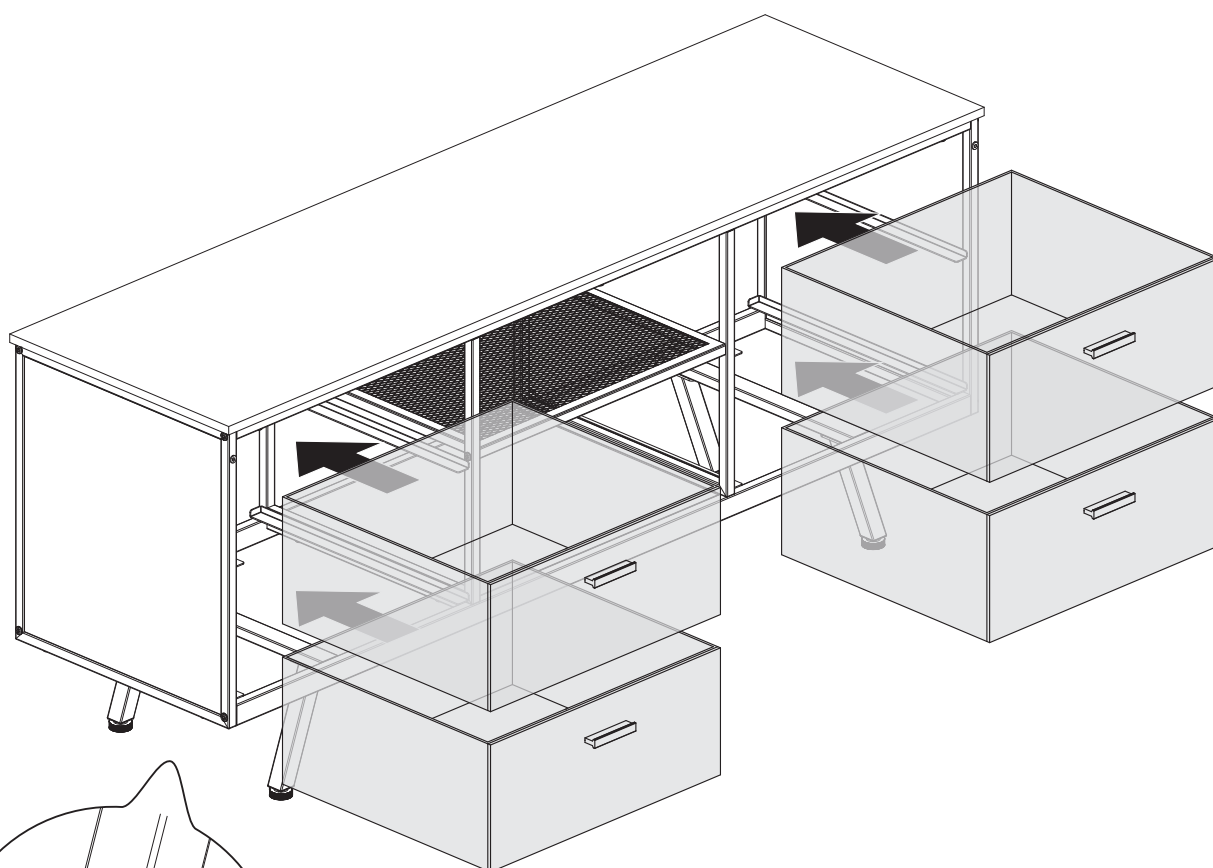

NOTE: If the unit is not level,
adjust the feet by turning to
raise or lower each corner.

[11]*4 [12]*4

F*8 G*4