

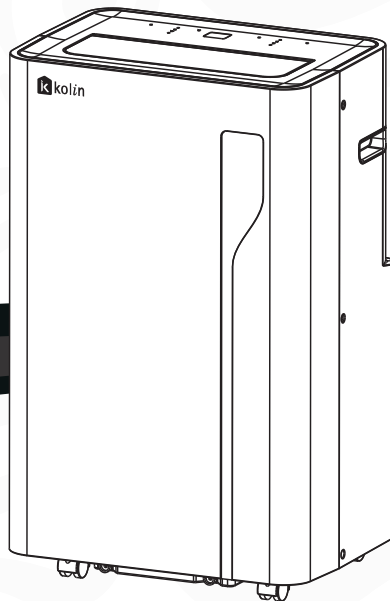

# Owner's Manual

## **PORTABLE AIR CONDITIONER**



**KPA-150-R15D410**

 **Kolin Phils. Int'l, Inc.**

Please read this owner's manual before operation and retain it for future reference.

# Table of Contents

I. Product Introduction	-----	1
II. Safety Instruction	-----	1
III. Product Diagram	-----	3
IV. Features	-----	4
V. Installation Instruction	-----	4
VI. Operation Instruction	-----	8
VII. Cleaning and Care	-----	14
VIII. Troubleshooting	-----	16
IX. Decommisioning	-----	17

## TO USERS

Thank you for choosing Kolin as your trusted brand for a portable air conditioner. We appreciate your confidence in our products. Before installing and using the portable air conditioner, we kindly request you to carefully read and understand this instruction manual. This will enable you to effectively utilize and operate the product to its fullest potential. We aim to provide clear guidance and instructions for your convenience.

## I. PRODUCT INTRODUCTION

Our powerful portable air conditioners are great cooling solutions for single rooms, creating a comfortable atmosphere in your space. They also have ventilation and dehumidifying functions for circulating air and removing moisture. They are self-contained systems that do not require any permanent installation, allowing you to move them to the space in which they are most needed. They are commonly used in bedrooms, temporary residences, computer rooms, living areas, and many other places where installation of an outdoor air conditioner unit is limited.

### AIR CONDITIONER SAFETY

Your safety and the safety of others are very important. We have provided many important safety messages in this manual for your appliance. Always read and obey all safety messages.

## II. SAFETY INSTRUCTION



**Please read the operating instructions carefully before using your dehumidifier for the first time.**

This product cannot be installed in corrosive, inflammable, or explosive environments or places with special requirements, such as kitchens or washing rooms. Otherwise, it will affect the normal operation or shorten the service life of the unit, or even cause a fire hazard or serious injury. For such special places, please use a special air conditioner with anti-corrosive or anti-explosion functions.



This unit uses a flammable refrigerant.

If refrigerant leaks and comes in contact with fire or heating part, it will create harmful gas and there is risk of fire.

The following should always be observed for safety:

1. Plug into a grounded 3-prong outlet, do not remove grounding prong, do not use an adapter, and do not use an extension cord.
2. Install the unit on a flat and hard floor to diminish vibration or noise.
3. Never immerse the unit in water or other liquids.
4. Do not operate the unit if the cable or other connector is damaged or if something abnormal may happen. Please call the Kolin hotline for help.
5. Disconnect the unit from the power supply when it is not in use, or before relocating or cleaning it.
6. Operate the unit only at the specified voltage.
7. The unit is for indoor use only. Do not use it for any other purpose.
8. Avoid placing heavy objects on the appliance.
9. Do not tip the unit to any side as spilled water could damage the appliance.
10. Never insert any other object into the unit body to avoid any hazards or unit failure.
11. Keep the unit away from heat-generating devices or near flammable and dangerous materials.
12. This appliance is not intended for use by persons (including children) with reduced physical, sensory, or lack of experience and knowledge, unless they have been given supervision or instruction concerning the use of the appliance by a person responsible for their safety. Children should be supervised to ensure that they do not play with the appliance.
13. If the supply cord is damaged, it must be replaced by the manufacturer, its service agent, or a similarly qualified person to avoid hazards.
14. Ensure the appliance is positioned so that the plug is accessible.
15. The appliance shall be installed in accordance with national wiring regulations.
16. The ambient temperature range for the appliance is 5 degrees to 35 degrees Celsius.



## CAUTION

**Don't attempt to repair or modify the appliance, as it may result in damage. Even the replacement of the power cord should be performed by a specially qualified person.**

## II. Product Overview

**Product Diagram:**

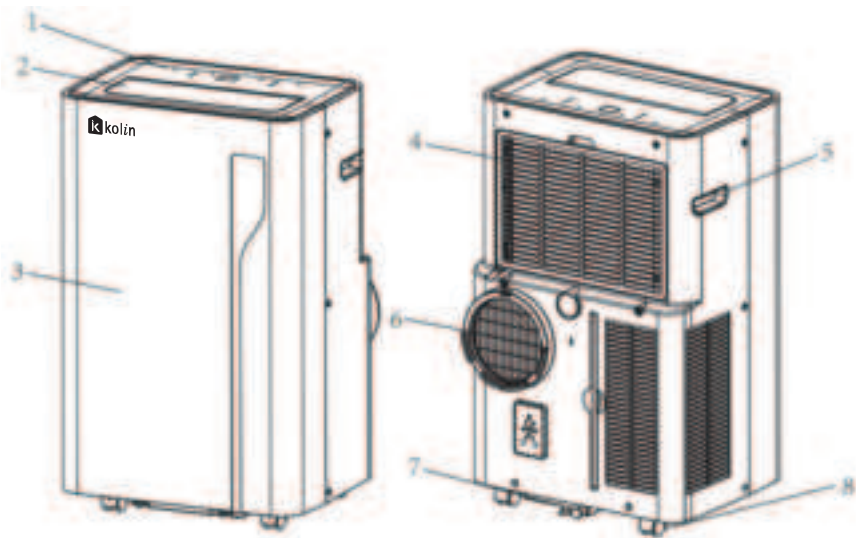

1	Control panel	4	Air inlet with air filter	7	Drain opening with sealing plug
2	Air outlet with adjustable louver	5	Recessed handle	8	Castor
3	Front Panel	6	Air Exhaust		

**NOTE:** The appearance is only for reference. Please see the real product for detailed information.

### III. FEATURES

- ✓ High Capacity in a compact size with cooling, dehumidifying and fan function.
- ✓ Temperature setting and display
- ✓ LED Digital display
- ✓ Electronic control with built-in timer, sleep mode
- ✓ Self-evaporating system for better efficient
- ✓ Auto shut off when base pan is full
- ✓ Automatic restart in the event of power outage
- ✓ Auto defrosting function at low ambient temperatures
- ✓ Remote control
- ✓ 3- speed fan
- ✓ Casters for easy mobility

### IV. Installation

#### Unpacking

- Unpack the carton and take the appliance and accessories out.
- Check the device after unpacking for any damage or scratches on it .
- Accessories:
  1. Exhaust hose
  2. Hose connector
  3. Window kit adapter
  4. Remote control
  5. Drainage pipe
  6. Window kit



## Choose your location

- If tipped more than 45°, allow the unit to set upright for at least 2 hours before start up.
- Place the unit on a firm, level surface in an area with at least 50cm of free space around it to allow for proper air circulation.

Do not operate in close proximity to walls, curtains, or other objects that may block air inlet and outlet. Keep the air inlet and outlet free of obstacles.

Never install the unit where it could be subject to:

- Heat sources such as radiators, heat registers, stoves or other products that produce heat.
- Direct sunlight
- Mechanical vibration or shock
- Excessive dust
- Lack of ventilation, such as cabinet or bookcase
- Uneven surface

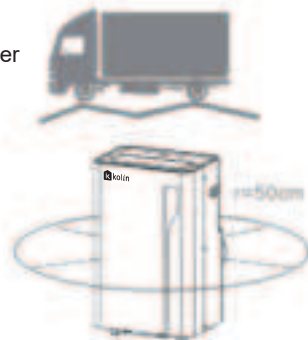

### WARNING!

Install the unit in rooms which exceed 10 m<sup>2</sup>.

Do not install the unit in a place where inflammable gas may leak.



### NOTE!

The manufacture may provide other suitable example or may provide additional information about the refrigerant odour.

## Attach the exhaust hose

The air conditioner requires being vented outside so that the exhaust air can escape the room which coming from the appliance contains waste heat and moisture.

Do not replace or extend exhaust hose which will result in decreased efficiency, even worse shut down the unit due to low backpressure.

Step 1: Connect the hose connector to one end of the exhaust hose..



Step 2: Connect the windows kit adapter to the other end of the exhaust hose.

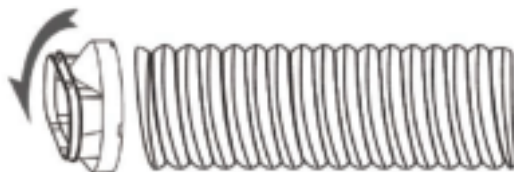

Step 3: Extend the adjustable window kit the length of your window. Connect the exhaust hose to the window kit.



Step 4: Close your window to secure the kit in place. It needs to hold the windows kit firmly in place, secure the window kit with duct tape if required. It is recommended that the gap between the adapter and the sides of the window should be sealed off for maximum efficiency..

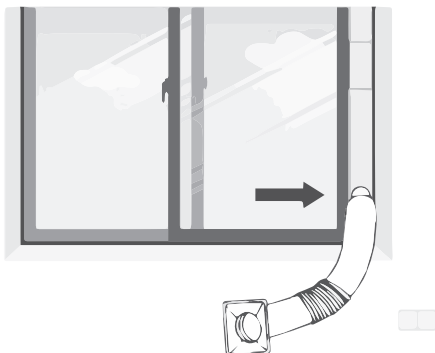



Step 5: Attach the hose connector to the exhaust air outlet of unit.

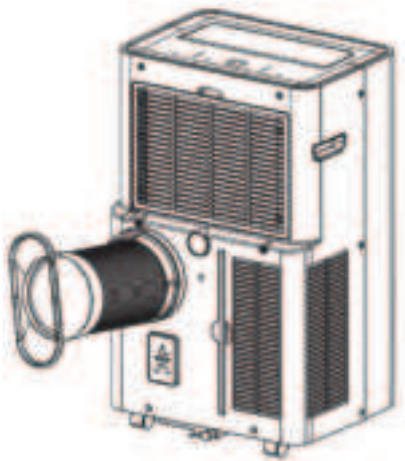

Step 6: Adjusting the length of the flexible exhaust hose, and avoid bends in the hose. Then place AC near an electrical outlet.

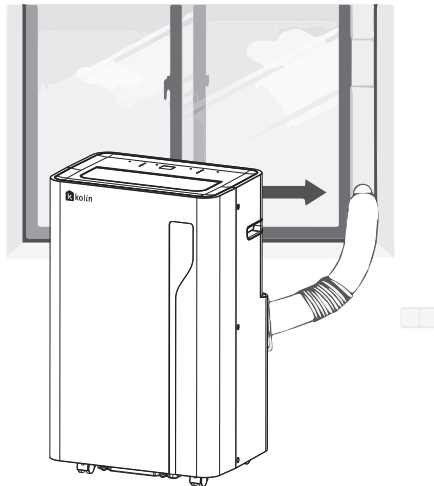

Step 7: Adjust the louver at the air outlet, and then switch on the unit.

### Control Panel and Display

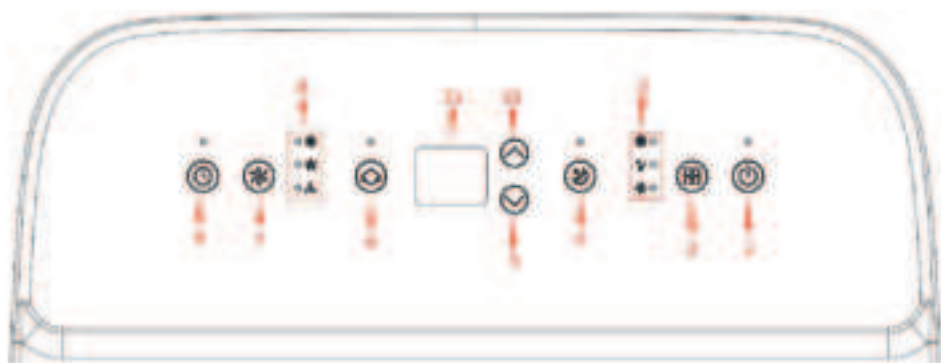

### Function Keys and Indicators

1	POWER	Press to switch the machine on or off.
2.	MODE	Press to switch the operation mode between cool, dry and fan.
3.	MODE INDICATOR	This display the Mode Setting between cool, dry and fan.
4	SLEEP	Press to turn sleep mode on or off.
5	DOWN	Decreasing the desired temperature or timer setting.
6.	SWING	Adjust the air flow direction vertically.
7	SPEED	Press to switch the fan speed in HIGH, middle and LOW.
8.	INDICATORS	LED for high speed & middle speed & low speed.
9	TIMER	Sets a time for the unit to automatically start or stop.
10	UP	Increasing the desired temperature(16 °C - 32°C) or timer setting.
11	DIGITAL DISPLAY	Displays timer setting and temperature.

## Remote Control



## Settings

### Start- up and Shutdown

- Press POWER to turn the unit on.
- The unit runs in FAN as default.
- Press MODE button to select the desired operation mode.
- Press POWER again to turn off the power.

### Operation mode

- The unit has four operation modes: Cool, Dry, Fan, Speed.

### A. Cooling your Room

- Select the cool mode to lower the temperature in your room.
- Press MODE button repeatedly until the LED of COOL operation lights up.
- Press Up/Down button to adjust the temperature which is displayed on the screen. The temperature can be set between 16 °C and 32 °C.
- Press SPEED button repeatedly until the desired fan speed indicator lights up.

To control the direction of the air flow horizontally, please press the SWING button on.

NOTE: The air conditioner stops if the room temperature is lower than selected temperature.

### B. Ventilating your Room

- Press MODE button repeatedly until the LED of FAN operation lights up.
- In ventilation mode the room air is circulated, but not cooled.
- Press SPEED button repeatedly to select the fan speed as desired.

### C. Drying your Room

- Press MODE button on the control panel or remote control, the LED of DRY operation lights up. The fan speed is unable to select. User should connect the hose to the drain outlet at the bottom of the unit.

NOTE: In this mode, the fan speed switches over to low speed and the temperature cannot be selected.

### D. Sleep mode

The sleep mode can be activated when in cool mode.

- In cool mode:

After 1 hour the preset temperature is increased by 1°C, after another hour the preset temperature will again be increased by 1 °C .

## Timer Setting ( 1hour-24 hours )

- The timer has two ways of operation:

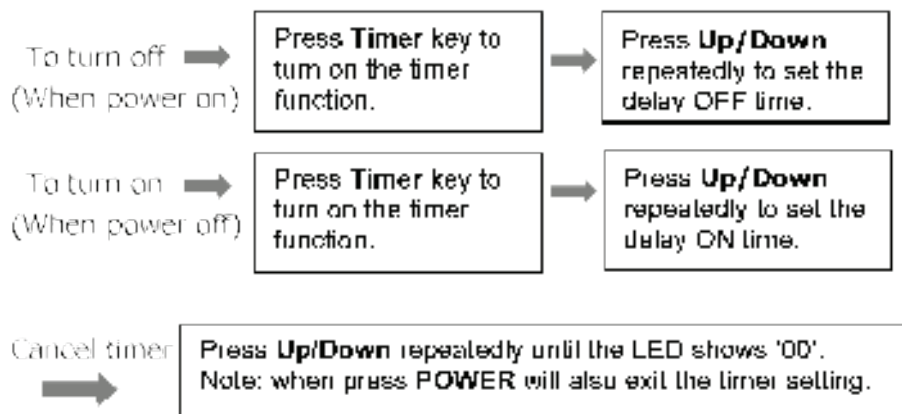

## Automatic Defrost

At low room temperatures, frost may build up at the evaporator during operation. The unit will automatically start defrosting and the **POWER** LED blinking. The defrost control sequence is as follows:

1. When the unit operates in the cooling operation, drying operation, the ambient temperature sensor senses the evaporator coil temperature is below  $-1^{\circ}\text{C}$ , after the compressor will stop operating for 10 minutes or the coil temperature up to  $7^{\circ}\text{C}$ , the unit restart to cool operating mode.
2. When the unit operates in the drying operation, once the coil temperature sensor senses the temperature of the evaporator is below  $-10^{\circ}\text{C}$  (and the differential temperature between coil temperature and room temperature is below  $-9^{\circ}\text{C}$ ) after the compressor operation for 70 minutes, the unit start defrosting for 5 minutes and the power indicator blinking.

## Overload Protection

In the event of a power loss, to protect the compressor there is a 3-minute delay until the compressor restarting.

# Drainage

## Manual drainage:

1) When the machine stops after the water is full, please unplug the power plug.

Notes: Please move the machine carefully, so as not to spill the water in the water pan at the bottom of the body.

2) Place the water container below the side water outlet behind the body.

3) Unplug the water plug, the water will automatically flow into the water container.

## Notes:

1. Keep the water plug properly.

2. During drainage, the body can be tilted slightly backwards.

3. If the water container cannot hold all the water, before the water container is full, stuff the water outlet with the water plug as soon as possible to prevent water from flowing to the floor or the carpet.

4) When the water is discharged, stuff the water plug.

Notes: 1. Restart the machine after the water plug and drainage cover are

installed, otherwise condensate water of the machine will flow to the floor or the carpet.

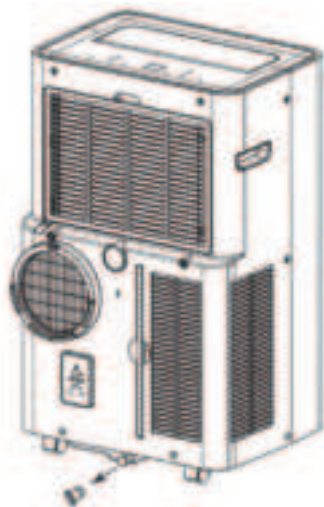

## Continuous drainage

The self-evaporating system uses the collected water to cool the condenser coils for better efficient performance. It is no need to empty the drainage tank in cooling operation except in drying operation and high humidity conditions. The condensate water evaporates at the condenser and evacuated through the exhaust hose.

For continuous operation or unattended operating in drying operation, please connect the attached drain hose to the unit. Condensate water can be automatically flow into a bucket or drain by gravity.

- Switch off the unit before operating.
- Remove the plug of the water outlet opening, and keep it in safe area.
- Securely and properly connect the drain hose and make sure it is not kinked and clear of obstruction.
- Place the outlet of hose over a drain or bucket and ensure that water could freely flow out of the unit.
- Do not submerge the end of hose into water; otherwise it can cause "Air Lock" in the hose.

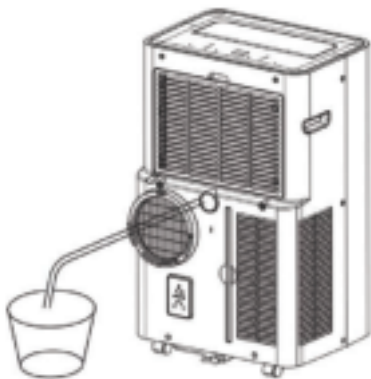

### To avoid water spillage:

- As the negative pressure of condensate drain pan is large, tilt the drain hose downward toward the floor. It is appropriate that the degree of inclination should exceed 20 degrees.
- Straighten the hose to avoid a trap existing in the hose.

## VI. Cleaning and Care

### Cleaning the air Filter (every two weeks)

Dust collects on the filter and restricts the airflow. The restricted airflow reduces the efficiency of the system and if it becomes blocked it can cause damage to the unit.

The air filter requires regular cleaning. The air filter is removable for easy cleaning. Do not operate the unit without an air filter, or the evaporator may be contaminated.

1. Press POWER button to switch off the unit and unplug the power cord. 2. Remove the filter mesh from the unit.
2. Remove the filter mesh from the unit.
3. Use a vacuum cleaner to suck dust from the filter.
4. Turn the filter over and rinse the air filter under running water. Let the water run through the filter in the opposite direction of air flow. Set aside and allow the filter to air dry completely before reinstalling.

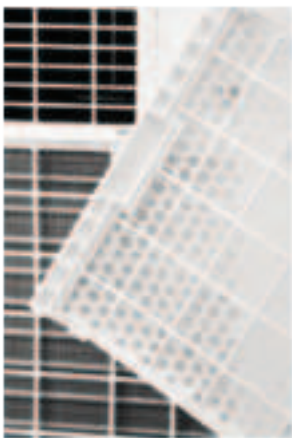

Pic1. Switch off the unit and remove the two air filters.



Pic2. Rinse the air filter under running water.

### Warning!!!

Do not touch the evaporator surface with bare-hand, or could cause injury of your fingers.



# Cleaning up of Refrigerant

## General Measures:

1. Gas/vapor heavier than air. May accumulate in confined spaces, particularly at or below ground level.
2. Eliminate every possible source of ignition.
3. Use appropriate personal protection equipment (PPE).
4. Evacuate unnecessary personnel, isolate, and ventilate area.
5. Do not get in eyes, on skin, or on clothing. Do not breathe vapors or gas.
6. Prevent entry to sewers and public waters.
7. Stop the source of the release, if safe to do so. Consider the use of water spray to disperse vapors.
8. Isolate the area until gas has dispersed. Ventilate and gas test area before entering. Contact competent authorities after a spill.

## VII. Troubleshooting

Symptom		Inspection	Solution
The unit is not operating.		✓ Check the power connection in securely.	➤ Insert the power cord securely into the wallOutlet.
		✓ Check if the water level indicator lights up?	➤ Empty the drain pan by remove the rubber plug.
		✓ Check the room temperature.	➤ The range of operating temperature is 5-35°C.
The unit works with reduced capacity.		✓ Check the air filter for dirt.	➤ Clean the air filter as necessary.
		✓ Check if the air duct is blocked.	➤ To clear the obstacle.
		✓ Check if the room door or window is open.	➤ Keep the door and windows closed.
		✓ Check if the desired operating mode is selected and the temperature is properly set.	➤ Set the mode and temperature at proper set-point according the manual.
		✓ The exhaust hose is detached.	➤ Make sure the exhaust hose is securely attached.
Water Leakage		✓ Overflow while moving the unit.	➤ Empty the water tank before transport.
		✓ Check if the drain hose is kinked or bends.	➤ Straighten the hose to avoid a trap existing.
Excessive Noise		✓ Check if the unit is securely positioned.	➤ Place the unit on horizontal and firm ground.
		✓ Check if any loose, vibrating parts.	➤ Secure and tight the parts.
		✓ Noise sounds like water flowing.	➤ Noise comes from flowing refrigerant. This is normal.
Error Codes	E0	✓ Communication faults between main PCB and display PCB.	➤ Check the wire harness of the display PCB for damage.
	E1	✓ Ambient temperature sensor failure	➤ Check connection or replace it. To clean or replace the temperature sensor.
	E2	✓ Coil temperature sensor failures.	➤ Check connection or replace it. To clean or replace the temperature sensor.
	Ft	✓ Condensate water high level alarm.	➤ Empty the drain pan by removal the rubber plug.

## VIII. Decommissioning

### STORAGE

Long-Term Storage - If you will not be using the unit for an extended period of time (more than a few weeks) it is best to clean the unit and dry it out completely. Please store the unit per the following steps:

1. Unplug the unit and remove exhaust hose and window kit store with the unit.
2. Drain the remaining water from the unit.
3. Clean the filter and let the filter dry completely in a shaded area.
4. Collect the power cord at the water tank.
5. Re-install the filter at its position.
6. The unit must be kept in upright position when in storage.
7. Preserving the machine in ventilating, dry, non- corrosive gas and safe place indoor.

### ATTENTION:

**The evaporator inside the machine has to be dried out before the unit is packed to avoid component damage and molds. Unplug the unit and place it in a dry open area for days to dry it out. Another way to dry the unit is turn on the machine, adjust it to low-wind ventilation mode, and maintain this state until the drainage pipe becomes dry, so as to keep the inside of the body in a dry state and prevent it from mildewing.**

### DISPOSAL



#### **WARNING!!!**

Releasing refrigerant into atmosphere is strictly forbidden!

Do not dispose of electrical appliances as unsorted municipal waste, use separate collection facilities. Contact your local government for information regarding the collection systems available. If electrical appliances are disposed of in landfills or dumps, hazardous substances can leak into the groundwater and get into the food chain damaging your health and well-being.



The design and specifications are subject to change without prior notice for product improvement. Any updates to the manual will be uploaded to the service website, please check for the latest version.

If you have any concerns, please contact us at the following:

Customer hotline: (02) 8852-6868  
Text hotline: +63 917-881-8982  
Email: customerservice@kolinphil.com.ph

Also, please like and follow us on our social media accounts:

Facebook: kolinphilippines  
Instagram kolinphilippines  
Youtube: kolinphilippines  
Tiktok: kolinphilippines  
Website: www.kolinphil.com.ph

KPII032024



## Kolin Phils. Int'l., Inc.

### SERVICE CENTERS

BRANCH	ADDRESS	TEL. NO.
Bacolod	Door #A-2 & A-3 UTC Bldg., Alunan St., Brgy. 36, Bacolod City	(034) 466-9145
Cagayan De Oro	Door #3 De Oro Land Bldg., Julio Pacana St., Puntod, Cagayan de Oro City	(088) 557 - 7353
Cebu	Lot 758-B-1, P. Suico St. Upper Tabok, Mandaue City, Cebu	(032) 234 - 1844
Dagupan	Unit #1 107 Caranglaan District, Dagupan City, Pangasinan	(075) 529 - 0587
Davao	Blk 17 Lot 9, Calamansi St., Juna Subd., Matina, Davao City	(082) 272 - 0048
Iloilo	Door# 4,5 & 7, D' Appliance Arcade, South Fundidor, Molo, Iloilo City	(033) 337 - 5914
Pampanga	LRK Commercial Bldg., Jose Abad Ave., Lagundi, Mexico, Pampanga	(045) 455 - 2934

For More air conditioner tips, please like, share and follow us on our social media accounts:

Facebook : [kolinphilippines](#)  
Instagram : [kolinphilippines](#)  
Youtube : [kolinphilippines](#)  
Tiktok : [kolinphilippines](#)  
Website : [www.kolinphil.com.ph](http://www.kolinphil.com.ph)

### OFFICE

Kolin Bldg. 1854 Sta. Rita St.,  
Guadalupe Nuevo, Makati City, 1212  
Service Hotline: (632) 8852 - 6868

### PLANT

Blk 3 Lot 5, Main Drive First Cavite  
Industrial Estate, Langkaan 1,  
Dasmariñas City, Cavite  
Tel. No.: (046) 402-0793

