

Luoware

SMART TOILET

Concealed cistern series

INSTRUCTION MANUAL

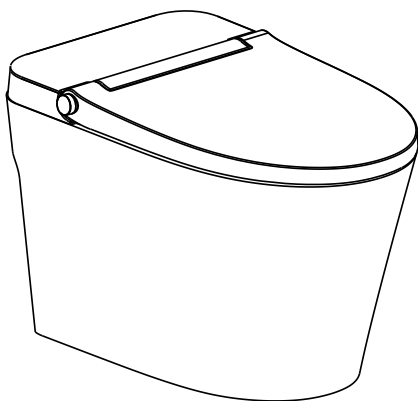

Model: LW-S01 LITE

Customer Service Email:
support@luoware.xyz

- Thank you for purchasing our product.
Before using, please read the instruction carefully.
Please keep the instruction properly for further reference.
- Our company reserves the right of final interpretation for this manual. The manual is subject to change without notice.

Catalogue

Packing List 02

Installation of the Battery Box 04

Components 05

Technical Drawing 06

Features 06

Attentions 07

Installation Instruction 13

Preparation before Use 18

How to Use 19

Cleaning and Maintenance 20

Troubleshooting 22

Product Specification 22

Warranty 23

Packing List

Dear user,

Please count the following items after opening the package:

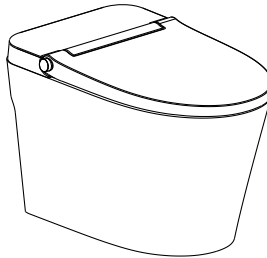

Smart Toilet Lite

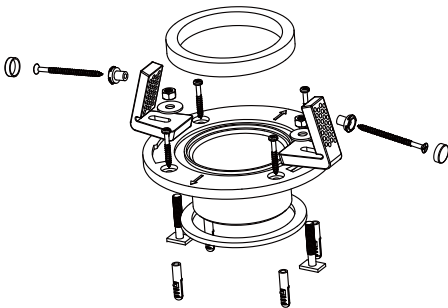

Flange, Sealing Wax Rings,
Mounting Accessory Kit

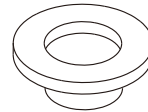

Wax Ring Gasket

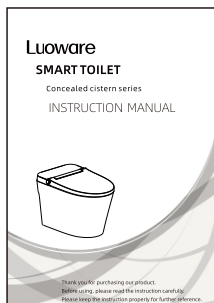

Instruction Manual

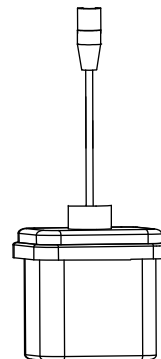

Backup Battery Box
for Power Outage Flush

Packing List

Dear user,

Please count the following items after opening the package:



1 Braided Hose (for Flushing Water)
(Pre-installed)



9/16" thread to 1/2"
(spare part)

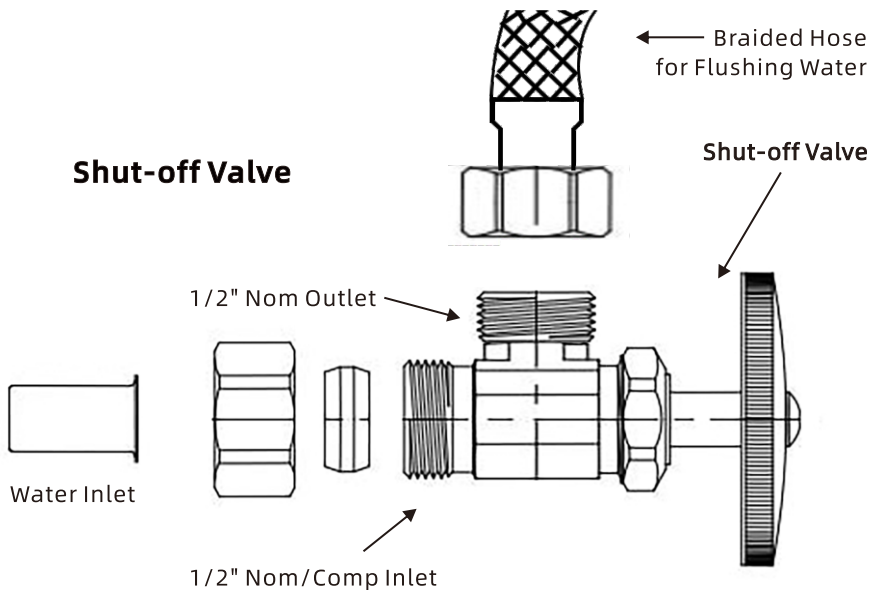

Battery Box for Power Outage Flush

Installation of the Battery Box for Power Outage

1. This battery box is for use as backup during power outages. **The battery box must not be used simultaneously with a plugged-in power source when the toilet is in operation.** It is recommended to connect it to the main unit only during power outages. We accept no responsibility for the consequences of using dual power sources at the same time, and such usage is not covered by the warranty.
2. Before activating the power outage flushing function, install 10 AA alkaline batteries (Batteries not supplied. Please purchase batteries separately before installation.) into the battery box in advance (open the battery box with a screwdriver). Do not mix new and old batteries, batteries of different models, or batteries from different brands. When replacing the batteries, ensure that all are replaced at the same time.
3. Please follow the "+" and "-" signs on the battery box when installing batteries. This battery box is a series battery group, and no single cell can be reversed. Failing to do so may cause battery damage, and in severe cases, may pose safety hazards such as explosion and combustion.
4. Take out the battery connection cable from the rear side of seat cover and connect it to the battery box, ensuring that it is plugged in place.
5. Do not disassemble the battery box unnecessarily. After replacing the battery, make sure to seal the battery box tightly. If moisture from the bathroom gets into the box, it could cause the batteries to rust and become damaged.
6. When replacing batteries, disconnect the battery box from the main unit.
7. To avoid potential hazards, this battery box cannot be recharged.

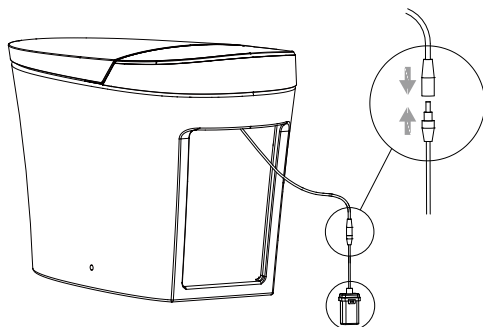

Components

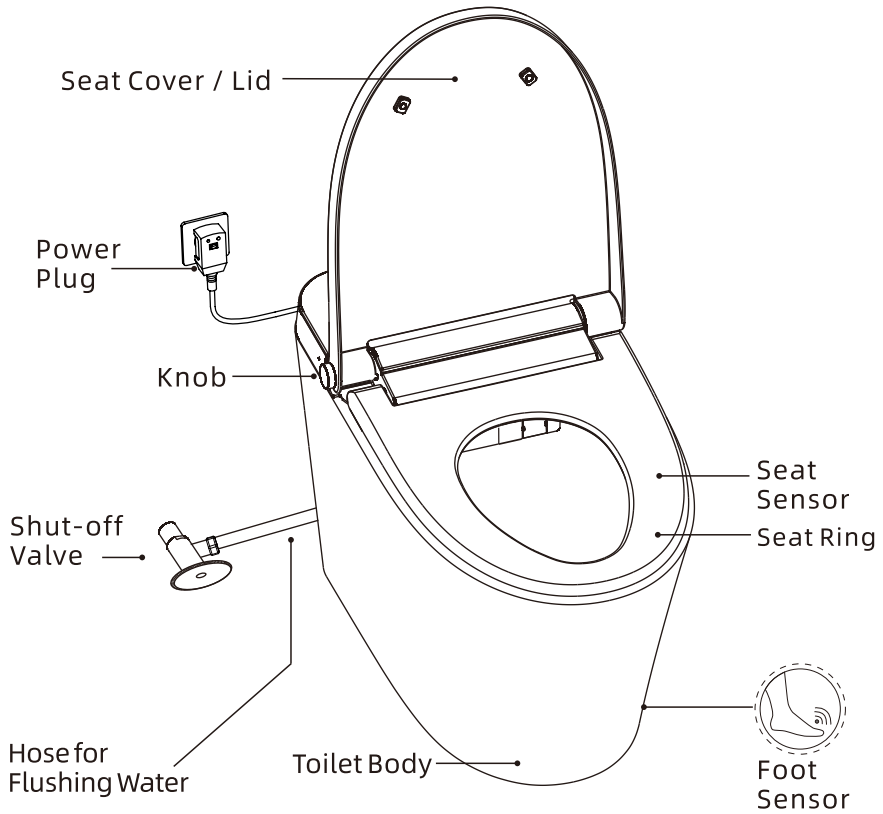

Technical Drawing

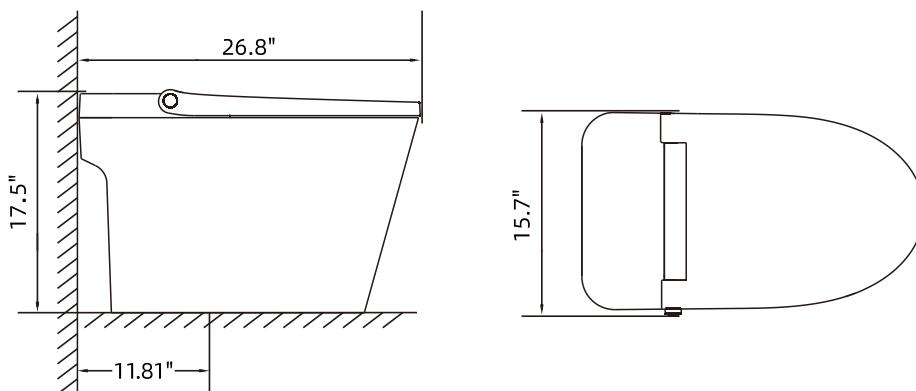

Features

Seat Sensor

All corresponding functions will be activated and be ready after seated.

Seat Ring Temperature Adjustment

Heated seat with 4 levels of temperature adjustment: normal (room temperature) / high / medium / low.

Off Seat Auto Flush

Auto flush after using and standing up from the toilet seat.

Foot Sensor to Flush

Flush by lifting the foot near the sensor.

Flush by Side Knob

Flush by pressing the side knob on the smart toilet.

Night Light

The night light is designed to be gentle on the eyes and provide enough illumination to navigate the bathroom without needing to turn on any harsh overhead lights.

Power Outage Flush

Equipped with a backup battery box, the backup battery can be activated for flushing when there is a power outage.

Attentions



NO WATER

Do not pull the plug with wet hand.

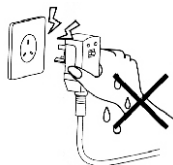

▲Otherwise, it may cause electric shock.



PROHIBIT

Do not pour water, detergent or deodorant on the smart toilet main unit and power plug. Otherwise:

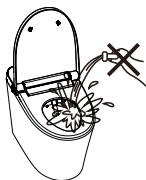

▲It may cause fire, electric shock, short circuit or damage.

▲Injury or indoor water seepage may occur due to product damage.



PROHIBIT

When there is thunder, do not touch the power plug.

▲Otherwise, it may cause electric shock.



PROHIBIT

Do not touch the water inlet hose to the power plug or outlet.

▲Otherwise, it may cause fire, electric shock, heating, or short circuit due to condensation.



PROHIBIT

Do not damage the power cord or plug. Do not forcefully drop, pull, twist, bend, scratch, process, heat, place heavy objects on, tie, or clamp the power cord or plug.

▲Otherwise, it may cause product damage. Continuing to use the product in a damaged state may cause fire, electric shock, heating, or short circuit.



PROHIBIT

Do not use power outlets that are loose or malfunctioning.

▲ Otherwise, it may cause fire or short circuit.



PROHIBIT

Please use power outlets and wiring tools within the specified range.

▲ When the wiring exceeds the specified range of the outlet, it may cause fire due to overheating.



PROHIBIT

Do not use a power source other than the specified one (AC 120V, 60Hz). Please do not plug in until the inlet valve opens.

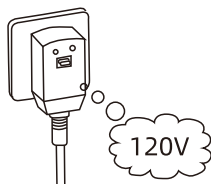

▲ Otherwise, it may cause fire.



NO
DISASSEMBLE

Do not disassemble, repair, or modify this product on your own.

▲ Otherwise, it may cause fire, electric shock, heating, short circuit or damage.



PROHIBIT

Do not install on a moving vehicle, ship, or other mobile structure. Otherwise:

▲ It may cause fire, electric shock, short circuit, or malfunction.

▲ The seat ring, seat cover, and smart toilet main unit may be damaged due to detachment and falling.



PROHIBIT

When the smart toilet malfunctions, do not continue to use it. In the following situations, turn off the power and close the water inlet valve to stop the water supply.

*Water leaks from the hose or product inside to the outside.

*The product has cracks or damage.

*Abnormal sound or odor.

*Product smoking.

*Product abnormal heating.

*The cushion of the seat ring falls off.

▲ Continuing to use the product in a malfunctioning state may cause fire, electric shock, heating, short circuit, injury, or indoor water seepage.



PROHIBIT

Do not use water sources other than tap water or potable well water (groundwater). Otherwise:

- ▲ It may cause corrosion in components or machine malfunctions.
- ▲ It may cause skin inflammation or burns due to unclean water.



MANDATORY

Beware of low-temperature burns.

- ▲ Improper use of the warm seat ring may result in low-temperature burns.
- ▲ If sitting on the seat ring for a long time, please set the temperature of the seat ring to normal/unheated (room temperature).
- ▲ When using the warm seat ring or warm air drying function, please set the temperature of the seat ring to normal/unheated (room temperature) and the temperature of the warm air dryer to the lowest setting for the following groups of people.
 - * Children, the elderly, and those who are unable to adjust the temperature to a suitable level themselves.
 - * Individuals with behavioral impairments such as patients or people with disabilities.
 - * Individuals who have taken hypnotic drugs (such as sleeping pills, cold medicine, etc.), heavy drinkers, and those who are excessively fatigued must use this product under the supervision of a responsible person.



MANDATORY

Please confirm that the power outlet has been waterproofed.

- ▲ Make sure of the position of the outlet before installation and keep it away from the bathtub as much as possible.
- ▲ If it is not waterproofed, it may cause fire or electric shock.
- ▲ For the installation and waterproofing of the outlet, please consult qualified professionals.



MANDATORY

Please confirm that the outlet being used is correctly grounded.

- ▲ Otherwise, it may cause electric shock due to malfunction or short circuit.
- ▲ When installing the ground wire, please entrust a professional installation company.



MANDATORY

Do not pull out the power plug by holding the power cord. When unplugging the power plug, do not hold the power cord, but hold the power plug.

▲Otherwise, it may cause fire or heating due to damage to the power cord.



MANDATORY

Please make sure to firmly insert the power plug into the outlet.

▲Otherwise, it may cause fire, heating, or short circuit.



MANDATORY

If the power cord is damaged, it must be replaced by the manufacturer, maintenance department, or other professionals to avoid potential hazards.



MANDATORY

When performing maintenance, be sure to turn off the power.

▲Otherwise, it may cause electric shock.



MANDATORY

This is an electrical product. Do not install it in places where it is easy to be splashed with water or where the humidity is high. When using it in the bathroom, please install an exhaust fan or ventilation opening to keep the bathroom well ventilated.

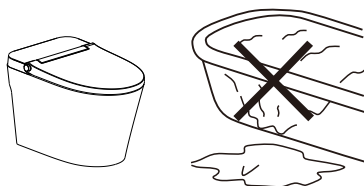

▲Otherwise, it may cause fire or electric shock.



MANDATORY

When removing the smart toilet main unit, be sure to disconnect the power.

▲Otherwise, it may cause fire or electric shock.



MANDATORY

Individuals with physical, sensory, or cognitive disabilities, or those lacking experience and knowledge of this product (including children), must use this product under the supervision of a responsible person. Children should not play with this product.

▲Otherwise, it may cause burn, electric shock, fire, or injury.



NO BURNING

Do not let cigarettes or other sources of fire get close to the product.

▲Otherwise, it may cause fire.



PROHIBIT

When maintaining plastic parts (seat ring, seat cover, etc.) and water inlet hoses, please use kitchen detergent (neutral). Do not use the following items: toilet cleaner, household detergent, gasoline, benzene, washing powder, or nylon brushes. Otherwise:

▲It may damage plastic parts, causing cracks and resulting in personal injury or malfunction.

▲It may damage the water inlet hose and cause water leakage.



PROHIBIT

Do not forcibly impact the product. Do not place heavy objects on or stand on the seat ring, seat cover, or smart toilet main unit. Otherwise:

▲The product may crack, and the smart toilet main unit may detach and fall, causing personal injury.

▲Injury or indoor water seepage may occur due to product damage.



PROHIBIT

Do not use the smart toilet when its main unit is loose.

▲Otherwise, the smart toilet main unit may detach and fall, causing personal injury.



PROHIBIT

Do not use your hands to lift the smart toilet main unit by holding the seat ring or seat cover. Do not open the seat ring or seat cover when there are items on them.

▲Otherwise, the smart toilet main unit may detach and fall, causing personal injury.



PROHIBIT

Do not violently open or close the seat cover or seat ring, or swing the seat cover and seat ring quickly. Otherwise:

▲The flipping device may fail due to the powerful external force.

▲The main unit may break or detach from the toilet body due to powerful external force, causing personal injury.



PROHIBIT

Do not bend or damage the water inlet hose.

▲Otherwise, it may cause water leakage.



PROHIBIT

Please use the new hose component provided with the product. The old hose cannot be reused.

▲ Using the old hose component may result in water leakage or hose rupture.



MANDATORY

When water leaks, be sure to turn off the shut-off valve.



MANDATORY

In order to prevent pipes or hoses from being damaged due to freezing, anti-freezing measures should be taken.

▲ When the water inlet hose is frozen, it may damage the main unit of the smart toilet or the pipe and cause water leakage.

▲ If the room temperature is below 32°F/0°C, it is recommended to empty the water inside the product to prevent internal cracking due to freezing.



MANDATORY

When the smart toilet is not used for a long time, be sure to drain the water from the smart toilet main unit and water inlet hose, and disconnect the power supply. When using it again, please first let the water flow through, and then use it. Otherwise:

▲ It may cause skin inflammation due to water deterioration.

▲ If the power is always turned on, it may cause fire or heating.



MANDATORY

Do not use any paper other than toilet paper, and do not drop objects that may clog the drain into the toilet bowl.

▲ Otherwise, it may cause blockages in the ceramic pipes of the toilet.



PROHIBIT

Do not put any solid substances or corrosive liquids into the water tank.

▲ Otherwise, it may cause blockages or corrosion of the flushing water pipe.

Installation Instruction

■ Installation of the Smart Toilet

1. Confirmation of installation environment

Before installation, please confirm that the bathroom wall and floor tiles have been completed, and that the sewage pipes, water pipes, and electrical circuits have been reserved as shown in the figure below. This toilet rough-in is 300mm (11.81in); Water inlet pressure range: 0.15Mpa (dynamic) - 0.75Mpa (static); water inlet temperature: 4°C-35°C (39.2°F-95°F).

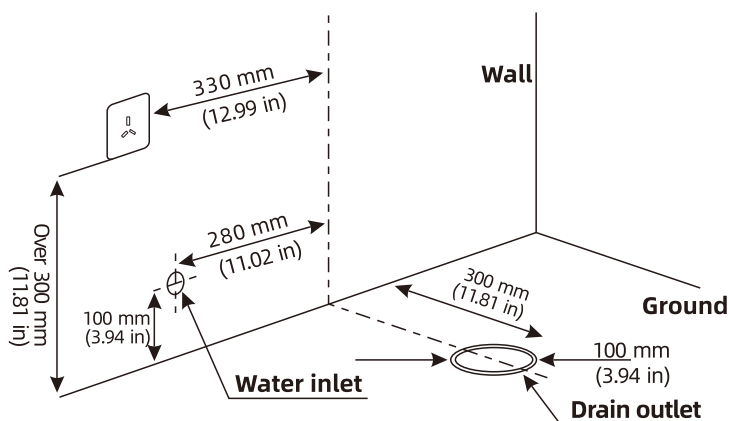

2. Assembly of dedicated shut-off valve

Install the shut-off valve provided with the product.

- Note: Remove the old water supply valve if it has been installed before.

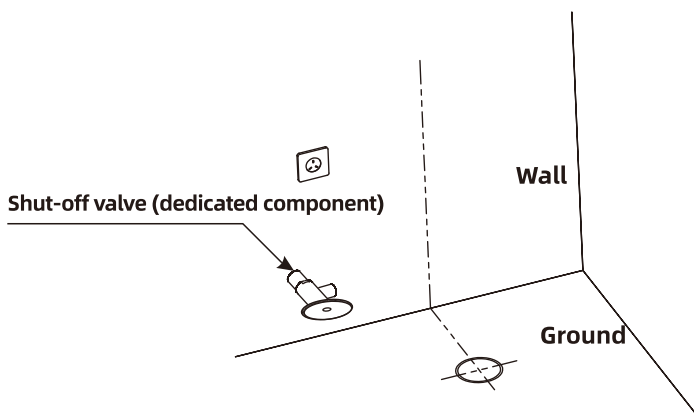

3. Installation and mounting of the toilet

(1.1) Assemble the mounting bracket with bolts and then secure them to the flange on the ground and tighten with nuts. **Please refer to Figure 1.0 on the next page for details.**

(1.2) Insert the wax ring gasket under the toilet.

(1.3) Install the toilet on the corresponding position.

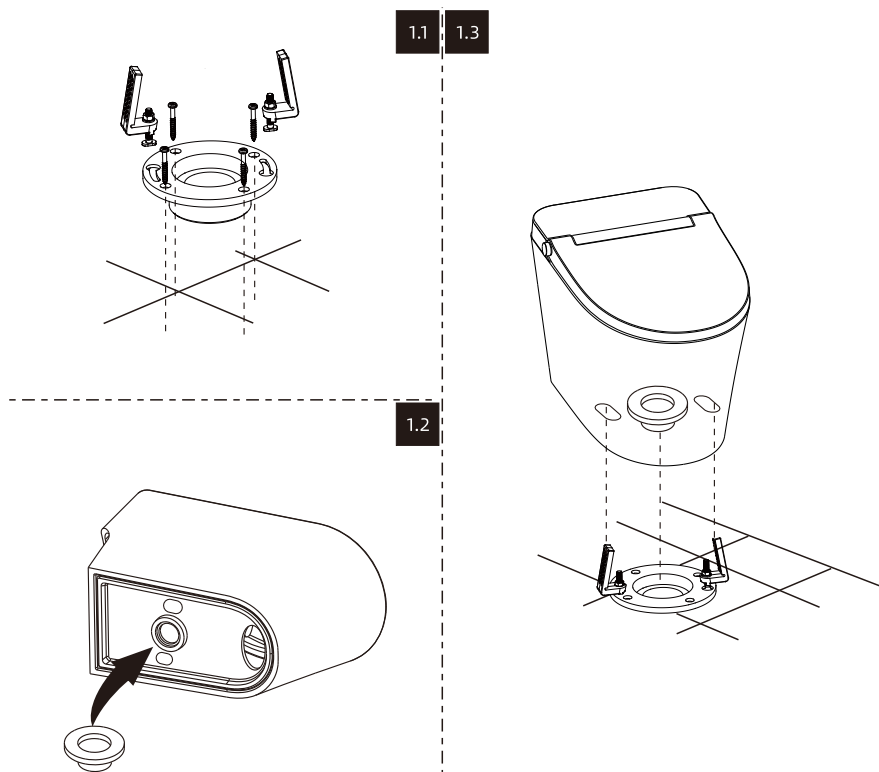

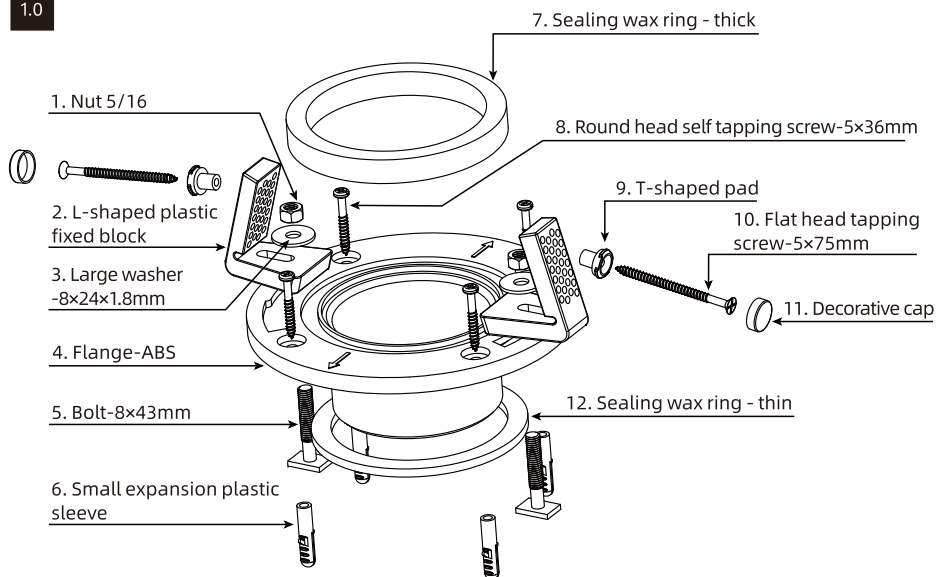

Flange accessories package

Details:

- 1. Nut 5/16 (2pcs)
- 2. L-shaped plastic fixed block (2pcs)
- 3. Large washer-8×24×1.8mm (2pcs)
- 4. Flange-ABS (1pc)
- 5. Bolt-8×43mm (2pcs)
- 6. Small expansion plastic sleeve (4pcs)
- 7. Sealing wax ring - thick (1pc)
- 8. Round head self tapping screw-5×36mm (4pcs)
- 9. T-shaped pad (2pcs)
- 10. Flat head tapping screw-5×75mm (2pcs)
- 11. Decorative cap (2pcs)
- 12. Sealing wax ring - thin (1pc)

Optional accessories

- 13. Outer hexagon self tapping screw-6×60mm (2pcs)
- 14. Small washer-6×16×1mm (2pcs)
- 15. Large expansion plastic sleeve (2 pcs)

Optional accessories

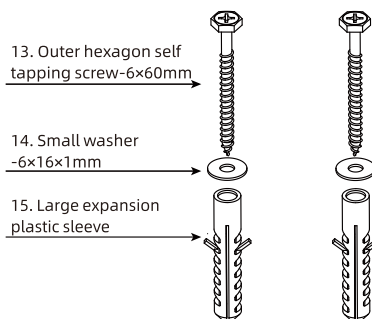

(2.1) Put the screw through the T-shaped pad and then install it through the holes (on both sides of the toilet ceramic) to the mounting bracket (L-shaped plastic fixed block) on the ground, and tighten it securely with a tool.

(2.2) Put the decorative cap on the T-shaped pad.

(2.3) Connect the water inlet hose and water pump with the water tank and tighten them with an adjustable wrench.

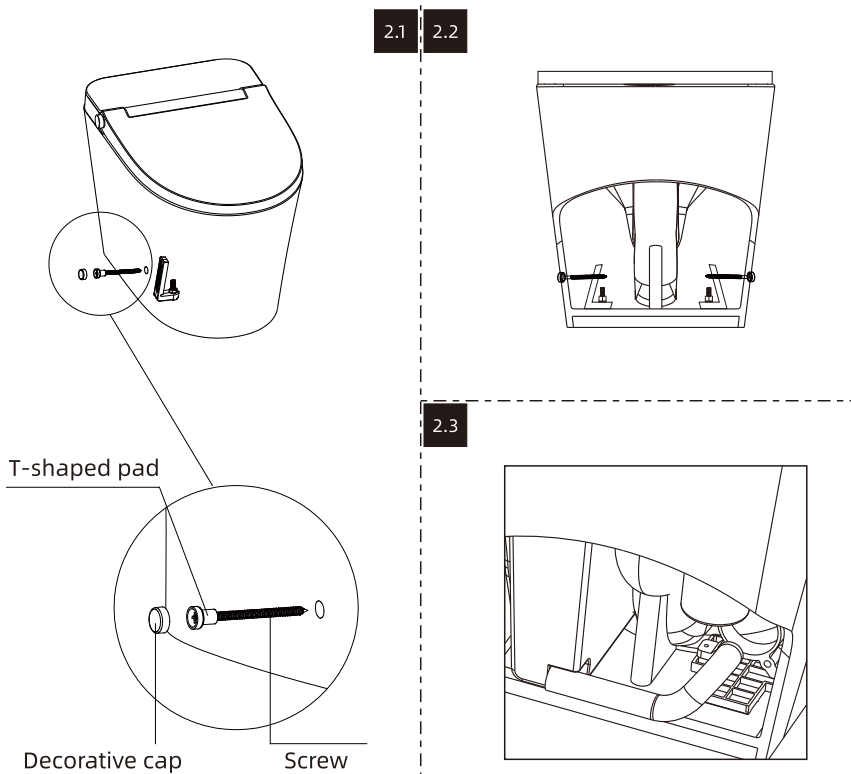

(3) Caulk the bottom of the toilet with silicone sealant.

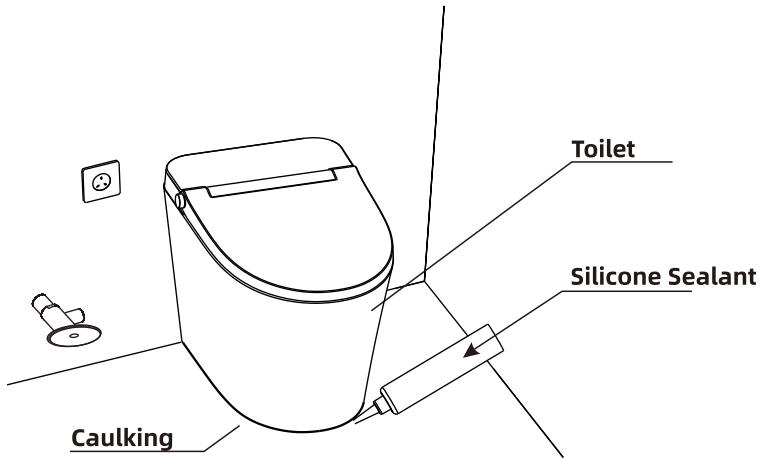

4. Connection of the water inlet hose

Connect the inlet hose with the shut-off valve by using tools like wrench.
(Valve Installation - Refer to Page 3 for Details)

● Notice: After installation, turn on the shut-off valve to check whether it leaks.

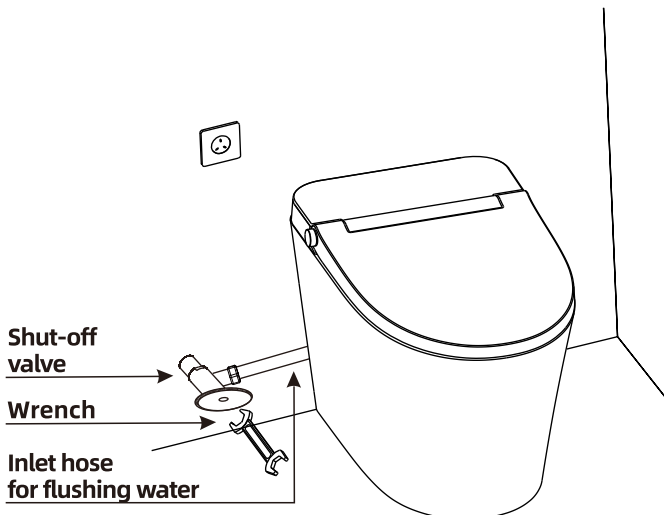

Preparation before Use

1. Open the shut-off valve

Turn the valve counterclockwise to fully open the water supply valve.

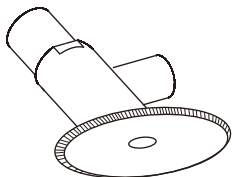

2. Plug the power plug into the outlet.

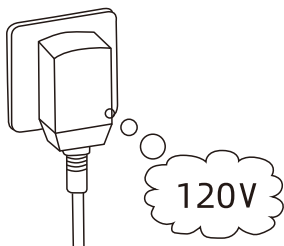

Plug the power plug into a 120V power outlet. The smart toilet will perform a self-check run once, and the main unit will be in standby mode.

- Do not use wiring that exceeds the power supply specifications, such as an extension cord.
- The outlet must be reliably and safely grounded.

How to Use

■ Side Knob

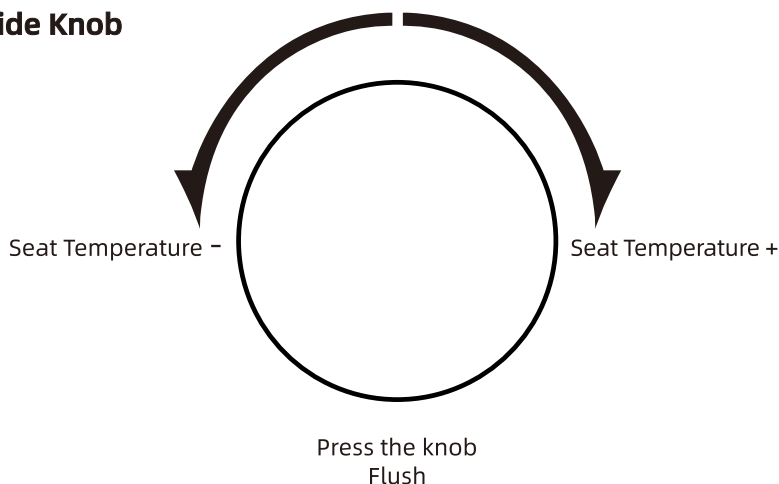

- Rotate clockwise to increase seat temperature.
- Rotate counterclockwise to decrease seat temperature.
- Press the side knob to flush.
- Long press the side knob for 3 seconds to turn the night light on/off.

■ Functions

● Flush

Auto Flush: The toilet will auto flush once when the user stands up from the seat.

Flush by the Side Knob: Short press the knob down vertically to flush once.

Flush by Foot Sensor: Stretch your foot slightly against the sensor sign on the ceramic surface, and the water will start flowing once you remove your foot.

● Heated Seat

The seat ring temperature can be adjusted to 4 different levels, including room temperature, high, medium, and low levels. Rotate the side knob to switch between different temperature levels.

Cleaning and Maintenance

■ Clean and Maintain the Power Plug

Please clean the power plug regularly. When cleaning, remove the power plug from the outlet and wipe it with a dry cloth.

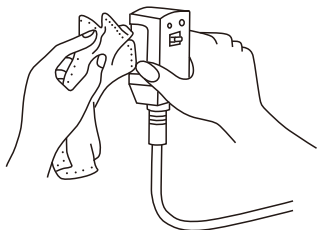

- Dust accumulation on the power plug may cause fire.

■ Clean and Maintain the Main Unit of the Smart Toilet

When cleaning the surface of the main unit, please wipe it with a soft, wet cloth.

- When cleaning and maintaining the smart toilet main unit, please pull the power plug out of the outlet to avoid any contact with water.
- If the surface has stubborn stains, you can use a soft, wet cloth with neutral kitchen detergent to clean it.

■ Clean and Maintain the Ceramic Part of the Smart Toilet

You can pour a neutral toilet cleaner onto a soft brush or sponge and use it to clean the ceramic part of the smart toilet. Rinse the area with tap water after cleaning.

- Do not use detergents or disinfectants that contain chlorine or are acidic.
- Do not use brushes that contain abrasive materials.

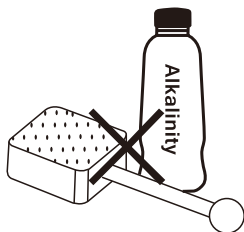

■ When not in use for a long time

When not using this product for a long time, please be sure to drain all the water from the smart toilet to prevent water deterioration and freezing. Also, turn off the power and remove the battery from the remote control.

(1) Close the shut-off valve and stop the water supply.

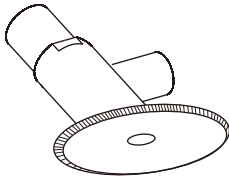

(2) Unplug the power plug from the outlet.

(3) Remove the water hose from the shut-off valve, drain the water from the hose, and then reinstall it.

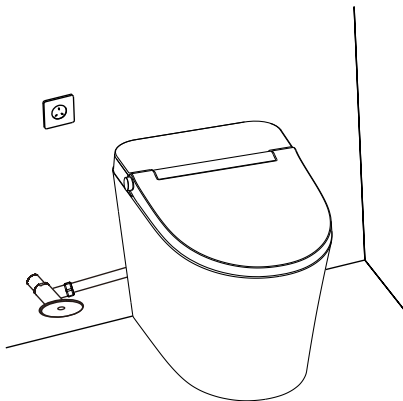

● When using again, open the shut-off valve, plug the power plug back into the outlet.

Troubleshooting

Some malfunctions can be resolved by simple operations. Please confirm the following items before authorizing a professional to repair the product.

Problem	Possible Reason	Solution
Press the side knob and it does not work (the ambient light is not on).	Is the power outlet powered on?	Please confirm whether there is a power failure or whether the circuit breaker has tripped.
	Is the power plug switch in the off position? (Is the power plug indicator light off?)	Press the reset button on the power plug to light up the indicator light.
	Is the power plug plugged in properly?	Reconnect the power plug and insert it completely.
The seat temperature is not hot enough.	Are the temperature settings appropriate?	Use the side knob to set the corresponding temperature.

Product Specification

Model		LW-S01 LITE
Rated Voltage		120V~60Hz
Rated Power		45W
Power Cord Length		1.2M
Water Pressure Range		0.15MPa (dynamic pressure) ~ 0.75MPa (static pressure)
Flush Water Consumption		1.03 gallons per flush (Less than 4.0L)
Energy Consumption per Unit Cycle		Less than 0.03kWh
Overall Unit Waterproof		IPX4
Product Dimensions		LWH: 26.8*15.7*17.5in (680*400*445mm)
Product Weight		84.9 LB (38.5KG)
Heated Seat Ring	Heating Power	40W
	Seat Ring Temperature	4-level adjustable: 1st level 95°F, 2nd level 100°F, 3rd level 104°F, room temperature
	Safety Device	Thermal Fuse

Warranty

Luoware warrants its products as listed in below to be free of material and workmanship defect, subjected to the limitations set forth in this limited warranty.

***Model Number: LW-S01 LITE, 2 Year limited to be free of defects in material and workmanship.**

This limited warranty is non-transferable and only applies to products purchased and installed in the United States.

This limited warranty excludes all industrial, commercial and business usage. Proof of purchase (original sales receipt) from the original purchaser, Description and pictures of defect, model number or model description must be provided to Luoware for all warranty claims and Luoware IS NOT responsible for labor cost, removal or installation costs.

This limited warranty shall not apply to goods which have been subject to accident, negligence, improper installation, product abuse, product misuse, or use of cleaners containing abrasives, alcohol or other organic solvents, whether performed by a contractor, service company, or yourself, are excluded from this warranty.

This warranty does not cover surface damaged caused by use of chemicals that break through or dissolve the surface finish or damage caused by the accidental dropping of sharp or heavy objects. Improper care and use of abrasive cleaners and will void the warranty.

During this limited warranty period if a malfunction occurs and after inspection it is determined that a defect developed during normal use, Luoware's obligations under this warranty are limited to repair, replacement, or any other appropriate adjustment, at Luoware's option, of the smart toilet or parts found to be defective in normal use, provided that such products are properly installed, used and serviced in accordance with instructions. Luoware reserves the right to make such inspections as may be necessary in order to determine the cause of the defect.

Caution:

NEVER use cleaners containing abrasive cleaners, ammonia, bleach, acids, waxes, alcohol, solvents or other products that are not recommend for Chrome finish will void the warranty.

Luoware products should be installed by a fully insured and licensed contractor only. Installation by anyone other than fully insured and licensed contractor will void this limited warranty.

RESPONSIBILITIES OF OTHERS

Inspecting the unit prior to installation is the responsibility of the installer or building contractor who acts on behalf of the user. They are responsible for ensuring the unit is free of defect or damage. In the event of a problem, the unit must not be installed. Luoware is not responsible for failures or damage that could have been discovered, repaired, or avoided by proper inspection and testing prior to installation.

Damage occurring in transit is the responsibility of the carrier. The user or installer **MUST** open the carton and inspect the unit for damage when it is delivered. If damage is discovered, it must be reported immediately to the seller and the carrier in writing, and an inspection requested. Failure of the carrier to respond should be reported to the seller and the carrier. Your freight claims should be filed promptly thereafter.

This limited warranty does not cover any liability for consequential or incidental damages, all of which are hereby expressly disclaimed, or the extension beyond the duration of this limited warranty of any implied limited warranties, including those of merchantability or fitness for an intended purpose.

DISCLAIMER

Except as expressly provided, there shall be no warranty or obligation, express or implied, oral or statutory. No dealer or other person has the authority to make any warranties or representations concerning or its products. In no event shall be held responsible for any such warranties or representations.

Some states/provinces do not allow limitations on how long an implied warranty lasts, or the exclusion on limitation of special, incidental or consequential damages, so these limitations and exclusions may not apply to you. This warranty gives you specific legal rights, you may also have other rights which vary from state/province to state/province.

To obtain warranty and replacement parts, please send e-mail to **support@luoware.xyz** with the original receipt information, Luoware will determine how to fix the problem.

Luoware



www.luoware.xyz



info@luoware.xyz



support@luoware.xyz



[@luoware.global](https://www.instagram.com/luoware.global)



[@luoware.global](https://www.tiktok.com/@luoware.global)



[@luoware](https://www.youtube.com/luoware)